

04-26-13 LETTING ITEM 152

STATE OF ILLINOIS
 DEPARTMENT OF TRANSPORTATION
 DIVISION OF HIGHWAYS
PROPOSED
CONTRACT MAINTENANCE

FOR INDEX OF SHEETS, SEE SHEET NO. 2

F.A.P. ROUTE 745 (IL 104)
 SECTION (106)RS-6, 1-2
 PROJECT RESURFACING & PATCHING
 TYPE of IMPROVEMENT
 ADAMS COUNTY

C-96-014-13

R 6 W

F.A.P. RTE.	SECTION	COUNTY	TOTAL SHEETS	SHEET NO.
745	(106)RS-6, 1-2	ADAMS	6	1
		ILLINOIS	CONTRACT NO. 72F82	

D-96-014-13

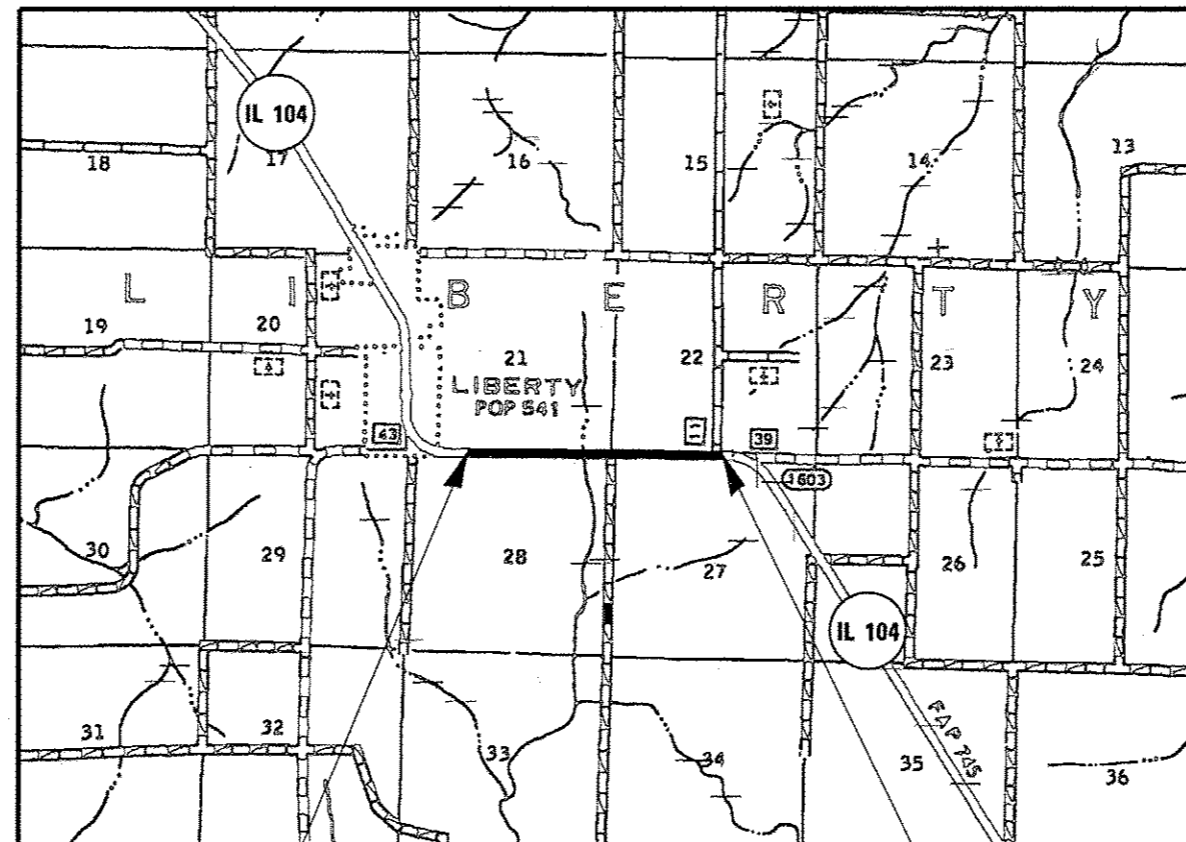
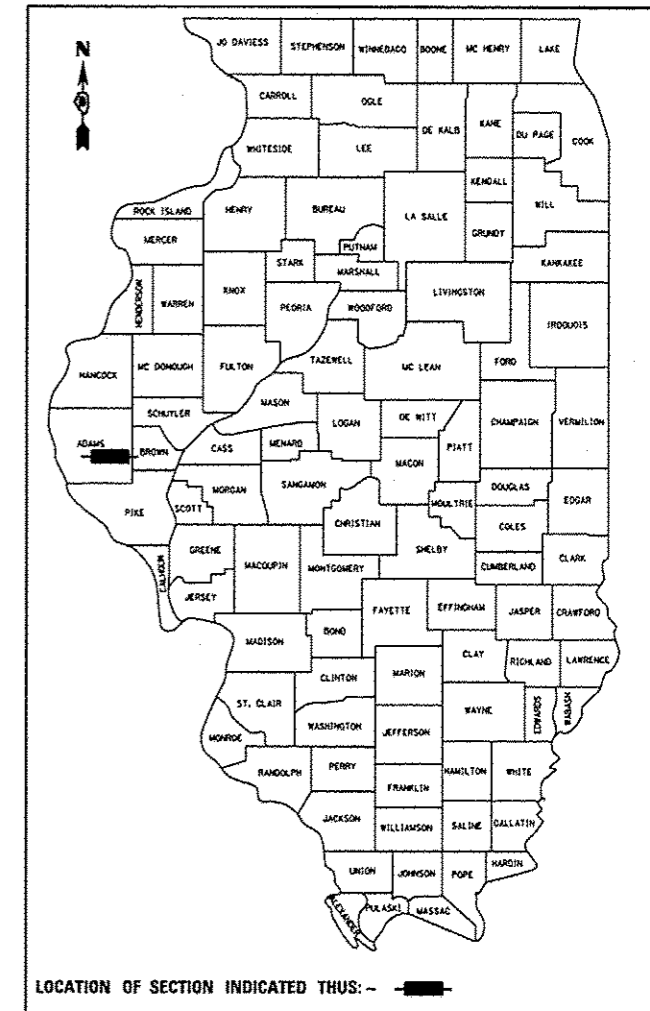

BEGIN PROJECT
 STA. 875+00.00

END PROJECT
 STA. 945+50.00

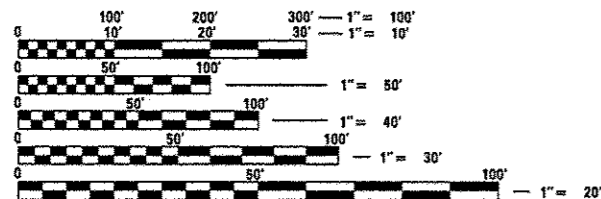

FULL SIZE PLANS HAVE BEEN PREPARED USING STANDARD ENGINEERING SCALES. REDUCED SIZED PLANS WILL NOT CONFORM TO STANDARD SCALES. IN MAKING MEASUREMENTS ON REDUCED PLANS, THE ABOVE SCALES MAY BE USED.

J.U.L.I.E.
 JOINT UTILITY LOCATION INFORMATION FOR EXCAVATION
 1-800-892-0123
 OR 811

PLAN AND CONTRACT TECHNICIAN
 TIM SHARP (217) 782-7743
 DAVE SHAH
 CONTRACT NO. 72F82

NET LENGTH = 7,050.00 FT. = 1.335 MILE

ADT (COUNT): 1300
 SU (%): 4.62
 MU (%): 3.08

STATE OF ILLINOIS
 DEPARTMENT OF TRANSPORTATION
 DIVISION OF HIGHWAYS

SUBMITTED February 1 20 13
Rep. J. Orskov
 DEPUTY DIRECTOR OF HIGHWAYS, REGION ENGINEER

March 22 20 13
John D. Baranzoli, PE, BS
 ENGINEER OF DESIGN AND ENVIRONMENT

March 22 20 13
Omer Osman, PE, BS
 DIRECTOR OF HIGHWAYS, CHIEF ENGINEER

PRINTED BY THE AUTHORITY
 OF THE STATE OF ILLINOIS

INDEX OF SHEETS

SHEET NO.	DESCRIPTION
1.	COVER SHEET
2.	INDEX OF SHEETS, STANDARDS, SIGNATURES, MIX. REQ.
3.	PROJECT LOCATION
4.	SUMMARY OF QUANTITIES
5.	SCHEDULE OF QUANTITIES
6.	TYPICAL SECTIONS

STANDARDS

STANDARD NO.	DESCRIPTION
701011-03	OFF-RD MOVING OPERATIONS, 2L, 2W, DAY ONLY
701201-04	LANE CLOSURE, 2L, 2W, DAY ONLY FOR SPEEDS >45 MPH
701206-03	LANE CLOSURE, 2L, 2W, NIGHT ONLY FOR SPEEDS > 45 MPH
701301-04	LANE CLOSURE, 2L, 2W, SHORT TIME OPERATIONS
701306-03	LANE CLOSURE, 2L, 2W, SLOW MOVING OPERATIONS DAY ONLY, FOR SPEEDS > 45 MPH
701311-03	LANE CLOSURE, 2L, 2W MOVING OPERATIONS - DAY ONLY
701901-02	TRAFFIC CONTROL DEVICES

STATE OF ILLINOIS DEPARTMENT OF TRANSPORTATION DIVISION OF HIGHWAYS DISTRICT 6	
EXAMINED <u>1/27</u> 20 <u>13</u>	<u>Bill Ryan</u> ENGINEER OF OPERATIONS
EXAMINED <u>JAN 9</u> 20 <u>13</u>	<u>[Signature]</u> ENGINEER OF PROJECT IMPLEMENTATION
EXAMINED <u>Jan 9</u> 20 <u>13</u>	<u>[Signature]</u> ENGINEER OF PROGRAM DEVELOPMENT

MIXTURE REQUIREMENTS		
THE FOLLOWING MIXTURE REQUIREMENTS ARE APPLICABLE FOR THIS PROJECT		
MIXTURE USES (S):	SURFACE	PATCHING
AC/PG:	PG 64-22	PG 64-22
DESIGN AIR VOIDS:	4.0% @ N50	4.0% @ N50
MIXTURE COMPOSITION:	IL 9.5	IL 19.0
FRICTION AGGREGATE:	MIX C	N/A



LIBERTY

BEGIN PROJECT
STA. 875+00.00

END PROJECT
STA. 945+50.00

FILE NAME *	USER NAME * shahdm	DESIGNED -	REVISED -	STATE OF ILLINOIS DEPARTMENT OF TRANSPORTATION	PROJECT LOCATION	F.A.P. RTE.	SECTION	COUNTY	TOTAL SHEETS	SHEET NO.	
c:\pwork\pwork\shahdm\d9328871\06xxx	shh-details.dgn	DRAWN - DMS	REVISED -			745	(106)RS-6,1-2	ADAMS	6	3	
Default	PLOT SCALE * 48.0000' / in.	CHECKED -	REVISED -			CONTRACT NO. 72F82					
	PLOT DATE * Jan-14-2013 09:33:24AM	DATE -	REVISED -			ILLINOIS FED. AID PROJECT					
				SCALE:	SHEET	OF	SHEETS	STA.	TO	STA.	

100% STATE

CODE NO.	ITEM	UNIT	TOTAL QUANTITY	ROADWAY
				0005
				S.N.
40600200	BITUMINOUS MATERIALS (PRIME COAT)	TON	7.6	7.6
40600895	CONSTRUCTING TEST STRIP	EACH	1	1
40600990	TEMPORARY RAMP	SQ YD	28	28
40603310	HOT-MIX ASPHALT SURFACE COURSE, MIX "C", N50	TON	1,587.00	1,587.00
44000155	HOT-MIX ASPHALT SURFACE REMOVAL, 1 1/2"	SQ YD	19,975.00	19,975.00
44200144	PAVEMENT PATCHING, TYPE II, 12 INCH	SQ YD	200.0	200.0
44200148	PAVEMENT PATCHING, TYPE III, 12 INCH	SQ YD	250.0	250.0
44200150	PAVEMENT PATCHING, TYPE IV, 12 INCH	SQ YD	500.0	500.0
48101200	AGGREGATE SHOULDERS, TYPE B	TON	124.0	124.0
67100100	MOBILIZATION	L SUM	1	1
70100450	TRAFFIC CONTROL AND PROTECTION, STANDARD 701201	L SUM	1	1
70100460	TRAFFIC CONTROL AND PROTECTION, STANDARD 701306	L SUM	1	1
70300100	SHORT TERM PAVEMENT MARKING	FOOT	1,410.0	1,410.0
70301000	WORK ZONE PAVEMENT MARKING REMOVAL	SQ FT	235.0	235.0
* 78001120	PAINT PAVEMENT MARKING - LINE 5"	FOOT	23,761.0	23,761.0
* 78100100	RAISED REFLECTIVE PAVEMENT MARKER	EACH	89.0	89.0
78300200	RAISED REFLECTIVE PAVEMENT MARKER REMOVAL	EACH	89.0	89.0

NOTE:
 COST OF SAW CUTS AND BUTT JOINTS SHALL BE INCLUDED IN
 HOT-MIX ASPHALT SURFACE REMOVAL 1 1/2" AND NOT PAID
 FOR SEPARATELY.

*SPECIALTY ITEM

PAVEMENT MARKING SCHEDULE			
STATION	TYPE	PAINT PAVEMENT MARKING - LINE 5"	
		WHITE	YELLOW
LT & RT 875+00 TO 945+50	EDGE	14100	
LT & RT 875+00 TO 945+50	SKIP-DASH		1270
RT 875+00 TO 882+86	NO PASSING		786
LT 875+00 TO 893+13	NO PASSING		1813
RT 892+88 TO 902+00	NO PASSING		912
RT 911+33 TO 922+15	NO PASSING		1082
LT 902+90 TO 932+53	NO PASSING		2963
RT 938+95 TO 945+50	NO PASSING		655
LT 943+70 TO 945+50	NO PASSING		180
SUB-TOTAL		14100	9661
TOTAL		23761	

AGGREGATE SHOULDER TYPE "B"	TONNAGE
LT & RT 875+00 TO 882+38	29
LT & RT 892+20 TO 901+10	32
LT 907+00 TO 912+45	10
RT 909+00 TO 912+45	6
LT & RT 924+00 TO 937+25	48
TOTAL	125

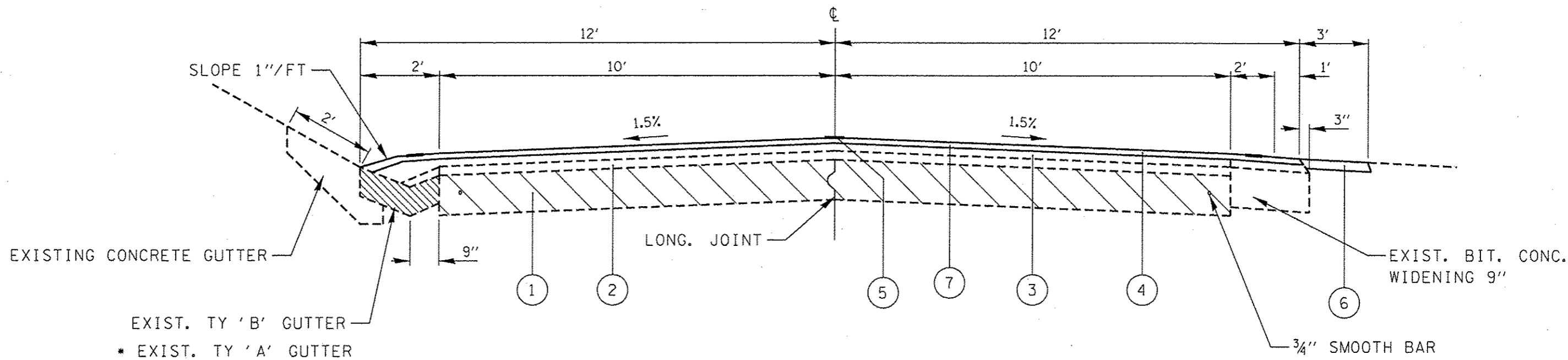

LT & RT	STA. 875+00.00 TO STA. 882+43.00
LT & RT	STA. 891+96.00 TO STA. 901+12.00
LT & RT	STA. 924+50.00 TO STA. 936+97.00
RT	STA. 936+97.00 TO STA. 937+54.00
LT	STA. 936+97.00 TO STA. 945+00.00 *

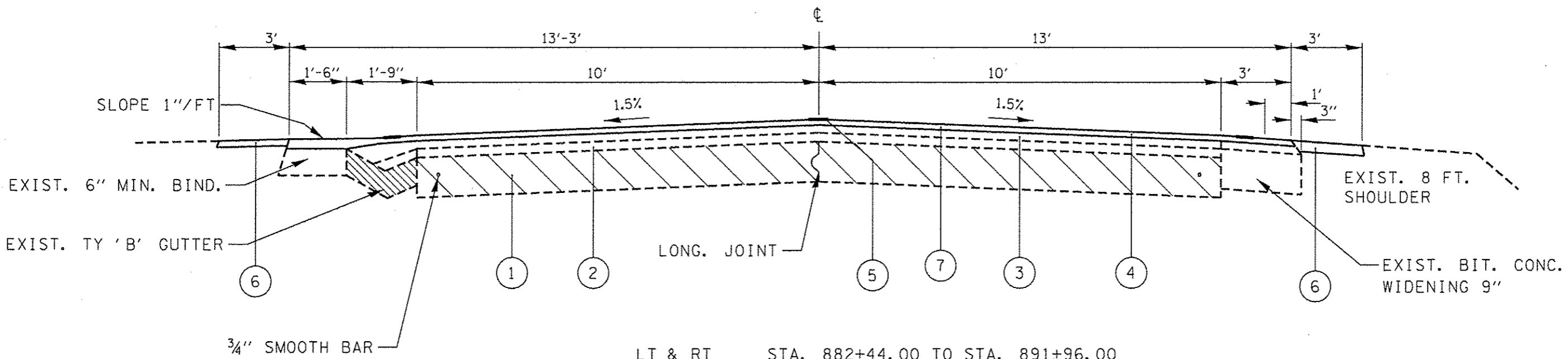

LT & RT	STA. 882+44.00 TO STA. 891+96.00
RT	STA. 937+54.00 TO STA. 945+50.00

LEGEND

- ① EXIST. PAVEMENT
- ② EXIST. BITUMINOUS OVERLAY
- ③ EXIST. 1 3/4" BIT. CONC. BIND. CSE.
- ④ EXIST. 1 1/4" BIT. CONC. SURF. CSE. CL I
- ⑤ PROP. PAVT. MARKING, 5"
- ⑥ PROP. AGG. SHOULDERS.
- ⑦ 1 1/2" PAVT. REMOVAL/REPLACEMENT