

NOTE: Complete All Work on One Splice Before Beginning Rivet Removal on Next Splice.

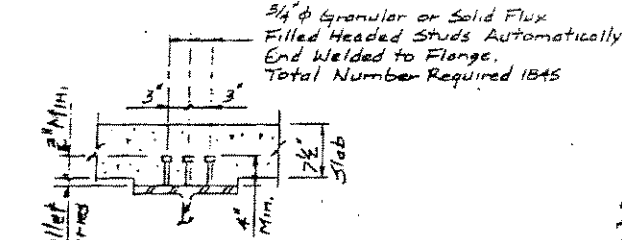
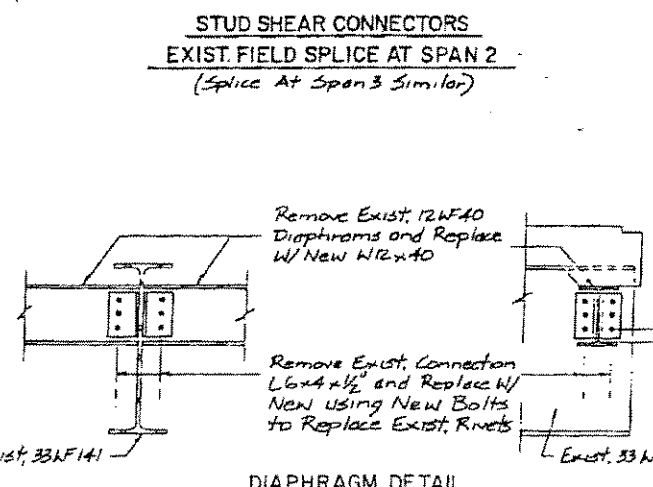
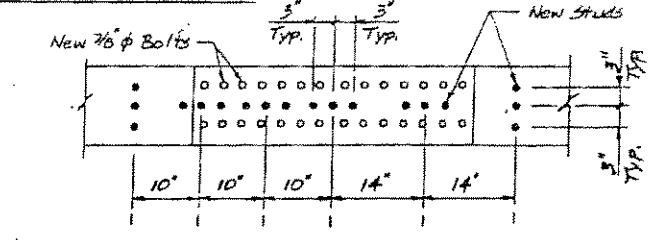

NOTES
 All Existing Top Flange Surfaces Which Shall be in Contact with New Concrete Shall be Cleaned to Satisfy Art. 509.06(b) Method II, Locations to Receive Studs Shall be Cleaned to Bare Metal to Satisfy Method II per Art. 507.05(m)(2). Cost of this work is incidental to Removal of Existing Concrete Deck.
 All Bolts to Be M164
 For Beam Load Tables See Sht. 17
 Stage Diaphragm Replacement to Match Deck Staging.

BILL OF MATERIAL

ITEM	Unit	Total
Structural Steel	LBS.	5,010

FRAMING PLAN - UNIT A
 BRIDGE OVER KASKASKIA RIVER
 F.A. RT. 817 (IL. RTS. 4 & 15)
 SECTION 421 BR
 ST. CLAIR COUNTY
 STATION 132 + 53.67
 SN 082 - 0077