

STATE OF ILLINOIS
DEPARTMENT OF TRANSPORTATION
DIVISION OF HIGHWAYS

**PROPOSED
HIGHWAY PLANS**

FAI ROUTE 70 (I-70)
DIST 8 PATCHING 2013-3

MADISON/BOND COUNTY
PATCHING

C-98-004-13

F.A.I. RTE.	SECTION	COUNTY	TOTAL SHEETS	SHEET NO.
70	DIST 8 PATCHING 2013-3	•	7	1
ILLINOIS		CONTRACT NO. 76G05		

*MADISON/BOND

FOR INDEX OF SHEETS, SEE SHEET NO. 2

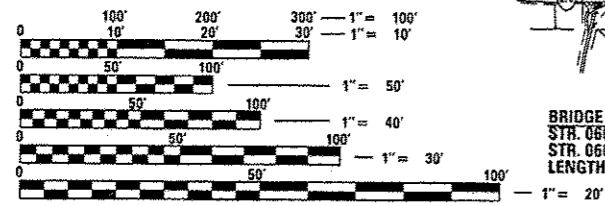
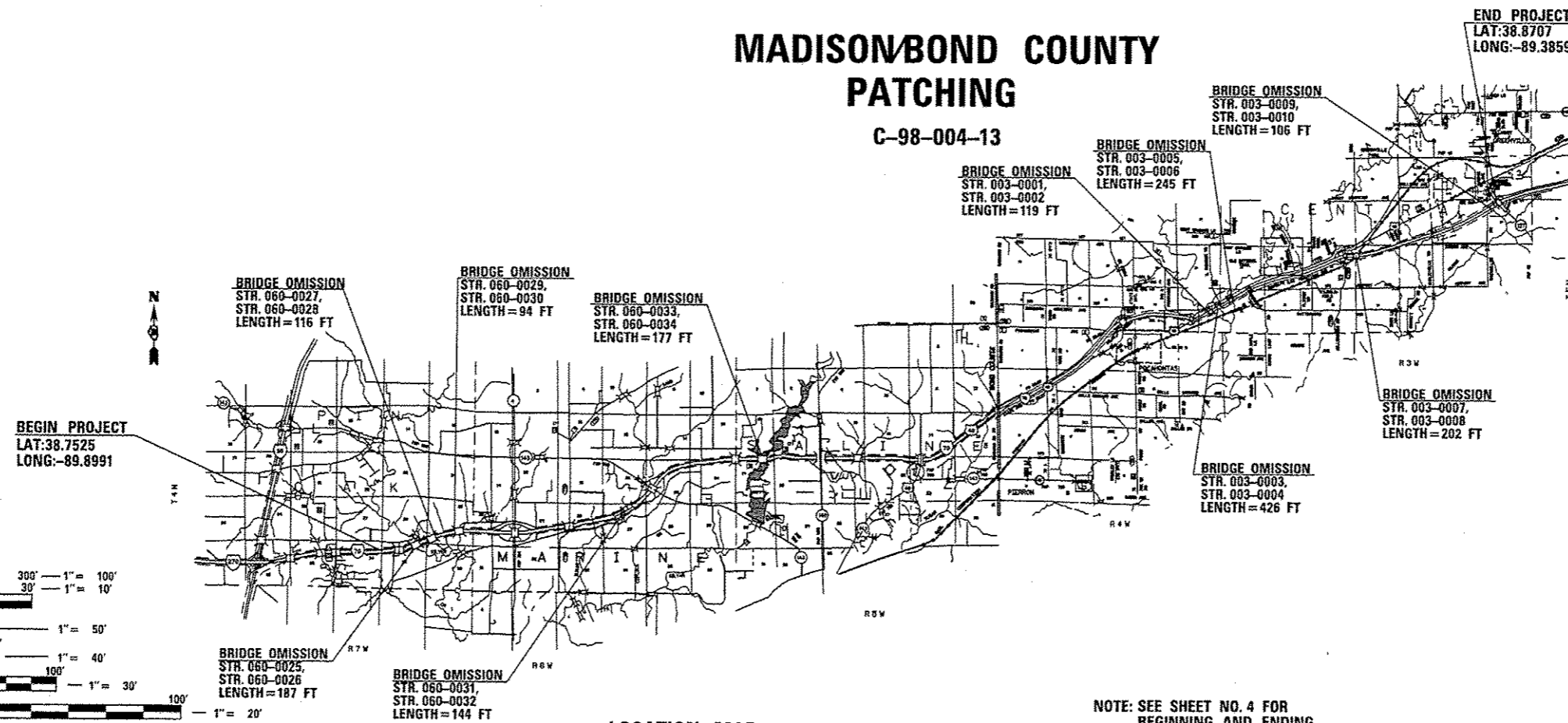

FULL SIZE PLANS HAVE BEEN PREPARED USING STANDARD ENGINEERING SCALES. REDUCED SIZED PLANS WILL NOT CONFORM TO STANDARD SCALES. IN MAKING MEASUREMENTS ON REDUCED PLANS, THE ABOVE SCALES MAY BE USED.

J.U.L.I.E.
JOINT UTILITY LOCATION INFORMATION FOR EXCAVATION
1-800-892-0123
OR 811

LOCATION MAP
NOT TO SCALE

NOTE: SEE SHEET NO. 4 FOR BEGINNING AND ENDING LOCATIONS

TRAFFIC DATA

	2013 ADT	SU	MU
I-70			
I-55 TO IL 4	28300	3.4%	26.7%
IL 4 TO IL 143	25300	3.3%	28.6%
IL 143 TO IL 160	21600	3.7%	32.2%
IL 160 TO US 40	21800	3.3%	32.7%
US 40 TO MILLERSBURG RD	21000	2.7%	34.5%
MILLERSBURG RD TO IL 127	18000	4.0%	39.2%

GROSS LENGTH = 149,477 FT. = 28.310 MILE
NET LENGTH = 147,784 FT. = 27.989 MILE

PROJECT ENGINEER: PATTI LEBEAU (618) 346-3179
PROJECT MANAGER: REBECCA THARP (618) 346-3323

DESIGN DESIGNATION
N/A

CONTRACT NO. 76G05

STATE OF ILLINOIS
DEPARTMENT OF TRANSPORTATION
DIVISION OF HIGHWAYS

SUBMITTED *Fes 6* 20 *13*

[Signature]
DEPUTY DIRECTOR OF HIGHWAYS, REGION 5 ENGINEER

March 22 20 *13*
John D. Baranzelli P.E. bc
ENGINEER OF DESIGN AND ENVIRONMENT

March 22 20 *13*
Omer Osman P.E. /bc
DIRECTOR OF HIGHWAYS, CHIEF ENGINEER

PRINTED BY THE AUTHORITY
OF THE STATE OF ILLINOIS