

STATE STREET TRAFFIC CONTROL PLAN, STAGE 5C

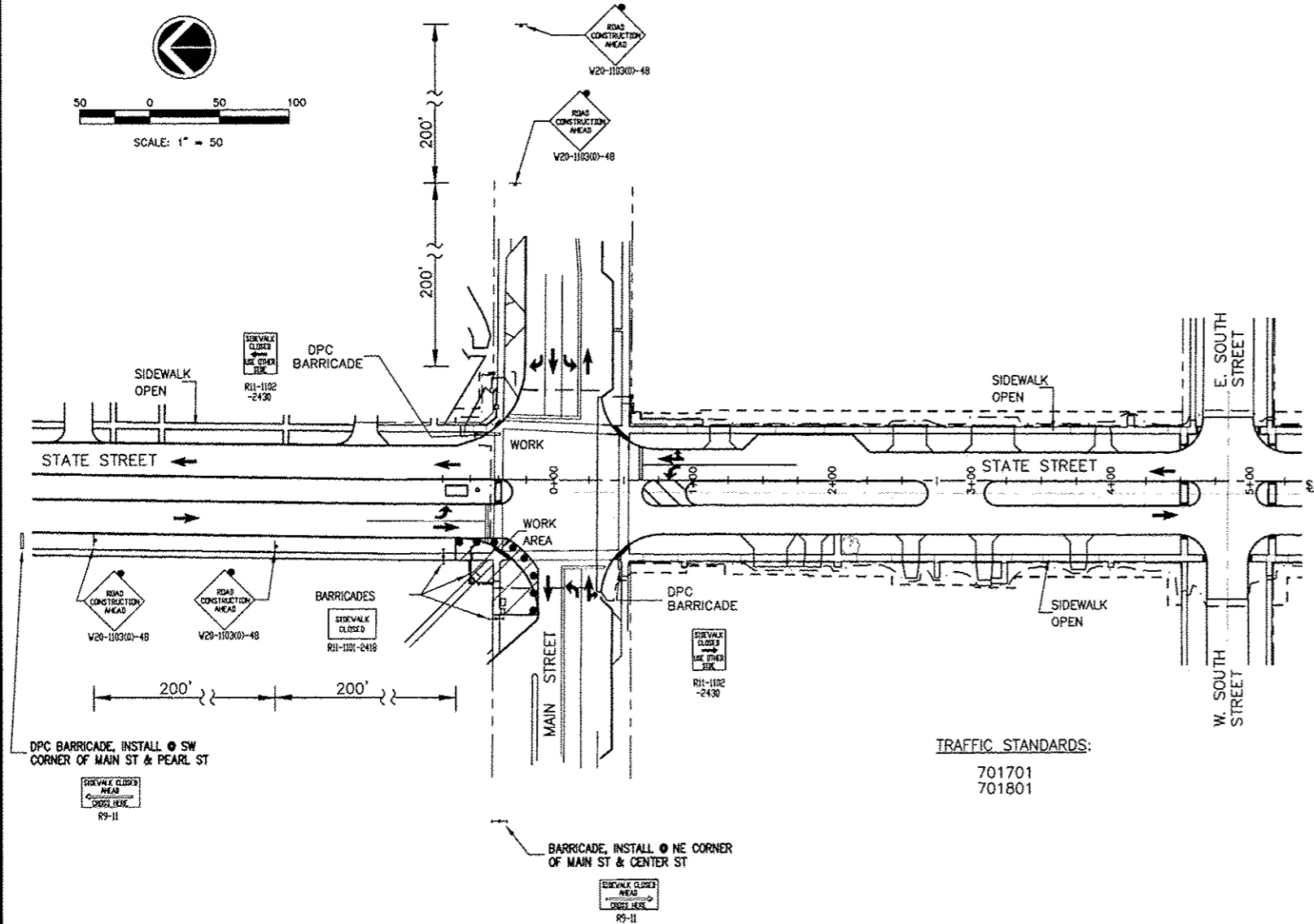

TRAFFIC STANDARDS:
701701
701801

- STAGE 5C TRAFFIC STATUS:
1. ALL TRAVEL LANES TO REMAIN OPEN ON STATE STREET AND MAIN STREET.
 2. SIDEWALK CLOSURE ON ONLY ONE SIDE OF STATE STREET AT A TIME.

STAGE 5C TRAFFIC CONTROL NOTES:

1. MAINTAIN PEDESTRIAN ACCESS TO PROPERTY / BUSINESSES AS LONG AS POSSIBLE. SAFETY FENCE SHALL BE ERECTED BETWEEN ALL OPEN PEDESTRIAN AREAS AND ADJACENT WORK AREAS.
2. CONFORM TO STANDARD 701801 FOR SIDEWALK CLOSURES. SIDEWALKS ON BOTH SIDES OF THE STREET SHALL NOT BE CLOSED AT THE SAME TIME.
3. COORDINATE WITH LOCAL RESIDENTS AND BUSINESSES A MINIMUM OF 48 HOURS PRIOR TO RESTRICTING ACCESS TO DRIVEWAYS AND BUSINESS ENTRANCES. PEDESTRIAN ACCESS SHALL BE MAINTAINED AT ALL TIMES.
4. IF A PROPERTY AND / OR BUSINESS HAS TWO ACCESS DRIVEWAYS AS DETERMINED BY THE ENGINEER, THE REMOVAL AND REPLACEMENT OF THE TWO DRIVEWAYS SHALL NOT OCCUR SIMULTANEOUSLY. ONE PAVED DRIVEWAY SHALL BE OPEN TO THE PROPERTY AND / OR BUSINESS AT ALL TIMES.

STAGE 5C CONSTRUCTION:

1. SAW CUT AND REMOVE SECTIONS OF THE EXISTING STREET AND SIDEWALK PAVEMENTS IN THE STAGE 5C AREA AS SHOWN ABOVE AND SPECIFIED IN THE SPECIAL PROVISIONS UNDER TRAFFIC CONTROL AND PROTECTION.
2. CONSTRUCT NEW SECTIONS OF THE EXISTING STREET AND SIDEWALK PAVEMENTS IN THE STAGE 5C AREA AS SHOWN ABOVE AND SPECIFIED IN THE SPECIAL PROVISIONS UNDER TRAFFIC CONTROL AND PROTECTION.

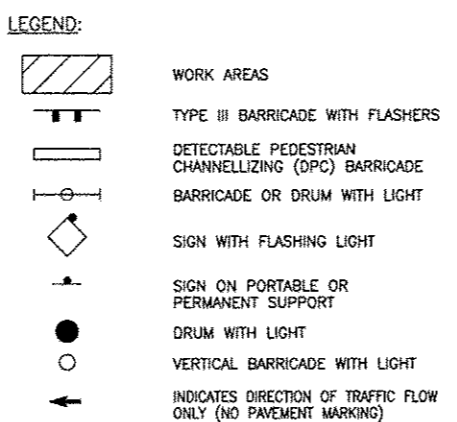

IL DESIGN FIRM NO. 184-000943

STATE STREET TRAFFIC CONTROL PLAN, OAKWOOD AVENUE DETOUR

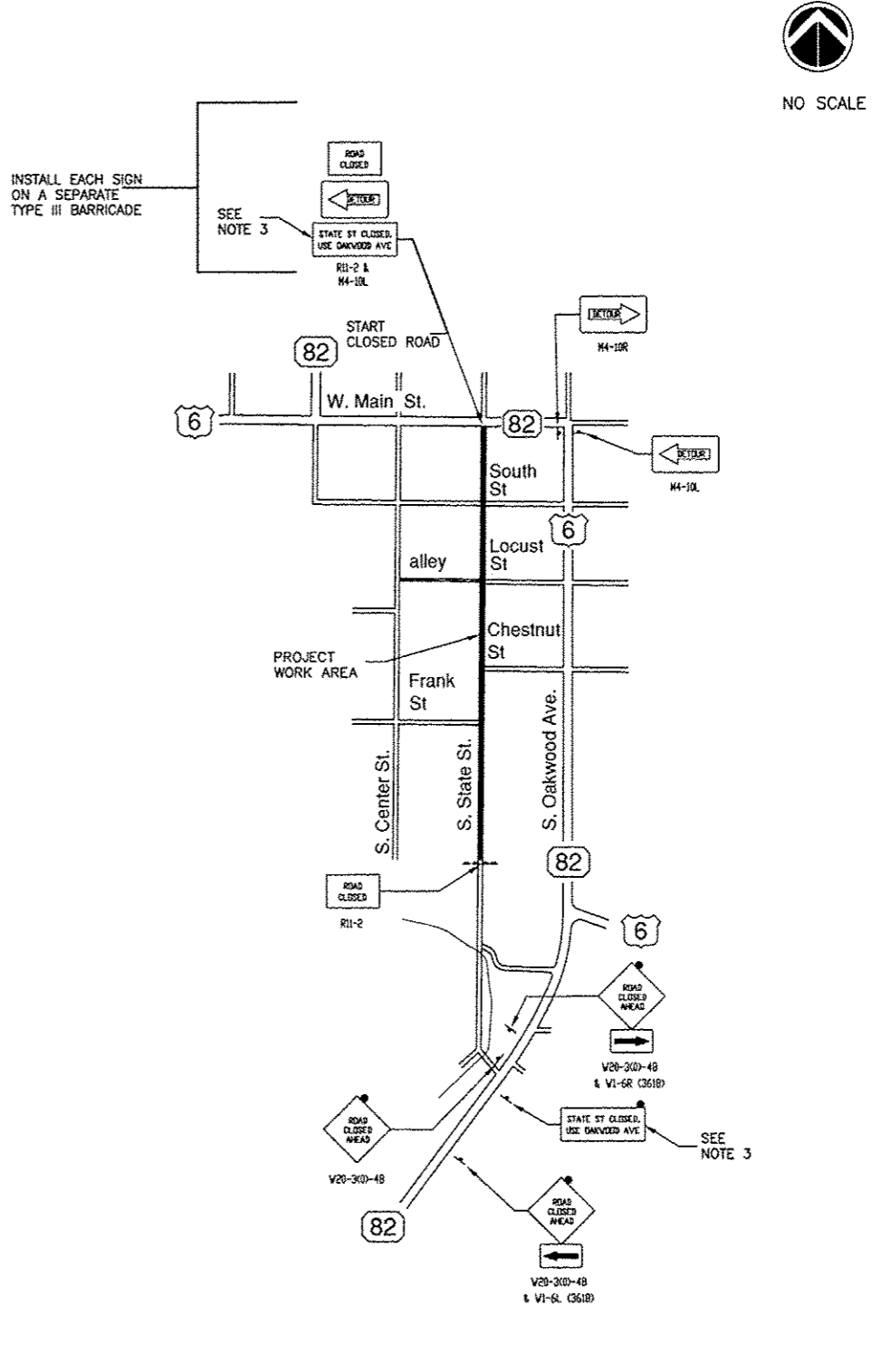

- DETOUR NOTES:
1. OAKWOOD AVENUE DETOUR SHALL BE IN PLACE DURING STAGES 2, 3, AND 4.
 2. THE 2012 ADT FOR THE SOUTH LEG OF THE INTERSECTION OF STATE ST. AND MAIN ST. IS 1,850.
 3. SIGN LETTERING SIZE (4" MINIMUM), LEGEND COLOR, BACKGROUND COLOR, BORDER, AND MINIMUM RETROREFLECTIVITY SHALL MATCH THE "ROAD CLOSED AHEAD" WARNING SIGN DETAILS FOUND IN THE "STANDARD HIGHWAY SIGNS AND MARKING" BOOK PUBLISHED BY THE FHWA. THE SHAPE OF THE SIGN SHALL BE A RECTANGLE.

REVISIONS	DESCRIPTION	DATE
No.		

Missman, Inc.
Professional Engineers & Land Surveyors

Rock Island, IL • Bettendorf, IA • Rockford, IL • Sycamore, IL
(309) 788-7644 • (563) 344-0280 • (815) 865-9400 • (815) 885-3825
www.missman.com

STATE STREET RE-CONSTRUCTION
GENESEEO, ILLINOIS

TRAFFIC CONTROL PLAN - STAGE 5C
AND OAKWOOD AVENUE DETOUR

Missman Project No: A10M008
File Name: A10M008 TRAFFIC CONTROL.dwg
© COPYRIGHT 2013 ALL RIGHTS RESERVED
Field Book No: #####
Drawn By: JNM
Checked By: JLM
Date: 11/19/2012

G:\2010\AUNA10M008-Geneseeo-S.State.St.SewerWaterDrawings\Traffic\10M008 TRAFFIC CONTROL.dwg, 3/7/2013 9:32:32 AM, jelfm