

ROUTE NO.	SECTION	COUNTY	TOTAL SHEETS	SHEET NO.
MULTIPLE	12-00177-02-SP	PEORIA	66	34
FED. ROAD DIST. NO.	--	ILLINOIS	PROJECT: HSIP 0143 (052)	
CONTRACT NO. 89627				

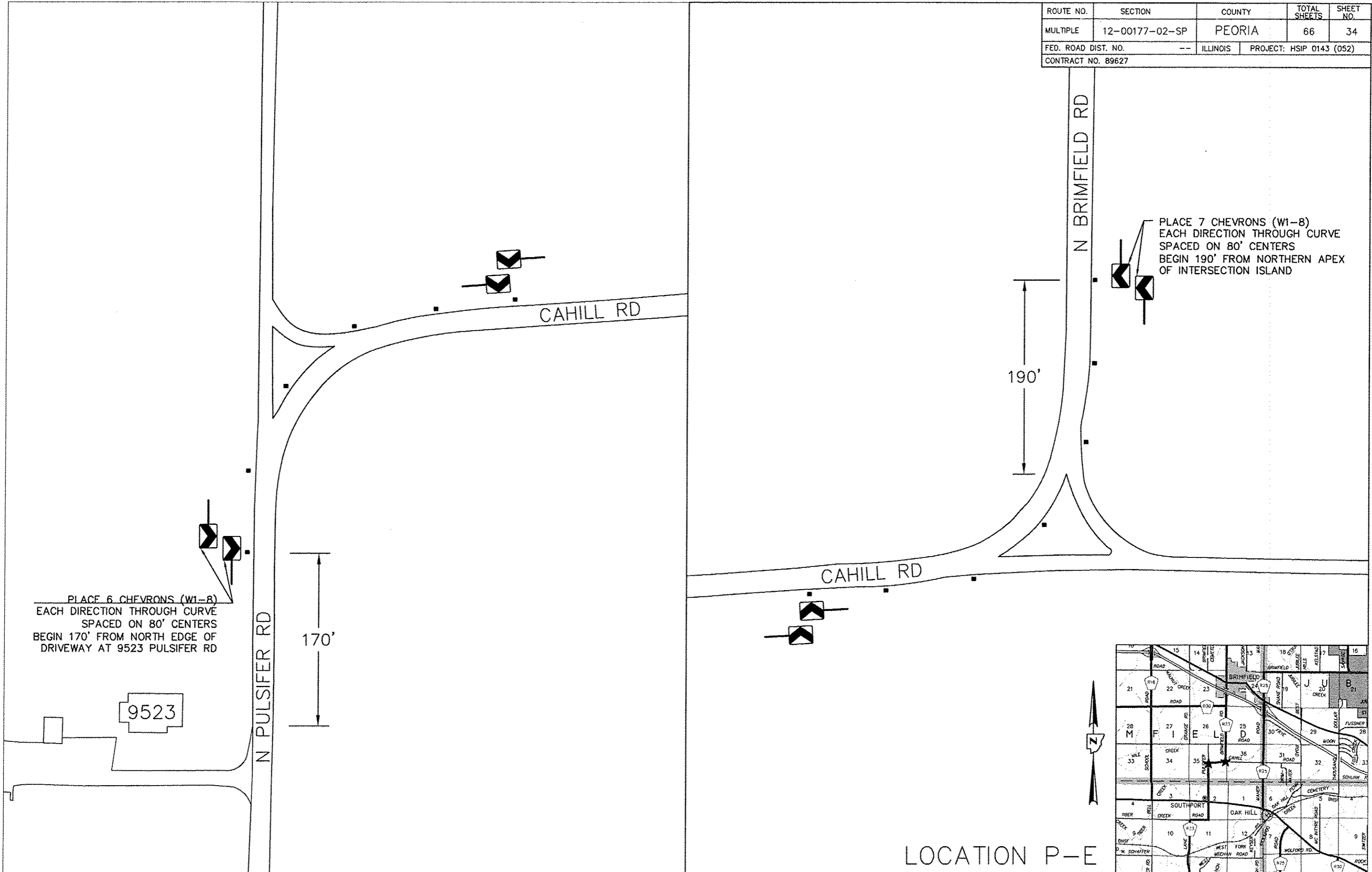

PLACE 6 CHEVRONS (W1-8)  
EACH DIRECTION THROUGH CURVE  
SPACED ON 80' CENTERS  
BEGIN 170' FROM NORTH EDGE OF  
DRIVEWAY AT 9523 PULSIFER RD

9523

170'

190'

PLACE 7 CHEVRONS (W1-8)  
EACH DIRECTION THROUGH CURVE  
SPACED ON 80' CENTERS  
BEGIN 190' FROM NORTHERN APEX  
OF INTERSECTION ISLAND

LOCATION P-E

