

ROUTE NO.	SECTION	COUNTY	TOTAL SHEETS	SHEET NO.
MULTIPLE	12-00177-02-SP	PEORIA	66	44
FED. ROAD DIST. NO.	--	ILLINOIS	PROJECT: HSIP 0143 (052)	
CONTRACT NO. 89627				

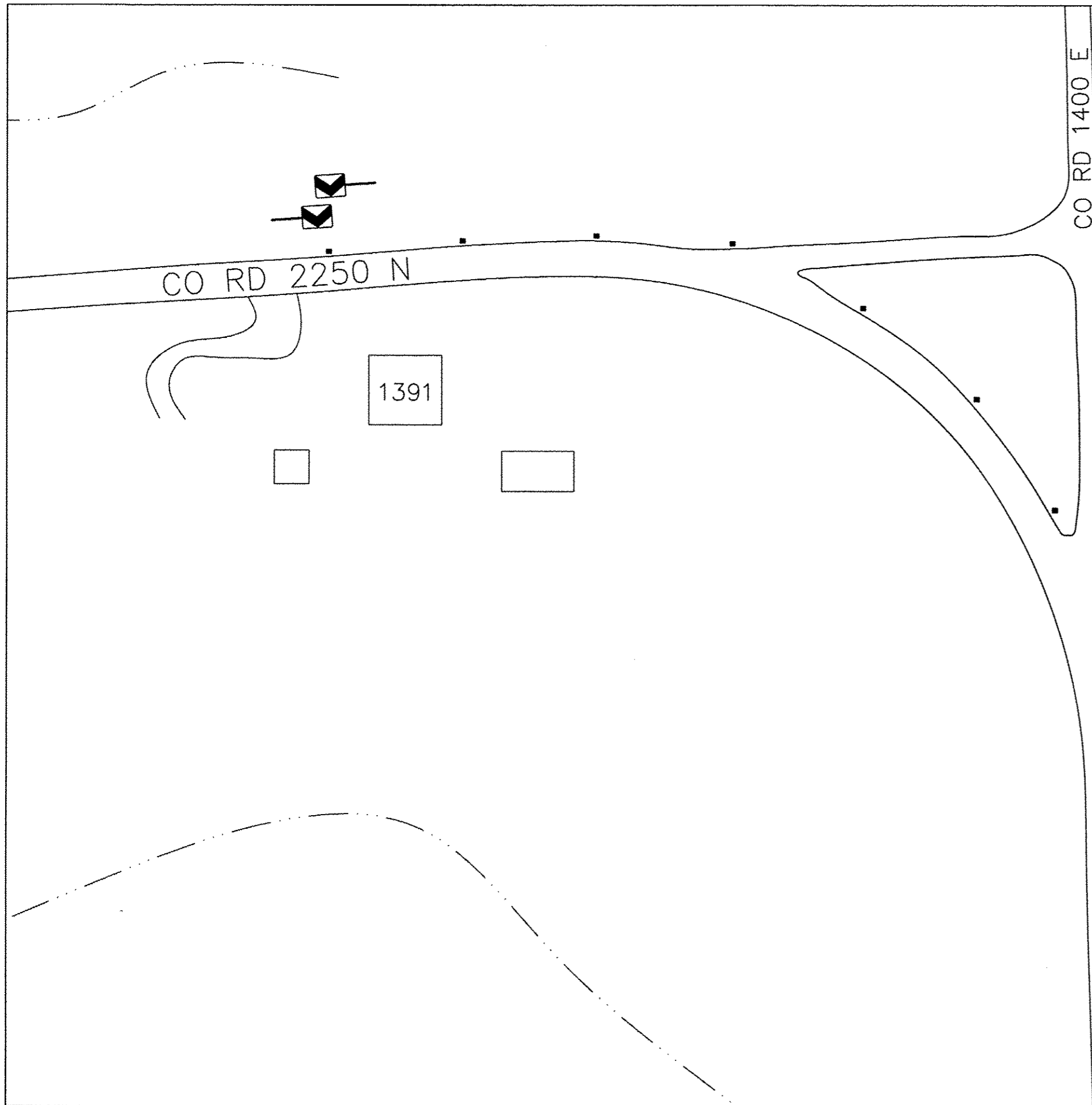

225'

PLACE 10 CHEVRONS (W1-8)
EACH DIRECTION THROUGH CURVE
SPACED ON 80' CENTERS
BEGIN 225' SOUTH OF SOUTHERN APEX
OF INTERSECTION ISLAND

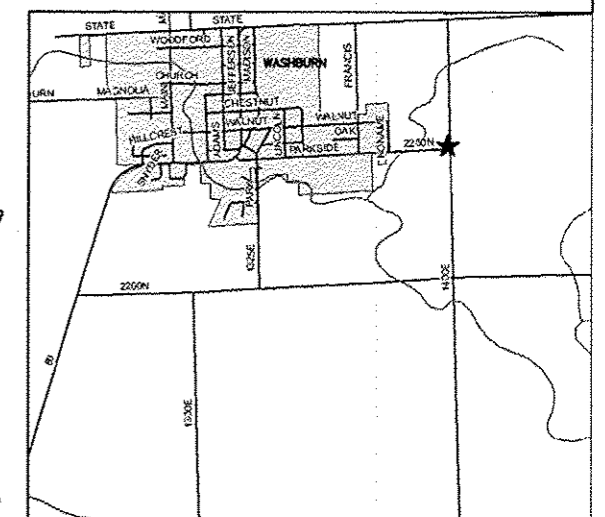
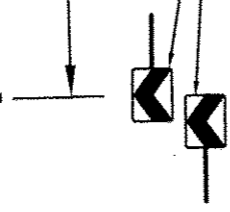

LOCATION W-A