

0' 20' 40'
SCALE: 1"=40'-0"

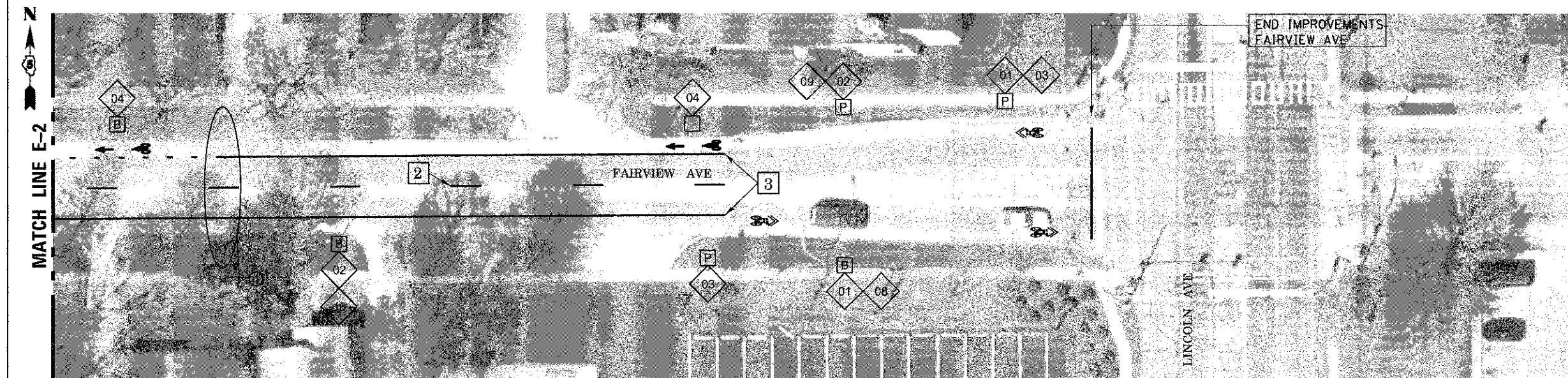

SIGN LEGEND					
01	BIKE ROUTE (D11-1)		06	BIKE ROUTE ARROW RIGHT (M6-1)	
02	BIKE LANE (R3-17)		07	BIKE ROUTE ARROW LEFT (M6-1)	
03	MAY USE FULL LANE (R4-11)		08	BIKE ROUTE ARROW AHEAD (M6-3)	
04	NO PARKING THIS SIDE OF STREET		09	AHEAD (R3-17aP)	
05	BIKE ROUTE ARROW LEFT AND RIGHT (M6-4)		10	ENDS (R3-17bP)	

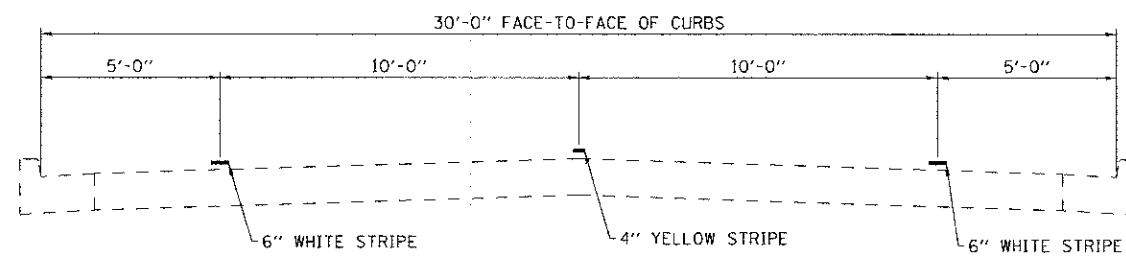

① TYPICAL FOR PAVEMENT MARKING FAIRVIEW AVENUE
GOODWIN AVENUE TO LINCOLN AVENUE

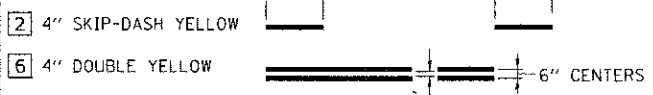

PAVEMENT MARKING LEGEND	
1	4" WHITE
2	4" YELLOW
3	6" WHITE
4	12" YELLOW
5	12" WHITE
6	4" DOUBLE YELLOW

PROJECT ENGINEER: J. D. LEONARDI
 PROJECT MANAGER: J. D. LEONARDI
 DESIGNER: J. D. LEONARDI
 CHECKER: J. D. LEONARDI
 DATE: 01/29/13



USER NAME: jhas	DESIGNED: JMS	REVISED: -
ESCA PROJECT NO. 1020.04	DRAWN: RJT/HAS	REVISED: -
PLDT SCALE: 0.0033' / IN.	CHECKED: JMS	REVISED: -
PLDT DATE: 1/30/2013	DATE: 01/29/13	REVISED: -

STATE OF ILLINOIS
DEPARTMENT OF TRANSPORTATION

FAIRVIEW AVENUE PAVEMENT MARKING	
SCALE AS SHOWN	SHEET NO. 2 OF 2 SHEETS
STA.	TO STA.

F.A. RTE.	SECTION	COUNTY	TOTAL SHEETS	SHEET NO.
VAR	12-00517-00-ST	CHAMPAIGN	22	22
CONTRACT NO. 91482				
FED. ROAD DIST. NO. ILLINOIS FED. AID PROJECT AID				