

04-26-13 LETTING ITEM 102

F.A. RTE.	SECTION	COUNTY	TOTAL SHEETS	SHEET NO.
VAR	12-00517-00-ST	CHAMPAIGN	22	1
FED. ROAD DIST. NO.	ILLINOIS	CONTRACT NO. 91482		

**STATE OF ILLINOIS**  
**DEPARTMENT OF TRANSPORTATION**  
**DIVISION OF HIGHWAYS**  
**PROPOSED**  
**HIGHWAY PLANS**  
**CITY OF URBANA**  
**VARIOUS ROUTES**  
**SECTION 12-00517-00-ST**  
**PROJECT SRTS-4009(248)**  
**CHAMPAIGN COUNTY**  
**JOB NO. C-95-302-13**  
**FUNDING: SAFE ROUTES TO SCHOOLS**  
**PAVEMENT MARKING**

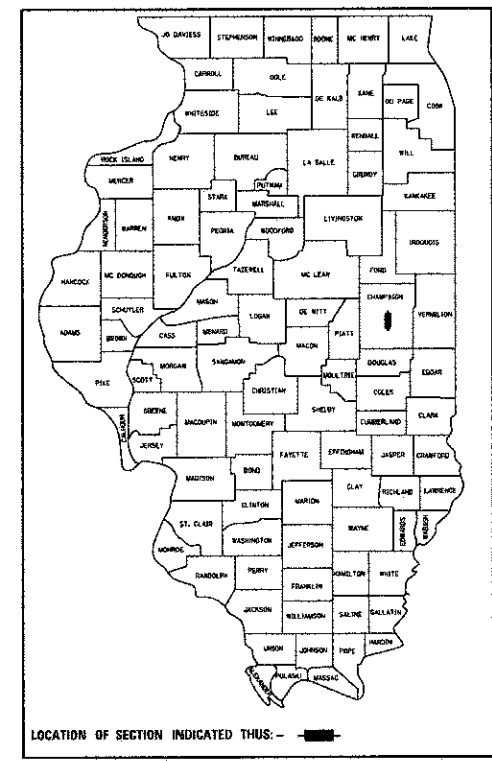

**INDEX OF SHEETS**

SHEET NO.	DESCRIPTION
1.	COVER SHEET
2.	LOCATION MAP
3.	SUMMARY OF QUANTITIES, GENERAL NOTES & STANDARDS
4.	SCHEDULE OF QUANTITIES & PLAN DETAILS
5.-12.	FLORIDA AVENUE PAVEMENT MARKING (LOCATION A)
13.-15.	KINCH STREET PAVEMENT MARKING (LOCATION B)
16.-18.	ANDERSON STREET PAVEMENT MARKING (LOCATION C)
19.-20.	PENNSYLVANIA AVENUE PAVEMENT MARKING (LOCATION D)
21.-22.	FAIRVIEW AVENUE PAVEMENT MARKING (LOCATION E)

ROUTE	FUNCTIONAL CLASSIFICATION	CURRENT ADT
FLORIDA AVENUE (FAU 7138)	MINOR ARTERIAL	5100
KINCH STREET	COLLECTOR	1550
ANDERSON STREET	COLLECTOR	2350
PENNSYLVANIA AVE.	COLLECTOR	1250
FAIRVIEW AVE.	COLLECTOR	1900

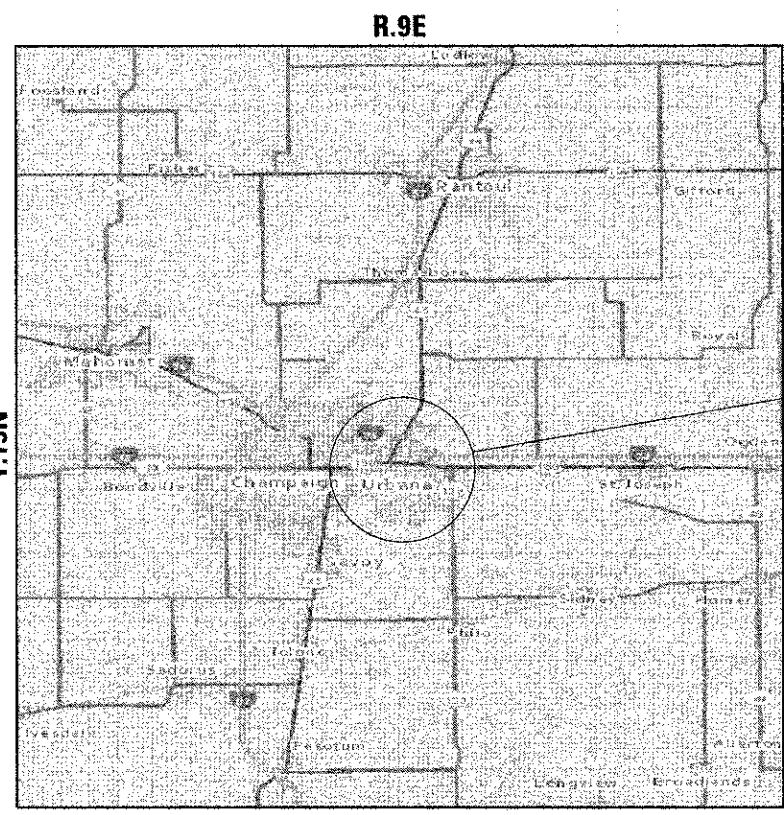

**LOCATION MAP**  
NOT TO SCALE

PROJECT LOCATION SEE SHEET NO. 2 FOR DETAILED LOCATION MAP

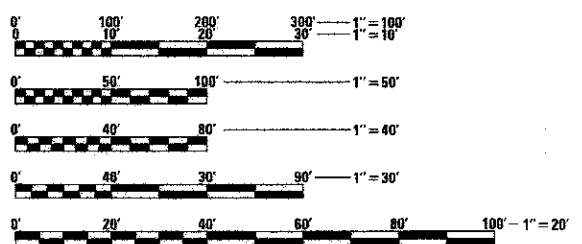

FULL SIZE PLANS HAVE BEEN PREPARED USING STANDARD ENGINEERING SCALES. REDUCED SIZED PLANS WILL NOT CONFORM TO STANDARD SCALES. IN MAKING MEASUREMENTS ON REDUCED PLANS, THE ABOVE SCALES MAY BE USED.

J.U.L.I.E.  
JOINT UTILITY LOCATION INFORMATION FOR EXCAVATION  
1-800-892-0123  
OR 811



*Richard D. Payne*  
DATE: 01/31/13  
ILLINOIS PROFESSIONAL LICENSE NO. 37421  
(EXPIRATION DATE: 11-30-13)

GROSS LENGTH = 16099 FT. = 3.049 MI.  
NET LENGTH = 16099 FT. = 3.049 MI.

CONTRACT NO. 91482

  
**CITY OF URBANA**  
**PUBLIC WORKS DEPARTMENT**  
**ENGINEERING DIVISION**

APPROVED:

  
 Public Works Director/City Engineer

1/31/13  
 Date

---

**Illinois Department of Transportation**

PASSED February 6 2013

  
 ACTING DISTRICT FIVE ENGINEER OF LOCAL ROADS & STREETS

Releasing For Bid Based on Limited Review FEBRUARY 6 2013

  
 DEPUTY DIRECTOR OF HIGHWAYS,  
 REGION THREE ENGINEER

STATE OF ILLINOIS  
 DEPARTMENT OF TRANSPORTATION

**PRINTED BY THE AUTHORITY OF THE STATE OF ILLINOIS**

LOCATION LENGTHS			
LOCATION A:	8171	FEET	= 1.548 MILES
LOCATION B:	2460	FEET	= 0.466 MILES
LOCATION C:	2895	FEET	= 0.548 MILES
LOCATION D:	1312	FEET	= 0.248 MILES
LOCATION E:	1261	FEET	= 0.239 MILES
GROSS LENGTH:	16099	FEET	= 3.049 MILES
NET LENGTH:	16099	FEET	= 3.049 MILES

**LOCATIONS:**

- LOCATION A = FLORIDA AVENUE FROM RACE STREET TO KINCH STREET
- LOCATION B = KINCH STREET FROM FLORIDA AVENUE TO WASHINGTON STREET
- LOCATION C = ANDERSON STREET FROM FLORIDA AVENUE TO MUMFORD DRIVE
- LOCATION D = PENNSYLVANIA AVENUE FROM VINE STREET TO ANDERSON STREET
- LOCATION E = FAIRVIEW AVENUE FROM GOODWIN AVENUE TO LINCOLN AVENUE

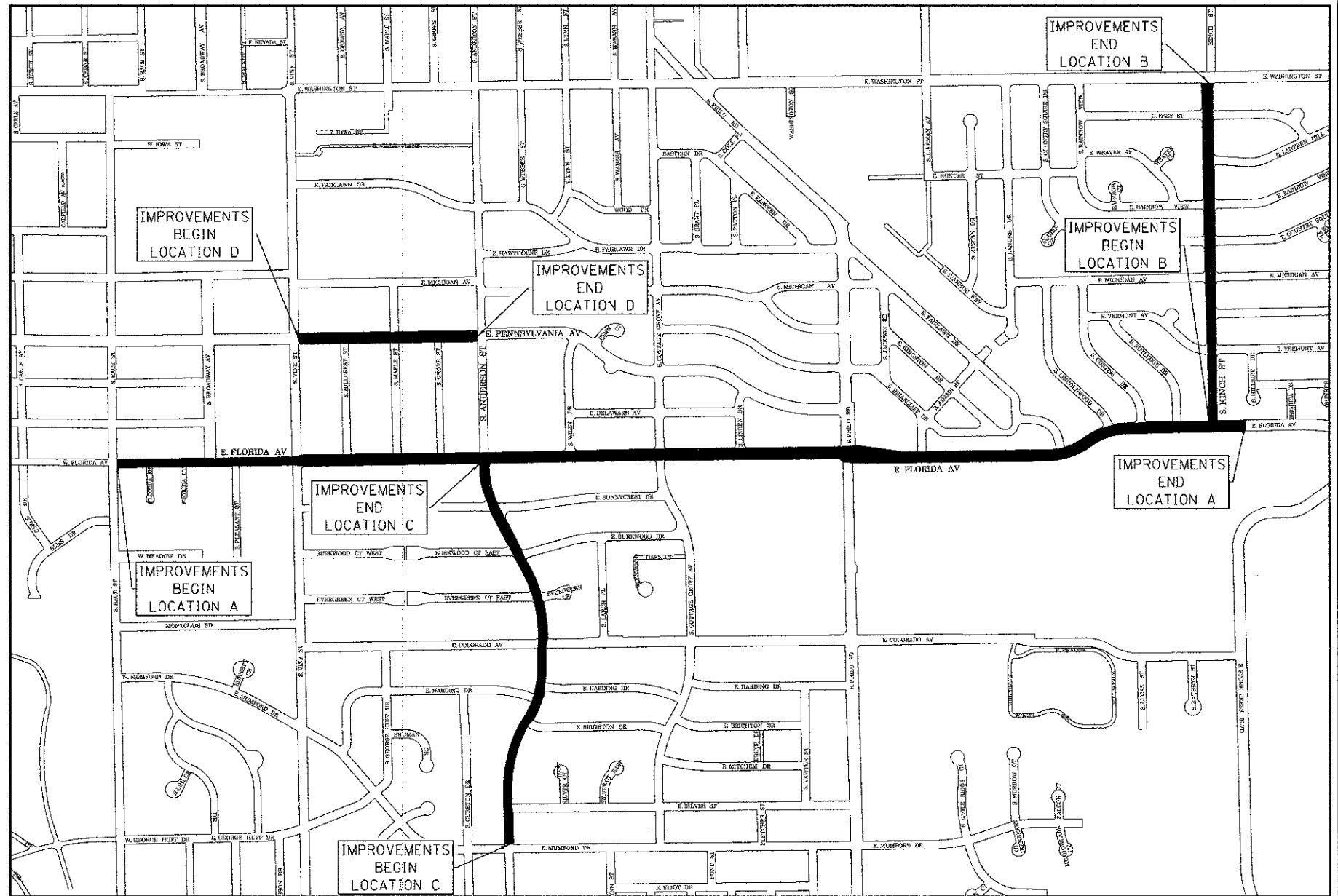
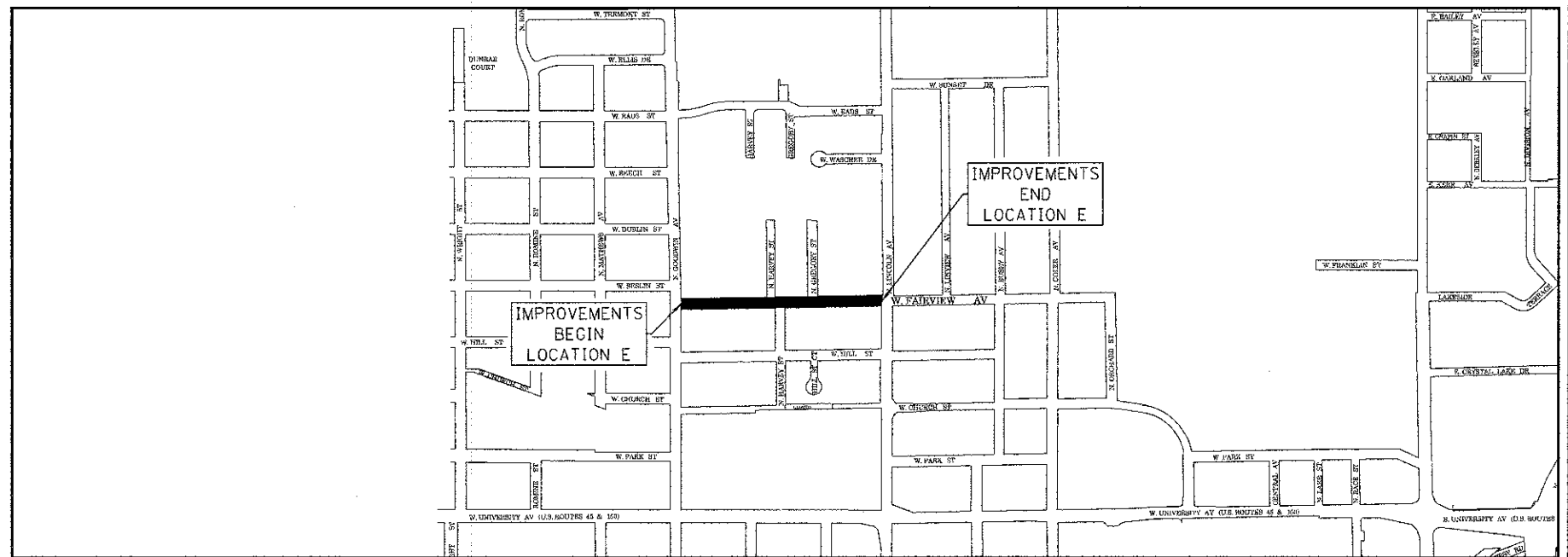

DRAWN: JMS  
 CHECKED: JMS  
 DATE: 01/29/13



USER NAME	has
ESCA PROJECT NO.	1020.04
PLOT SCALE	0.0033" / IN.
PLOT DATE	1/30/2013 15:56:33 PM

DESIGNED	JMS	REVISED	-
DRAWN	RJT/HAS	REVISED	-
CHECKED	JMS	REVISED	-
DATE	01/29/13	REVISED	-

**STATE OF ILLINOIS  
DEPARTMENT OF TRANSPORTATION**

**LOCATION MAP**  
SCALE 1" = 500' SHEET NO. 1 OF 1 SHEETS STA. TO STA.

F.A. RTE.	SECTION	COUNTY	TOTAL SHEETS	SHEET NO.
VAR	12-00517-00-ST	CHAMPAIGN	22	2
CONTRACT NO. 91482				
FED. ROAD DIST. NO. ILLINOIS FED. AID PROJECT AID				

SUMMARY OF QUANTITIES				CONSTRUCTION CODE	
CODE NO.	ITEM	UNIT	TOTAL QUANTITY	100% FEDERAL	
				SAFETY	PAVEMENT MARKING
67100100	MOBILIZATION	L SUM	1	1	
78009000	MODIFIED URETHANE PAVEMENT MARKING - LETTERS AND SYMBOLS	SQ FT	1381	1381	
78009004	MODIFIED URETHANE PAVEMENT MARKING - LINE 4"	FOOT	18957	18957	
78009006	MODIFIED URETHANE PAVEMENT MARKING - LINE 6"	FOOT	16096	16096	
78009012	MODIFIED URETHANE PAVEMENT MARKING - LINE 12"	FOOT	799	799	
78300100	PAVEMENT MARKING REMOVAL	SQ FT	1147	1147	
X7010216	TRAFFIC CONTROL AND PROTECTION, (SPECIAL)	L SUM	1	1	

**GENERAL NOTES**

- WHEREVER IN THE PLANS AND SPECIFICATIONS THE TERM "STANDARD SPECIFICATION" IS USED IT SHALL BE UNDERSTOOD BY THE CONTRACTOR TO MEAN THE "STANDARD SPECIFICATION FOR ROAD AND BRIDGE CONSTRUCTION" AS PREPARED BY THE DEPARTMENT OF TRANSPORTATION OF THE STATE OF ILLINOIS AND ADOPTED ON JANUARY 1, 2012.
- ANY REFERENCE TO STANDARDS THROUGHOUT THE PLANS SHALL BE INTERPRETED TO BE THE LATEST STANDARDS OF THE DEPARTMENT OF TRANSPORTATION WITH THE REVISION NUMBER AS SHOWN ON SHEET NO. 3 OF THE PLANS.
- IT IS THE CONTRACTOR'S RESPONSIBILITY TO ASCERTAIN EXISTING FIELD CONDITIONS BEFORE BIDDING ON THE PROJECT.
- THE CONTRACTOR WILL BE REQUIRED TO COMPLY WITH STATE AND LOCAL REGULATIONS REGARDING AIR, WATER AND NOISE POLLUTION.
- THE CONTRACTOR SHALL TAKE CARE NOT TO STORE OR DISPOSE OF DEBRIS AND UNSUITABLE MATERIALS WITHIN LIMITS OF THE IMPROVEMENT AND TAKE CARE TO LIMIT CONSTRUCTION TO WITHIN THE RIGHT-OF-WAY AND EASEMENT AREAS. UNNECESSARY ENCROACHMENTS INTO PRIVATE OR PUBLIC AREAS WILL NOT BE ALLOWED.
- THE CONTRACTOR SHALL BE RESPONSIBLE FOR CLEANUP OF THE SITE PRIOR TO FINAL ACCEPTANCE IN ACCORDANCE WITH ARTICLE 104.06 OF THE STANDARD SPECIFICATIONS.
- THE CONTRACTOR SHALL BE RESPONSIBLE FOR PROTECTING UTILITY PROPERTY FROM CONSTRUCTION OPERATIONS AS OUTLINED IN ARTICLE 107.31 OF THE STANDARD SPECIFICATIONS. THE J.U.L.I.E NUMBER IS 800-892-0123. A MINIMUM OF 48 HOURS ADVANCE NOTICE IS REQUIRED.
- THE CITY OF URBANA SHALL BE RESPONSIBLE FOR NOTIFYING THE PUBLIC, THE UNITED STATES POSTAL SERVICE, AND THE EMERGENCY SERVICE AGENCIES OF ALL ROAD CLOSURES AND CHANGES IN THE TRAFFIC MAINTENANCE PLANS. THE CONTRACTOR SHALL NOTIFY THE CITY OF URBANA OF ALL ROAD CLOSURES AND CHANGES IN THE TRAFFIC MAINTENANCE PLANS A MINIMUM OF 48 HOURS IN ADVANCE.
- PROPOSED BICYCLE ROUTE AND LANE SIGNAGE MAY BE SHOWN ON VARIOUS PLAN SHEETS. THE SIGNAGE IS SHOWN FOR INFORMATION ONLY AND FURNISHING AND ERECTING PROPOSED SIGNAGE IS NOT PART OF THE SCOPE OF WORK FOR THIS PROJECT.
- THE EXISTING PAVEMENT MARKINGS FOR CROSS WALKS AND STOP BARS SHALL REMAIN IN PLACE.

**LIST OF ILLINOIS DOT HIGHWAY STANDARDS**

STANDARD NO.	DESCRIPTION
701301-04	LANE CLOSURE, 2L, 2W, SHORT TIME OPERATIONS
701311-03	LANE CLOSURE, 2L, 2W, MOVING OPERATIONS - DAY ONLY
701901-02	TRAFFIC CONTROL DEVICES
780001-03	TYPICAL PAVEMENT MARKINGS

PRINT COMMAND - C:\ES\B\A\...  
 PEN TABLE - ...  
 FILE NAME - ...



USER NAME = has	DESIGNED - JMS	REVISED -
ESCA PROJECT NO. 1020.04	DRAWN - HAS	REVISED -
PLOT SCALE = 0.8633 / IN.	CHECKED - JMS	REVISED -
PLOT DATE = 1/30/2013 2:01:02 PM	DATE - 01/30/13	REVISED -

**STATE OF ILLINOIS  
DEPARTMENT OF TRANSPORTATION**

**SUMMARY OF QUANTITIES, GENERAL NOTES AND STANDARDS**

SCALE	SHEET NO. 1 OF 1 SHEETS	STA.	TO STA.	F.A. RTE.	SECTION	COUNTY	TOTAL SHEETS	SHEET NO.
				VAR	12-00517-00-ST	CHAMPAIGN	22	3
							CONTRACT NO. 91482	
				FED. ROAD DIST. NO.	ILLINOIS	FED. AID PROJECT AID		

**PAVEMENT MARKING SCHEDULE**

LOCATION	DESCRIPTION	PAVEMENT MARKING REMOVAL	MODIFIED URETHANE PAVEMENT MARKING - LINE 4" (WHITE)	MODIFIED URETHANE PAVEMENT MARKING - LINE 4" (YELLOW)	MODIFIED URETHANE PAVEMENT MARKING - LINE 6" (WHITE)	MODIFIED URETHANE PAVEMENT MARKING - LINE 12" (YELLOW)	MODIFIED URETHANE PAVEMENT MARKING - LINE 12" (WHITE)	MODIFIED URETHANE PAVEMENT MARKING - LINE 12" (WHITE)	MODIFIED URETHANE PAVEMENT MARKING - LETTERS & SYMBOLS (SHARED LANE MARKING)	MODIFIED URETHANE PAVEMENT MARKING - LETTERS & SYMBOLS (BIKE LANE SYMBOL & ARROW)	MODIFIED URETHANE PAVEMENT MARKING - LETTERS & SYMBOLS (LEFT TURN ARROW)
		SQ FT	FOOT	FOOT	FOOT	FOOT	FOOT	FOOT	SQ FT	SQ FT	SQ FT
LOCATION A	RACE STREET TO ANDERSON STREET	160	1164	660	3315		127	138		218	
LOCATION A	ANDERSON STREET TO PHILO ROAD	197	2683	1632	4167	58	262			196	
LOCATION A	PHILO ROAD TO JAMES CHERRY DRIVE	87	1757	630	2482	18	205			120	
LOCATION A	JAMES CHERRY DRIVE TO KINCH STREET	569	562	2661	1349	71	58		56	99	32
LOCATION B	FLORIDA AVENUE TO WASHINGTON STREET	40	922	500	3074					349	
LOCATION C	FLORIDA AVENUE TO COLORADO AVENUE			220							
LOCATION C	COLORADO AVENUE TO MUMFORD DRIVE		1893	320							
LOCATION D	VINE STREET TO ANDERSON STREET	94	1541	290							
LOCATION E	GOODWIN AVENUE TO LINCOLN AVENUE			240	1709				42	131	
	SUBTOTAL	1147	11804	7153	16096	147	652		236	1113	32
	TOTAL	1147		18957	16096		799			1381	

LOCATION A = FLORIDA AVENUE FROM RACE STREET TO KINCH STREET  
 LOCATION B = KINCH STREET FROM FLORIDA AVENUE TO WASHINGTON STREET  
 LOCATION C = ANDERSON STREET FROM FLORIDA AVENUE TO MUMFORD DRIVE  
 LOCATION D = PENNSYLVANIA AVENUE FROM VINE STREET TO ANDERSON STREET  
 LOCATION E = FAIRVIEW AVENUE FROM GOODWIN AVENUE TO LINCOLN AVENUE

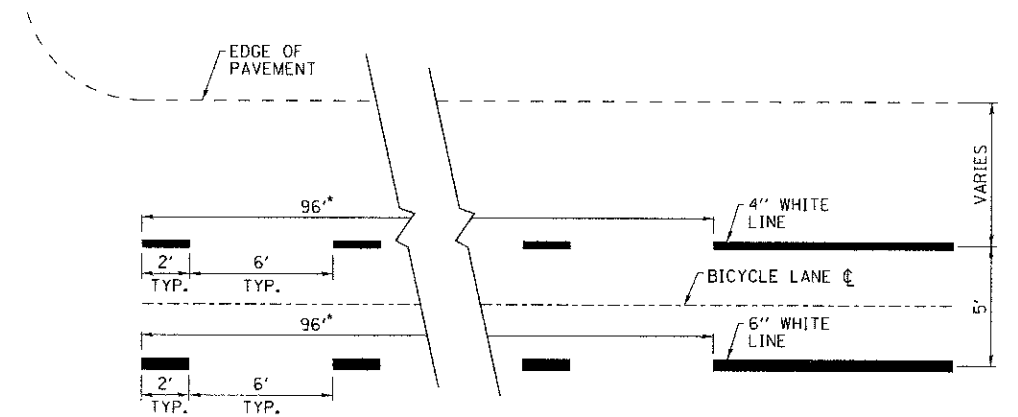

**TYPICAL DOTTED LINE EXTENSION**

\* NOTE: TYPICAL DIMENSION UNLESS OTHERWISE NOTED ON THE PLANS

SYMBOL AREAS	
SYMBOL	SQ FT
BIKE RIDER SYMBOL	6.6
BIKE LANE ARROW	4.3
SHARED LANE MARKING	13.8

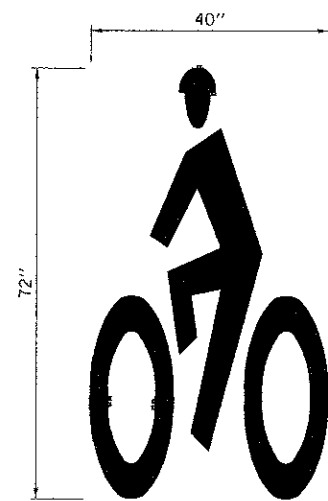

**BIKE RIDER SYMBOL DETAIL**

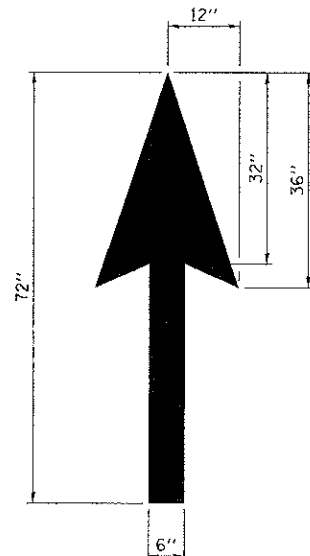

**BIKE LANE ARROW DETAIL**

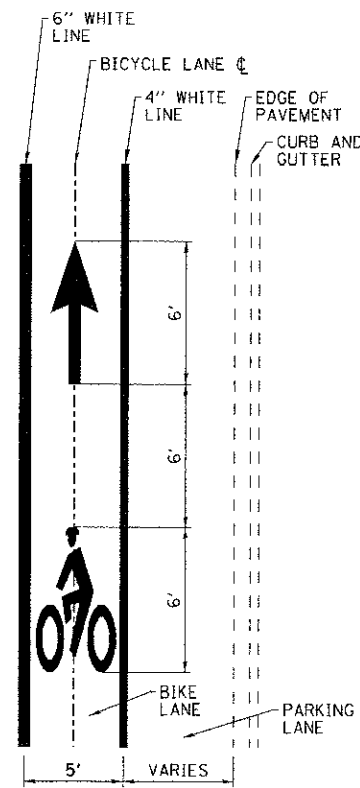

**BIKE LANE SYMBOL LAYOUT**

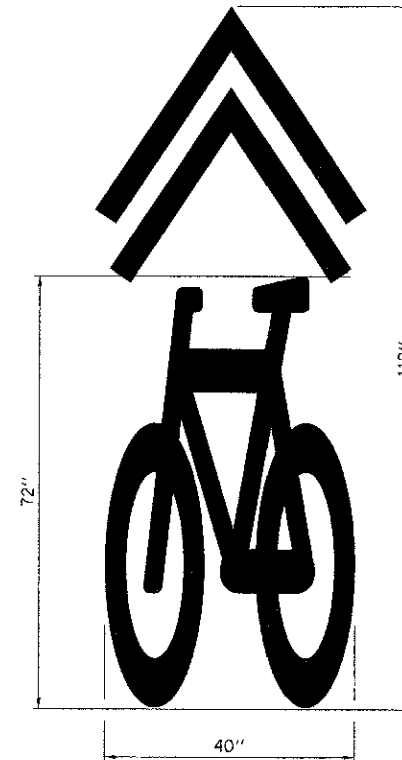

**SHARED LANE MARKING DETAIL**

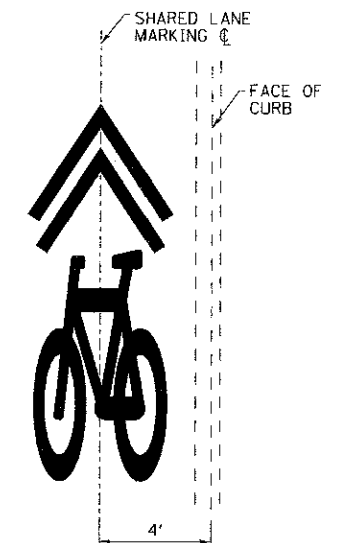

**SHARED LANE MARKING LAYOUT**

ARMY DRIVER - L.D. F.G. B.A.  
 PROJECT MANAGER - R.J.T.  
 FILE NAME - 120006-05.MXD



USER NAME - jhas	DESIGNED - JMS	REVISED -
ESCA PROJECT NO. 1020.04	DRAWN - RJT	REVISED -
PLOT SCALE - 0.0033" / IN.	CHECKED - JMS	REVISED -
PLOT DATE - 1/30/2013 2:01:17 PM	DATE - 01/17/13	REVISED -

**STATE OF ILLINOIS  
DEPARTMENT OF TRANSPORTATION**

**SCHEDULE OF QUANTITIES AND PLAN DETAILS**

SCALE	SHEET NO. 1 OF 1 SHEETS	STA.	TO STA.
-------	-------------------------	------	---------

F.A. RTE.	SECTION	COUNTY	TOTAL SHEETS	SHEET NO.
VAR	12-00517-00-ST	CHAMPAIGN	22	4
FED. ROAD DIST. NO.		ILLINOIS FED. AID PROJECT AID	CONTRACT NO. 91482	



0' 20' 40'  
SCALE: 1"=40'-0"

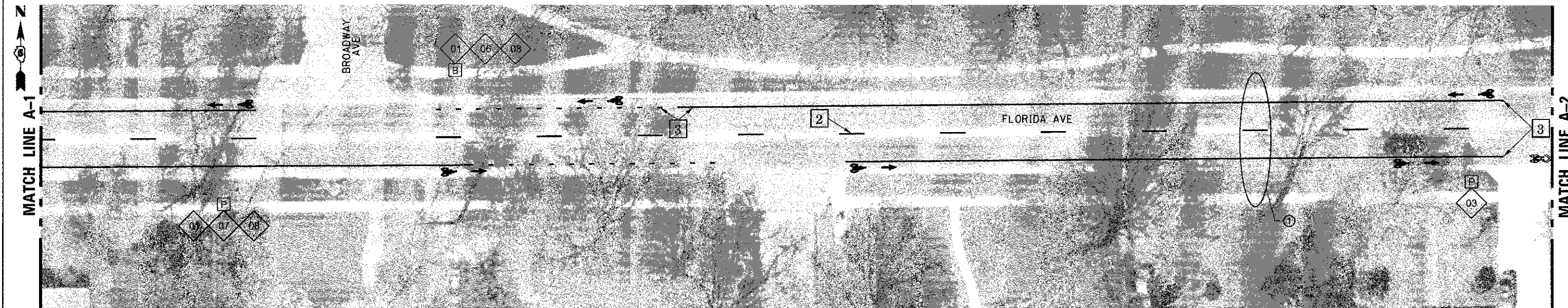
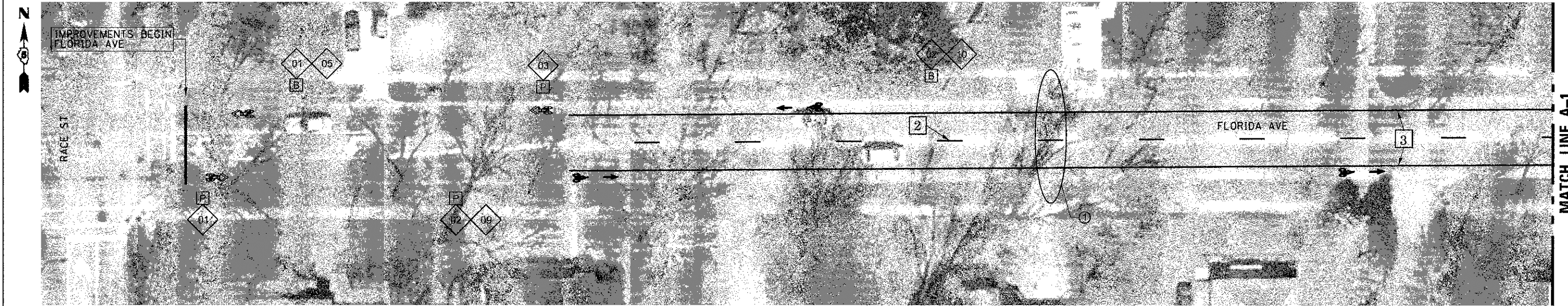

SIGN LEGEND					
01	BIKE ROUTE (D11-1)		06	BIKE ROUTE ARROW RIGHT (M6-1)	
02	BIKE LANE (R3-17)		07	BIKE ROUTE ARROW LEFT (M6-1)	
03	MAY USE FULL LANE (R4-11)		08	BIKE ROUTE ARROW AHEAD (M6-3)	
04	NO PARKING THIS SIDE OF STREET		09	AHEAD (R3-17aP)	
05	BIKE ROUTE ARROW LEFT AND RIGHT (M6-4)		10	ENDS (R3-17bP)	

2 4" SKIP-DASH YELLOW  
6 4" DOUBLE YELLOW

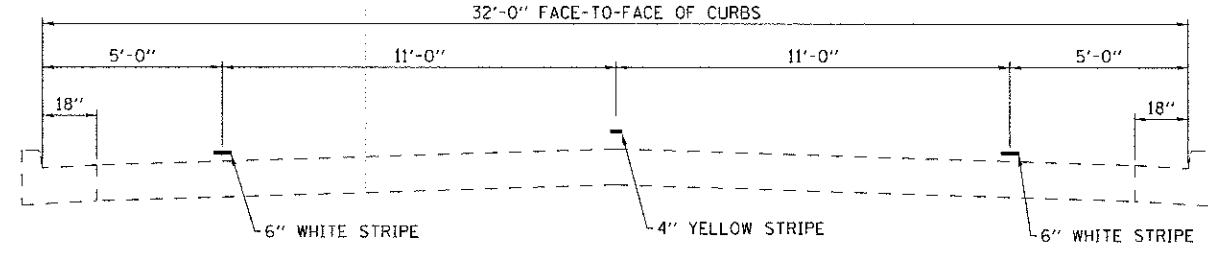
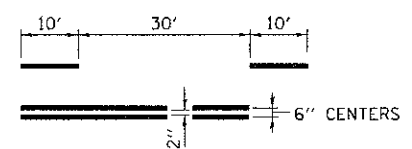

1 TYPICAL FOR PAVEMENT MARKING FLORIDA AVENUE

PAVEMENT MARKING LEGEND	
1	4" WHITE
2	4" YELLOW
3	6" WHITE
4	12" YELLOW
5	12" WHITE
6	4" DOUBLE YELLOW

PRINT DRIVER: I, P.L.E.D. & L.  
 PEN NAME: I, P.L.E.D. & L.  
 FILE NAME: I, P.L.E.D. & L.



USER NAME: has  
 ESCA PROJECT NO.: 1020.04  
 PLOT SCALE: 0.0033 / IN.  
 PLOT DATE: 1/30/2013 2:02:25 PM

DESIGNED: JMS  
 DRAWN: RJT/HAS  
 CHECKED: JMS  
 DATE: 01/29/13

REVISED: -  
 REVISED: -  
 REVISED: -  
 REVISED: -

STATE OF ILLINOIS  
DEPARTMENT OF TRANSPORTATION

FLORIDA AVENUE PAVEMENT MARKING

SCALE AS SHOWN SHEET NO. 1 OF 8 SHEETS STA. TO STA.

F.A. RTE.	SECTION	COUNTY	TOTAL SHEETS	SHEET NO.
VAR	12-00517-00-ST	CHAMPAIGN	22	5
CONTRACT NO. 91482				
FED. ROAD DIST. NO. ILLINOIS/FED. AID PROJECT AID				



0' 20' 40'  
SCALE: 1"=40'-0"

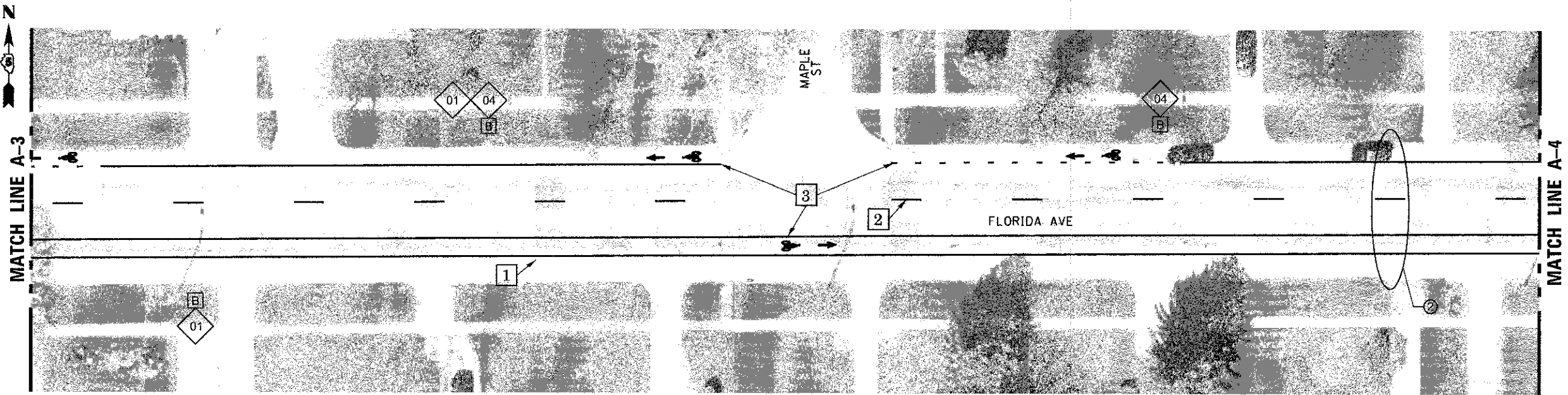
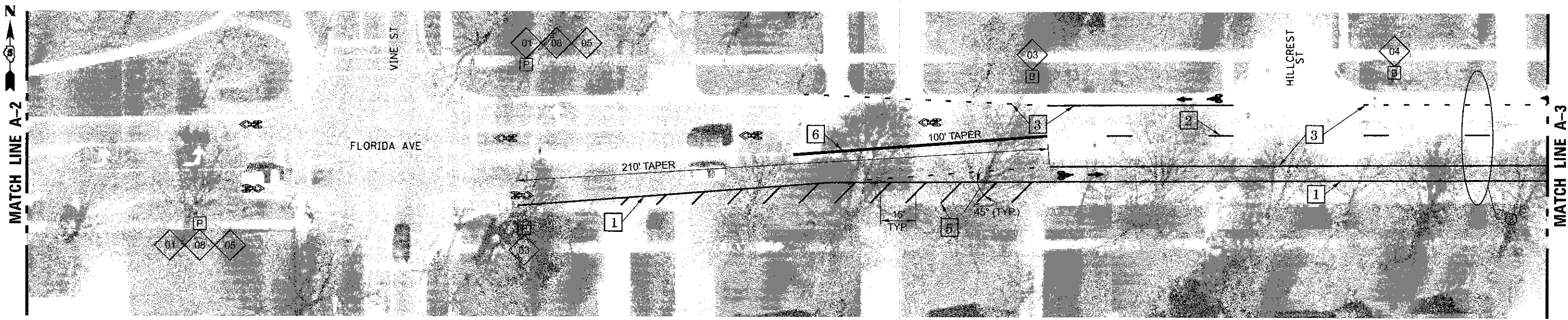

SIGN LEGEND					
01	BIKE ROUTE (D11-1)		06	BIKE ROUTE ARROW RIGHT (M6-1)	
02	BIKE LANE (R3-17)		07	BIKE ROUTE ARROW LEFT (M6-1)	
03	MAY USE FULL LANE (R4-11)		08	BIKE ROUTE ARROW AHEAD (M6-3)	
04	NO PARKING THIS SIDE OF STREET		09	AHEAD (R3-17aP)	
05	BIKE ROUTE ARROW LEFT AND RIGHT (M6-4)		10	ENDS (R3-17bP)	

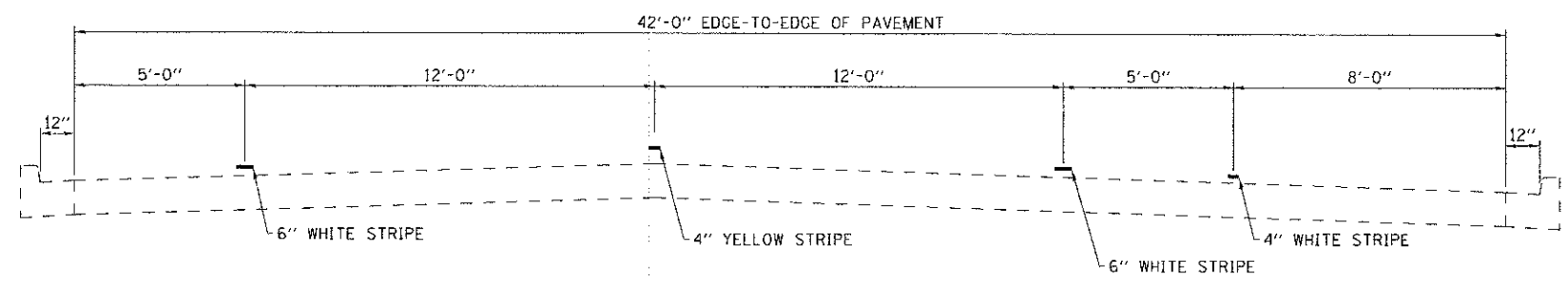

② TYPICAL FOR PAVEMENT MARKING FLORIDA AVENUE

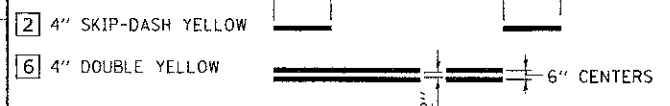

PAVEMENT MARKING LEGEND	
1	4" WHITE
2	4" YELLOW
3	6" WHITE
4	12" YELLOW
5	12" WHITE
6	4" DOUBLE YELLOW

PRINTED BY: ESCA CONSULTANTS, INC. 1/30/2013 2:03:12 PM  
 FILE NAME: 12-00517-00-ST-02.DWG



USER NAME = hcs	DESIGNED = JWS	REVISED =
ESCA PROJECT NO. 1020.04	DRAWN = RJT/HAS	REVISED =
PLOT SCALE = 0.0033" / IN.	CHECKED = JWS	REVISED =
PLOT DATE = 1/30/2013 2:03:12 PM	DATE = 01/29/13	REVISED =

STATE OF ILLINOIS  
DEPARTMENT OF TRANSPORTATION

FLORIDA AVENUE PAVEMENT MARKING

SCALE AS SHOWN SHEET NO. 2 OF 8 SHEETS STA. TO STA.

F.A. RTE.	SECTION	COUNTY	TOTAL SHEETS	SHEET NO.
VAR	12-00517-00-ST	CHAMPAIGN	22	6
CONTRACT NO. 91482				
FED. ROAD DIST. NO.		ILLINOIS FED. AID PROJECT AID		

0' 20' 40'  
SCALE: 1"=40'-0"

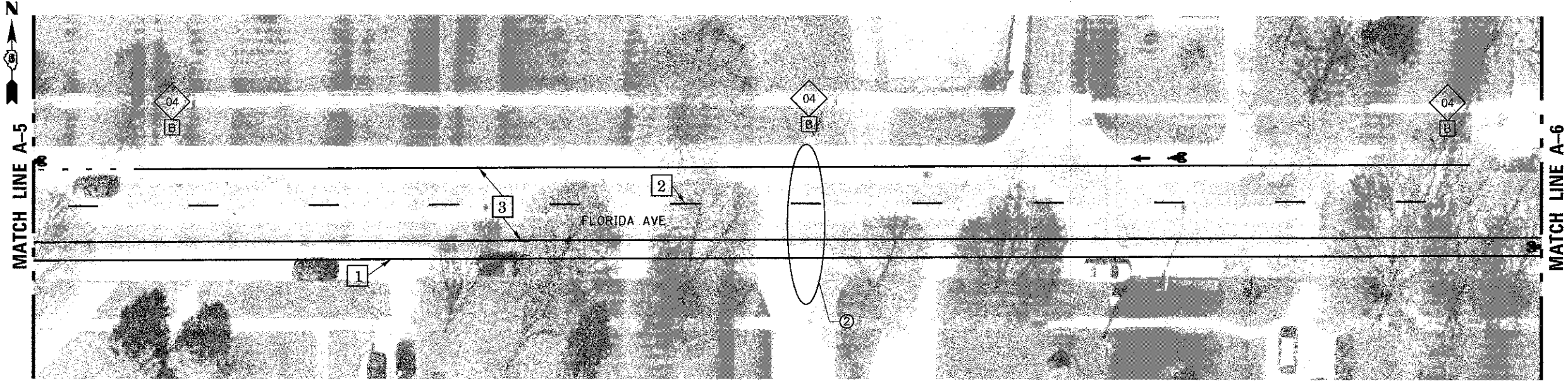
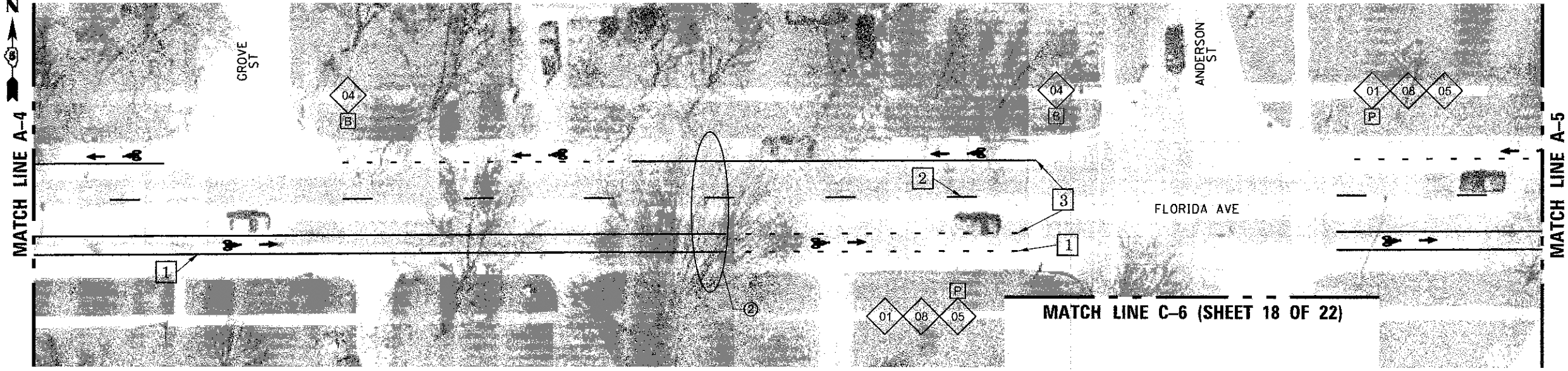

SIGN LEGEND					
01	BIKE ROUTE (D11-1)		06	BIKE ROUTE ARROW RIGHT (M6-1)	
02	BIKE LANE (R3-17)		07	BIKE ROUTE ARROW LEFT (M6-1)	
03	MAY USE FULL LANE (R4-11)		08	BIKE ROUTE ARROW AHEAD (M6-3)	
04	NO PARKING THIS SIDE OF STREET		09	AHEAD (R3-17aP)	
05	BIKE ROUTE ARROW LEFT AND RIGHT (M6-4)		10	ENDS (R3-17bP)	

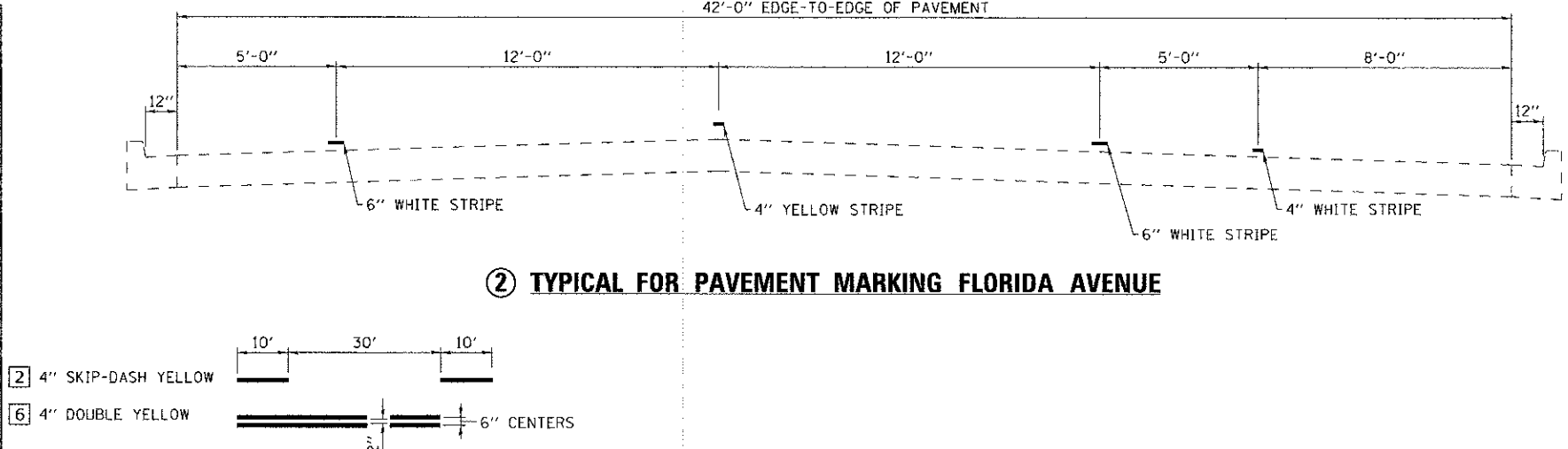

PAVEMENT MARKING LEGEND	
1	4" WHITE
2	4" YELLOW
3	6" WHITE
4	12" YELLOW
5	12" WHITE
6	4" DOUBLE YELLOW

PRINTED BY: JLD/ED/DAW  
DATE: 01/29/13  
SCALE: 1"=40'-0"



USER NAME = has	DESIGNED - JMS	REVISED -
ESCA PROJECT NO. 1020.04	DRAWN - RJT/HAS	REVISED -
PLOT SCALE = 0.0833" / IN.	CHECKED - JMS	REVISED -
PLOT DATE = 1/30/2013 2:03:58 PM	DATE - 01/29/13	REVISED -

STATE OF ILLINOIS  
DEPARTMENT OF TRANSPORTATION

FLORIDA AVENUE PAVEMENT MARKING		
SCALE AS SHOWN	SHEET NO. 3 OF 8 SHEETS	STA. TO STA.

F.A. RTE.	SECTION	COUNTY	TOTAL SHEETS	SHEET NO.
VAR	12-00517-00-ST	CHAMPAIGN	22	7
CONTRACT NO. 91482				
FED. ROAD DIST. NO. ILLINOIS FED. AID PROJECT AID				



0' 20' 40'  
SCALE: 1"=40'-0"

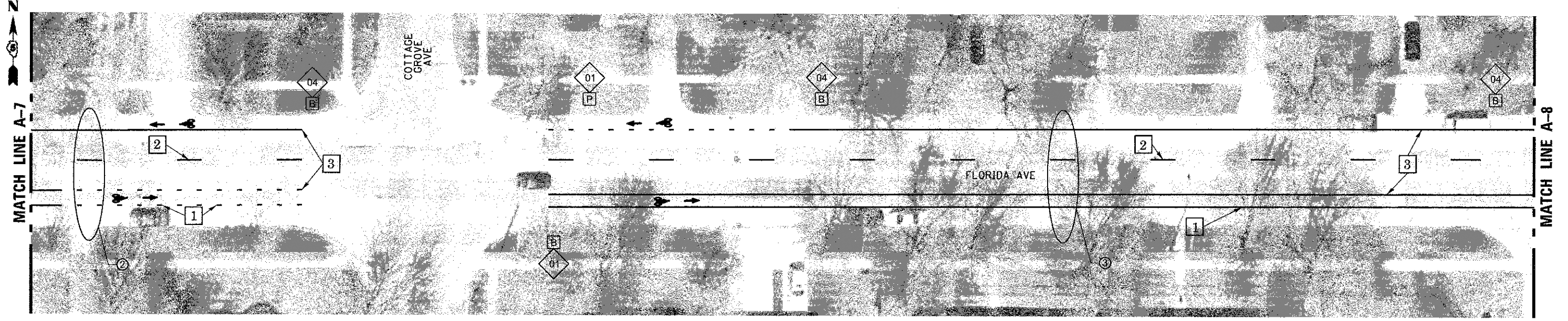
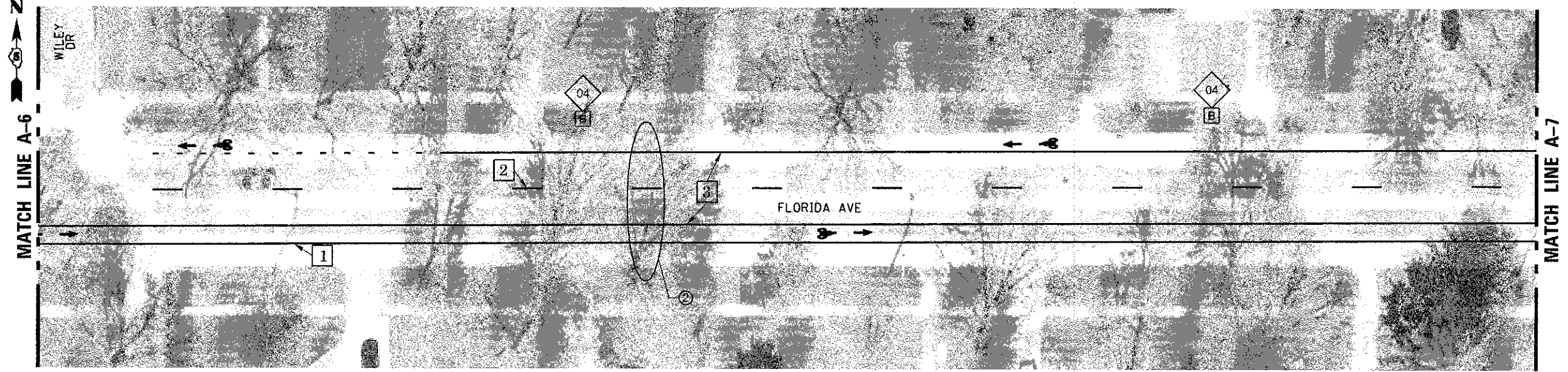

NOTE: TYPICAL FOR PAVEMENT MARKING DETAIL DOES NOT APPLY FROM LINDEN DRIVE THROUGH ADAMS STREET

SIGN LEGEND					
01	BIKE ROUTE (D11-1)		06	BIKE ROUTE ARROW RIGHT (M6-1)	
02	BIKE LANE (R3-17)		07	BIKE ROUTE ARROW LEFT (M6-1)	
03	MAY USE FULL LANE (R4-11)		08	BIKE ROUTE ARROW AHEAD (M6-3)	
04	NO PARKING THIS SIDE OF STREET		09	AHEAD (R3-17aP)	
05	BIKE ROUTE ARROW LEFT AND RIGHT (M6-4)		10	ENDS (R3-17bP)	

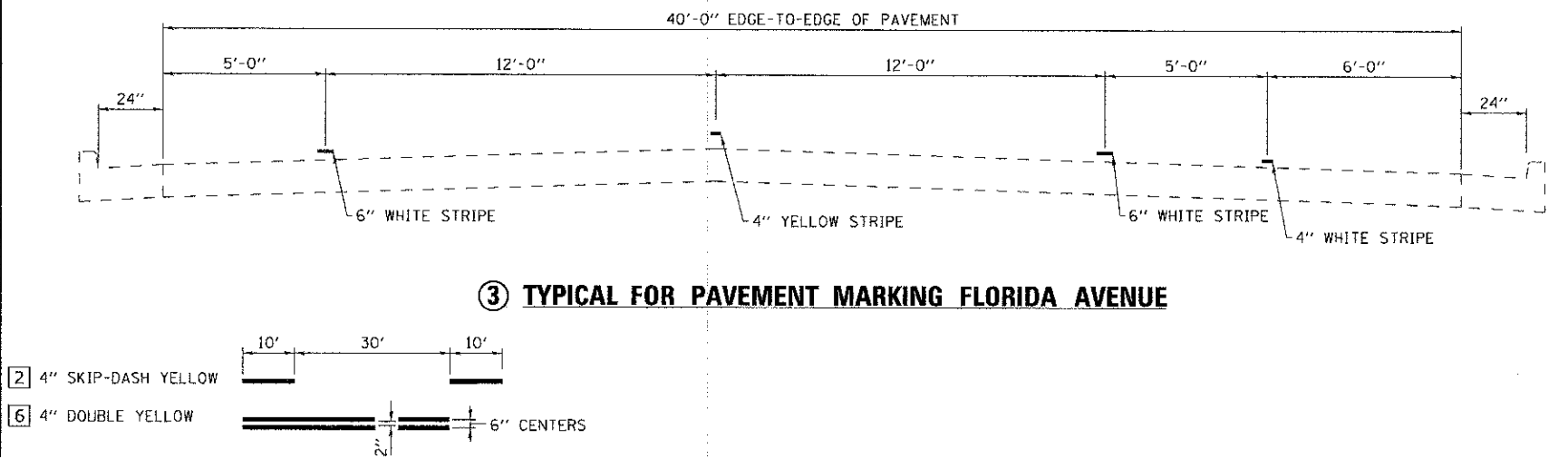

PAVEMENT MARKING LEGEND	
1	4" WHITE
2	4" YELLOW
3	6" WHITE
4	12" YELLOW
5	12" WHITE
6	4" DOUBLE YELLOW

PRINT DRIVER: LAD, D. B. B. A. L.  
 MEDIA: 11x17  
 FILE NAME: 12-00517-00-ST-04-01.dwg



USER NAME: jhas  
 ESCA PROJECT NO. 1020.04  
 PLOT SCALE: 0.0033" / IN.  
 PLOT DATE: 1/30/2013 2:05:04 PM

DESIGNED: JMS  
 DRAWN: RJT/HAS  
 CHECKED: JMS  
 DATE: 01/29/13

REVISED: -  
 REVISED: -  
 REVISED: -  
 REVISED: -

STATE OF ILLINOIS  
 DEPARTMENT OF TRANSPORTATION

FLORIDA AVENUE PAVEMENT MARKING

SCALE AS SHOWN SHEET NO. 4 OF 8 SHEETS STA. TO STA.

F.A. RTE.	SECTION	COUNTY	TOTAL SHEETS	SHEET NO.
VAR	12-00517-00-ST	CHAMPAIGN	22	8
CONTRACT NO. 91482				
FED. ROAD DIST. NO. ILLINOIS FED. AID PROJECT AID				

SCALE: 1"=40'-0"

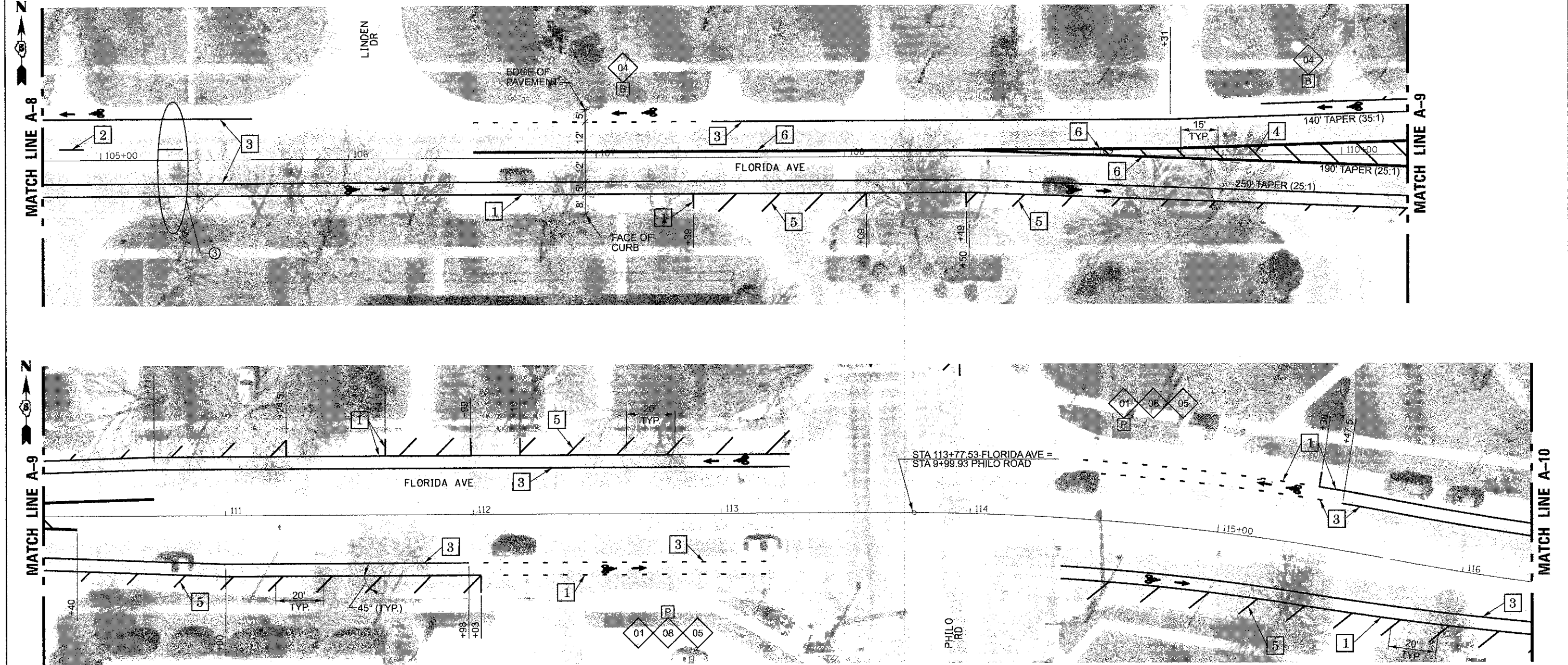

NOTE: TYPICAL FOR PAVEMENT MARKING DETAIL DOES NOT APPLY FROM LINDEN DRIVE THROUGH ADAMS STREET

SIGN LEGEND		
01	BIKE ROUTE (D11-1)	
02	BIKE LANE (R3-17)	
03	MAY USE FULL LANE (R4-11)	
04	NO PARKING THIS SIDE OF STREET	
05	BIKE ROUTE ARROW LEFT AND RIGHT (M6-4)	
06	BIKE ROUTE ARROW RIGHT (M6-1)	
07	BIKE ROUTE ARROW LEFT (M6-1)	
08	BIKE ROUTE ARROW AHEAD (M6-3)	
09	AHEAD (R3-17aP)	
10	ENDS (R3-17bP)	

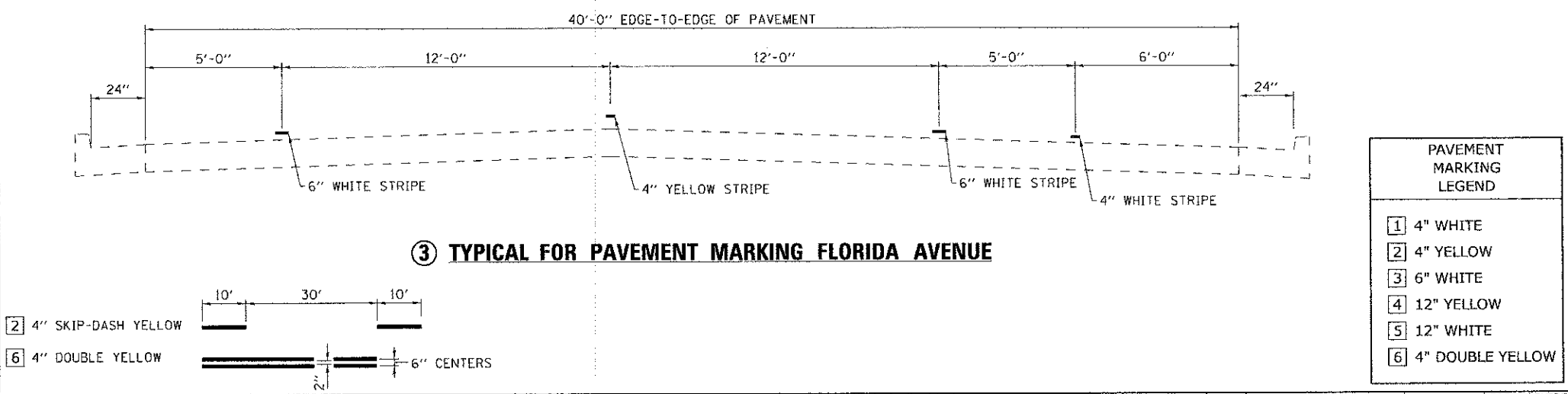

③ TYPICAL FOR PAVEMENT MARKING FLORIDA AVENUE

PAVEMENT MARKING LEGEND	
1	4" WHITE
2	4" YELLOW
3	6" WHITE
4	12" YELLOW
5	12" WHITE
6	4" DOUBLE YELLOW



SCALE: 1" = 40'-0"

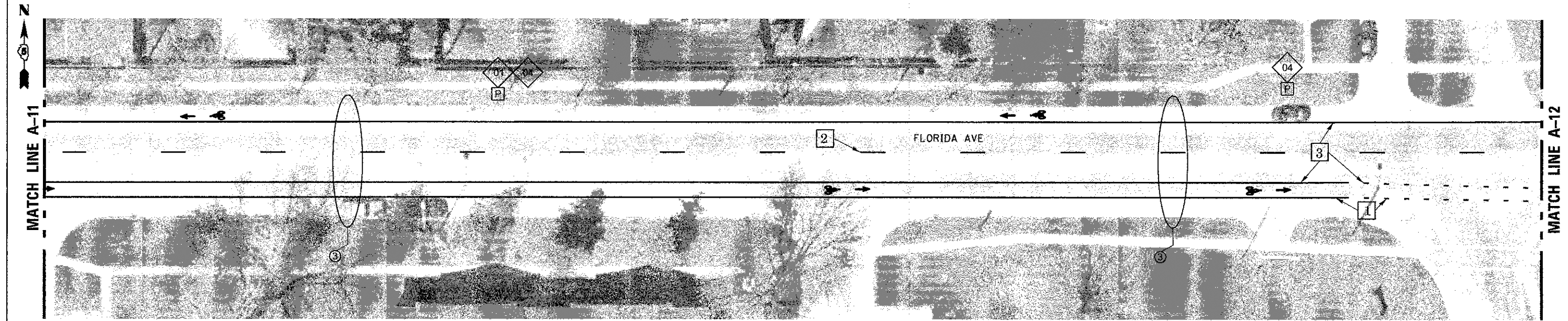
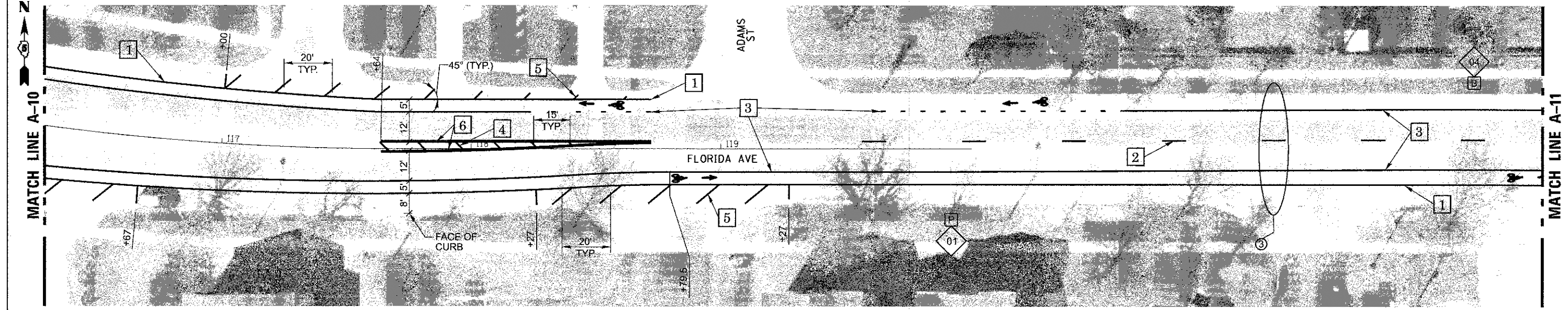

NOTE: TYPICAL FOR PAVEMENT MARKING DETAIL DOES NOT APPLY FROM LINDEN DRIVE THROUGH ADAMS STREET

SIGN LEGEND					
01	BIKE ROUTE (D11-1)		06	BIKE ROUTE ARROW RIGHT (M6-1)	
02	BIKE LANE (R3-17)		07	BIKE ROUTE ARROW LEFT (M6-1)	
03	MAY USE FULL LANE (R4-11)		08	BIKE ROUTE ARROW AHEAD (M6-3)	
04	NO PARKING THIS SIDE OF STREET		09	AHEAD (R3-17aP)	
05	BIKE ROUTE ARROW LEFT AND RIGHT (M6-4)		10	ENDS (R3-17bP)	

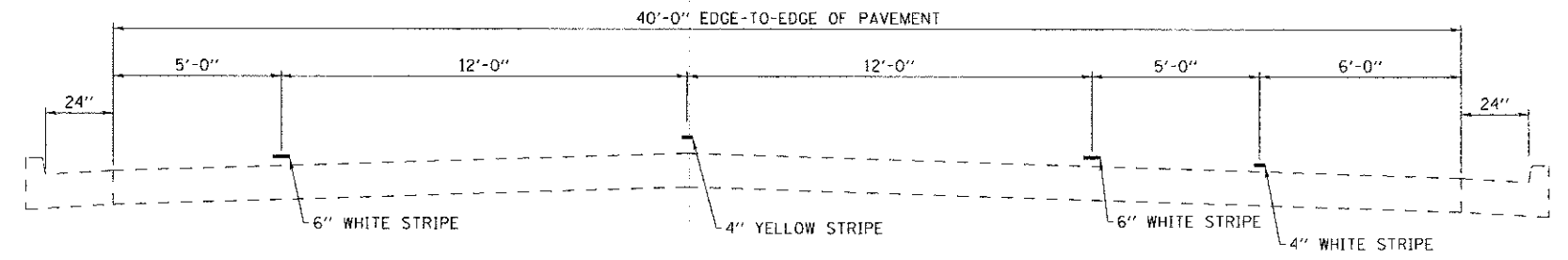

3 TYPICAL FOR PAVEMENT MARKING FLORIDA AVENUE

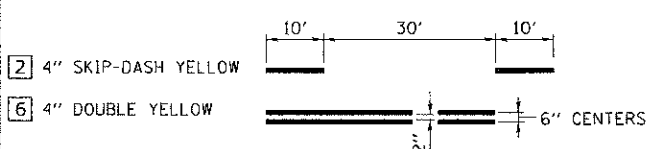

PAVEMENT MARKING LEGEND	
1	4" WHITE
2	4" YELLOW
3	6" WHITE
4	12" YELLOW
5	12" WHITE
6	4" DOUBLE YELLOW

PLOT DATE: 1/30/2013 2:06:57 PM  
 USER NAME: has  
 ESCA PROJECT NO: 10200.04  
 PLOT SCALE: 0.0033 "/in.  
 PLOT DATE: 1/30/2013 2:06:57 PM



DESIGNED - JMS	REVISED -
DRAWN - RJT/HAS	REVISED -
CHECKED - JMS	REVISED -
DATE - 01/29/13	REVISED -

STATE OF ILLINOIS  
DEPARTMENT OF TRANSPORTATION

FLORIDA AVENUE PAVEMENT MARKING

F.A. RTE.	SECTION	COUNTY	TOTAL SHEETS	SHEET NO.
VAR	12-00517-00-ST	CHAMPAIGN	22	10
FED. ROAD DIST. NO.		ILLINOIS FED. AID PROJECT AID	CONTRACT NO. 91482	

SCALE AS SHOWN SHEET NO. 6 OF 8 SHEETS STA. TO STA.

0' 20' 40'  
SCALE: 1"=40'-0"

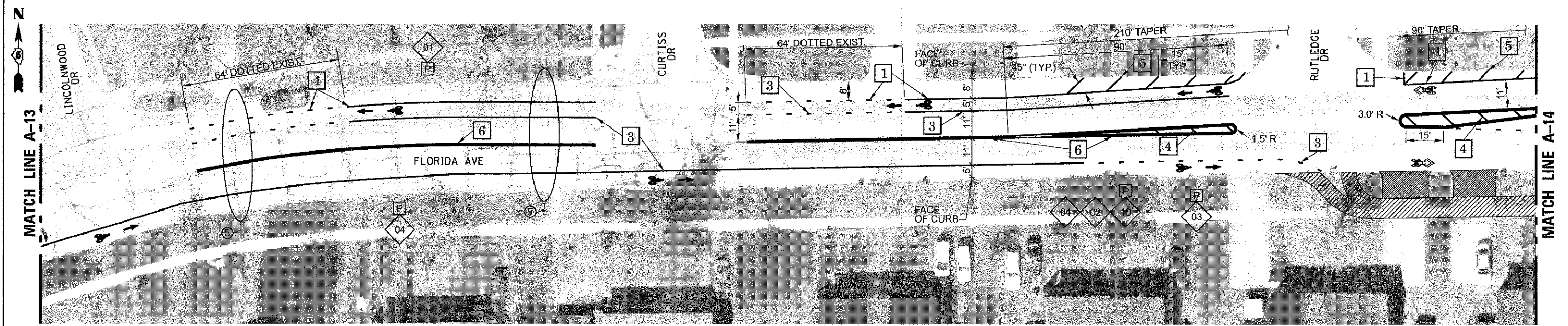
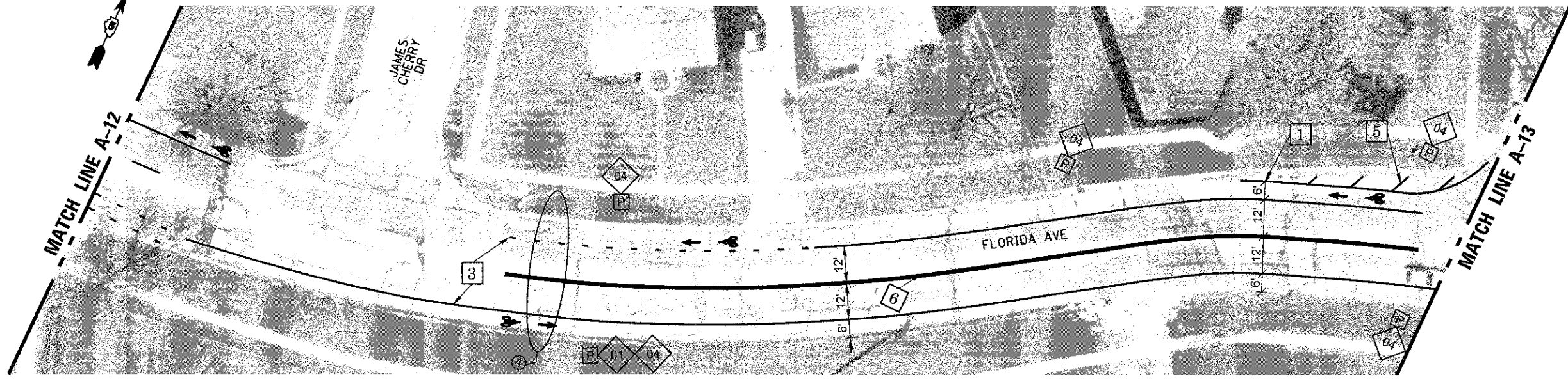

NOTE: TYPICAL PAVEMENT MARKING DETAILS DO NOT APPLY FROM CURTISS DRIVE THROUGH KINCH STREET

SIGN LEGEND					
01	BIKE ROUTE (D11-1)		06	BIKE ROUTE ARROW RIGHT (M6-1)	
02	BIKE LANE (R3-17)		07	BIKE ROUTE ARROW LEFT (M6-1)	
03	MAY USE FULL LANE (R4-11)		08	BIKE ROUTE ARROW AHEAD (M6-3)	
04	NO PARKING THIS SIDE OF STREET		09	AHEAD (R3-17aP)	
05	BIKE ROUTE ARROW LEFT AND RIGHT (M6-4)		10	ENDS (R3-17bP)	

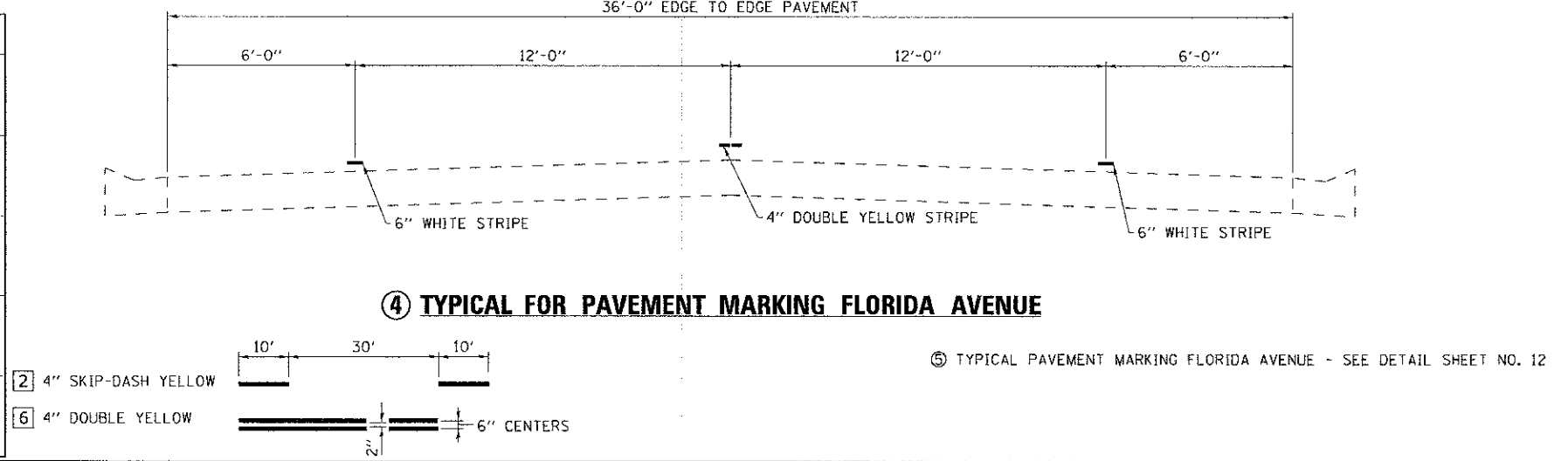

PAVEMENT MARKING LEGEND	
1	4" WHITE
2	4" YELLOW
3	6" WHITE
4	12" YELLOW
5	12" WHITE
6	4" DOUBLE YELLOW

PRINT DRIVER: L.P.L. E.D. B.A.  
 PEN: J.A.B. / J.C. / J.C.  
 FILE NAME: I:\WORK\12-00517-00-ST\12-00517-00-ST.dwg



USER NAME = has	DESIGNED = JMS	REVISED =
ESCA PROJECT NO. 1020.04	DRAWN = RJT/HAS	REVISED =
PLOT SCALE = 0.00333 / IN.	CHECKED = JMS	REVISED =
PLOT DATE = 1/30/2013 2:07:44 PM	DATE = 01/29/13	REVISED =

STATE OF ILLINOIS  
DEPARTMENT OF TRANSPORTATION

FLORIDA AVENUE PAVEMENT MARKING

SCALE AS SHOWN SHEET NO. 7 OF 8 SHEETS STA. TO STA.

F.A. RTE. VAR	SECTION 12-00517-00-ST	COUNTY CHAMPAIGN	TOTAL SHEETS 22	SHEET NO. 11
FED. ROAD DIST. NO.		ILLINOIS FED. AID PROJECT AID		



0' 40' 80'  
 FULL SIZE: 1"=40'-0"  
 HALF SIZE: 1"=80'-0"

MATCH LINE B-1 (SHEET 13 OF 22)

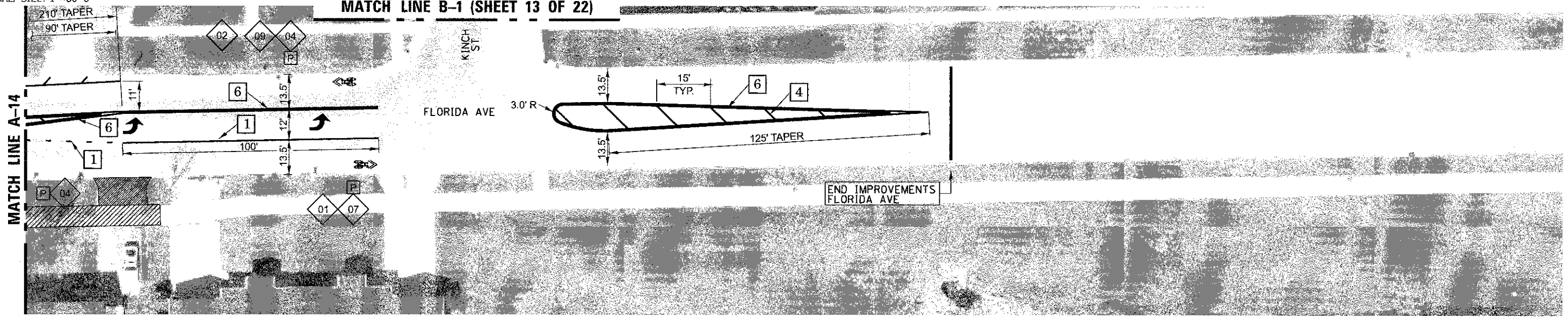

NOTE: THE 13.5' LANE WIDTHS ARE FROM THE CENTERLINE OF STRIPE TO THE FACE OF CURB.  
 NOTE: THE LEFT TURN ARROWS ARE LARGE SIZE (8' HEIGHT).

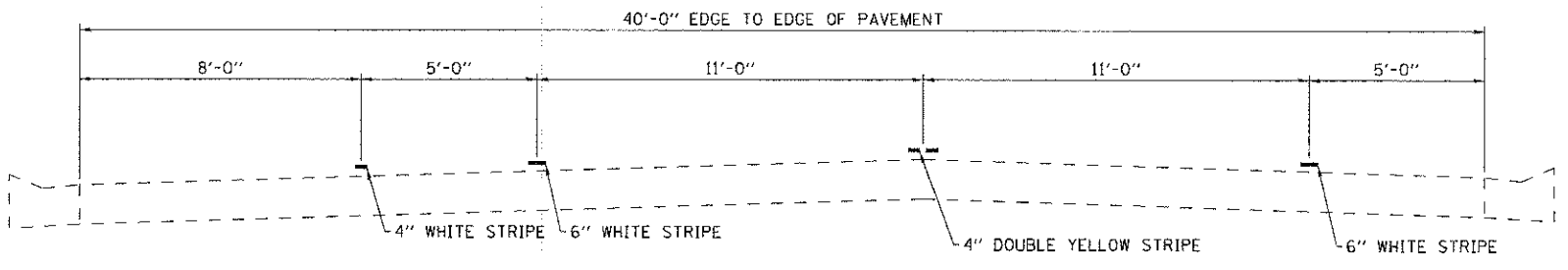

⑤ TYPICAL FOR PAVEMENT MARKING FLORIDA AVENUE

SIGN LEGEND					
01	BIKE ROUTE (D11-1)		06	BIKE ROUTE ARROW RIGHT (M6-1)	
02	BIKE LANE (R3-17)		07	BIKE ROUTE ARROW LEFT (M6-1)	
03	MAY USE FULL LANE (R4-11)		08	BIKE ROUTE ARROW AHEAD (M6-3)	
04	NO PARKING THIS SIDE OF STREET		09	AHEAD (R3-17aP)	
05	BIKE ROUTE ARROW LEFT AND RIGHT (M6-4)		10	ENDS (R3-17bP)	

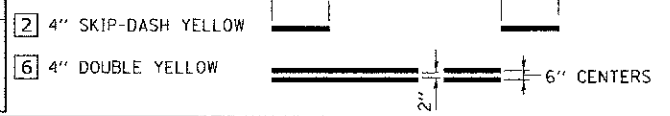

PAVEMENT MARKING LEGEND	
1	4" WHITE
2	4" YELLOW
3	6" WHITE
4	12" YELLOW
5	12" WHITE
6	4" DOUBLE YELLOW

PRINTED BY: J. L. B. & S. L. B. ENGINEERS, INC.  
 1000 W. WASHINGTON ST., CHAMPAIGN, IL 61821  
 TEL: 219/244-1111 FAX: 219/244-1112  
 WWW.JLBS.COM



USER NAME = hsp	DESIGNED = JWS	REVISED =
ESCA PROJECT NO. 1020.04	DRAWN = RJT	REVISED =
PLT SCALE = 0.8833 1/8" IN.	CHECKED = JWS	REVISED =
PLT DATE = 1/30/2013 2:08:28 PM	DATE = 01/29/13	REVISED =

STATE OF ILLINOIS  
 DEPARTMENT OF TRANSPORTATION

FLORIDA AVENUE PAVEMENT MARKING	
SCALE AS SHOWN	SHEET NO. 8 OF 8 SHEETS STA. TO STA.

F.A. RTE.	SECTION	COUNTY	TOTAL SHEETS	SHEET NO.
VAR	12-00517-00-ST	CHAMPAIGN	22	12
FED. ROAD DIST. NO.		ILLINOIS FED. AID PROJECT AID		





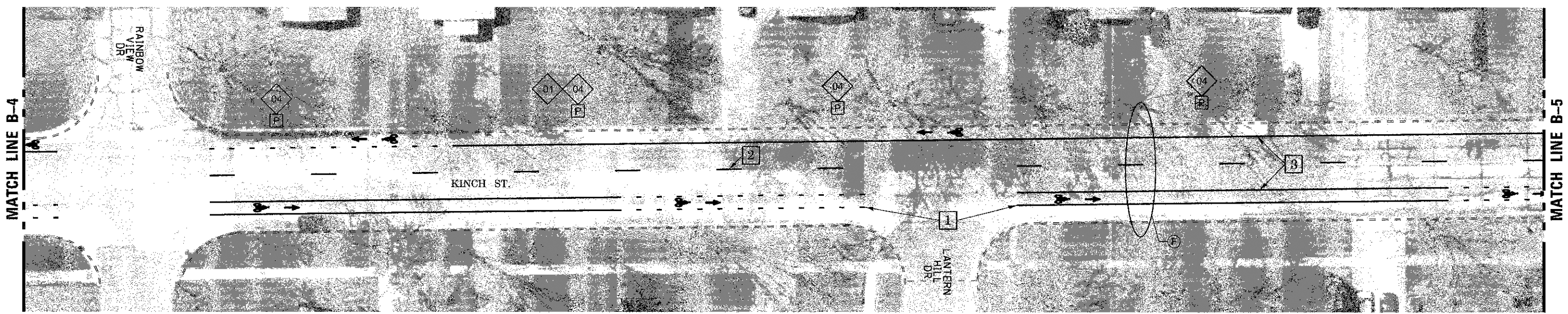
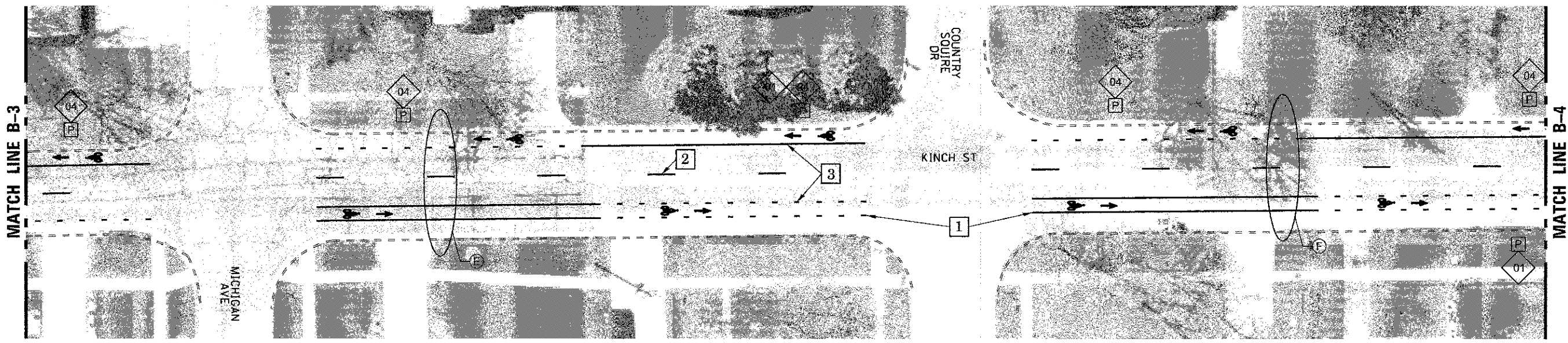

© TYPICAL FOR PAVEMENT MARKING KINCH STREET - SEE DETAIL ON SHEET NO. 15

SIGN LEGEND					
01	BIKE ROUTE (D11-1)		06	BIKE ROUTE ARROW RIGHT (M6-1)	
02	BIKE LANE (R3-17)		07	BIKE ROUTE ARROW LEFT (M6-1)	
03	MAY USE FULL LANE (R4-11)		08	BIKE ROUTE ARROW AHEAD (M6-3)	
04	NO PARKING THIS SIDE OF STREET		09	AHEAD (R3-17aP)	
05	BIKE ROUTE ARROW LEFT AND RIGHT (M6-4)		10	ENDS (R3-17bP)	

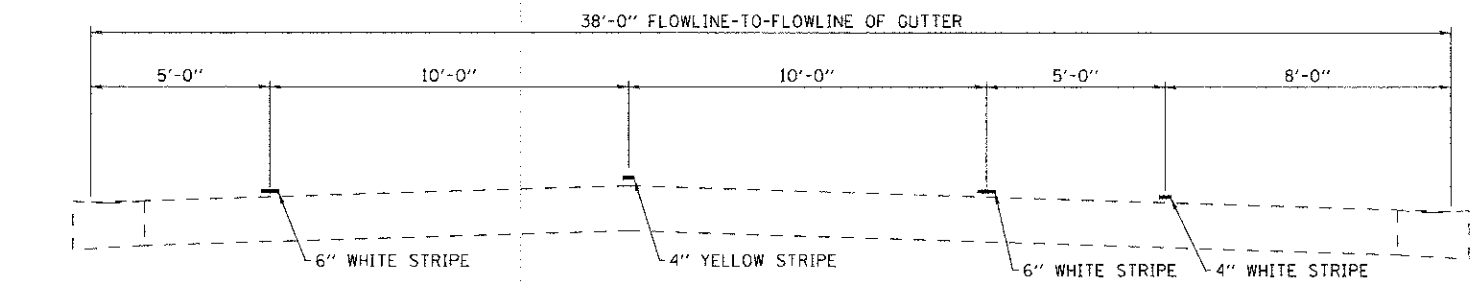

Ⓕ TYPICAL FOR PAVEMENT MARKING KINCH STREET  
COUNTRY SQUIRE DRIVE TO EASY STREET

PAVEMENT MARKING LEGEND	
1	4" WHITE
2	4" YELLOW
3	6" WHITE
4	12" YELLOW
5	12" WHITE
6	4" DOUBLE YELLOW

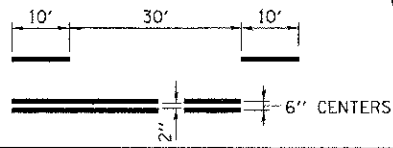

PRINT DRIVER: J. P. O. B. A. L.  
 PLOT DATE: 1/30/2013 2:10:09 PM  
 FILE NAME: I:\PROJECTS\12-00517-00-ST\12-00517-00-ST-02.dwg



USER NAME: jhas	DESIGNED: JMS	REVISED: -
ESCA PROJECT NO. 1020.04	DRAWN: RJT/HAS	REVISED: -
PLOT SCALE: 0.0033" / IN.	CHECKED: JMS	REVISED: -
PLOT DATE: 1/30/2013 2:10:09 PM	DATE: 01/29/13	REVISED: -

**STATE OF ILLINOIS**  
**DEPARTMENT OF TRANSPORTATION**

**KINCH STREET PAVEMENT MARKING**  
 SCALE AS SHOWN SHEET NO. 2 OF 3 SHEETS STA. TO STA.

F.A. RTE. VAR	SECTION 12-00517-00-ST	COUNTY CHAMPAIGN	TOTAL SHEETS 22	SHEET NO. 14
FED. ROAD DIST. NO.		ILLINOIS FED. AID PROJECT AID		

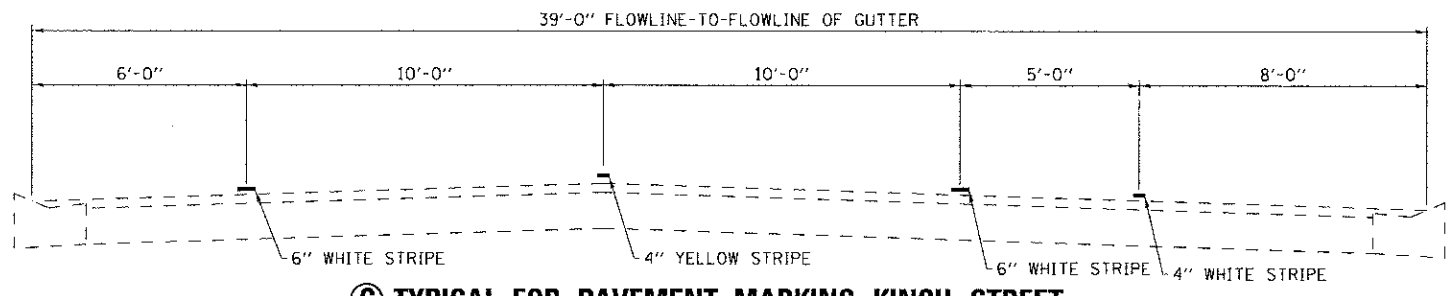
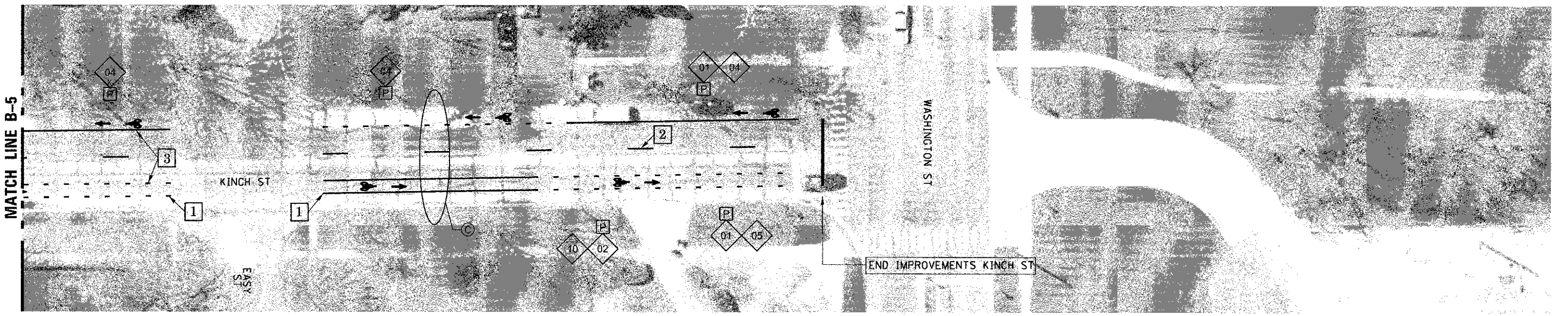

**(C) TYPICAL FOR PAVEMENT MARKING KINCH STREET**  
VERMONT STREET TO PENNSYLVANIA AVE  
EASY STREET TO WASHINGTON STREET

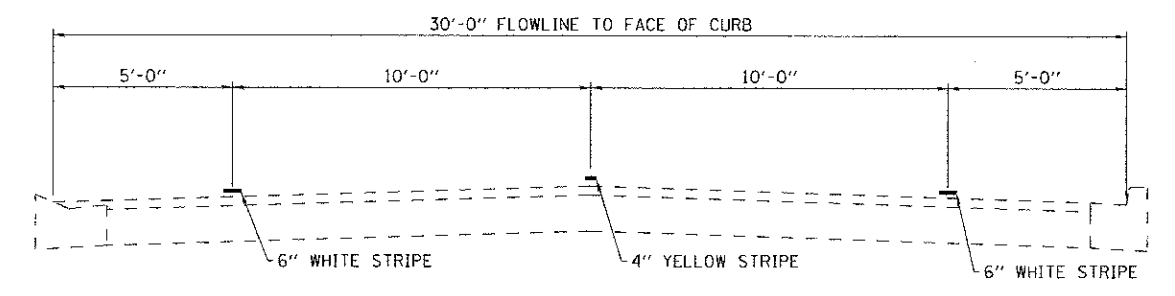

**(D) TYPICAL FOR PAVEMENT MARKING KINCH STREET**  
PENNSYLVANIA AVE TO MICHIGAN AVE

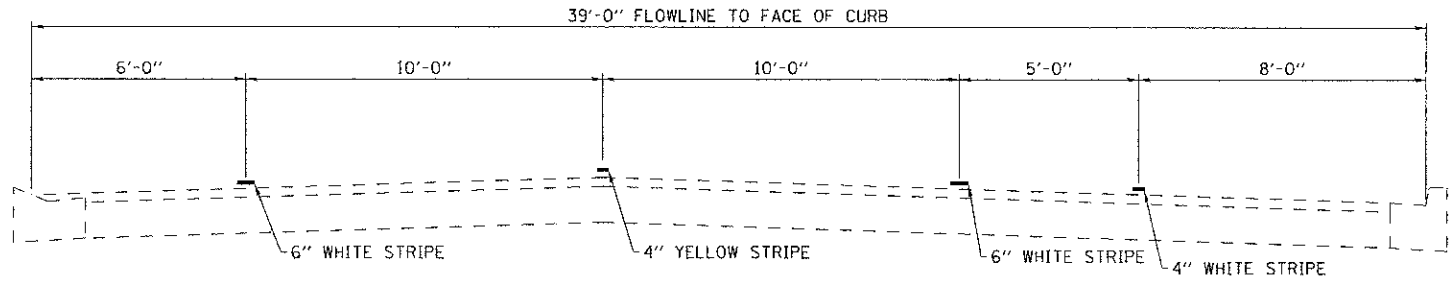

**(E) TYPICAL FOR PAVEMENT MARKING KINCH STREET**  
MICHIGAN AVENUE TO COUNTRY SQUIRE DRIVE

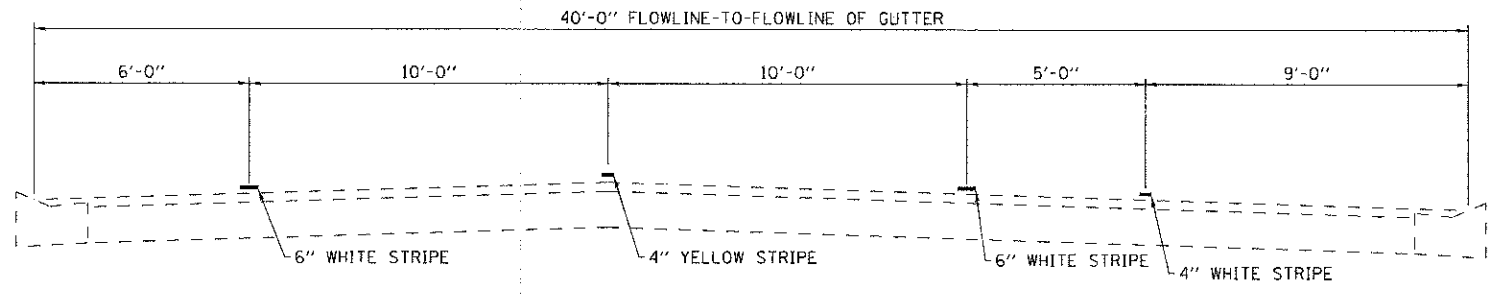

**(B) TYPICAL FOR PAVEMENT MARKING KINCH STREET**  
PARKING ALLOWED AREA FLORIDA AVENUE TO VERMONT STREET

SIGN LEGEND					
01	BIKE ROUTE (D11-1)		06	BIKE ROUTE ARROW RIGHT (M6-1)	
02	BIKE LANE (R3-17)		07	BIKE ROUTE ARROW LEFT (M6-1)	
03	MAY USE FULL LANE (R4-11)		08	BIKE ROUTE ARROW AHEAD (M6-3)	
04	NO PARKING THIS SIDE OF STREET		09	AHEAD (R3-17aP)	
05	BIKE ROUTE ARROW LEFT AND RIGHT (M6-4)		10	ENDS (R3-17bP)	

- 2 4" SKIP-DASH YELLOW
- 6 4" DOUBLE YELLOW

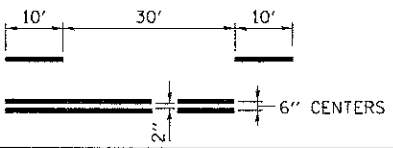

PAVEMENT MARKING LEGEND				
1	4" WHITE			
2	4" YELLOW			
3	6" WHITE			
4	12" YELLOW			
5	12" WHITE			
6	4" DOUBLE YELLOW			

PRINT DRIVER - L.D.E.B./B.A.T.  
 PLOT DATE - 1/30/2013 2:11:01 PM  
 PLOT SCALE - 0.0033 1/ IN.  
 USER NAME - hos  
 ESCA PROJECT NO. 1020.04  
 DESIGNED - JMS  
 DRAWN - RJT/HAS  
 CHECKED - JMS  
 DATE - 01/29/13  
 REVISED -  
 REVISED -  
 REVISED -  
 REVISED -



USER NAME - hos	DESIGNED - JMS	REVISED -
ESCA PROJECT NO. 1020.04	DRAWN - RJT/HAS	REVISED -
PLOT SCALE - 0.0033 1/ IN.	CHECKED - JMS	REVISED -
PLOT DATE - 1/30/2013 2:11:01 PM	DATE - 01/29/13	REVISED -

STATE OF ILLINOIS  
DEPARTMENT OF TRANSPORTATION

KINCH STREET PAVEMENT MARKING

SCALE AS SHOWN	SHEET NO. 3 OF 3 SHEETS	STA. TO STA.
----------------	-------------------------	--------------

F.A. RTE. VAR	SECTION 12-00517-00-ST	COUNTY CHAMPAIGN	TOTAL SHEETS 22	SHEET NO. 15
FED. ROAD DIST. NO. ILLINOIS FED. AID PROJECT AID				
CONTRACT NO. 91482				



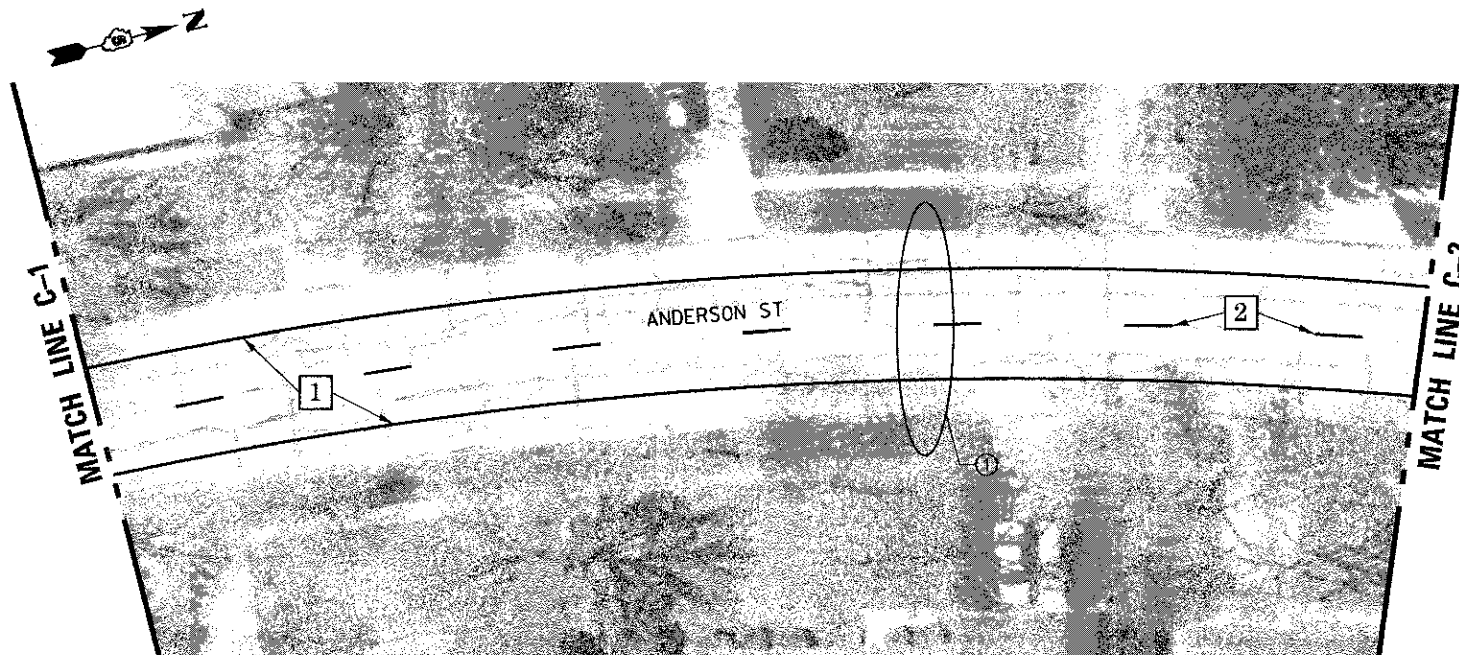
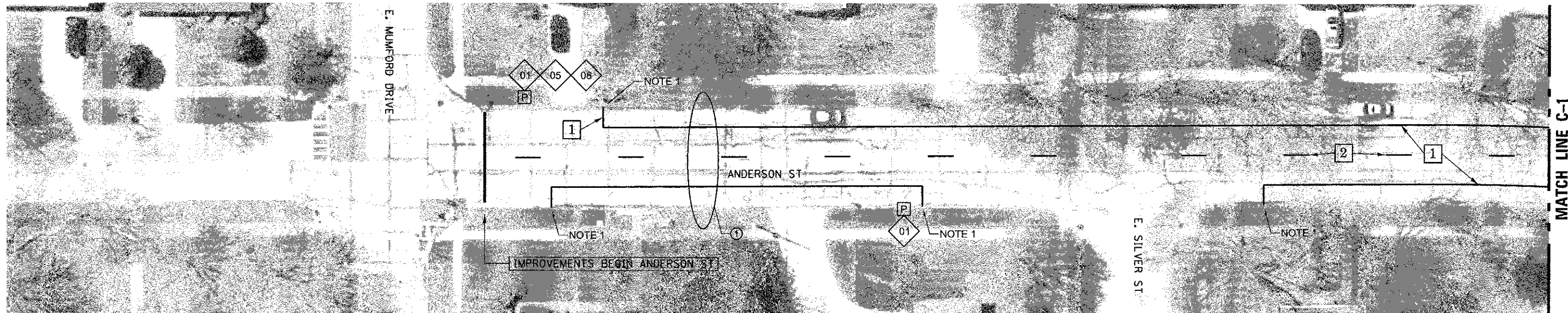
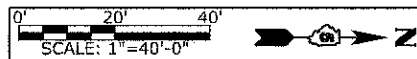

NOTE 1: THE 4" WHITE PAVEMENT MARKING LINE TERMINATES AT THE LIMIT OF THE YELLOW PAINTED CURB (TYPICAL)

SIGN LEGEND					
01	BIKE ROUTE (D11-1)		06	BIKE ROUTE ARROW RIGHT (M6-1)	
02	BIKE LANE (R3-17)		07	BIKE ROUTE ARROW LEFT (M6-1)	
03	MAY USE FULL LANE (R4-11)		08	BIKE ROUTE ARROW AHEAD (M6-3)	
04	NO PARKING THIS SIDE OF STREET		09	AHEAD (R3-17aP)	
05	BIKE ROUTE ARROW LEFT AND RIGHT (M6-4)		10	ENDS (R3-17bP)	

- 2 4" SKIP-DASH YELLOW
- 6 4" DOUBLE YELLOW

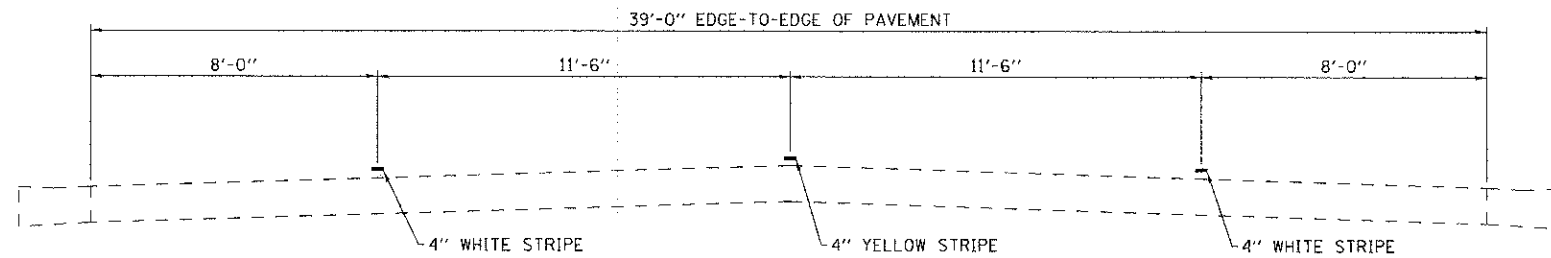

① TYPICAL FOR PAVEMENT MARKING ANDERSON ST. MUMFORD DRIVE TO COLORADO AVENUE

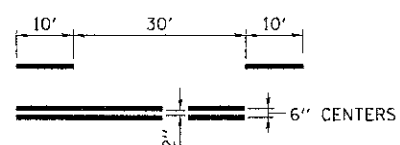

PAVEMENT MARKING LEGEND	
1	4" WHITE
2	4" YELLOW
3	6" WHITE
4	12" YELLOW
5	12" WHITE
6	4" DOUBLE YELLOW

ESCA CONSULTANTS, INC.  
 100 N. WASHINGTON ST.  
 CHAMPAIGN, IL 61820-4400  
 TEL: 217/244-8800  
 FAX: 217/244-8801  
 WWW.ESCA-CONSULTANTS.COM



USER NAME = hns  
 ESCA PROJECT NO. 1020.04  
 PLOT SCALE = 0.0033 / IN.  
 PLOT DATE = 1/30/2013 2:12:03 PM

DESIGNED - JMS  
 DRAWN - RJT/HAS  
 CHECKED - JMS  
 DATE - 01/29/13

REVISED -  
 REVISED -  
 REVISED -  
 REVISED -

STATE OF ILLINOIS  
 DEPARTMENT OF TRANSPORTATION

ANDERSON STREET PAVEMENT MARKING

SCALE AS SHOWN SHEET NO. 1 OF 3 SHEETS STA. TO STA.

F.A. RTE.	SECTION	COUNTY	TOTAL SHEETS	SHEET NO.
VAR	12-00517-00-ST	CHAMPAIGN	22	16
CONTRACT NO. 91482				
FED. ROAD DIST. NO. ILLINOIS FED. AID PROJECT AID				

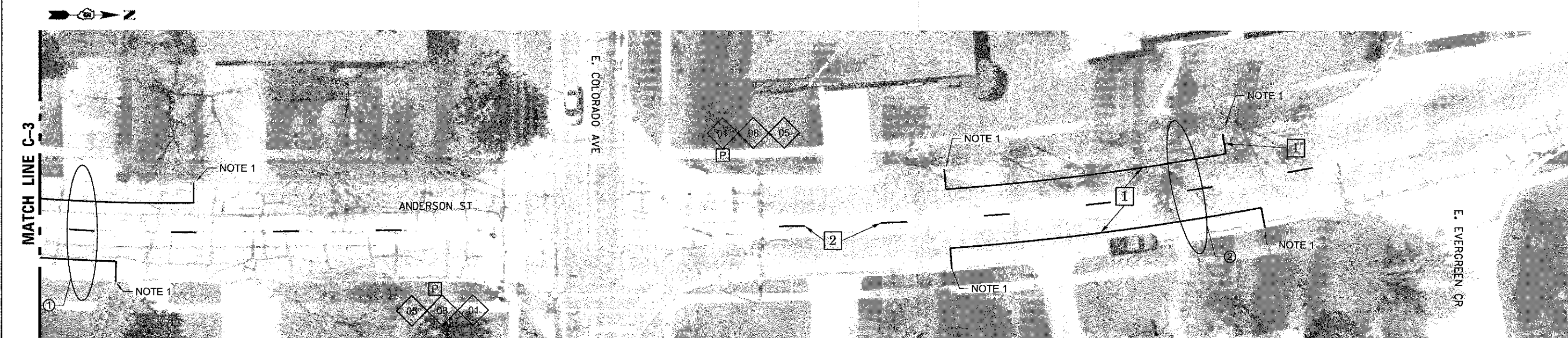
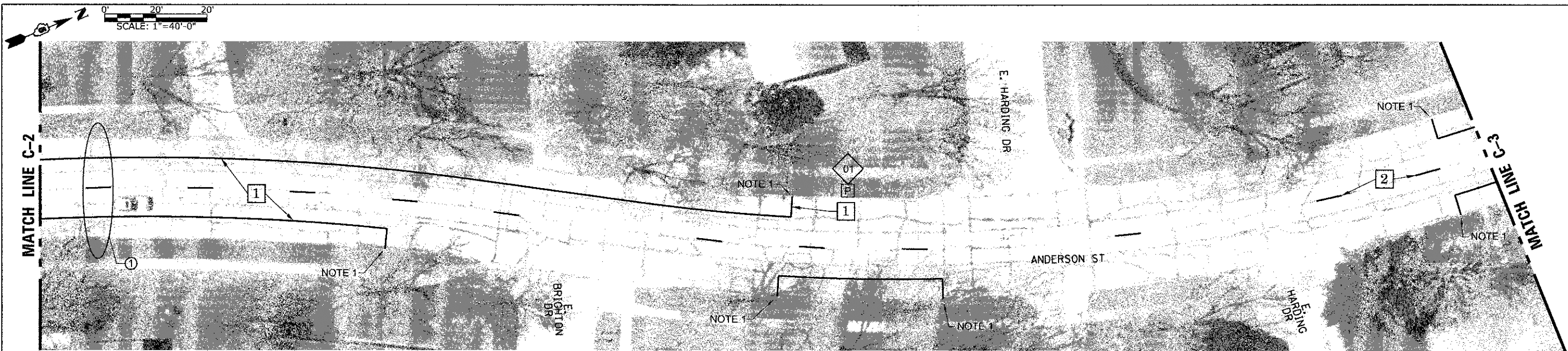

NOTE 1: THE 4" WHITE PAVEMENT MARKING LINE TERMINATES AT THE LIMIT OF THE YELLOW PAINTED CURB (TYPICAL)

- ① TYPICAL PAVEMENT MARKING ANDERSON STREET - SEE DETAIL ON SHEET NO. 16
- ② TYPICAL PAVEMENT MARKING ANDERSON STREET - SEE DETAIL ON SHEET NO. 18

SIGN LEGEND					
01	BIKE ROUTE (D11-1)		06	BIKE ROUTE ARROW RIGHT (M6-1)	
02	BIKE LANE (R3-17)		07	BIKE ROUTE ARROW LEFT (M6-1)	
03	MAY USE FULL LANE (R4-11)		08	BIKE ROUTE ARROW AHEAD (M6-3)	
04	NO PARKING THIS SIDE OF STREET		09	AHEAD (R3-17aP)	
05	BIKE ROUTE ARROW LEFT AND RIGHT (M6-4)		10	ENDS (R3-17bP)	

- 2 4" SKIP-DASH YELLOW
- 6 4" DOUBLE YELLOW

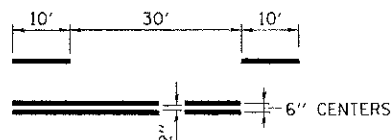

PAVEMENT MARKING LEGEND	
1	4" WHITE
2	4" YELLOW
3	6" WHITE
4	12" YELLOW
5	12" WHITE
6	4" DOUBLE YELLOW

PRINTED BY: ESCA  
 FILE NO.: 12-00517-00-ST  
 PLOT DATE: 1/30/2013 2:12:58 PM  
 PLOT SCALE: 0.8833 / IN.  
 USER: JMS

	USER NAME = jms	DESIGNED = JMS	REVISED =
	ESCA PROJECT NO. 1020-04	DRAWN = RJT/HAS	REVISED =
	PLOT SCALE = 0.8833 / IN.	CHECKED = JMS	REVISED =
	PLOT DATE = 1/30/2013 2:12:58 PM	DATE = 01/29/13	REVISED =

**STATE OF ILLINOIS**  
**DEPARTMENT OF TRANSPORTATION**

**ANDERSON STREET PAVEMENT MARKING**  
 SCALE AS SHOWN SHEET NO. 2 OF 3 SHEETS STA. TO STA.

F.A. RTE.	SECTION	COUNTY	TOTAL SHEETS	SHEET NO.
VAR	12-00517-00-ST	CHAMPAIGN	22	17
CONTRACT NO. 91482				
FED. ROAD DIST. NO. ILLINOIS FED. AID PROJECT AID				



0' 20' 40'  
SCALE: 1"=40'-0"

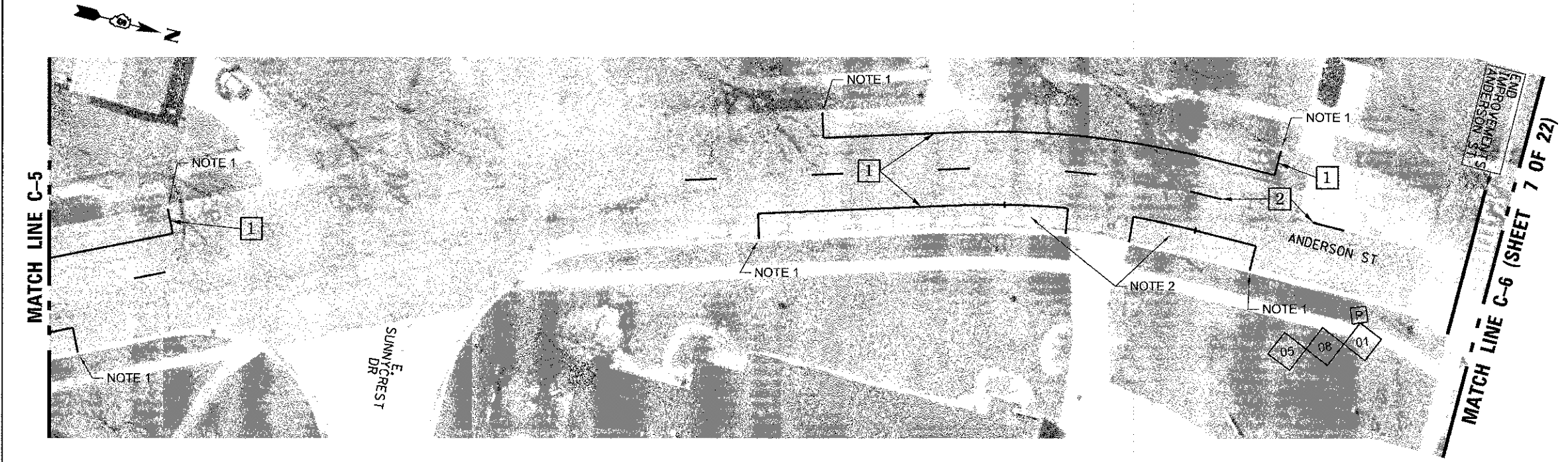
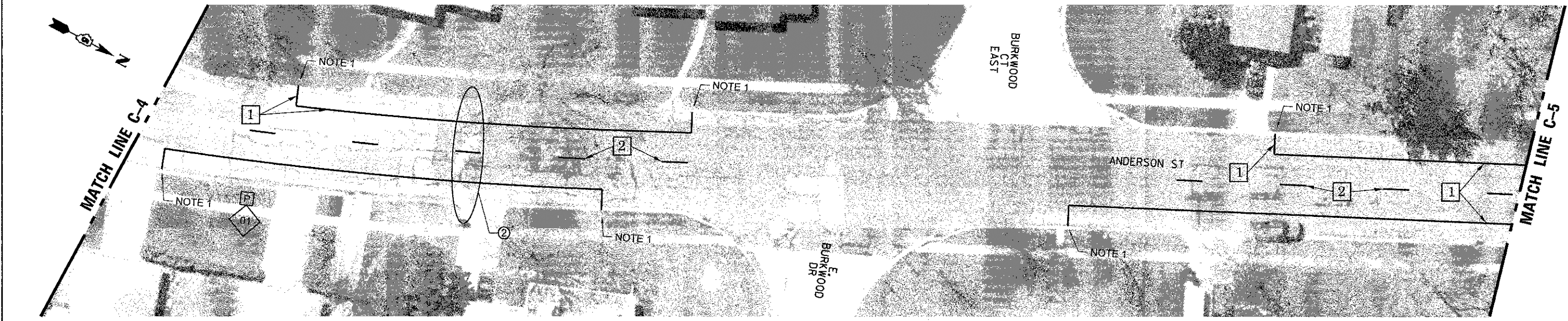

NOTE 1:  
THE 4" WHITE PAVEMENT MARKING LINE TERMINATES AT THE LIMIT OF THE YELLOW PAINTED CURB UNLESS NOTED OTHERWISE

NOTE 2:  
THE EXISTING HANDICAP PARKING SHALL BE MAINTAINED.

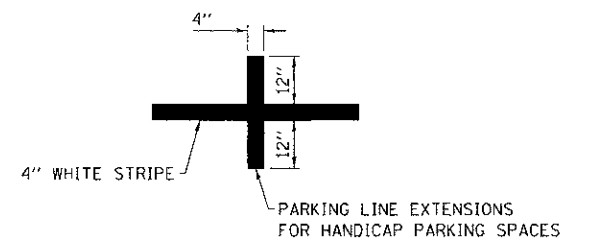

SIGN LEGEND			
01	BIKE ROUTE (D11-1)		
02	BIKE LANE (R3-17)		
03	MAY USE FULL LANE (R4-11)		
04	NO PARKING THIS SIDE OF STREET		
05	BIKE ROUTE ARROW LEFT AND RIGHT (M6-4)		
06	BIKE ROUTE ARROW RIGHT (M6-1)		
07	BIKE ROUTE ARROW LEFT (M6-1)		
08	BIKE ROUTE ARROW AHEAD (M6-3)		
09	AHEAD (R3-17aP)		
10	ENDS (R3-17bP)		

- 2 4" SKIP-DASH YELLOW
- 6 4" DOUBLE YELLOW

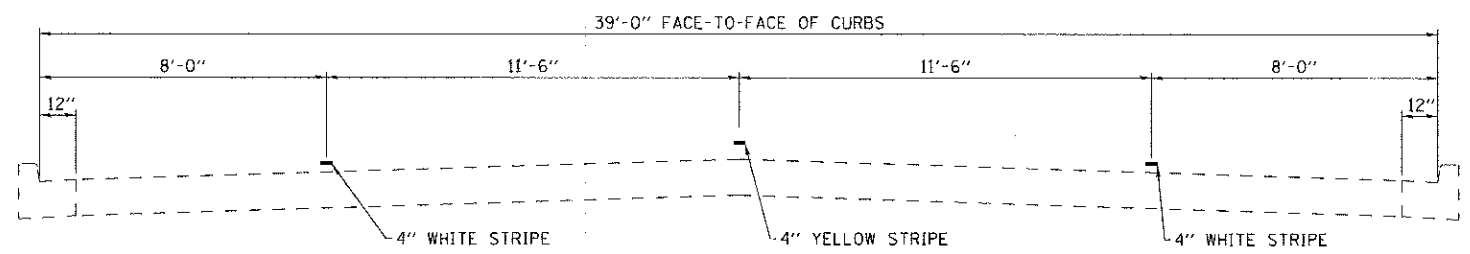

2 TYPICAL FOR PAVEMENT MARKING ANDERSON STREET  
COLORADO AVENUE TO FLORIDA AVENUE

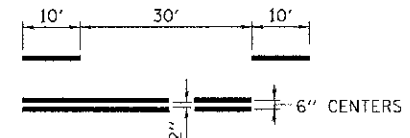

PAVEMENT MARKING LEGEND	
1	4" WHITE
2	4" YELLOW
3	6" WHITE
4	12" YELLOW
5	12" WHITE
6	4" DOUBLE YELLOW

PRINTED BY: ESCA  
 PROJECT NO. 102004  
 DATE: 01/30/2013



0' 20' 40'  
SCALE: 1"=40'-0"

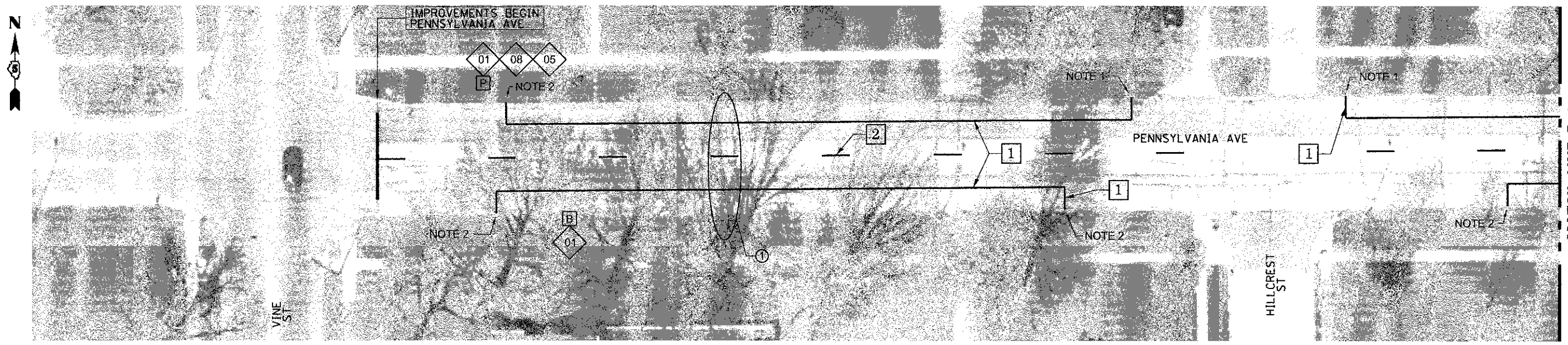

MATCH LINE D-1

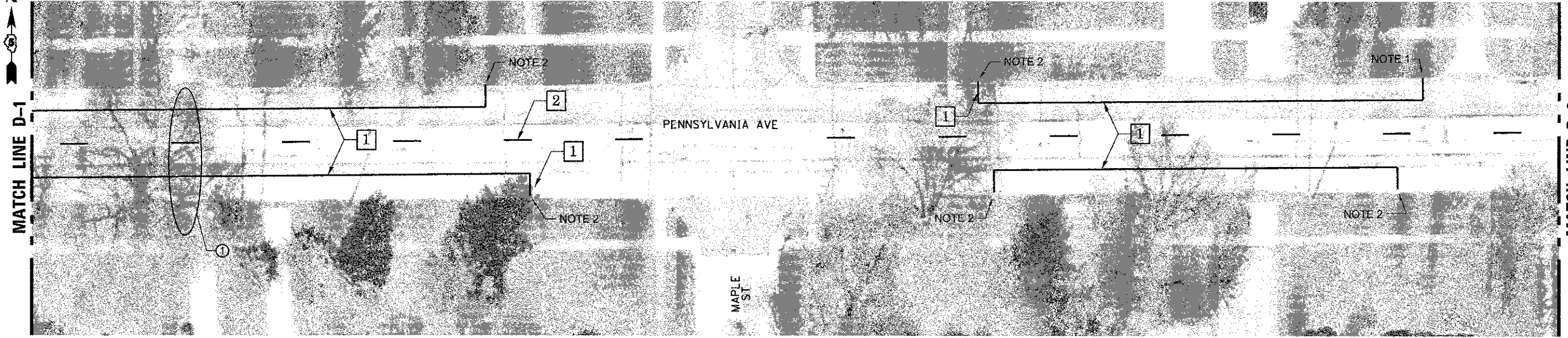

MATCH LINE D-2

NOTE 1: THE 4" WHITE PAVEMENT MARKING LINE TERMINATES AT THE LIMIT OF THE YELLOW PAINTED CURB.  
NOTE 2: THE 4" WHITE PAVEMENT MARKING LINE TERMINATES AT THE "NO PARKING HERE TO CORNER" SIGNS.

SIGN LEGEND					
01	BIKE ROUTE (D11-1)		06	BIKE ROUTE ARROW RIGHT (M6-1)	
02	BIKE LANE (R3-17)		07	BIKE ROUTE ARROW LEFT (M6-1)	
03	MAY USE FULL LANE (R4-11)		08	BIKE ROUTE ARROW AHEAD (M6-3)	
04	NO PARKING THIS SIDE OF STREET		09	AHEAD (R3-17aP)	
05	BIKE ROUTE ARROW LEFT AND RIGHT (M6-4)		10	ENDS (R3-17bP)	

- 2 4" SKIP-DASH YELLOW
- 6 4" DOUBLE YELLOW

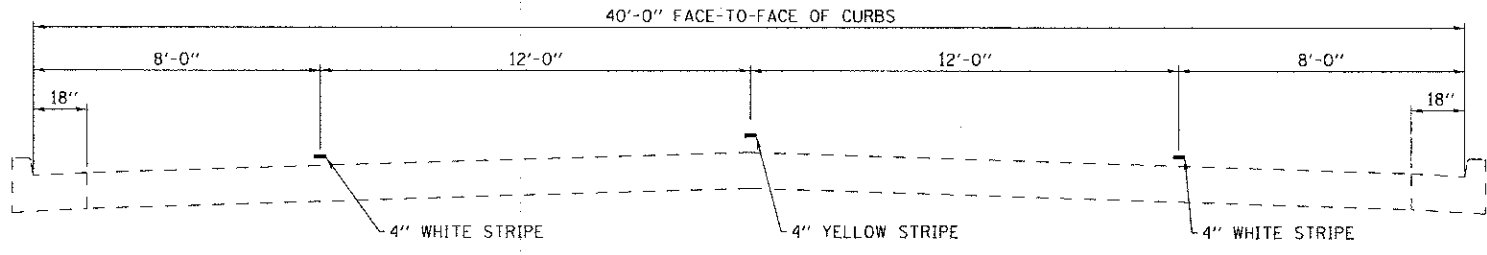

1 TYPICAL FOR PAVEMENT MARKING PENNSYLVANIA AVENUE  
VINE STREET TO ANDERSON STREET

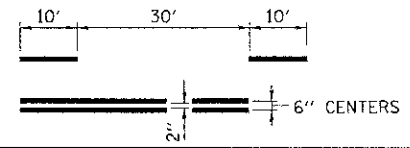

PAVEMENT MARKING LEGEND	
1	4" WHITE
2	4" YELLOW
3	6" WHITE
4	12" YELLOW
5	12" WHITE
6	4" DOUBLE YELLOW

PRINTED ON: 1/30/2013 2:14:24 PM  
 USER: hms  
 PLOT SCALE: 0.0033 / IN.  
 PLOT DATE: 1/30/2013 2:14:24 PM



USER NAME = hms	DESIGNED - JMS	REVISED -
ESCA PROJECT NO. 1020.04	DRAWN - RJT/HAS	REVISED -
PLOT SCALE = 0.0033 / IN.	CHECKED - JMS	REVISED -
PLOT DATE = 1/30/2013 2:14:24 PM	DATE - 01/29/13	REVISED -

STATE OF ILLINOIS  
DEPARTMENT OF TRANSPORTATION

PENNSYLVANIA AVENUE PAVEMENT MARKING

SCALE AS SHOWN SHEET NO. 1 OF 2 SHEETS STA. TO STA.

F.A. RTE.	SECTION	COUNTY	TOTAL SHEETS	SHEET NO.
VAR	12-00517-00-ST	CHAMPAIGN	22	19
CONTRACT NO. 91482				
FED. ROAD DIST. NO. ILLINOIS/FED. AID PROJECT AID				

SCALE: 1"=40'-0"

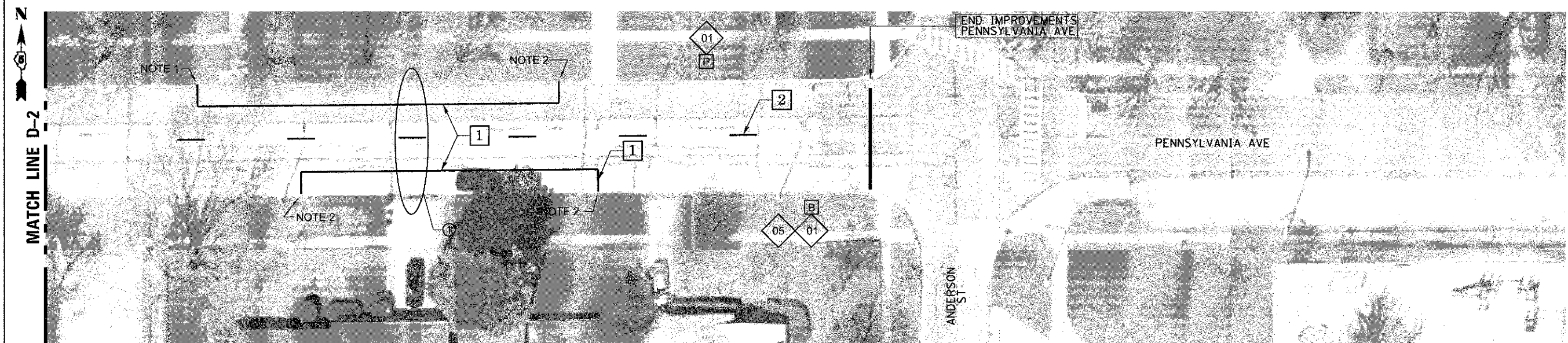

NOTE 1: THE 4" WHITE PAVEMENT MARKING LINE TERMINATES AT THE LIMIT OF THE YELLOW PAINTED CURB.  
 NOTE 2: THE 4" WHITE PAVEMENT MARKING LINE TERMINATES AT THE "NO PARKING HERE TO CORNER" SIGNS

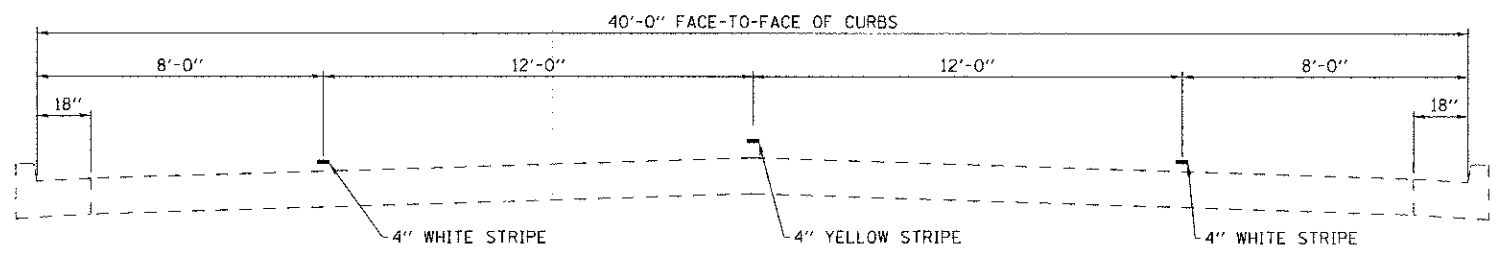

① TYPICAL FOR PAVEMENT MARKING PENNSYLVANIA AVENUE  
 VINE STREET TO ANDERSON STREET

SIGN LEGEND					
01	BIKE ROUTE (D11-1)		06	BIKE ROUTE ARROW RIGHT (M6-1)	
02	BIKE LANE (R3-17)		07	BIKE ROUTE ARROW LEFT (M6-1)	
03	MAY USE FULL LANE (R4-11)		08	BIKE ROUTE ARROW AHEAD (M6-3)	
04	NO PARKING THIS SIDE OF STREET		09	AHEAD (R3-17aP)	
05	BIKE ROUTE ARROW LEFT AND RIGHT (M6-4)		10	ENDS (R3-17bP)	

② 4" SKIP-DASH YELLOW  
 ⑥ 4" DOUBLE YELLOW

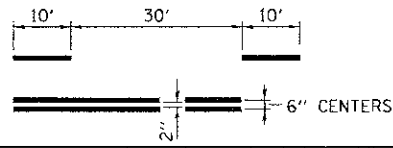

PAVEMENT MARKING LEGEND	
①	4" WHITE
②	4" YELLOW
③	6" WHITE
④	12" YELLOW
⑤	12" WHITE
⑥	4" DOUBLE YELLOW

PRINT NUMBER: 1100 F.D. 84-A  
 PENNSYLVANIA STATE ROAD DISTRICT NO. 12  
 FILE NAME: 12-00517-00-S1-20-01.DWG



USER NAME	has	DESIGNED	JMS	REVISED	-
ESCA PROJECT NO.	1020.04	DRAWN	RJT/HAS	REVISED	-
PLOT SCALE	0.0833 1/12 IN.	CHECKED	JMS	REVISED	-
PLOT DATE	1/30/2013 2:15:05 PM	DATE	01/29/13	REVISED	-

STATE OF ILLINOIS  
 DEPARTMENT OF TRANSPORTATION

PENNSYLVANIA AVENUE PAVEMENT MARKING

SCALE AS SHOWN SHEET NO. 2 OF 2 SHEETS STA. TO STA.

F.A. RTE.	SECTION	COUNTY	TOTAL SHEETS	SHEET NO.
VAR	12-00517-00-S1	CHAMPAIGN	22	20
CONTRACT NO. 9J482				
FED. ROAD DIST. NO. ILLINOIS FED. AID PROJECT AID				





0' 20' 40'  
SCALE: 1"=40'-0"

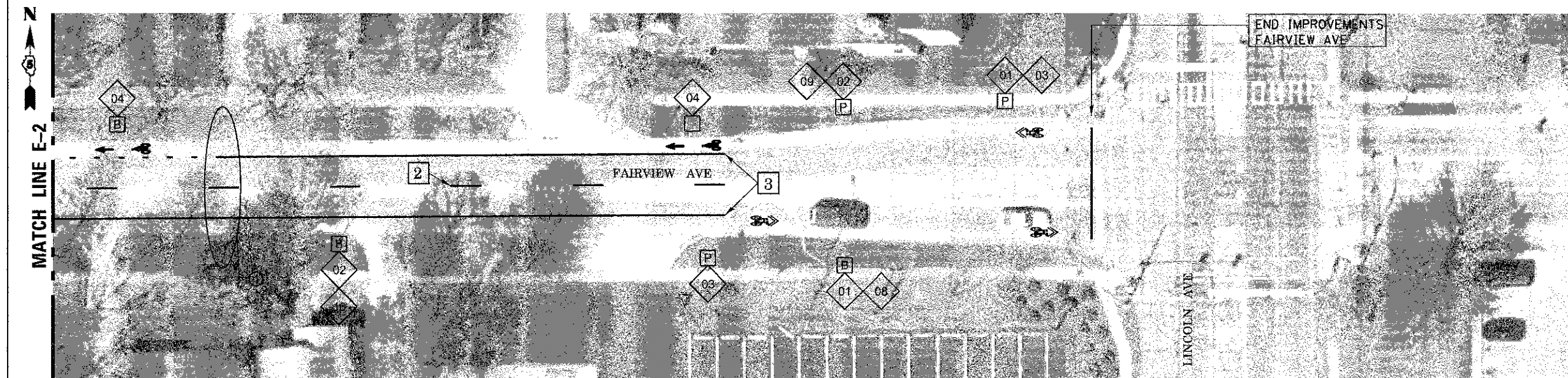

SIGN LEGEND					
01	BIKE ROUTE (D11-1)		06	BIKE ROUTE ARROW RIGHT (M6-1)	
02	BIKE LANE (R3-17)		07	BIKE ROUTE ARROW LEFT (M6-1)	
03	MAY USE FULL LANE (R4-11)		08	BIKE ROUTE ARROW AHEAD (M6-3)	
04	NO PARKING THIS SIDE OF STREET		09	AHEAD (R3-17aP)	
05	BIKE ROUTE ARROW LEFT AND RIGHT (M6-4)		10	ENDS (R3-17bP)	

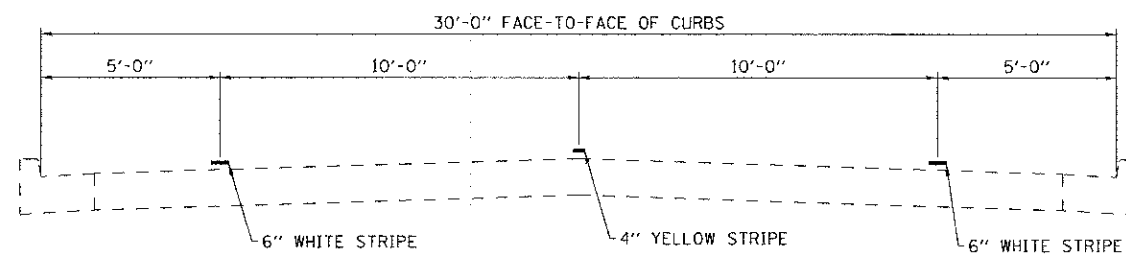

① TYPICAL FOR PAVEMENT MARKING FAIRVIEW AVENUE  
GOODWIN AVENUE TO LINCOLN AVENUE

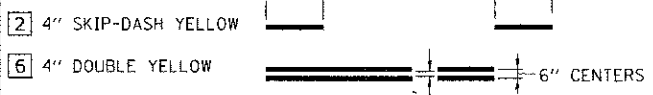

PAVEMENT MARKING LEGEND	
1	4" WHITE
2	4" YELLOW
3	6" WHITE
4	12" YELLOW
5	12" WHITE
6	4" DOUBLE YELLOW

PROJECT ENGINEER: J. D. LEONARDI  
 PROJECT MANAGER: J. D. LEONARDI  
 DESIGNER: J. D. LEONARDI  
 CHECKER: J. D. LEONARDI  
 DATE: 01/29/13



USER NAME: jhas	DESIGNED: JMS	REVISED: -
ESCA PROJECT NO. 1020.04	DRAWN: RJT/HAS	REVISED: -
PLDT SCALE: 0.0033' / IN.	CHECKED: JMS	REVISED: -
PLDT DATE: 1/30/2013	DATE: 01/29/13	REVISED: -

STATE OF ILLINOIS  
DEPARTMENT OF TRANSPORTATION

FAIRVIEW AVENUE PAVEMENT MARKING		F.A. RTE.	SECTION	COUNTY	TOTAL SHEETS	SHEET NO.
SCALE AS SHOWN	SHEET NO. 2 OF 2 SHEETS	VAR	12-00517-00-ST	CHAMPAIGN	22	22
STA. TO STA.		FED. ROAD DIST. NO. ILLINOIS FED. AID PROJECT AID				

CONTRACT NO. 91482