

**THOUVENOT, WADE & MOERCHEN, INC.**  
ENGINEERS • SURVEYORS • PLANNERS



**CORPORATE OFFICE**  
4940 OLD COLLINGSVILLE RD.  
SWANSEA, ILLINOIS 62226  
TEL (618) 624-4488  
FAX (618) 624-6888  
corp@twm-inc.com

**WATERLOO OFFICE**  
113 SOUTH MAIN STREET  
WATERLOO, ILLINOIS 62298  
TEL (618) 939-5050  
FAX (618) 939-3938  
waterloo@twm-inc.com

**EDWARDSVILLE OFFICE**  
1015B CENTURY DRIVE  
EDWARDSVILLE, ILLINOIS 62025  
TEL (618) 656-4040  
FAX (618) 656-4343  
edwardsville@twm-inc.com

**ST. CHARLES OFFICE**  
400 N. 5TH STREET, SUITE 101  
ST. CHARLES, MISSOURI 63301  
TEL (636) 724-8300  
FAX (636) 724-8304  
stlouis@twm-inc.com

PROFESSIONAL REGISTRATIONS	LICENSE NO.
ILLINOIS PROFESSIONAL DESIGN FIRM	184-031220
PROFESSIONAL ENGINEERING CORP.	02-033370
PROFESSIONAL STRUCTURAL ENGR. CORP.	01-005202
ILLINOIS PROF. LAND SURVEYING CORP.	048-000028
MISSOURI PROFESSIONAL ENGR. CORP.	MO 001528
MISSOURI LAND SURVEYING CORP.	MO 000346

SEAL

Signature: \_\_\_\_\_  
Signature Date: \_\_\_\_\_  
Expiration Date: \_\_\_\_\_

**STATEMENT OF RESPONSIBILITY**

I hereby confirm that the document herein to be authorized by my seal is restricted to this sheet, and I hereby disclaim any responsibility for all other drawings, specifications, estimates, reports or other documents or instruments relating to or intended to be utilized for any other part of the architectural, engineering or survey project.

**TITLE:** SHILOH STATION ROAD  
DETOUR PLAN  
10-00011-01-PV AND 11-00011-02-PV

**PROJECT:** SHILOH STATION ROAD  
RECONSTRUCTION - PHASE 1 AND 2  
VILLAGE OF SHILOH  
ST. CLAIR COUNTY, ILLINOIS

REV.	DATE	DESCRIPTION

DRAWN BY: NTS	SHEET
DESIGNED BY: NTS	10
CHECKED BY:	OF 24 SHEETS
APPROVED BY:	PROJECT DESCRIPTION
PROJECT NUMBER: T01100602	
<input type="checkbox"/> ISSUED FOR REVIEW	<input checked="" type="checkbox"/> ISSUED FOR BIDDING
<input type="checkbox"/> ISSUED FOR CONSTR.	<input type="checkbox"/> RECORD DRAWING

- LEGEND**
- STAGE 1 ROAD CONSTRUCTION
  - ▬ STAGE 1 CONSTRUCTION DETOUR ROUTES
1. TYPE III BARRIERS W/ ROAD CLOSED SIGN - PLACE PER BLR 22
  2. TYPE III BARRIERS W/ ROAD CLOSED TO THROUGH TRAFFIC ON EACH STAGGERED BARRIER - PLACE PER BLR 22
  3. ROAD CLOSED AHEAD
  4. ROAD CLOSED 500 FEET
  5. NOT USED
  6. DETOUR W/ RIGHT ARROW (COMBINED)
  7. DETOUR W/ LEFT ARROW (COMBINED)
  8. NOT USED
  9. "SHILOH STATION ROAD" SIGN
  10. "LEBANON AVE" SIGN
  11. INDIVIDUAL LEFT ARROW
  12. INDIVIDUAL RIGHT ARROW
  13. DETOUR AHEAD
  14. INDIVIDUAL STRAIGHT ARROW

- NOTES:**
1. CONTRACTOR SHALL USE STANDARD SIZES FOR SIGNING ON THIS PROJECT REQUIRED FOR URBAN LOCAL ROADS AS SPECIFIED BY IDOT HIGHWAY STANDARDS AND THE MUTCD. THE CONTRACTOR SHALL PROVIDE TRAFFIC CONTROL ACCORDING TO APPLICABLE HIGHWAY STANDARDS INCLUDED IN THESE PLANS FOR ROAD CLOSURES AT ALL INTERSECTIONS. FOR SHEET CLARITY AND TO MINIMIZE REDUNDANCY, NOT ALL TRAFFIC CONTROL ITEMS AS REQUIRED BY HIGHWAY STANDARDS ARE SHOWN ON THESE STAGING SHEETS. TRAFFIC CONTROL ITEMS NOT SHOWN SHOULD BE INSTALLED PER THE APPLICABLE HIGHWAY STANDARDS INCLUDED IN THESE PLANS.
  2. CONTRACTOR TO PROVIDE CONTINUOUS ACCESS TO ALL RESIDENTS AND BUSINESSES ALONG SHILOH STATION ROAD THROUGHOUT THE DURATION OF THE PROJECT

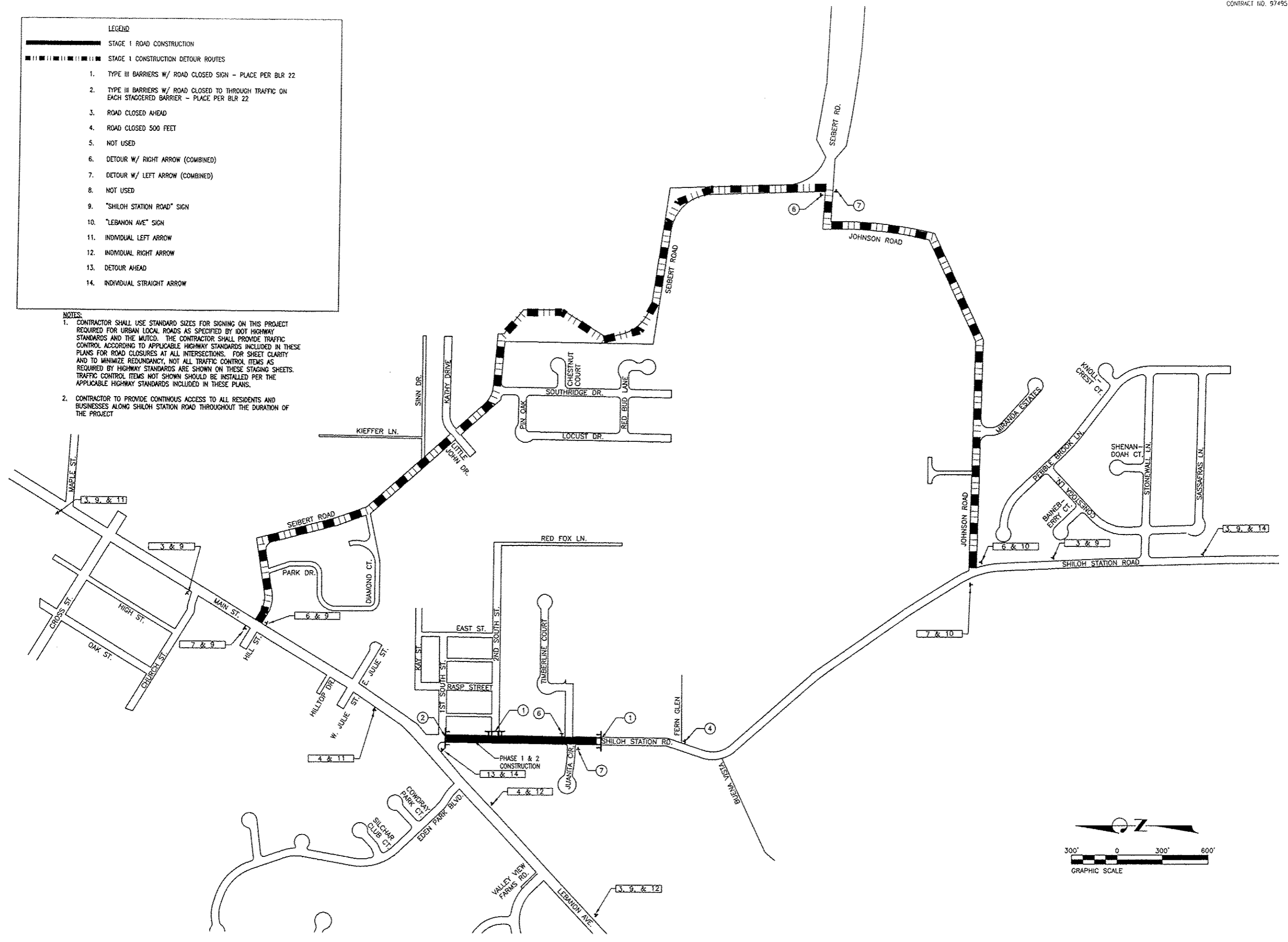

P:\100602\1-C400 - DWG\1-2-TR\Drawings\Phase 1 & 2 Combined\100602 - Phase 1 - Plan and Profiles, Detour, Drainage, Erection, Marking and Signage, Wpding.dwg