

P:\100602\1-1-0400 - DWG\4.2-TR(Drawings)\Phase 1 & 2 Combined\100602 - Phase 1 - Plan and Profiles, Detour, Drainage, Erosion, Delineation, Marking and Signage, Worshiping.dwg

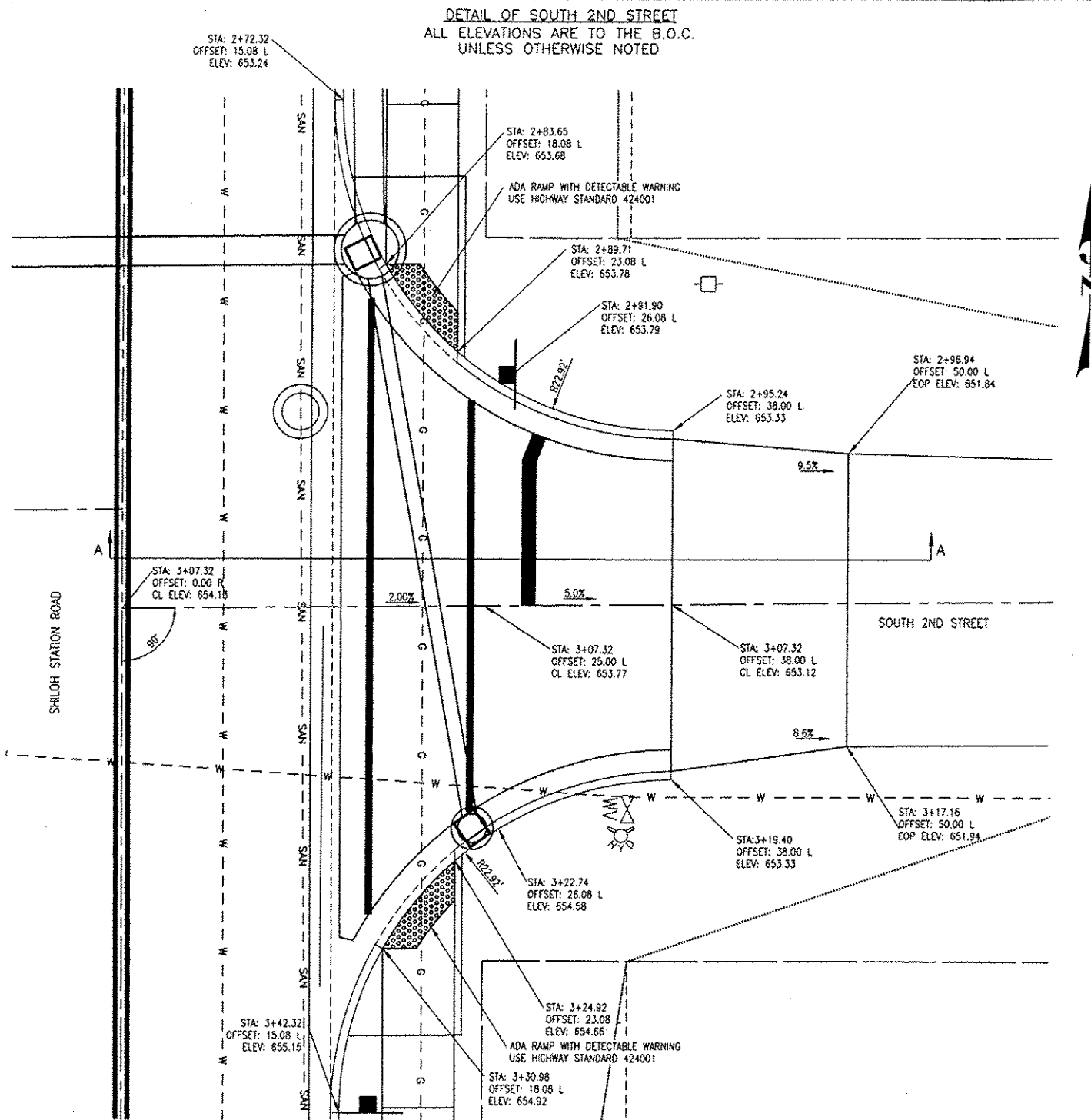

DETAIL OF SOUTH 2ND STREET
ALL ELEVATIONS ARE TO THE B.O.C.
UNLESS OTHERWISE NOTED

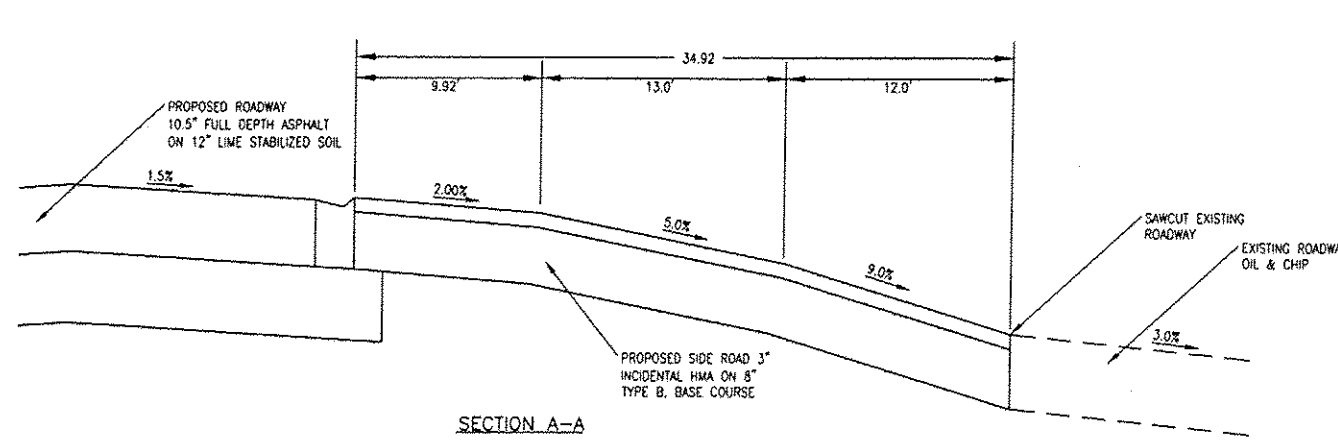

SECTION A-A

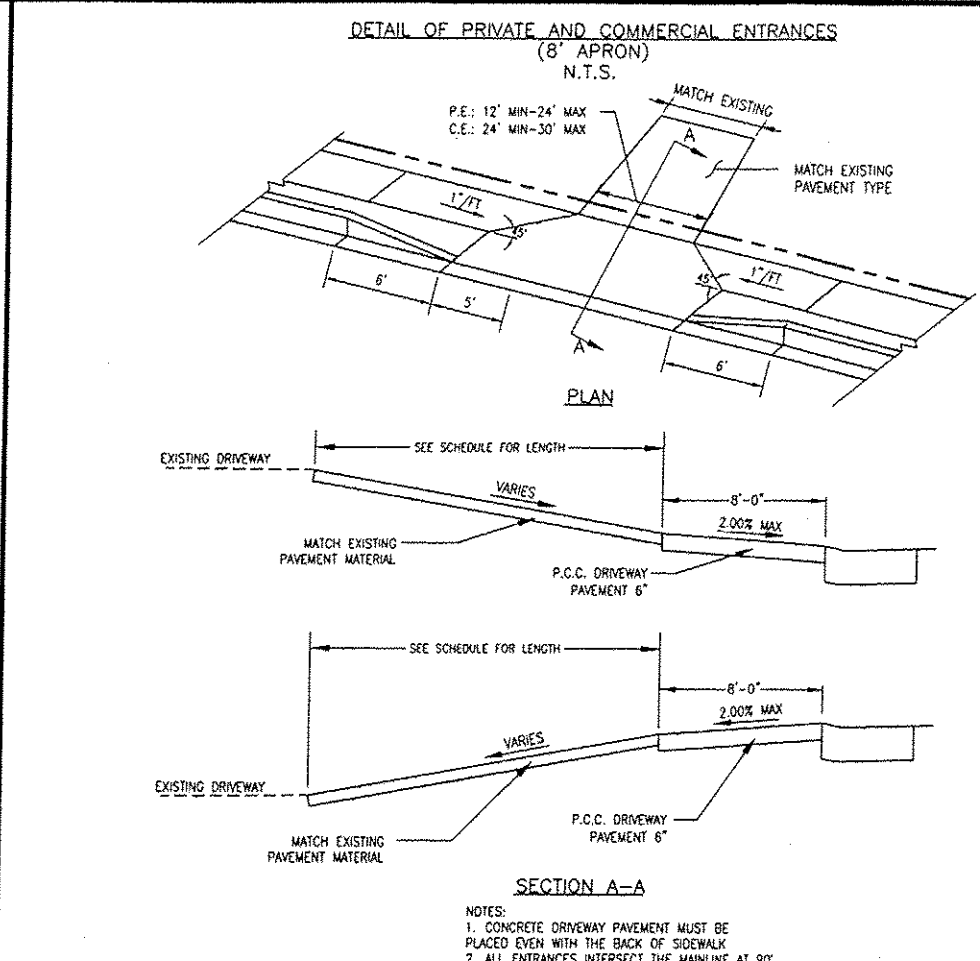

DETAIL OF PRIVATE AND COMMERCIAL ENTRANCES
(8' APRON)
N.T.S.

SECTION A-A

NOTES:
1. CONCRETE DRIVEWAY PAVEMENT MUST BE PLACED EVEN WITH THE BACK OF SIDEWALK
2. ALL ENTRANCES INTERSECT THE MAINLINE AT 90°

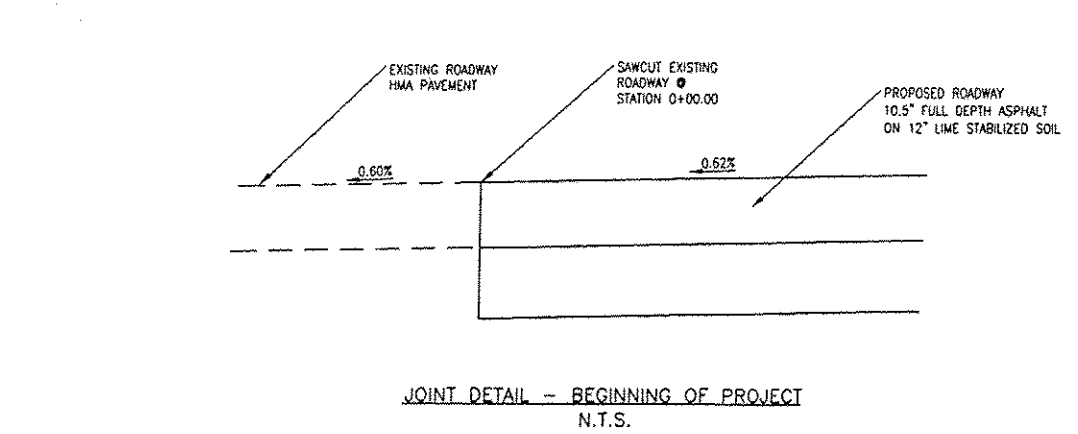

JOINT DETAIL - BEGINNING OF PROJECT
N.T.S.

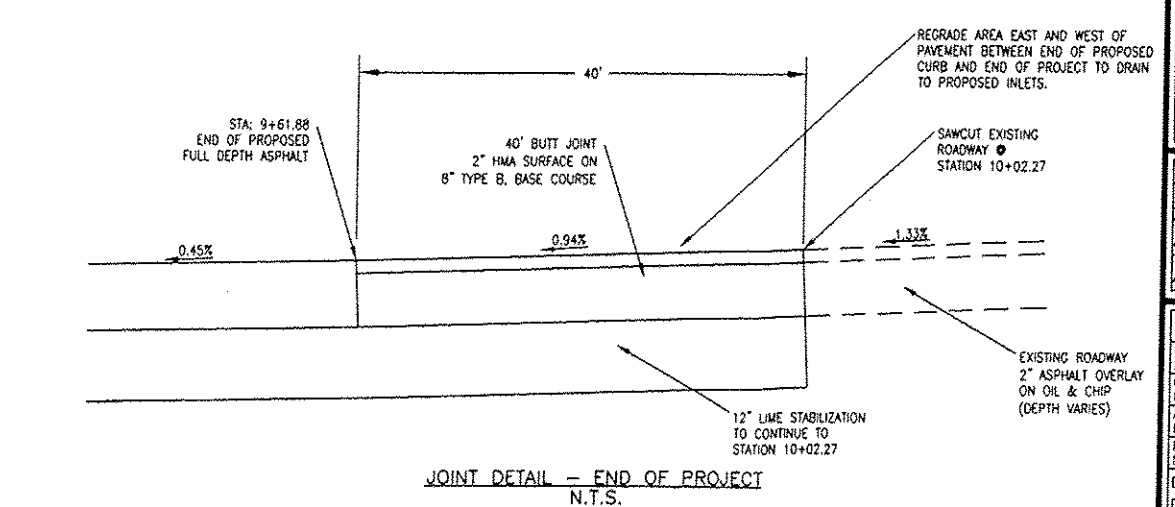

JOINT DETAIL - END OF PROJECT
N.T.S.

CONTRACT NO. 97495

THOUVENOT,
WADE &
MOERCHEN, INC.
ENGINEERS • SURVEYORS • PLANNERS



- CORPORATE OFFICE
4940 OLD COLLINSVILLE RD.
SWANSEA, ILLINOIS 62226
TEL (618) 624-4488
FAX (618) 624-6688
corp@twm-inc.com
- WATERLOO OFFICE
113 SOUTH MAIN STREET
WATERLOO, ILLINOIS 62298
TEL (618) 939-5050
FAX (618) 939-3938
waterloo@twm-inc.com
- EDWARDSVILLE OFFICE
1015B CENTURY DRIVE
EDWARDSVILLE, ILLINOIS 62025
TEL (618) 656-4040
FAX (618) 656-4343
edwardsville@twm-inc.com
- ST. CHARLES OFFICE
400 N. 5TH STREET, SUITE 101
ST. CHARLES, MISSOURI 63301
TEL (636) 724-8300
FAX (636) 724-8304
stlouis@twm-inc.com

PROFESSIONAL REGISTRATIONS	LICENSE NO.
ILLINOIS PROFESSIONAL DESIGN FIRM	181-001220
PROFESSIONAL ENGINEERING CORP.	62-035370
PROFESSIONAL STRUCTURAL ENGR. CORP.	81-005202
ILLINOIS PROF. LAND SURVEYING CORP.	048-000029
MISSOURI PROFESSIONAL ENGR. CORP.	MC 001528
MISSOURI LAND SURVEYING CORP.	MC 000346

Signature: _____
Signature Date: _____
Expiration Date: _____

STATEMENT OF RESPONSIBILITY
I hereby confirm that the document herein to be authenticated by my seal is restricted to this sheet, and I hereby disclaim any responsibility for all other drawings, specifications, estimates, reports or other documents or instruments relating to or intended to be utilized for any other part of the architectural, engineering or survey project.

TITLE: SHILOH STATION ROAD INTERSECTION AND MISC. DETAILS 10-00011-01-PV AND 11-00011-02-PV
PROJECT: SHILOH STATION ROAD RECONSTRUCTION - PHASE 1 AND 2 VILLAGE OF SHILOH ST. CLAIR COUNTY, ILLINOIS

REV	DATE	DESCRIPTION

DRAWN BY: NTS	SHEET
DESIGNED BY: NTS	17
CHECKED BY:	OF 24 SHEETS
APPROVED BY:	PROJECT DESCRIPTION
PROJECT NUMBER: T01100602	
<input type="checkbox"/> ISSUED FOR REVIEW	<input checked="" type="checkbox"/> ISSUED FOR BIDDING
<input type="checkbox"/> ISSUED FOR CONSTR.	<input type="checkbox"/> RECORD DRAWING