

0' 25' 50' 100'  
 HALF SIZE SCALE: 1" = 100'  
 FULL SIZE SCALE: 1" = 50'

**LEGEND**

- EXISTING PAVEMENT
- EXISTING STORM SEWER
- EXISTING DITCH
- EXISTING STORM INLET/MAHOLE
- PROPOSED PAVED DITCH
- PROPOSED SEEDING/MULCHING
- PROPOSED EROSION CONTROL BLANKET
- PROPOSED SILT FENCE

**NOTES**

1. CONTRACTOR SHALL CLEAN OUT EXISTING PIPE UNDER TAXIWAY AT COMPLETION OF DITCH CONSTRUCTION PRIOR TO ESTABLISHING NATURAL WATER FLOW THROUGH NEW DITCH (INCIDENTAL).

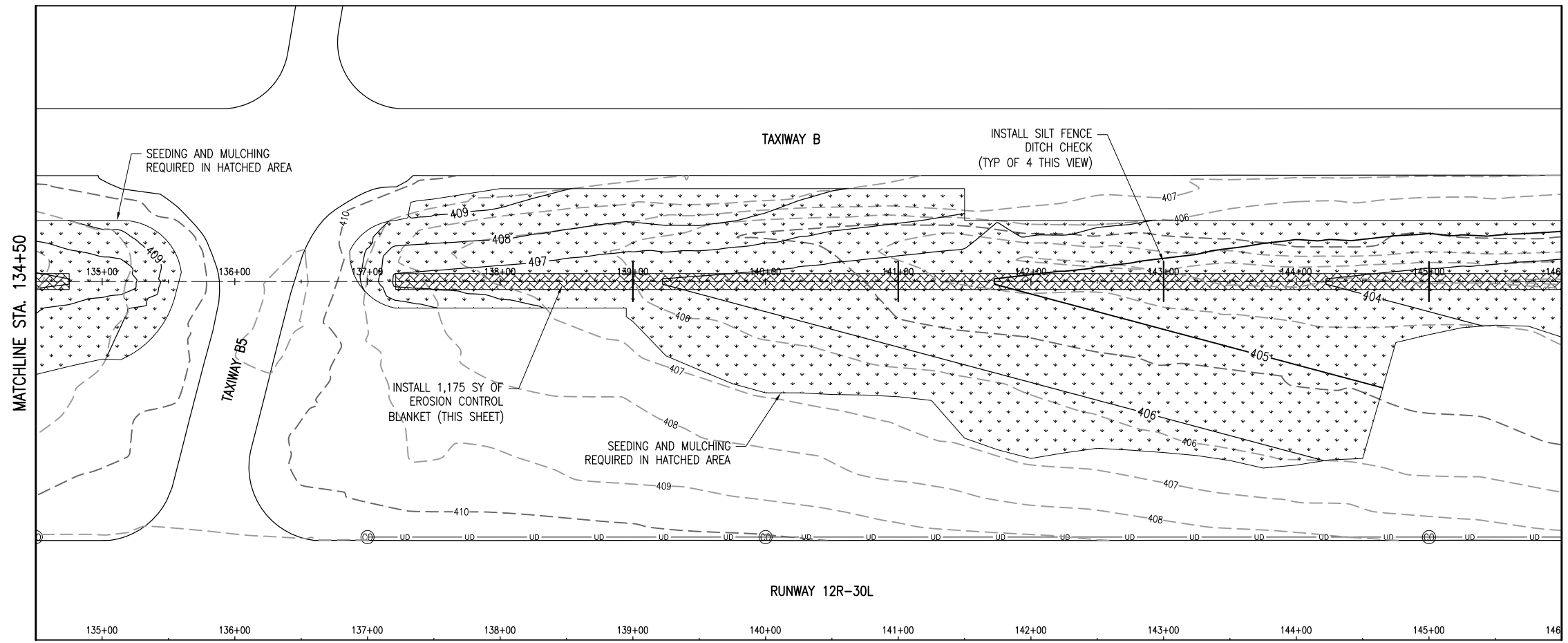
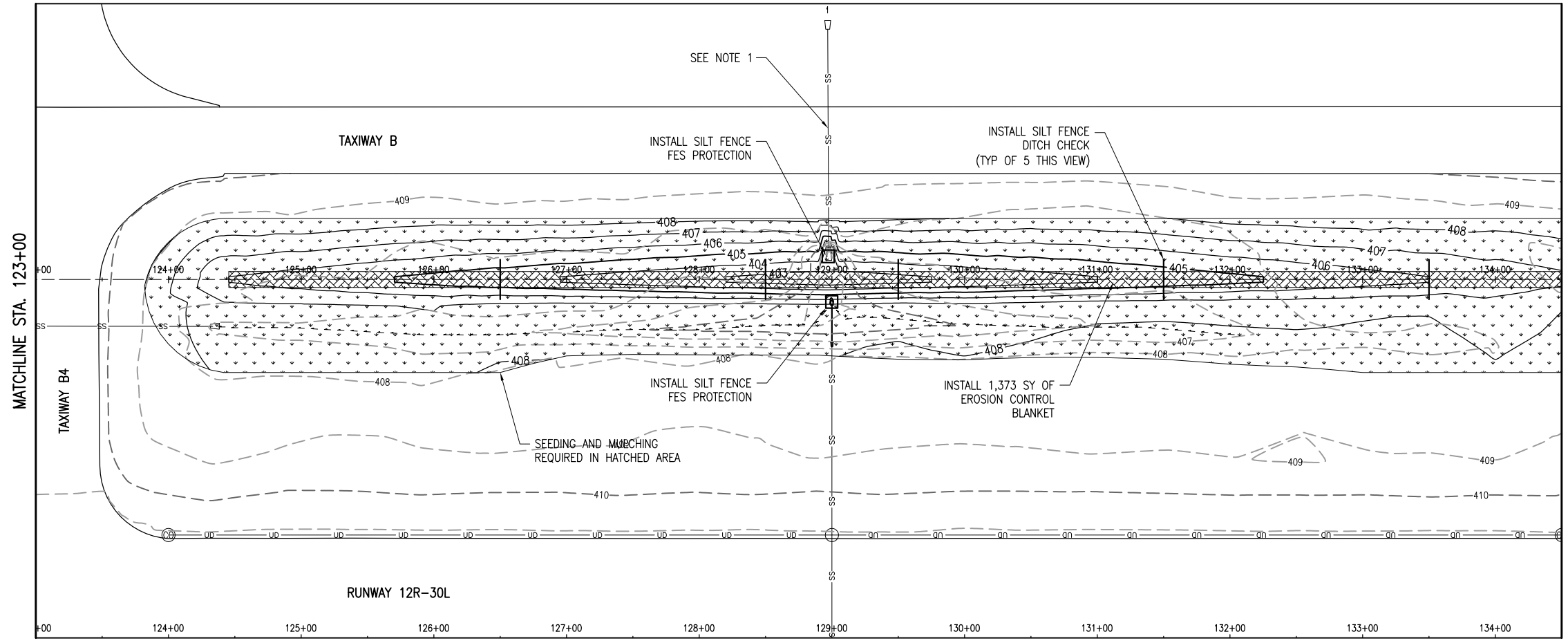

REVISION	DATE

**SAINT LOUIS DOWNTOWN AIRPORT**  
 A Division of Bi-State Development Agency  
 BLOCK GRANT PROJ.: 3-17-0039-B29  
 ILL PROJ.: CPS-4210

Hanson Project No.	11A0190	
Filename	C-181-SWP.dwg	
Scale	1" = 50'H, 1" = 5'V	
Date	03/08/13	
LAYOUT	DRAW	01/28/13
DRAWN	MLH	01/29/13
REVIEWED	BSS	03/08/13

**HANSON**  
 © Copyright Hanson Professional Services Inc. 2013  
 Hanson Professional Services Inc.  
 1525 South Main Street  
 Springfield, Illinois 62703-2886

GRADE DITCH PARALLEL TO MAIN RUNWAY  
 SWPPP STA. 123+00 TO STA. 146+00

MAR 11, 2013 12:42 PM HARR01115  
 pw:\sps-sv306\hanson\Documents\11A0190\11A0190D\CAD\Airport\Sheet\C-181-SWP