

K:\Denville\12042010\Draw\Sheets

T HANGAR TAXILANE

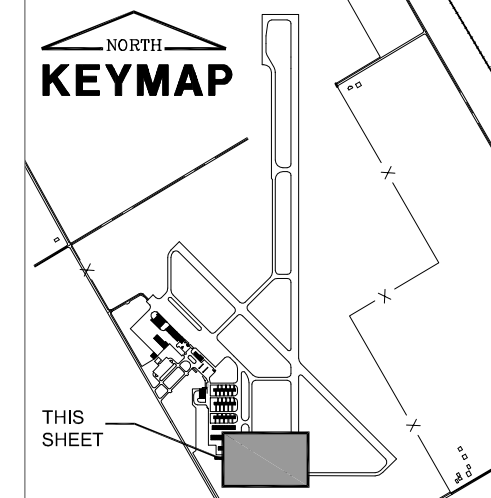
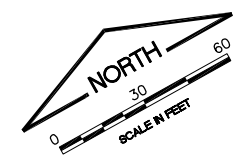
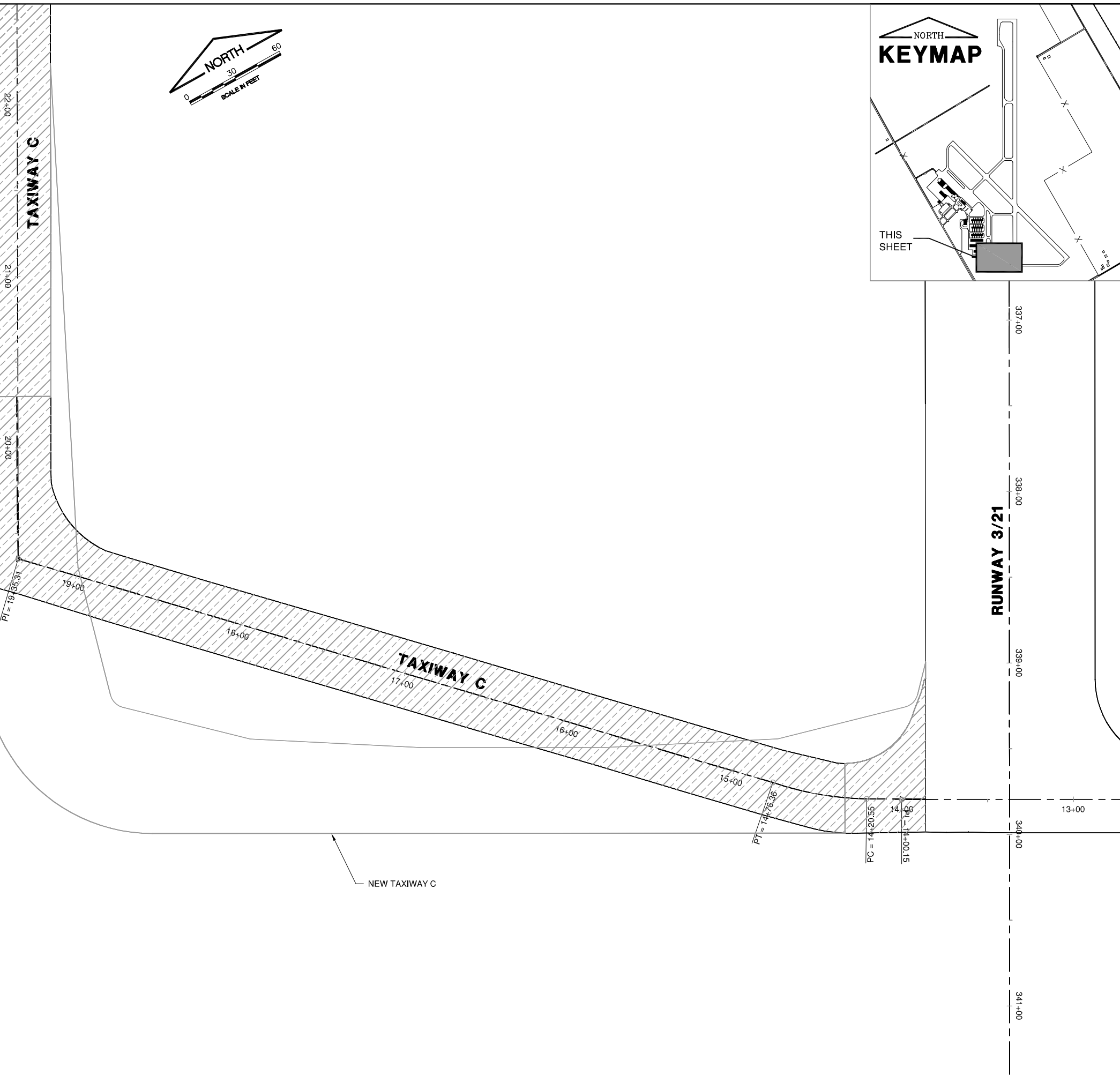

FILE: EXISTPVM.dwg
 UPDATE BY: Andrew Bodine
 PLOT DATE: 3/6/2013 2:22 PM

DNVBase_StatePlane
 C=SPAL-EXIST
 BASE: PROP.GEO
 C=SPAL
 Keymap

VE048

REVISIONS		
NUMBER	BY	DATE

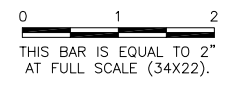

VERMILION REGIONAL AIRPORT
 VERMILION REGIONAL AIRPORT AUTHORITY
 DANVILLE, ILLINOIS

RELOCATE TAXIWAY C AND WIDEN FILLETS
 EXISTING PAVEMENT STRUCTURES

© Copyright CMT, Inc.

CMT
 CRAWFORD, MURPHY & TILLY, INC.
 CONSULTING ENGINEERS
 License No. 184-000613

DESIGN BY:	AJB
DRAWN BY:	CMT
CHECKED BY:	CET
APPROVED BY:	CET
DATE:	MARCH 1, 2013
JOB No:	120420100
IL. PROJ. NO. DNV-4229 SBG PROJ. NO. 3-17-0032-B14	
SHEET	07 OF 27 SHEETS

NOTES:
 THE INFORMATION ON THIS SHEET HAS BEEN
 OBTAINED FROM AVAILABLE RECORD DRAWINGS.

LEGEND

- 3" BITUMINOUS SURFACE COURSE (OVERLAY) (401)
- 2" BITUMINOUS SURFACE COURSE (401)
- 7" BITUMINOUS BASE COURSE (201)
- 7" GRANULAR SUBBASE (154)

NEW TAXIWAY C