

054

F.A.P. RTE.	SECTION	COUNTY	TOTAL SHEETS	SHEET NO.
586A	(59-1.31) RS-4	MADISON	21	1
		ILLINOIS	CONTRACT NO. 76L16	

STATE OF ILLINOIS
DEPARTMENT OF TRANSPORTATION

**PROPOSED
HIGHWAY PLANS**

FAP ROUTE 586A (IL 162)
SECTION (59-1,31)RS-4
PROJECT NHPP-4DAM(009)
3P RESURFACING
MADISON COUNTY

C-98-164-18

FOR INDEX OF SHEETS, SEE SHEET NO. 2



BEGIN PROJECT
STA.374+60.18
LAT: 38.73834
LONG: -89.95539

END PROJECT
STA.485+46.15
LAT: 38.7331
LONG: -89.91625

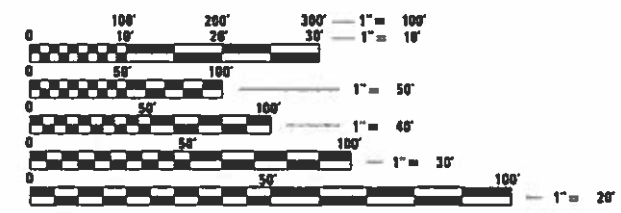

FULL SIZE PLANS HAVE BEEN PREPARED USING STANDARD ENGINEERING SCALES. REDUCED SIZED PLANS WILL NOT CONFORM TO STANDARD SCALES. IN MAKING MEASUREMENTS ON REDUCED PLANS, THE ABOVE SCALES MAY BE USED.

J.U.L.E.
JOINT UTILITY LOCATION INFORMATION FOR EXCAVATION
1-800-892-0123
OR 811

PROJECT ENGINEER: HERVE GELIN 618-346-3179
PROJECT MANAGER: BILLIE OWEN 618-346-3209

CONTRACT NO. 76L16

GROSS / NET LENGTH = 2.100 MILE

NOT TO SCALE

STATE OF ILLINOIS
DEPARTMENT OF TRANSPORTATION

SUBMITTED Jan 18 2019
Keith Roberts
REGIONAL ENGINEER

March 22 2019
[Signature]
ENGINEER OF DESIGN AND ENVIRONMENT

March 20 2019
[Signature]
DIRECTOR OF HIGHWAYS PROJECT IMPLEMENTATION

**PRINTED BY THE AUTHORITY
OF THE STATE OF ILLINOIS**

INDEX OF SHEETS

- 1 COVER SHEET
- 2 INDEX OF SHEETS, HIGHWAY STANDARDS, GENERAL NOTES, COMMITMENTS, AND ADT
- 3-6 SUMMARY OF QUANTITIES
- 7-9 TYPICAL SECTIONS
- 10-11 SCHEDULES
- 12-15 PLAN VIEW
- 16-19 PAVEMENT MARKING DETAILS
- 20 DETAILS, CENTERLINE CONTROL POINT
- 21 CURB RAMP DETAILS

GENERAL NOTES

1 ILLINOIS STATE LAW REQUIRES A 48-HOUR NOTICE BE GIVEN TO ALL UTILITIES WITHIN THE PROJECT AREA BEFORE DIGGING. FIELD MARKING OF FACILITIES MAY BE OBTAINED BY CONTACTING J.U.L.I.E. OR FOR NON-MEMBERS, THE UTILITY COMPANY DIRECTLY. AGENCIES KNOWN TO HAVE FACILITIES WITHIN THE PROJECT AREA ARE AS FOLLOWS:

- *AMEREN ILLINOIS
- *AT&T ILLINOIS
- *CHARTER COMMUNICATIONS, INC.
- *VILLAGE OF GLEN CARBON
- *ILLINOIS AMERICAN WATER COMPANY
- *VILLAGE OF MARYVILLE
- *SOUTHWESTERN ELECTRIC COOPERATIVE, INC.
- *CITY OF TROY

MEMBERS OF J.U.L.I.E. CALL TOLL FREE (800) 892-0123 OR 811 AND ARE INDICATED BY *. NON- J.U.L.I.E. MEMBERS MUST BE NOTIFIED INDIVIDUALLY.

- 2 THE THICKNESS OF HOT-MIX ASPHALT SURFACE MIXTURES SHOWN ON THE PLANS IS THE NOMINAL THICKNESS. DEVIATIONS MAY OCCUR DUE TO IRREGULARITIES IN THE EXISTING SURFACE OR BASE ON WHICH THE BITUMINOUS MIXTURE IS PLACED.
- 3 NO OVERNIGHT LANE CLOSURES WILL BE PERMITTED.
- 4 THE DEPARTMENT STRONGLY ENCOURAGES THE PRIME CONTRACTOR AND THEIR APPROVED SUB-CONTRACTORS TO HIRE MINORITY, WOMEN AND DISADVANTAGED INDIVIDUALS FROM ITS FEDERALLY FUNDED HIGHWAY CONSTRUCTION CAREERS TRAINING PROGRAM (HCCTP) TO HELP MEET WORKFORCE AND TRAINEE GOALS. THIS PROGRAM IS TRAINING MINORITIES, WOMEN AND DISADVANTAGED INDIVIDUALS IN HIGHWAY CONSTRUCTION-RELATED SKILLS, E.G., MATH FOR THE TRADES, JOB READINESS, TECHNICAL SKILLS COURSEWORK (CARPENTRY, CONCRETE FLATWORK, BLUEPRINT READING, SITE PLANS, SITE WORK, TOOLS USE, ETC.) AND OSHA 10 HOUR CERTIFICATION, TO PREPARE THEM FOR A CAREER IN THE HIGHWAY CONSTRUCTION TRADES. GRADUATES ARE WELL-TRAINED AND READY TO BECOME PRODUCTIVE ENTRY-LEVEL CONSTRUCTION WORKERS. CONTACT THE DISTRICT 8 EEO OFFICE AT 618-346-3360 AND/OR THE HCCTP COORDINATOR AT 618-874-6528 TO LEARN MORE ABOUT THE PROGRAM AND FOR ASSISTANCE IN MEETING WORKFORCE AND TRAINEE GOALS.
- 5 THE RECONSTRUCTION OF EXISTING SIDEWALK, PAVEMENT, CURB AND GUTTER, AS WELL AS OTHER MISCELLANEOUS ITEMS MAY REQUIRE EXCAVATIONS, EMBANKMENT, OR AGGREGATE FILL MATERIAL DURING LEVELING TO ESTABLISH THE SUBGRADE OR FORMING FOR THE VARIOUS RECONSTRUCTION OPERATIONS FOR THIS PROJECT. ANY EARTHWORK, EMBANKMENT, AGGREGATE, OR SEEDING AND MULCH REQUIRED FOR SIDEWALK RECONSTRUCTION SHALL BE INCLUDED IN THE COST OF PORTLAND CEMENT CONCRETE SIDEWALK 4 INCH.
- 6 ANY DOWEL BARS USED TO TIE PROPOSED CONCRETE CURB, TYPE B INTO EXISTING CURB SHALL BE INCLUDED IN THE COST OF CONCRETE CURB, TYPE B.

STANDARDS

- 000001-07
- 001001-02
- 001006
- 406201-01
- 424001-11
- 442201-03
- 606001-07
- 606006-04
- 701201-05
- 701301-04
- 701306-04
- 701311-03
- 701336-07
- 701502-09
- 701602-10
- 701801-06
- 701901-08
- 780001-05
- 781001-04
- 782001-01

COMMITMENTS

NONE

MIXTURE USE	POLY SURFACE	LEVEL BINDER	INCIDENTAL
AC/PG	SBS PG 76-22	PG 64-22	PG 64-22
RAP% (MAX)	SEE SPECIAL PROVISION	SEE SPECIAL PROVISION	SEE SPECIAL PROVISION
DESIGN AIR VOIDS	4.0% @ Ndes=70	4.0% @ Ndes=70	4.0% @ Ndes=70
MIX COMPOSITION (GRADATION)	IL 9.5	IL 9.5 FG	IL 9.5
FRICTION AGG	MIXTURE "D"	MIXTURE "C"	MIXTURE "C"
QUALITY MGMT PROGRAM	QCP	QCP	QC/QA

MIXTURE USE	SHOULDERS ≥ 2.25"	SHOULDERS < 2.25"	PATCHING
AC/PG	PG 64-22	PG 64-22	PG 64-22
RAP% (MAX)	SEE SPECIAL PROVISION	SEE SPECIAL PROVISION	SEE SPECIAL PROVISION
DESIGN AIR VOIDS	4.0% @Ndes=30	4.0% @Ndes=30	4.0% @Ndes=70
MIX COMPOSITION (GRADATION)	IL 19.0L	IL 9.5L	IL 19.0
FRICTION AGG			MIXTURE "B"
QUALITY MGMT PROGRAM	QC/QA	QC/QA	QC/QA

PLAN QUANTITIES FOR HOT-MIX ASPHALT ITEMS ARE CALCULATED USING A UNIT WEIGHT OF 112 LB/SQ YD/IN (59.8 KG/SQ M/25MM THICKNESS).

ADT

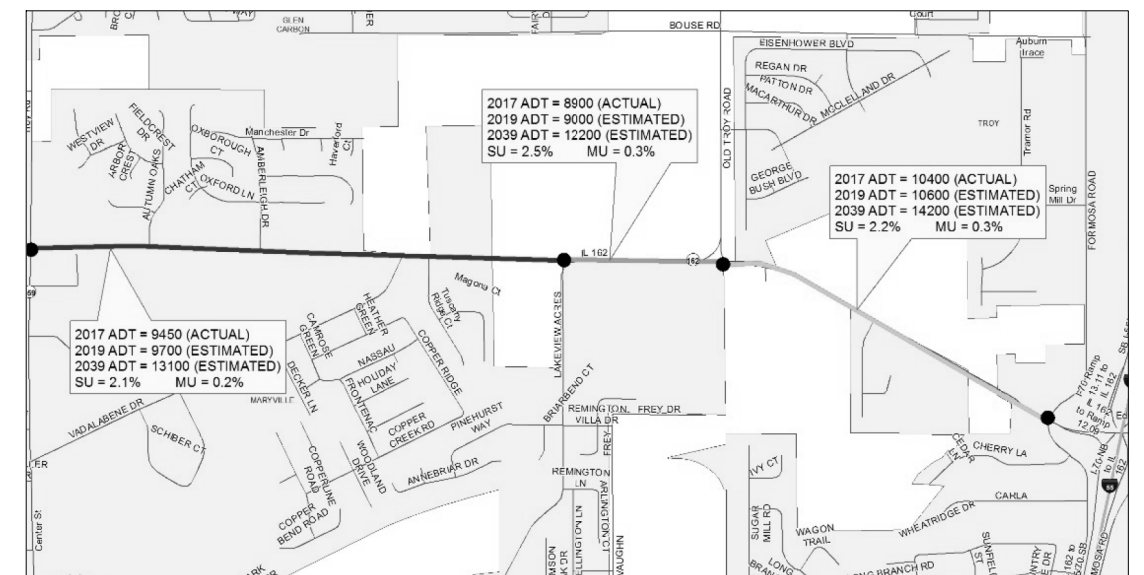

MODEL: Default
FILE: \\nashc\p\11108\B&E\IND\TEC\Illinois\gov\PIWDOT\Documents\101\0\16\CAD\data\CAD\here\0876116.spl-h-gencor.dgn

USER NAME = challandeske	DESIGNED -	REVISED -
	DRAWN -	REVISED -
PLOT SCALE = 100.0000 ' / in.	CHECKED -	REVISED -
PLOT DATE = 1/18/2019	DATE -	REVISED -

**STATE OF ILLINOIS
DEPARTMENT OF TRANSPORTATION**

**INDEX OF SHEETS, HIGHWAY STANDARDS,
GENERAL NOTES, COMMITMENTS, AND ADT**

SCALE: SHEET OF SHEETS STA. TO STA.

F.A.P. RTE.	SECTION	COUNTY	TOTAL SHEETS	SHEET NO.
586A	(59-1,31)RS-4	MADISON	21	2
CONTRACT NO. 76L16				
ILLINOIS FED. AID PROJECT				

CODE NO.	ITEM	UNIT	TOTAL QUANTITY	CONSTRUCTION CODE	
				ROADWAY	SAFETY
				0005 URBAN	0021 URBAN
40600295	POLYMERIZED BITUMINOUS MATERIALS (TACK COAT)	POUND	23026	23026	
40600637	LEVELING BINDER (MACHINE METHOD), IL-9.5FG, N70	TON	2333	2333	
40600982	HOT-MIX ASPHALT SURFACE REMOVAL - BUTT JOINT	SQ YD	1439	1439	
40600990	TEMPORARY RAMP	SQ YD	449	449	
40603540	POLYMERIZED HOT-MIX ASPHALT SURFACE COURSE, MIX "D", N70	TON	2799	2799	
40800050	INCIDENTAL HOT-MIX ASPHALT SURFACING	TON	55	55	
42400100	PORTLAND CEMENT CONCRETE SIDEWALK 4 INCH	SQ FT	94		94
42400800	DETECTABLE WARNINGS	SQ FT	17		17
44000155	HOT-MIX ASPHALT SURFACE REMOVAL, 1 1/2"	SQ YD	29050	29050	
44000160	HOT-MIX ASPHALT SURFACE REMOVAL, 2 3/4"	SQ YD	5293	5293	
44000300	CURB REMOVAL	FOOT	12		12
44000400	GUTTER REMOVAL	FOOT	1289	1289	
44000600	SIDEWALK REMOVAL	SQ FT	232		232
44201815	CLASS D PATCHES, TYPE II, 14 INCH	SQ YD	353	353	

URBAN
80% FED
20% STATE

MODEL: Default
 FILE: \\nashpc-pix1\llob\BID\NTEC\Illinois\gov\PIV\DOT\Documents\1\DOT_Offices\BID\refct 8\Projects\0876L16\CAD\data\CAD\sheet\0876L16.sht-500.dgn

USER NAME = challandeske	DESIGNED -	REVISED -
PLOT SCALE = 100.0000 ' / in.	DRAWN -	REVISED -
PLOT DATE = 1/18/2019	CHECKED -	REVISED -
	DATE -	REVISED -

**STATE OF ILLINOIS
DEPARTMENT OF TRANSPORTATION**

SUMMARY OF QUANTITIES

SCALE: SHEET 1 OF 4 SHEETS STA. TO STA.

F.A.P. RTE.	SECTION	COUNTY	TOTAL SHEETS	SHEET NO.
586A	(59-1,31)RS-4	MADISON	21	3
CONTRACT NO. 76L16			ILLINOIS FED. AID PROJECT	

CODE NO.	ITEM	UNIT	TOTAL QUANTITY	CONSTRUCTION CODE	
				ROADWAY	SAFETY
				0005 URBAN	0021 URBAN
44201819	CLASS D PATCHES, TYPE III, 14 INCH	SQ YD	57	57	
44201821	CLASS D PATCHES, TYPE IV, 14 INCH	SQ YD	80	80	
44300200	STRIP REFLECTIVE CRACK CONTROL TREATMENT	FOOT	21340	21340	
48102100	AGGREGATE WEDGE SHOULDER, TYPE B	TON	532	532	
48203100	HOT-MIX ASPHALT SHOULDERS	TON	182	182	
60500060	REMOVING INLETS	EACH	2	2	
60600095	CLASS S1 CONCRETE (OUTLET)	CU YD	15	15	
60600605	CONCRETE CURB, TYPE B	FOOT	11		11
60602800	CONCRETE GUTTER, TYPE B	FOOT	1339	1339	
67000400	ENGINEER'S FIELD OFFICE, TYPE A	CAL MO	3	3	
67100100	MOBILIZATION	L SUM	1	1	
70100450	TRAFFIC CONTROL AND PROTECTION, STANDARD 701201	L SUM	1	0.5	0.5
70100460	TRAFFIC CONTROL AND PROTECTION, STANDARD 701306	L SUM	1	1	
70100600	TRAFFIC CONTROL AND PROTECTION, STANDARD 701336	L SUM	1	1	

URBAN
80% FED
20% STATE

MODEL: Default
 FILE: \\nas01c.pva\illinois\BID\NTEC\Illinois\gov\PIV\DOT\Documents\DOT Office\BID\refct 8\Projects\0876L16\CAD\data\CAD\sheet\0876L16.rft-500.dgn

USER NAME = challandeske	DESIGNED -	REVISED -
PLOT SCALE = 100.0000' / in.	DRAWN -	REVISED -
PLOT DATE = 1/18/2019	CHECKED -	REVISED -
	DATE -	REVISED -

**STATE OF ILLINOIS
DEPARTMENT OF TRANSPORTATION**

SUMMARY OF QUANTITIES

SCALE: SHEET 2 OF 4 SHEETS STA. TO STA.

F.A.P. RTE.	SECTION	COUNTY	TOTAL SHEETS	SHEET NO.
586A	(59-1,31)RS-4	MADISON	21	4
			CONTRACT NO. 76L16	
		ILLINOIS	FED. AID PROJECT	

URBAN
80% FED
20% STATE

CONSTRUCTION CODE

CODE NO.	ITEM	UNIT	TOTAL QUANTITY	CONSTRUCTION CODE	
				ROADWAY	SAFETY
				0005 URBAN	0021 URBAN
70102622	TRAFFIC CONTROL AND PROTECTION, STANDARD 701502	L SUM	1	1	
70102632	TRAFFIC CONTROL AND PROTECTION, STANDARD 701602	L SUM	1	1	
70102640	TRAFFIC CONTROL AND PROTECTION, STANDARD 701801	L SUM	1		1
70300100	SHORT TERM PAVEMENT MARKING	FOOT	6273	6273	
70300150	SHORT TERM PAVEMENT MARKING REMOVAL	SQ FT	697	697	
70300210	TEMPORARY PAVEMENT MARKING LETTERS AND SYMBOLS	SQ FT	94	94	
70300220	TEMPORARY PAVEMENT MARKING - LINE 4"	FOOT	52628	52628	
70300260	TEMPORARY PAVEMENT MARKING - LINE 12"	FOOT	360	360	
* 78000100	THERMOPLASTIC PAVEMENT MARKING - LETTERS AND SYMBOLS	SQ FT	94	94	
* 78000200	THERMOPLASTIC PAVEMENT MARKING - LINE 4"	FOOT	52628	52628	
* 78000600	THERMOPLASTIC PAVEMENT MARKING - LINE 12"	FOOT	377	360	17
* 78100100	RAISED REFLECTIVE PAVEMENT MARKER	EACH	216	216	
* 78200020	CURB REFLECTORS	EACH	133	133	
78300200	RAISED REFLECTIVE PAVEMENT MARKER REMOVAL	EACH	216	216	

* SPECIALTY ITEM

USER NAME = challandeske	DESIGNED -	REVISED -
	DRAWN -	REVISED -
PLOT SCALE = 100,0000 ' / in.	CHECKED -	REVISED -
PLOT DATE = 1/18/2019	DATE -	REVISED -

STATE OF ILLINOIS
DEPARTMENT OF TRANSPORTATION

SUMMARY OF QUANTITIES

SCALE: SHEET 3 OF 4 SHEETS STA. TO STA.

F.A.P. RTE.	SECTION	COUNTY	TOTAL SHEETS	SHEET NO.
586A	(59-1,31)RS-4	MADISON	21	5
CONTRACT NO. 76L16			ILLINOIS FED. AID PROJECT	

MODEL: Default
FILE NAME: P:\1108\B&E\BIDDING\Illinois\gov\PIWDOT\Documents\1108\DOT Office\1108\16\16\CAD\data\CAD\sheet\0876L16.rpt-500.dgn

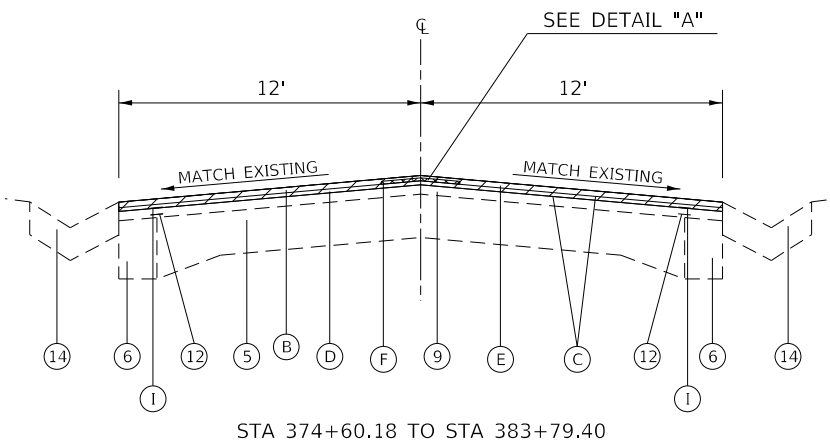

STA 374+60.18 TO STA 383+79.40

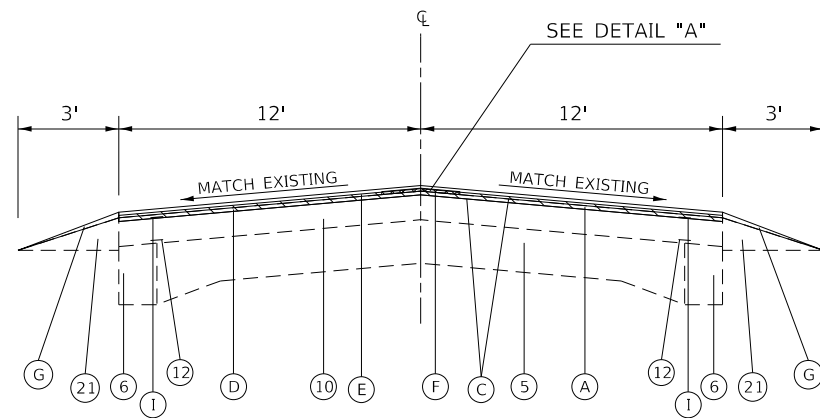

STA 383+79.40 TO STA 387+05.23
 STA 401+11.65 TO STA 424+68.74
 STA 435+87.76 TO STA 450+99.73
 STA 458+35.00 TO STA 477+77.80

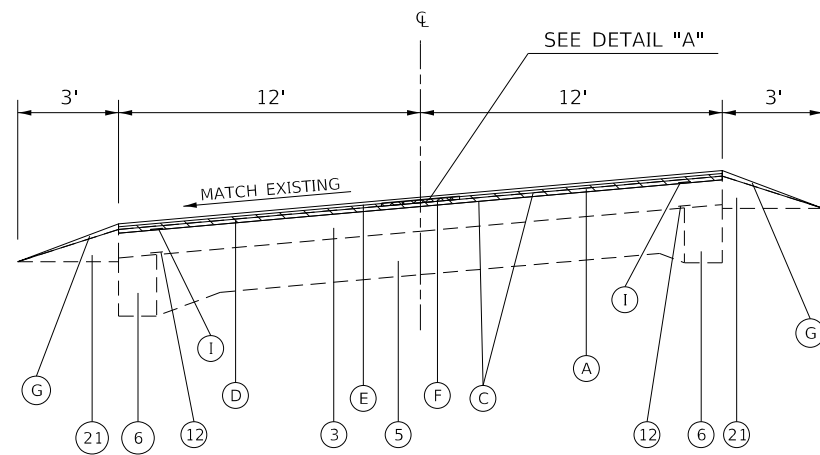

STA 450+99.73 TO STA 458+35.00

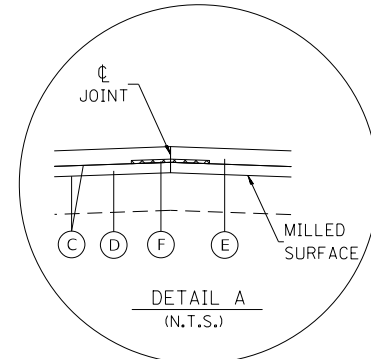

••DETAIL "A" SHALL BE APPLIED
 ALONG THE CENTERLINE OF PAVEMENT
 OR ALONG THE MEDIAN SIDE OF PAVEMENT

LEGEND

- 1 EXISTING AGGREGATE BASE COURSE, TYPE A, VARIABLE DEPTH
- 2 EXISTING MODIFIED SOIL, 12"
- 3 EXISTING AGGREGATE BASE COURSE, ±4"
- 4 EXISTING CONCRETE PAVEMENT, VARIES 10"-13"
- 5 EXISTING PAVEMENT, 9"-7"-9"
- 6 EXISTING HOT-MIX ASPHALT WIDENING ± 9"
- 7 EXISTING HOT-MIX ASPHALT SURFACE, 11"
- 8 EXISTING HOT-MIX ASPHALT OVERLAY ± 2½"
- 9 EXISTING HOT-MIX ASPHALT OVERLAY ± 4¼"
- 10 EXISTING HOT-MIX ASPHALT OVERLAY ± 5¾"
- 11 EXISTING HOT-MIX ASPHALT BINDER, 17½"
- 12 EXISTING STRIP REFLECTIVE CRACK CONTROL
- 13 EXISTING CONCRETE MEDIAN SURFACE, 4"
- 14 EXISTING TYPE B GUTTER
- 15 EXISTING PCC CURB AND GUTTER, TYPE B-6.24
- 16 EXISTING PCC CURB AND GUTTER, TYPE B-6.12
- 17 EXISTING PCC CURB AND GUTTER, TYPE B-9.24
- 18 EXISTING PCC CURB AND GUTTER, TYPE M-2.12
- 19 EXISTING AGGREGATE SHOULDERS, TYPE A, 6"
- 20 EXISTING AGGREGATE SHOULDERS, TYPE B, 11"
- 21 EXISTING AGGREGATE WEDGE SHOULDER
- 22 EXISTING HOT-MIX ASPHALT SHOULDER, 8"
- 23 EXISTING HOT-MIX ASPHALT SHOULDERS, 11"
- A PROPOSED HOT-MIX ASPHALT SURFACE REMOVAL, 1½"
- B PROPOSED HOT-MIX ASPHALT SURFACE REMOVAL, 2¾"
- C PROPOSED TACK COAT
- D PROPOSED HOT-MIX ASPHALT BINDER, 1¼"
- E PROPOSED HOT-MIX ASPHALT SURFACE COURSE, 1½"
- F PROPOSED LONGITUDINAL JOINT SEALANT
- G PROPOSED AGGREGATE WEDGE
- H PROPOSED HOT-MIX ASPHALT SHOULDERS, 2¾"
- I PROPOSED STRIP REFLECTIVE CRACK CONTROL

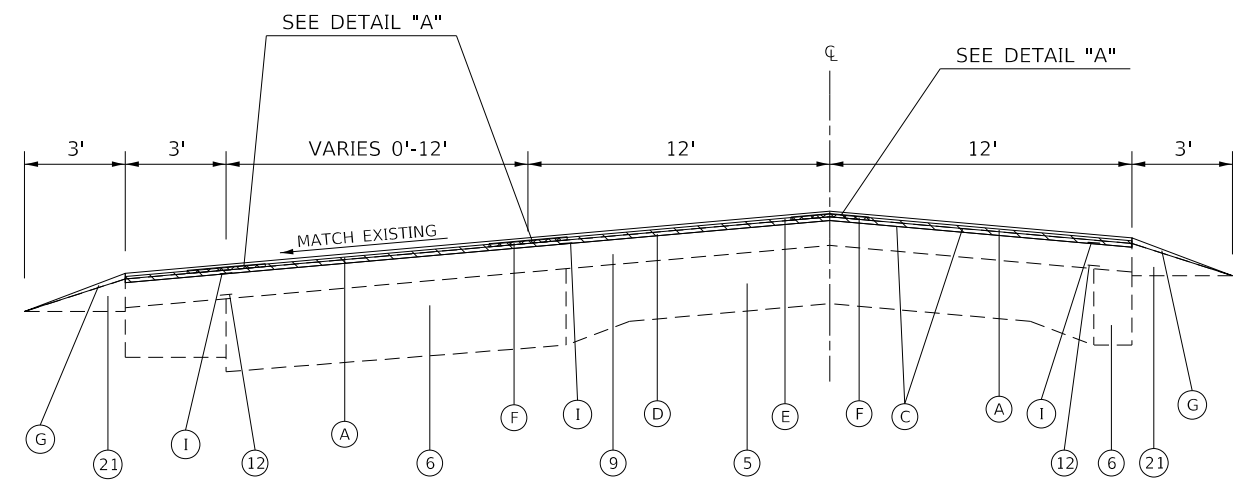

STA 387+05.23 TO STA 401+11.65

MODEL: Default
 FILE: \\mhc\p\1108\B&E\ID\TCE\Illinois\gov\PIV\DOT\Documents\1\DOT_Offices\Director\B\Projects\0876116\CAD\data\CAD\sheet\0876116\sheet\typical.dgn

USER NAME = challandeske	DESIGNED -	REVISED -
	DRAWN -	REVISED -
PLOT SCALE = 100.0000' / in.	CHECKED -	REVISED -
PLOT DATE = 1/18/2019	DATE -	REVISED -

STATE OF ILLINOIS
 DEPARTMENT OF TRANSPORTATION

TYPICAL SECTIONS

SCALE: SHEET 1 OF 3 SHEETS STA. TO STA.

F.A.P. RTE.	SECTION	COUNTY	TOTAL SHEETS	SHEET NO.
586A	(59-1,31)RS-4	MADISON	21	7
CONTRACT NO. 76L16				
ILLINOIS FED. AID PROJECT				

LEGEND

- 1 EXISTING AGGREGATE BASE COURSE, TYPE A, VARIABLE DEPTH
- 2 EXISTING MODIFIED SOIL, 12"
- 3 EXISTING AGGREGATE BASE COURSE, ±4"
- 4 EXISTING CONCRETE PAVEMENT, VARIES 10"-13"
- 5 EXISTING PAVEMENT, 9"-7"-9"
- 6 EXISTING HOT-MIX ASPHALT WIDENING ± 9"
- 7 EXISTING HOT-MIX ASPHALT SURFACE, 11"
- 8 EXISTING HOT-MIX ASPHALT OVERLAY ± 2½"
- 9 EXISTING HOT-MIX ASPHALT OVERLAY ± 4¾"
- 10 EXISTING HOT-MIX ASPHALT OVERLAY ± 5¾"
- 11 EXISTING HOT-MIX ASPHALT BINDER, 17½"
- 12 EXISTING STRIP REFLECTIVE CRACK CONTROL
- 13 EXISTING CONCRETE MEDIAN SURFACE, 4"
- 14 EXISTING TYPE B GUTTER
- 15 EXISTING PCC CURB AND GUTTER, TYPE B-6.24
- 16 EXISTING PCC CURB AND GUTTER, TYPE B-6.12
- 17 EXISTING PCC CURB AND GUTTER, TYPE B-9.24
- 18 EXISTING PCC CURB AND GUTTER, TYPE M-2.12
- 19 EXISTING AGGREGATE SHOULDERS, TYPE A, 6"
- 20 EXISTING AGGREGATE SHOULDERS, TYPE B, 11"
- 21 EXISTING AGGREGATE WEDGE SHOULDER
- 22 EXISTING HOT-MIX ASPHALT SHOULDER, 8"
- 23 EXISTING HOT-MIX ASPHALT SHOULDERS, 11"
- A PROPOSED HOT-MIX ASPHALT SURFACE REMOVAL, 1½"
- B PROPOSED HOT-MIX ASPHALT SURFACE REMOVAL, 2¾"
- C PROPOSED TACK COAT
- D PROPOSED HOT-MIX ASPHALT BINDER, 1¼"
- E PROPOSED HOT-MIX ASPHALT SURFACE COURSE, 1½"
- F PROPOSED LONGITUDINAL JOINT SEALANT
- G PROPOSED AGGREGATE WEDGE
- H PROPOSED HOT-MIX ASPHALT SHOULDERS, 2¾"
- I PROPOSED STRIP REFLECTIVE CRACK CONTROL

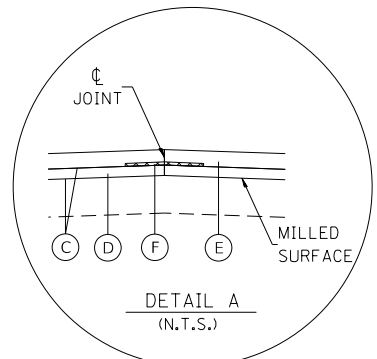

••DETAIL "A" SHALL BE APPLIED ALONG THE CENTERLINE OF PAVEMENT OR ALONG THE MEDIAN SIDE OF PAVEMENT

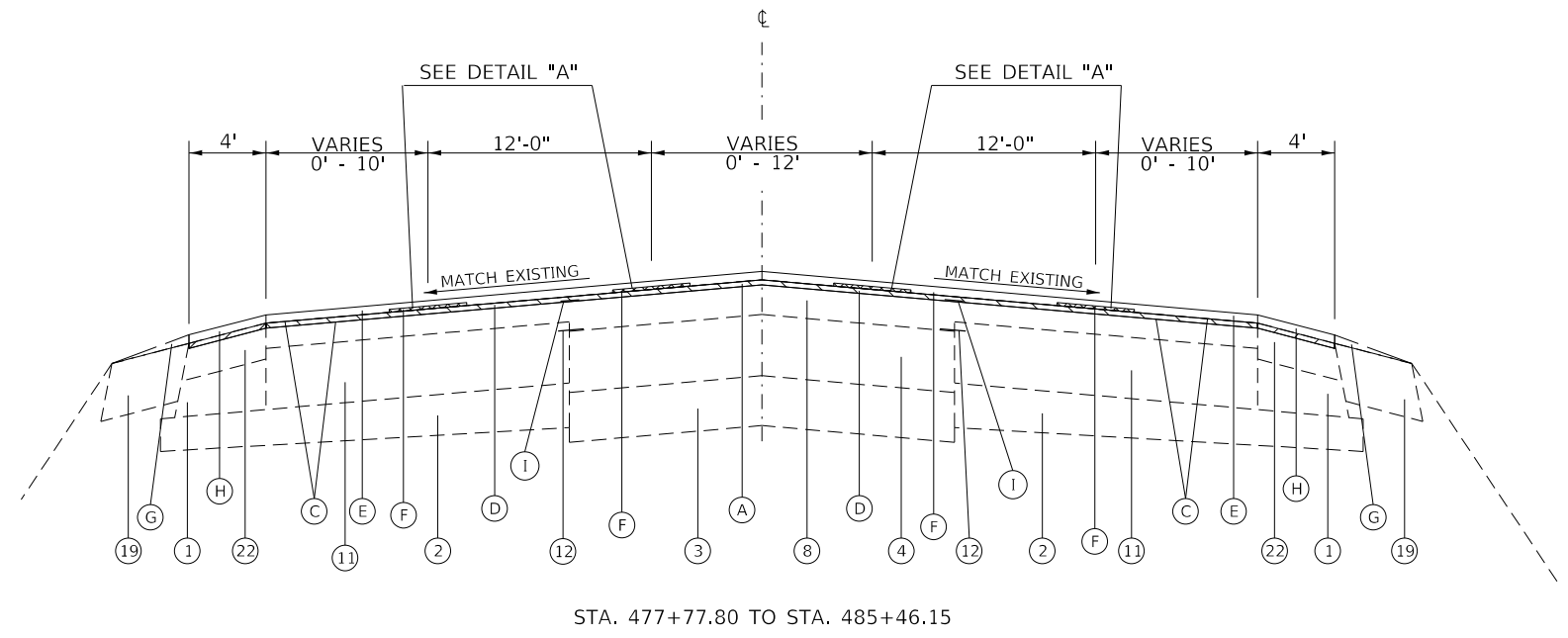
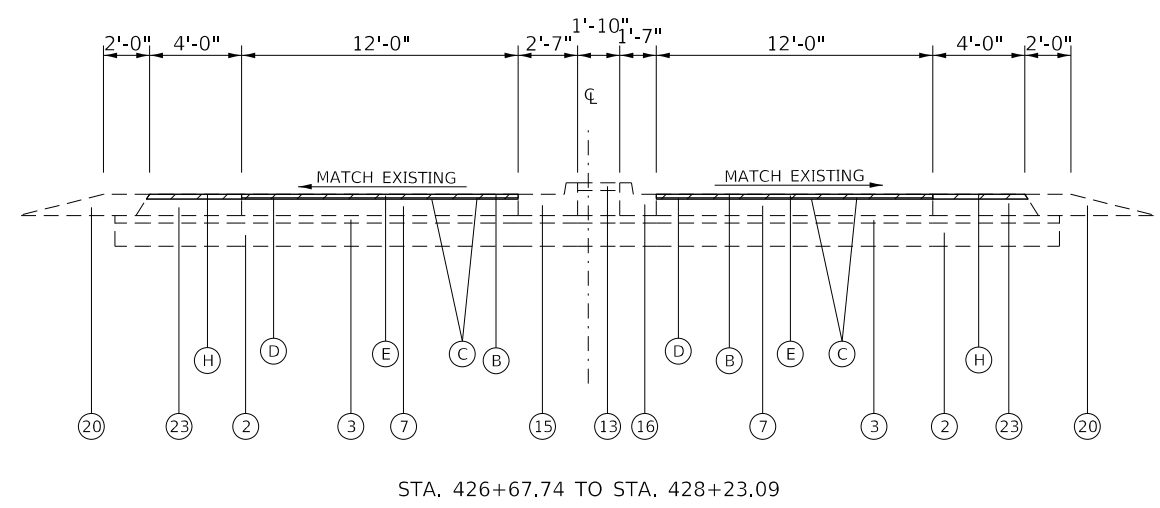
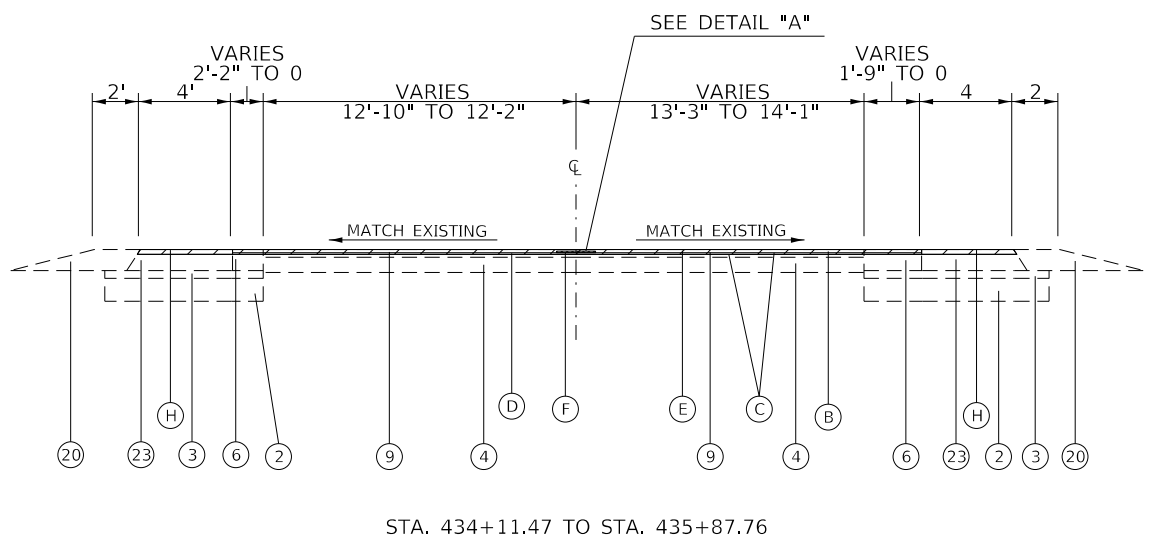
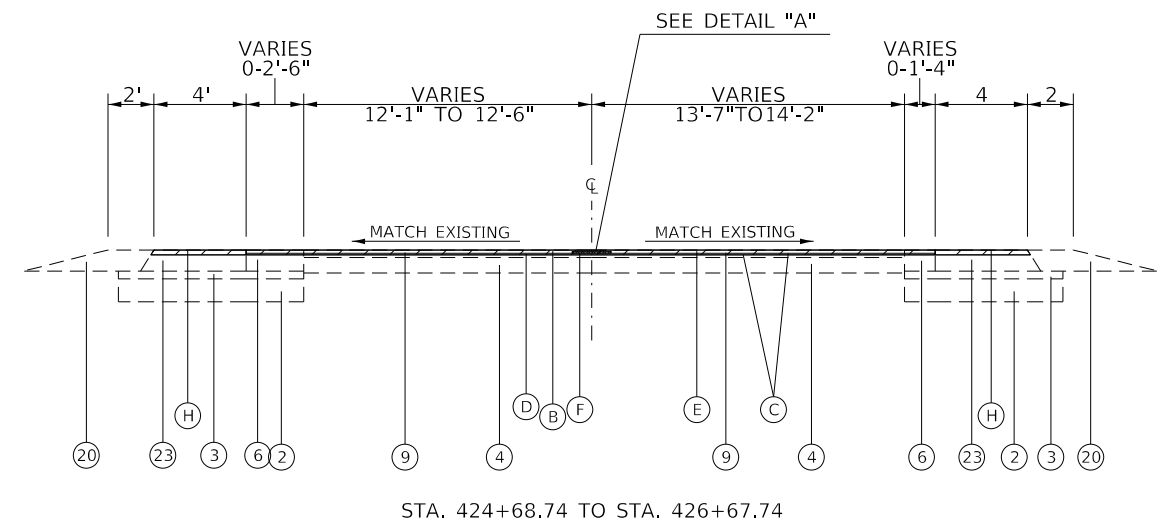

MODEL: Default
 FILE: \\nrc\p\1108\B&E\ID\NTEC\Illinois\gov\p\1108\DOT\Documents\1108\DOT Office\1108\1616\CAD\data\CAD\sheet\0876116.spl\typical.dgn

USER NAME = challandeske	DESIGNED -	REVISED -
	DRAWN -	REVISED -
PLOT SCALE = 100.0000' / in.	CHECKED -	REVISED -
PLOT DATE = 1/18/2019	DATE -	REVISED -

STATE OF ILLINOIS
DEPARTMENT OF TRANSPORTATION

TYPICAL SECTIONS

SCALE: SHEET 2 OF 3 SHEETS STA. TO STA.

F.A.P. RTE.	SECTION	COUNTY	TOTAL SHEETS	SHEET NO.
586A	(59-1,31)RS-4	MADISON	21	8
ILLINOIS FED. AID PROJECT			CONTRACT NO. 76L16	

LEGEND

- 1 EXISTING AGGREGATE BASE COURSE, TYPE A, VARIABLE DEPTH
- 2 EXISTING MODIFIED SOIL, 12"
- 3 EXISTING AGGREGATE BASE COURSE, ±4"
- 4 EXISTING CONCRETE PAVEMENT, VARIES 10"-13"
- 5 EXISTING PAVEMENT, 9"-7"-9"
- 6 EXISTING HOT-MIX ASPHALT WIDENING ± 9"
- 7 EXISTING HOT-MIX ASPHALT SURFACE, 11"
- 8 EXISTING HOT-MIX ASPHALT OVERLAY ± 2½"
- 9 EXISTING HOT-MIX ASPHALT OVERLAY ± 4¼"
- 10 EXISTING HOT-MIX ASPHALT OVERLAY ± 5¾"
- 11 EXISTING HOT-MIX ASPHALT BINDER, 17½"
- 12 EXISTING STRIP REFLECTIVE CRACK CONTROL
- 13 EXISTING CONCRETE MEDIAN SURFACE, 4"
- 14 EXISTING TYPE B GUTTER
- 15 EXISTING PCC CURB AND GUTTER, TYPE B-6.24
- 16 EXISTING PCC CURB AND GUTTER, TYPE B-6.12
- 17 EXISTING PCC CURB AND GUTTER, TYPE B-9.24
- 18 EXISTING PCC CURB AND GUTTER, TYPE M-2.12
- 19 EXISTING AGGREGATE SHOULDERS, TYPE A, 6"
- 20 EXISTING AGGREGATE SHOULDERS, TYPE B, 11"
- 21 EXISTING AGGREGATE WEDGE SHOULDER
- 22 EXISTING HOT-MIX ASPHALT SHOULDER, 8"
- 23 EXISTING HOT-MIX ASPHALT SHOULDERS, 11"
- A PROPOSED HOT-MIX ASPHALT SURFACE REMOVAL, 1½"
- B PROPOSED HOT-MIX ASPHALT SURFACE REMOVAL, 2¾"
- C PROPOSED TACK COAT
- D PROPOSED HOT-MIX ASPHALT BINDER, 1¼"
- E PROPOSED HOT-MIX ASPHALT SURFACE COURSE, 1½"
- F PROPOSED LONGITUDINAL JOINT SEALANT
- G PROPOSED AGGREGATE WEDGE
- H PROPOSED HOT-MIX ASPHALT SHOULDERS, 2¾"
- I PROPOSED STRIP REFLECTIVE CRACK CONTROL

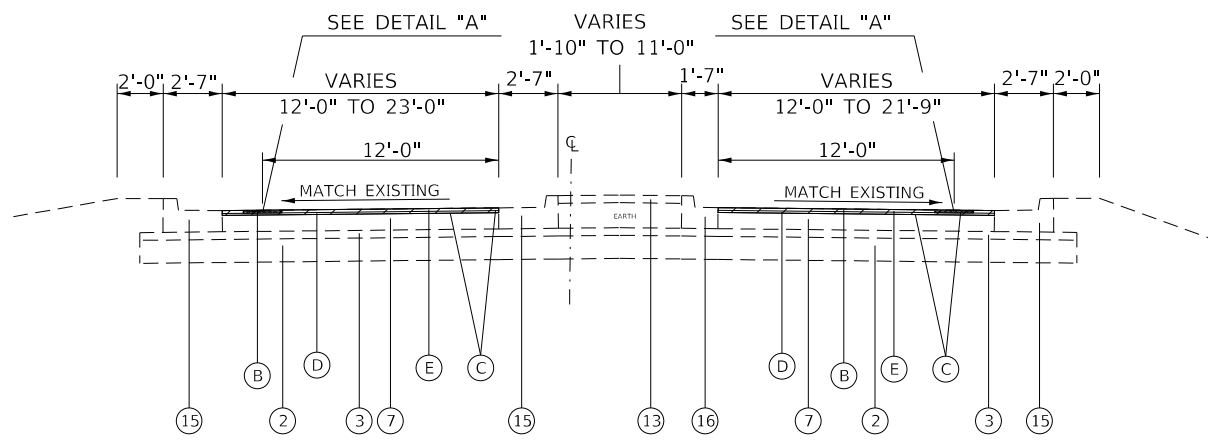
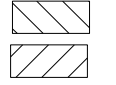

STA. 428+23.09 TO STA. 429+62.25
(SPLITTER ISLAND)

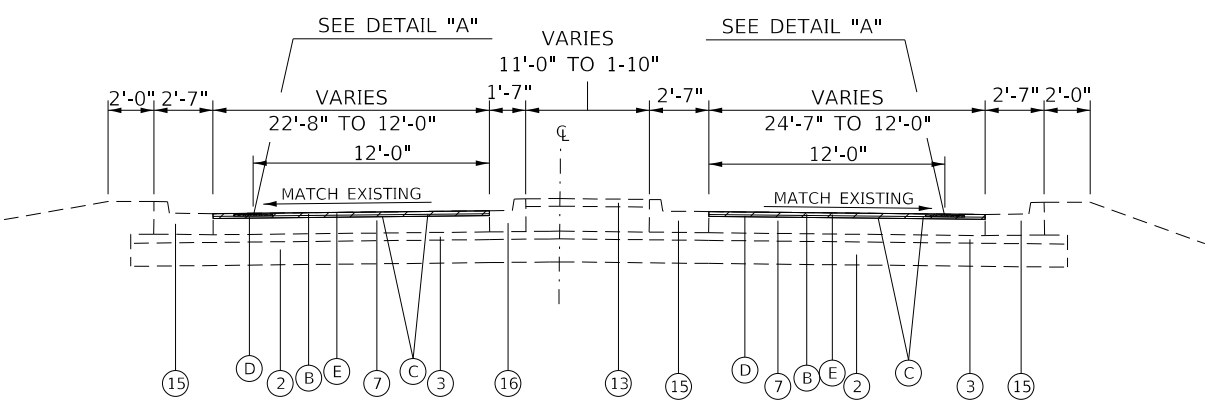

STA. 431+16.69 TO STA. 433+82.38

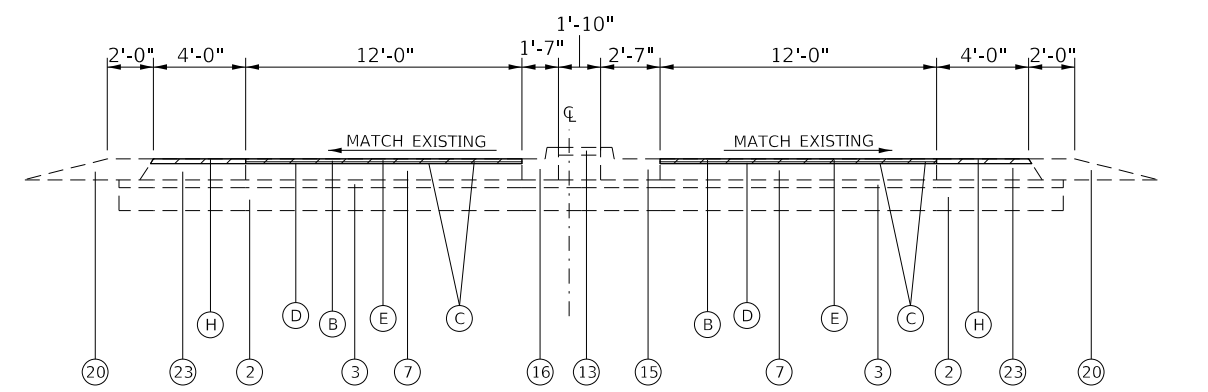

STA. 433+82.38 TO STA. 434+11.47

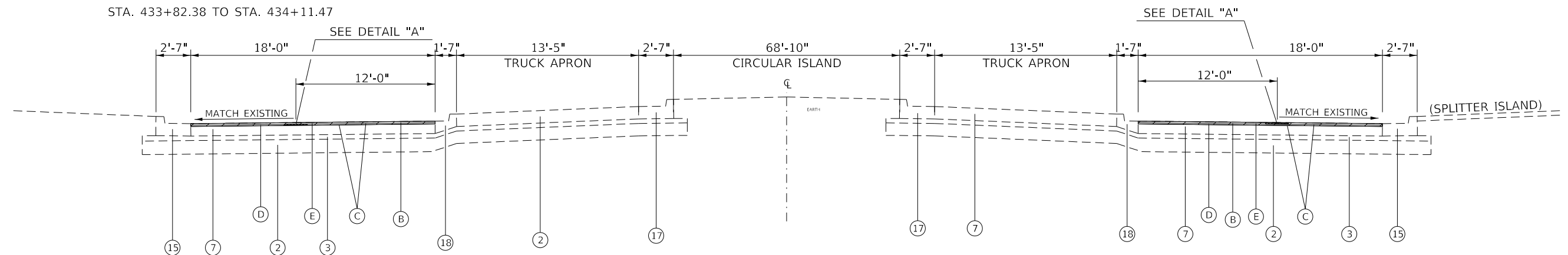

AT STA. 430+32.25 AND 430+46.47 (CENTER OF ROUNDABOUT)
ROUNDABOUT FROM STA. 429+62.25 TO STA. 430+32.25 AND STA. 430+46.47 TO STA. 431+16.69

MODEL: Default
 FILE: \\nrcs-pix01\08\BID\NTEC\Illinois\gov\PIV\DOT\Documents\1\DOT\Office\BID\1616\CAD\data\CAD\sheet\08761_16-sht-typr-cal.dgn

USER NAME = challandeske	DESIGNED -	REVISED -
	DRAWN -	REVISED -
PLOT SCALE = 100.0000' / in.	CHECKED -	REVISED -
PLOT DATE = 1/18/2019	DATE -	REVISED -

STATE OF ILLINOIS
DEPARTMENT OF TRANSPORTATION

TYPICAL SECTIONS

SCALE: SHEET 3 OF 3 SHEETS STA. TO STA.

F.A.P. RTE.	SECTION	COUNTY	TOTAL SHEETS	SHEET NO.
586A	(59-1,31)RS-4	MADISON	21	9
ILLINOIS FED. AID PROJECT			CONTRACT NO. 76L16	

RESURFACING SCHEDULE													
STATION	TO	STATION	COMMENTS	BITUMINOUS MATERIALS (TACK COAT) POUND	LEVEL BINDER (MACHINE METHOD) 1L 9.5FG N70 TON	POLYMERIZED HOT-MIX ASPHALT SURFACE COURSE, MIX "D", N70 TON	HOT-MIX ASPHALT SURFACE REMOVAL, 1 1/2" SQ YD	HOT-MIX ASPHALT SURFACE REMOVAL, 2 3/4" SQ YD	STRIP REFLECTIVE CRACK CONTROL FOOT	LONGITUDINAL JOINT SEALANT FOOT	HOT-MIX ASPHALT SHOULDERS TON	AGGREGATE WEDGE SHOULDER TON	MATERIAL TRANSFER DEVICE TON
374+60.18	TO	383+79.40		1654.60	171.59	205.91		2451.25	1838.44	919.22			377.49
383+79.40	TO	387+05.23		586.49	60.82	72.99	868.88		651.66	325.83		16.73	133.81
387+05.23	TO	401+11.65		3480.89	360.98	433.18	5156.87		4219.26	2812.84		72.20	794.16
401+11.65	TO	424+68.74		4242.76	439.99	527.99	6285.57		4714.18	2357.09		121.00	967.98
424+68.74	TO	426+67.74		498.69	43.46	52.15	797.77			199.00	27.24	10.22	95.62
426+67.74	TO	428+23.09		341.77	29.00	34.80		414.27			21.27	7.97	63.80
428+23.09	TO	429+62.25		358.77	37.21	44.65		531.51		278.32			81.85
429+62.25	TO	430+32.25	ROUNDAABOUT	258.71	26.83	32.20		383.28		201.06			59.03
430+32.25	TO	431+16.69	ROUNDAABOUT	258.71	26.83	32.20		383.28		201.06			59.03
431+16.69	TO	433+82.38		709.88	73.62	88.34		1051.68		531.38			161.96
433+82.38	TO	434+11.47		64.00	5.43	6.52		77.57			3.98	1.49	11.95
434+11.47	TO	435+87.76		416.48	35.88	43.05	669.24			176.29	24.13	9.05	78.93
435+87.76	TO	450+99.73		2721.55	282.23	338.68	4031.92		3023.94	1511.97		77.61	620.92
450+99.73	TO	454+10.62		559.60	58.03	69.64	829.04		621.78	310.89	0.00	15.96	127.67
454+10.62	TO	458+35.00		763.88	79.22	95.06	1131.68		848.76	424.38		21.78	174.28
458+35.00	TO	477+77.80		3497.04	362.66	435.19	5180.80		3885.6	1942.80		99.73	797.84
477+77.80	TO	485+46.15		2612.39	239.04	286.85	4097.87		1536.7	1536.70	105.18	39.44	525.89
			TOTAL	23026	2333	2799	29050	5293	21340	13729	182	493 *	5132

* NOT TOTAL QUANTITY - SEE ENTRANCE AND SIDE ROAD SCHEDULE

PATCHING SCHEDULE							
MILE POINT	EB/WB	LENGTH	WIDTH	NOTES	CLASS D PATCHING TYPE II, 14" SQ YD	CLASS D PATCHING TYPE III, 14" SQ YD	CLASS D PATCHING TYPE IV, 14" SQ YD
0.1	EB	6	13		8.67		
0.12	EB	6	13		8.67		
0.12	WB	6	13		8.67		
0.15	WB	8	6		5.33		
0.3	WB	24	6			16.00	
0.4	EB	6	14		9.33		
0.42	EB	4	13		5.78		
0.5	EB	6	12	WEST ANDERSON HOSPITAL ENTRANCE	8.00		
0.52	EB	10	15			16.67	
0.52	WB	10	15			16.67	
0.55	EB	6	15	EAST ANDERSON HOSPITAL ENTRANCE	10.00		
0.55	WB	6	15	EAST ANDERSON HOSPITAL ENTRANCE	10.00		
0.6	EB	24	13				34.67
0.6	WB	24	13				34.67
0.7	EB	10	13		14.44		
0.7	WB	10	13		14.44		
0.8				VADALABENE DRIVE			
0.9	EB	6	13		8.67		
0.9	WB	6	13		8.67		
0.95	EB	6	13		8.67		
0.95	WB	6	13		8.67		
1.1				ROUNDAABOUT			
1.2	WB	15	6		10.00		
1.25	EB	10	13		14.44		
1.25	WB	10	13		14.44		
1.3	EB	6	13		8.67		
1.3	WB	10	13		14.44		
1.35	EB	10	13		14.44		
1.35	WB	10	13		14.44		
1.4	EB	6	13		8.67		
1.45	EB	8	13		11.56		
1.7	EB	6	13		8.67		
1.7	WB	6	13		8.67		
1.9	EB	4	13		5.78		
1.9	WB	4	13		5.78		
2.1	EB	10	13		14.44		
2.1	WB	10	13		14.44		
				SUB-TOTAL	307	49	69
				ANTICIPATED FAILURES 15%	46.03	7.40	10.40
				GRAND TOTAL	353	57	80

DRAINAGE ITEMS							
STATION	TO	STATION	EB/WB	REMOVING INLETS EACH	CLASS SI CONCRETE (OUTLET) CU YDS	CONCRETE GUTTER, TYPE B FOOT	GUTTER REMOVAL FOOT
375+71.18	TO	381+60.83	EB			589.7	589.7
		379+19.58	EB	1	7.4		
375+71.18	TO	382+01.78	WB			630.6	630.6
383+20.67	TO	383+89.77	WB			69.1	69.1
383+89.77	TO	384+39.77	WB			50.0	
		379+19.58	WB	1	7.4		
			TOTAL	2	15	1339	1289

CURB RAMP SCHEDULE					
	PORTLAND CEMENT CONCRETE SIDEWALK 4" SQ FT	DETECTABLE WARNINGS SQ FT	CURB REMOVAL FOOT	SIDEWALK REMOVAL SQ FT	CONCRETE CURB, TYPE B FOOT
WEST SIDE OF AMBERLEIGH DRIVE	48.3	8	6.2	127.4	5.7
EAST SIDE OF AMBERLEIGH DRIVE	45.2	9	6.2	104.8	5.7
TOTAL	94	17	12	232	11

REFLECTOR SCHEDULE						
STATION	TO	STATION	COMMENTS	RAISED REFLECTIVE PAVEMENT MARKER EACH	RAISED REFLECTIVE PAVEMENT MARKER REMOVAL EACH	CURB REFLECTOR EACH
374+60.18	TO	383+79.40		11	11	
383+79.40	TO	387+05.23		4	4	
387+05.23	TO	393+50.86		32	32	
393+50.86	TO	394+82.33		10	10	
394+82.33	TO	395+62.21				
395+62.21	TO	401+11.65		31	31	
401+11.65	TO	424+68.74		29	29	
424+68.74	TO	426+67.74		10	10	66
426+67.74	TO	434+11.47	ROUNDAABOUT			
434+11.47	TO	435+87.76		9	9	67
435+87.76	TO	450+99.73		19	19	
450+99.73	TO	477+77.80		33	33	
477+77.80	TO	480+67.69		14	14	
480+67.69	TO	485+46.15		12	12	
			TOTAL	216	216	133

MODEL: Default
 FILE: \\mhc-pix01\l\B&E\ID\NTEC\Illinois\gov\p\WIDOT\Documents\IDOT_Offices\IDOT\Projects\08761_16\COData\CAD\heeres\08761_16\p\Resurfacing.dgn

USER NAME = challesdeske	DESIGNED -	REVISED -
PLOT SCALE = 100,0000' / in.	CHECKED -	REVISED -
PLOT DATE = 1/18/2019	DATE -	REVISED -

**STATE OF ILLINOIS
DEPARTMENT OF TRANSPORTATION**

SCHEDULES

SCALE: SHEET 1 OF 2 SHEETS STA. TO STA.

F.A.P. RTE. 586A	SECTION (59-1.31)R5-4	COUNTY MADISON	TOTAL SHEETS 21	SHEET NO. 10
CONTRACT NO. 76L16				
ILLINOIS FED. AID PROJECT				

ENTRANCES AND SIDE ROADS							INCIDENTAL HMA SURFACING TON	AGGREGATE WEDGE SHOULDER, TY B		TEMPORARY RAMP SQ YD	HMA REMOVAL BUTT JOINT SQ YD		
STATION	L/R	LENGTH	TYPE	SURFACE TYPE	MAILBOX: L/R	SHOULDER TYPE		AT ENTRANCES TON	AT MAILBOXES TON				
376+57.70	R	35.94	PRIVATE	AGGREGATE	NONE	GUTTER							
379+51.02	L	77.54	COMMERCIAL	CONCRETE	NONE	GUTTER							
382+55.11	L	108.89	COMMERCIAL	CONCRETE	NONE	GUTTER							
385+23.79	L	35.49	COMMERCIAL	CONCRETE	RT	NONE	0.8	1.9	7.9				
386+13.79	R	28.94	FIELD	AGGREGATE	NONE	AGG		0.7					
387+08.79	R	30.76	FIELD	AGGREGATE	NONE	AGG		0.7					
388+69.70	R	64.13	COMMERCIAL	CONCRETE	RT	NONE	1.5	1.9	14.3				
394+13.51	L	19.8	PRIVATE	AGGREGATE	LT	AGG		1.9					
395+22.28	L	122.91	AMBERLEIGH ROAD	HMA	NONE	NONE	2.9		27.3	170.7			
395+22.28	R	79.01	HOSPITAL ROAD	HMA	NONE	NONE	1.8		17.6				
398+55.83	L	21.01	PRIVATE	AGGREGATE	RT	AGG		0.5	1.9				
399+57.52	R	55.43	HOSPITAL DRIVEWAY	HMA	NONE	NONE	1.3		12.3				
400+96.26	L	12.07	PRIVATE	AGGREGATE	LT	AGG		0.3	1.9				
402+90.39	R	42.51	POWER SUBSTATION	AGGREGATE	NONE	AGG		1.0					
402+93.80	L	19.86	PRIVATE	AGGREGATE	LT	AGG		0.5	1.9				
404+66.83	R	62.64	COMMERCIAL	HMA	NONE	NONE	1.5		13.9				
407+15.85	R	55.6	COMMERCIAL	HMA	NONE	NONE	1.3		12.4				
409+23.61	R	82.29	COMMERCIAL	HMA	NONE	NONE	1.9		18.3				
410+87.35	L	22.64	PRIVATE	AGGREGATE	LT	AGG		0.5	1.9				
411+61.29	R	165.78	VADALABENE DRIVE	HMA	NONE	NONE	3.9		36.8	230.3			
414+88.49	R	214.93	TUSCANY RIDGE	HMA	NONE	NONE	5.0		47.8	298.5			
416+26.64	L	63.67	LIBERTY VILLAGE	HMA	NONE	NONE	1.5		14.1				
417+38.36	R	32.78	FIELD	AGGREGATE	NONE	AGG		0.8					
420+04.19	R	80.1	COMMERCIAL	CONCRETE	NONE	NONE	1.9		17.8				
422+13.75	L	68.71	LIBERTY VILLAGE	CONCRETE	NONE	NONE	1.6		15.3				
422+13.75	R	73.82	MARYVILLE MANOR	CONCRETE	NONE	NONE	1.7		16.4				
435+63.29	R	101.23	MARYVILLE BAPTIST	CONCRETE	NONE	NONE	2.4		22.5				
438+64.34	L	130.83	PRIVATE	AGGREGATE	LT	AGG		3.1	1.9				
441+01.48	R	92.97	MARYVILLE BAPTIST	CONCRETE	NONE	NONE	2.2		20.7				
446+27.95	L	82.2	OLD TROY ROAD	HMA	NONE	HMA	1.9		18.3	114.2			
448+82.01	L	75.11	OLD TROY ROAD	HMA	NONE	HMA	1.8		16.7	104.3			
450+40.56	R	341.59	PRIVATE	AGGREGATE	LT	HMA	8.0	1.9					
453+78.91	R	154.87	KENNEDY DRIVE	HMA	RT	HMA	3.6	1.9	34.4	215.1			
453+82.73	L	70.54	WATER TOWER	AGGREGATE	NONE	AGG		1.6					
456+62.41	R	60.81	PRIVATE	CONCRETE	NONE	AGG	1.4		13.5	84.5			
457+67.99	R	22.74	PRIVATE	AGGREGATE	RT	AGG		0.5	1.9				
460+18.94	R	24.52	PRIVATE	AGGREGATE	LT	AGG		0.6	1.9				
461+69.97	R	41.81	PRIVATE	CONCRETE	NONE	NONE	1.0		9.3				
463+08.59	R	38.21	PRIVATE	AGGREGATE	NONE	AGG		0.9					
464+28.03	R	37.46	PRIVATE	AGGREGATE	LT	AGG		0.9	1.9				
468+02.15	R	159.75	GLIDDEN BLVD	HMA	NONE	HMA	3.7		35.5	221.9			
475+72.56	R	38.39	FIELD	EARTH/AGG	NONE	AGG		0.9					
485+34.73	R	28.03	PRIVATE	CONCRETE	NONE	HMA	0.7		6.2				
SUB-TOTAL							55.1	13.8	25.1	449.2	1439.4		
TOTAL							55	14	25	449	1439		

PAVEMENT MARKING SCHEDULE													
STATION	TO	STATION	COMMENTS	SHORT TERM PAVEMENT MARKING FOOT	SHORT TERM PAVEMENT MARKING REMOVAL SQ FT	TEMPORARY PAVEMENT MARKING - LETTERS AND SYMBOLS SQ FT	TEMPORARY PAVEMENT MARKING, LINE 4" FOOT	TEMPORARY PAVEMENT MARKING, LINE 12" FOOT	TEMPORARY PAVEMENT MARKING REMOVAL SQ FT	THERMOPLASTIC PAVEMENT MARKING - LETTERS AND SYMBOLS SQ FT	THERMOPLASTIC PAVEMENT MARKING, LINE 4" FOOT	THERMOPLASTIC PAVEMENT MARKING, LINE 12" FOOT	PAINT CURB FOOT
374+60.18	TO	383+79.40		501.39	55.71		3676.9		1225.6		3676.9		
383+79.40	TO	387+05.23		177.73	19.75		1303.3		434.4		1303.3		
387+05.23	TO	394+82.33		423.87	47.10	31.2	4662.6	162.10	1747.5	31.2	4662.6	162.1	
395+62.21	TO	401+11.74		299.74	33.30		3297.2	98.60	1197.7		3297.2	98.6	
401+11.74	TO	424+68.74		1285.64	142.85		14142.0		4714.0		14142.0		
424+68.74	TO	426+77.39		227.62	25.29		1251.9	23.20	440.5		1251.9	23.2	
426+67.74	TO	428+23.09					310.0		103.3		310.0		310.7
428+23.09	TO	429+62.25					290.0		96.7		290.0		278.3
429+62.25	TO	430+32.25					220.0		73.3		220.0		
430+46.47	TO	431+16.69					220.0		73.3		220.0		
431+16.69	TO	433+75.26					605.0		201.7		605.0		517.1
433+75.26	TO	435+89.69		233.92	25.99		1286.6	22.10	451.0		1286.6	22.1	70.0
435+89.69	TO	450+99.73		823.66	91.52		6040.2		2013.4		6040.2		
450+99.73	TO	458+35.00		401.06	44.56		2941.1		980.4		2941.1		
458+35.00	TO	477+77.80		1059.71	117.75		7771.2		2590.4		7771.2		
477+77.80	TO	485+46.15		838.20	93.13	62.4	4610.1	53.70	1652.8	62.40	4610.1	53.7	
TOTAL				6273	697	94	52628	360	17996	94	52628	360	1176

MODEL: Default
 FILE: \\mhc\p\proj\1108\B&E\ID\NETC\Illinois\gov\FW\DOT\Documents\DOT - Office\ID\ierfct_8\proj\sect0876L16\CAD\data\CAD\sheet0876L16.rvt
 PROJECT: 0876L16\CAD\data\CAD\sheet0876L16.rvt
 DATE: 1/18/2019

USER NAME = challandeske	DESIGNED -	REVISED -
	DRAWN -	REVISED -
PLOT SCALE = 100.0000' / in.	CHECKED -	REVISED -
PLOT DATE = 1/18/2019	DATE -	REVISED -

**STATE OF ILLINOIS
DEPARTMENT OF TRANSPORTATION**

SCHEDULES

SCALE: SHEET 2 OF 2 SHEETS STA. TO STA.

F.A.P. RTE.	SECTION	COUNTY	TOTAL SHEETS	SHEET NO.
586A	(59-1,31)RS-4	MADISON	21	11
CONTRACT NO. 76L16				
ILLINOIS		FED. AID PROJECT		

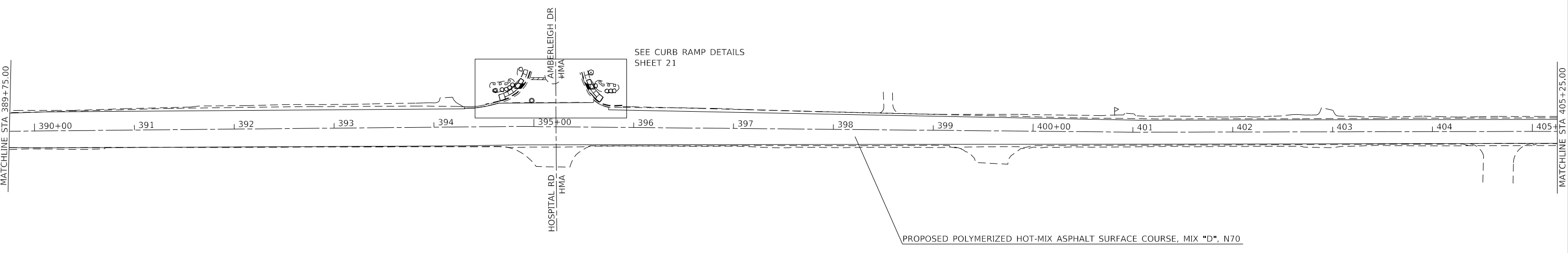
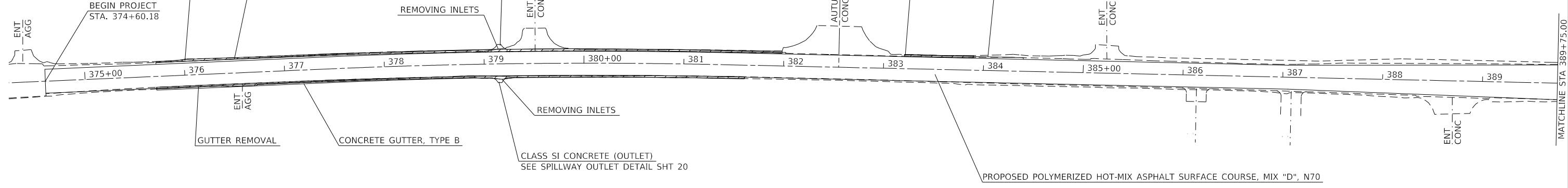
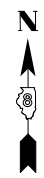

MODEL: Default
 FILE: \\nashc-pix\ill08\BID\NTEC\Illinois\gov\PIWDOT\Documents\1\DOT_Offices\Director\B\Projects\08761_16\CAD\data\CAD\sheet\08761_16-sht-plan.dgn

USER NAME = challeske	DESIGNED -	REVISED -
PLOT SCALE = 100,0000' / in.	DRAWN -	REVISED -
PLOT DATE = 1/18/2019	CHECKED -	REVISED -
	DATE -	REVISED -

**STATE OF ILLINOIS
DEPARTMENT OF TRANSPORTATION**

PLAN VIEW			
SCALE: 1"=100'	SHEET 1	OF 4 SHEETS	STA. TO STA.

F.A.P. RTE. 586A	SECTION (59-1,31)RS-4	COUNTY MADISON	TOTAL SHEETS 21	SHEET NO. 12
CONTRACT NO. 76L16				
ILLINOIS FED. AID PROJECT				

MODEL: Default
 FILE: N:\mhc\p16\1108\B&E\BID\ITEC\Illinois\gov\PW\DOT\Documents\1\DOT_Offices\1\08761.16\CADD\data\CAD\sheet\08761.16-surf-plan.dgn

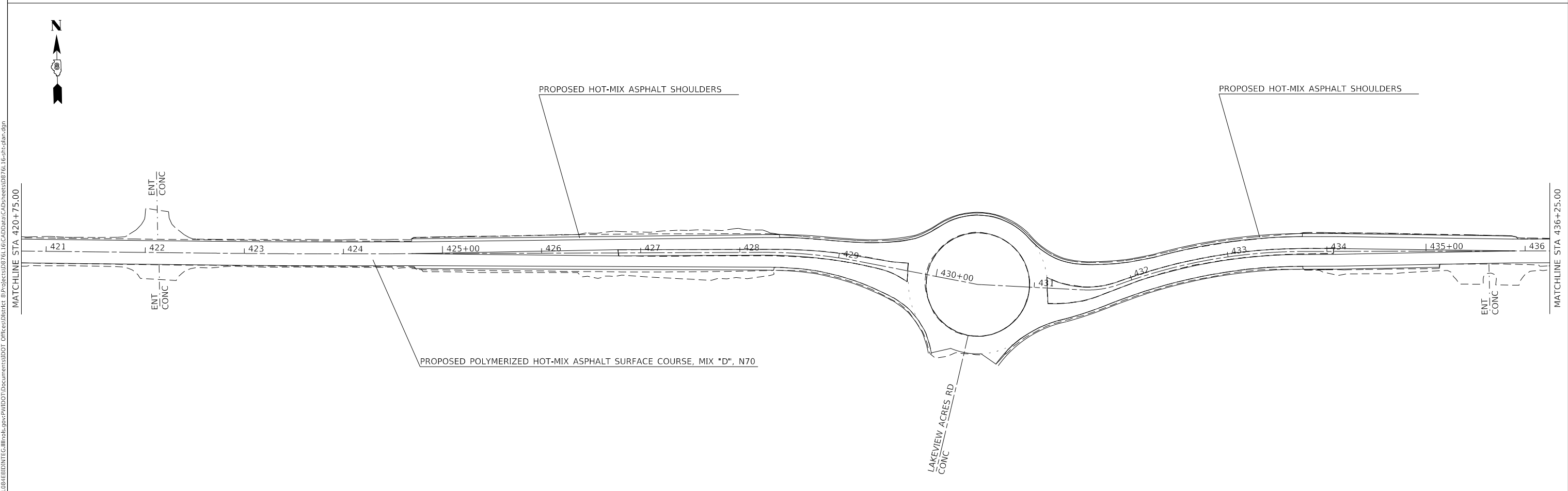
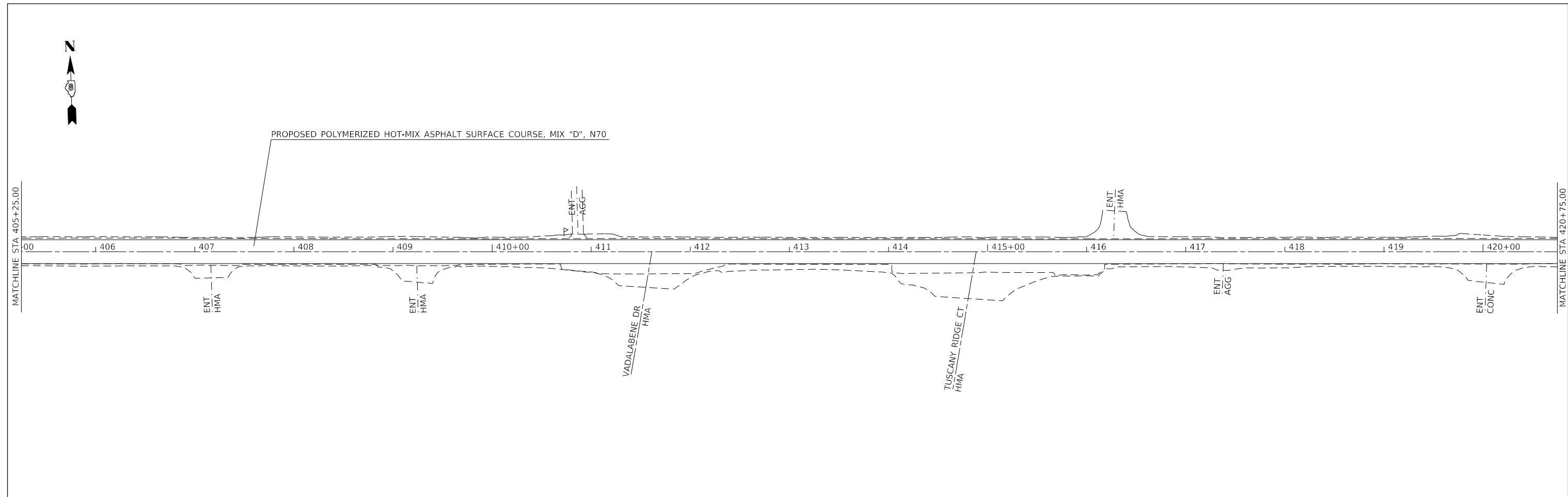

USER NAME = challesdeske	DESIGNED -	REVISED -
	DRAWN -	REVISED -
PLOT SCALE = 100,0000' / in.	CHECKED -	REVISED -
PLOT DATE = 1/18/2019	DATE -	REVISED -

**STATE OF ILLINOIS
 DEPARTMENT OF TRANSPORTATION**

PLAN VIEW
 SCALE: 1"=100' SHEET 2 OF 4 SHEETS STA. TO STA.

F.A.P. RTE.	SECTION	COUNTY	TOTAL SHEETS	SHEET NO.
586A	(59-1,31)RS-4	MADISON	21	13
CONTRACT NO. 76L16				
ILLINOIS FED. AID PROJECT				



MATCHLINE STA 436+25.00

437 438 439 440+00 441 442 443 444 445+00 446 447 448 449 450+00 451

MATCHLINE STA 451+75.00

PROPOSED POLYMERIZED HOT-MIX ASPHALT SURFACE COURSE, MIX "D", N70

OLD TROY RD
HMA

OLD TROY RD
HMA

ENT
CONC

ENT
HMA

ENT
AGG



MATCHLINE STA 451+75.00

452 453 454 455+00 456 457 458 459 460+00 461 462 463 464 465+00 466 467

MATCHLINE STA 467+50.00

PROPOSED POLYMERIZED HOT-MIX ASPHALT SURFACE COURSE, MIX "D", N70

PROPOSED INCIDENTAL HOT-MIX ASPHALT SURFACING

KENNEDY DR
HMA

ENT
AGG

ENT
CONC

ENT
AGG

ENT
AGG

ENT
CONC

ENT
AGG

ENT
AGG

MODEL: D:\default
FILE NAME: P:\1108\B&E\BID\NTEC\Illinois\gov\PI\DOT\Documents\11DOT_Offices\11DOT_08761\6-21-16\p11-eban.dgn

USER NAME = challeske	DESIGNED -	REVISED -
	DRAWN -	REVISED -
PLOT SCALE = 100,0000' / in.	CHECKED -	REVISED -
PLOT DATE = 1/18/2019	DATE -	REVISED -

**STATE OF ILLINOIS
DEPARTMENT OF TRANSPORTATION**

PLAN VIEW

SCALE: 1"=100' SHEET 3 OF 4 SHEETS STA. TO STA.

F.A.P. RTE.	SECTION	COUNTY	TOTAL SHEETS	SHEET NO.
586A	(59-1,31)RS-4	MADISON	21	14
CONTRACT NO. 76L16				
ILLINOIS FED. AID PROJECT				

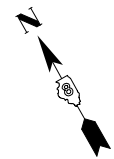

MATCHLINE STA 467+50.00

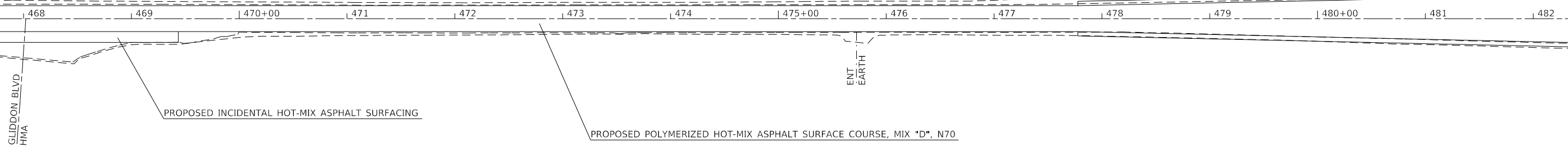

MATCHLINE STA 482+75.00



MATCHLINE STA 482+75.00

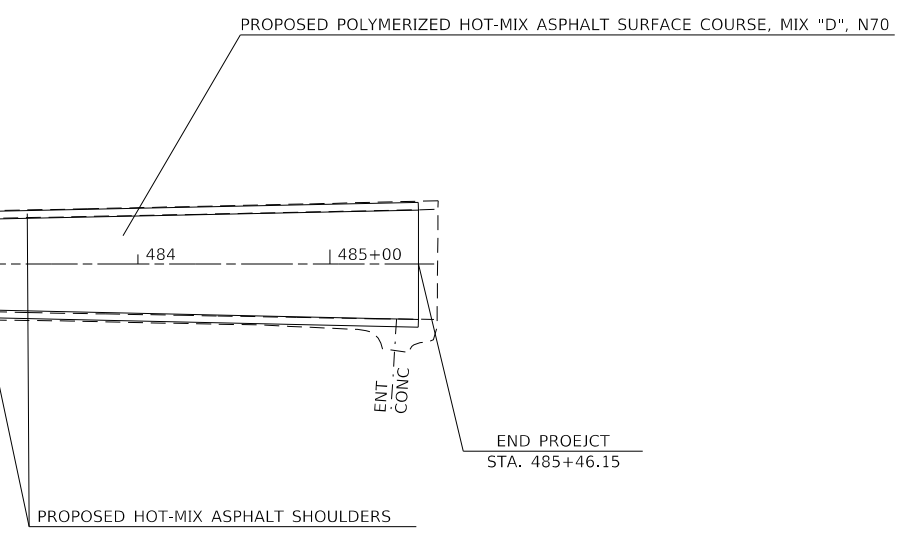

END PROEJCT
STA. 485+46.15

MODEL: Default
FILE: \\nas01.pva\illinois\BID\NTEC\Illinois\gov\PIVDOT\Documents\DOT_Offices\Director\8\Projects\08761.16\CADdata\CAD\sheet\08761.16-sht-plan.dgn

USER NAME = challandeske	DESIGNED -	REVISED -
PLOT SCALE = 100.0000 ' / in.	DRAWN -	REVISED -
PLOT DATE = 1/18/2019	CHECKED -	REVISED -
	DATE -	REVISED -

**STATE OF ILLINOIS
DEPARTMENT OF TRANSPORTATION**

PLAN VIEW

SCALE: 1"=100' SHEET 4 OF 4 SHEETS STA. TO STA.

F.A.P. RTE.	SECTION	COUNTY	TOTAL SHEETS	SHEET NO.
586A	(59-1,31)RS-4	MADISON	21	15
CONTRACT NO. 76L16			ILLINOIS FED. AID PROJECT	

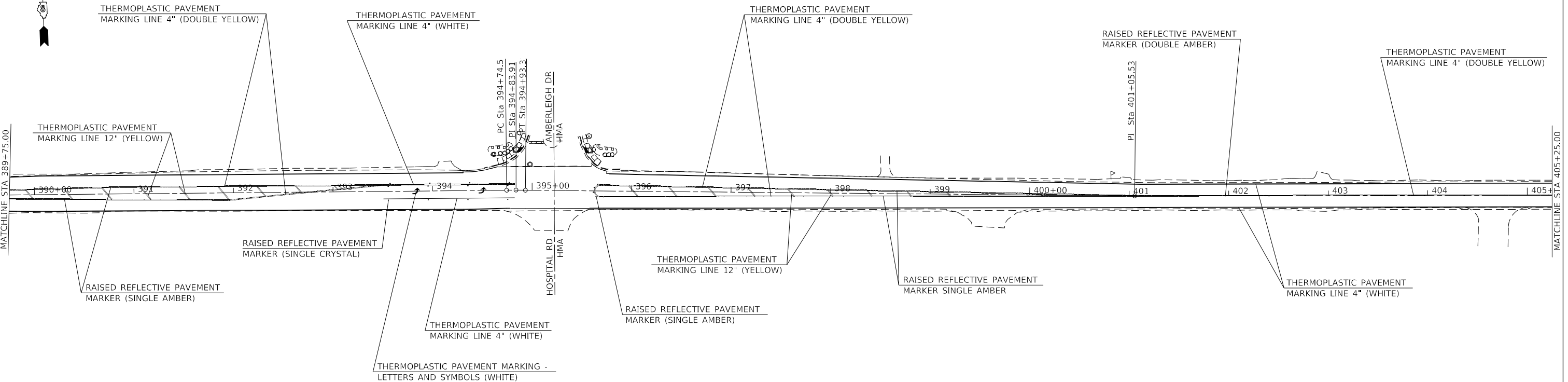
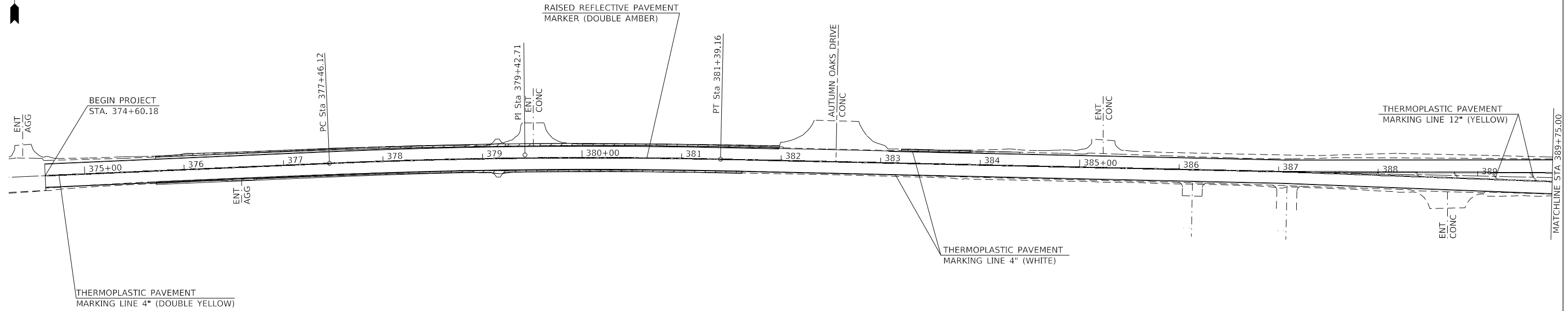

SEE STANDARD 780001 FOR DETAILS NOT SHOWN

MODEL: Default
 FILE NAME: p:\11\08\BID\INTC\Illinois.gov\PWD\DOT\Documents\DOT Office\Drawings\16\CAD\data\CAD\here\0876116.dwg
 PROJECT: 0876116

USER NAME = challesdeske	DESIGNED -	REVISED -
	DRAWN -	REVISED -
PLOT SCALE = 100,0000' / in.	CHECKED -	REVISED -
PLOT DATE = 1/18/2019	DATE -	REVISED -

**STATE OF ILLINOIS
DEPARTMENT OF TRANSPORTATION**

PAVEMENT MARKING

SCALE: 1"=100' SHEET 1 OF 4 SHEETS STA. TO STA.

F.A.P. RTE.	SECTION	COUNTY	TOTAL SHEETS	SHEET NO.
586A	(59-1,31)RS-4	MADISON	21	16
CONTRACT NO. 76L16				
		ILLINOIS	FED. AID PROJECT	



MATCHLINE STA 405+25.00

406 407 408 409 410+00 411 412 413 414 415+00 416 417 418 419 420+00

MATCHLINE STA 420+75.00

RAISED REFLECTIVE PAVEMENT MARKER (DOUBLE AMBER)

THERMOPLASTIC PAVEMENT MARKING LINE 4" (DOUBLE YELLOW)

THERMOPLASTIC PAVEMENT MARKING LINE 4" (WHITE)

VADALABENE DR
HMA

TUSCANY RIDGE CT
HMA



MATCHLINE STA 420+75.00

421 422 423 424 425+00 426 427 428 429 430+00 431 432 433 434 435+00 436

MATCHLINE STA 436+25.00

RAISED REFLECTIVE PAVEMENT MARKER (DOUBLE AMBER)

THERMOPLASTIC PAVEMENT MARKING LINE 12" (YELLOW)

THERMOPLASTIC PAVEMENT MARKING LINE 4" (WHITE)

RAISED REFLECTIVE PAVEMENT MARKER (DOUBLE AMBER)

THERMOPLASTIC PAVEMENT MARKING LINE 4" (DOUBLE YELLOW)

THERMOPLASTIC PAVEMENT MARKING LINE 4" (WHITE)

THERMOPLASTIC PAVEMENT MARKING LINE 4" (YELLOW)

THERMOPLASTIC PAVEMENT MARKING LINE 4" (WHITE)

THERMOPLASTIC PAVEMENT MARKING LINE 4" (DOUBLE YELLOW)

ENT. CONC

PC Sta 422+66.33

PT Sta 424+47.03

H Sta 423+56.68

PC Sta 428+23.34

PI Sta 428+72.53

PT Sta 429+21.40

PI Sta 430+13.07

PC Sta 431+49.76

PI Sta 431+88.23

PI Sta 432+81.87

PT Sta 433+75.61

ENT. CONC

LAKEVIEW ACRES RD
CONC

SEE STANDARD 780001 FOR DETAILS NOT SHOWN

MODEL: Default
FILE: \\mhc-pw\illinois\BID\NTEC\Illinois\gov\PI\DOT\Documents\1\DOT_Offices\Director\B\Projects\08761\6\CAD\data\CAD\Sheet\08761_16.spl-pv.mxd

USER NAME = challesdeske	DESIGNED -	REVISED -
	DRAWN -	REVISED -
PLOT SCALE = 100.0000' / in.	CHECKED -	REVISED -
PLOT DATE = 1/18/2019	DATE -	REVISED -

STATE OF ILLINOIS
DEPARTMENT OF TRANSPORTATION

PAVEMENT MARKING

SCALE: 1"=100' SHEET 2 OF 4 SHEETS STA. TO STA.

F.A.P. RTE.	SECTION	COUNTY	TOTAL SHEETS	SHEET NO.
586A	(59-1,31)RS-4	MADISON	21	17
CONTRACT NO. 76L16				
ILLINOIS		FED. AID PROJECT		

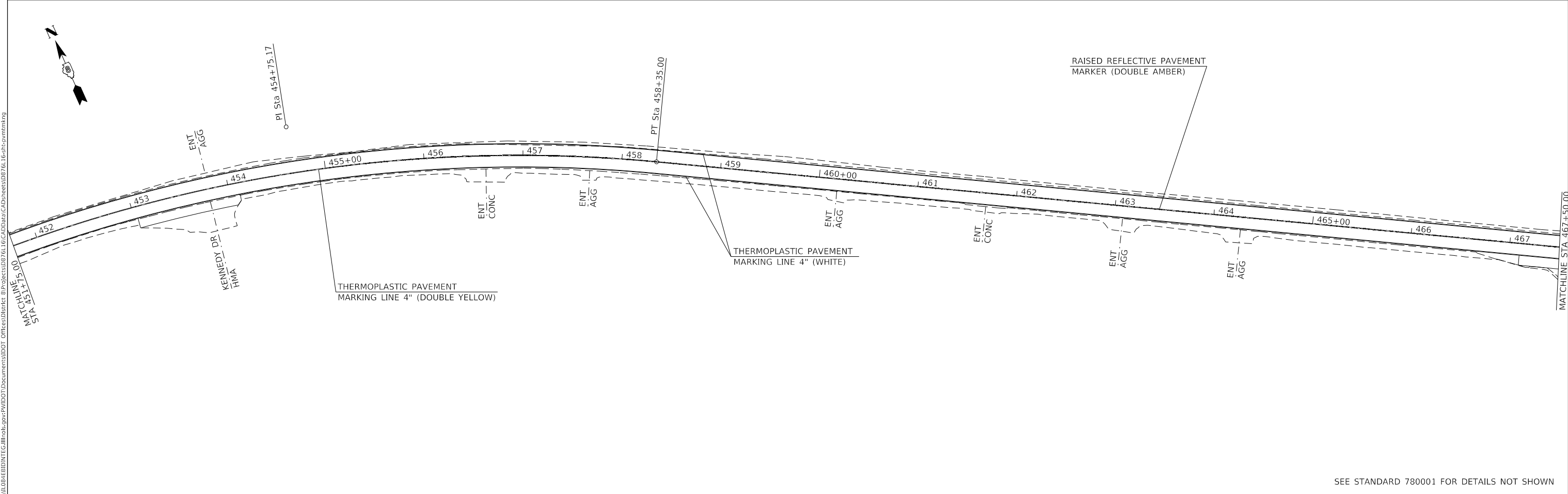
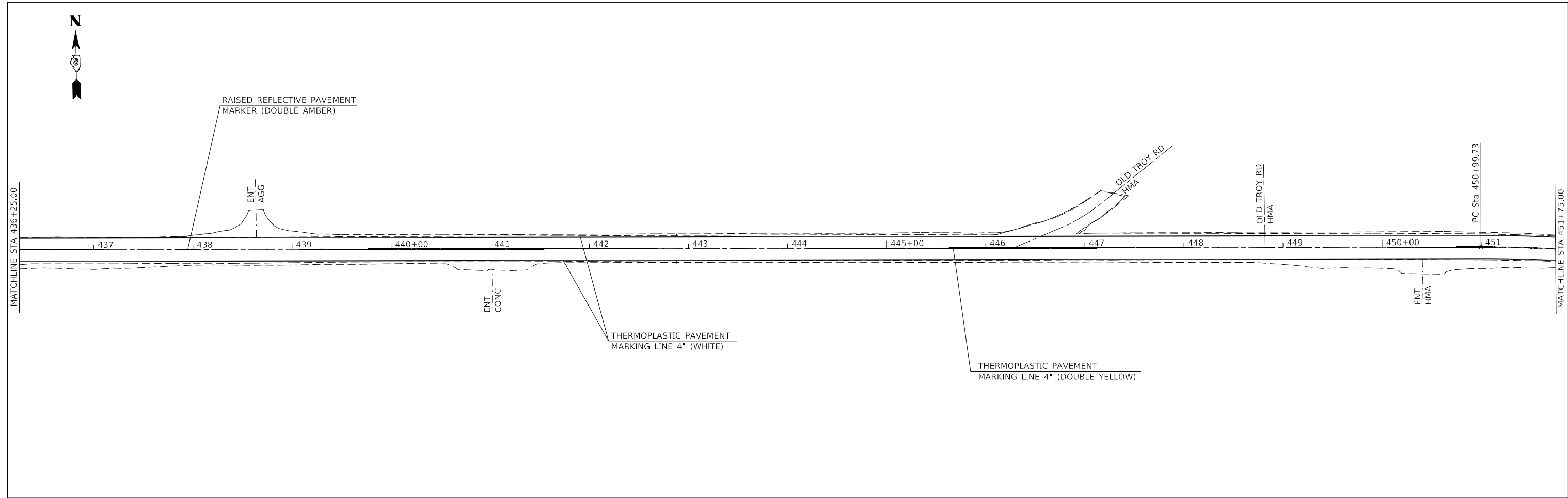

MODEL: Default
 FILE: \\mhc-pw\c\l\08\BID\NTEC\Illinois\gov\PWIDOT\Documents\DOT_Offices\Director @ Projects\0876116\CADD\data\CAD\here\0876116-epc-pavement.mxd

USER NAME = challesdeske	DESIGNED -	REVISED -
	DRAWN -	REVISED -
PLOT SCALE = 100,0000 ' / in.	CHECKED -	REVISED -
PLOT DATE = 1/18/2019	DATE -	REVISED -

STATE OF ILLINOIS
DEPARTMENT OF TRANSPORTATION

PAVEMENT MARKING

SCALE: 1"=100' SHEET 3 OF 4 SHEETS STA. TO STA.

SEE STANDARD 780001 FOR DETAILS NOT SHOWN

F.A.P. RTE.	SECTION	COUNTY	TOTAL SHEETS	SHEET NO.
586A	(59-1,31)RS-4	MADISON	21	18
CONTRACT NO. 76L16				
		ILLINOIS	FED. AID PROJECT	

MODEL: Default
 FILE: h:\mhc_p\1108\848E\BID\NTEC\Illinois\gov\PIVDOT\Documents\11DOT_Offices\BID\ref\16\Co\data\CAD\sheet\08761_16.spl-pavmarking

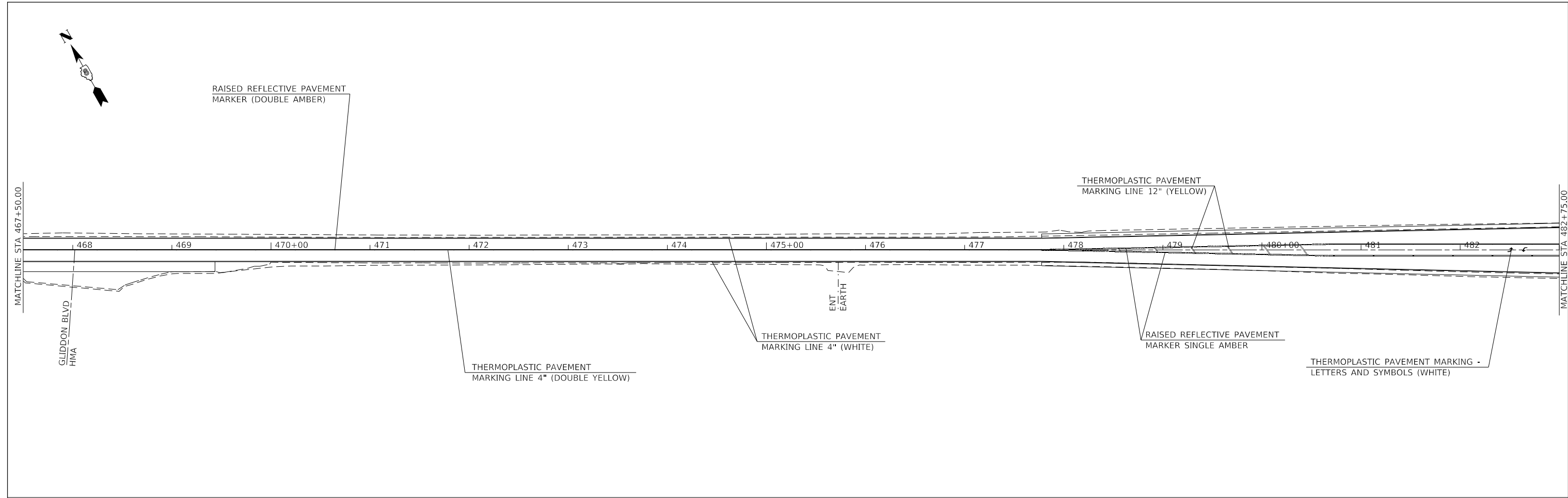

SEE STANDARD 780001 FOR DETAILS NOT SHOWN

USER NAME = challandeske	DESIGNED -	REVISED -
PLOT SCALE = 100.0000' / in.	DRAWN -	REVISED -
PLOT DATE = 1/18/2019	CHECKED -	REVISED -
	DATE -	REVISED -

**STATE OF ILLINOIS
 DEPARTMENT OF TRANSPORTATION**

PAVEMENT MARKING

SCALE: 1"=100' SHEET 4 OF 4 SHEETS STA. TO STA.

F.A.P. RTE.	SECTION	COUNTY	TOTAL SHEETS	SHEET NO.
586A	(59-1,31)RS-4	MADISON	21	19
CONTRACT NO. 76L16				
ILLINOIS		FED. AID PROJECT		

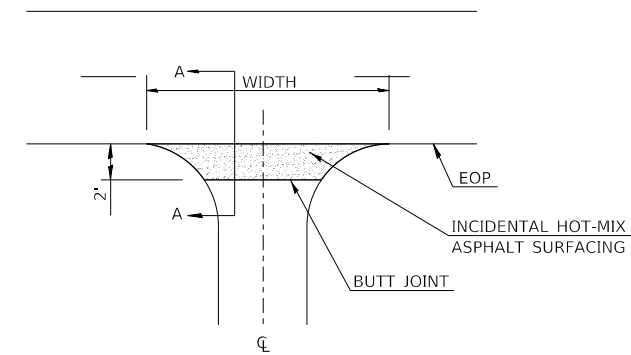
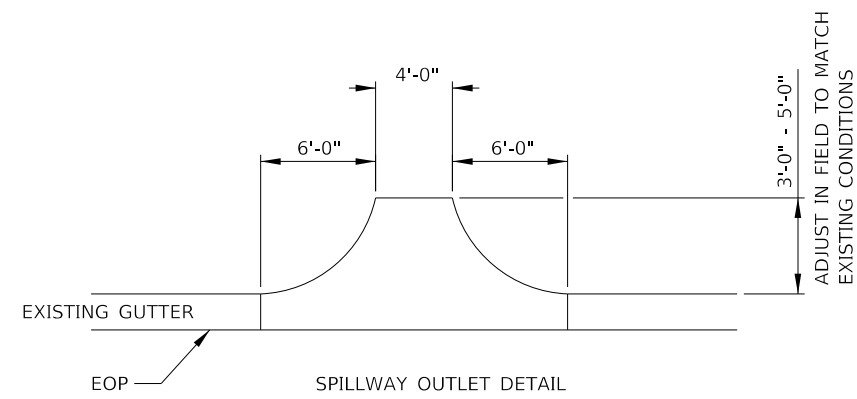

CONCRETE ENTRANCE DETAIL

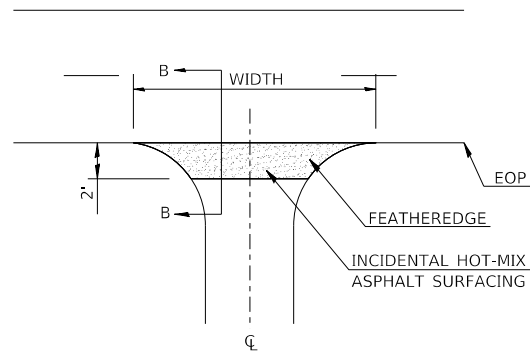

**HMA, AGG, AND FIELD ENTRANCE DETAIL
(FEATHEREDGE DETAIL)**

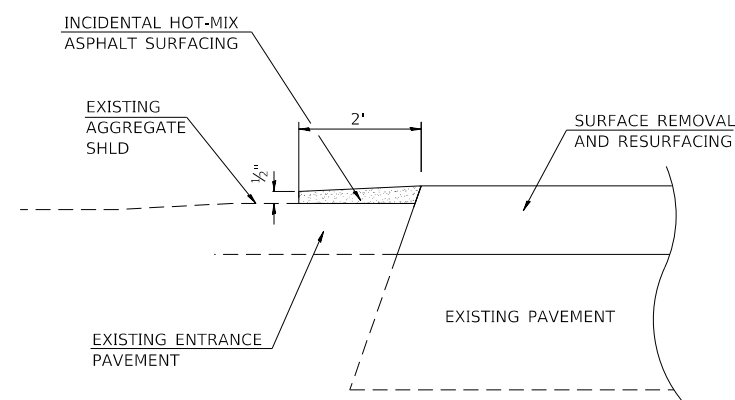

SECTION A-A

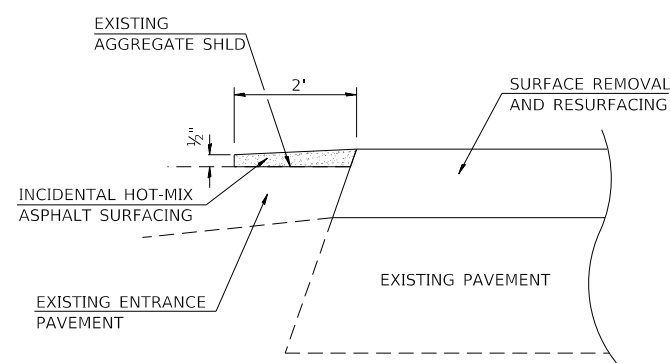

SECTION B-B

GPS PT #1
N=754,263.582
E=2,361,885.186
ALL TIES PULLED DIRECT

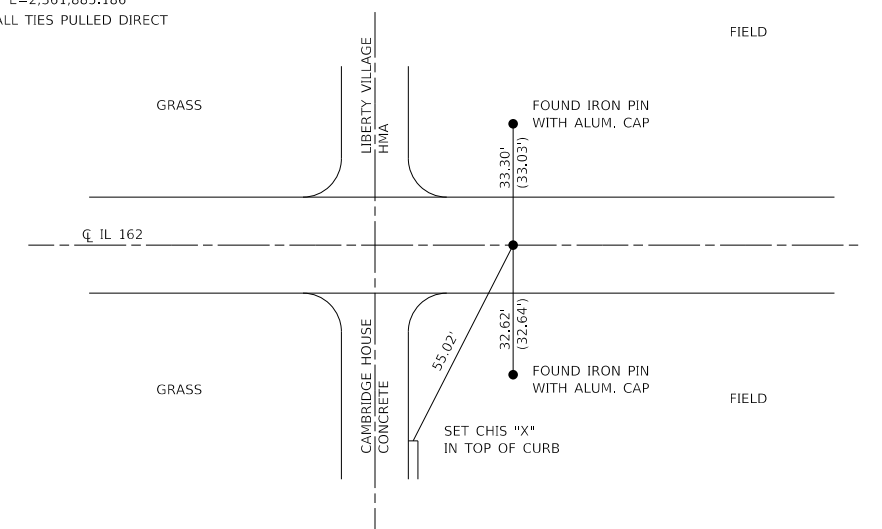

CENTER SEC 1, T3N, R8W
FOUND MAG NAIL

CENTERLINE MARKER - 3 POINT TIE

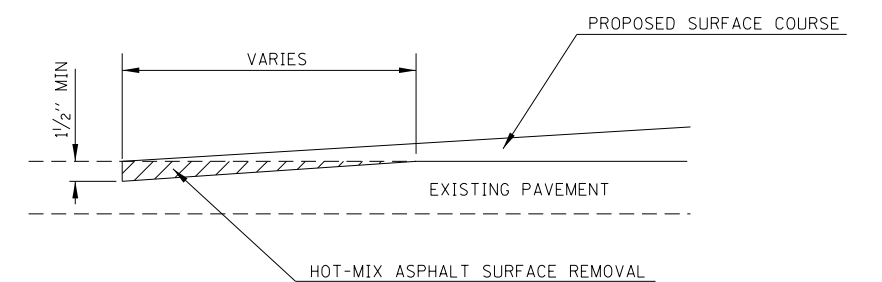

HMA SURFACE REMOVAL - BUTT JOINT

•SEE SCHEDULE FOR BUTT JOINT LOCATIONS

MODEL: Default
FILE: N:\mfc_p\11\08\B&E\BID\NTEC\Illinois\gov\PIWDOT\Documents\11DOT_Offices\11dot\16\CAD\data\CAD\sheet\08761_16_sht-detail.dgn

USER NAME = challeske	DESIGNED -	REVISED -
PLOT SCALE = 100.0000' / in.	DRAWN -	REVISED -
PLOT DATE = 1/18/2019	CHECKED -	REVISED -
	DATE -	REVISED -

**STATE OF ILLINOIS
DEPARTMENT OF TRANSPORTATION**

DETAILS			
CENTERLINE MARKER - 3 POINT TIE			
SCALE: NTS	SHEET	OF SHEETS	STA. TO STA.

F.A.P. RTE.	SECTION	COUNTY	TOTAL SHEETS	SHEET NO.
586A	(59-1,31)RS-4	MADISON	21	20
ILLINOIS FED. AID PROJECT			CONTRACT NO. 76L16	

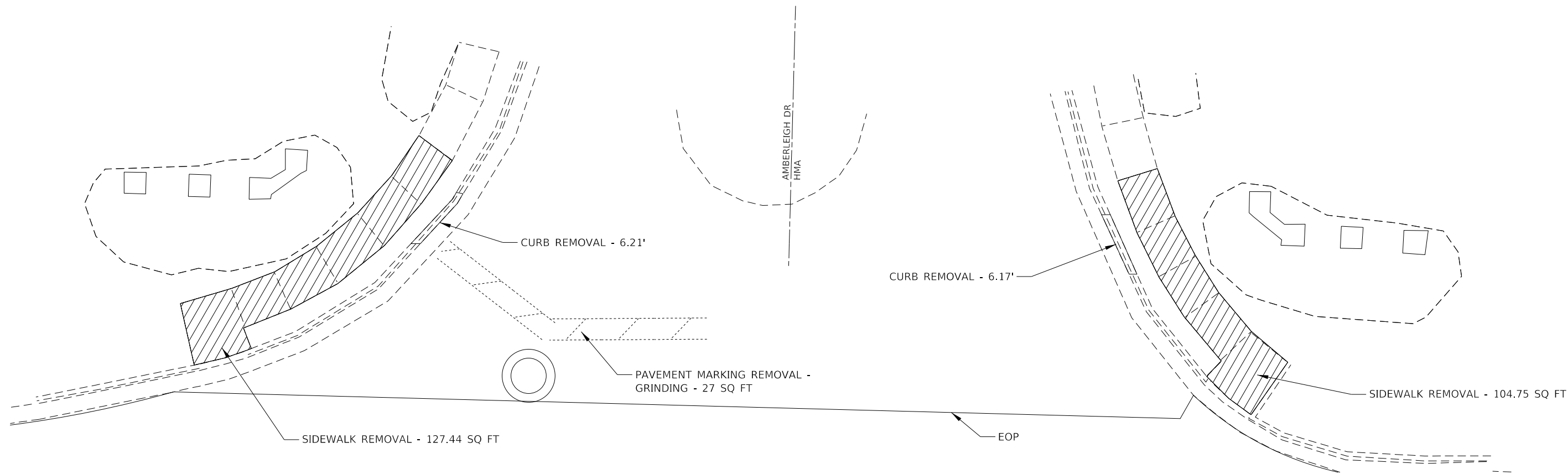

EXISTING LAYOUT

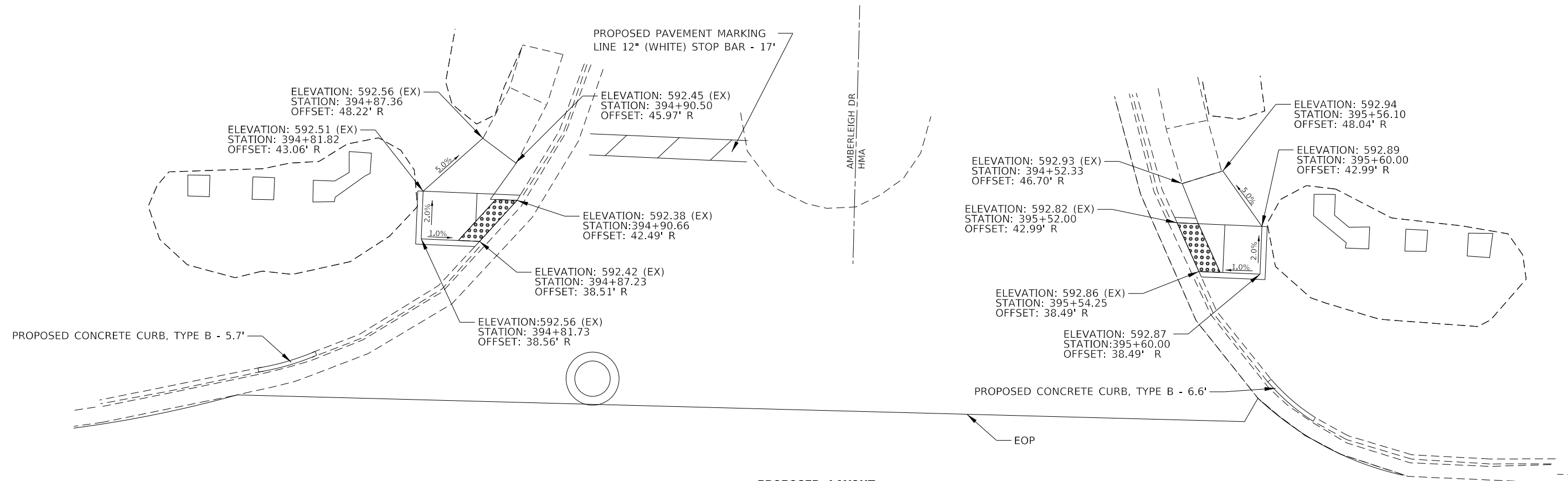

PROPOSED LAYOUT



MODEL: Default
 FILE: \\msn\pc\paul@BEIDNET\ITG\Illinois\gov\PWD\DOT\Documents\180761_16\CAD\data\CAD\here\here\08761_16\pr-h-detailed.dgn
 PROJECT: 180761_16\CAD\data\CAD\here\here\08761_16\pr-h-detailed.dgn

USER NAME	= challandeske	DESIGNED	-	REVISED	-
DRAWN	-	CHECKED	-	REVISED	-
PLOT SCALE	= 100,0000' / in.	DATE	-	REVISED	-
PLOT DATE	= 1/18/2019				

**STATE OF ILLINOIS
DEPARTMENT OF TRANSPORTATION**

CURB RAMP DETAILS

F.A.P. RTE.	SECTION	COUNTY	TOTAL SHEETS	SHEET NO.
586A	(59-1,31)RS-4	MADISON	21	21
CONTRACT NO. 76L16				
		ILLINOIS	FED. AID PROJECT	

SCALE: 1"=10' SHEET OF SHEETS STA. TO STA.