

STATE OF ILLINOIS  
DEPARTMENT OF TRANSPORTATION

F.A.U. RTE.	SECTION	COUNTY	TOTAL SHEETS	SHEET NO.
8173	12310	SANGAMON	6	1
ILLINOIS			CONTRACT NO. 72K90	

D-96-009-19



FOR INDEX OF SHEETS, SEE SHEET NO. 2

# PROPOSED IMPROVEMENTS

FAU 8173 (MOUND RD)  
(23)Q  
BITUMINOUS SURFACE TREATMENT, A-2

MORGAN CO

C-96-010-19

ADT = 750  
SU = 40  
MU = 10

PROJECT ENDS  
STA. 1782+98

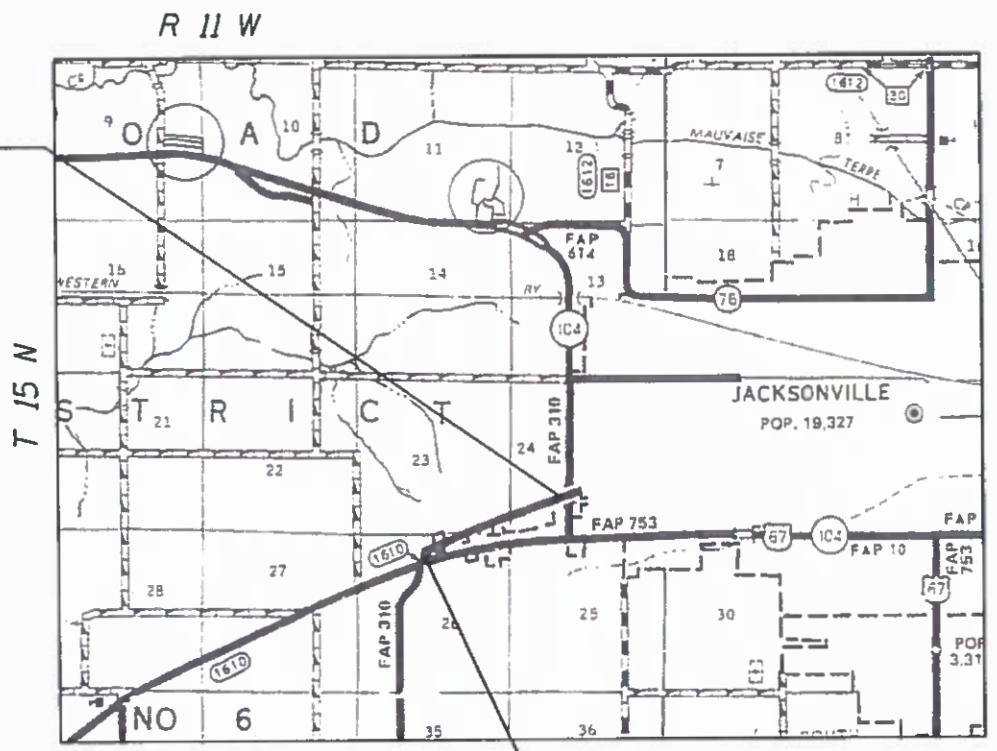

PROJECT BEGINS  
STA. 1738+35

GROSS LENGTH = 4,463 FT = 0.845 MI  
NET LENGTH = 4,463 FT = 0.845 MI

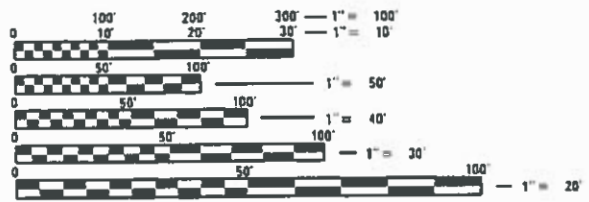

FULL SIZE PLANS HAVE BEEN PREPARED USING STANDARD ENGINEERING SCALES. REDUCED SIZED PLANS WILL NOT CONFORM TO STANDARD SCALES. IN MAKING MEASUREMENTS ON REDUCED PLANS, THE ABOVE SCALES MAY BE USED

J.U.L.I.E.  
JOINT UTILITY LOCATION INFORMATION FOR EXCAVATION  
1-800-892-0123  
OR 811

PROJECT ENGINEER : MIKE IRWIN - (217)524-7765  
PROJECT MANAGER : TIM SHARP - (217)524-9160

CONTRACT NO. 72K90

STATE OF ILLINOIS  
DEPARTMENT OF TRANSPORTATION

SUBMITTED *December 21 20 18*

*Jeffrey M. Smith*  
REGIONAL ENGINEER

*Paul P. Chaf*  
ENGINEER OF DESIGN AND ENVIRONMENT

*Paul P. Chaf*  
DIRECTOR OF HIGHWAYS, PROJECT IMPLEMENTATION

PRINTED BY THE AUTHORITY  
OF THE STATE OF ILLINOIS

## INDEX OF SHEETS

SHEET NO.	DESCRIPTION
1.	COVER SHEET
2.	INDEX OF SHEETS, STANDARDS, GENERAL NOTES & SIGNATURE
3.	SUMMARY OF QUANTITIES
4.	SCHEDULE OF QUANTITIES
5.	PROJECT LOCATION MAP
6.	PROJECT TYPICAL SECTIONS

## STANDARDS

STANDARD NO.	DESCRIPTION
701006-05	OFF-ROAD OPERATIONS, 2L, 2W, 15' (4.5m) TO 24" (600mm) FROM EDGE OF PAVMENT
701501-06	URBAN LANE CLOSURE, 2L, 2W - UNDIVIDED
701901-08	TRAFFIC CONTROL DEVICES

### NOTES:

MATERIALS TO BE USED SHALL BE

#### BITUMINOUS:

- HF-P
- 0.4 GAL/SY COVER COAT
- 0.4 GAL/SY SEAL COAT

#### AGGREGATE:

CM13 AIR COOLED BLAST SLAG OR TRAP ROCK

D-6 OPERATIONS WILL PLACE PERMANENT PAVEMENT MARKINGS.

UP TO 3 SWEEPINGS MAY BE REQUIRED BY A ROTARY TYPE BROOM TO REMOVE EXCESS AGGREGATE.

STATE OF ILLINOIS DEPARTMENT OF TRANSPORTATION DIVISION OF HIGHWAYS DISTRICT 6	
EXAMINED	December 17 20 18 <i>[Signature]</i> ENGINEER OF OPERATIONS
EXAMINED	Nov 21 20 18 <i>[Signature]</i> ENGINEER OF PROJECT IMPLEMENTATION
EXAMINED	December 11 20 18 <i>[Signature]</i> ENGINEER OF PROGRAM DEVELOPMENT

REV. - MS

FILE NAME =	USER NAME = sharptd	DESIGNED -	REVISED -	STATE OF ILLINOIS DEPARTMENT OF TRANSPORTATION	INDEX OF SHEETS, STANDARDS GENERAL NOTES, SIGNATURES	F.A.J. RTE.	SECTION	COUNTY	TOTAL SHEETS	SHEET NO.
S:\CONTRMAINT_CAD\72K90 - FAU 8173 (MORGAN) RD - Morgan Co - A2\PLANS\72K90-shi-2-g		DAMS				8173	(2310)	MORGAN	6	2
Default	PLOT SCALE = 40.0000' / in.	CHECKED -	REVISED -		SCALE: _____ SHEET _____ OF _____ SHEETS STA. _____ TO STA. _____					
	PLOT DATE = 12/20/2018	DATE -	REVISED -							ILLINOIS FED. AID PROJECT CONTRACT NO. 72K90

0-01625-6011  
 100% STATE  
 MORGAN  
 ROADWAY  
 0005  
 URBAN

CODE NO.	ITEM	UNIT	TOTAL QUANTITY	
40300400	BITUMINOUS MATERIALS (COVER AND SEAL COATS)	TON	37	37
40300500	COVER COAT AGGREGATE	TON	125	125
40300600	SEAL COAT AGGREGATE	TON	125	125
40600400	MIXTURE FOR CRACKS, JOINTS, AND FLANGEWAYS	TON	3	3
67100100	MOBILIZATION	L SUM	1	1
70102620	TRAFFIC CONTROL AND PROTECTION, STANDARD 701501	L SUM	1	1
78300200	RAISED REFLECTIVE PAVEMENT MARKER REMOVAL	EACH	57	57

REV. - MS

FILE NAME =	USER NAME = shorptd	DESIGNED -	REVISED -	<b>STATE OF ILLINOIS DEPARTMENT OF TRANSPORTATION</b>	<b>SUMMARY OF QUANTITIES</b>	F.A.J. RTE.	SECTION	COUNTY	TOTAL SHEETS	SHEET NO.	
S:\CONTRMINT_CAD\72K90 - FAU 8173 (HOU	RD - Morgan Co. - A2\PLANS\72K90-sh-3-S	DRAWN - OMS	REVISED -			8173	12310	LOGAN	6	3	
PLOT SCALE = 40.0000' / in.	CHECKED -	REVISED -				<b>CONTRACT NO. 72K90</b>					
PLOT DATE = 11/19/2018	DATE -	REVISED -				SCALE: SHEET OF SHEETS STA. TO STA.		(ILLINOIS) FED. AID PROJECT			

40300400 BITUMINOUS MATERIALS (COVER AND SEAL COATS)					
STA.	TO	STA.	LENGTH	WIDTH	AREA
			FT	FT	SQ YD
1738+35		1782+98	4463	22	10909.56
TOTAL			4463		10909.56
COVER COAT (0.32 GAL/SQ YD * 8.5PPG) (1TON=2000POUND)					
RATE	PPG	POUND	AREA	TON	
0.32	8.5	2000	10909.56	14.84	
SEAL COAT (0.40 GAL/SQ YD * 8.5PPG) (1TON=2000POUND)					
RATE	PPG	POUND	AREA	TON	
0.4	8.5	2000	10909.56	18.55	
TOTAL COVER COAT + SEAL COAT (TON)				33	

40300500 COVER COAT AGGREGATE		
AREA	RATE	TON
SQ YD	TON/SQ YD	
10909.56	0.0125	136

40300600 SEAL COAT AGGREGATE		
AREA	RATE	TON
SQ YD	TON/SQ YD	
10909.56	0.01	109

78300200 RAISED REFLECTIVE PAVEMENT MARKER REMOVAL			
1738+35 TO	LENGTH	SPACING	EACH
1782+98	(FEET)	(FEET)	
	4463	80	57



END PROJECT  
STA. 1782+98



BEGIN PROJECT  
STA. 1738+35

FILE NAME =	USER NAME = sharptd	DESIGNED - _____	REVISED - _____	<b>STATE OF ILLINOIS DEPARTMENT OF TRANSPORTATION</b>	<b>LOCATION MAP</b>			F.A.U. RTE.	SECTION	COUNTY	TOTAL SHEETS	SHEET NO.
S:\CONTRMAINT_CAD\72K90 - FAU 8173 (HOU	ID RD - Morgan Co. - A2\PLANS\72K90-shk-5-p	DRAWN - _____	REVISED - _____		67	12310	MORGAN	6	5			
	PLOT SCALE = 40,0000' / 1" =	CHECKED - _____	REVISED - _____		SCALE: _____ SHEET OF SHEETS STA. _____ TO STA. _____			<b>CONTRACT NO. 72K90</b>				
Default	PLOT DATE = 12/19/2018	DATE - _____	REVISED - _____		ILLINOIS FED. AID PROJECT							

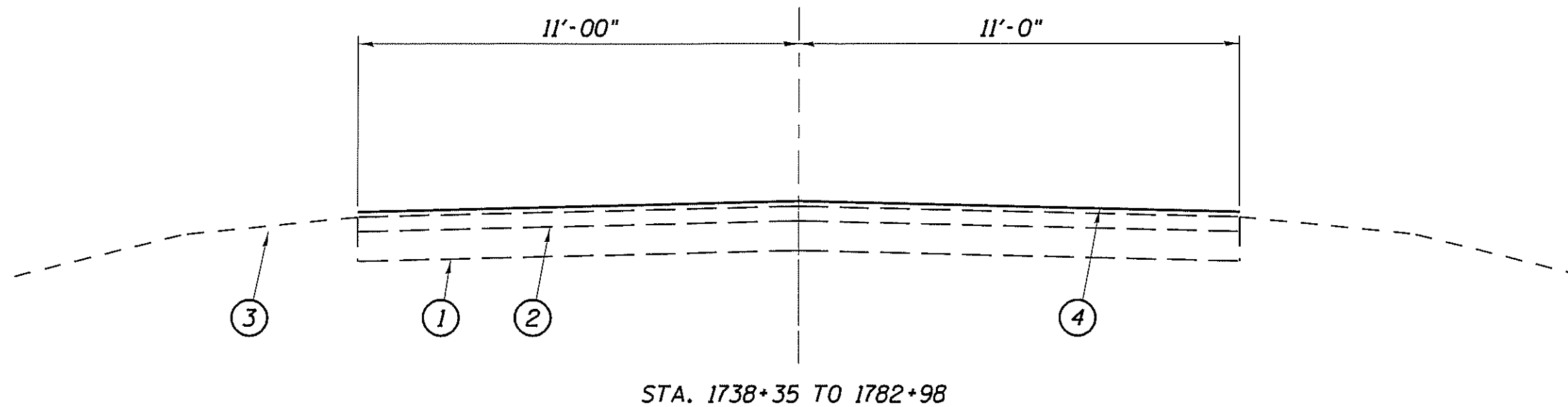

L E G E N D

- 1- EXIST. P.C.C. PAVEMENT
- 2- EXIST. H.M.A SURFACE
- 3- EXIST. AGGREGATE SHOULDERS, TYPE B
- 4- PROP. BITUMINOUS SURFACE TREATMENT, A-2

FILE NAME =	USER NAME = sherpdt	DESIGNED -	REVISED -	<b>STATE OF ILLINOIS DEPARTMENT OF TRANSPORTATION</b>	<b>TYPICALS</b>	F.A.I. RTE. =	SECTION	COUNTY	TOTAL SHEETS	SHEET NO.
S:\CONTRMANT_CAD\72K90 - FAU 0173 (MORGAN RD) - Morgan Co. - A2\PLANS\72K90-sht-8-typ		GRANIN	REVISED -			0173	(2310)	MORGAN	6	6
Default	PLOT SCALE = 3.0000 / 1 in.	CHECKED -	REVISED -		SCALE:					CONTRACT NO. 72K90
	PLOT DATE = 11/19/2018	DATE -	REVISED -		SHEET	OF	SHEETS	STA.	TO STA.	ILLINOIS FED. AID PROJECT