

STATE OF ILLINOIS  
DEPARTMENT OF TRANSPORTATION

F.A.P. RTE.	SECTION	COUNTY	TOTAL SHEETS	SHEET NO.
681	116RS-2, 117RS-3	IROQUOIS	27	1
		ILLINOIS	CONTRACT NO. 66C45	

FOR INDEX OF SHEETS, SEE SHEET NO. 2

# PROPOSED HIGHWAY PLANS

FAP ROUTE 681 ( IL-116 )  
SECTION 116RS-2, 117RS-3  
PROJECT STP-Q4II(638)  
RESURFACING (DESIGNED OVERLAY)  
IROQUOIS COUNTY

C-93-145-12

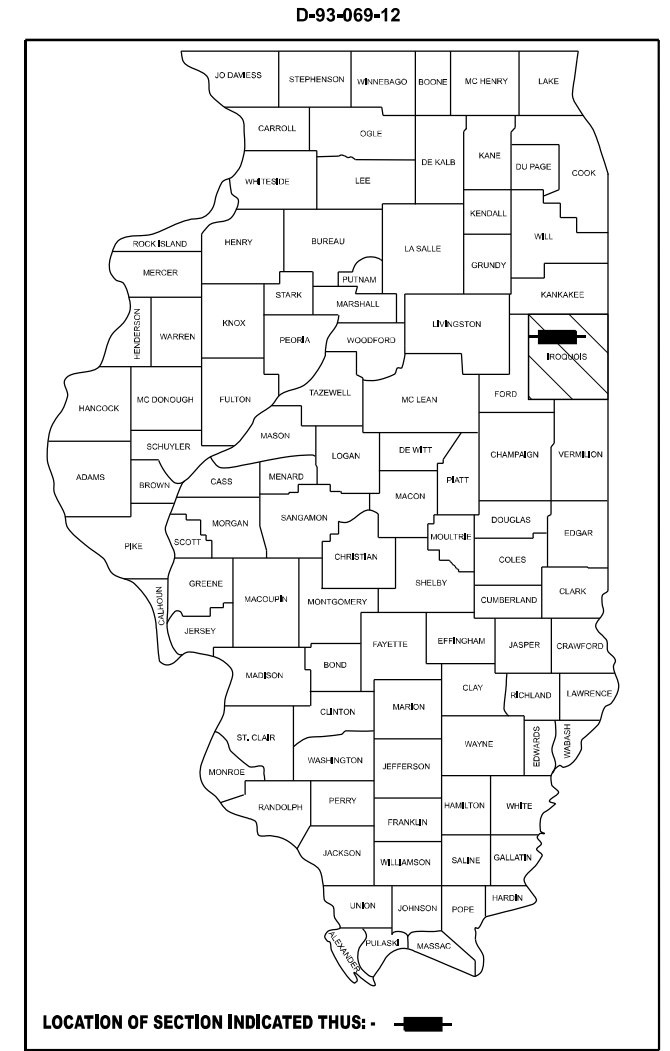

MINOR ARTERIAL  
2024 ADT = 1350  
P.V.=76.16%  
S.U.=11.11%  
M.U.=17.73%

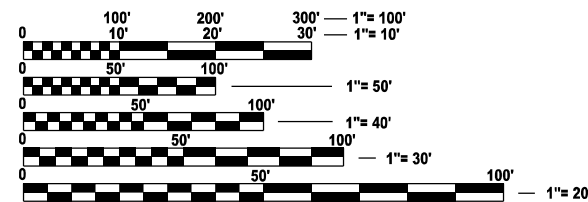

FULL SIZE PLANS HAVE BEEN PREPARED USING STANDARD ENGINEERING SCALES. REDUCED SIZED PLANS WILL NOT CONFORM TO STANDARD SCALES. IN MAKING MEASUREMENTS ON REDUCED PLANS, THE ABOVE SCALES MAY BE USED.

J.U.L.I.E.  
JOINT UTILITY LOCATION INFORMATION FOR EXCAVATION  
1-800-892-0123  
OR 811

PROJECT ENGINEER: JOE KANNEL, P.E.  
UNIT CHIEF: STEPHENIE CARMIN

CONTRACT NO. 66C45

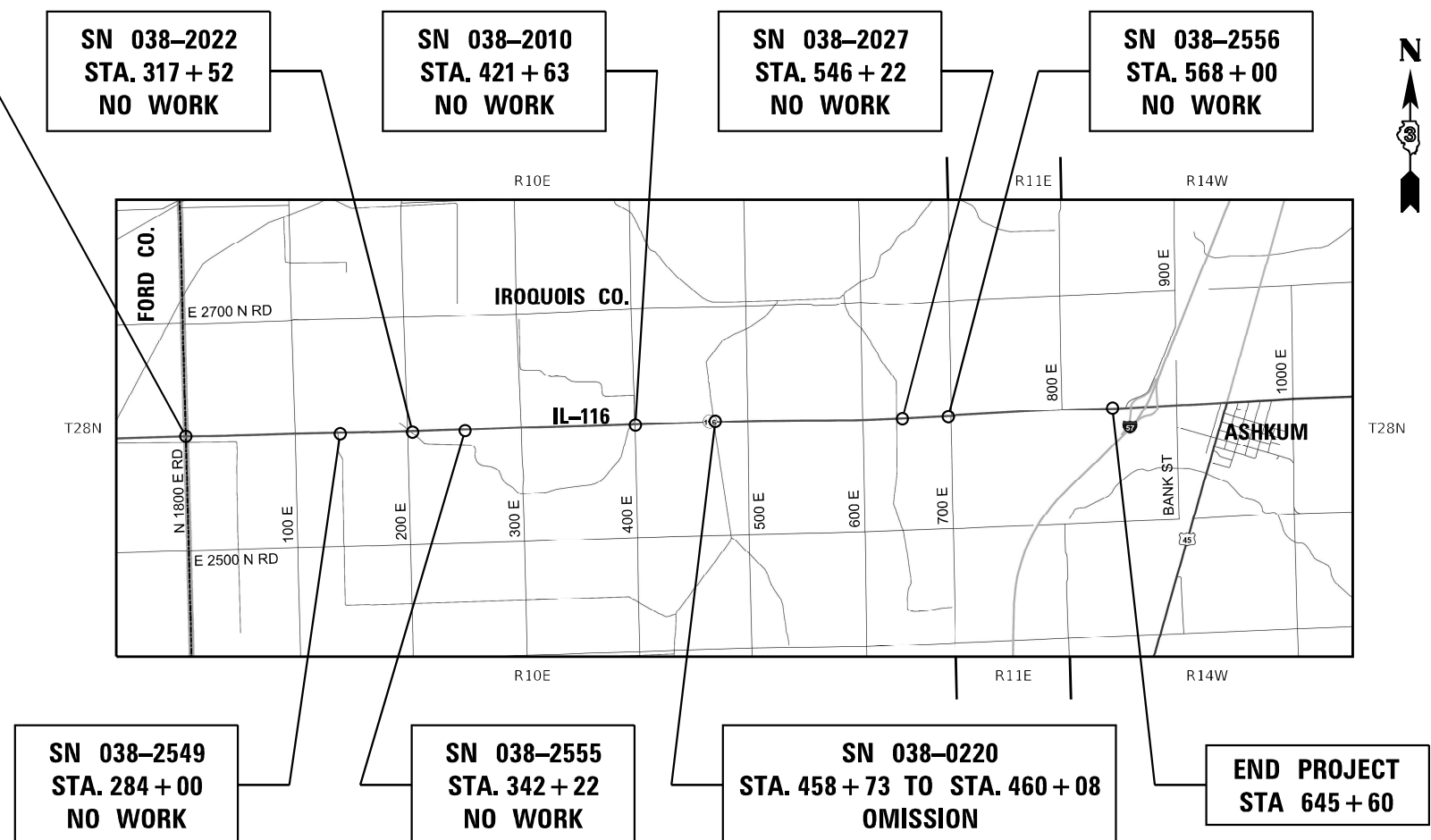

GROSS LENGTH = 43356.51 FT. = 8.21 MILES  
NET LENGTH = 43221.51 FT. = 8.19 MILE

STATE OF ILLINOIS  
DEPARTMENT OF TRANSPORTATION

SUBMITTED February 07, 2024

*Stephen M. Travin*  
REGIONAL ENGINEER

March 22, 2024  
*Joe Kannel*  
ENGINEER OF DESIGN AND ENVIRONMENT

March 22, 2024  
*Stephen M. Travin*  
DIRECTOR OF HIGHWAYS PROJECT IMPLEMENTATION

PRINTED BY THE AUTHORITY  
OF THE STATE OF ILLINOIS

**INDEX OF SHEETS**

- 1 COVER SHEET
- 2 GENERAL NOTES, HWY STANDARDS & HMA MIX TABLE
- 3 - 7 SUMMARY OF QUANTITIES
- 8 - 9 TYPICAL SECTIONS
- 10 LINE DIAGRAM
- 11 - 21 SCHEDULES
- 22 - 27 DETAILS

**GENERAL NOTES**

THE HMA SURFACE OF ALL MAILBOX TURNOUTS, PRIVATE ENTRANCES, COMMERCIAL ENTRANCES, AND SIDE ROADS SHALL BE MADE NEATLY, IN A WORKMANLIKE MANNER, AND SHALL ACCURATELY CONFORM TO THE SHAPES AND DIMENSIONS SHOWN ON THE PLAN DETAILS. IF REQUIRED BY THE ENGINEER, THE CONTRACTOR SHALL SAW CUT THE HMA SURFACE TO CONFORM TO THE SHAPES AND DIMENSIONS SHOWN ON THE PLAN DETAILS. THIS WORK WILL BE INCLUDED IN THE COST OF THE HMA SURFACE.

EXCEPT AS NOTED ON THE PLANS, PAVEMENT GRADES SHOWN ARE AT THE TOP OF PAVEMENT SURFACES.

BEFORE ORDERING PIPE CULVERTS OR PIPE DRAINS, THE CONTRACTOR SHALL CONSULT THE ENGINEER FOR EXACT LENGTHS.

THE ENGINEER WILL BE THE SOLE JUDGE CONCERNING CURING TIME FOR THE VARIOUS HMA LIFTS.

THE FINISHED EARTHWORK SHALL HAVE A VEGETATION SUSTAINING SOIL COVERING THE TOP FOUR INCHES ( 100 MILLIMETERS) IN AREAS TO BE SEEDED OR SODDED. THE VEGETATION SUSTAINING SOIL REQUIRED WILL NOT BE PAID FOR SEPARATELY BUT WILL BE INCLUDED IN THE COST OF FURNISHED EXCAVATION.

ALL ELEVATIONS REFERRING TO U.S.G.S. MEAN SEA LEVEL DATUM.

THE FOLLOWING RATES OF APPLICATION HAVE BEEN USED IN CALCULATING PLAN QUANTITIES:

GRANULAR MATERIALS	2.05	TONS / CU YD
HMA RESURFACING	112	LBS / SQ YD / IN
SHORT TERM PAVEMENT MARKING	10	FT /100 FT OF APPLICATION
MIX FOR CRACKS, JTS & FLGWYS	0.0003	TONS / SQ YD
HMA BINDER (HAND METHOD)	0.0005	TONS / SQ YD

MEMBERS OF JULIE KNOWN TO BE WITHIN THE LIMITS OF THE IMPROVEMENT ARE:

- Eastern Illini Electric Co-op
- Frontier Communications
- Midwestern Gas Transmission
- Nicor Gas
- Bluebird Network
- Buckeye Partners

**LIST OF ILLINOIS DOT HIGHWAY STANDARDS**

- 000001-08 STANDARD SYMBOLS, ABBREVIATIONS AND PATTERNS
- 001001-02 AREAS OF REINFORCEMENT BARS
- 001006 DECIMAL OF AN INCH AND OF A FOOT
- 280001-07 TEMPORARY EROSION CONTROL SYSTEMS
- 406201-01 MAILBOX TURNOUT
- 442101-09 CLASS B PATCHES
- 542306-03 PRECAST REINFORCED CONCRETE ELLIPTICAL FLARED END SECTION
- 635001-02 DELINEATORS
- 701001-02 OFF-ROAD OPERATIONS 2L, 2W, MORE THAN 15' AWAY
- 701006-05 OFF-ROAD OPERATIONS 2L, 2W, 15' TO 24" FROM PAVEMENT EDGE
- 701011-04 OFF-ROAD MOVING OPERATIONS 2L, 2W, DAY ONLY
- 701201-05 LANE CLOSURE, 2L, 2W, DAY ONLY, FOR SPEEDS  $\geq$  45 MPH
- 701301-04 LANE CLOSURE, 2L, 2W, SHORT TIME OPERATIONS
- 701306-04 LANE CLOSURE, 2L, 2W, SLOW MOVING OPERATIONS DAY ONLY, FOR SPEEDS  $\geq$  45 MPH
- 701311-03 LANE CLOSURE, 2L, 2W, MOVING OPERATIONS - DAY ONLY
- 701336-07 LANE CLOSURE, 2L, 2W, WORK AREAS IN SERIES, FOR SPEEDS  $\geq$  45 MPH
- 701901-09 TRAFFIC CONTROL DEVICES
- 720011-01 METAL POSTS FOR SIGNS, MARKERS AND DELINEATORS
- 780001-05 TYPICAL PAVEMENT MARKINGS
- 781001-04 TYPICAL APPLICATIONS RAISED REFLECTIVE PAVEMENT MARKERS

**COMMITMENTS**

NONE

**HMA MIXTURE REQUIREMENT TABLE**

LOCATIONS:	ENTIRE PROJECT	ENTIRE PROJECT	ENTIRE PROJECT
MIXTURE USE(S):	HMA SURFACE	HMA BINDER	HMA INCIDENTAL
BINDER GRADE (PG):	PG 64-22	PG 64-22	PG 64-22
DESIGN AIR VOIDS:	4.0% @ N50	4.0% @ N50	4.0% @ N50
MIXTURE COMPOSITION: (MIXTURE GRADATION)	IL 9.5	IL 19.0	IL 9.5
FRICTION AGGREGATE:	MIXTURE C		
MIXTURE WEIGHT:	112.0 LB/SY/IN	112.0 LB/SY/IN	112.0 LB/SY/IN
QUALITY MANAGEMENT PROGRAM:	QCP	QCP	QCQA
SUBLOT SIZE:	1000 TONS	1000 TONS	NA
DENSITY TEST METHOD:	CORES	CORES	CORES/NUCLEAR
MATERIAL TRANSFER DEVICE (REQUIRED)	YES	YES	NO

STATE OF ILLINOIS  
DEPARTMENT OF TRANSPORTATION  
DISTRICT THREE  
AS BUILT INFORMATION

\_\_\_\_\_  
SUPERVISING CONSTRUCTION FIELD ENGINEER

\_\_\_\_\_  
RESIDENT ENGINEER / TECHNICIAN

START & END DATES  
OF CONSTRUCTION:

INSPECTORS:

MODEL: Default  
FILE NAME: c:\pwworking\jzagar\0228610\66C45 - Cover, General Notes & Standards.dgn

USER NAME = Joseph.Zagar	DESIGNED -	REVISED -	<b>STATE OF ILLINOIS DEPARTMENT OF TRANSPORTATION</b>	<b>HIGHWAY STANDARS, GENERAL NOTES &amp; HMA MIX TABLE</b>				F.A.P. RTE.	SECTION	COUNTY	TOTAL SHEETS	SHEET NO.
DRAWN -	REVISED -	681						116RS-2, 117RS-3	IROQUOIS	27	2	
PLOT SCALE = \$SCALE\$	CHECKED -	REVISED -		CONTRACT NO. 66C45				ILLINOIS FED. AID PROJECT				
PLOT DATE = 2/5/2024	DATE -	REVISED -		SCALE:	SHEET	OF	SHEETS	STA.	TO	STA.		

MODEL: Default  
 FILE NAME: c:\pwwork\jzagark\0228610\66C45-S00.dgn

CODE NO.	ITEM	UNIT	TOTAL QUANTITY	CONSTR. CODE
				80% FED 20% STATE
				ROADWAY
				0005 RURAL
20200100	EARTH EXCAVATION	CU YD	137	137
20400800	FURNISHED EXCAVATION	CU YD	35	35
20800150	TRENCH BACKFILL	CU YD	10	10
21400100	GRADING AND SHAPING DITCHES	FOOT	756	756
25000210	SEEDING, CLASS 2A	ACRE	0.25	0.25
25000400	NITROGEN FERTILIZER NUTRIENT	POUND	11	11
25000500	PHOSPHORUS FERTILIZER NUTRIENT	POUND	11	11
25000600	POTASSIUM FERTILIZER NUTRIENT	POUND	11	11
25100630	EROSION CONTROL BLANKET	SQ YD	565	565
28100107	STONE RIPRAP, CLASS A4	SQ YD	47	47
28200200	FILTER FABRIC	SQ YD	47	47
40200800	AGGREGATE SURFACE COURSE, TYPE B	TON	2	2
40600290	BITUMINOUS MATERIALS (TACK COAT)	POUND	87343	87343
40600370	LONGITUDINAL JOINT SEALANT	FOOT	43222	43222

\* SPECIALITY ITEMS

USER NAME = Joseph.Zagar	DESIGNED -	REVISED -
PLOT SCALE = \$SCALE\$	DRAWN -	REVISED -
PLOT DATE = 2/7/2024	CHECKED -	REVISED -
	DATE -	REVISED -

**STATE OF ILLINOIS  
 DEPARTMENT OF TRANSPORTATION**

**SUMMARY OF QUANTITIES**

SCALE: SHEET 1 OF 10 SHEETS STA. TO STA.

F.A.I. RTE.	SECTION	COUNTY	TOTAL SHEETS	SHEET NO.
681	116RS-2, 117RS-3	IROQUOIS	27	3
CONTRACT NO. 66C45				
ILLINOIS FED. AID PROJECT				

MODEL: Default  
 FILE NAME: c:\pwwork\jzagark\0228610\66C45-SOQ.dgn

CODE NO.	ITEM	UNIT	TOTAL QUANTITY	CONSTR. CODE	
				80% FED 20% STATE	
				ROADWAY	
				0005	
				RURAL	
40600400	MIXTURE FOR CRACKS, JOINTS, AND FLANGEWAYS	TON	38		38
40600900	HOT-MIX ASPHALT BINDER COURSE (HAND METHOD), N50	TON	62		62
40600990	TEMPORARY RAMP	SQ YD	742		742
40603080	HOT-MIX ASPHALT BINDER COURSE, IL-19.0, N50	TON	15733		15733
40604050	HOT-MIX ASPHALT SURFACE COURSE, IL-9.5, MIX "C", N50	TON	10490		10490
40800050	INCIDENTAL HOT-MIX ASPHALT SURFACING	TON	665		665
44000164	HOT-MIX ASPHALT SURFACE REMOVAL, 3 3/4"	SQ YD	124863		124863
44200050	WELDED WIRE REINFORCEMENT	SQ YD	513		513
44201019	CLASS B PATCHES, TYPE II, 14 INCH	SQ YD	464		464
44201023	CLASS B PATCHES, TYPE III, 14 INCH	SQ YD	122		122
44201025	CLASS B PATCHES, TYPE IV, 14 INCH	SQ YD	152		152
44201043	CLASS B PATCHES, TYPE II, 16 INCH	SQ YD	771		771
44201047	CLASS B PATCHES, TYPE III, 16 INCH	SQ YD	210		210
44201048	CLASS B PATCHES, TYPE IV, 16 INCH	SQ YD	29		29

\* SPECIALITY ITEMS

USER NAME = Joseph.Zagar	DESIGNED -	REVISED -
PLOT SCALE = \$SCALE\$	DRAWN -	REVISED -
PLOT DATE = 2/7/2024	CHECKED -	REVISED -
	DATE -	REVISED -

**STATE OF ILLINOIS  
 DEPARTMENT OF TRANSPORTATION**

**SUMMARY OF QUANTITIES**

SCALE: SHEET 1 OF 10 SHEETS STA. TO STA.

F.A.I. RTE.	SECTION	COUNTY	TOTAL SHEETS	SHEET NO.
681	116RS-2, 117RS-3	IROQUOIS	27	4
CONTRACT NO. 66C45				
ILLINOIS FED. AID PROJECT				

MODEL: Default  
 FILE NAME: c:\pwwork\jzagark\0228610\66C45-S00.dgn

CODE NO.	ITEM	UNIT	TOTAL QUANTITY	CONSTR. CODE	
				80% FED 20% STATE	
				ROADWAY	
				0005	
				RURAL	
44201297	DOWEL BARS 1"	EACH	2580		2580
44213200	SAWCUTS	FOOT	7486		7486
44213204	TIE BARS 3/4"	EACH	44		44
48102100	AGGREGATE WEDGE SHOULDER, TYPE B	TON	3023		3023
50104400	CONCRETE HEADWALL REMOVAL	EACH	4		4
50105220	PIPE CULVERT REMOVAL	FOOT	42		42
542A8203	PIPE CULVERTS, CLASS A, TYPE 2 EQUIVALENT ROUND-SIZE 18"	FOOT	38		38
54214503	PRECAST REINFORCED CONCRETE FLARED END SECTIONS, EQUIVALENT ROUND-SIZE 18"	EACH	2		2
59300100	CONTROLLED LOW-STRENGTH MATERIAL	CU YD	3		3
60905305	BOX CULVERTS TO BE CLEANED	FOOT	72		72
63500105	DELINEATORS	EACH	18		18
* 66700205	PERMANENT SURVEY MARKERS, TYPE I	EACH	11		11
* 66900200	NON-SPECIAL WASTE DISPOSAL	CU YD	8		8
* 66900530	SOIL DISPOSAL ANALYSIS	EACH	1		1

\* SPECIALITY ITEMS

USER NAME = Joseph.Zagar	DESIGNED -	REVISED -	<b>STATE OF ILLINOIS DEPARTMENT OF TRANSPORTATION</b>	<b>SUMMARY OF QUANTITIES</b>			F.A.I. RTE.	SECTION	COUNTY	TOTAL SHEETS	SHEET NO.
PLOT SCALE = \$SCALE\$	DRAWN -	REVISED -					681	116RS-2, 117RS-3	IROQUOIS	27	5
PLOT DATE = 2/7/2024	CHECKED -	REVISED -		SCALE: SHEET 1 OF 10 SHEETS STA. TO STA.			CONTRACT NO. 66C45				
	DATE -	REVISED -					ILLINOIS FED. AID PROJECT				

MODEL: Default  
 FILE NAME: c:\p\work\pww\del\zagar\k0228610\66C45-S00.dgn

CODE NO.	ITEM	UNIT	TOTAL QUANTITY	CONSTR. CODE	
				80% FED 20% STATE	
				ROADWAY	
				0005	
				RURAL	
* 66901001	REGULATED SUBSTANCES PRE CONSTRUCTION PLAN	L SUM	1		1
* 66901003	REGULATED SUBSTANCES FINAL CONSTRUCTION REPORT	L SUM	1		1
* 66901006	REGULATED SUBSTANCES MONITORING	CAL DA	2		2
67000400	ENGINEER'S FIELD OFFICE, TYPE A	CAL MO	4		4
67100100	MOBILIZATION	L SUM	1		1
70100450	TRAFFIC CONTROL AND PROTECTION, STANDARD 701201	L SUM	1		1
70100460	TRAFFIC CONTROL AND PROTECTION, STANDARD 701306	L SUM	1		1
70100600	TRAFFIC CONTROL AND PROTECTION, STANDARD 701336	L SUM	1		1
70300100	SHORT TERM PAVEMENT MARKING	FOOT	8680		8680
70300150	SHORT TERM PAVEMENT MARKING REMOVAL	SQ FT	2900		2900
* 78009004	MODIFIED URETHANE PAVEMENT MARKING - LINE 4"	FOOT	169658		169658
* 78009006	MODIFIED URETHANE PAVEMENT MARKING - LINE 6"	FOOT	21622		21622
* 78100100	RAISED REFLECTIVE PAVEMENT MARKER	EACH	539		539
78300200	RAISED REFLECTIVE PAVEMENT MARKER REMOVAL	EACH	459		459

\* SPECIALITY ITEMS

USER NAME = Joseph.Zagar	DESIGNED -	REVISED -
PLOT SCALE = \$\$SCALE\$	DRAWN -	REVISED -
PLOT DATE = 2/7/2024	CHECKED -	REVISED -
	DATE -	REVISED -

**STATE OF ILLINOIS  
 DEPARTMENT OF TRANSPORTATION**

SUMMARY OF QUANTITIES			
SCALE:	SHEET 1	OF 10 SHEETS	STA. TO STA.

F.A.I. RTE.	SECTION	COUNTY	TOTAL SHEETS	SHEET NO.
681	116RS-2, 117RS-3	IROQUOIS	27	6
CONTRACT NO. 66C45				
ILLINOIS FED. AID PROJECT				

CODE NO.	ITEM	UNIT	TOTAL QUANTITY	CONSTR. CODE
				80% FED 20% STATE
				ROADWAY
				0005
				RURAL
X4401198	HOT-MIX ASPHALT SURFACE REMOVAL, VARIABLE DEPTH	SQ YD	4531	4531
X6350120	DELINEATOR REMOVAL	EACH	18	18
Z0034105	MATERIAL TRANSFER DEVICE	TONS	26,233	26,233
X6350204	LINEAR DELINEATOR PANELS, 4 INCH	EACH	185	185
∅ Z0076600	TRAINEES	HOUR	1,000	1,000
X6350206	LINEAR DELINEATOR PANELS, 6 INCH	EACH	4	4
∅ Z0076604	TRAINEES - TRAINING PROGRAM GRADUATE	HOUR	1,000	1,000
Z0030850	TEMPORARY INFORMATION SIGNING	SQ FT	42	42

\* SPECIALITY ITEMS

∅ 0042

MODEL: Default  
FILE NAME: c:\p\work\pww\del\zagar\k0228610\66C45-S00.dgn

USER NAME = Joseph.Zagar	DESIGNED -	REVISED -
	DRAWN -	REVISED -
PLOT SCALE = \$\$SCALE\$	CHECKED -	REVISED -
PLOT DATE = 2/7/2024	DATE -	REVISED -

**STATE OF ILLINOIS  
DEPARTMENT OF TRANSPORTATION**

**SUMMARY OF QUANTITIES**

SCALE: SHEET 1 OF 10 SHEETS STA. TO STA.

F.A.I. RTE.	SECTION	COUNTY	TOTAL SHEETS	SHEET NO.
681	116RS-2, 117RS-3	IROQUOIS	27	7
CONTRACT NO. 66C45				
ILLINOIS FED. AID PROJECT				

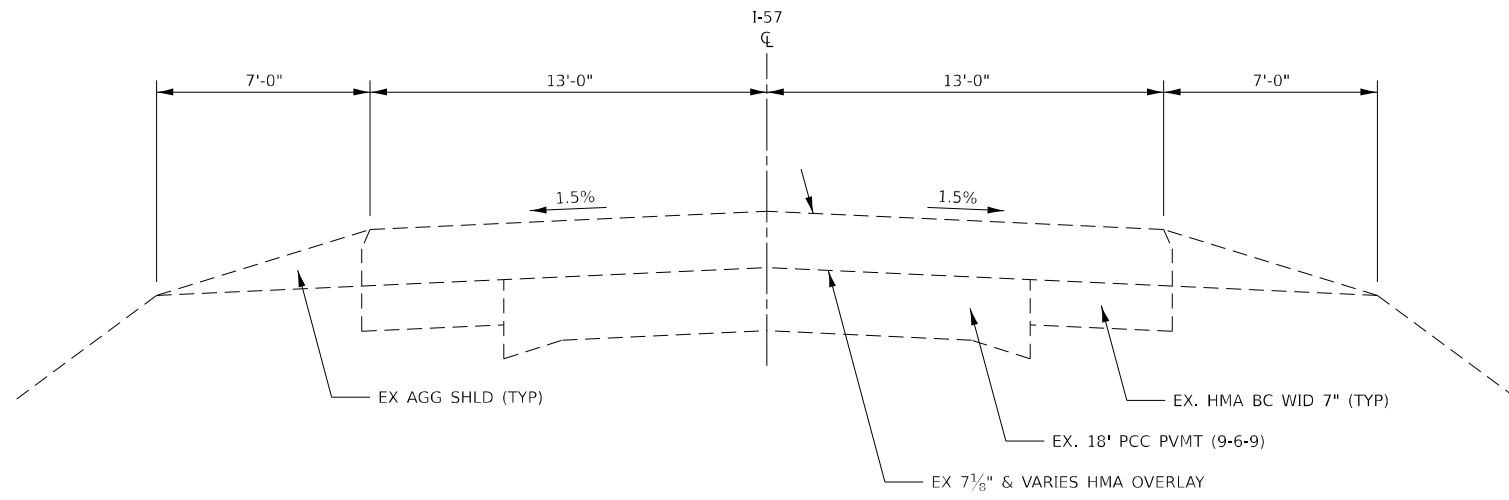

**EXISTING TYPICAL SECTION 1**

STA. 211+84 TO STA 353+96

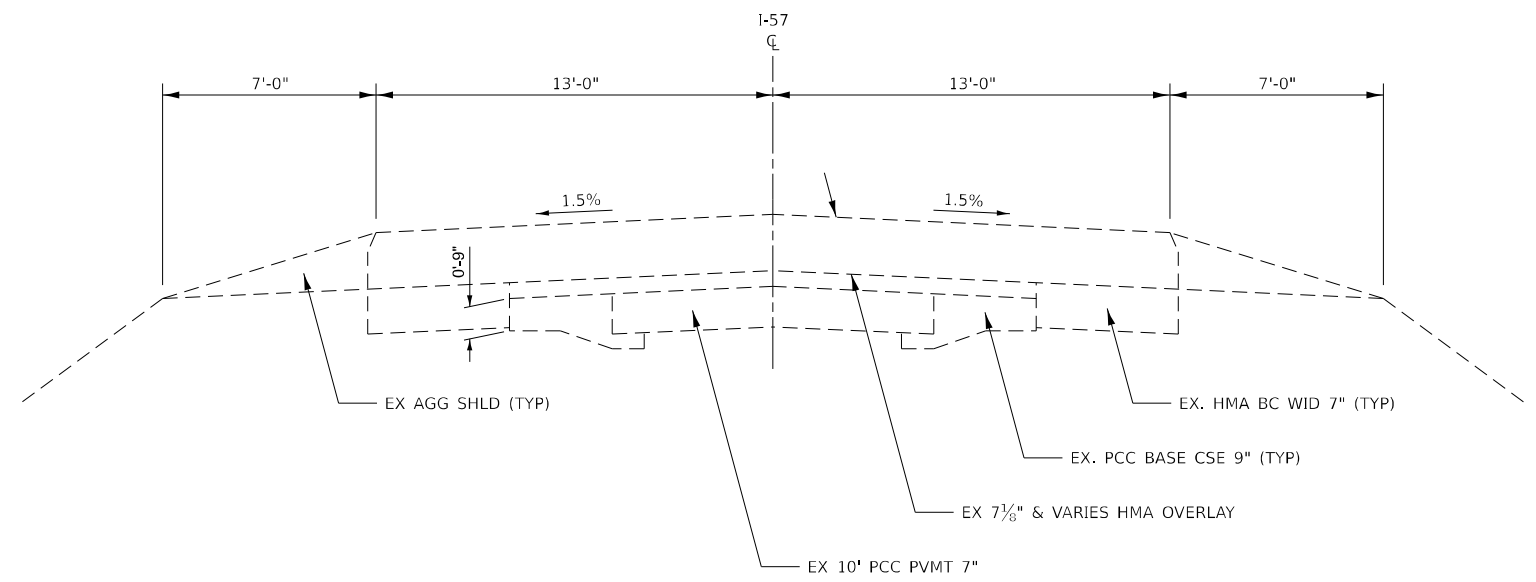

**EXISTING TYPICAL SECTION 2**

STA. 353+96 TO STA 645+60

MODEL: Default  
FILE NAME: c:\p\work\pvt\zagar\k0228610\66C4E-Typical.dgn

USER NAME = Joseph.Zagar	DESIGNED -	REVISED -
	DRAWN -	REVISED -
PLOT SCALE = \$SCALE\$	CHECKED -	REVISED -
PLOT DATE = 2/5/2024	DATE -	REVISED -

**STATE OF ILLINOIS  
DEPARTMENT OF TRANSPORTATION**

**EXISTING IL-116 TYPICAL SECTIONS**

SCALE: SHEET OF SHEETS STA. TO STA.

F.A.P. RTE.	SECTION	COUNTY	TOTAL SHEETS	SHEET NO.
681	116RS-2, 117RS-3	IROQUOIS	27	8
CONTRACT NO. 66C45				
		ILLINOIS	FED. AID PROJECT	



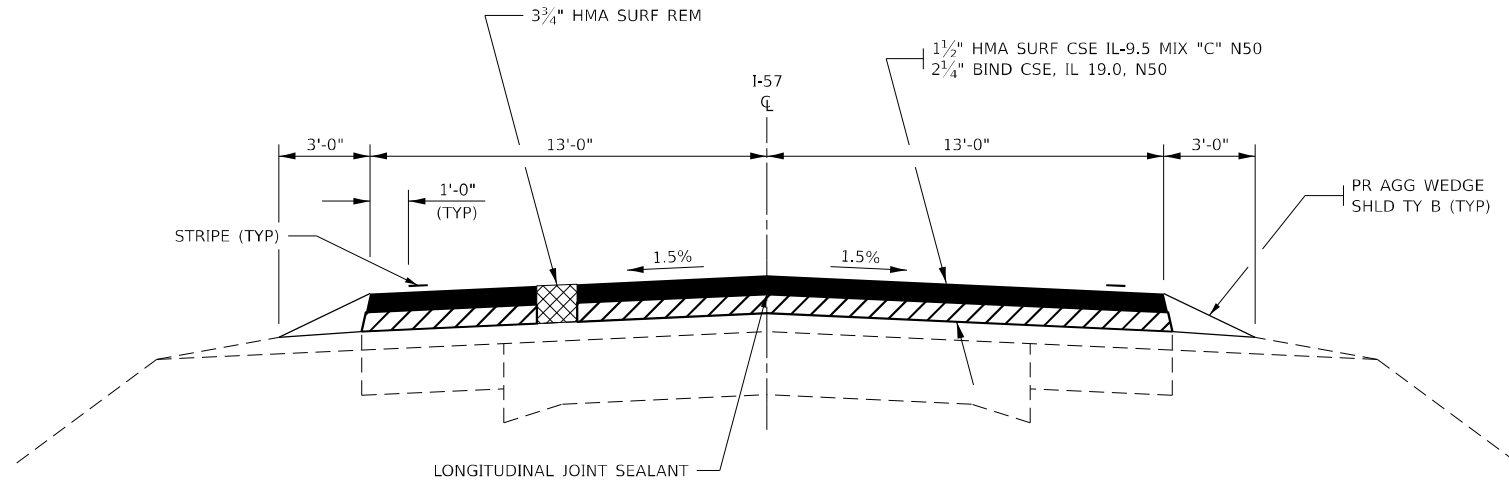

**PROPOSED TYPICAL SECTION 1**

STA. 211+84 TO STA 353+96

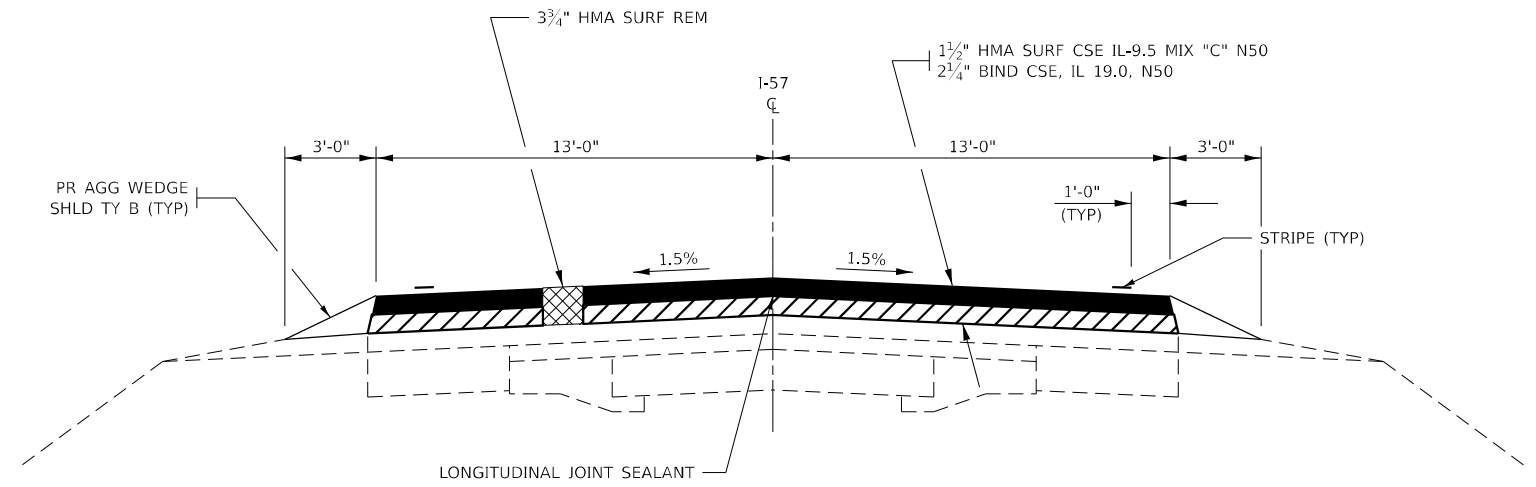

**PROPOSED TYPICAL SECTION 2**

STA. 353+96 TO STA 645+60

OMISSION SN 038-0220  
STA 458+73 TO STA 460+08

MODEL: Default  
FILE NAME: c:\p\work\p\work\zagar\k0228610\66C45-Typical.dgn

USER NAME = Joseph.Zagar	DESIGNED -	REVISED -
	DRAWN -	REVISED -
PLOT SCALE = \$SCALE\$	CHECKED -	REVISED -
PLOT DATE = 2/5/2024	DATE -	REVISED -

**STATE OF ILLINOIS  
DEPARTMENT OF TRANSPORTATION**

**PROPOSED IL-116 TYPICAL SECTIONS**

SCALE: SHEET OF SHEETS STA. TO STA.

F.A.P. RTE.	SECTION	COUNTY	TOTAL SHEETS	SHEET NO.
681	116RS-2, 117RS-3	IROQUOIS	27	9
CONTRACT NO. 66C45				
ILLINOIS FED. AID PROJECT				



NOT TO SCALE

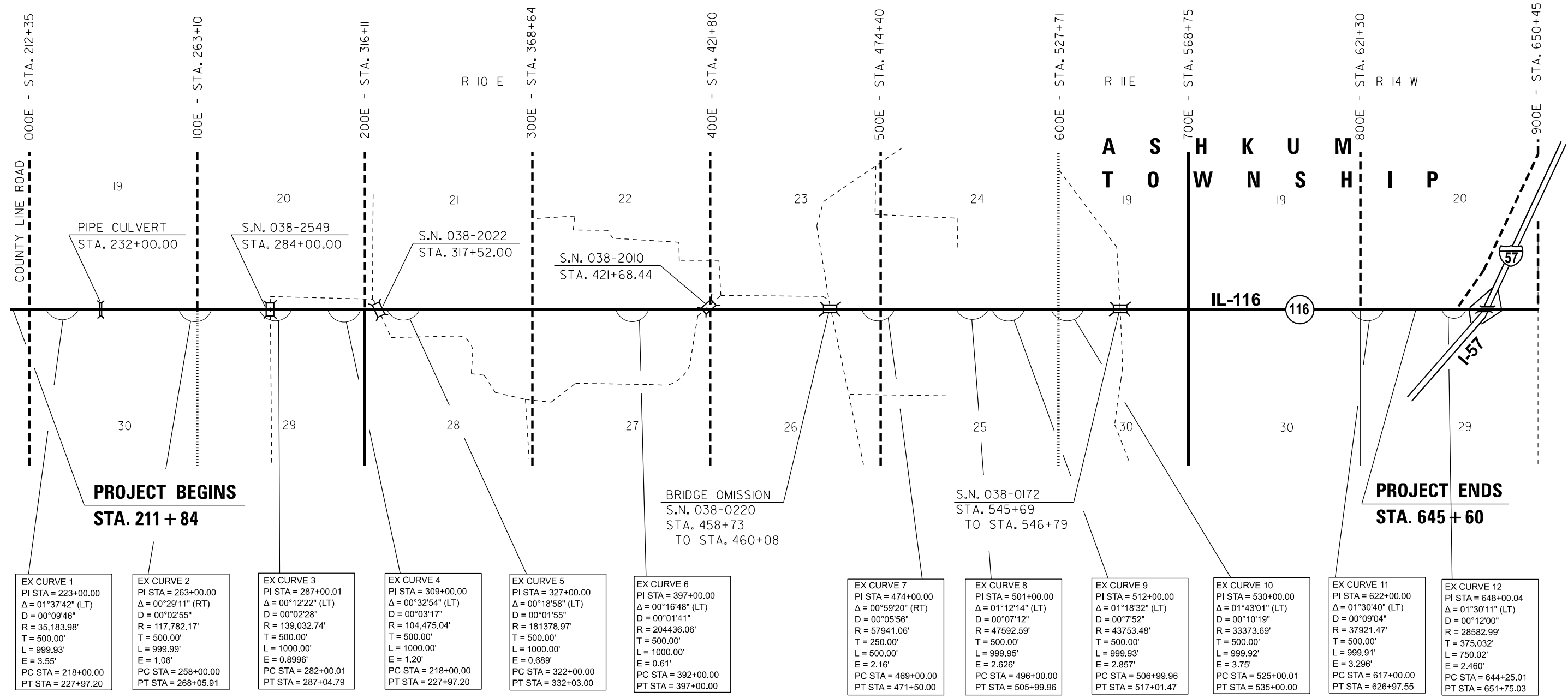

MODEL: Default  
FILE NAME: c:\pwworking\jzagark\d028610\66C45-Line Diagram.dgn

USER NAME = Joseph.Zagar	DESIGNED -	REVISED -
DRAWN -	REVISED -	
PLOT SCALE = \$SCALE\$	CHECKED -	REVISED -
PLOT DATE = 1/12/2024	DATE -	REVISED -

**STATE OF ILLINOIS  
DEPARTMENT OF TRANSPORTATION**

**LINE DIAGRAM  
MAINLINE CURVES**

SCALE: SHEET OF SHEETS STA. TO STA.

F.A.P. RTE.	SECTION	COUNTY	TOTAL SHEETS	SHEET NO.
681	116RS-2, 117RS-3	IROQUOIS	27	10
CONTRACT NO. 66C45				
ILLINOIS FED. AID PROJECT				

# MAINLINE SCHEDULE

LOCATION		LENGTH	MAINLINE WIDTH	AREA	HMA SURF REM 3 3/4"	HMA BC HM N50	HMA BC IL-19.0 N50 (2 1/4")	HMA SC IL-9.5 C N50 (1 1/2")	MIX CR JTS & FLANGEWYS	BIT MATLS TACK CT	LONG JOINT SEALANT	AGG WEDGE SHLD TYP B	TEMP RAMP	MATL TRANSFER DEVICE			
STA	TO	STA			SQ YD	SQ YD	TON	TON	TON	TON	POUND	FOOT	TON	SQ YD	TON		
211+84	TO	227+99.93	BK		1,616	26	4,668	4,668	2.3	588	392	1.4	3150.9	1,616	110	50	980
227+97.20	AI	TO	262+98		3,501	26	10,113	10,113	5.1	1274	849	3.0	6826	3,501	247		2123
262+98	TO	267+99.99	BK		502	26	1,450	1,450	0.7	183	122	0.4	979	502	34		305
268+05.91	AH	IO	287+00.00	BK	1,894	26	5,472	5,472	2.7	689	460	1.6	3694	1,894	135		1149
287+04.79	AH	TO	309+00.00	BK	2,195	26	6,342	6,342	3.2	799	533	1.9	4281	2,195	156		1332
309+03.01	AH	TO	315+80		677	26	1,956	1,956	1.0	246	164	0.6	1320	677	43		410
315+80	TO	327+00.00	BK		1,120	26	3,236	3,236	1.6	408	272	1.0	2184	1,120	74		680
327+03.00	AH	TO	347+00.00	BK	1,997	26	5,769	5,769	2.9	727	485	1.7	3894	1,997	142		1212
347+02.25	AH	TO	368+69		2,167	26	6,260	6,260	3.1	789	526	1.9	4226	2,167	152		1315
368+69	TO	421+72			5,303	26	15,320	15,320	7.7	1930	1287	4.6	10341	5,303	368		3217
421+72	TO	422+00.00	BK		28	26	81	81	0.04	10	7	0.0	55	28			17
422+02.00	AH	TO	458+73		3,671	26	10,605	10,605	5.3	1336	891	3.2	7158	3,671	261	50	2227
458+73	TO	460+08		SN 038-0220 CMISSION	135												
460+08	TO	474+00.00	BK		1,392	26	4,021	4,021	2.0	507	338	1.2	2714	1,392	99	50	845
474+02.02	AH	TO	474+31		29	26	84	84	0.04	11	7	0.0	57	29			18
474+31	TO	512+00.00	BK		3,769	26	10,888	10,888	5.4	1372	915	3.3	7349	3,769	266		2287
512+01.55	AH	TO	527+78		1,576	26	4,554	4,554	2.3	574	383	1.4	3074	1,576	110		957
527+78	TO	534+99.93	BK		722	26	2,086	2,086	1.0	263	175	0.6	1408	722	49		438
535+00.00	AH	TO	568+88		3,388	26	9,788	9,788	4.9	1233	822	2.9	6607	3,388	237		2055
568+88	TO	621+34			5,246	26	15,155	15,155	7.6	1910	1273	4.5	10230	5,246	368		3183
621+34	TO	626+99.94	BK		566	26	1,635	1,635	0.8	206	137	0.5	1104	566	39		343
626+97.55	AH	TO	645+60		1,862	26	5,380	5,380	2.7	678	452	1.6	3632	1,862	133	50	1130
<b>TOTAL</b>					<b>43,222</b>		<b>124,863</b>	<b>124,863</b>	<b>62</b>	<b>15,733</b>	<b>10,490</b>	<b>38</b>	<b>84,284</b>	<b>43,222</b>	<b>3,023</b>	<b>200</b>	<b>26,223</b>

MODEL: Default  
 FILE NAME: c:\pwworking\jzagark\0228610\66C45-Schedules.dgn

USER NAME = Joseph.Zagar	DESIGNED -	REVISED -
	DRAWN -	REVISED -
PLOT SCALE = \$SCALE\$	CHECKED -	REVISED -
PLOT DATE = 2/7/2024	DATE -	REVISED -

**STATE OF ILLINOIS**  
**DEPARTMENT OF TRANSPORTATION**

SCHEDULES			
SCALE:	SHEET	OF	SHEETS
	STA.		TO STA.

F.A.P. RTE.	SECTION	COUNTY	TOTAL SHEETS	SHEET NO.
681	116RS-2, 117RS-3	IROQUOIS	27	11
CONTRACT NO. 66C45				
ILLINOIS FED. AID PROJECT				

## SIDEROAD SCHEDULE

STATION	SIDE	TYPE	MTL	LENGTH	AREA	BIT MTL TACK COAT	HMA SURF REM VAR DEPTH	INC HMA SURF	TEMP RAMP	FURN EX
				FOOT	SQ YD	POUND	SQ YARD	TON	SQ YARD	CU YD
212+16	RT	000 E/N 1800 E RD	HMA	40	141	95	141	21	28	1.6
212+16	LT	000 E/N 1800 E RD	HMA	30	107	72	107	16	28	1.2
262+98	RT	N 100 E RD	HMA	30	91	61	91	13	24	1.2
262+98	LT	N 100 E RD	HMA	30	90	61	90	13	22	1.2
315+80	RT	N 200 E RD	HMA	30	175	118	175	26	42	1.6
315+80	LT	N 200 E RD	HMA	30	234	158	234	34	42	2.3
368+69	RT	N 300 E RD	HMA	30	94	63	94	14	21	1.3
368+69	LT	N 300 E RD	HMA	30	102	69	102	15	25	1.3
421+72	LT	N 400 E RD	HMA	80	592	400	592	87	39	4
421+72	RT	N 400 E RD	HMA	99	672	454	672	99	33	4.6
474+31	RT	N 500 E RD	HMA	30	130	88	130	19	35	1.3
474+31	LT	N 500 E RD	HMA	30	108	73	108	16	32	1.1
527+78	RT	N 600 E RD	HMA	25	80	54	80	12	22	1.1
527+78	LT	N 600 E RD	HMA	30	82	55	82	12	22	1.1
568+88	RT	N 700 E RD	HMA	28	124	84	124	18	35	1.3
569+14	LT	N 700 E RD	HMA	40	266	180	266	39	42	2.3
621+34	LT	N 800 E RD	HMA	30	104	70	104	15	25	1.3
621+54	RT	N 800 E RD	HMA	16	39	26	39	6	25	0.5
TOTAL						2181	3231	475	542	30.3

## ENTRANCES SCHEDULE (1/2)

STATION	SIDE	TYPE	MTL	NOTES	LENGTH	AREA	BIT MTL TACK COAT	HMA SURF REM VAR DEPTH	INC HMA SURF	AGG SURF CSE TYPE B
					FOOT	SQ YD	POUND	SQ YARD	TON	TON
212+82	LT	PE/DUMPSTFR	AGG		20	83.0	56	83	17.7	
221+75	LT	PE	HMA		10	59.1	40	59	8.7	
236+45	LT	FE	AGG		10	175.0				0.55
237+31	RT	FE	AGG		13	22.7				0.07
247+85	LT	FE	AGG		10	17.7				0.06
281+90	RT	FE	AGG		13	36.2				0.11
289+31	RT	FE	AGG		10	23.7				0.07
294+09	RT	PE	AGG		12	48.8	33	49	7.2	
296+77	RT	MBTO	HMA		8	36.8	25	37	5.4	
296+77	RT	PE	HMA		10	31.8	22	32	4.7	
298+51	LT	PE	HMA		10	29.7	20	30	4.4	
298+51	RT	MBTO	HMA		8	36.8	25	37	5.4	
307+03	RT	MBTO	HMA		10	36.0	24	36	5.3	
307+03	RT	PE	HMA		11	39.3	26	39	5.7	
319+34	RT	FE	HMA		9	48.8	33	49	7.2	
320+23	LT	FE	AGG		10	38.3				0.12
SUBTOTAL							304	451	66	1

MODEL: Default  
FILE NAME: c:\pwwork\jzagar\0228610\66C45-Schedules.dgn

USER NAME = Joseph.Zagar	DESIGNED -	REVISED -	<b>STATE OF ILLINOIS DEPARTMENT OF TRANSPORTATION</b>	<b>SCHEDULES</b>				F.A.P. RTE.	SECTION	COUNTY	TOTAL SHEETS	SHEET NO.
	DRAWN -	REVISED -						681	116RS-2, 117RS-3	IROQUOIS	27	12
PLOT SCALE = \$SCALE\$	CHECKED -	REVISED -						CONTRACT NO. 66C45				
PLOT DATE = 2/7/2024	DATE -	REVISED -						SCALE:	SHEET OF SHEETS	STA.	TO STA.	
ILLINOIS FED. AID PROJECT												

## ENTRANCES SCHEDULE (2/2)

STATION	SIDE	TYPE	MTL	NOTES	LENGTH	AREA	BIT MTL	HMA	INC	AGG	
					FOOT	SQ YD	TACK COAT	SURF REM VAR DEPTH	HMA SURF	SURF CSE TYPE B	
							POUND	SQ YARD	TON	TON	
332+82	LT	PE	HMA		10	35.2	24	35		5.1	
332+82	RT	MBTO	HMA		10	43.7	30	44		6.5	
345+31	RT	PE	HMA	WITHIN MBTO	0	3.5	3	4		0.6	
345+31	RT	MBTO	HMA		8	36.8	25	37		5.4	
351+35	LT	PE	HMA	HMA & AGG	10	39.3	26	39		0.12	
375+82	LT	FE	AGG		8	16.5					
391+43	RT	MBTO	HMA		8	36.8	25	37		5.4	
392+23	RT	PE	HMA		10	29.6	20	30		4.4	
395+18	RT	FE	AGG		10	17.5				0.06	
399+32	RT	MBTO	HMA		8	36.8	25	37		5.4	
399+32	LT	PE	HMA		10	24.2	16	24		3.5	
420+02	RT	FE	AGG		10	27.4				0.09	
435+03	RT	FE	AGG		7	11.3				0.04	
444+65	RT	PE	AGG		10	27.7				0.09	
451+11	LT	CE	HMA		10	37.5	26	38		5.6	
451+11	RT	MBTO	HMA		8	36.8	25	37		5.4	
454+40	RT	FE	AGG		10	21.5				0.07	
456+02	RT	FE	HMA		15	86.7	59	87		12.8	
462+55	LT	FE	HMA		12	34.0	23	34		5	
463+82	RT	PE	HMA	WITHIN MBTO	0	0.9	1	1		0.1	
463+82	RT	MBTO	HMA		8	36.8	25	37		5.4	
470+94	RT	MBTO	HMA		8	36.8	25	37		5.4	
470+94	LT	PE	HMA		8	25.2	17	25		3.7	
481+42	RT	FE	AGG		10	15.2				0.05	
487+74	LT	FE	AGG		10	17.7				0.06	
495+86	RT	MBTO	HMA		8	36.8	25	37		5.4	
495+86	LT	PE	HMA		10	33.2	22	33		4.9	
500+90	LT	FE	AGG		10	16.9				0.05	
512+71	LT	CE	HMA		12	42.6	29	43		6.3	
514+46	RT	MBTO	HMA		8	42.0	28	42		6.2	
514+46	RT	PE	HMA	WITHIN MBTO							
524+85	RT	FE	AGG		10	15.2				0.05	
526+48	RT	PE	HMA	WITHIN MBTO							
526+48	RT	MBTO	HMA		8	36.8	25	37		5.4	
544+35	LT	FE	HMA		10	39.0				0.12	
547+97	LT	FE	HMA		10	40.4				0.13	
555+18	RT	FE	AGG		12	29.6				0.09	
557+45	RT	CE	AGG		10	30.5				0.10	
559+72	RT	CE	AGG		13	35.2				0.11	
570+32	RT	FE	AGG		10	17.1				0.05	
571+70	LT	FE	EARTH		16	57.8					
581+86	LT	FE	AGG		12	23.3				0.07	
595+31	RT	FE	AGG		8	11.6				0.04	
612+47	RT	PE	HMA	WITHIN MBTO							
612+47	RT	MBTO	HMA		8	36.8	25	37		5.4	
640+44	RT	MBTO	HMA		8	36.8	25	37		5.4	
640+44	RT	PE	HMA	WITHIN MBTO							
SUBTOTAL							574	849	124	1	
GRAND TOTAL							878	1300	190	2	

MODEL: Default  
 FILE NAME: c:\pwworking\jzagar\k0228610\66C45-Schedules.dgn

USER NAME = Joseph.Zagar PLOT SCALE = \$SCALE\$ PLOT DATE = 2/7/2024	DESIGNED - DRAWN - CHECKED - DATE -	REVISED - REVISED - REVISED - REVISED -	<b>STATE OF ILLINOIS</b> <b>DEPARTMENT OF TRANSPORTATION</b>	<b>SCHEDULES</b>	SCALE:      SHEET      OF      SHEETS      STA.      TO STA.	F.A.P. RTE.      SECTION      COUNTY      TOTAL SHEETS      SHEET NO. 681      116RS-2, 117RS-3      IROQUOIS      27      13 CONTRACT NO. 66C45 ILLINOIS      FED. AID PROJECT
--	--	--	---	------------------	--	--

# PAVEMENT MARKING SCHEDULE

LOCATION			LENGTH	MOD URETH PMK (2 APPLICATIONS)		RAISED REFL PAVT MARKS	RAISED REFL PAVT MARKS REMOVAL	SHORT TERM PAVT MKING	
				WHITE	YELLOW			INSTALL (2 APP)	REMOVE (1 APP)
				4"	6"				
STA	TO	STA	FOOT	FOOT	FOOT	EACH	EACH	FOOT	SQ FT
211+84	TO	227+99.93	1,616	6202	808	20	17	328	110
STATION EQUATION STA 227+99.93 BK = STA 227+97.20 AH									
227+97.20	TO	267+99.93	4,003	15786	2002	20	17	808	270
STATION EQUATION STA 267+99.99 BK = STA 268+05.91 AH									
268+05.91	TO	287+00.00	1,894	7578	948	50	43	384	128
STATION EQUATION STA 287+00.00 BK = STA 287+04.79 AH									
287+04.79	TO	309+00.00	2,195	8782	1098	24	20	440	147
STATION EQUATION STA 309+00.00 BK = STA 309+03.01 AH									
309+03.01	TO	327+00.00	1,797	6598	900	27	23	360	120
STATION EQUATION STA 327+00.00 BK = STA 327+03.00 AH									
327+03.00	TO	347+00.00	1,997	7988	1000	23	20	400	134
STATION EQUATION STA 347+00.00 BK = STA 347+02.25 AH									
347+02.25	TO	422+00.00	7,498	28976	3750	25	21	1504	502
STATION EQUATION STA 422+00.00 BK = STA 422+02.00 AH									
422+02.00	TO	458+72.00	3,670	14680	1836	94	80	736	246
BRIDGE OMISSION STA 458+72 TO STA 460+07									
460+07.00	TO	474+00.00	1,393	5572	698	46	39	280	94
STATION EQUATION STA 474+00.00 BK = STA 474+02.02 AH									
474+02.02	TO	512+00.00	3,798	14922	1900	18	15	760	254
STATION EQUATION STA 512+00.00 BK = STA 512+01.55 AH									
512+01.55	TO	534+99.93	2,298	8974	1150	47	40	464	155
STATION EQUATION STA 534+99.93 BK = STA 535+00.00 AH									
535+00.00	TO	626+99.94	9,200	36800	4600	29	25	1840	614
STATION EQUATION STA 626+99.94 BK = STA 626+97.55 AH									
626+97.55	TO	645+60	1,862	6800	932	116	99	376	126
<b>TOTAL</b>			<b>43,221</b>	<b>169,658</b>	<b>21,622</b>	<b>539</b>	<b>459</b>	<b>8,680</b>	<b>2,900</b>

MODEL: Default  
FILE NAME: c:\pwwork\jzagar\k0028610\66C45-Schedules.dgn

USER NAME = Joseph.Zagar	DESIGNED -	REVISED -	<b>STATE OF ILLINOIS DEPARTMENT OF TRANSPORTATION</b>	<b>SCHEDULES</b>				F.A.P. RTE.	SECTION	COUNTY	TOTAL SHEETS	SHEET NO.		
PLOT SCALE = \$SCALE\$	CHECKED -	REVISED -		SCALE:	SHEET	OF	SHEETS	STA.	TO STA.	681	116RS-2, 117RS-3	ILLOINOIS	27	14
PLOT DATE = 2/7/2024	DATE -	REVISED -		CONTRACT NO. 66C45										
				ILLINOIS FED. AID PROJECT										

DELINEATOR SCHEDULE			
STATION	CULVERT	DELINEATOR REMOVAL	DELINEATORS
212+44	2313	2	2
219+98	2314	2	2
232+00	2315	2	2
236+85	1619	2	2
290+92	2316	2	2
307+88	1622	2	2
426+13	1624	2	2
474+67	2317	2	2
569+00	1625	2	2
TOTAL		18	18

LINEAR DELINEATOR SCHEDULE						
LOCATION		LENGTH	LIN. DELIN. 4" WHITE EACH	LIN. DELIN. 6" WHITE EACH		
STA TO STA	ID	FOOT	EACH	EACH		
<b>EASTBOUND</b>						
215+00 TO 237+00	2314	2200	28			
	2315					
	1619					
282+13 TO 285+25	SN 038-2549	312	4			
316+40 TO 318+77	SN 038-2022	237	3			
341+14 TO 342+68	SN 038-2555	154	2			
420+28 TO 421+52	SN 038-2010	164	3			
456+81 TO 458+87	SN 038-0220	206	3			
458+87 TO 459+93		106		2		
459+93 TO 460+86		93	2			
544+45 TO 547+54	SN 038-2027	309	4			
567+15 TO 568+38	SN 038 2556	123	2			
EASTBOUND TOTAL			51	2		
<b>WESTBOUND</b>						
236+90 TO 237+67	1619	77	2			
282+75 TO 298+27	SN 038-2549	1569	20			
	2316					
298+63 TO 315+61	1622	1736	22			
316+00 TO 319+65	SN 038-2549	432	6			
341+66 TO 343+19	SN 038-2555	153	2			
421+96 TO 451+02	SN 038-2010	2942	37			
	1624					
451+23 TO 458+87	SN 038-0220	764	10			
458+87 TO 459+93		106		2		
459+93 TO 462+43		250	4			
544+91 TO 547+73	SN 038-2027	282	4			
548+25 TO 569+00	SN 038-2556	2152	27			
	2318					
	1625					
WESTBOUND TOTAL			134	2		
GRAND TOTAL			185	4		

MODEL: Default  
 FILE NAME: c:\p\work\pww\delzagar\k0228610\66C45-Schedules.dgn

USER NAME = Joseph.Zagar	DESIGNED -	REVISED -
	DRAWN -	REVISED -
PLOT SCALE = \$\$SCALE\$	CHECKED -	REVISED -
PLOT DATE = 2/7/2024	DATE -	REVISED -

**STATE OF ILLINOIS  
DEPARTMENT OF TRANSPORTATION**

**SCHEDULES**

SCALE: SHEET OF SHEETS STA. TO STA.

F.A.P. RTE.	SECTION	COUNTY	TOTAL SHEETS	SHEET NO.
681	116RS-2, 117RS-3	IROQUOIS	27	15
CONTRACT NO. 66C45				
ILLINOIS FED. AID PROJECT				

## DRAINAGE REPAIR SCHEDULE

LOCATION						DESCRIPTION OF WORK	BOX	STONE	FILTER	CONC	CLSM	FURN	PIPE	PIPE	PRC	TRENCH	CLASS B	DOWEL	SAW
STA	OS	RT/LT	ID	MAT	SIZE		CUL	RIPRAP	FABRIC	HDWL		EX	CULV	CUL	FL	BACKFILL	PATCH	BARS	CUTS
				TYPE			TO BE	CL A4		REMOV	CU	CU	REMOV	CL A	EQ	RS	TYPE II	1 IN	
						FOOT	SQ YD	SY YD	EACH	CU YD	CU YD	FOOT	FOOT	EACH	CU YD	SQ YD	EACH	FOOT	
212+44	39.1'	RT	2313	BOX	3x3	10													
219+98	30.5'	RT	2314	CLAY	18"		4	4											
232+00	24.4'	RT/LT	2315	CLAY	18"				2	2.75	3.53								
236+85	26'	RT	1619	BOX	3x2	10	10	10											
290+92	25'	LT	2316	BOX	3x2		8	8											
307+88	29.7'	LT	1624	BOX	2x1.5		8	8											
426+13	28.3'	RT/LT	1622	CLAY	18"				2			41.33	38	2	9.53	17	20	96	
474+67	26'	RT/LT	2317	BOX	2x2	52													
568+00	28.6'	RT	SN 038-2556	CIP Box	6x3		8	8											
569+00	40'	RT	1625	BOX	4x2		9	9											
<b>TOTAL</b>						<b>72</b>	<b>47</b>	<b>47</b>	<b>4</b>	<b>3</b>	<b>5</b>	<b>42</b>	<b>38</b>	<b>2</b>	<b>10</b>	<b>17</b>	<b>20</b>	<b>96</b>	

\*PATCHES TO BE ACCOMPLISHED IN TWO SEPARATE OPERATIONS

## GRADING & SHAPING

STATION		LENGTH	FARTH	GRADE	FLOW DIRECTION
TO	STA	FOOT	EX	& SHAPE DITCH	
STA	TO	STA	CU YD	FOOT	
212+44	TO	212+44	5	6	SW
232+00	TO	232+00	3	15	FORESLOPE ONLY
232+00	TO	232+00	3	15	FORESLOPE ONLY
238+00	TO	240+00	33	200	WEST
241+00	TO	243+20	25	150	WEST
474+67	TO	474+67	9	20	NW
471+60	TO	474+10	42	250	WEST
568+00	TO	569+00	17	100	SOUTH
<b>TOTAL</b>			<b>137</b>	<b>756</b>	

## SEEDING SCHEDULE

LOCATION		NOTES	LENGTH	WIDTH	AREA	SEEDING	NITRO	PHOSP	POT	EROSION
STA	TO	STA	FOOT	FOOT	SQ YD	CLASS 2A	FERT NUT	FERT NUT	FERT NUT	CONTROL BLANKET
						ACRE	LB	LB	LB	SQ YD
212+44	TO	212+44	30	6	20	0.005	0.45	0.45	0.45	20
238+00	TO	240+00	200	6	133	0.028	2.52	2.52	2.52	133
241+00	TO	243+20	150	6	100	0.021	1.89	1.89	1.89	100
474+67	TO	474+67	20	10	22	0.005	0.45	0.45	0.45	22
471+60	TO	474+10	250	6	167	0.035	3.15	3.15	3.15	167
568+00	TO	569+00	100	6	67	0.014	1.26	1.26	1.26	67
<b>DRAINAGE REPAIR</b>										
232+00			15	14	23	0.005	0.45	0.45	0.45	23
232+00			15	15	25	0.006	0.54	0.54	0.54	25
426+13			12	6	8	0.002	0.18	0.18	0.18	8
<b>TOTAL</b>						<b>0.12</b>	<b>11</b>	<b>11</b>	<b>11</b>	<b>565</b>

MODEL: Default  
FILE NAME: c:\pwworking\jzagar\k0028610\66C45-Schedules.dgn

USER NAME = Joseph.Zagar	DESIGNED -	REVISED -
	DRAWN -	REVISED -
PLOT SCALE = \$SCALE\$	CHECKED -	REVISED -
PLOT DATE = 2/7/2024	DATE -	REVISED -

**STATE OF ILLINOIS  
DEPARTMENT OF TRANSPORTATION**

**SCHEDULES**

SCALE: SHEET OF SHEETS STA. TO STA.

F.A.P. RTE.	SECTION	COUNTY	TOTAL SHEETS	SHEET NO.
681	116RS-2, 117RS-3	IROQUOIS	27	16
CONTRACT NO. 66C45				
ILLINOIS FED. AID PROJECT				



## CLASS B PATCHING SCHEDULE (1/4)

LOCATION					LENGTH	WIDTH	PATCH AREA	TYPE II 16 INCH	TYPE III 16 INCH	TYPE IV 16 INCH	TYPE II 14 INCH	TYPE III 14 INCH	TYPE IV 14 INCH	DOWEL BARS 1 IN	TIE BARS 3/4 IN	SAW CUTS	WELDED WIRE REINF
STA	TO	STA	LOG MI	LANE	FOOT	FOOT	SQ YD	SQ YD	SQ YD	SQ YD	SQ YD	SQ YD	SQ YD	EACH	EACH	FOOT	SQ YD
212+12	TO	217+40	0	EB	6	13	9	9						20		51	
212+12	TO	217+40	0	EB	6	13	9	9						20		51	
217+40	TO	222+68	0.1	EB	12	13	17		17					20		63	17
217+40	TO	222+68	0.1	EB	6	13	9	9						20		51	
217+40	TO	222+68	0.1	EB	6	13	9	9						20		51	
222+68	TO	227+69	0.2	EB	6	13	9	9						20		51	
227+69	TO	233+24	0.3	EB	6	13	9	9						20		51	
227+69	TO	233+24	0.3	EB	6	13	9	9						20		51	
233+24	TO	238+52	0.4	EB	10	13	14	14						20		59	
233+24	TO	233+24	0.4	EB	6	13	9	9						20		51	
238+52	TO	238+52	0.5	EB	15	13	22		22					20		69	22
238+52	TO	243+80	0.5	EB	10	13	14	14						20		59	
238+52	TO	243+80	0.5	EB	6	13	9	9						20		51	
243+80	TO	249+08	0.6	EB	10	13	14	14						20		59	
249+08	TO	254+36	0.7	EB	6	13	9	9						20		51	
249+08	TO	254+36	0.7	EB	6	13	9	9						20		51	
249+08	TO	254+36	0.7	EB	6	13	9	9						20		51	
254+36	TO	259+64	0.8	EB	10	13	14	14						20		59	
254+36	TO	259+64	0.8	EB	20	13	29			29				20	7	79	29
254+36	TO	259+64	0.8	EB	10	13	14	14						20		59	
254+36	TO	259+64	0.8	EB	10	13	14	14						20		59	
259+64	TO	264+92	0.9	EB	10	13	14	14						20		59	
259+64	TO	264+92	0.9	EB	10	13	14	14						20		59	
259+64	TO	264+92	0.9	EB	6	13	9	9						20		51	
259+64	TO	264+92	0.9	EB	6	13	9	9						20		51	
264+92	TO	270+20	1	EB	15	13	22		22					20		69	22
264+92	TO	270+20	1	EB	15	13	22		22					20		69	22
270+20	TO	275+48	1.1	EB	10	13	14	14						20		59	
270+20	TO	275+48	1.1	EB	10	13	14	14						20		59	
275+48	TO	280+76	1.2	EB	10	13	14	14						20		59	
275+48	TO	280+76	1.2	EB	10	13	14	14						20		59	
275+48	TO	280+76	1.2	EB	6	13	9	9						20		51	
296+60	TO	301+88	1.6	EB	10	13	14	14						20		59	
301+88	TO	307+16	1.7	EB	10	13	14	14						20		59	
301+88	TO	307+16	1.7	EB	6	13	9	9						20		51	
312+44	TO	317+72	1.9	EB	15	13	22		22					20		69	22
312+44	TO	317+72	1.9	EB	15	13	22		22					20		69	22
323+00	TO	323+00	2.1	EB	6	13	9	9						20		51	
323+00	TO	328+28	2.1	EB	10	13	14	14						20		59	
323+00	TO	328+28	2.1	EB	6	13	9	9						20		51	
328+28	TO	333+56	2.2	EB	10	13	14	14						20		59	
328+28	TO	333+56	2.2	EB	6	13	9	9						20		51	
333+56	TO	338+84	2.3	EB	6	13	9	9						20		51	
<b>SUBTOTAL</b>								404	127	29				860	7	2451	156

MODEL: Default  
 FILE NAME: c:\pwwork\jzagark\0228610\66C45-Schedules.dgn

USER NAME = Joseph.Zagar	DESIGNED -	REVISED -
	DRAWN -	REVISED -
PLOT SCALE = \$SCALE\$	CHECKED -	REVISED -
PLOT DATE = 2/7/2024	DATE -	REVISED -

**STATE OF ILLINOIS  
DEPARTMENT OF TRANSPORTATION**

<b>SCHEDULES</b>			
SCALE:	SHEET	OF	SHEETS
	STA.		TO STA.

F.A.P. RTE.	SECTION	COUNTY	TOTAL SHEETS	SHEET NO.
681	116RS-2, 117RS-3	IROQUOIS	27	17
CONTRACT NO. 66C45				
		ILLINOIS	FED. AID PROJECT	

## CLASS B PATCHING SCHEDULE (2/4)

LOCATION					LENGTH	WIDTH	PATCH AREA	TYPE II 16 INCH	TYPE III 16 INCH	TYPE IV 16 INCH	TYPE II 14 INCH	TYPE III 14 INCH	TYPE IV 14 INCH	DOWEL BARS 1 IN	TIE BARS 3/4 IN	SAW CUTS	WELDED WIRE REINF
STA	TO	STA	LOG MI	LANE	FOOT	FOOT	SQ YD	SQ YD	SQ YD	SQ YD	SQ YD	SQ YD	SQ YD	EACH	EACH	FOOT	SQ YD
359+96	TO	365+24	2.8	EB	6	13	9				9			20		51	
359+96	TO	365+24	2.8	EB	6	13	9				9			20		51	
365+24	TO	370+52	2.9	EB	10	13	14				14			20		59	
386+36	TO	386+36	3.3	EB	10	13	14				14			20		59	
407+48	TO	407+48	3.7	EB	25	13	36						36	20	9	89	36
412+76	TO	418+04	3.8	EB	6	13	9				9			20		51	
423+32	TO	428+60	4	EB	10	13	14				14			20		59	
423+32	TO	428+60	4	EB	10	13	14				14			20		59	
486+68	TO	491+96	5.2	EB	10	13	14				14			20		59	
513+08	TO	518+36	5.7	EB	6	13	9				9			20		51	
528+92	TO	534+20	6	EB	6	13	9				9			20		51	
571+16	TO	576+44	6.8	EB	10	13	14				14			20		59	
581+72	TO	587+00	7	EB	10	13	14				14			20		59	
581+72	TO	587+00	7	EB	20	13	29						29	20	7	79	29
592+28	TO	597+56	7.2	EB	10	13	14				14			20		59	
597+56	TO	602+84	7.3	EB	10	13	14				14			20		59	
602+84	TO	608+12	7.4	EB	12	13	17					17		20		63	17
613+40	TO	618+68	7.6	EB	10	13	14				14			20		59	
618+68	TO	623+96	7.7	EB	6	13	9				9			20		51	
634+52	TO	639+80	8	EB	15	13	22					22		20		69	22
639+80	TO	645+08	8	EB	15	13	22					22		20		69	22
<b>SUBTOTAL</b>											194	61	65	420	16	1265	126

MODEL: Default  
 FILE NAME: c:\pwwork\jzagar\jzagar\0228610\66C45-Schedules.dgn

USER NAME = Joseph.Zagar	DESIGNED -	REVISED -
	DRAWN -	REVISED -
PLOT SCALE = \$SCALE\$	CHECKED -	REVISED -
PLOT DATE = 2/7/2024	DATE -	REVISED -

**STATE OF ILLINOIS  
DEPARTMENT OF TRANSPORTATION**

**SCHEDULES**

SCALE: SHEET OF SHEETS STA. TO STA.

F.A.P. RTE.	SECTION	COUNTY	TOTAL SHEETS	SHEET NO.
681	116RS-2, 117RS-3	IROQUOIS	27	18
CONTRACT NO. 66C45				
ILLINOIS FED. AID PROJECT				

## CLASS B PATCHING SCHEDULE (3/4)

LOCATION					LENGTH	WIDTH	PATCH AREA	TYPE II 16 INCH	TYPE III 16 INCH	TYPE IV 16 INCH	TYPE II 14 INCH	TYPE III 14 INCH	TYPE IV 14 INCH	DOWEL BARS 1 IN	TIE BARS 3/4 IN	SAW CUTS	WELDED WIRE REINF
STA	TO	STA	LOG MI	LANE	FOOT	FOOT	SQ YD	SQ YD	SQ YD	SQ YD	SQ YD	SQ YD	SQ YD	EACH	EACH	FOOT	SQ YD
212+12	TO	217+40	0	WB	6	13	9	9						20		51	
212+12	TO	217+40	0	WB	6	13	9	9						20		51	
217+40	TO	222+68	0.1	WB	12	13	17		17					20		63	17
217+40	TO	222+68	0.1	WB	6	13	9	9						20		51	
217+40	TO	222+68	0.1	WB	6	13	9	9						20		51	
222+68	TO	227+69	0.2	WB	6	13	9	9						20		51	
227+69	TO	233+24	0.3	WB	6	13	9	9						20		51	
227+69	TO	233+24	0.3	WB	6	13	9	9						20		51	
233+24	TO	238+52	0.4	WB	10	13	14	14						20		59	
238+52	TO	238+52	0.5	WB	15	13	22		22					20		69	22
238+52	TO	243+80	0.5	WB	10	13	14	14						20		59	
238+52	TO	243+80	0.5	WB	6	13	9	9						20		51	
249+08	TO	254+36	0.7	WB	6	13	9	9						20		51	
249+08	TO	254+36	0.7	WB	6	13	9	9						20		51	
254+36	TO	259+64	0.8	WB	10	13	14	14						20		59	
254+36	TO	259+64	0.8	WB	10	13	14	14						20		59	
259+64	TO	264+92	0.9	WB	10	13	14	14						20		59	
259+64	TO	264+92	0.9	WB	10	13	14	14						20		59	
259+64	TO	264+92	0.9	WB	6	13	9	9						20		51	
259+64	TO	264+92	0.9	WB	6	13	9	9						20		51	
264+92	TO	270+20	1	WB	15	13	22		22					20		69	22
264+92	TO	270+20	1	WB	15	13	22		22					20		69	22
270+20	TO	275+48	1.1	WB	10	13	14	14						20		59	
270+20	TO	275+48	1.1	WB	10	13	14	14						20		59	
275+48	TO	280+76	1.2	WB	10	13	14	14						20		59	
275+48	TO	280+76	1.2	WB	10	13	14	14						20		59	
275+48	TO	280+76	1.2	WB	6	13	9	9						20		51	
291+32	TO	296+60	1.5	WB	6	13	9	9						20		51	
296+60	TO	301+88	1.6	WB	10	13	14	14						20		59	
301+88	TO	307+16	1.7	WB	10	13	14	14						20		59	
301+88	TO	307+16	1.7	WB	6	13	9	9						20		51	
323+00	TO	323+00	2.1	WB	6	13	9	9						20		51	
323+00	TO	328+28	2.1	WB	10	13	14	14						20		59	
323+00	TO	328+28	2.1	WB	6	13	9	9						20		51	
328+28	TO	333+56	2.2	WB	10	13	14	14						20		59	
328+28	TO	333+56	2.2	WB	6	13	9	9						20		51	
333+56	TO	338+84	2.3	WB	6	13	9	9						20		51	
<b>SUBTOTAL</b>								367	83					740		2065	83

MODEL: Default  
 FILE NAME: c:\p\work\pww\zagar\k0228610\66C45-Schedule.dgn

USER NAME = Joseph.Zagar	DESIGNED -	REVISED -
	DRAWN -	REVISED -
PLOT SCALE = \$SCALE\$	CHECKED -	REVISED -
PLOT DATE = 2/7/2024	DATE -	REVISED -

**STATE OF ILLINOIS  
DEPARTMENT OF TRANSPORTATION**

**SCHEDULES**

SCALE: SHEET OF SHEETS STA. TO STA.

F.A.P. RTE.	SECTION	COUNTY	TOTAL SHEETS	SHEET NO.
681	116RS-2, 117RS-3	IROQUOIS	27	19
CONTRACT NO. 66C45				
		ILLINOIS	FED. AID PROJECT	

## CLASS B PATCHING SCHEDULE (4/4)

LOCATION					LENGTH	WIDTH	PATCH AREA	TYPE II 16 INCH	TYPE III 16 INCH	TYPE IV 16 INCH	TYPE II 14 INCH	TYPE III 14 INCH	TYPE IV 14 INCH	DOWEL BARS 1 IN	TIE BARS 3/4 IN	SAW CUTS	WELDED WIRE REINF	
STA	TO	STA	LOG MI	LANE	FOOT	FOOT	SQ YD	SQ YD	SQ YD	SQ YD	SQ YD	SQ YD	SQ YD	EACH	EACH	FOOT	SQ YD	
359+96	TO	365+24	2.8	WB	6	13	9				9			20		51		
359+96	TO	365+24	2.8	WB	6	13	9				9			20		51		
365+24	TO	370+52	2.9	WB	10	13	14				14			20		59		
375+80	TO	381+08	3.1	WB	6	13	9				9			20		51		
386+36	TO	386+36	3.3	WB	10	13	14				14			20		59		
386+36	TO	391+64	3.3	WB	6	13	9				9			20		51		
402+20	TO	402+20	3.6	WB	6	13	9				9			20		51		
412+76	TO	418+04	3.8	WB	6	13	9				9			20		51		
423+32	TO	428+60	4	WB	10	13	14				14			20		59		
423+32	TO	428+60	4	WB	10	13	14				14			20		59		
455+00	TO	460+28	4.6	WB	15	13	22					22		20		69	22	
481+40	TO	486+68	5.1	WB	40	13	58						58	20	14	119	58	
486+68	TO	491+96	5.2	WB	10	13	14				14			20		59		
513+08	TO	518+36	5.7	WB	6	13	9				9			20		51		
528+92	TO	534+20	6	WB	6	13	9				9			20		51		
534+20	TO	539+48	6.1	WB	10	13	14				14			20		59		
571+16	TO	576+44	6.8	WB	10	13	14				14			20		59		
581+72	TO	587+00	7	WB	10	13	14				14			20		59		
581+72	TO	587+00	7	WB	20	13	29					29	20	7	79	29		
587+00	TO	592+28	7.1	WB	6	13	9				9			20		51		
592+28	TO	597+56	7.2	WB	10	13	14				14			20		59		
597+56	TO	602+84	7.3	WB	10	13	14				14			20		59		
597+56	TO	602+84	7.3	WB	6	13	9				9			20		51		
602+84	TO	608+12	7.4	WB	12	13	17					17		20		63	17	
613+40	TO	618+68	7.6	WB	10	13	14				14			20		59		
618+68	TO	623+96	7.7	WB	6	13	9				9			20		51		
639+80	TO	645+08	8	WB	15	13	22					22		20		69	22	
<b>SUBTOTAL</b>											253	61	87	540	21	1609	148	
<b>GRAND TOTAL</b>									771	210	29	447	122	152	2560	44	7390	513

MODEL: Default  
 FILE NAME: c:\p\work\pww\dot\zagar\k04028610\66C45-Schedules.dgn

USER NAME = Joseph.Zagar	DESIGNED -	REVISED -
	DRAWN -	REVISED -
PLOT SCALE = \$SCALE\$	CHECKED -	REVISED -
PLOT DATE = 2/7/2024	DATE -	REVISED -

**STATE OF ILLINOIS  
DEPARTMENT OF TRANSPORTATION**

**SCHEDULES**

SCALE: SHEET OF SHEETS STA. TO STA.

F.A.P. RTE.	SECTION	COUNTY	TOTAL SHEETS	SHEET NO.
681	116RS-2, 117RS-3	IROQUOIS	27	20
CONTRACT NO. 66C45				
		ILLINOIS	FED. AID PROJECT	

# PERMANENT SURVEY MARKER SCHEDULE

GPS NUMBER	DESCRIPTION	APPROXIMATE LOCATION	EXISTING MONUMENT TYPE	PROPOSED MONUMENT TYPE	MONUMENT RECORD TO BE RECORDED	RESPONSIBILITY
116402	N QTR CORNER SECTION 30, T28N, R10E, 3RD PM	1/2 MILE WEST OF 100 E RD	MISSING	TYPE 1	YES	1
116403	NW CORNER SECTION 29, T28N, R10E, 3RD PM	100 E RD	MISSING	TYPE 1	YES	1
116404	NE CORNER SECTION 29, T28N, R10E, 3RD PM	200 E RD	PK NAIL	TYPE 1	YES	1
116405	S QTR CORNER SECTION 21, T28N, R10E, 3RD PM	1/2 MILE EAST OF 200 E RD	PK NAIL	TYPE 1	YES	1
116406	SW CORNER SECTION 22, T28N, R10E, 3RD PM	300 E RD	BRASS DISK	TYPE 1	YES	1
116408	NE CORNER SECTION 27, T28N, R10E, 3RD PM	400 E RD	BRASS DISK	TYPE 1	YES	1
116410	SE CORNER SECTION 23, T28N, R10E, 3RD PM	500 E RD	BRASS DISK	TYPE 1	YES	1
A116412	SW CORNER SECTION 19, T28N, R11E, 3RD PM	600 E RD	SURVEY NAIL	TYPE 1	YES	1
A116414	SE CORNER SECTION 19, T28N, R11E, 3RD PM	700 E RD	BRASS DISK	TYPE 1	YES	1
A116416	SW CORNER SECTION 20, T28N, R14W, 2ND PM	800 E RD	MAG NAIL	TYPE 1	YES	1
B116417	N QTR CORNER SECTION 29, T28N, R14W, 2ND PM MR 08R4134	IDOT MAINTENANCE ENTRANCE	SURVEY NAIL STEM	TYPE 1	YES	1
A116417	N QTR CORNER SECTION 29, T28N, R14W, 2ND PM PER MR 15R2704		MAG NAIL	NONE	REFERENCE ON NEW MR	---

THE ABOVE TOTALS ARE SUBJECT TO CHANGE DUE TO ONGOING PRIVATE SURVEY WORK IN THE AREA.  
 UNKNOWN MONUMENTS MAY EXIST. IF FOUND, R.E. WILL REQUEST PLATS AND PLANS PERSONNEL TO TIE ANY MONUMENT SUBJECT TO DAMAGE FROM RESURFACING FOR THE PURPOSE OF RESFETTING THE MONUMENT(S) WHEN RESURFACING IS COMPLETE.

R.E. IS TO INFORM PLATS AND PLANS TO SEARCH FOR ADDITIONAL MONUMENTS IF JOB LIMITS ARE EXPANDED DURING CONSTRUCTION.  
 UPON PAVING COMPLETION, R.E. WILL DIRECT PLATS AND PLANS LAND SURVEYORS TO STAKE THE LOCATIONS FOR TYPE 1 MONUMENT CORING.  
 PLATS AND PLANS WILL PREPARE AND RECORD THE REQUIRED MONUMENT RECORDS.

NOTE: FOR BIDDING PURPOSES, NO CONTRACTED LAND SURVEYING SERVICES WILL BE REQUIRED FOR SETTING THE LISTED PERMANENT SURVEY MARKERS.

**RESPONSIBILITY:**

- 1) RESIDENT TO RE-ESTABLISH MONUMENT (PAY ITEM REQUIRED. PERMANENT SURVEY MARKER, TYPE 1)
- 2) PLATS AND PLANS TO RE-ESTABLISH MONUMENT

MODEL: Default  
FILE NAME: c:\p\work\pwwdof\zagark\0228610\66C45-Schedules.dgn

USER NAME = Joseph.Zagar	DESIGNED -	REVISED -
	DRAWN -	REVISED -
PLOT SCALE = \$SCALE\$	CHECKED -	REVISED -
PLOT DATE = 2/7/2024	DATE -	REVISED -

**STATE OF ILLINOIS  
DEPARTMENT OF TRANSPORTATION**

**SCHEDULES**

SCALE: SHEET OF SHEETS STA. TO STA.

F.A.P. RTE.	SECTION	COUNTY	TOTAL SHEETS	SHEET NO.
681	116RS-2, 117RS-3	IROQUOIS	27	21
CONTRACT NO. 66C45				
ILLINOIS FED. AID PROJECT				

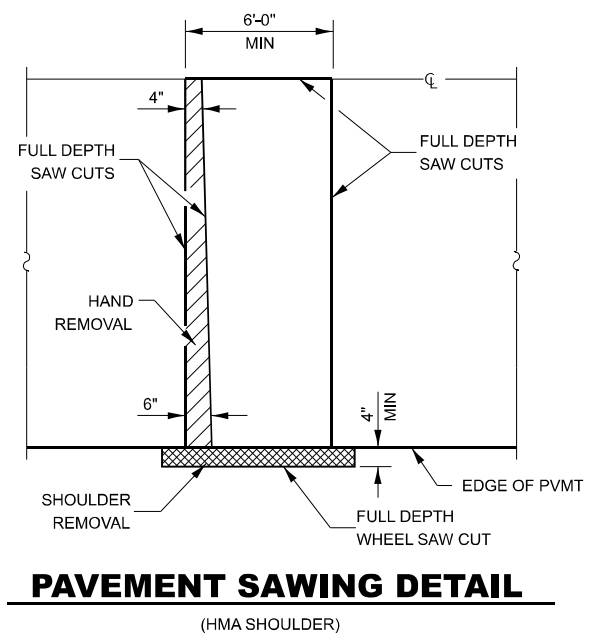

**PAVEMENT SAWING DETAIL**  
(HMA SHOULDER)

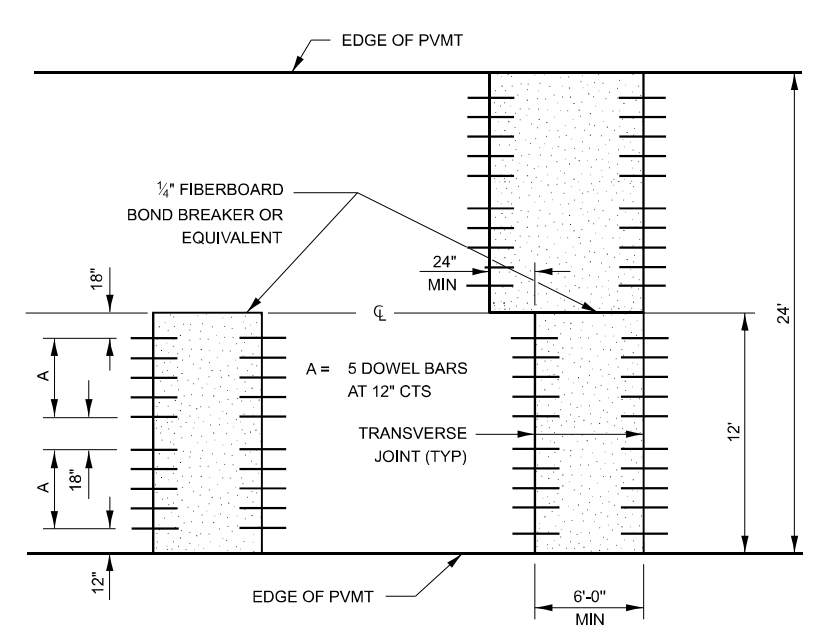

**12' WIDE LANES**

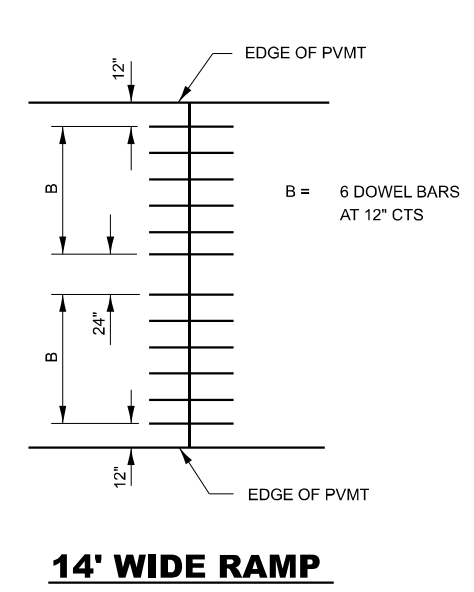

**14' WIDE RAMP**

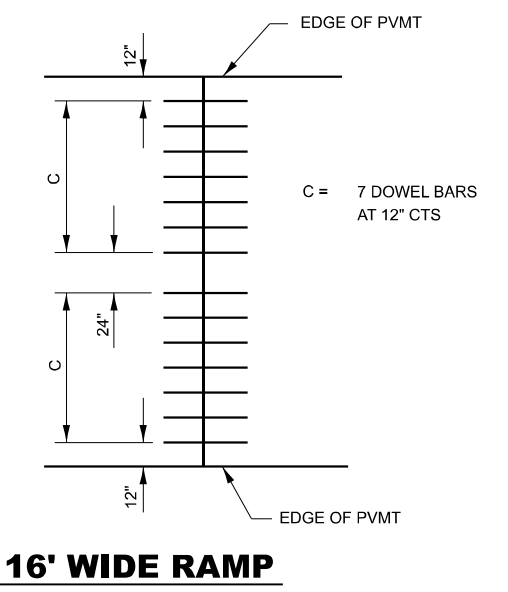

**16' WIDE RAMP**

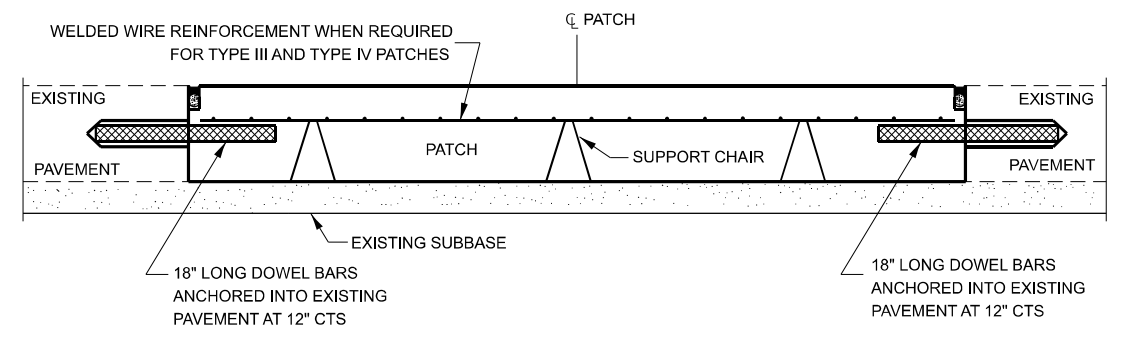

**PATCHING WITHOUT HMA OVERLAY**

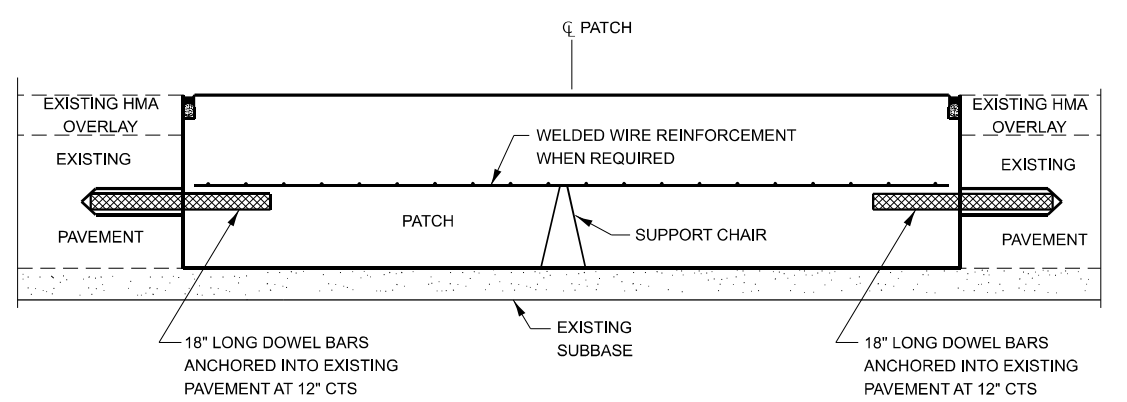

**PATCHING WITH HMA OVERLAY**

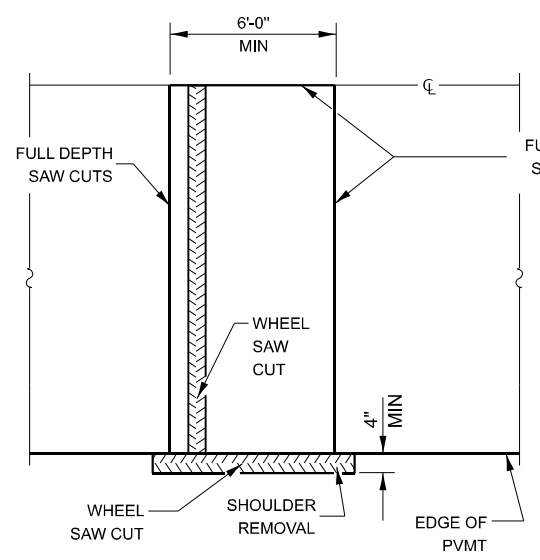

**ALTERNATE SAWING DETAIL**  
(HMA SHOULDER)

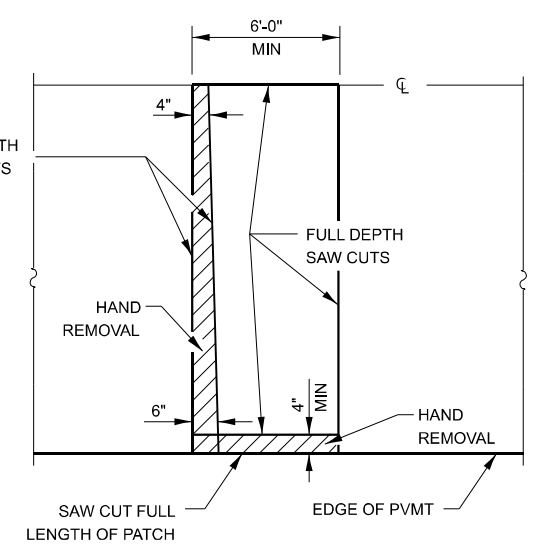

**PAVEMENT SAWING DETAIL**  
(PCC SHOULDER)

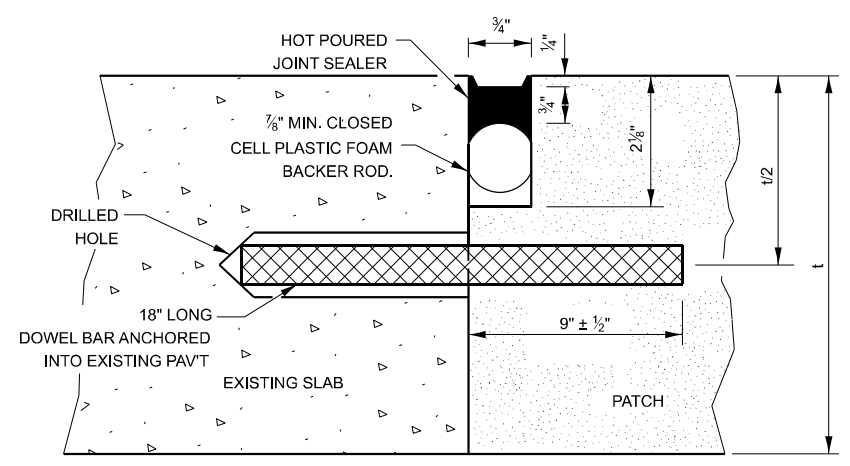

**TRANSVERSE JOINT**

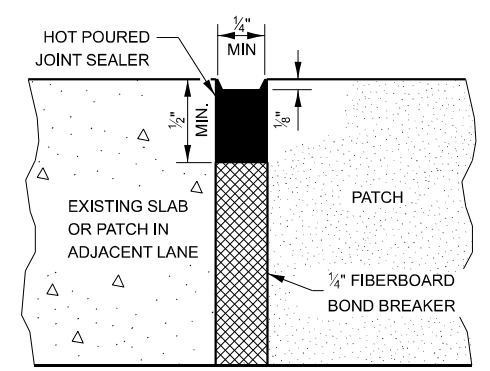

**CENTERLINE JOINT**

DOWEL BAR TABLE		
PAVEMENT THICKNESS	DOWEL BAR DIAMETER	HOLE DIAMETER
10" OR GREATER	1 1/2"	1 5/8"
8" THRU 9.99"	1 1/4"	1 3/8"
LESS THAN 8"	1"	1 1/8"

**GENERAL NOTES**

THE TRANSVERSE JOINTS FOR CLASS B PATCHES SHALL ALIGN WITH JOINTS OR CRACKS IN THE ADJACENT LANE WHENEVER POSSIBLE.

SEE STANDARD 420701 FOR DETAILS OF PAVEMENT WELDED WIRE REINFORCEMENT.

MODEL: Default  
FILE NAME: c:\pwwork\work\zagar\k0228610\66C45 - Details.dgn

USER NAME = Joseph.Zagar	DESIGNED -	REVISED -
PLOT SCALE = \$SCALE\$	DRAWN -	REVISED -
PLOT DATE = 1/26/2024	CHECKED -	REVISED -
	DATE -	REVISED -

**STATE OF ILLINOIS  
DEPARTMENT OF TRANSPORTATION**

**CLASS B PATCHING DETAILS**

SCALE:	SHEET	OF	SHEETS	STA.	TO	STA.
--------	-------	----	--------	------	----	------

F.A.P. RTE.	SECTION	COUNTY	TOTAL SHEETS	SHEET NO.
681	116RS-2, 117RS-3	IROQUOIS	27	22
CONTRACT NO. 66C45				
ILLINOIS FED. AID PROJECT				

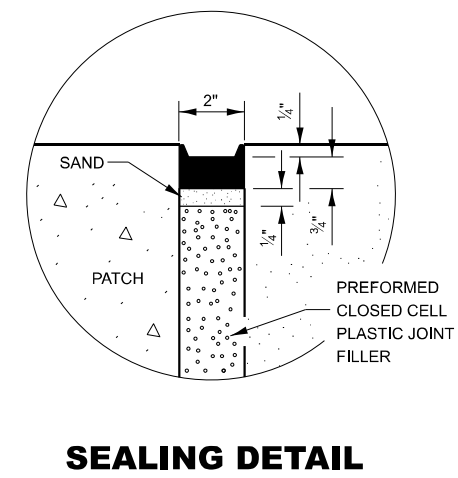
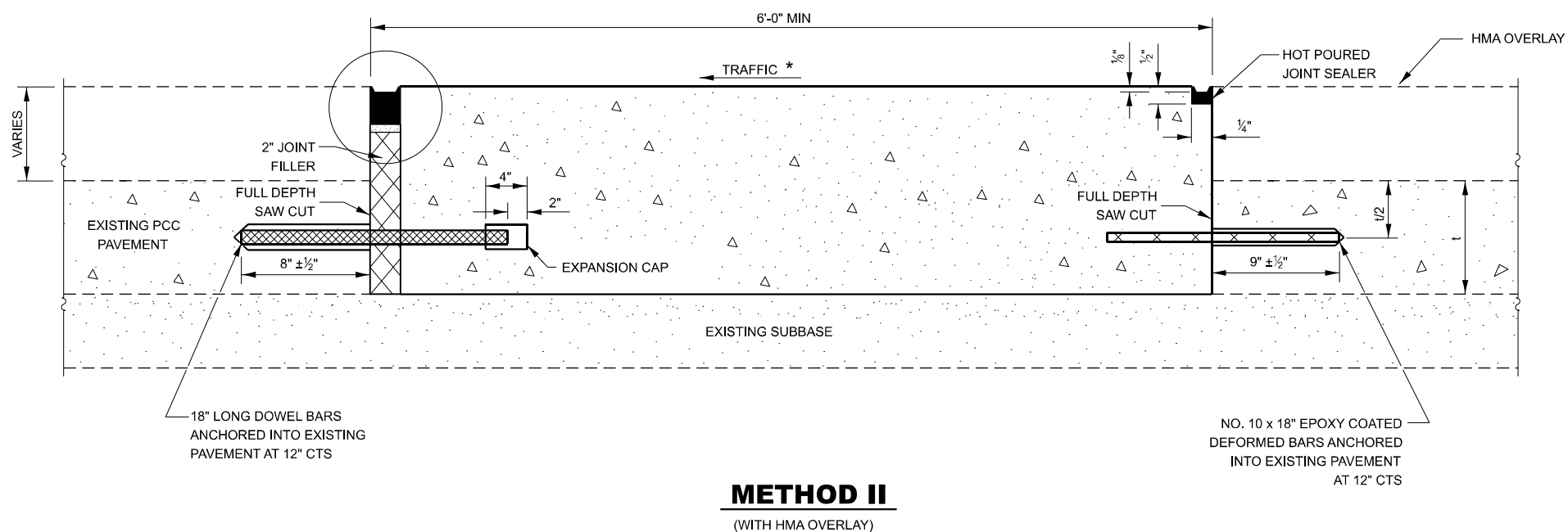
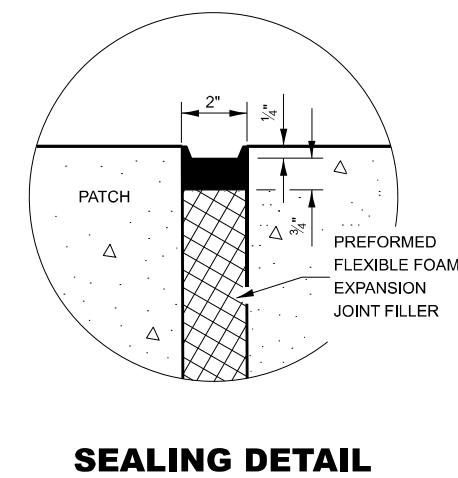
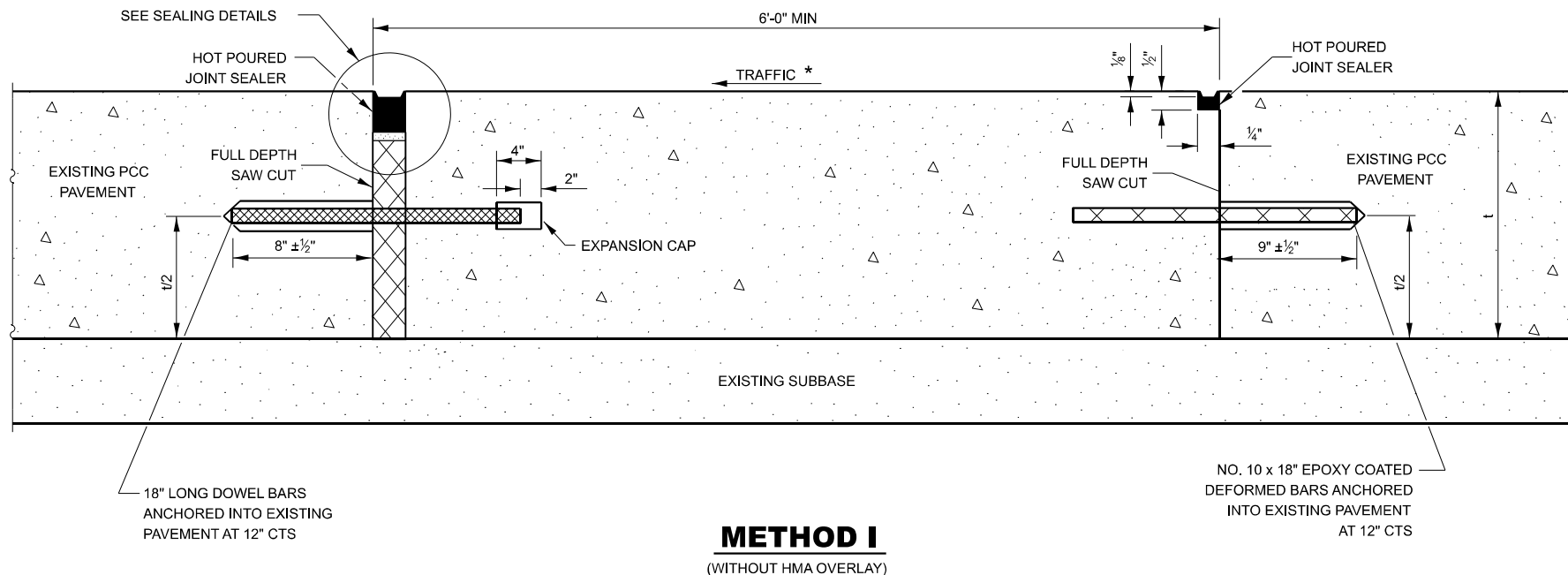

**NOTE**  
 \* WHEN RE-ESTABLISHING A TRANSVERSE EXPANSION JOINT ON A TWO-WAY ROAD, REVERSE THE ORIENTATION OF THE DOWEL BARS WITH RESPECT TO TRAFFIC FOR ONE OF THE PATCHES SUCH THAT THE JOINT WILL BE CONTINUOUS ACROSS BOTH LANES.

MODEL: Default  
 FILE NAME: c:\pwwork\jzagar\k0928610\66C45 - Details.dgn

USER NAME = Joseph.Zagar DESIGNED - DRAWN - PLOT SCALE = \$SCALE\$ PLOT DATE = 1/26/2024				REVISED - REVISED - REVISED - REVISED -				<b>STATE OF ILLINOIS                  DEPARTMENT OF TRANSPORTATION</b>				<b>CLASS B PATCHING DETAILS</b>				F.A.P. RTE. 681		SECTION 116RS-2, 117RS-3		COUNTY IROQUOIS		TOTAL SHEETS 27		SHEET NO. 23	
SCALE: SHEET OF SHEETS STA. TO STA.												CONTRACT NO. 66C45				ILLINOIS FED. AID PROJECT									

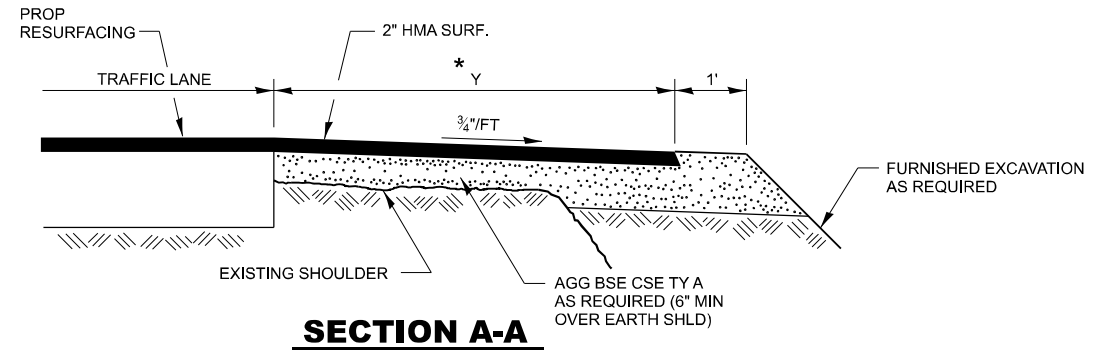
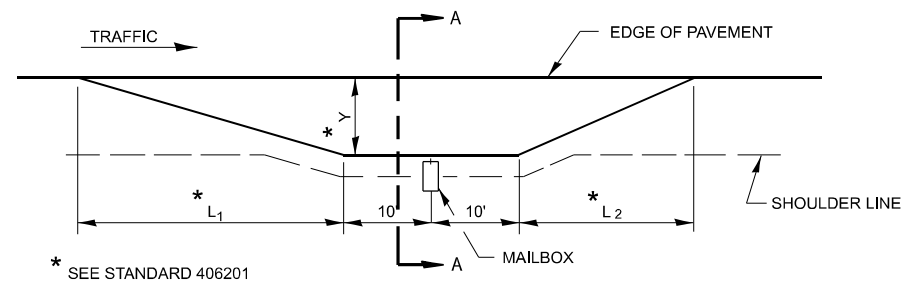

**SECTION A-A**

**RURAL MAILBOX TURNOUT DETAILS**

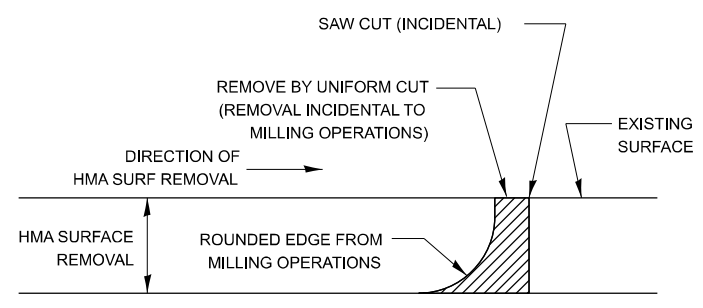

NOTE:  
 WHEN MILLING OPERATIONS PRODUCE A ROUNDED EDGE, THEN A SAW CUT SHALL BE USED TO MANUFACTURE A PERPENDICULAR EDGE AS SHOWN IN THE DETAIL. THE ENGINEER SHALL BE THE SOLE JUDGE CONCERNING THE USE OF THIS DETAIL.

**HMA BUTT JOINT SAW CUTS**

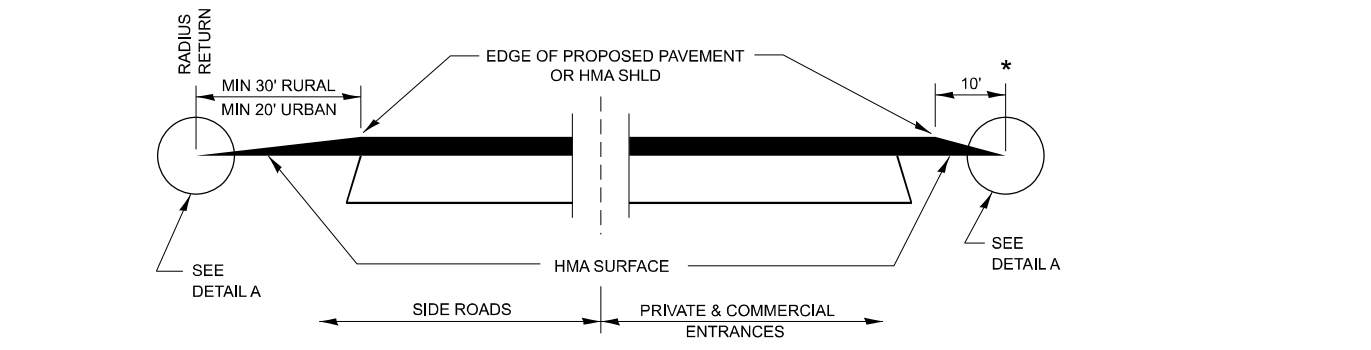

**SECTION A-A  
 DETAILS AT ENTRANCES & SIDE ROADS**

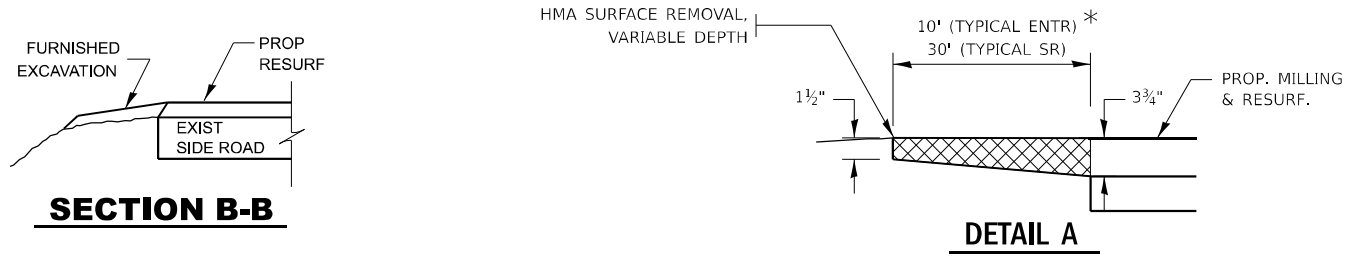

**SECTION B-B**

**DETAIL A**

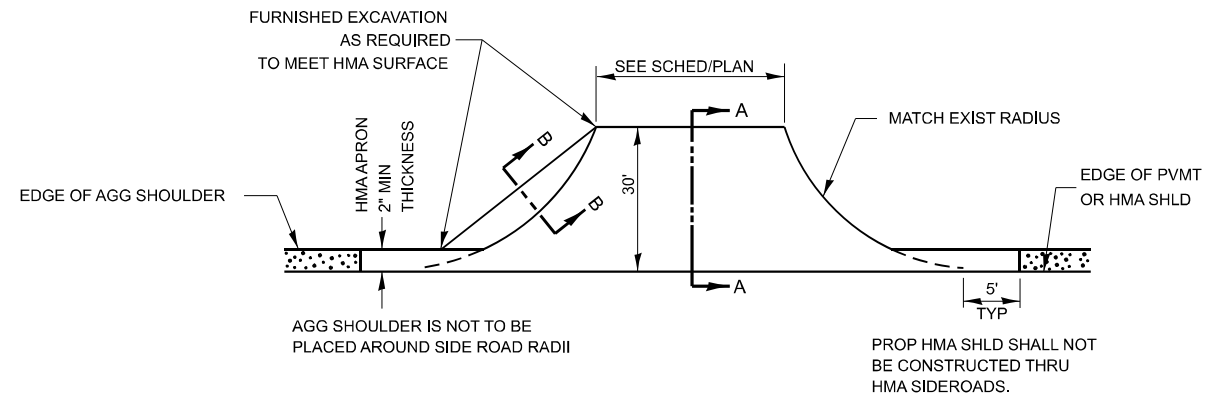

**PLAN AT SIDE ROADS**

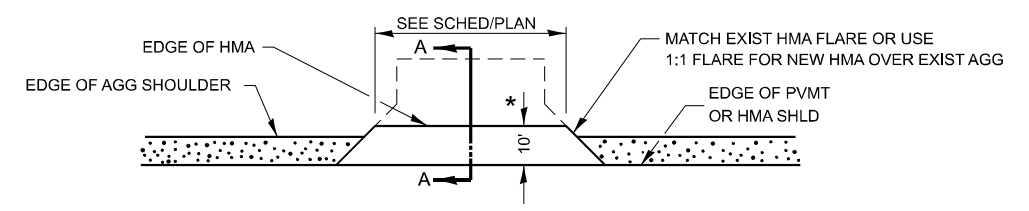

**PLAN AT PRIVATE & COMMERCIAL ENTRANCES**

(DO NOT RESURFACE FIELD ENTRANCES)

\* PROPOSED HMA RESURFACING AT PUBLIC EDUCATIONAL FACILITY ENTRANCES SHALL BE EXTENDED TO THE RIGHT-OF-WAY LIMITS.

MODEL: Default  
 FILE NAME: c:\pwworking\jzagar\k04028610\66C45 - Details.dgn

USER NAME = Joseph.Zagar	DESIGNED -	REVISED -
	DRAWN -	REVISED -
PLOT SCALE = \$SCALE\$	CHECKED -	REVISED -
PLOT DATE = 1/26/2024	DATE -	REVISED -

**STATE OF ILLINOIS  
 DEPARTMENT OF TRANSPORTATION**

<b>DETAILS</b>			
SCALE:	SHEET	OF SHEETS	STA. TO STA.

F.A.P. RTE.	SECTION	COUNTY	TOTAL SHEETS	SHEET NO.
681	116RS-2, 117RS-3	IROQUOIS	27	24
CONTRACT NO. 66C45				
ILLINOIS FED. AID PROJECT				



# IDENTIFICATION OF ROADSIDE HAZARDS FOR TWO-LANE ROADWAYS

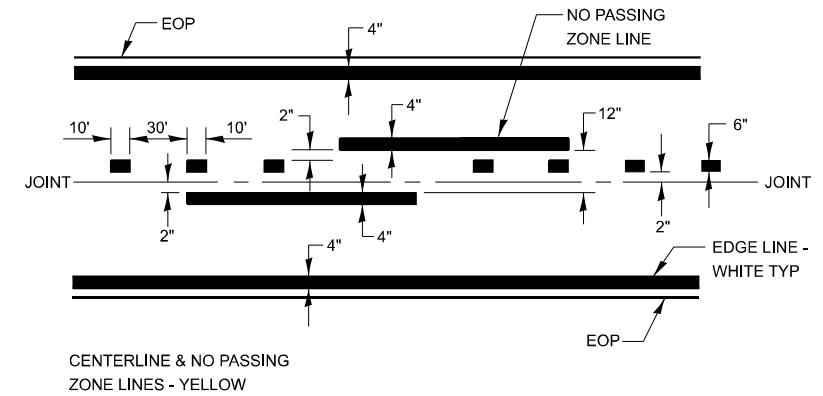
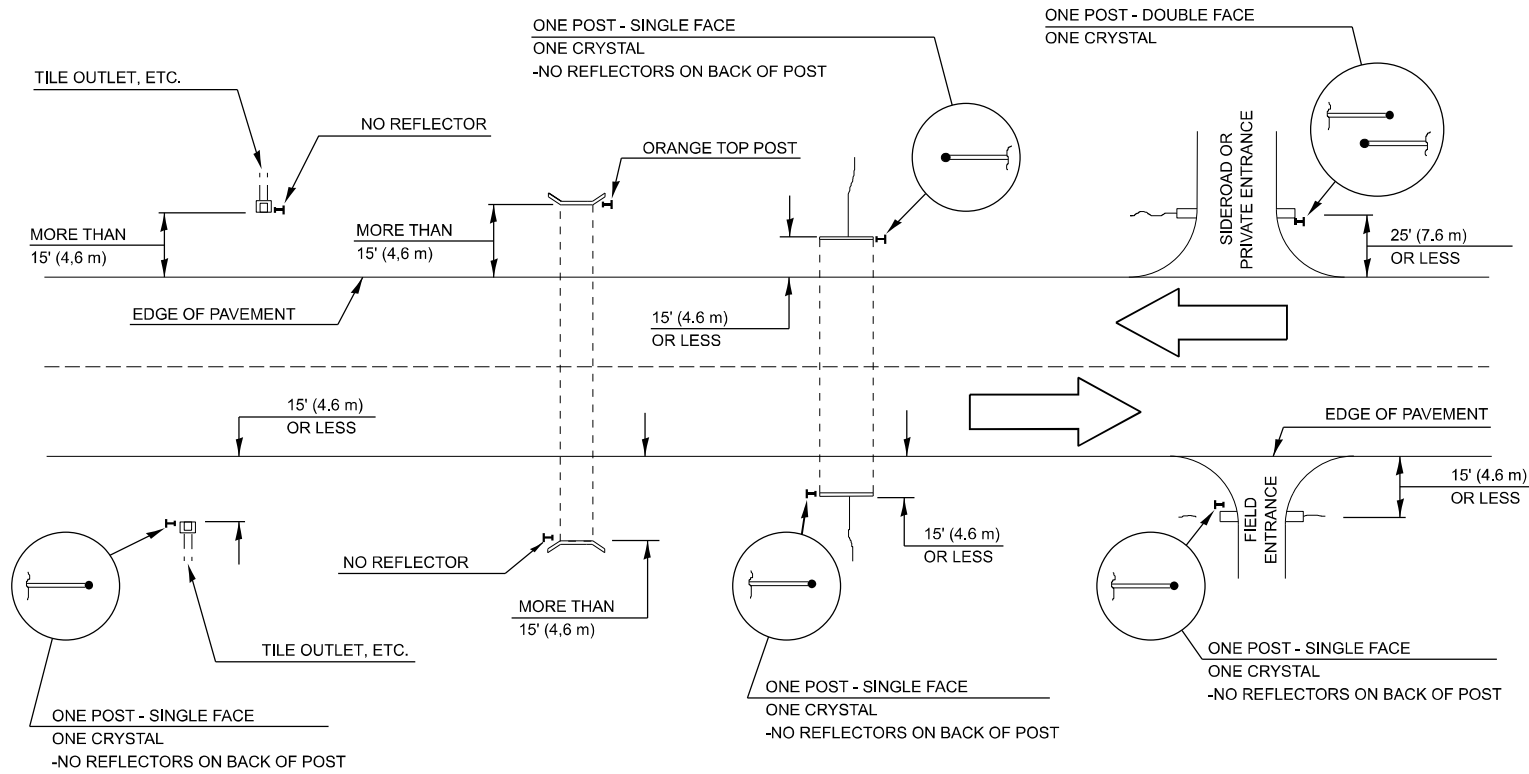

## PAVEMENT MARKING

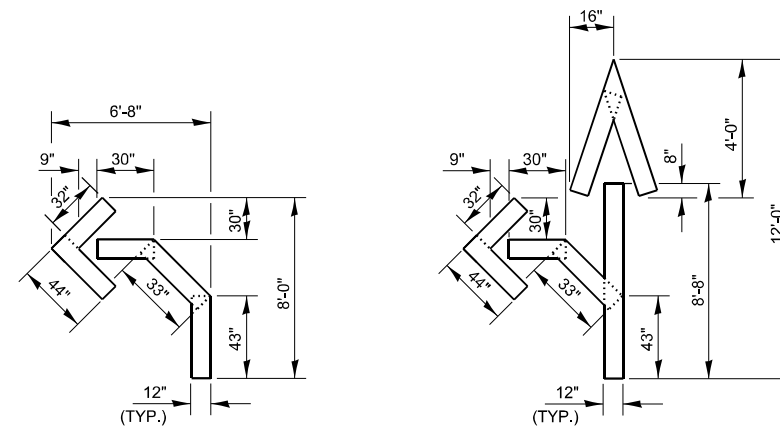

QUANTITY  
12" LINE = 16 LIN FT  
OR 4" LINE = 48 LIN FT

QUANTITY  
12" LINE = 29 LIN FT  
OR 4" LINE = 87 LIN FT

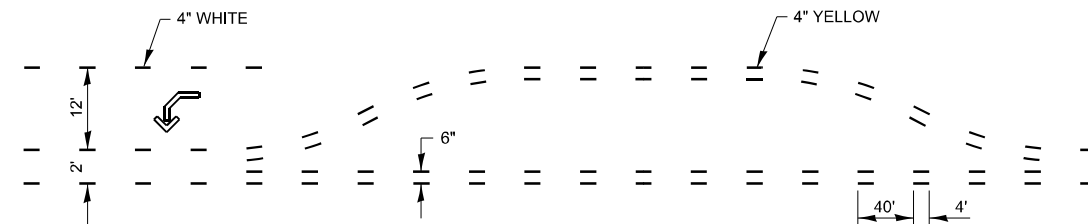

## SHORT-TERM PAVEMENT MARKING FOR MEDIANS AND ARROWS

DELINEATORS FOR ROADSIDE HAZARDS SHALL ONLY BE PLACED AT LOCATIONS WHERE THERE IS NO GUARDRAIL, OR OTHER PERMANENT BARRIER, ON THE SAME SIDE OF THE ROAD AS THE HAZZARD.

DELINEATORS FOR ROADSIDE HAZARDS SHALL ONLY BE PLACED AT LOCATIONS WHERE DELINEATORS ARE NOT IN PLACE ALONG THE EDGE OF SHOULDER.

EACH POST SHALL BE CONSIDERED AS ONE DELINEATOR FOR PAYMENT, REGARDLESS OF THE NUMBER OF DELINEATORS ATTACHED TO IT.

FOR ONE-WAY AND INTERSTATE ROADWAYS THE APPLICATION SHALL BE SIMILAR WITH DELINEATORS PLACED ON THE TRAFFIC APPROACH SIDE OF HAZARDS AND OBJECTS, ONLY SINGLE FACE DELINEATORS WILL BE REQUIRED ON ONE-WAY ROADWAYS, CRYSTAL ON THE RIGHT SIDE AND AMBER ON THE LEFT SIDE.

FOR OTHER DELINEATOR APPLICATIONS, REFER TO HIGHWAY STANDARD 635001.

MODEL: Default  
FILE NAME: c:\pwwork\jzagar\k0228610\66C45 - Details.dgn

USER NAME = Joseph.Zagar	DESIGNED -	REVISED -
PLOT SCALE = \$SCALE\$	DRAWN -	REVISED -
PLOT DATE = 1/26/2024	CHECKED -	REVISED -
	DATE -	REVISED -

STATE OF ILLINOIS  
DEPARTMENT OF TRANSPORTATION

DETAILS			
SCALE:	SHEET	OF SHEETS	STA. TO STA.

F.A.P. RTE.	SECTION	COUNTY	TOTAL SHEETS	SHEET NO.
681	116RS-2, 117RS-3	IROQUOIS	27	25
CONTRACT NO. 66C45				
ILLINOIS FED. AID PROJECT				

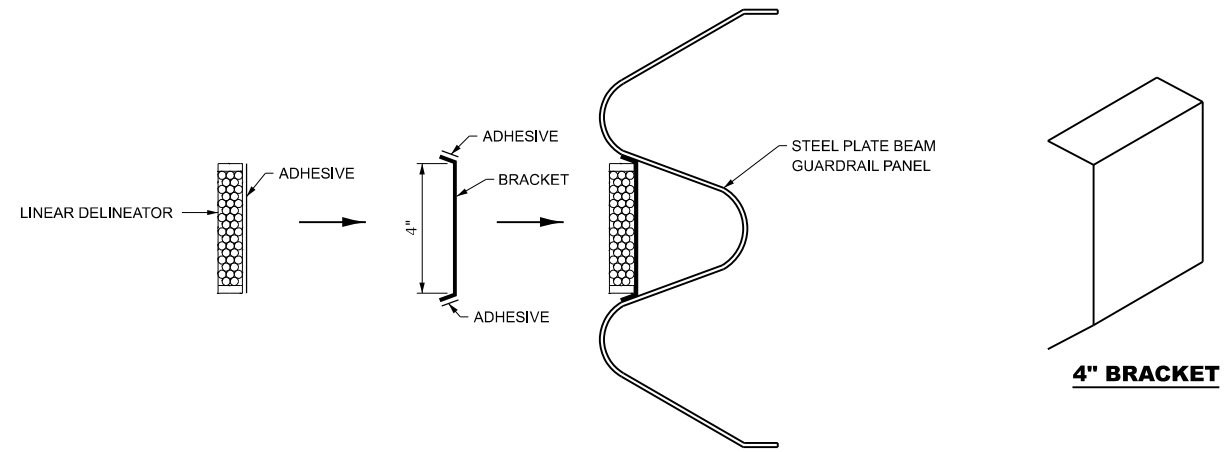

**LINEAR DELINEATOR APPLICATION TO STANDARD GALVANIZED GUARDRAIL**

LINEATOR DELINEATOR SHALL BE APLIED ACCORDING TO THE MANUFACTURER'S RECOMMENDATIONS

MODEL: Default  
FILE NAME: c:\p\work\pav\dot\zagar\k\02286\0166C45 - Details.dgn

USER NAME = Joseph.Zagar	DESIGNED -	REVISED -
	DRAWN -	REVISED -
PLOT SCALE = \$\$SCALE\$	CHECKED -	REVISED -
PLOT DATE = 1/26/2024	DATE -	REVISED -

**STATE OF ILLINOIS  
DEPARTMENT OF TRANSPORTATION**

**DETAILS**

SCALE: SHEET OF SHEETS STA. TO STA.

F.A.P. RTE.	SECTION	COUNTY	TOTAL SHEETS	SHEET NO.
681	116RS-2, 117RS-3	IROQUOIS	27	26
CONTRACT NO. 66C45				
ILLINOIS FED. AID PROJECT				

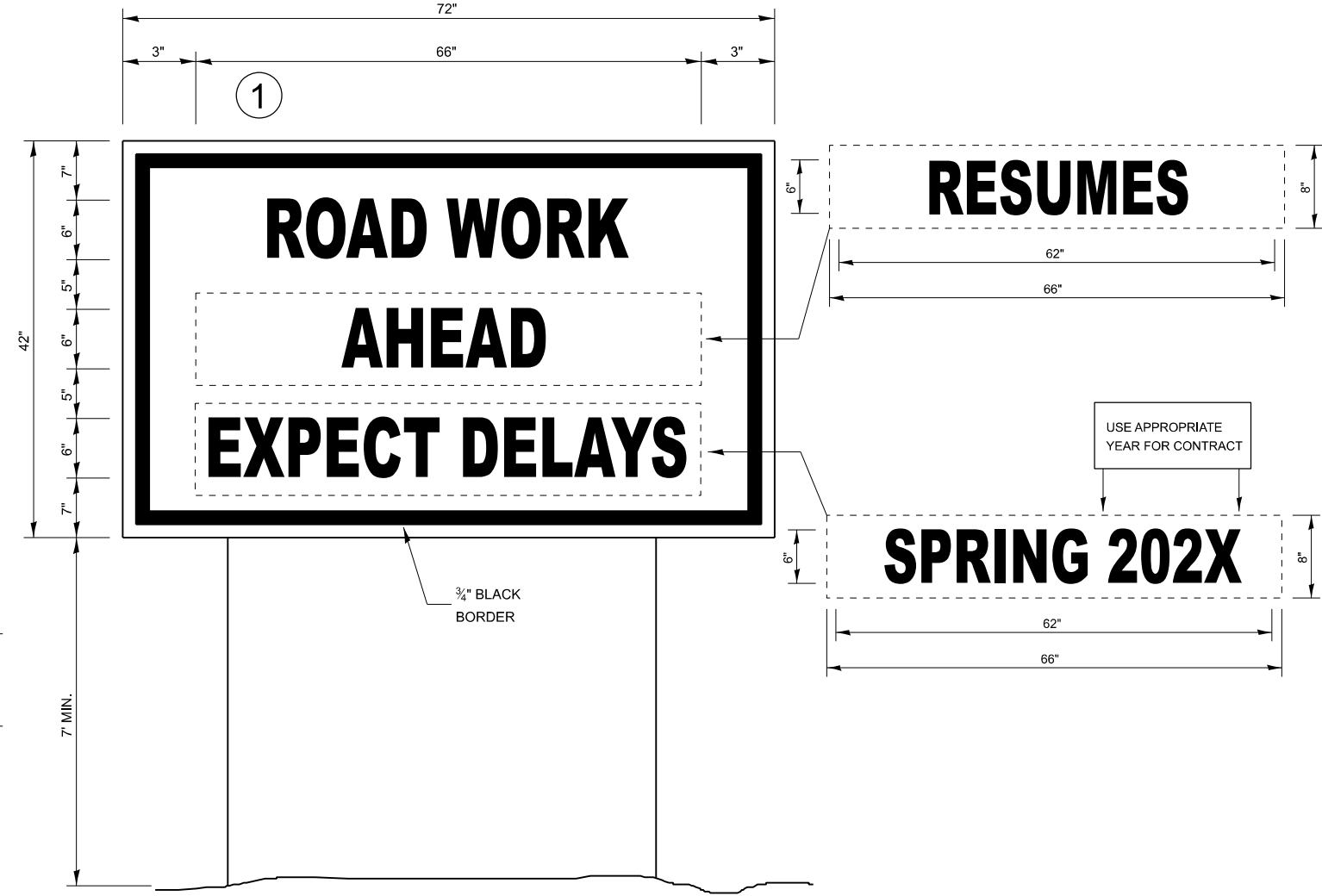
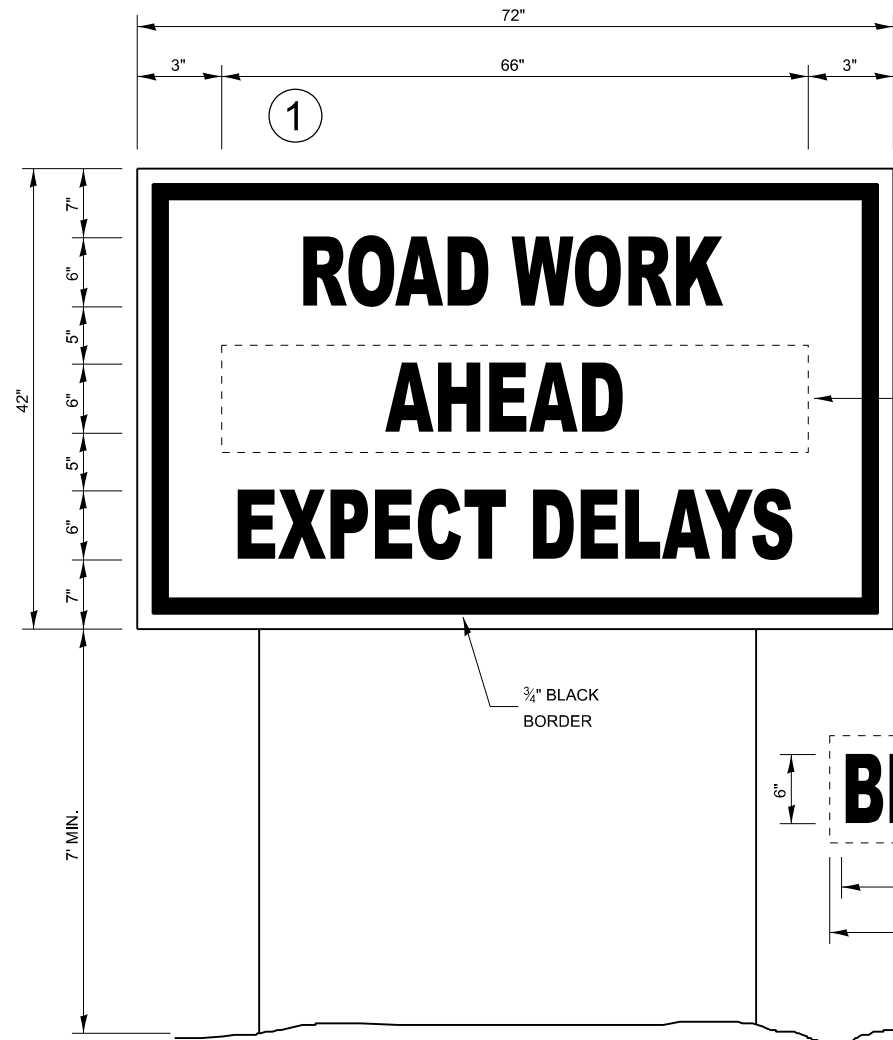

**TEMPORARY INFORMATION SIGNING**

**WINTER SHUT DOWN SIGNING**

**NOTES:**

1. USE 6" D BLACK LETTERING ON FLOURESENT ORANGE BACKGROUND.
2. ERECT SIGNS AT LOCATIONS IN ADVANCE OF THE "ROAD CONSTRUCTION AHEAD" SIGNS AS DIRECTED BY THE ENGINEER.
3. ERECT SIGN ① WITH INSTALLED PANEL ② A MINIMUM OF ONE WEEK PRIOR TO THE START OF THE LANE CLOSURE.
4. REMOVE PANEL ② ON THAT DATE.
5. SEE SPECIAL PROVISION "TEMPORARY INFORMATION SIGNING" FOR ADDITIONAL INFORMATION.
6. WILL BE PAID FOR PER SQ FT AS "TEMPORARY INFORMATION SIGNING". EACH SIGN = 21 SQ FT AND THE DATE PANEL ② WILL NOT BE MEASURED SEPARATELY FOR PAYMENT.

MODEL: Default  
FILE NAME: c:\p\work\work\zagar\k0228610\66C45 - Details.dgn

USER NAME = Joseph.Zagar	DESIGNED -	REVISED -
	DRAWN -	REVISED -
PLOT SCALE = \$\$SCALE\$	CHECKED -	REVISED -
PLOT DATE = 1/26/2024	DATE -	REVISED -

**STATE OF ILLINOIS  
DEPARTMENT OF TRANSPORTATION**

<b>DETAILS</b>			
SCALE:	SHEET	OF	SHEETS
	STA.		TO STA.

F.A.P. RTE.	SECTION	COUNTY	TOTAL SHEETS	SHEET NO.
681	116RS-2, 117RS-3	IROQUOIS	27	27
CONTRACT NO. 66C45				
ILLINOIS FED. AID PROJECT				