

STATE OF ILLINOIS  
DEPARTMENT OF TRANSPORTATION

F.A.P. RTE.	SECTION	COUNTY	TOTAL SHEETS	SHEET NO.
317	(20,21)PP	IROQUOIS	9	1
		ILLINOIS	CONTRACT NO. 66M43	

**INDEX OF SHEETS**

1. COVER SHEET
2. GENERAL NOTES
3. SUMMARY OF QUANTITIES
4. TYPICAL SECTION
5. PROJECT LAYOUT
6. SCHEDULES
- 7-8. CLASS B PAVEMENT PATCHING DETAILS
9. TEMPORARY INFORMATION SIGNING

**HIGHWAY STANDARDS**

000001-08	STANDARD SYMBOLS, ABBREVIATIONS AND PATTERNS
001001-02	AREAS OF REINFORCEMENT BARS
001006	DECIMAL OF AN INCH AND OF A FOOT
701001-02	OFF-ROAD OPERATIONS 2L, 2W, MORE THAN 15' (4.5 m) AWAY
701006-05	OFF-ROAD OPERATIONS 2L, 2W, 15' (4.5 m) TO 24" (600 mm) FROM PAVEMENT EDGE
701301-04	LANE CLOSURE, 2L, 2W, SHORT TIME OPERATIONS
701336-07	LANE CLOSURE, 2L, 2W, WORK AREAS IN SERIES, FOR SPEEDS ≥ 45 MPH
701501-06	URBAN LANE CLOSURE, 2L, 2W, UNDIVIDED
701901-09	TRAFFIC CONTROL DEVICES

**PROPOSED  
HIGHWAY PLANS**

**FAP ROUTE 317 (US 24)  
SECTION (20,21)PP  
CLASS B PAVEMENT PATCHING  
IROQUOIS COUNTY  
C-93-068-22**

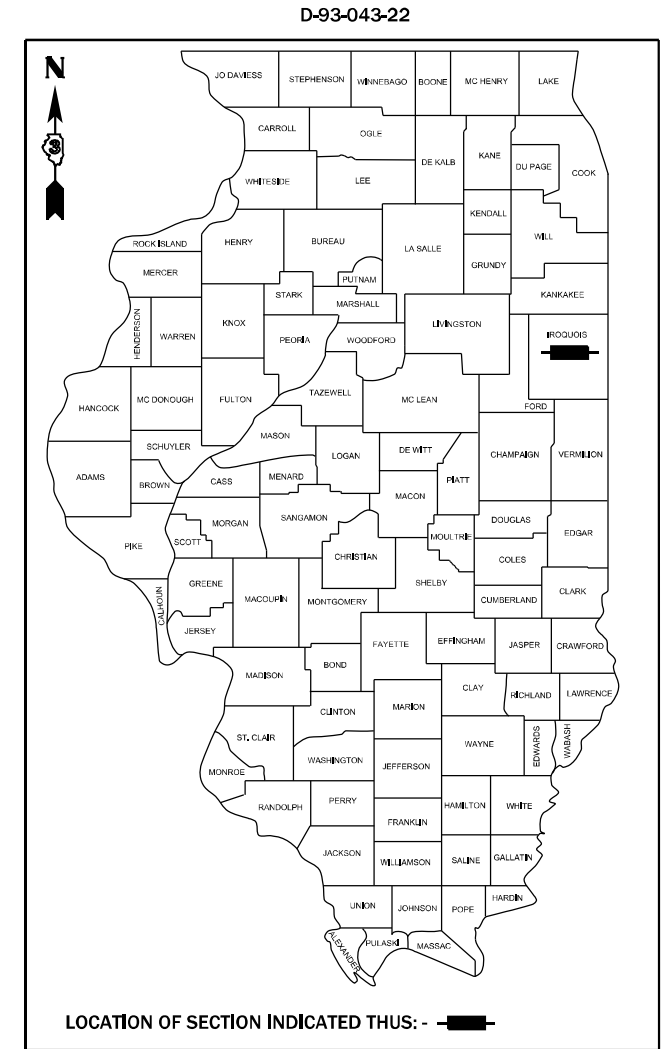

**BEGIN IMPROVEMENT**

INTERSECTION OF  
US 49 AND US 24  
IN CRESENT CITY  
LOG MILE. 0.00

**END IMPROVEMENT**

WEST ABUTMENT  
OF STRUCTURE NO. 038-0179  
EAST OF WATSEKA  
LOG MILE 6.35

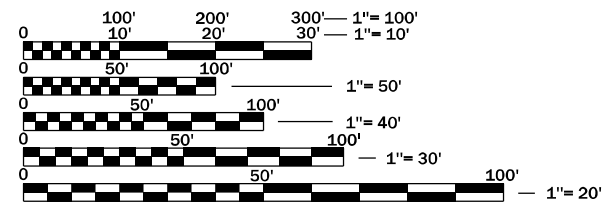

FULL SIZE PLANS HAVE BEEN PREPARED USING STANDARD ENGINEERING SCALES. REDUCED SIZED PLANS WILL NOT CONFORM TO STANDARD SCALES. IN MAKING MEASUREMENTS ON REDUCED PLANS, THE ABOVE SCALES MAY BE USED.

J.U.L.I.E.  
JOINT UTILITY LOCATION INFORMATION FOR EXCAVATION  
1-800-892-0123  
OR 811

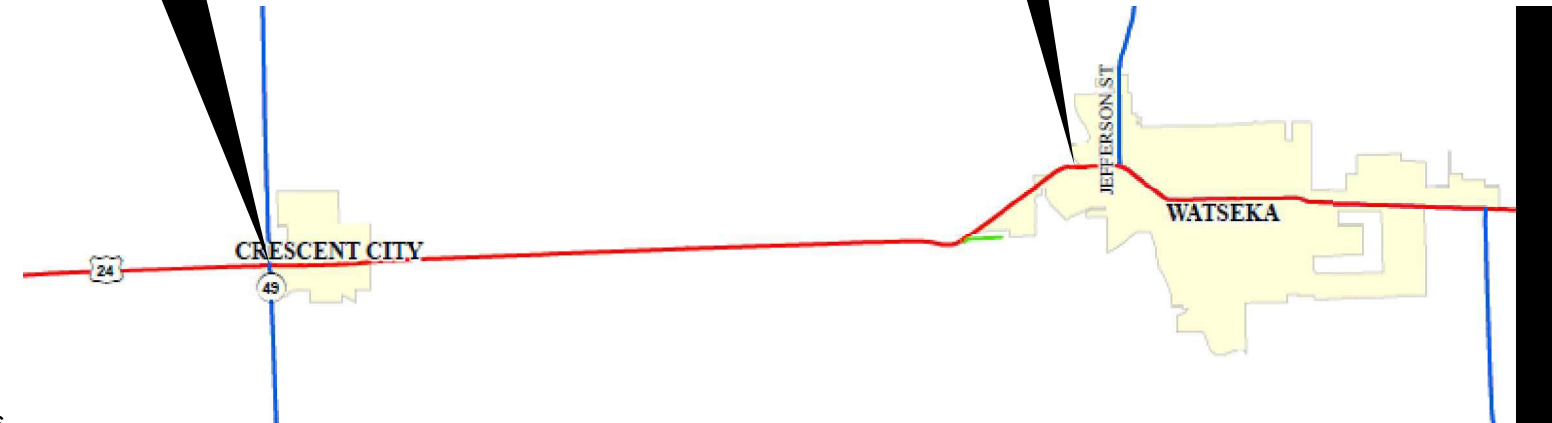

**PROJECT ENGINEER YOGESH PATEL P.E.  
UNIT CHIEF RON WOODSHANK  
DISTRICT 3 NO. (815) 434-6131  
CONTRACT NO. 66M43**

GROSS LENGTH = 33,528 FT. = 6.35 MILES  
NET LENGTH = 230 FT. = 1.75 MILES

**FUNCTIONAL CLASSIFICATION**  
RURAL/URBAN OTHER PRINCIPAL ARTERIAL  
F.A.P. ROUTE 317 US 24)  
2019 ADT = 4650  
P.V. 79.1 % S.U. 5.6 % M.U. 15.3 %

STATE OF ILLINOIS  
DEPARTMENT OF TRANSPORTATION

SUBMITTED February 06, 2024  
*Stephen M. Harris* REGIONAL ENGINEER  
March 22, 2024  
*Scott A. Etkin*  
ENGINEER OF DESIGN AND ENVIRONMENT  
March 22, 2024  
*Stephen M. Harris*  
DIRECTOR OF HIGHWAYS PROJECT IMPLEMENTATION

**PRINTED BY THE AUTHORITY  
OF THE STATE OF ILLINOIS**

**GENERAL NOTES**

ALL EXCAVATED MATERIALS, WHICH INCLUDES DIGGING OR GRADING OF ANY SOIL OR FILL MATERIAL WITH THE EXECUTION OF AGGREGATE FILLS, MUST BE INCORPORATED WITHIN THE LIMITS OF THE IDOT RIGHT OF WAY.

**COMMITMENTS**

PRIOR TO BEGINNING AND CONSTRUCTION WORK ON THIS PROJECT, THE CONTRACTOR SHALL COORDINATE FINAL, PERMANENT PAVEMENT MARKING WORK WITH THE IDOT BUREAU OF OPERATIONS, TRAFFIC SECTION. PHONE (815) 434-8446.

STATE OF ILLINOIS  
DEPARTMENT OF TRANSPORTATION  
DISTRICT THREE  
AS BUILT INFORMATION

\_\_\_\_\_  
SUPERVISING CONSTRUCTION FIELD ENGINEER

\_\_\_\_\_  
RESIDENT ENGINEER / TECHNICIAN

START & END DATES  
OF CONSTRUCTION:

INSPECTORS:

FILE NAME =	USER NAME = ronald.woodshank	DESIGNED - EVAN MARINI	REVISED -	<b>STATE OF ILLINOIS DEPARTMENT OF TRANSPORTATION</b>	<b>GENERAL NOTES</b>			F.A.P. RTE.	SECTION	COUNTY	TOTAL SHEETS	SHEET NO.
pw:\illdot\pw.berkeley.com\PWIDOT\Documents\IDOT Office\District 3\Projects\I366M43\CADData\I366M43 - PLANS.dwg	DRAWN - EVAN MARINI	REVISED -	317					(20,21)PP	IROQUOIS	9	2	
Default	PLOT SCALE = 100,0000' / in.	CHECKED - RON WOODSHANK	REVISED -		CONTRACT NO. 66M43							
	PLOT DATE = 10/4/2023	DATE - 1/22/2019	REVISED -		SCALE:	SHEET 1	OF 1	SHEETS	STA.	TO STA.	ILLINOIS FED. AID PROJECT	

CODE NO.	ITEM	UNIT	TOTAL QUANTITY	CONSTRUCTION CODE	
				CONTRACT MAINTENANCE	
				100% STATE	
				ROADWAY	
				0006	
				RURAL	
44200050	WELDED WIRE REINFORCEMENT	SQ YD	32		32
44201007	CLASS B PATCHES, TYPE II, 13 INCH	SQ YD	185		185
44201011	CLASS B PATCHES, TYPE III, 13 INCH	SQ YD	32		32
44201043	CLASS B PATCHES, TYPE II, 16 INCH	SQ YD	101		101
44201297	DOWEL BARS 1"	EACH	220		220
44201299	DOWEL BARS 1 1/2"	EACH	480		480
44213200	SAW CUTS	FOOT	1684		1684
67100100	MOBILIZATION	L SUM	1		1
70100600	TRAFFIC CONTROL AND PROTECTION, STANDARD 701336	L SUM	1		1
70102620	TRAFFIC CONTROL AND PROTECTION, STANDARD 701501	L SUM	1		1
Z0030850	TEMPORARY INFORMATION SIGNING	SQ FT	42		42

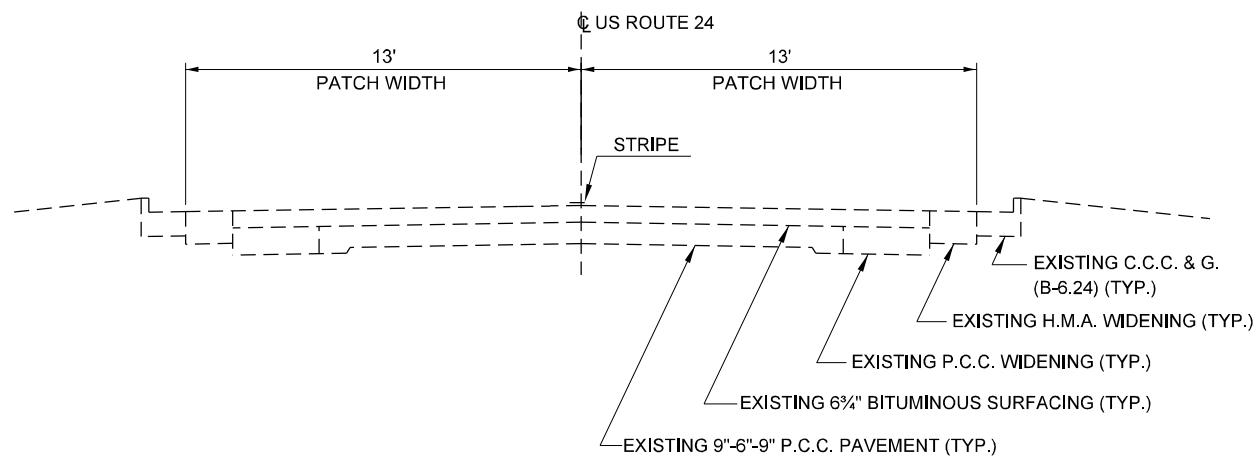

**TYPICAL SECTION 1**

LOG MILE 0.00 TO LOG MILE 0.34

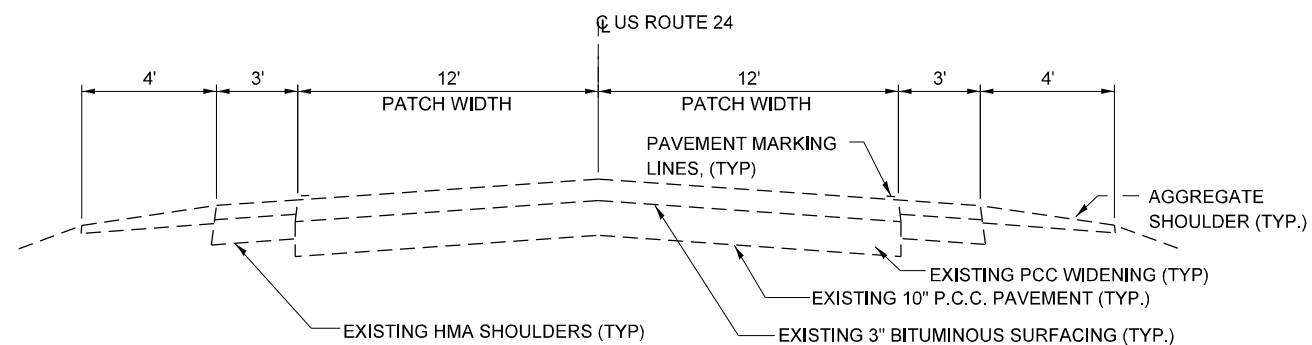

**TYPICAL SECTION 2**

LOG MILE 4.60 TO LOG MILE 6.31 (WEST ABUTMENT SN 038-0179)

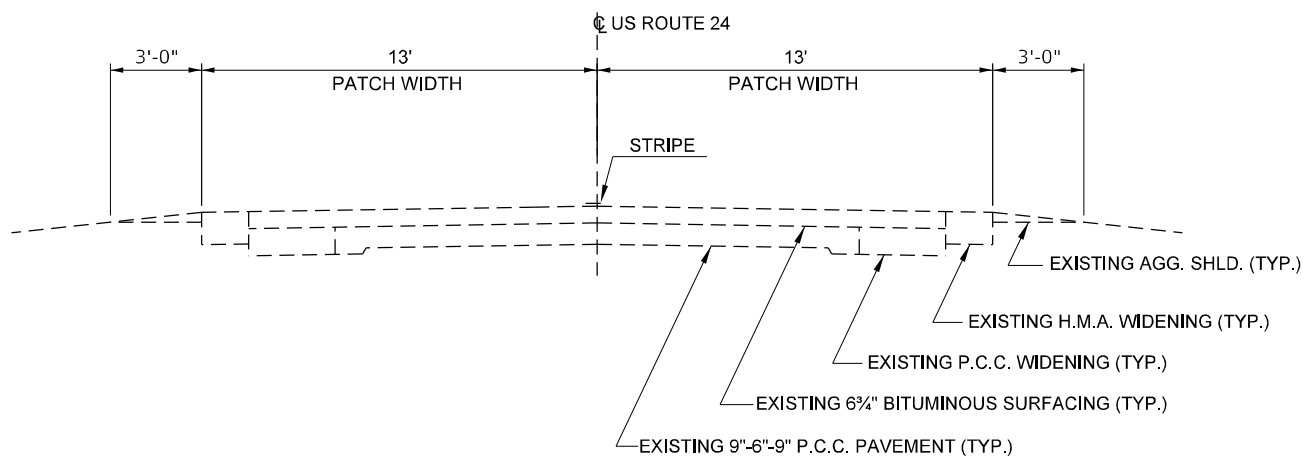

**TYPICAL SECTION 2**

LOG MILE 0.34 TO LOG MILE 4.60

FILE NAME =	USER NAME = ronald.woodshank	DESIGNED - EVAN MARINI	REVISED -
pw:\illdot\pw.berntley.com\PWIDOT\Documents\IDOT Office\District 3\Projects\I386M43\CADData\I386M43 - PLANS.dwg		DRAWN - EVAN MARINI	REVISED -
Default	PLOT SCALE = 100,0000' / in.	CHECKED - RON WOODSHANK	REVISED -
	PLOT DATE = 10/4/2023	DATE - 1/22/2019	REVISED -

STATE OF ILLINOIS  
DEPARTMENT OF TRANSPORTATION

TYPICAL SECTIONS

SCALE: SHEET 1 OF 1 SHEETS STA. TO STA.

F.A.P. RTE.	SECTION	COUNTY	TOTAL SHEETS	SHEET NO.
317	(20,21)PP	IROQUOIS	9	4
CONTRACT NO. 66M43			ILLINOIS FED. AID PROJECT	

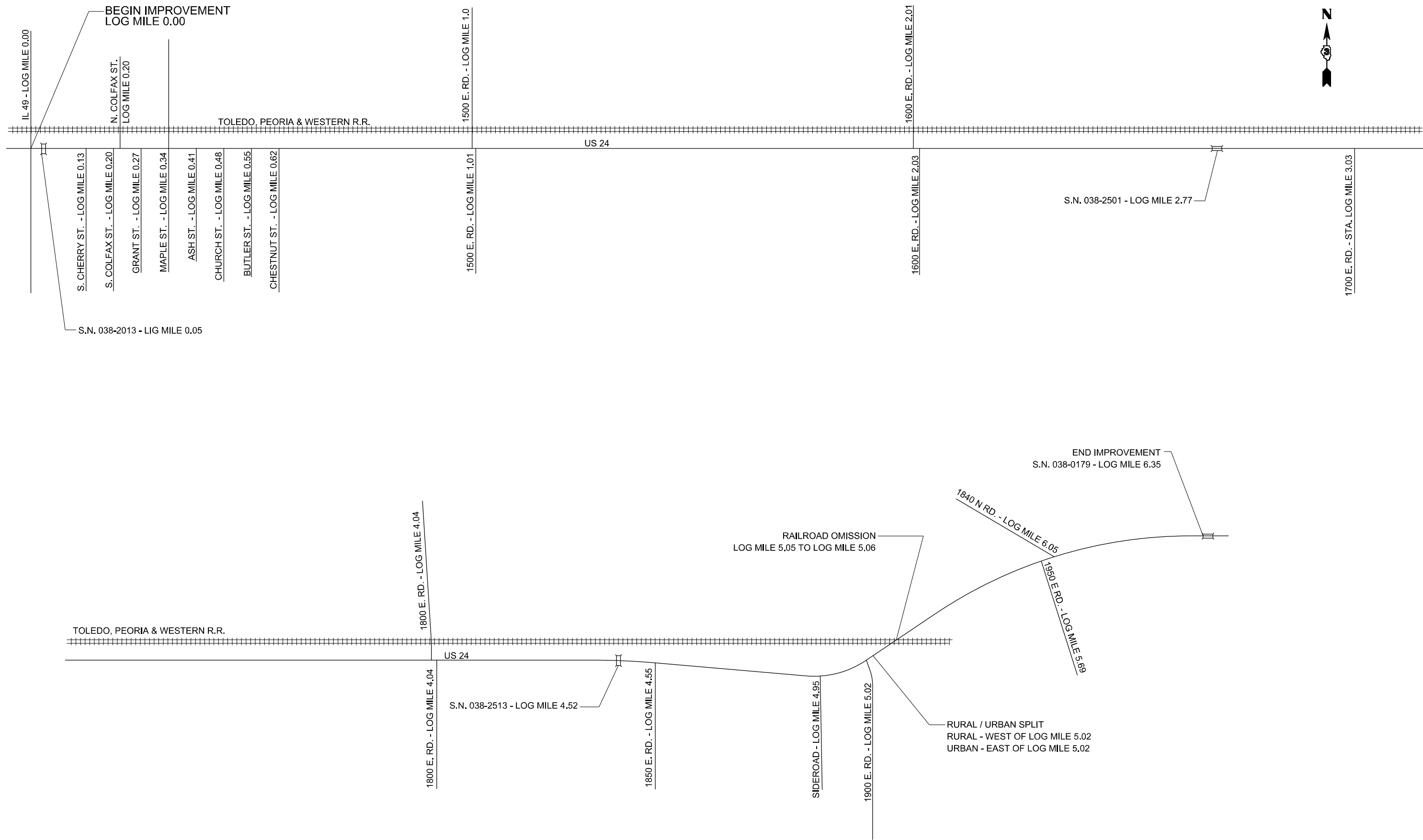

FILE NAME =	USER NAME = ronald.woodshank	DESIGNED - EVAN MARINI	REVISED -	<b>STATE OF ILLINOIS DEPARTMENT OF TRANSPORTATION</b>	<b>PROJECT LAYOUT</b>			F.A.P. RTE.	SECTION	COUNTY	TOTAL SHEETS	SHEET NO.
pw:\illdot\pw\berkeley.com\PWIDOT\Documents\IDOT Office\District 3\Projects\I366M43\CADData\I366M43 - PLANS.dwg	DRAWN - EVAN MARINI	REVISIONS -			317	(20,21)PP	IROQUOIS	9	5			
Default	PLOT SCALE = 100,0000' / in.	CHECKED - RON WOODSHANK	REVISED -		CONTRACT NO. 66M43			ILLINOIS FED. AID PROJECT				
	PLOT DATE = 10/4/2023	DATE - 1/22/2019	REVISED -		SCALE:	SHEET 1 OF 1 SHEETS	STA.	TO STA.				

**PATCHING SCHEDULE**

**EASTBOUND LANE**

**WESTBOUND LANE**

LOCATION EASTBOUND	PATCH LENGTH	PATCH WIDTH	CLASS B		DOWEL BARS 1"	SAW CUTS	WELDED WIRE REINF.	PATCH LENGTH	PATCH WIDTH	CLASS B		DOWEL BARS 1"	SAW CUTS	WELDED WIRE REINF.
			TYPE II 16"	TYPE III 16"						TYPE II 16"	TYPE III 16"			
			SQ YD	SQ YD						SQ YD	SQ YD			
LOG MILE	FEET	FEET	SQ YD	SQ YD	EACH	FOOT	SQ YD	FEET	FEET	SQ YD	SQ YD	EACH	FOOT	SQ YD
0.1								6	13	9		22	48	
0.3								6	13	9		22	48	
0.4								6	13	9		22	48	
0.6								6	13	9		22	48	
0.8	6	13	9		22	48								
0.9	6	13	9		22	48								
2.6	8	13	12		22	52								
2.6	6	13	9		22	48								
4.5	10	13	14		22	56								
4.6	8	13	12		22	52								
<b>TOTAL</b>			<b>65</b>		<b>132</b>	<b>304</b>				<b>36</b>		<b>88</b>	<b>192</b>	

**PATCHING SCHEDULE**

**EASTBOUND LANE**

**WESTBOUND LANE**

LOCATION EASTBOUND	PATCH LENGTH	PATCH WIDTH	CLASS B		DOWEL BARS 1 1/2"	SAW CUTS	WELDED WIRE REINF.	PATCH LENGTH	PATCH WIDTH	CLASS B		DOWEL BARS 1 1/2"	SAW CUTS	WELDED WIRE REINF.
			TYPE II 13'	TYPE III 13"						TYPE II 13'	TYPE III 13"			
			SQ YD	SQ YD						SQ YD	SQ YD			
LOG MILE	FEET	FEET	SQ YD	SQ YD	EACH	FOOT	SQ YD	FEET	FEET	SQ YD	SQ YD	EACH	FOOT	SQ YD
4.7	8	12	11		20	52		6	12	8		20	48	
4.7		12						6	12	8		20	48	
4.8	6	12	8		20	48		6	12	8		20	48	
4.8	6	12	8		20	48		6	12	8		20	48	
4.9								6	12	8		20	48	
4.9								6	12	8		20	48	
5.0								6	12	8		20	48	
5.1	6	12	8		20	48								
5.2	8	12	11		20	52		6	12	8		20	48	
5.2	6	12	8		20	48		6	12	8		20	48	
5.4								6	12	8		20	48	
5.5								6	12	8		20	48	
5.6	12	12		16	20	60	16	6	12	8		20	48	
6.1	6	12	8		20	48		12	12		16	20	60	16
6.1	6	12	8		20	48								
6.2	6	12	8		20	48		8	12	11		20	52	
<b>TOTAL</b>			<b>78</b>	<b>16</b>	<b>200</b>	<b>500</b>	<b>16</b>			<b>107</b>	<b>16</b>	<b>280</b>	<b>688</b>	<b>16</b>

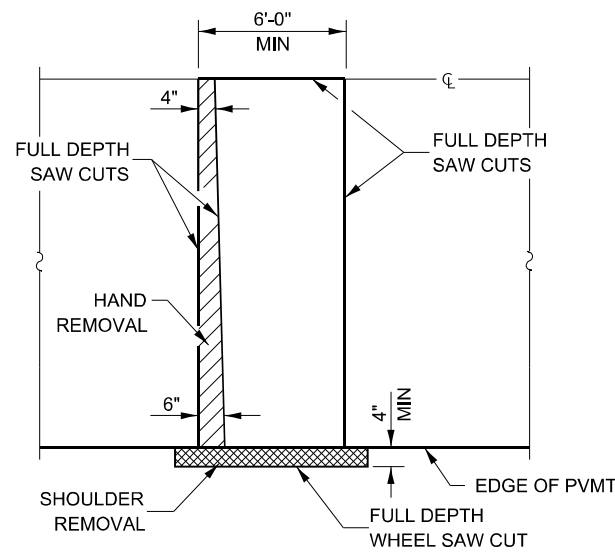

**PAVEMENT SAWING DETAIL**

(HMA SHOULDER)

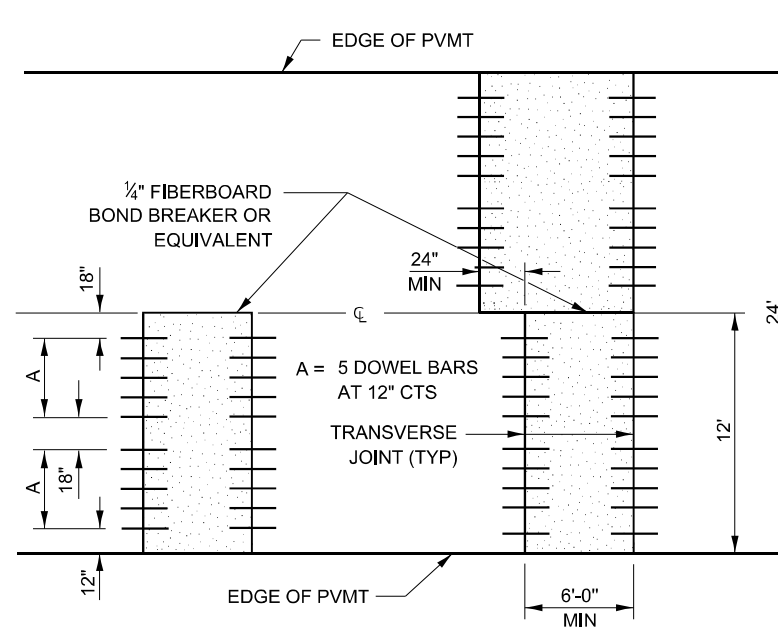

**12' WIDE LANES**

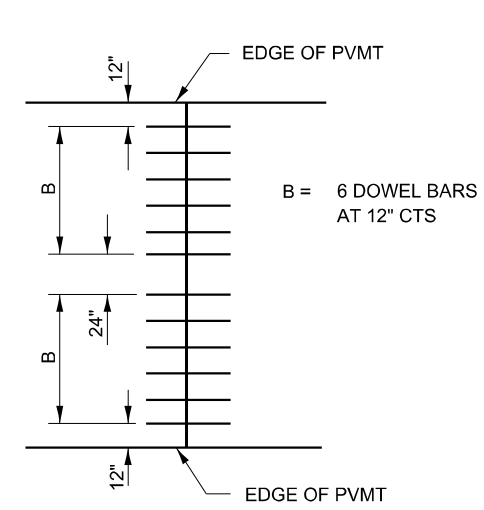

**14' WIDE RAMP**

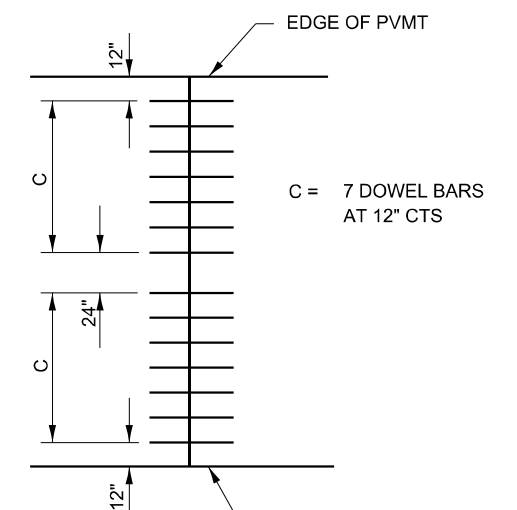

**16' WIDE RAMP**

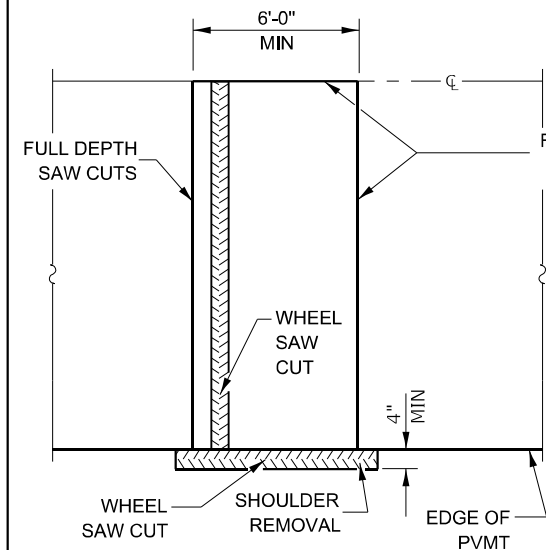

**ALTERNATE SAWING DETAIL**

(HMA SHOULDER)

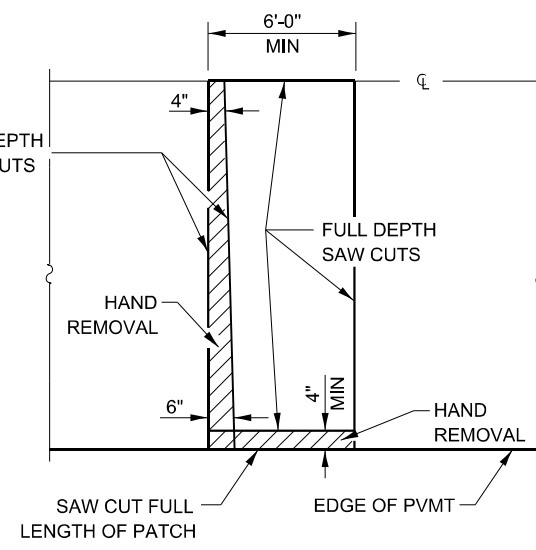

**PAVEMENT SAWING DETAIL**

(PCC SHOULDER)

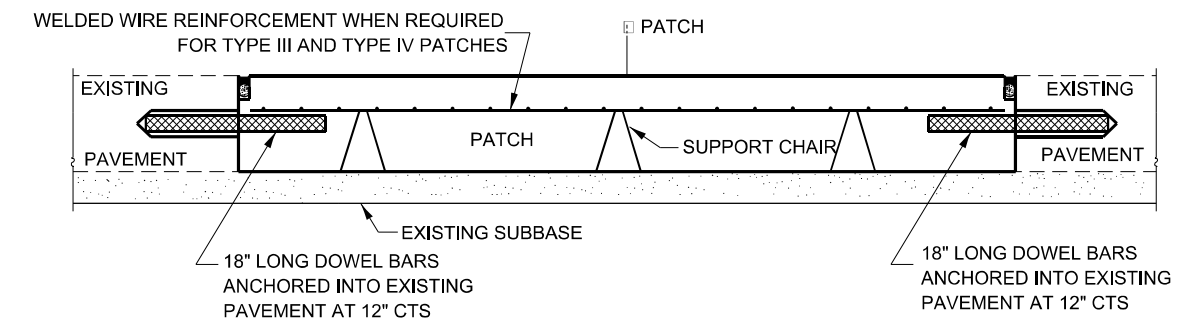

**PATCHING WITHOUT HMA OVERLAY**

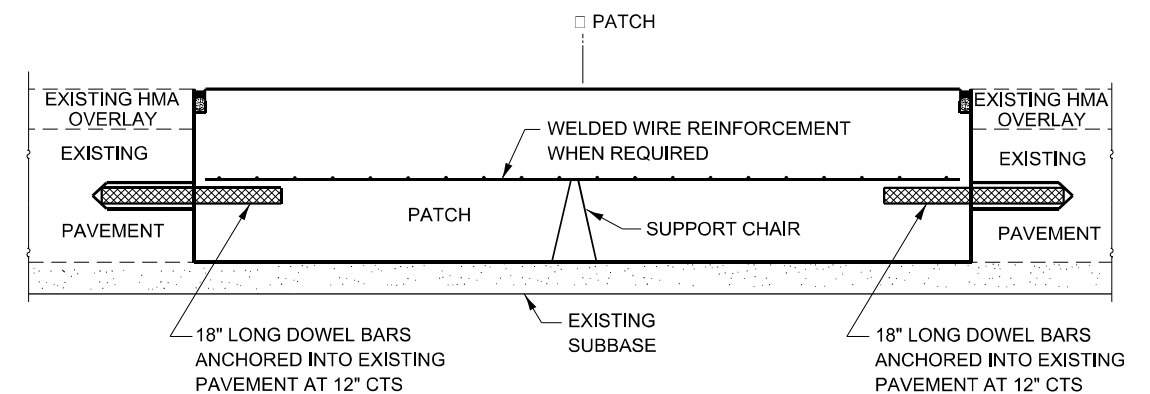

**PATCHING WITH HMA OVERLAY**

MODEL: D:\in\it\... FILE NAME: ...

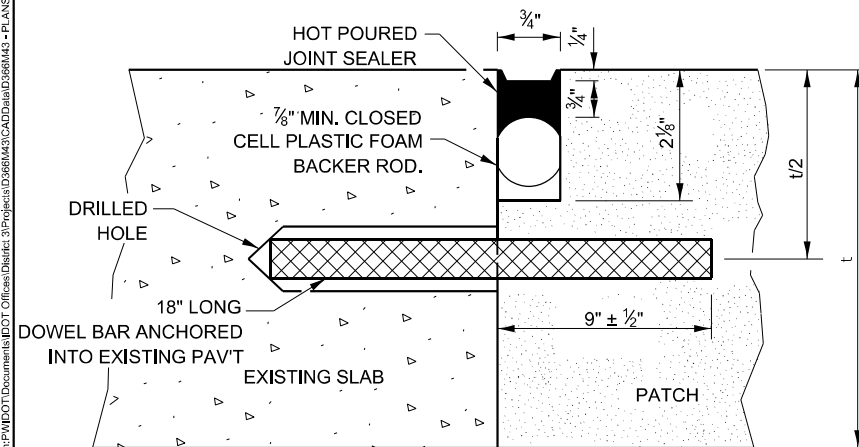

**TRANSVERSE JOINT**

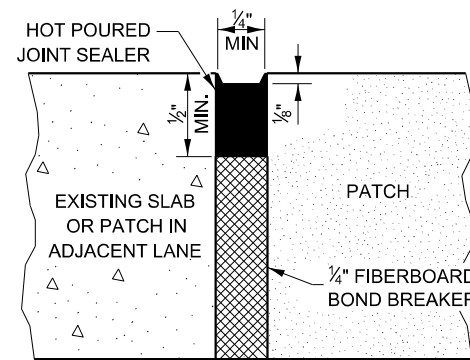

**CENTERLINE JOINT**

DOWEL BAR TABLE		
PAVEMENT THICKNESS	DOWEL BAR DIAMETER	HOLE DIAMETER
8" OR GREATER	1 1/2"	1 5/8"
7" THRU 7.99"	1 1/4"	1 3/8"
LESS THAN 7"	1"	1 1/8"

**GENERAL NOTES**

THE TRANSVERSE JOINTS FOR CLASS B PATCHES SHALL ALIGN WITH JOINTS OR CRACKS IN THE ADJACENT LANE WHENEVER POSSIBLE.  
SEE STANDARD 420701 FOR DETAILS OF PAVEMENT WELDED WIRE REINFORCEMENT.

USER NAME = ronald.woodshank	DESIGNED -	REVISED -
DRAWN -	REVISOR -	REVISION -
PLOT SCALE = 100,0000' / in.	CHECKED -	REVISOR -
PLOT DATE = 10/4/2023	DATE -	REVISION -

**STATE OF ILLINOIS  
DEPARTMENT OF TRANSPORTATION**

**CLASS "A" PATCHING DETAILS**

SCALE: SHEET 1 OF 2 SHEETS STA. TO STA.

F.A.P. RTE.	SECTION	COUNTY	TOTAL SHEETS	SHEET NO.
317	(20,21)PP	IROQUOIS	9	7
CONTRACT NO. 66M43				
ILLINOIS FED. AID PROJECT				

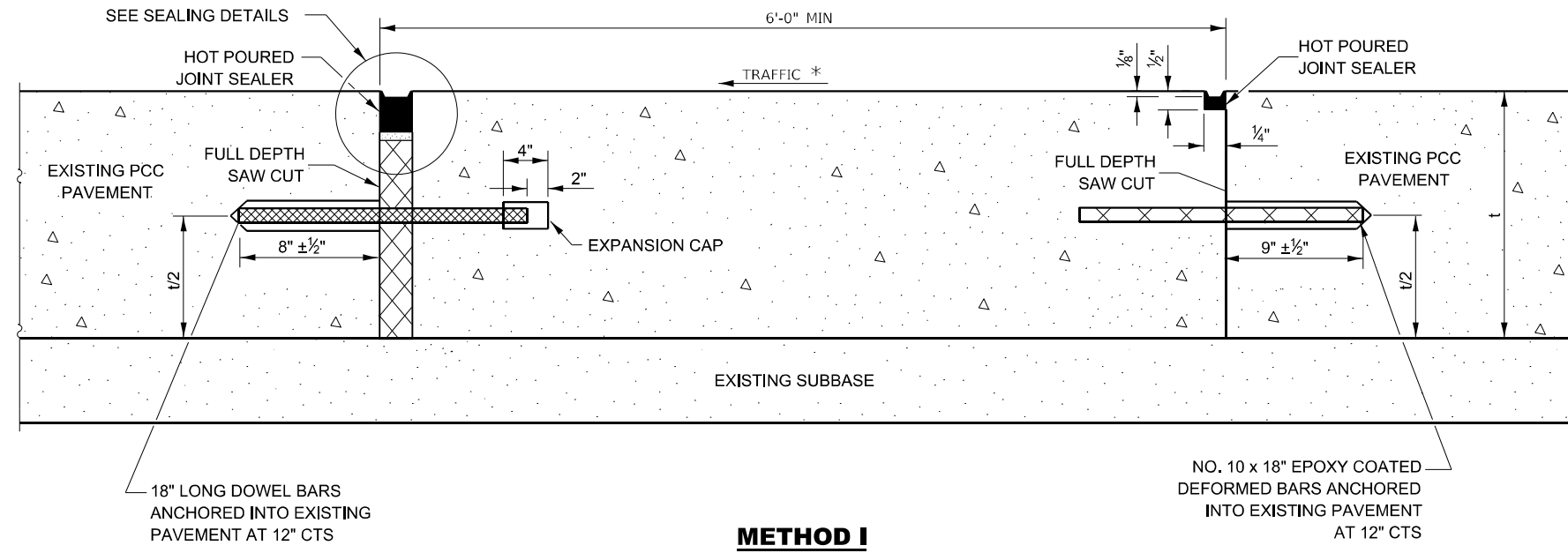

**METHOD I**  
(WITHOUT HMA OVERLAY)

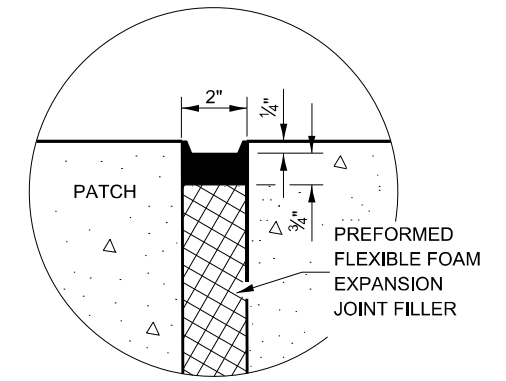

**SEALING DETAIL**

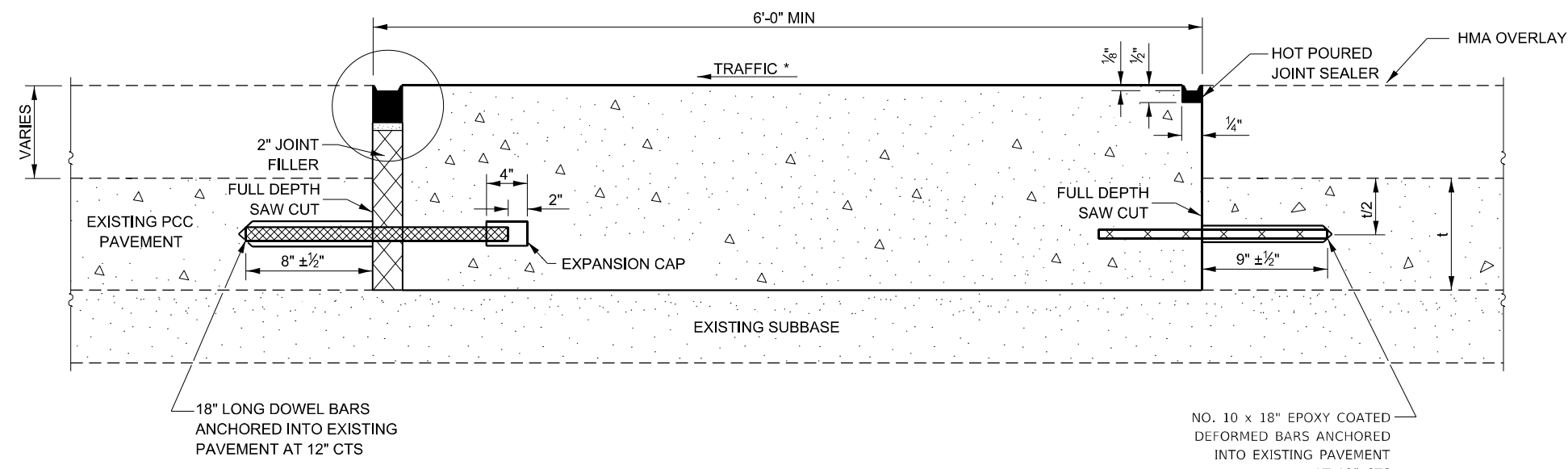

**METHOD II**  
(WITH HMA OVERLAY)

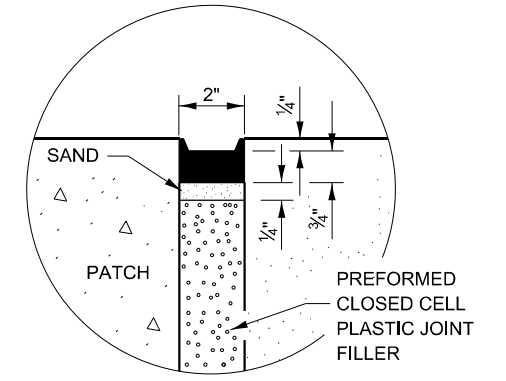

**SEALING DETAIL**

**NOTE**

\* WHEN RE-ESTABLISHING A TRANSVERSE EXPANSION JOINT ON A TWO-WAY ROAD, REVERSE THE ORIENTATION OF THE DOWEL BARS WITH RESPECT TO TRAFFIC FOR ONE OF THE PATCHES SUCH THAT THE JOINT WILL BE CONTINUOUS ACROSS BOTH LANES.

MODEL: D:\in\it...  
 FILE NAME: ...

USER NAME = ronald.woodshank	DESIGNED -	REVISED -
DRAWN -	REVISIONS -	
PLOT SCALE = 100,0000' / in.	CHECKED -	REVISED -
PLOT DATE = 10/4/2023	DATE -	REVISED -

**STATE OF ILLINOIS**  
**DEPARTMENT OF TRANSPORTATION**

<b>MISCELLANEOUS DETAILS</b>	
SCALE:	SHEET 1 OF 1 SHEETS
STA.	TO STA.

F.A.P. RTE.	SECTION	COUNTY	TOTAL SHEETS	SHEET NO.
317	(20,21)PP	IROQUOIS	9	8
CONTRACT NO. 66M43				
		ILLINOIS	FED. AID PROJECT	



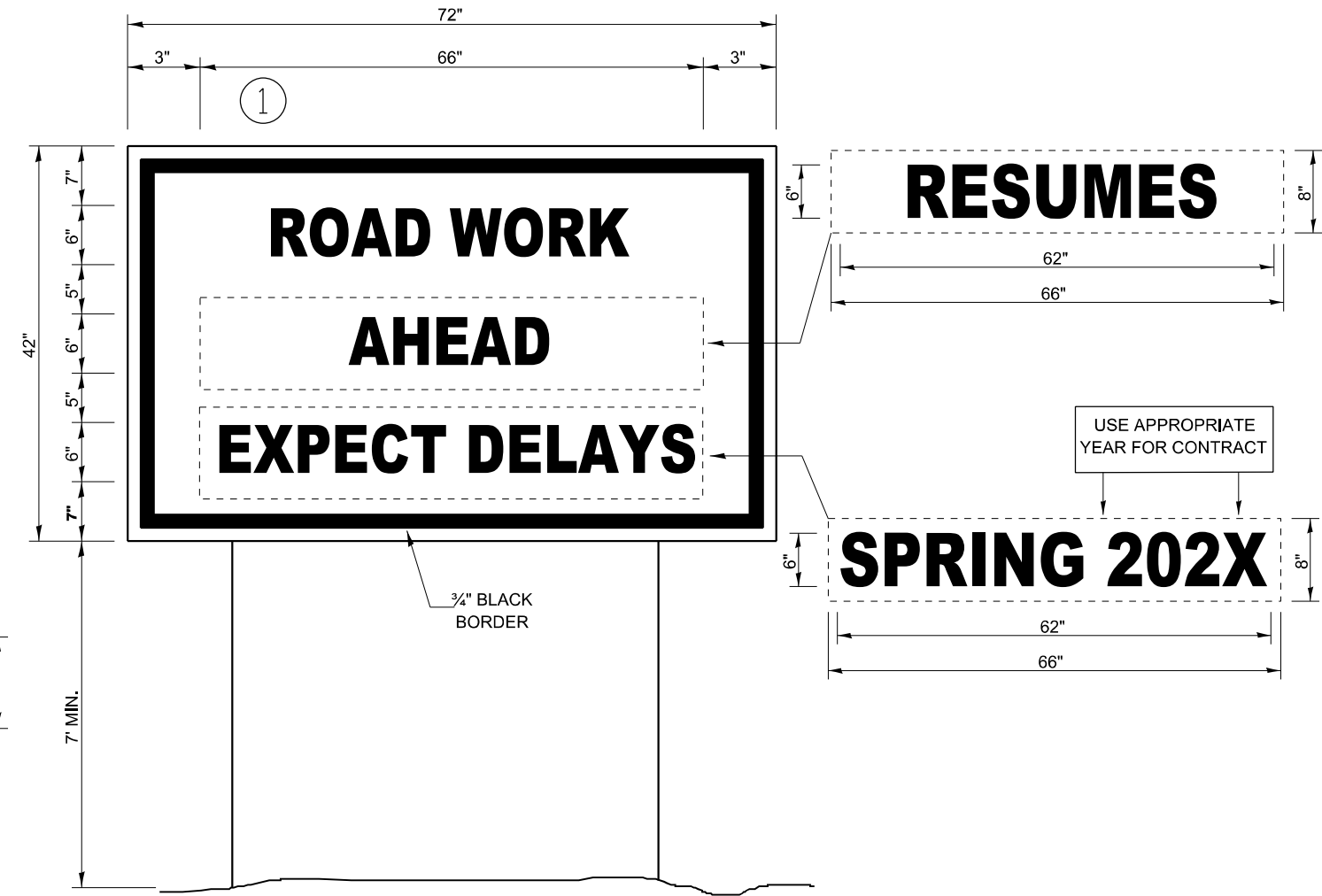
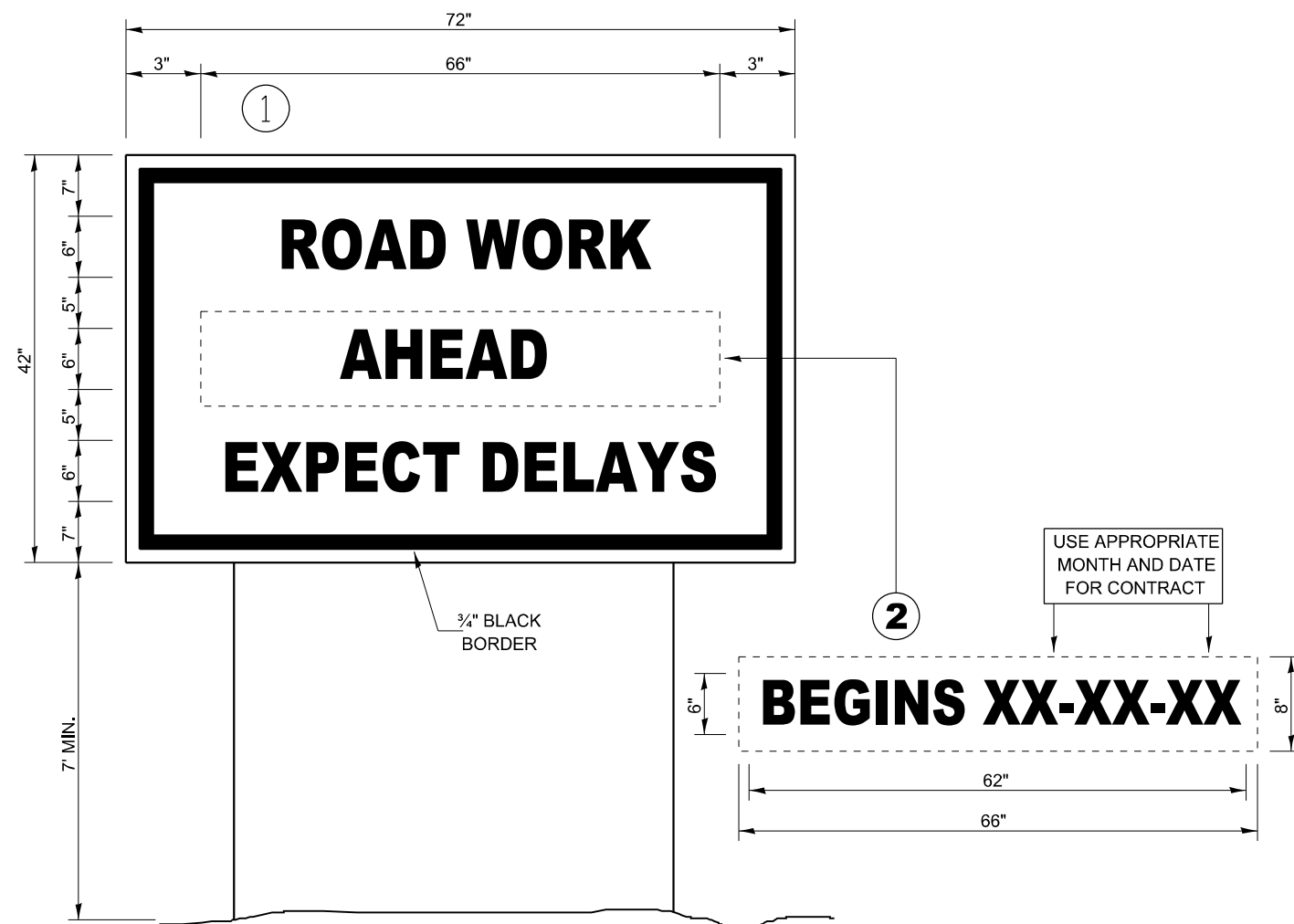

## TEMPORARY INFORMATION SIGNING

## WINTER SHUT DOWN SIGNING

### NOTES:

1. USE 6" D BLACK LETTERING ON FLOURESENT ORANGE BACKGROUND.
2. ERECT SIGNS AT LOCATIONS IN ADVANCE OF THE "ROAD CONSTRUCTION AHEAD" SIGNS AS DIRECTED BY THE ENGINEER.
3. ERECT SIGN ① WITH INSTALLED PANEL ② A MINIMUM OF ONE WEEK PRIOR TO THE START OF THE LANE CLOSURE.
4. REMOVE PANEL ② ON THAT DATE.
5. SEE SPECIAL PROVISION "TEMPORARY INFORMATION SIGNING" FOR ADDITIONAL INFORMATION.
6. WILL BE PAID FOR PER SQ FT AS "TEMPORARY INFORMATION SIGNING". EACH SIGN = 21 SQ FT AND THE DATE PANEL ② WILL NOT BE MEASURED SEPARATELY FOR PAYMENT.

FILE NAME =	USER NAME = ronald.woodshank	DESIGNED - EVAN MARINI	REVISED -	<b>STATE OF ILLINOIS DEPARTMENT OF TRANSPORTATION</b>	<b>TEMPORARY INFORMATION SIGNING</b>			F.A.P. RTE.	SECTION	COUNTY	TOTAL SHEETS	SHEET NO.
pw:\idol-pw.bentley.com\PWIDOT\Documents\IDOT Office\District 3\Projects\3186M43\CADData\3186M43 - PLANS.dwg	DRAWN - EVAN MARINI	CHECKED - RON WOODSHANK	REVISED -					317	(20,21)PP	IROQUOIS	9	9
Default	PLOT SCALE = 100.0000 / 1 in.	DATE - 1/22/2019	REVISED -		CONTRACT NO. 66M43			ILLINOIS FED. AID PROJECT				
	PLOT DATE = 10/4/2023				SCALE:	SHEET 1	OF 1	SHEETS	STA.	TO STA.		