

STATE OF ILLINOIS
DEPARTMENT OF TRANSPORTATION

F.A.P. RTE.	SECTION	COUNTY	TOTAL SHEETS	SHEET NO.
	DIST 8 HEADQUARTERS 2023-1	MADISON	8	1
	ILLINOIS		CONTRACT NO. 76R59	

D-98-102-22

FOR INDEX OF SHEETS, SEE SHEET NO. 2

PROPOSED
HIGHWAY PLANS

UNMARKED ROUTE
SECTION DIST 8 HEADQUARTERS 2023-1
PARKING LOT IMPROVEMENT
MADISON COUNTY

C-98-134-22

R8W



LOCATION OF SECTION INDICATED THIS: - [black rectangle]

PROJECT LOCATION
1102 EASTPORT PLAZA DRIVE
COLLINSVILLE, IL 62234
LATITUDE: 38.6766
LONGITUDE, -90.0208

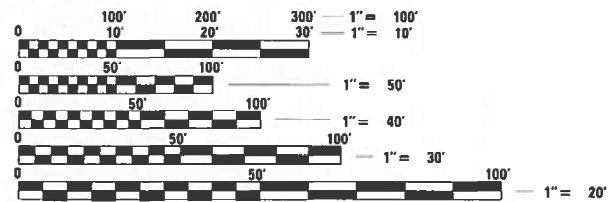

FULL SIZE PLANS HAVE BEEN PREPARED USING STANDARD ENGINEERING SCALES. REDUCED SIZED PLANS WILL NOT CONFORM TO STANDARD SCALES. IN MAKING MEASUREMENTS ON REDUCED PLANS, THE ABOVE SCALES MAY BE USED.

J.U.L.I.E.
JOINT UTILITY LOCATION INFORMATION FOR EXCAVATORS
1-800-892-0123
OR 811

PROJECT ENGINEER CHERYL KEPLAR
PROJECT MANAGER KAREN CHALLANDES

CONTRACT NO. 76R59

STATE OF ILLINOIS
DEPARTMENT OF TRANSPORTATION

SUBMITTED January 25, 2024
Kevin Brown
REGIONAL ENGINEER

March 22, 2024
[Signature]
ENGINEER OF DESIGN AND ENVIRONMENT

March 22, 2024
[Signature]
DIRECTOR OF HIGHWAYS PROJECT IMPLEMENTATION

PRINTED BY THE AUTHORITY
OF THE STATE OF ILLINOIS

CODE NO.	ITEM	UNIT	TOTAL QUANTITY	CONSTR. CODE
				100% STATE
				NONE
				0005
				URBAN
40600290	BITUMINOUS MATERIALS (TACK COAT)	POUND	8772	8772
40600990	TEMPORARY RAMP	SQ YD	131	131
40603080	HOT-MIX ASPHALT BINDER COURSE, 1L-19.0, N50	TON	1092	1092
40604050	HOT-MIX ASPHALT SURFACE COURSE, 1L-9.5, MIX "C", N50	TON	1456	1456
44000163	HOT-MIX ASPHALT SURFACE REMOVAL, 3 1/2"	SQ YD	12996	12996
63500105	DELINEATORS	EACH	49	49
67100100	MOBILIZATION	L SUM	1	1
* 78000100	THERMOPLASTIC PAVEMENT MARKING - LETTERS AND SYMBOLS	SQ FT	22	22
* 78000200	THERMOPLASTIC PAVEMENT MARKING - LINE 4"	FOOT	5561	5561
* 78000600	THERMOPLASTIC PAVEMENT MARKING - LINE 12"	FOOT	220	220
* 78000650	THERMOPLASTIC PAVEMENT MARKING - LINE 24"	FOOT	64	64

* SPECIALTY ITEM

REV. - MS

MODEL: D:\default...
 FILE: M:\aspc\challandes\p\112023\Documents\DOT_Offices\Distrc_8\Project\DOT76R59\CAD\Drawings\DOT76R59-ht-500.dgn

USER NAME = karen.challandes	DESIGNED -	REVISED -
	DRAWN -	REVISED -
PLOT SCALE = 100.0000' / in.	CHECKED -	REVISED -
PLOT DATE = 11/20/2023	DATE -	REVISED -

**STATE OF ILLINOIS
DEPARTMENT OF TRANSPORTATION**

SUMMARY OF QUANTITIES

SCALE: SHEET OF SHEETS STA. TO STA.

F.A.P. RTE.	SECTION	COUNTY	TOTAL SHEETS	SHEET NO.
	DIST 8 HEADQUARTERS 2023-1	MADISON	8	3
ILLINOIS FED. AID PROJECT			CONTRACT NO. 76R59	



 HOT-MIX ASPHALT SURFACE REMOVAL - 3 1/2"

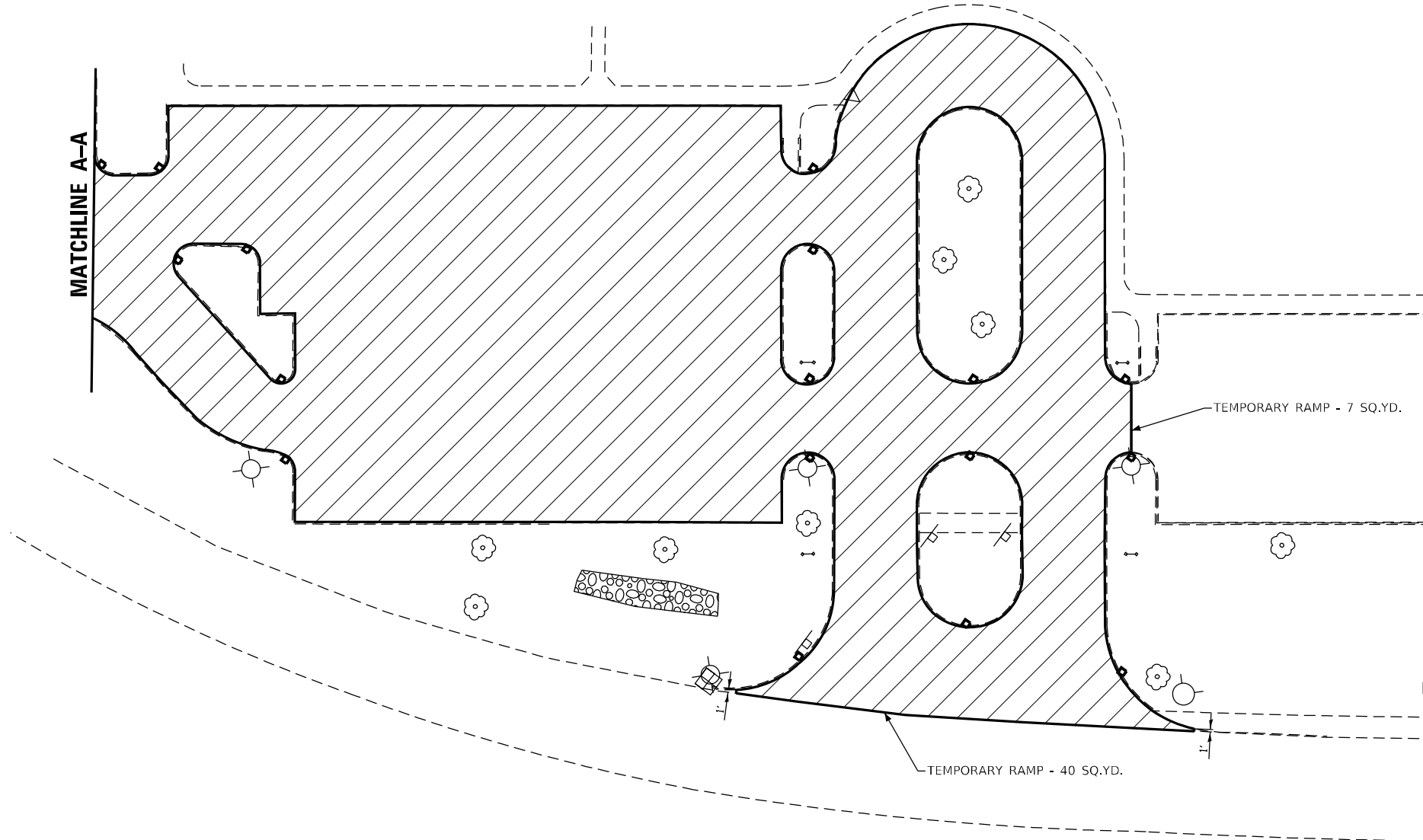

MODEL: Default
 FILE: \\mifs-pw-bldg-cw-beadley.com\PW\DOT\Documents\DOT_Offices\Dir\dr. 8\Project\0876559\CAD\Sheet\0876559-sub-a-bn.dgn

USER NAME = karen.challandes	DESIGNED -	REVISED -
	DRAWN -	REVISED -
PLOT SCALE = 100,0000 ' / in.	CHECKED -	REVISED -
PLOT DATE = 11/20/2023	DATE -	REVISED -

**STATE OF ILLINOIS
DEPARTMENT OF TRANSPORTATION**

SOUTH LOT REMOVAL	
SCALE:	SHEET OF SHEETS STA. TO STA.

F.A.P. RTE.	SECTION	COUNTY	TOTAL SHEETS	SHEET NO.
	DIST 8 HEADQUARTERS 2023-1	MADISON	8	5
			CONTRACT NO. 76R59	
		ILLINOIS	FED. AID PROJECT	

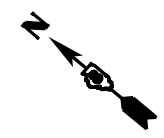

MATCHLINE B-B

MATCHLINE A-A

MATCHLINE B-B

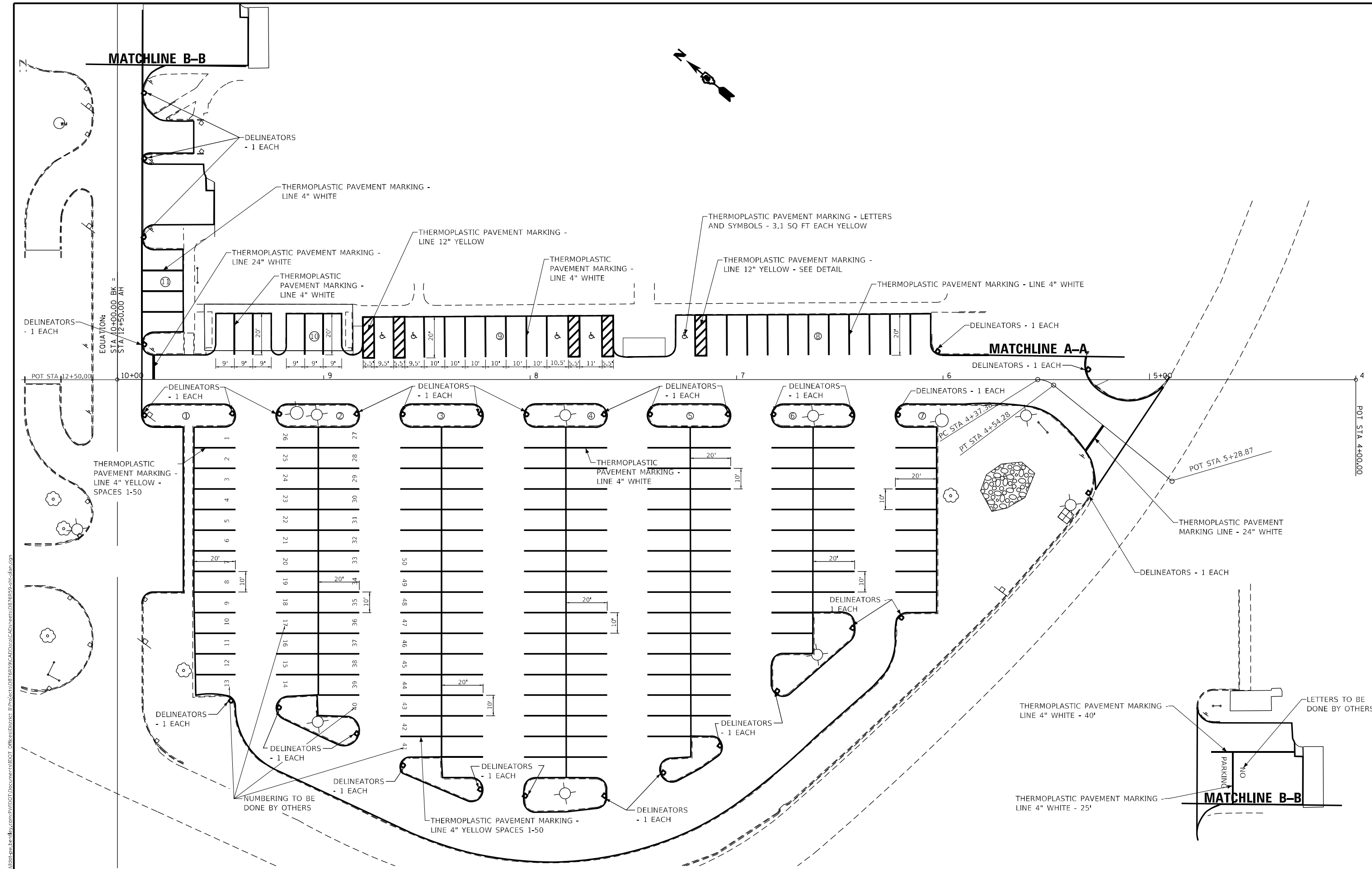

EQUATION:
STA 10+00.00 BK =
STA 12+50.00 AH

THERMOPLASTIC
PAVEMENT MARKING -
LINE 4" YELLOW -
SPACES 1-50

THERMOPLASTIC
PAVEMENT MARKING -
LINE 4" WHITE

THERMOPLASTIC PAVEMENT MARKING -
LINE 4" WHITE - 40'

THERMOPLASTIC PAVEMENT MARKING -
LINE 4" WHITE - 25'

LETTERS TO BE
DONE BY OTHERS

NUMBERING TO BE
DONE BY OTHERS

THERMOPLASTIC PAVEMENT MARKING -
LINE 4" YELLOW SPACES 1-50

MODEL: Default
 FILE: 11/15/23 11:28:45 AM
 PROJECT: 11/15/23 11:28:45 AM
 USER: karen.challandes
 TITLE: WEST LOT PAVEMENT MARKING

USER NAME = karen.challandes	DESIGNED -	REVISED -
PLOT SCALE = 100,0000' / in.	DRAWN -	REVISED -
PLOT DATE = 11/20/2023	CHECKED -	REVISED -
	DATE -	REVISED -

**STATE OF ILLINOIS
DEPARTMENT OF TRANSPORTATION**

WEST LOT PAVEMENT MARKING

SCALE: SHEET OF SHEETS STA. TO STA.

F.A.P. RTE.	SECTION	COUNTY	TOTAL SHEETS	SHEET NO.
DIST 8 HEADQUARTERS 2023-1		MADISON	8	6
ILLINOIS FED. AID PROJECT			CONTRACT NO. 76R59	

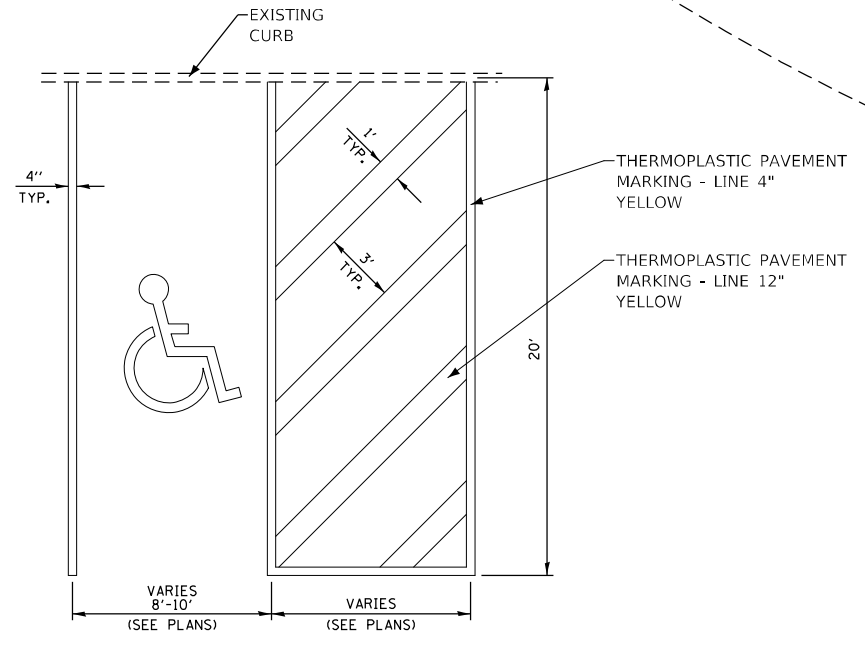
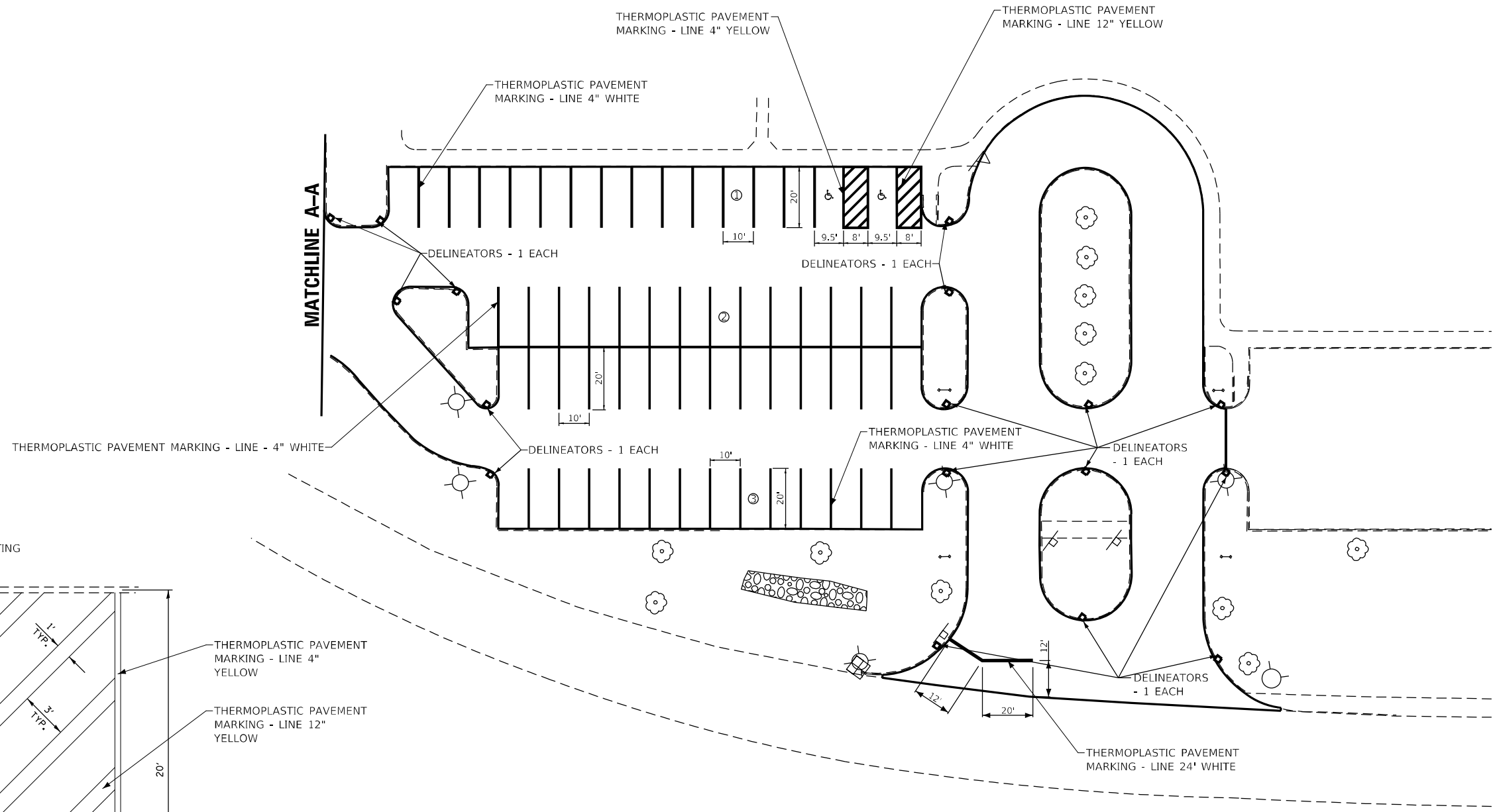

**PAVEMENT MARKING
AT ACCESSIBLE
PARKING SPACES**
NOT TO SCALE

MODEL: Default
 FILE: \\nailes-pw-bufilew-beadfw.com\P\INDOT\Documents\DOT_Offices\Director_E\Project\087659\CADD\Drawings\087659-sub-plan.dwg

USER NAME = karen.challandes	DESIGNED -	REVISED -
PLOT SCALE = 100,0000 ' / in.	DRAWN -	REVISED -
PLOT DATE = 11/20/2023	CHECKED -	REVISED -
	DATE -	REVISED -

**STATE OF ILLINOIS
DEPARTMENT OF TRANSPORTATION**

SOUTH LOT PAVEMENT MARKING			
SCALE:	SHEET	OF SHEETS	STA. TO STA.

F.A.P. RTE.	SECTION	COUNTY	TOTAL SHEETS	SHEET NO.
DIST 8 HEADQUARTERS 2023-1		MADISON	8	7
ILLINOIS FED. AID PROJECT			CONTRACT NO. 76R59	

THERMOPLASTIC PAVEMENT MARKING

	LINE 4"	LINE 4"	LETTERS AND SYMBOLS	LINE 24"	LINE 12"
	YELLOW	WHITE	YELLOW	WHITE STOP BAR	YELLOW
	FOOT	FOOT	SQ FT	FOOT	FOOT
LOCATION					
WEST PARKING LOT					
AISLE 1	240			12	
AISLE 2	630				
AISLE 3	200	580			
AISLE 4		810			
AISLE 5		450			
AISLE 6		450			
AISLE 7		160		20	
AISLE 8	46	200	3.1		27
AISLE 9	182	140	12.4		110
AISLE 10		80			
AISLE 11		60			
SOUTH PARKING LOT					
AISLE 1	48	280	6.2	32	83
AISLE 2		680			
AISLE 3		260			
NORTH PARKING AREA					
DOCK AREA		65			
SUB-TOTAL	1346	4215	21.7	64	220
TOTAL		5561	22	64	220

DELINEATORS

LOCATION	EACH
WEST PARKING LOT	26
SOUTH PARKING LOT	19
NORTH PARKING AREA	4
TOTAL	49

RESURFACING SCHEDULE

	HOT-MIX ASPHALT	HOT-MIX ASPHALT	HOT-MIX ASPHALT	BITUMINOUS	TEMPORARY
	SURFACE REMOVAL 3 1/2"	BINDER COURSE,	SURFACE COURSE,	MATERIALS	RAMP
		1L-19.0 N50	1L 9.5, MIX"C", N50	(TACK COAT)	(SQ YD)
	SQ YD	TON	TON	POUND	
WEST PARKING LOT	8836	742	990	5965	41
SOUTH PARKING LOT	3691	310	413	2491	47
NORTH PARKING AREA	469	39	52	316	29 43
TOTAL	12996	1092	1456	8772	117 131

MODEL: D:\draft
 FILE NAME: p:\m\l\c\w\benley.com\p\m\c\o\l\documents\DOT_Offices\Distrc_8\Projects\07659\CA\Drawings\07659-ah-schedule.dgn

USER NAME = karen.challandes	DESIGNED -	REVISED -
	DRAWN -	REVISED -
PLOT SCALE = 100.0000' / in.	CHECKED -	REVISED +
PLOT DATE = 11/20/2023	DATE -	REVISED +

**STATE OF ILLINOIS
DEPARTMENT OF TRANSPORTATION**

SCHEDULES OF QUANTITIES

SCALE: SHEET OF SHEETS STA. TO STA.

F.A.P. RTE.	SECTION	COUNTY	TOTAL SHEETS	SHEET NO.
	DIST 8 HEADQUARTERS 2023-1	MADISON	8	8
ILLINOIS FED. AID PROJECT			CONTRACT NO. 76R59	