

STATE OF ILLINOIS
DEPARTMENT OF TRANSPORTATION

F.A.P. RTE.	SECTION	COUNTY	TOTAL SHEETS	SHEET NO.
726	(41-B)BDR-1	WILLIAMSON	27	1
		ILLINOIS	CONTRACT NO. 78A06	

D-99-039-23



LOCATION OF SECTION INDICATED THUS: - [Symbol] -

FOR INDEX OF SHEETS, SEE SHEET NO. 3
FOR SUMMARY OF QUANTITIES, SEE SHEET NO. 4 TO 5

TRAFFIC DATA

ROADWAY CLASSIFICATION: MINOR ARTERIAL
DESIGN SPEED = 55 MPH
CURRENT ADT (2021) = 4,700
DESIGN YEAR ADT (2044) = 5,910
SU = 5.3%
MU = 8.5%

TOWNSHIPS

SOUTHERN

**PROPOSED
HIGHWAY PLANS**

FAP ROUTE 726 (IL ROUTE 148)
SECTION (41-B)BDR-1
PROJECT HBFP-P82F(069)
STRUCTURE REHABILITATION
WILLIAMSON COUNTY

C-99-055-23

DESIGN DESIGNATION : N/A
COORDINATE SYSTEM : N/A
POSTED SPEED : 55 MPH

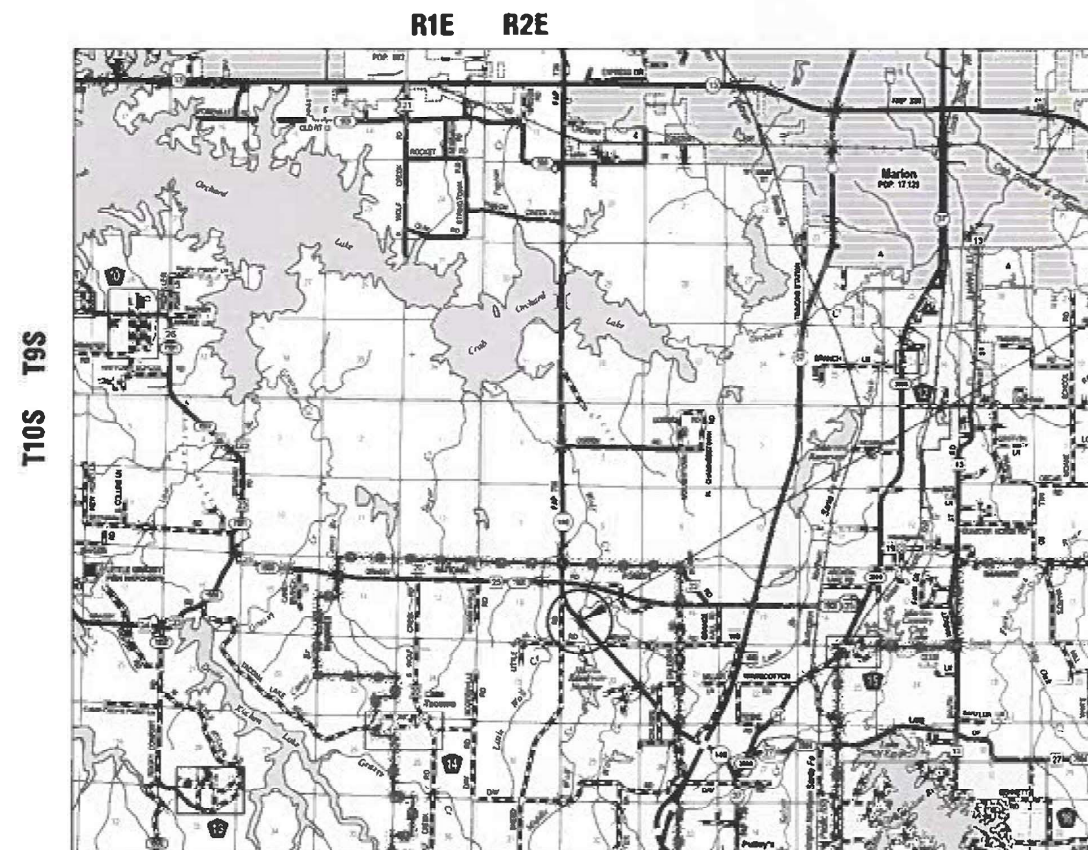

EXISTING SN 100-0037
C STRUCTURE STA 364+54.00 (IL ROUTE 148)
OVER MIDDLE FORK CREEK



SIGNATURE: [Signature]
DATE SIGNED: 1/10/2024
LICENSE EXPIRATION DATE:

STATE OF ILLINOIS
DEPARTMENT OF TRANSPORTATION

SUBMITTED *Jan 30th 2024*
Kyle H. Brown
REGIONAL ENGINEER

March 22, 2024 [Signature]
ENGINEER OF DESIGN AND ENVIRONMENT

March 22, 2024 [Signature]
DIRECTOR OF HIGHWAYS PROJECT IMPLEMENTATION

**PRINTED BY THE AUTHORITY
OF THE STATE OF ILLINOIS**

J.U.L.I.E.
JOINT UTILITY LOCATION INFORMATION FOR EXCAVATION
1-800-892-0123
OR 811

PROJECT ENGINEER: EHREN KIRBY, P.E.
PROJECT MANAGER: CMT INC. / CDI INC.

CONTRACT NO. 78A06

R1E R2E
GROSS LENGTH = 99.25 FT. = 0.019 MILES
NET LENGTH = 99.25 FT. = 0.019 MILES

MODEL: Signature (Sheet)
 FILE NAME: \\IDOT\22006610\001\WO_05\DrawRoadway\CADD_Sheets\0578A05-shi-signature.dwg

Prepared By: _____
 DISTRICT STUDIES & PLANS ENGINEER

Examined By: *Nancy Lee*
 DISTRICT LAND ACQUISITION ENGINEER

Examined By: *Carrie Nelson*
 DISTRICT PROGRAM DEVELOPMENT ENGINEER

Examined By: *[Signature]*
 DISTRICT OPERATIONS ENGINEER

Examined By: *Doris J. Melis*
 DISTRICT PROJECT IMPLEMENTATION ENGINEER

Examined By: *Doris J. Melis*
 DISTRICT CONSTRUCTION ENGINEER

Examined By: *Aan Hays*
 DISTRICT MATERIALS ENGINEER

REV. - MS

USER NAME = byoung PLOT SCALE = 0.16666633 in. PLOT DATE = 1/24/2024	DESIGNED -	REVISED -	STATE OF ILLINOIS DEPARTMENT OF TRANSPORTATION	SIGNATURES				F.A. RTE.	SECTION	COUNTY	TOTAL SHEETS	SHEET NO.
	DRAWN -	REVISED -										
	CHECKED -	REVISED -		SCALE: SHEET OF SHEETS STA. TO STA.				CONTRACT NO.				
DATE -	REVISED -					ILLINOIS FED. AID PROJECT						

INDEX OF SHEETS

- 1 COVER
- 2 SIGNATURE
- 3 GENERAL NOTES
- 4 - 5 SUMMARY OF QUANTITIES
- 6 TYPICAL SECTION
- 7 SCHEDULES OF QUANTITIES
- 8 - 10 MAINTENANCE OF TRAFFIC
- 11 WIDE LOAD SIGNING PLAN
- 12 - 27 STRUCTURE PLANS - S.N. 100-0037 (E)

GENERAL NOTES

- 1. F.A.P.726 CENTERLINE STATIONING PROVIDED IS FOR LONGITUDINAL REFERENCE ONLY AND IS NOT BASED ON ACTUAL FIELD SURVEY OR RECORD INVENTORY DATA. ALL OFFSETS AND RESPECTIVE SITE LAYOUT SHOULD BE TAKEN FROM PHYSICAL FEATURES IN THE FIELD AND AS PROVIDED BY THE ENGINEER.

- 1. NONE.

COMMITMENTS

HIGHWAY STANDARDS

- 000001-08 STANDARD SYMBOLS, ABBREVIATIONS AND PATTERNS
- 001001-02 AREAS OF REINFORCEMENT BARS
- 001006 DECIMAL OF AN INCH AND OF A FOOT
- 701201-05 LANE CLOSURE 2L, 2W, DAY ONLY, FOR SPEEDS GREATER THAN OR EQUAL TO 45 MPH
- 701301-04 LANE CLOSURE 2L, 2W, SHORT TIME OPERATIONS
- 701311-03 LANE CLOSURE 2L, 2W, MOVING OPERATIONS
- 701321-18 LANE CLOSURE 2L, 2W, BRIDGE REPAIR WITH BARRIER
- 701901-09 TRAFFIC CONTROL DEVICES
- 704001-08 TEMPORARY CONCRETE BARRIER
- 780001-05 TYPICAL PAVEMENT MARKINGS
- 782006-01 GUARDRAIL AND BARRIER WALL REFLECTOR MOUNTING DETAILS
- 862001-01 UNINTERRUPTABLE POWER SUPPLY (UPS)

REV. - MS

MODEL: General Notes (Sheet)
 FILE NAME: L:\DOT\2260661P-01\WO_05\Draw\Roadway\CADD_Sheets\078A06-shc-gemnotes.dgn

USER NAME = byoung	DESIGNED -	REVISED -
	DRAWN -	REVISED -
PLOT SCALE = 0.16666633 ' / in.	CHECKED -	REVISED -
PLOT DATE = 1/30/2024	DATE -	REVISED -

**STATE OF ILLINOIS
DEPARTMENT OF TRANSPORTATION**

F.A.P. 726 (IL ROUTE 148)
GENERAL NOTES

SCALE: SHEET 1 OF 1 SHEETS STA. TO STA.

F.A.P. RTE.	SECTION	COUNTY	TOTAL SHEETS	SHEET NO.
726	(41-B)BDR-1	WILLIAMSON	28	3
CONTRACT NO. 78A06				
ILLINOIS			FED. AID PROJECT	

CONSTR. CODE
 F.A.P. 726 - WILLIAMSON COUNTY
 FUNDING: 80% FEDERAL, 20% STATE

CODE NO.	ITEM	UNIT	TOTAL QUANTITY	BRIDGE
				0047 S.N. 100-0037
50102400	CONCRETE REMOVAL	CU YD	8	8
50300100	FLOOR DRAINS	EACH	8	8
50300255	CONCRETE SUPERSTRUCTURE	CU YD	15	15
50300260	BRIDGE DECK GROOVING	SQ YD	287	287
50300300	PROTECTIVE COAT	SQ YD	309	309
50800205	REINFORCEMENT BARS, EPOXY COATED	POUND	1,050	1,050
50800515	BAR SPLICERS	EACH	12	12
67000400	ENGINEER'S FIELD OFFICE, TYPE A	CAL MO	4	4
67100100	MOBILIZATION	L SUM	1	1
70100405	TRAFFIC CONTROL AND PROTECTION, STANDARD 701321	EACH	1	1
70100450	TRAFFIC CONTROL AND PROTECTION, STANDARD 701201	L SUM	1	1
70106500	TEMPORARY BRIDGE TRAFFIC SIGNALS	EACH	1	1
70106700	TEMPORARY RUMBLE STRIPS	EACH	12	12
70107025	CHANGEABLE MESSAGE SIGN	CAL DA	42	42

REV. - MS

MODEL: 500-2 (Rev. 4/11)
 FILE NAME: E:\DOT\2206661P-00\WD_05\DrawRoadway\CADD_Sheets\0978A06-sht-004.dgn

USER NAME = byoung	DESIGNED -	REVISED -
PLOT SCALE = 0.16666633 ' / in.	DRAWN -	REVISED -
PLOT DATE = 1/30/2024	CHECKED -	REVISED -
	DATE -	REVISED -

**STATE OF ILLINOIS
 DEPARTMENT OF TRANSPORTATION**

**F.A.P. 726 (IL ROUTE 148)
 SUMMARY OF QUANTITIES**

SCALE: SHEET 3 OF 1 SHEETS STA. TO STA.

F.A.P. RTE.	SECTION	COUNTY	TOTAL SHEETS	SHEET NO.
726	(41-B)BDR-1	WILLIAMSON	28	4
CONTRACT NO. 78A06				
ILLINOIS FED. AID PROJECT				

CONSTR. CODE
 F.A.P. 726 - WILLIAMSON COUNTY
 FUNDING: 80% FEDERAL, 20% STATE

CODE NO.	ITEM	UNIT	TOTAL QUANTITY	BRIDGE 0047 S.N. 100-0037
70400100	TEMPORARY CONCRETE BARRIER	FOOT	375	375
70400200	RELOCATE TEMPORARY CONCRETE BARRIER	FOOT	375	375
70600260	IMPACT ATTENUATORS, TEMPORARY (FULLY REDIRECTIVE, NARROW), TEST LEVEL 3	EACH	2	2
70600332	IMPACT ATTENUATORS, RELOCATE (FULLY REDIRECTIVE, NARROW), TEST LEVEL 3	EACH	2	2
* 78001110	PAINT PAVEMENT MARKING - LINE 4"	FOOT	230	230
* 78200011	BARRIER WALL REFLECTORS, TYPE C	EACH	8	8
78300201	PAVEMENT MARKING REMOVAL - GRINDING	SQ FT	77	77
* 86200300	UNINTERRUPTABLE POWER SUPPLY, EXTENDED	EACH	1	1
X0322194	POLYMER MODIFIED PORTLAND CEMENT MORTAR	SQ FT	42	42
Z0012147	BRIDGE DECK SCARIFICATION 2 3/8"	SQ YD	309	309
Z0012167	BRIDGE DECK MICROSILICA CONCRETE OVERLAY 2 3/8	SQ YD	289	289
Z0012754	STRUCTURAL REPAIR OF CONCRETE (DEPTH EQUAL TO OR LESS THAN 5 INCHES)	SQ FT	14	14
Z0016001	DECK SLAB REPAIR (FULL DEPTH, TYPE I)	SQ YD	7	7

* SPECIALTY ITEM

REV. - MS

MODEL: 500-1 (Rev. 1)
 FILE NAME: E:\DOT\22066610-00\WO_05\DrawRoadway\CADD_Sheets\0726A06-sht-004.dgn

USER NAME = byoung	DESIGNED -	REVISED -
PLOT SCALE = 0.16666633 ' / in.	DRAWN -	REVISED -
PLOT DATE = 1/30/2024	CHECKED -	REVISED -
	DATE -	REVISED -

**STATE OF ILLINOIS
 DEPARTMENT OF TRANSPORTATION**

**F.A.P. 726 (IL ROUTE 148)
 SUMMARY OF QUANTITIES**

SCALE: SHEET 2 OF 3 SHEETS STA. TO STA.

F.A.P. RTE. 726	SECTION (41-B)BDR-1	COUNTY WILLIAMSON	TOTAL SHEETS 28	SHEET NO. 5
CONTRACT NO. 78A06			ILLINOIS FED. AID PROJECT	

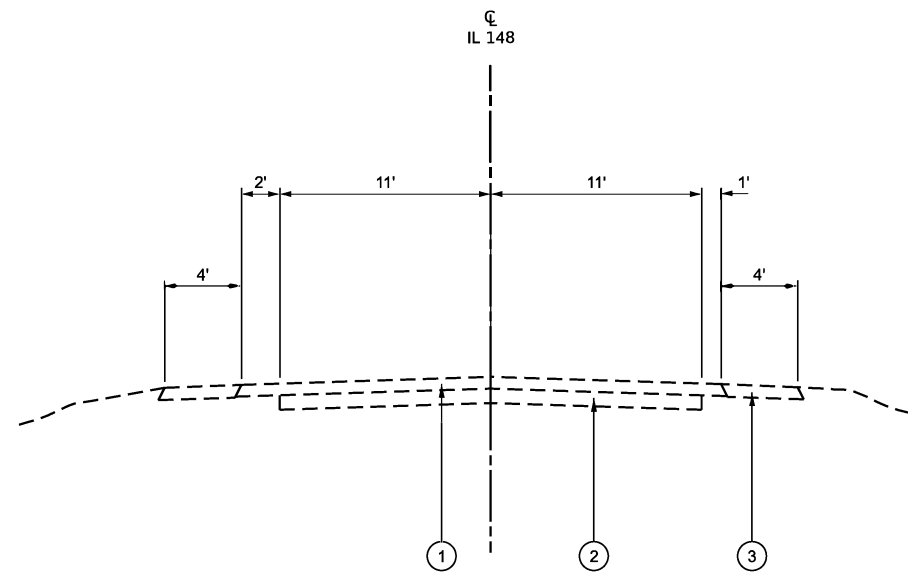

EXISTING F.A.P. 726 (IL 148)

(LOOKING EAST)
 STA. 360+74 TO STA. 364+04
 STA. 365+04 TO STA. 368+29

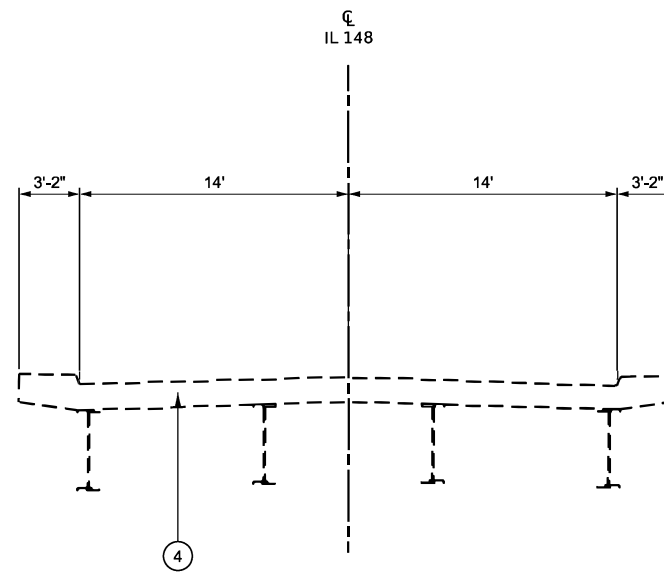

EXISTING F.A.P. 726 (IL 148)

(LOOKING EAST)
 S.N. 100-0037
 STA. 364+04 TO STA. 365+04

- ① EXISTING HMA PAVEMENT, 7½"
- ② EXISTING PCC PAVEMENT, 9"
- ③ EXISTING HMA SHOULDERS, VARIES 11¼" TO 9½"
- ④ REINFORCED CONCRETE SLAB, 1'-3½" (BRIDGE DECK / S.N. 100-0037)

MODEL: Typical-1 (Sheet)
 FILE NAME: L:\DOT\2206610-00\WO_05\Draw\Roadway\CADD_Sheets\1978A06-sh1-typical.dgn

REV. - MS

USER NAME = byoung	DESIGNED -	REVISED -
	DRAWN -	REVISED -
PLOT SCALE = 0.16666633' / in.	CHECKED -	REVISED -
PLOT DATE = 1/5/2024	DATE -	REVISED -

**STATE OF ILLINOIS
 DEPARTMENT OF TRANSPORTATION**

**F.A.P. 726 (IL ROUTE 148)
 TYPICAL SECTION**

SCALE: SHEET 1 OF 1 SHEETS STA. TO STA.

F.A.P. RTE.	SECTION	COUNTY	TOTAL SHEETS	SHEET NO.
726	(41-B)BDR-1	WILLIAMSON	28	6
CONTRACT NO. 78A06				
ILLINOIS FED. AID PROJECT				

MAINTENANCE OF TRAFFIC SCHEDULE

STATION			TEMPORARY CONCRETE BARRIER	RELOCATE TEMPORARY CONCRETE BARRIER	IMPACT ATTENUATOR, TEMPORARY (FULLY- REDIRECTIVE, NARROW), TEST LEVEL 3	IMPACT ATTENUATOR, RELOCATE (FULLY- REDIRECTIVE, NARROW), TEST LEVEL 3	BARRIER WALL REFLECTORS, TYPE C
STA.	TO	STA.	FOOT	FOOT	EACH	EACH	EACH
STAGE 1							
362+66.50	TO	366+00.00	333.5		1		3
366+00.00	TO	366+41.50	41.5		1		1
STAGE 2							
362+66.50	TO	366+00.00		333.5		1	3
366+00.00	TO	366+41.50		41.5		1	1
TOTAL			375	375	2	2	8

PAVEMENT MARKING SCHEDULE

LOCATION			PAINT PAVEMENT MARKING - LINE 4"		PAVEMENT MARKING REMOVAL - GRINDING
			WHITE	YELLOW	
STA.	TO	STA.	FOOT	FOOT	SQ FT
360+74.71	TO	368+28.94	200	30	77
TOTAL			230		77

*PERMANENT PAVEMENT MARKING LINES SHOULD MATCH THE ORIGINAL PAVEMENT MARKING LINES ON THE ROADWAY

REV. - MS

MODEL: Schedules (Sheet)
FILE NAME: L:\DOT\2280661\0-00\W0_05\Drawn\Roadway\CADD_Sheets\BDR\BDR-1\BDR-1-sht-schedules.dgn

USER NAME = byoung	DESIGNED -	REVISED -	STATE OF ILLINOIS DEPARTMENT OF TRANSPORTATION	F.A.P. 726 (IL ROUTE 148) SCHEDULE OF QUANTITIES	F.A.P. RTE. 726	SECTION (41-B)BDR-1	COUNTY WILLIAMSON	TOTAL SHEETS 28	SHEET NO. 7		
PLOT SCALE = 0.16666633 ' / in.	CHECKED -	REVISED -			SCALE:	SHEET 1 OF 1 SHEETS	STA.	TO STA.	CONTRACT NO. 78A06		
PLOT DATE = 1/30/2024	DATE -	REVISED -			ILLINOIS FED. AID PROJECT						

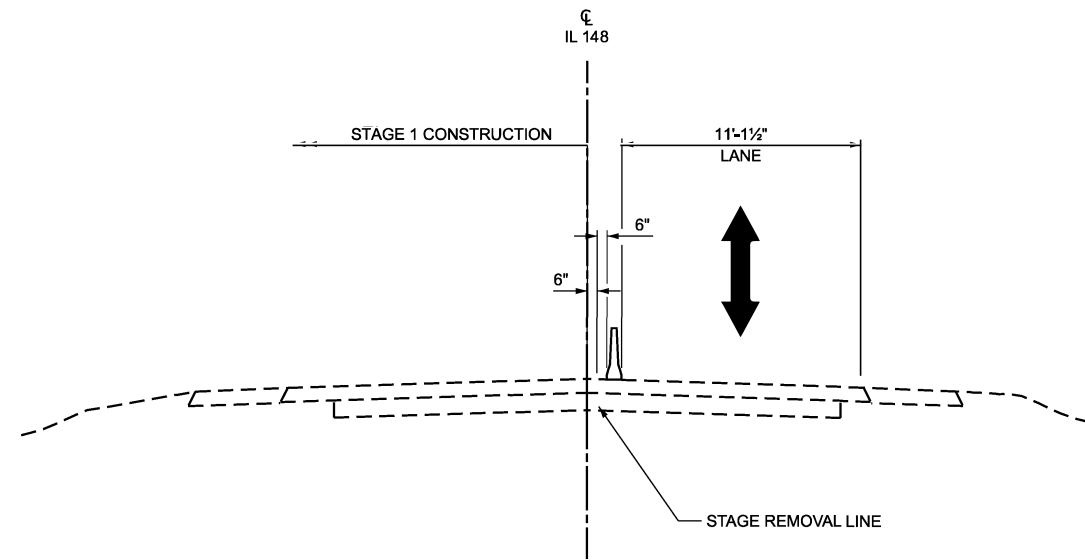

STAGE 1 CONSTRUCTION (ROADWAY)

(LOOKING EAST)

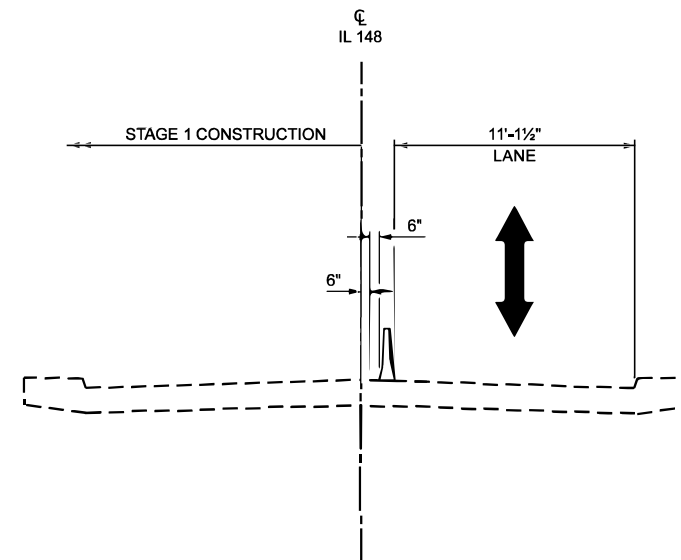

STAGE 1 CONSTRUCTION (BRIDGE)

(LOOKING EAST)

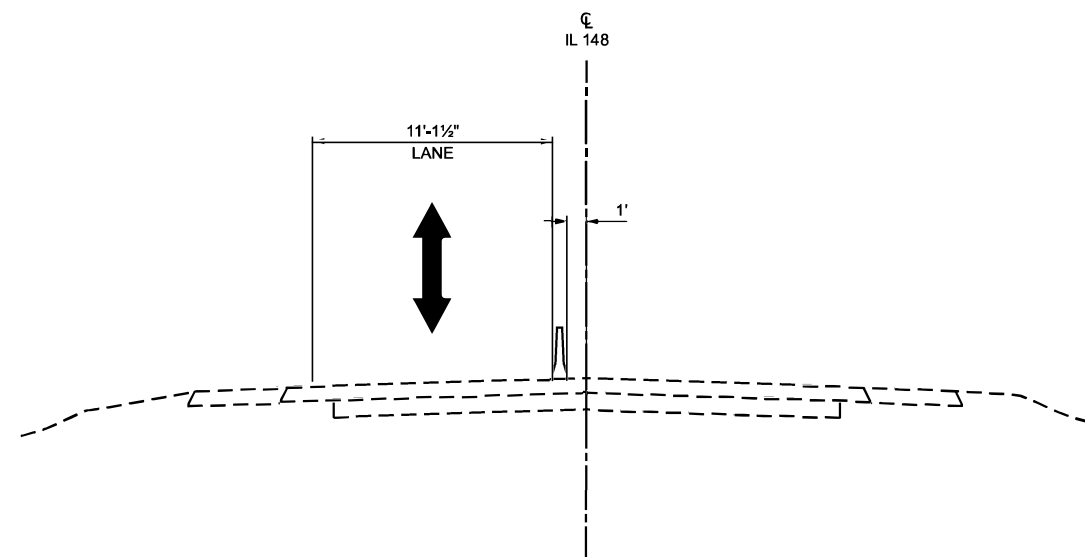

STAGE 2 CONSTRUCTION (ROADWAY)

(LOOKING EAST)

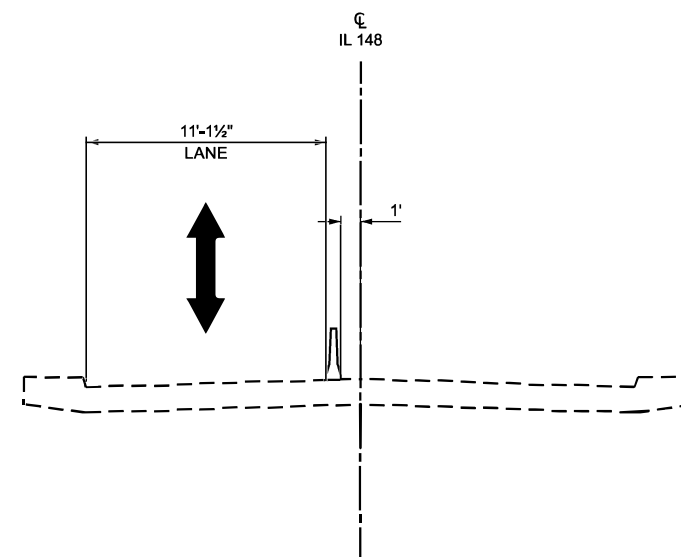

STAGE 2 CONSTRUCTION (BRIDGE)

(LOOKING EAST)

TRAFFIC CONTROL NOTES

1. TWO PHASE SIGNAL OPERATIONS IS REQUIRED WHEN HWY STD 701321 IS IN EFFECT. THE ENGINEER OF TRAFFIC SHALL APPROVE ALL TIMING PARAMETERS.
2. THE CONTRACTOR WILL HAVE THE OPTION TO USE MICROWAVE DETECTION FOR USE WITH THE TEMPORARY TRAFFIC SIGNALS IN ACCORDANCE WITH HWY STD 701321.
3. REMOVAL OF THE RUMBLE STRIPS AFTER STAGED CONSTRUCTION SHALL BE COMPLETED TO THE SATISFACTION OF THE ENGINEER. ANY DAMAGE TO THE EXISTING PAVEMENT FROM THE RUMBLE STRIPS SHALL BE REPAIRED AT THE CONTRACTOR'S EXPENSE. THERE WILL BE NO ADDITIONAL COMPENSATION.
4. ALL TEMPORARY PAVEMENT MARKINGS, DRUMS, ETC. SHALL BE PLACED PRIOR TO THE PLACING TEMPORARY CONCRETE BARRIERS.
5. COVER CONFLICTING ROADWAY SIGNS AS NECESSARY.

STAGE CONSTRUCTION GENERAL NOTES

1. ONE LANE OF TRAFFIC ON IL 148 SHALL BE MAINTAINED AT ALL TIMES.
2. EMERGENCY ACCESS SHALL BE PROVIDED AT ALL TIMES.
3. THE IL 148 CL AS SHOWN SHOULD BE USED FOR GRAPHICAL REFERENCE ONLY.

SUGGESTED STAGE 1 CONSTRUCTION

1. UTILIZE TRAFFIC CONTROL AND PROTECTION, STANDARD 701201 AND 701321.
2. PLACE TEMPORARY TRAFFIC CONTROL AS SHOWN ON THE PLANS.
3. UTILIZE TRAFFIC CONTROL AND PROTECTION, STANDARD 701321 AND DIRECT TRAFFIC TO THE SOUTH SIDE (EASTBOUND LANES) OF IL 148. MAKE REPAIRS TO THE NORTH SIDE OF THE EXISTING STRUCTURE.

SUGGESTED STAGE 2 CONSTRUCTION

1. UTILIZE TRAFFIC CONTROL AND PROTECTION, STANDARD 701201 AND 701321.
2. PLACE TEMPORARY TRAFFIC CONTROL AS SHOWN ON THE PLANS.
3. UTILIZE TRAFFIC CONTROL AND PROTECTION, STANDARD 701321 AND DIRECT TRAFFIC TO THE NORTH SIDE (WESTBOUND LANES) OF IL 148. MAKE REPAIRS TO THE SOUTH SIDE OF THE EXISTING STRUCTURE.

REV. - MS

MODEL: Staging Notes (Sheet)
FILE NAME: L:\DOT\22066110-00\WO_05\Draw\Roadway\CADD_Sheets\D978A06-sh1-staging_notes.dgn

USER NAME = b y o u n g	DESIGNED -	REVISED -
	DRAWN -	REVISED -
PLOT SCALE = 0.16666633 1/in.	CHECKED -	REVISED -
PLOT DATE = 1/5/2024	DATE -	REVISED -





STATE OF ILLINOIS
DEPARTMENT OF TRANSPORTATION

F.A.P. 726 (IL ROUTE 148)
MAINTENANCE OF TRAFFIC - NOTES

SCALE: SHEET 1 OF 3 SHEETS STA. TO STA.

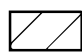
F.A.P. R T E	SECTION	COUNTY	TOTAL SHEETS	SHEET NO.
726	(41-B)BDR-1	WILLIAMSON	28	8
CONTRACT NO. 78A06			ILLINOIS FED. AID PROJECT	

LEGEND

	WORK ZONE		IMPACT ATTENUATOR, TEMPORARY (FULLY REDIRECTIVE), TEST LEVEL 3
	EDGE DRUMS		TEMPORARY CONCRETE BARRIER
	TEMPORARY TRAFFIC SIGNAL		

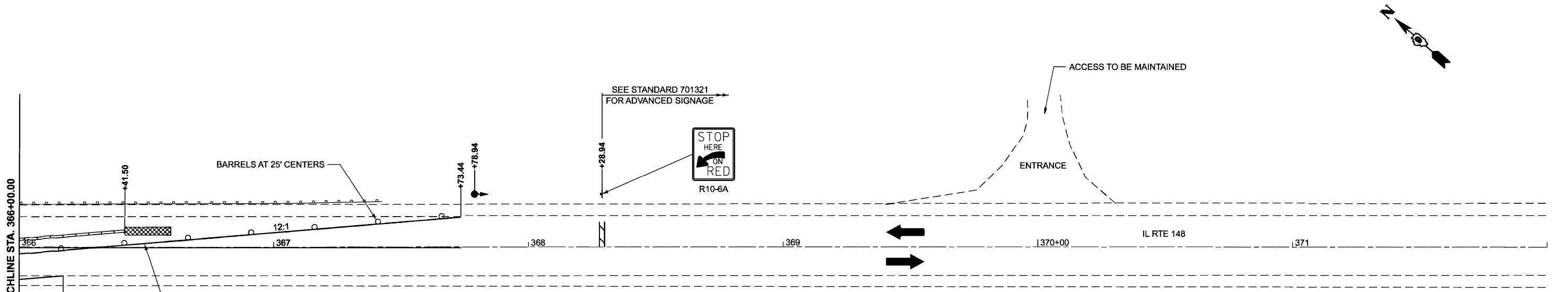
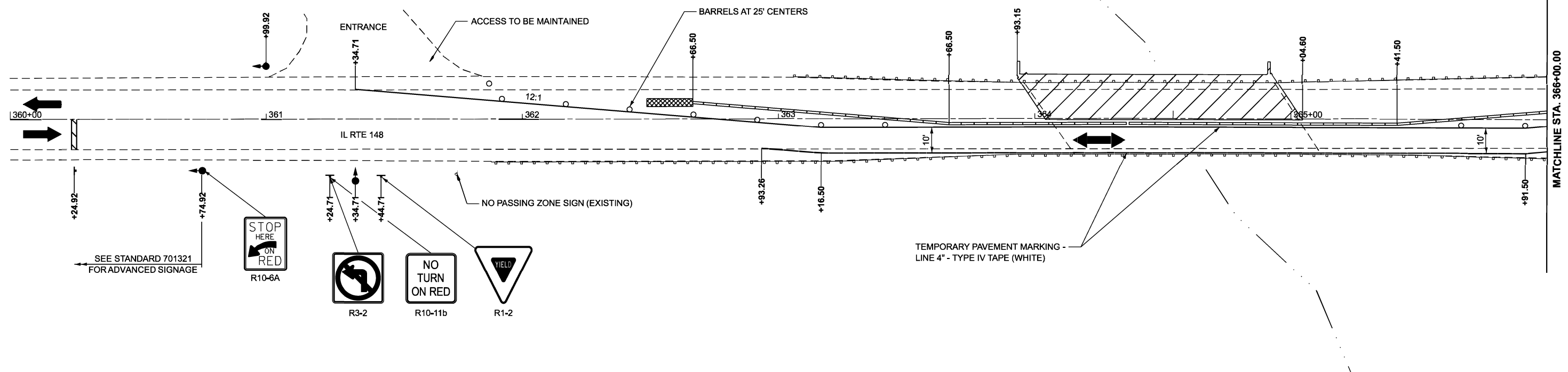

NOTES FOR PRIVATE LANE SIGNALS

1. THE CONTRACTOR SHALL PROVIDE A TEMPORARY SIGNAL ACROSS FROM THE PRIVATE LANE AT THE LOCATION DETAILED ABOVE.
2. THE SIGNALS SHALL CONTAIN A RED ARROW AND TWO YELLOW ARROWS.
3. THE PRIVATE DRIVE SIGNAL SHALL BE WIRED DIRECTLY WITH THE NORTHBOUND PHASE. THE PRIVATE PHASES SHALL COORDINATE WITH THE ORTHBOUND PHASES AS FOLLOWS: RED ARROW TO RED, TOP YELLOW ARROW TO YELLOW AND BOTTOM YELLOW ARROW TO GREEN.
4. BOTH SIGNALS WILL BE INCLUDED IN THE COST OF TEMPORARY BRIDGE TRAFFIC SIGNALS, EACH.

NOTES FOR TRAFFIC CONTROL & PROTECTION STANDARD 701321

- (ALL ITEMS BELOW SHALL BE INCLUDED IN THE CONTRACT UNIT PRICE, EACH FOR TRAFFIC CONTROL AND PROTECTION, STD. 701321. NO OTHER COMPENSTATION WILL BE ALLOWED.)
1. ALL SIGNAGE AS SHOWN ON THE HIGHWAY STANDARD AND ADDITIONAL SIGNAGE SHOWN ON THE DETAIL ABOVE. THE NOTED WORK SHALL INCLUDE SIGNS, POSTS, HARDWARE, AND LABOR. THE CONTRACTOR SHALL ERECT THE SIGNS AT THE LOCATIONS DETAILED ABOVE AND AT LOCATIONS DIRECTED BY THE ENGINEER.
 2. PER ARTICLE 703.07, WHEN TEMPORARY PAVEMENT MARKING IS SHOWN ON THE STANDARD AND DETAIL ABOVE, THE COST OF TEMPORARY PAVEMENT MARKING AND ITS REMOVAL WILL BE INCLUDED IN THE COST OF THE STANDARD.
 3. ALL TEMPORARY DRUMS OR BARRICADES SHOWN ON THE HIGHWAY STANDARD AND AS SHOWN ON THE DETAIL ABOVE.

MODEL: Stage 1 [Sheet]
FILE NAME: L:\DOT\2206610\00\WO_06\Drawn\Roadway\CADD_Sheets\1878A06-sh1-stage1.dgn

USER NAME = byoung	DESIGNED -	REVISED -
	DRAWN -	REVISED -
PLOT SCALE = 0.16666633' / in.	CHECKED -	REVISED -
PLOT DATE = 1/9/2024	DATE -	REVISED -

STATE OF ILLINOIS
DEPARTMENT OF TRANSPORTATION





F.A.P. 726 (IL ROUTE 148)
MAINTENANCE OF TRAFFIC - STAGE 1

SCALE: 1"=20' SHEET 2 OF 3 SHEETS STA. 360+00.00 TO STA. 372+00.00

F.A.P. RTE. 726	SECTION (41-B)BDR-1	COUNTY WILLIAMSON	TOTAL SHEETS 28	SHEET NO. 9
CONTRACT NO. 78A06			ILLINOIS FED. AID PROJECT	

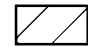
REV. - MS

LEGEND

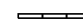
-  WORK ZONE
-  EDGE DRUMS
-  TEMPORARY TRAFFIC SIGNAL
-  IMPACT ATTENUATOR, TEMPORARY (FULLY REDIRECTIVE), TEST LEVEL 3
-  TEMPORARY CONCRETE BARRIER

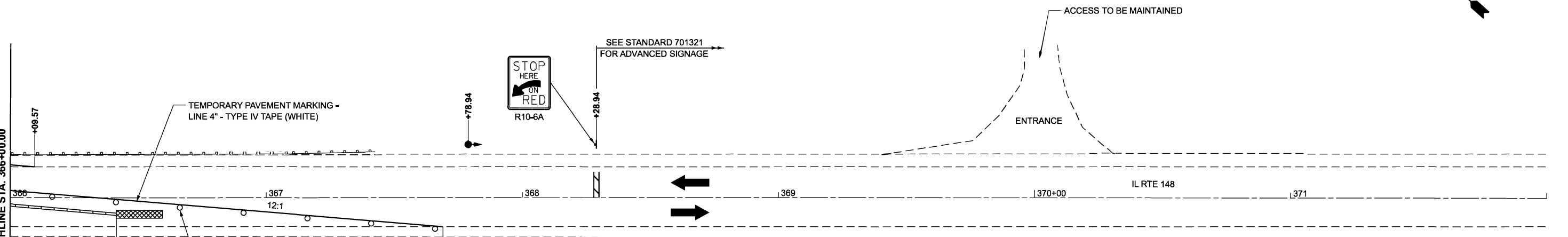
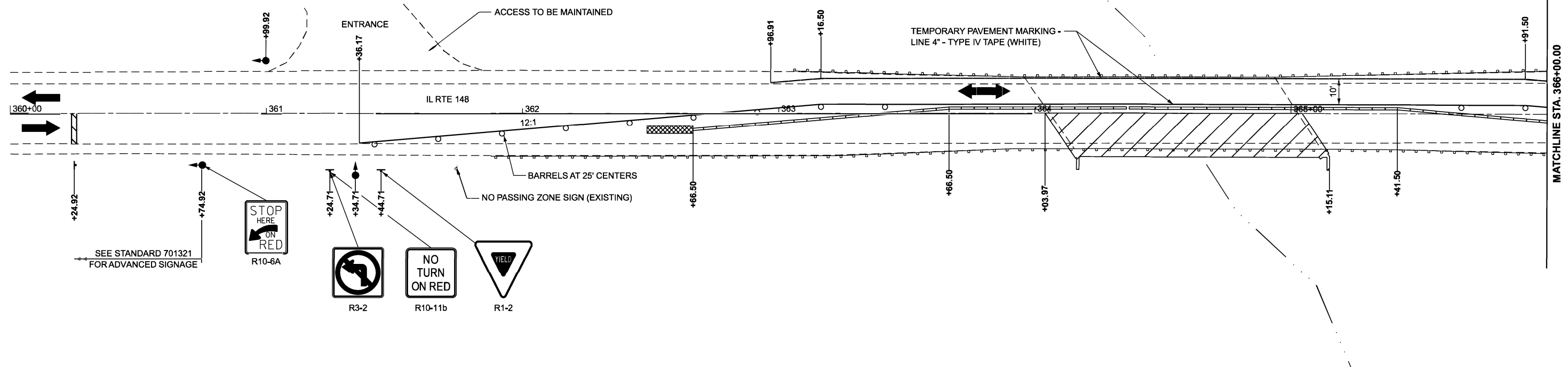

NOTES FOR PRIVATE LANE SIGNALS

1. THE CONTRACTOR SHALL PROVIDE A TEMPORARY SIGNAL ACROSS FROM THE PRIVATE LANE AT THE LOCATION DETAILED ABOVE.
2. THE SIGNALS SHALL CONTAIN A RED ARROW AND TWO YELLOW ARROWS.
3. THE PRIVATE DRIVE SIGNAL SHALL BE WIRED DIRECTLY WITH THE NORTHBOUND PHASE. THE PRIVATE PHASES SHALL COORDINATE WITH THE ORTHBOUND PHASES AS FOLLOWS: RED ARROW TO RED, TOP YELLOW ARROW TO YELLOW AND BOTTOM YELLOW ARROW TO GREEN.
4. BOTH SIGNALS WILL BE INCLUDED IN THE COST OF TEMPORARY BRIDGE TRAFFIC SIGNALS, EACH.

NOTES FOR TRAFFIC CONTROL & PROTECTION STANDARD 701321

(ALL ITEMS BELOW SHALL BE INCLUDED IN THE CONTRACT UNIT PRICE, EACH FOR TRAFFIC CONTROL AND PROTECTION, STD. 701321. NO OTHER COMPENSTATION WILL BE ALLOWED.)

1. ALL SIGNAGE AS SHOWN ON THE HIGHWAY STANDARD AND ADDITIONAL SIGNAGE SHOWN ON THE DETAIL ABOVE. THE NOTED WORK SHALL INCLUDE SIGNS, POSTS, HARDWARE, AND LABOR. THE CONTRACTOR SHALL ERECT THE SIGNS AT THE LOCATIONS DETAILED ABOVE AND AT LOCATIONS DIRECTED BY THE ENGINEER.
2. PER ARTICLE 703.07, WHEN TEMPORARY PAVEMENT MARKING IS SHOWN ON THE STANDARD AND DETAIL ABOVE, THE COST OF TEMPORARY PAVEMENT MARKING AND ITS REMOVAL WILL BE INCLUDED IN THE COST OF THE STANDARD.
3. ALL TEMPORARY DRUMS OR BARRICADES SHOWN ON THE HIGHWAY STANDARD AND AS SHOWN ON THE DETAIL ABOVE.

MODEL: Stage 2 (Sheet)
FILE NAME: L:\DOT\22066510\00\WO_05D\raw\Roadway\CADD_Sheets\1978A06-sh1-stage2.dgn

USER NAME = byoung	DESIGNED -	REVISED -	
	DRAWN -	REVISED -	
PLOT SCALE = 0.16666633' / in.	CHECKED -	REVISED -	
PLOT DATE = 1/30/2024	DATE -	REVISED -	

**STATE OF ILLINOIS
DEPARTMENT OF TRANSPORTATION**

**F.A.P. 726 (IL ROUTE 148)
MAINTENANCE OF TRAFFIC - STAGE 2**

SCALE: 1"=20' SHEET 3 OF 3 SHEETS STA. 360+00.00 TO STA. 372+00.00

F.A.P. RTE.	SECTION	COUNTY	TOTAL SHEETS	SHEET NO.
726	(41-B)BDR-1	WILLIAMSON	28	10
			CONTRACT NO. 78A06	
ILLINOIS FED. AID PROJECT				

REV. - MS

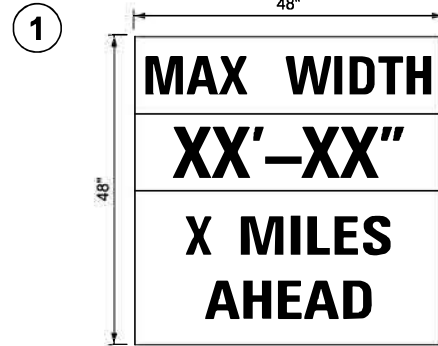

W12-I103
NINE (9) SIGNS REQUIRED



M1-5
SEVEN (7) SIGNS REQUIRED

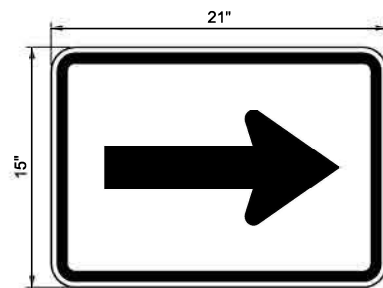

3
TWO (2) SIGNS REQUIRED

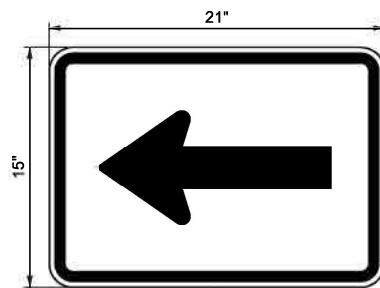

4
TWO (2) SIGNS REQUIRED

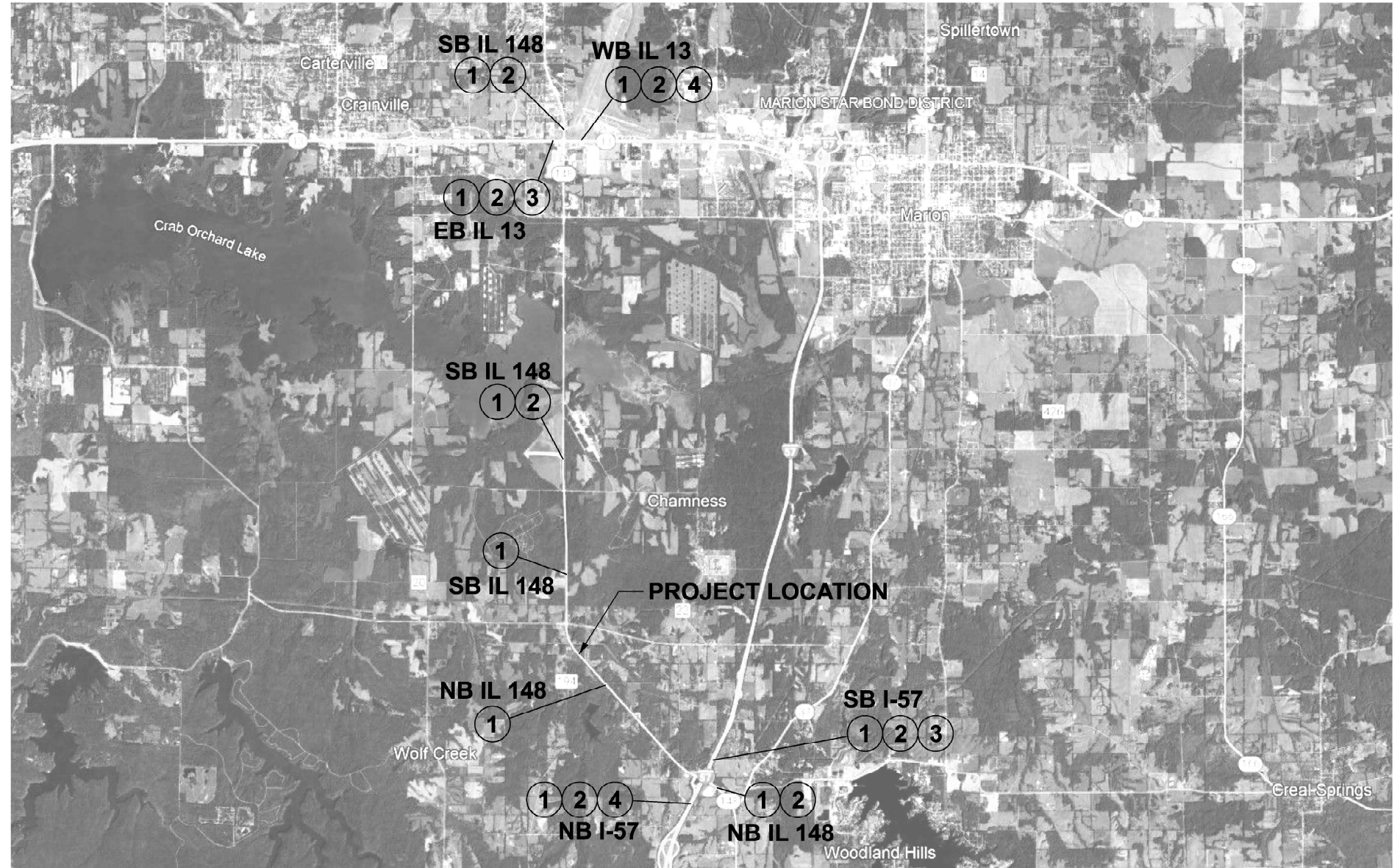

WIDE LOAD SIGNING PLAN

WIDE LOAD SIGNING NOTES:

1. THE CONTRACTOR SHALL FURNISH THE POSTS AND ERECT THE SIGNS AT THE LOCATIONS AS DIRECTED BY THE ENGINEER. ALL SIGNS SHALL BE POST MOUNTED.
2. THE ABOVE NOTED WORK, INCLUDED SIGNS, POSTS, HARDWARE AND LABOR SHALL BE INCLUDED IN THE CONTRACT UNIT PRICE, EACH, FOR TRAFFIC CONTROL AND PROTECTION, 701321 AND NO OTHER COMPENSATION WILL BE ALLOWED.
3. FOR WORK ON ALL STRUCTURES, THE WIDTH SHOWN ON THE W12-1103 SIGN SHALL BE 9'-7½" OR DIRECTED BY THE ENGINEER, THE "X" MILES AHEAD WILL BE DETERMINED BY THE ENGINEER.

REV. - MS

MODEL: S:\Pics\15week\ FILE NAME: L:\DDT220061\01\WO_051Dm\Roadway\CADD_Sheets\0778A06-rlc-wide_load.dgn

USER NAME = byoung	DESIGNED -	REVISED -
	DRAWN -	REVISED -
PLOT SCALE = 0.16666633 1/ in.	CHECKED -	REVISED -
PLOT DATE = 1/30/2024	DATE -	REVISED -

**STATE OF ILLINOIS
DEPARTMENT OF TRANSPORTATION**

F.A.P. 726 (IL ROUTE 148)
WIDE LOAD SIGNING PLAN

SCALE: SHEET 1 OF 1 SHEETS STA. TO STA.

F.A.P. RTE.	SECTION	COUNTY	TOTAL SHEETS	SHEET NO.
726	(41-B)BDR-1	WILLIAMSON	28	11
CONTRACT NO. 78A06			ILLINOIS FED. AID PROJECT	

GENERAL NOTES

1. Reinforcement bars designated (E) shall be epoxy coated.
2. Plan dimensions and details are relative to existing plans and are subject to nominal construction variations. The Contractor shall field verify existing dimensions and details affecting new construction and make necessary approved adjustments prior to construction or ordering of materials. Such variations shall not be cause for additional compensation for a change in scope of the work, however, the Contractor will be paid for the quantity actually furnished at the unit price bid for the work.
3. Any reinforcement bars that are damaged during concrete removal operations shall be replaced using an approved bar splicer or anchorage system. Cost included with Concrete Removal.
4. Prior to pouring the new concrete section, all heavy or loose rust, loose mill scale, and other loose or potentially detrimental foreign material shall be removed from steel surfaces to be in contact with concrete. Tightly adhered paint may remain unless otherwise noted. Removal shall be accomplished by methods that will not damage the steel and the cost will be included in Concrete Superstructure.

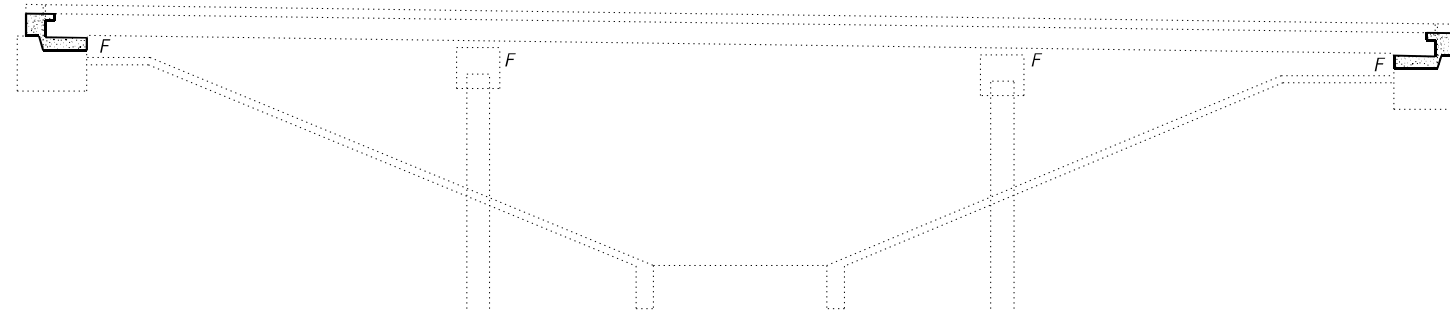

ELEVATION

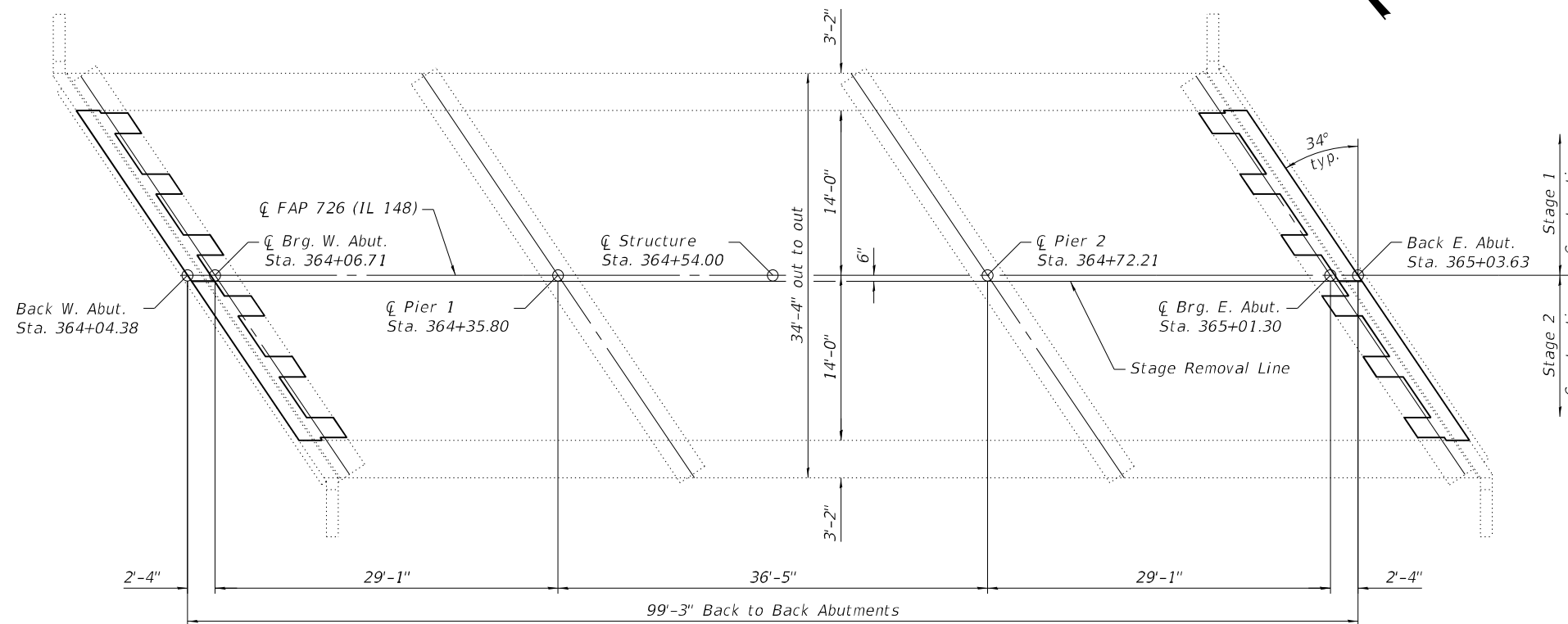

PLAN

TOTAL BILL OF MATERIAL

ITEM	UNIT	TOTAL
Concrete Removal	Cu. Yd.	8.0
Floor Drains	Each	8
Concrete Superstructure	Cu. Yd.	15.0
Bridge Deck Grooving	Sq. Yd.	287
Protective Coat	Sq. Yd.	309
Reinforcement Bars, Epoxy Coated	Pound	1,050
Bar Splicers	Each	12
Bridge Deck Scarification 2 3/8"	Sq. Yd.	309
Bridge Deck Microsilica Concrete Overlay 2 3/8"	Sq. Yd.	289
Structural Repair of Concrete (Depth Equal to or Less Than 5 Inches)	Sq. Ft.	14
Deck Slab Repair (Full Depth, Type I)	Sq. Yd.	7
Polymer Modified Portland Cement Mortar	Sq. Ft.	42

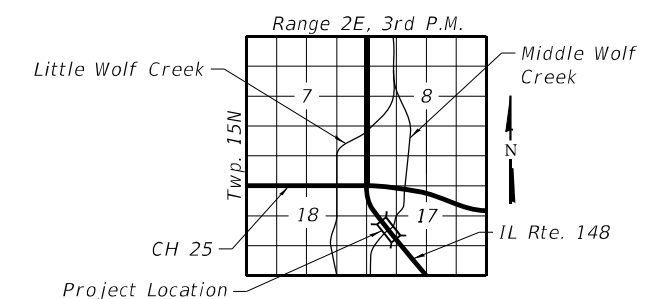

LOCATION SKETCH

DESIGN STRESSES

FIELD UNITS
NEW CONSTRUCTION
 $f'_c = 4,000$ psi
 $f_y = 60,000$ psi (Reinforcement)
EXISTING CONSTRUCTION
 $f'_c = 1,400$ psi
 $f_s = 20,000$ psi (Reinforcement)

SCOPE OF WORK

1. Remove existing microsilica overlay
2. Perform deck and curb repairs as shown
3. Perform joint elimination at abutments
4. Replace deck drains
5. Repair substructures as shown
6. Install microsilica concrete overlay

INDEX OF SHEETS

1. General Plan & Elevation
2. Stage Construction Details
3. Temporary Concrete Barrier for Stage Construction
4. Deck Patching Plan
5. Joint Removal Details
6. Joint Replacement Details
7. Deck Slab Repair
8. Abutment Repairs
9. Bar Splicer Assembly and Mechanical Splicer Details
- 10-16. Existing Plans



Signed: *Alex C. Benz*
 Date: 2/26/2024
 License Expires: 11/30/2024

GENERAL PLAN & ELEVATION
IL 148 OVER MIDDLE WOLF CREEK
F.A.P. 726-SEC. (41-B)BDR-1
WILLIAMSON COUNTY
STATION 364+54.00
STRUCTURE NO. 100-0037

MODEL: Default
 FILE NAME: Z:\230509_05_CMT_IL_148 over Middle Wolf Creek\DGN\BDR\General Plan & Elevation.dgn

EFK Moen
 Civil Engineering Design

USER NAME = acb	DESIGNED - ACB	REVISED -
PLOT SCALE =	CHECKED - CDL	REVISED -
PLOT DATE = 2/26/2024	DRAWN - ACB	REVISED -
	CHECKED - CDL	REVISED -

STATE OF ILLINOIS
DEPARTMENT OF TRANSPORTATION

GENERAL PLAN & ELEVATION
STRUCTURE NO. 100-0037

SHEET 1 OF 16 SHEETS

F.A.P. RTE.	SECTION	COUNTY	TOTAL SHEETS	SHEET NO.
726	(41-B)BDR-1	WILLIAMSON	27	12
CONTRACT NO. 78A06				
ILLINOIS FED. AID PROJECT				

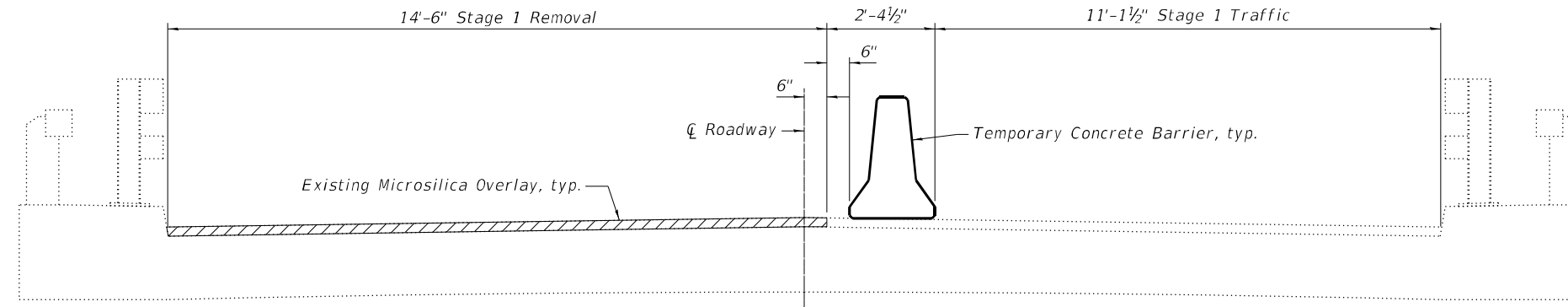

STAGE 1 REMOVAL
(Looking East)

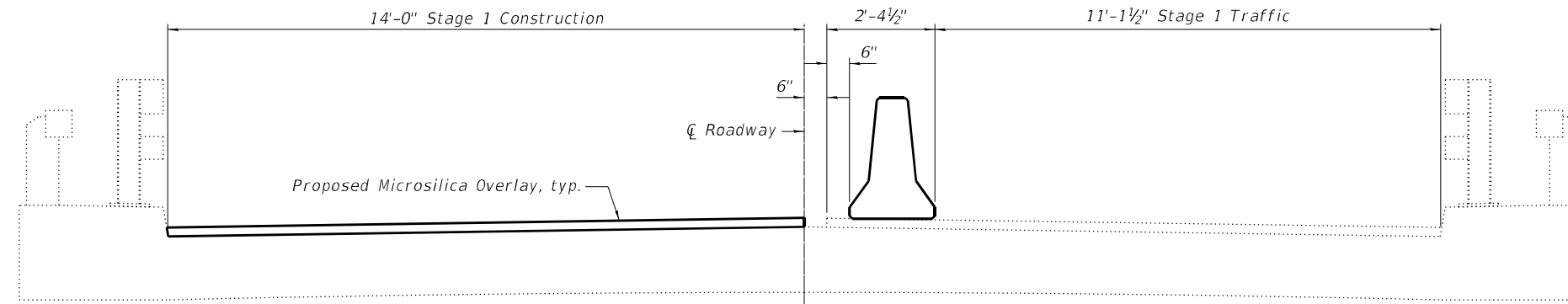

STAGE 1 CONSTRUCTION
(Looking East)

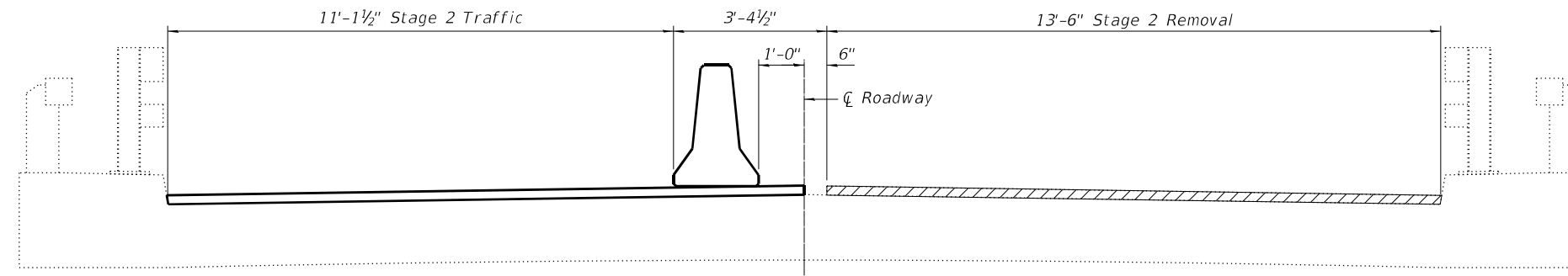

STAGE 2 REMOVAL
(Looking East)

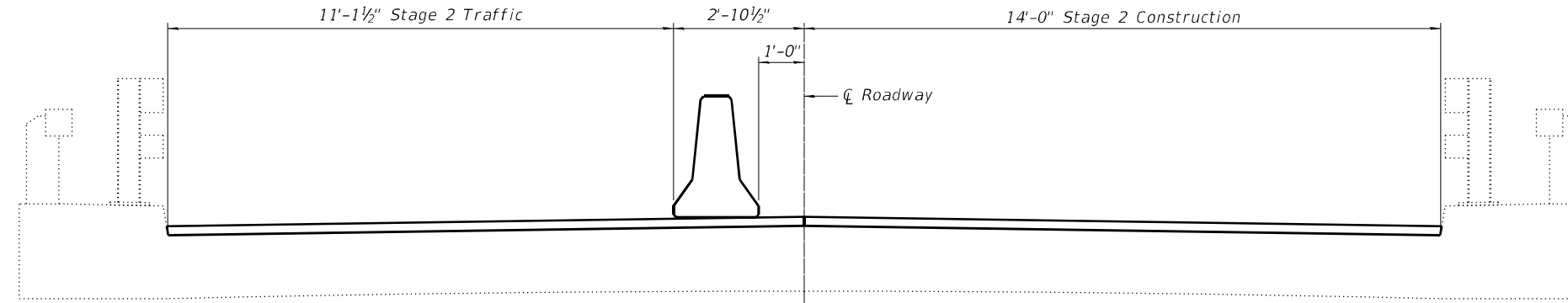

STAGE 2 CONSTRUCTION
(Looking East)

Note:
Hatched area indicates removal.

MODEL: Default
FILE NAME: Z:\23059_05_CMT_IL_148_over_Middle_Wolf_Creek\DGN\Bridges\1000037-78A06-02-Staging.dgn



USER NAME = acb	DESIGNED - ACB	REVISED -
PLOT SCALE =	CHECKED - CDL	REVISED -
PLOT DATE = 1/26/2024	DRAWN - ACB	REVISED -
	CHECKED - CDL	REVISED -

STATE OF ILLINOIS
DEPARTMENT OF TRANSPORTATION

STAGE CONSTRUCTION DETAILS
STRUCTURE NO. 100-0037

SHEET 2 OF 16 SHEETS

F.A.P. RTE.	SECTION	COUNTY	TOTAL SHEETS	SHEET NO.
726	(41-B)BDR-1	WILLIAMSON	27	13
CONTRACT NO. 78A06				
ILLINOIS FED. AID PROJECT				

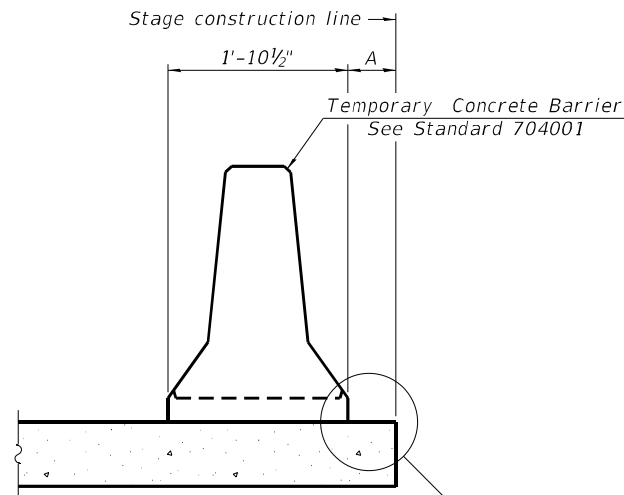

When "A" is 3'-1" or less, the temporary concrete barrier shall be restrained to the new slab according to Detail I, II or III. No restraint is required when "A" is greater than 3'-1".

NEW SLAB OR NEW DECK BEAM

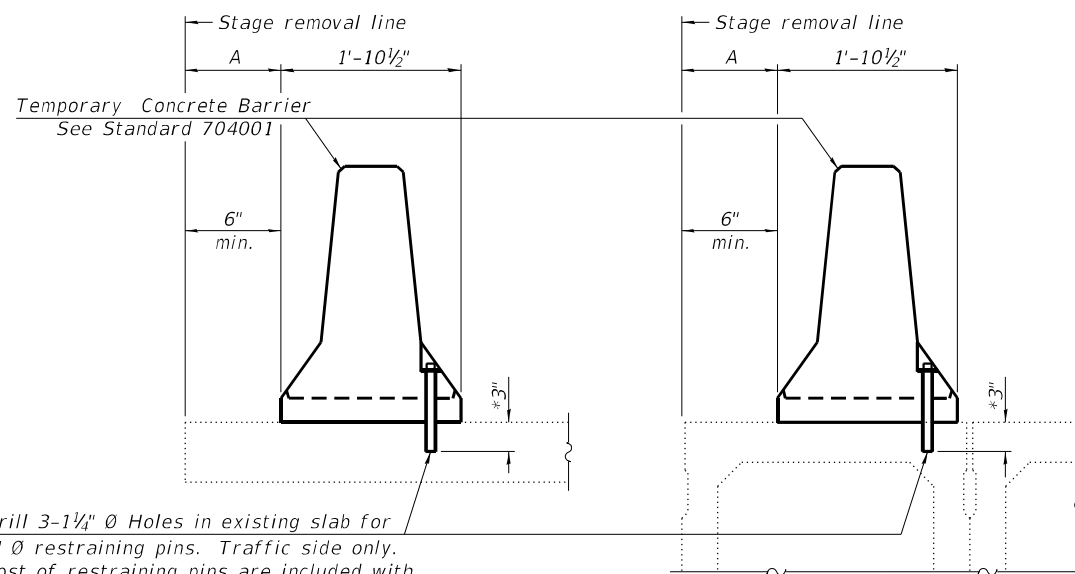

Drill 3-1/4" Ø Holes in existing slab for 1" Ø restraining pins. Traffic side only. Cost of restraining pins are included with Temporary Concrete Barrier. No restraint is required when "A" is greater than 3'-1".

EXISTING SLAB

* When hot-mix asphalt wearing surface is present, embedment shall be 3" plus the wearing surface depth.

EXISTING DECK BEAM

SECTIONS THRU SLAB OR DECK BEAM

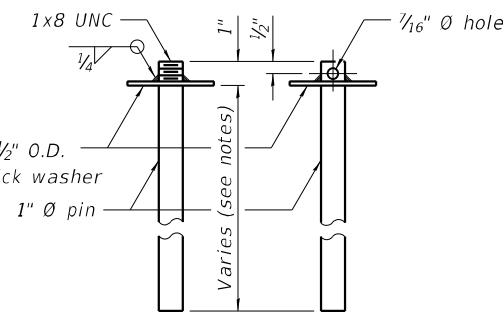

RESTRAINING PIN

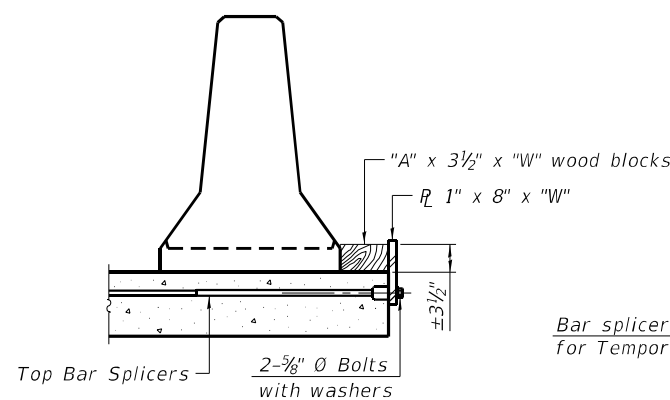

DETAIL I

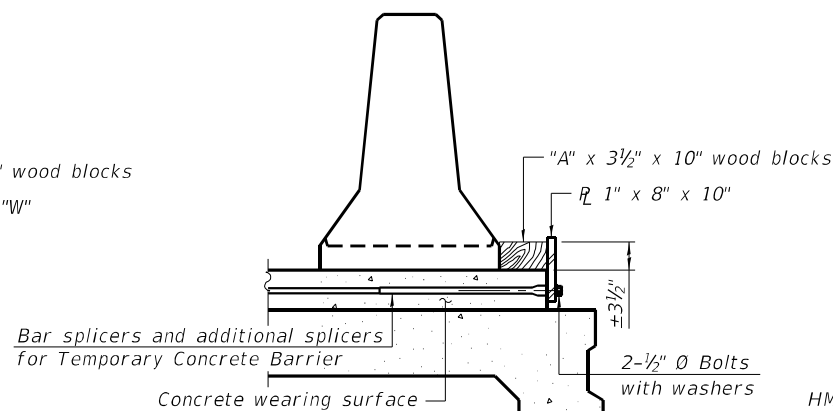

DETAIL II

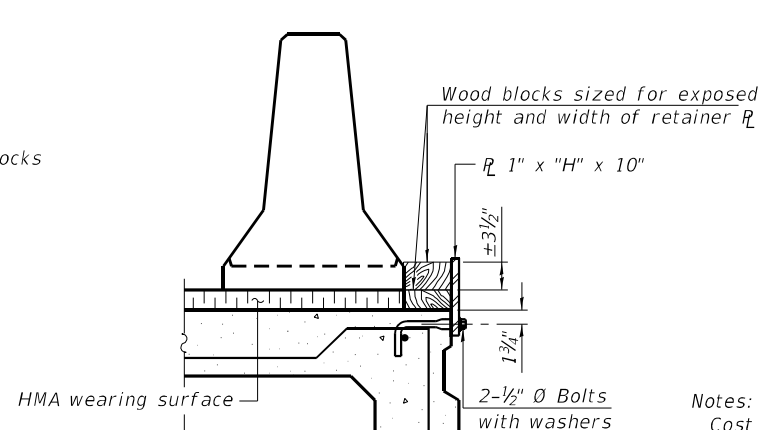

DETAIL III

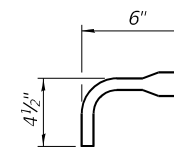

BAR SPLICER FOR #4 BAR - DETAIL III

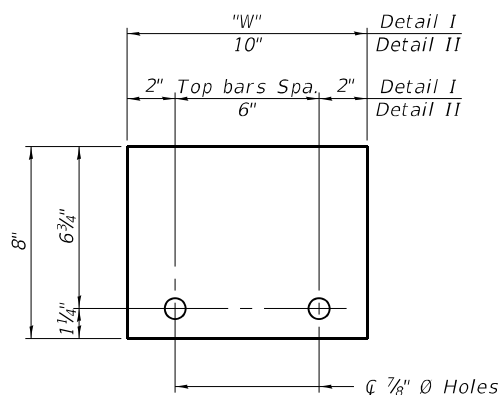

STEEL RETAINER 1" x 8" x "W" (Detail I and II)

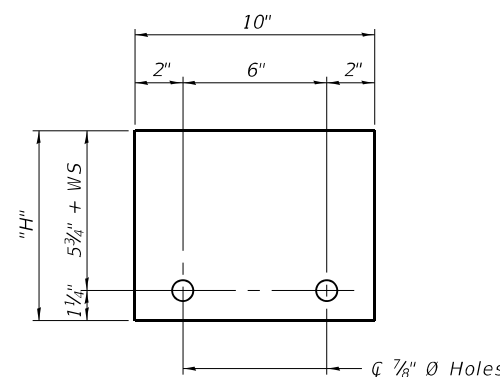

STEEL RETAINER 1" x "H" x 10" (Detail III)

Notes:
 Cost of retainer assembly is included with Temporary Concrete Barrier.
 A retainer assembly shall be located at the approximate center of each temporary concrete barrier.
 The retainer plate shall not be removed until the concrete on the adjacent stage is ready to be poured. For Detail III applications the retainer plate shall not be removed until just prior to placing the adjacent beam.
 When the 'A' dimension is less than 1 1/2', the wood block shall be omitted and the barrier shall be placed in direct contact with the steel retainer plate. For deck beam applications the minimum required 'A' distance is 6" to accommodate the shear key clamping device.

Detail I - Installation for a new bridge deck or bridge slab.
 Detail II - Installation for a new deck beam with an initial concrete wearing surface. Additional bar splicers shall be provided at 6'-0" centers and paired with the bar splicers of the concrete wearing surface reinforcement to accommodate the installation of the retainer assemblies. The cost of the additional bar splicers is included with the concrete wearing surface.
 Detail III - Installation for a new deck beam with no initial wearing surface or with an initial hot-mix asphalt (HMA) wearing surface present. The deck beam directly beneath the temporary concrete barrier shall be fabricated with bar splicer inserts in the side of the beam, as detailed, to accommodate the installation of the retainer assemblies. A pair of bar splicers, 6" apart, shall be placed at 6'-0" centers along the length of the beam. The cost of the bar splicers is included with the deck beam.

RAILING CRITERIA

NCHRP 350 Test Level	3
Railing Weight (plf)	440

R-27 10-12-2021

EFK•Moen
Civil Engineering Design

USER NAME = acb	DESIGNED - ACB	REVISED -
PLOT SCALE =	CHECKED - CDL	REVISED -
PLOT DATE = 1/26/2024	DRAWN - ACB	REVISED -
	CHECKED - CDL	REVISED -

STATE OF ILLINOIS
DEPARTMENT OF TRANSPORTATION

TEMPORARY CONCRETE BARRIER FOR STAGE CONSTRUCTION
STRUCTURE NO. 100-0037

SHEET 3 OF 16 SHEETS

F.A.P. RTE.	SECTION	COUNTY	TOTAL SHEETS	SHEET NO.
726	(41-B)BDR-1	WILLIAMSON	27	14
CONTRACT NO. 78A06				
ILLINOIS FED. AID PROJECT				

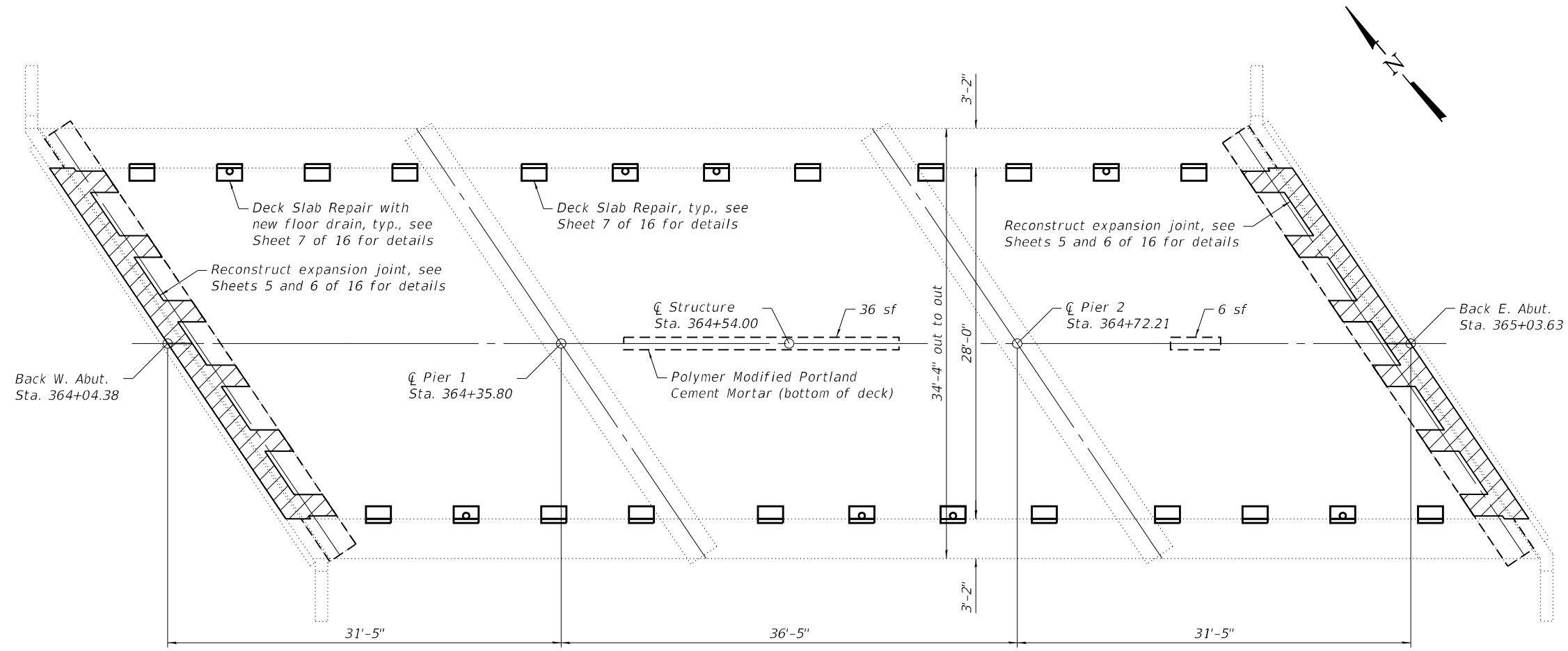

PLAN

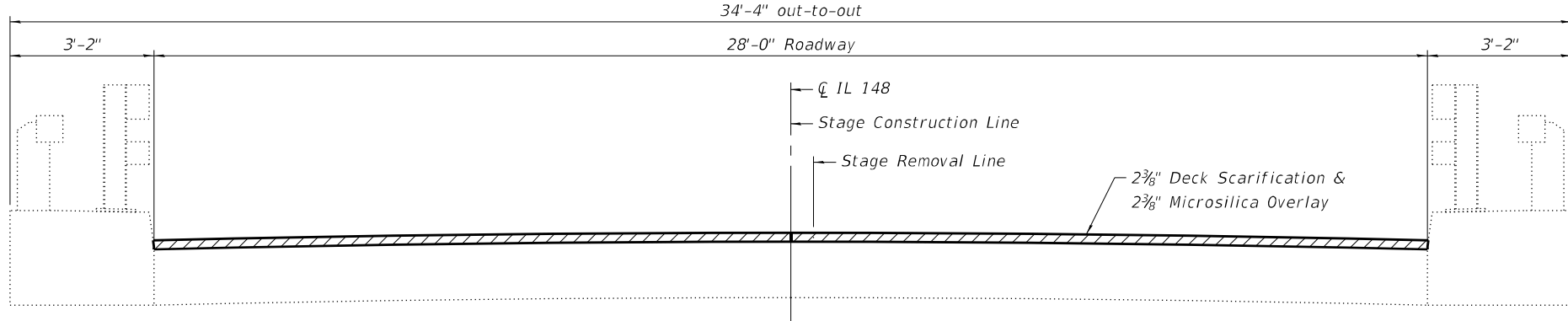

CROSS SECTION
(Looking East)

BILL OF MATERIAL

Item	Unit	Total
Bridge Deck Grooving	Sq. Yd.	287
Protective Coat	Sq. Yd.	309
Bridge Deck Scarification 2 3/8"	Sq. Yd.	309
Bridge Deck Microsilica Concrete Overlay 2 3/8"	Sq. Yd.	289
Polymer Modified Portland Cement Mortar	Sq. Ft.	42

Note:
Hatched area indicates removal of the existing overlay to the top of existing deck.

MODEL: Default
FILE NAME: Z:\23059_05_CMT_IL_148 over Middle Wolf Creek\DGN\Bridges\1000037-78A06-04-Deck Patching Plan.dgn

USER NAME = acb	DESIGNED - ACB	REVISED -
	CHECKED - CDL	REVISED -
PLOT SCALE =	DRAWN - ACB	REVISED -
PLOT DATE = 2/26/2024	CHECKED - CDL	REVISED -

F.A.P. RTE. 726	SECTION (41-B)BDR-1	COUNTY WILLIAMSON	TOTAL SHEETS 27	SHEET NO. 15
CONTRACT NO. 78A06				
ILLINOIS FED. AID PROJECT				

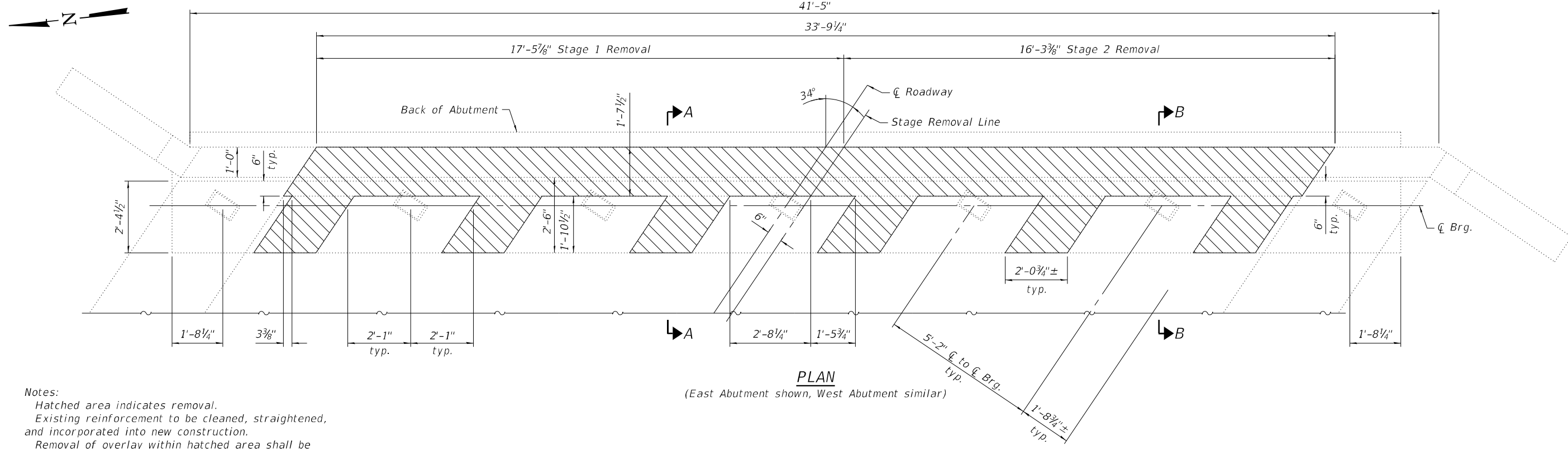

PLAN
(East Abutment shown, West Abutment similar)

Notes:
Hatched area indicates removal.
Existing reinforcement to be cleaned, straightened, and incorporated into new construction.
Removal of overlay within hatched area shall be considered included in Bridge Deck Scarification.

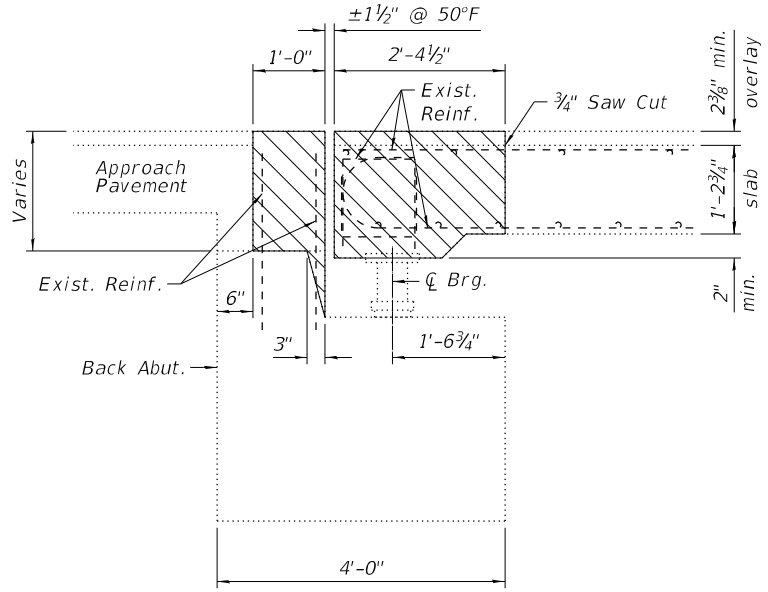

SECTION A-A

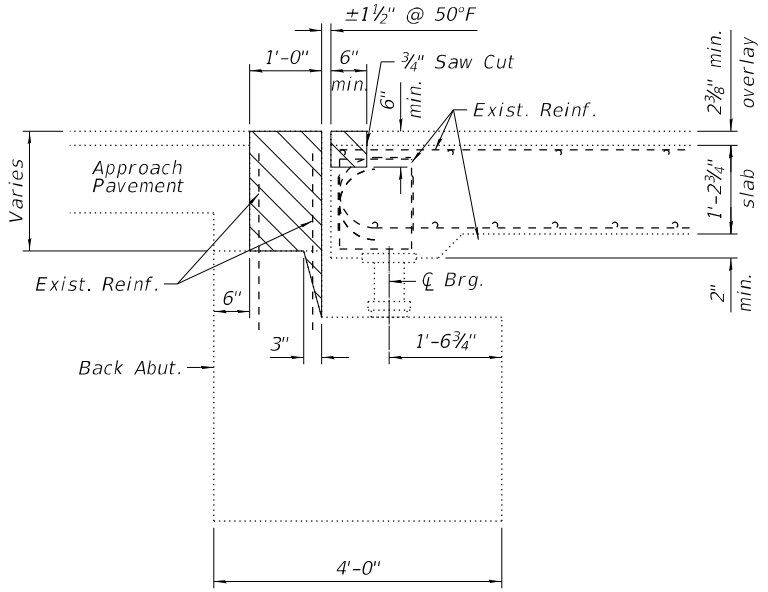

SECTION B-B

BILL OF MATERIAL

Item	Unit	Total
Concrete Removal	Cu. Yd.	8.0

MODEL: Default
FILE NAME: Z:\230509_05_CMT_IL_148 over Middle Wolf Creek\DGN\Bridges\1000037-78A06-005-Expansion Joint Removal.dgn
2/26/2024 11:30:47 AM

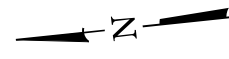

* Epoxy grout a2(E) & a3(E) bars in 7/8" x 9" (min.) drilled holes according to Section 584 of the Standard Specifications. Cost included in cost of "Reinforcement Bars, Epoxy Coated."
 ** Where possible lap b(E) bars with existing longitudinal bars.

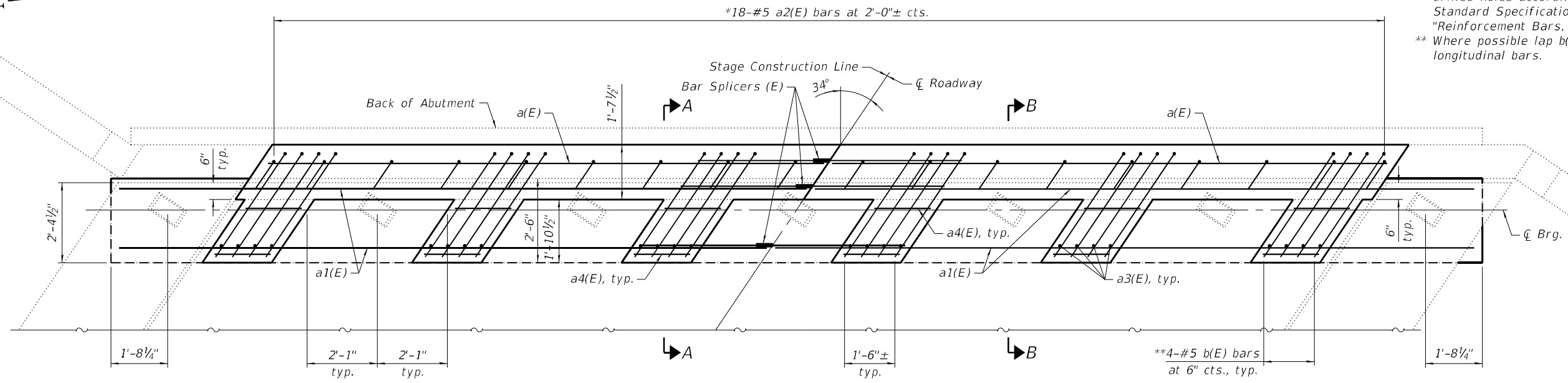

PLAN
 (East Abutment shown, West Abutment similar)

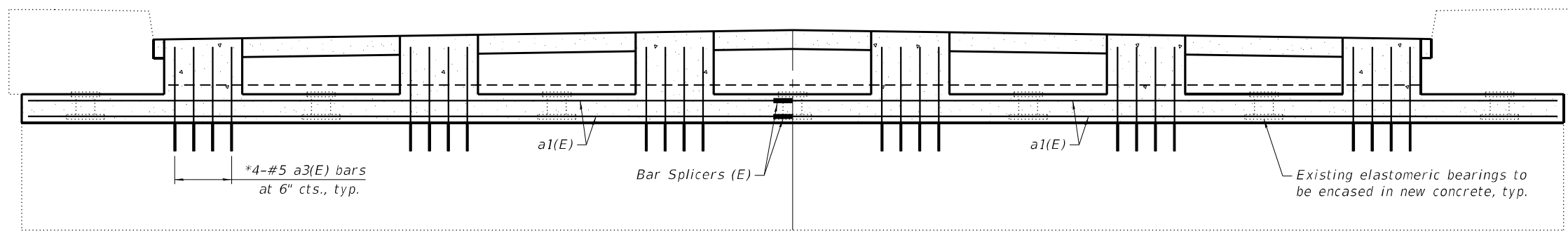

ELEVATION

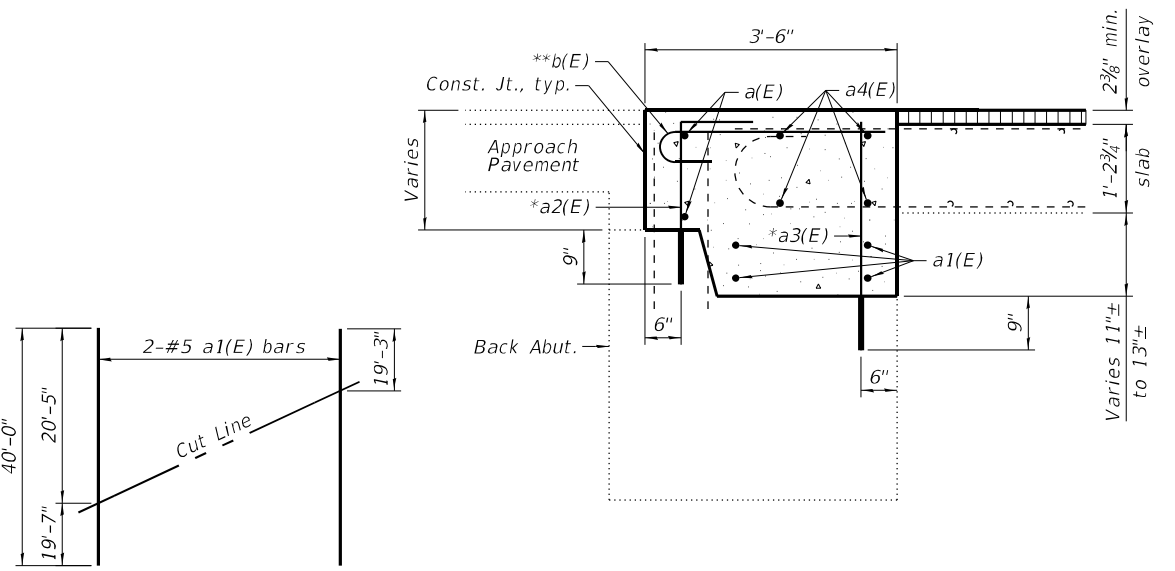

SECTION A-A

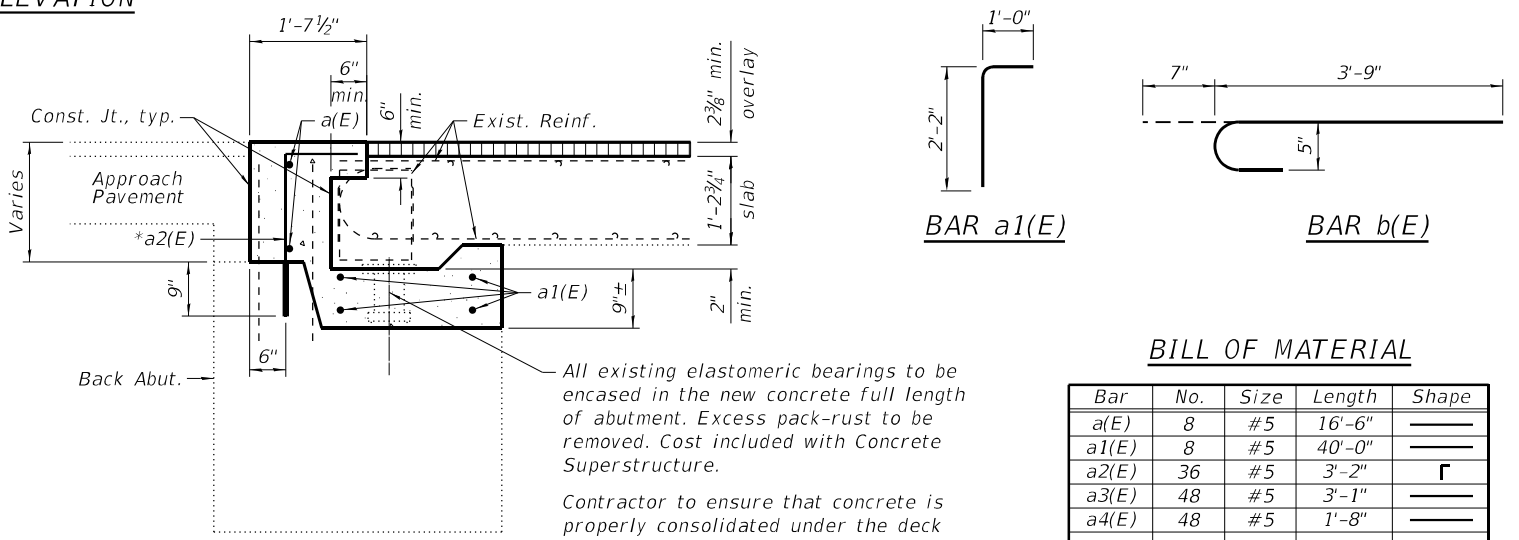

SECTION B-B

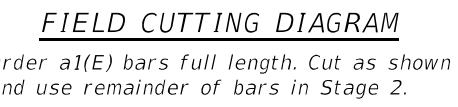

FIELD CUTTING DIAGRAM

Order a1(E) bars full length. Cut as shown and use remainder of bars in Stage 2.

All existing elastomeric bearings to be encased in the new concrete full length of abutment. Excess pack-rust to be removed. Cost included with Concrete Superstructure.
 Contractor to ensure that concrete is properly consolidated under the deck and around the bearings in these areas.

BILL OF MATERIAL

Bar	No.	Size	Length	Shape
a(E)	8	#5	16'-6"	—
a1(E)	8	#5	40'-0"	—
a2(E)	36	#5	3'-2"	┌
a3(E)	48	#5	3'-1"	—
a4(E)	48	#5	1'-8"	—
b(E)	48	#5	4'-4"	└
Reinforcement Bars, Epoxy Coated			Lbs.	1,050
Concrete Superstructure			Cu. Yds.	15.0
Bar Splicer			Each	12

MODEL: Default
 FILE NAME: Z:\23059_05_CMT_IL_148 over Middle Wolf Creek\DGNI\Bridges\100003778A06-06-Expansion Joint Replacement.dgn
 2/26/2024 11:30:48 AM

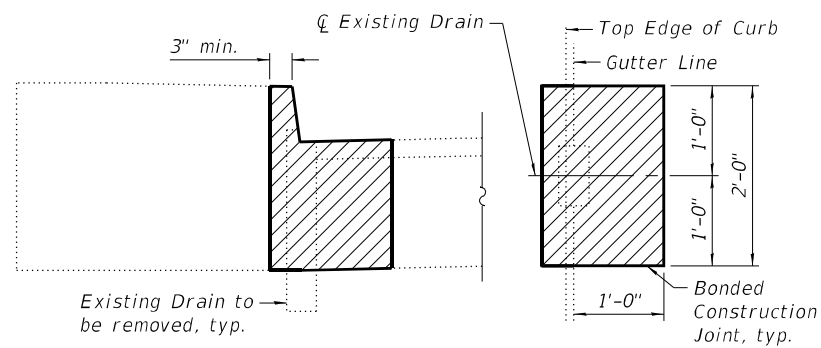

SECTION AT DRAIN

PARTIAL PLAN

DECK SLAB REPAIR

Hatched areas indicate sections to be removed and replaced. Dimensions are the minimum required to be removed. Perimeters of concrete removal areas shall be saw cut $\frac{3}{4}$ " prior to the removal of concrete. Cost of concrete removal, including removal of drain, and concrete placement included in Deck Slab Repair (Full Depth, Type I).

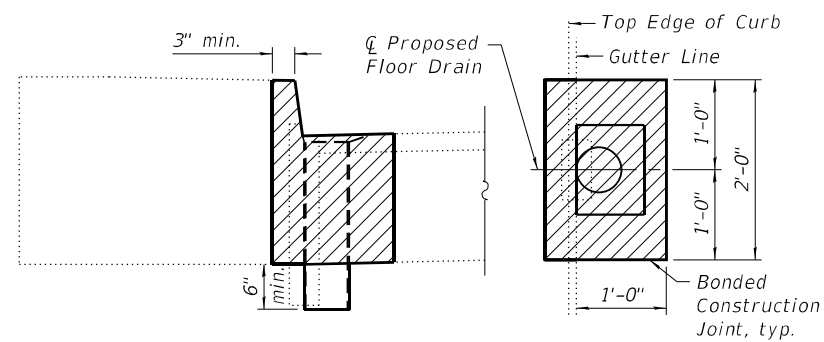

SECTION AT DRAIN

PARTIAL PLAN

DECK SLAB REPAIR WITH NEW FLOOR DRAIN

Hatched areas indicate sections to be removed and replaced. Dimensions are the minimum required to be removed. Perimeters of concrete removal areas shall be saw cut $\frac{3}{4}$ " prior to the removal of concrete. Cost of concrete removal, including removal of drain, and concrete placement included in Deck Slab Repair (Full Depth, Type I). All material and labor to install the floor drains will be included in the cost of Floor Drains.

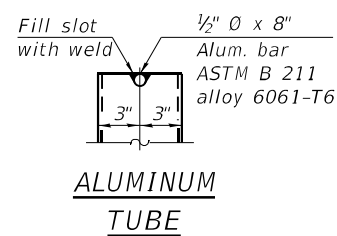

ALUMINUM TUBE

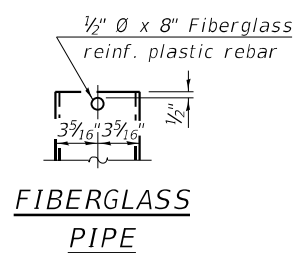

FIBERGLASS PIPE

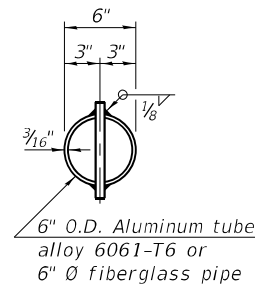

TOP PLAN (Showing aluminum tube)

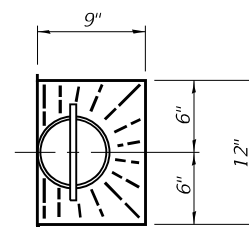

TOP PLAN

Notes:
Fiberglass pipe shall conform to ASTM D2996, with short-time rupture strength hoop tensile stress of 30,000 p.s.i. minimum.
The top portion of aluminum floor drains shall be coated to minimize reaction with wet concrete.

BILL OF MATERIAL

Item	Unit	Total
Floor Drains	Each	8
Deck Slab Repair (Full Depth, Type I)	Sq. Yd.	7

MODEL: Default
FILE NAME: Z:\23059.05_CMT_IL_148_over_Middle_Wolf_Creek\DGN\Bridges\1000037-78A06-007-Deck_Repairs_and_Drains.dgn
1/26/2024 9:17:37 AM

MODEL: Default
 FILE NAME: Z:\23059_05_CMT_IL_148_over_Middle_Wolf_Creek\DGN\Bridges\1000037-78A06-08-Abutment_Repairs.dgn

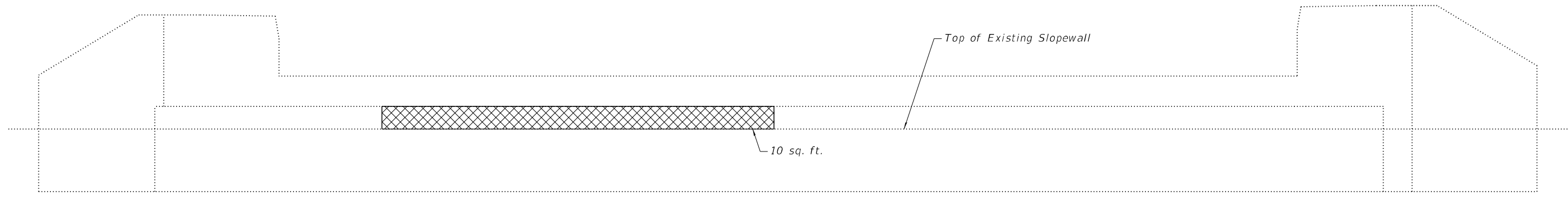

WEST ABUTMENT ELEVATION



EAST ABUTMENT ELEVATION

 Structure Repair of Concrete
 (Depth Equal to or Less than 5 Inches)

BILL OF MATERIAL

Item	Unit	Total
Structural Repair of Concrete (Depth Equal to or Less than 5 Inches)	Sq. Ft.	14

USER NAME = acb	DESIGNED - ACB	REVISED -
	CHECKED - CDL	REVISED -
PLOT SCALE =	DRAWN - ACB	REVISED -
PLOT DATE = 1/26/2024	CHECKED - CDL	REVISED -

F.A.P. RTE.	SECTION	COUNTY	TOTAL SHEETS	SHEET NO.
726	(41-B)BDR-1	WILLIAMSON	27	19
CONTRACT NO. 78A06				
ILLINOIS FED. AID PROJECT				

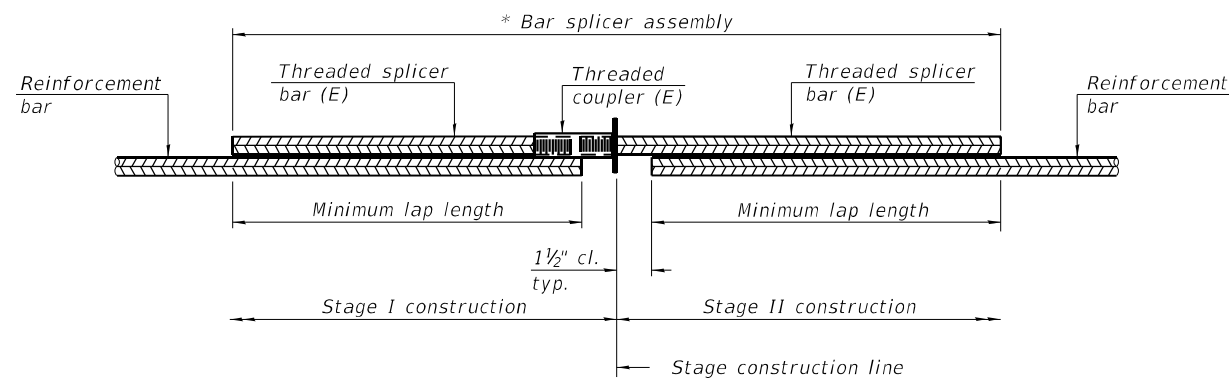

STANDARD BAR SPLICER ASSEMBLY PLAN

Only bar splicer assemblies as presented on the approved QPL list may be used.

Threaded splicer bar length = min. lap length + 1 1/2" + thread length

* Epoxy not required on Bar Splicer Assembly components used in conjunction with black bars.

Location	Bar size	No. assemblies required	Minimum lap length
West Deck Joint	#5	6	3'-6"
East Deck Joint	#5	6	3'-6"

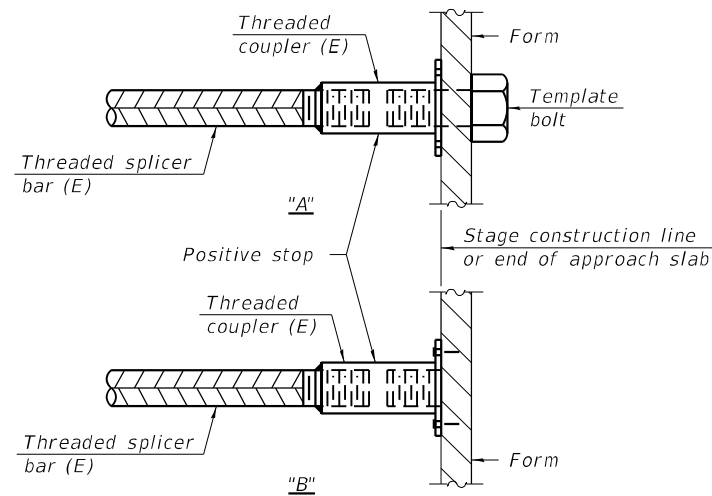

INSTALLATION AND SETTING METHODS

"A" : Set bar splicer assembly by means of a template bolt.

"B" : Set bar splicer assembly by nailing to wood forms or cementing to steel forms.

(E) : Indicates epoxy coating.

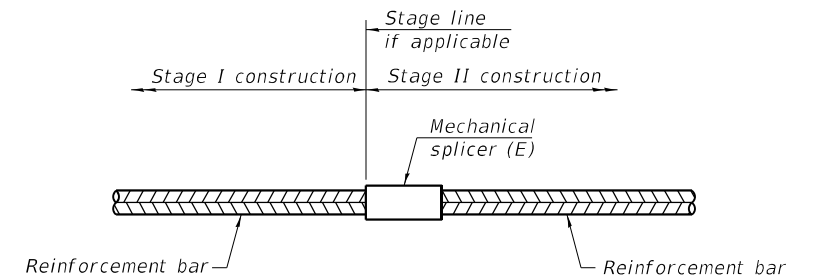

STANDARD MECHANICAL SPLICER

Location	Bar size	No. assemblies required

Notes:

Splicer bars shall be deformed with threaded ends and have a minimum 60 ksi yield strength.

All reinforcement shall be lapped and tied to the splicer bars.

Bar splicer assemblies shall be epoxy coated according to the requirements for reinforcement bars. See Section 508 of the Standard Specifications.

See approved list of bar splicer assemblies and mechanical splicers for alternatives.

MODEL: Default
FILE NAME: Z:\23059.05_CMT_IL_148 over Middle Wolf Creek\DGN\Bridges\1000037-78A06-09-Bar Splicer.dgn

BSD-1

2-1-2023

EFK Moen
Civil Engineering Design

USER NAME = acb	DESIGNED - ACB	REVISED -
PLOT SCALE =	CHECKED - CDL	REVISED -
PLOT DATE = 2/26/2024	DRAWN - ACB	REVISED -
	CHECKED - CDL	REVISED -

STATE OF ILLINOIS
DEPARTMENT OF TRANSPORTATION

BAR SPLICER ASSEMBLY AND MECHANICAL SPLICER DETAILS
STRUCTURE NO. 100-0037

SHEET 9 OF 16 SHEETS

F.A.P. RTE. 726	SECTION (41-B)BDR-1	COUNTY WILLIAMSON	TOTAL SHEETS 27	SHEET NO. 20
CONTRACT NO. 78A06				
ILLINOIS FED. AID PROJECT				

MODEL: Default
 FILE NAME: Z:\23059.05 CMT IL 148 over Middle Wolf Creek\IGNIBridge\m\Plotsheets\100003778A06-C10-Existing Plans.dgn

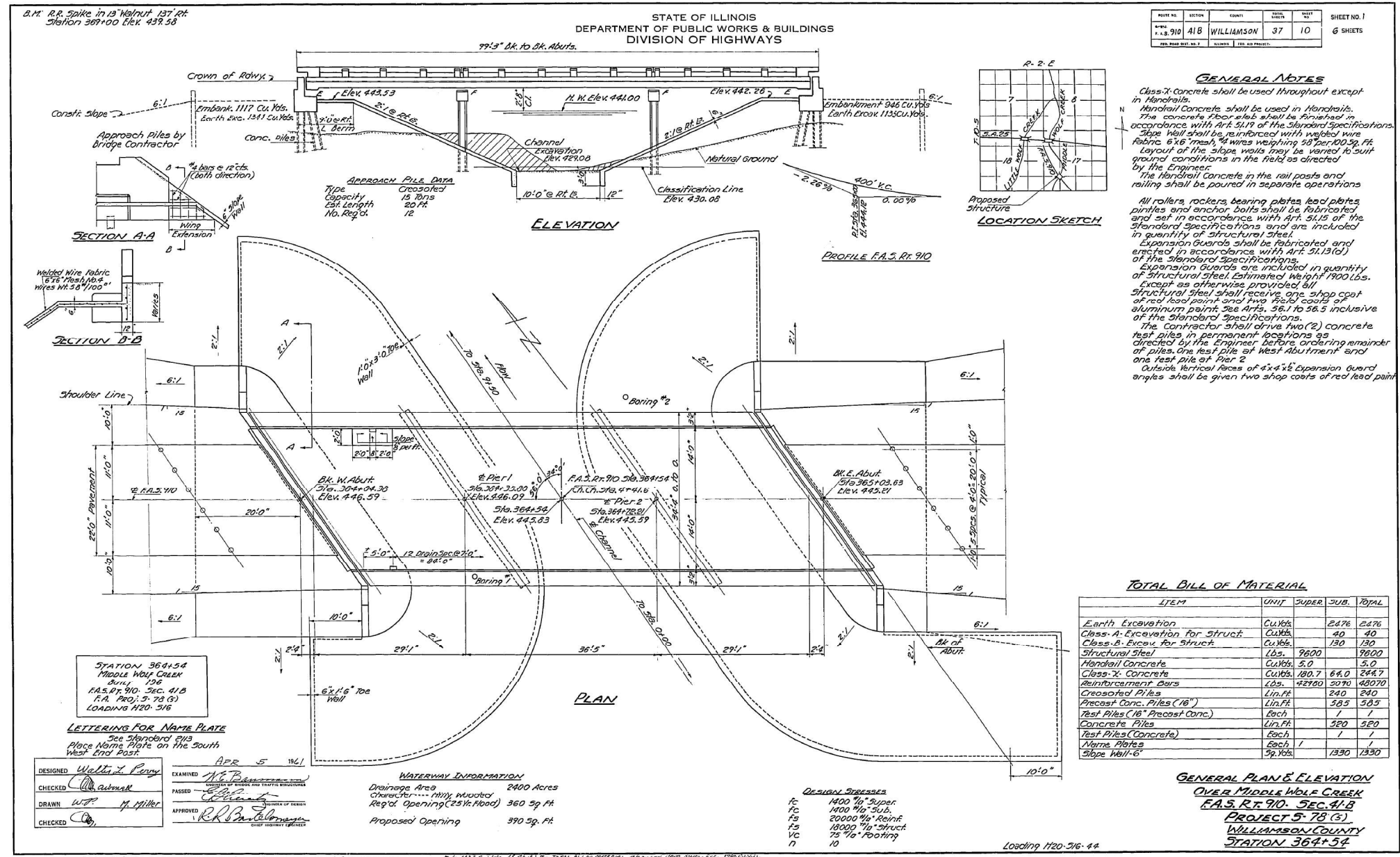

STATION 364+54
 MIDDLE WOLF CREEK
 JULY 196
 F.A.S. RT. 910, SEC. 41B
 P.A. PROJ. 5-78 (3)
 LOADING 1120-516

LETTERING FOR NAME PLATE
 See Standard Sp3
 Place Name Plate on the south
 West End Post.

DESIGNED: *Walter L. Parry*
 CHECKED: *W. L. Parry*
 DRAWN: *W. L. Parry*
 EXAMINED: *M. J. ...*
 PASSED: *M. J. ...*
 APPROVED: *R. K. ...*

WATERWAY INFORMATION
 Drainage Area: 2400 Acres
 Character: Heavy Wooded
 Reg'd. Opening (25 ft. Hood): 360 Sp. Ft.
 Proposed Opening: 390 Sp. Ft.

DESIGN STRESSES
 FC: 1400 1/2" Super
 FC: 1400 1/2" Sub.
 FS: 20000 1/2" Reinf.
 FS: 18000 1/2" Struct.
 VC: 75 1/2" Footing
 N: 10

Revised 5/24/61 in ELEVATION changed quantities of Embankment from 670 Cu.Yds. to 1117 Cu.Yds. (N. Abut.) From 850 Cu.Yds. to 940 Cu.Yds. (S. Abut.) Borrow Exc. changed to 65000 Cu.Yds. (see changed) from 800 Cu.Yds. to 1500 Cu.Yds. (see changed) from 180 Cu.Yds.



FOR INFORMATION ONLY

STATE OF ILLINOIS
 DEPARTMENT OF TRANSPORTATION

EXISTING PLANS
 STRUCTURE NO. 100-0037

SHEET 10 OF 16 SHEETS

USER NAME = acb	DESIGNED - ACB	REVISED -
	CHECKED - CDL	REVISED -
PLOT SCALE =	DRAWN - ACB	REVISED -
PLOT DATE = 1/26/2024	CHECKED - CDL	REVISED -

F.A.P. RTE. 726	SECTION (41-B)BDR-1	COUNTY WILLIAMSON	TOTAL SHEETS 27	SHEET NO. 21
CONTRACT NO. 78A06				
ILLINOIS FED. AID PROJECT				

MODEL: Default
 FILE NAME: Z:\23059.05_CMT_IL_148 over Middle Wolf Creek\IGNIBridge\small\Plotsheets\1000037-78A06-012-Existing_Plans.dgn

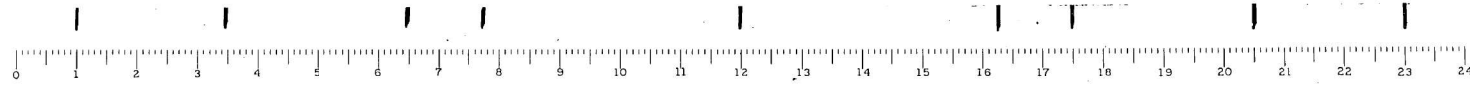
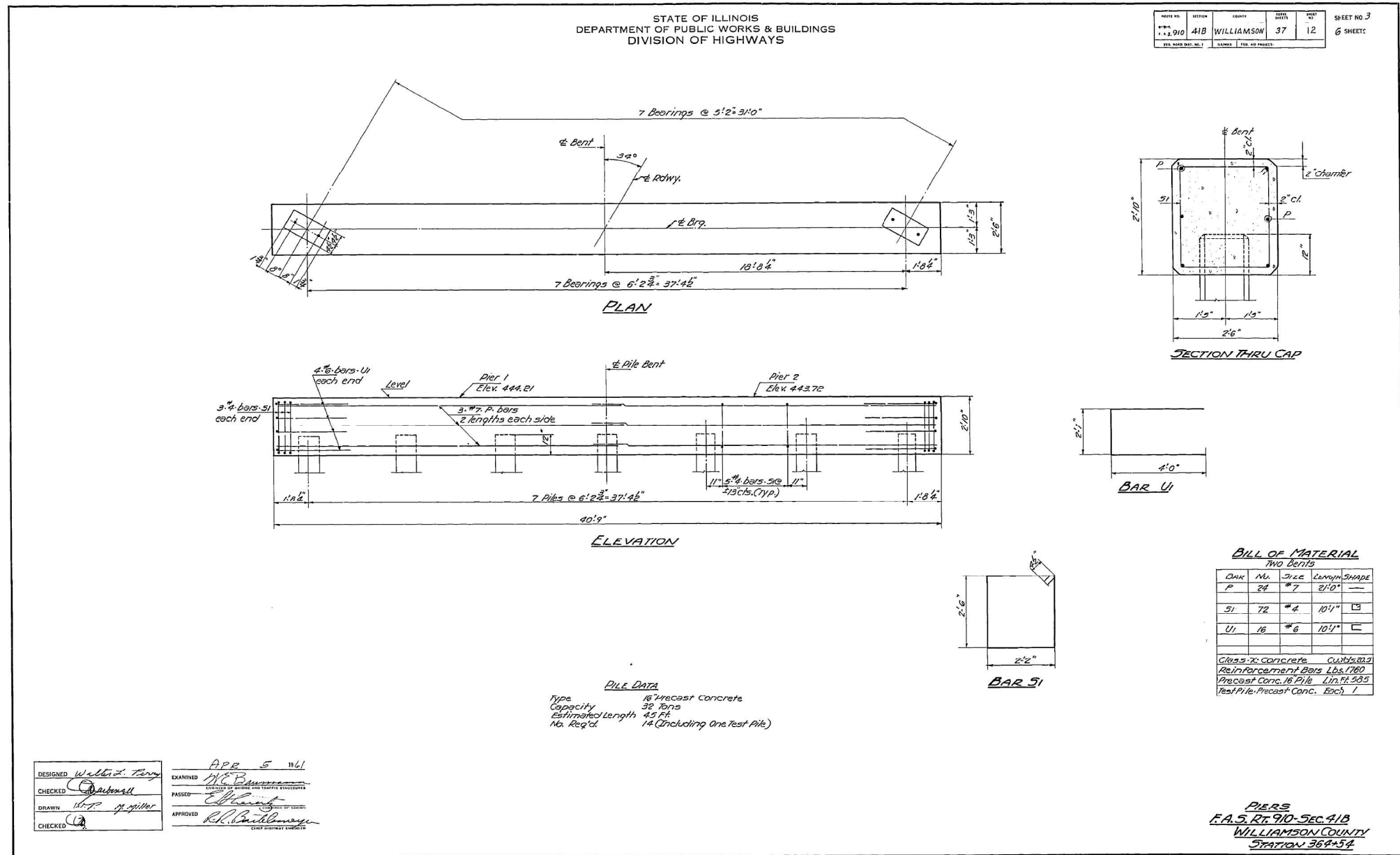

FOR INFORMATION ONLY

EFK Moen Civil Engineering Design	USER NAME = acb	DESIGNED - ACB	REVISED -	STATE OF ILLINOIS DEPARTMENT OF TRANSPORTATION	EXISTING PLANS STRUCTURE NO. 100-0037	F.A.P. RTE.	SECTION	COUNTY	TOTAL SHEETS	SHEET NO.
	PLOT SCALE =	DRAWN - ACB	REVISED -			726	(41-B)BDR-1	WILLIAMSON	27	23
PLOT DATE = 1/26/2024	CHECKED - CDL	REVISED -		SHEET 12 OF 16 SHEETS		CONTRACT NO. 78A06			ILLINOIS FED. AID PROJECT	

MODEL: Default
 FILE NAME: Z:\23059.05_CMT_IL_148 over Middle Wolf Creek\DGNI\Bridges\100003778A06-013-Existing Plans.dgn
 1/26/2024 9:18:02 AM

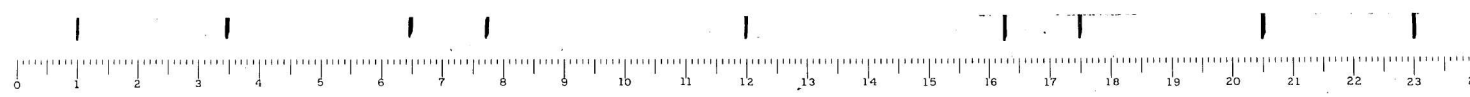
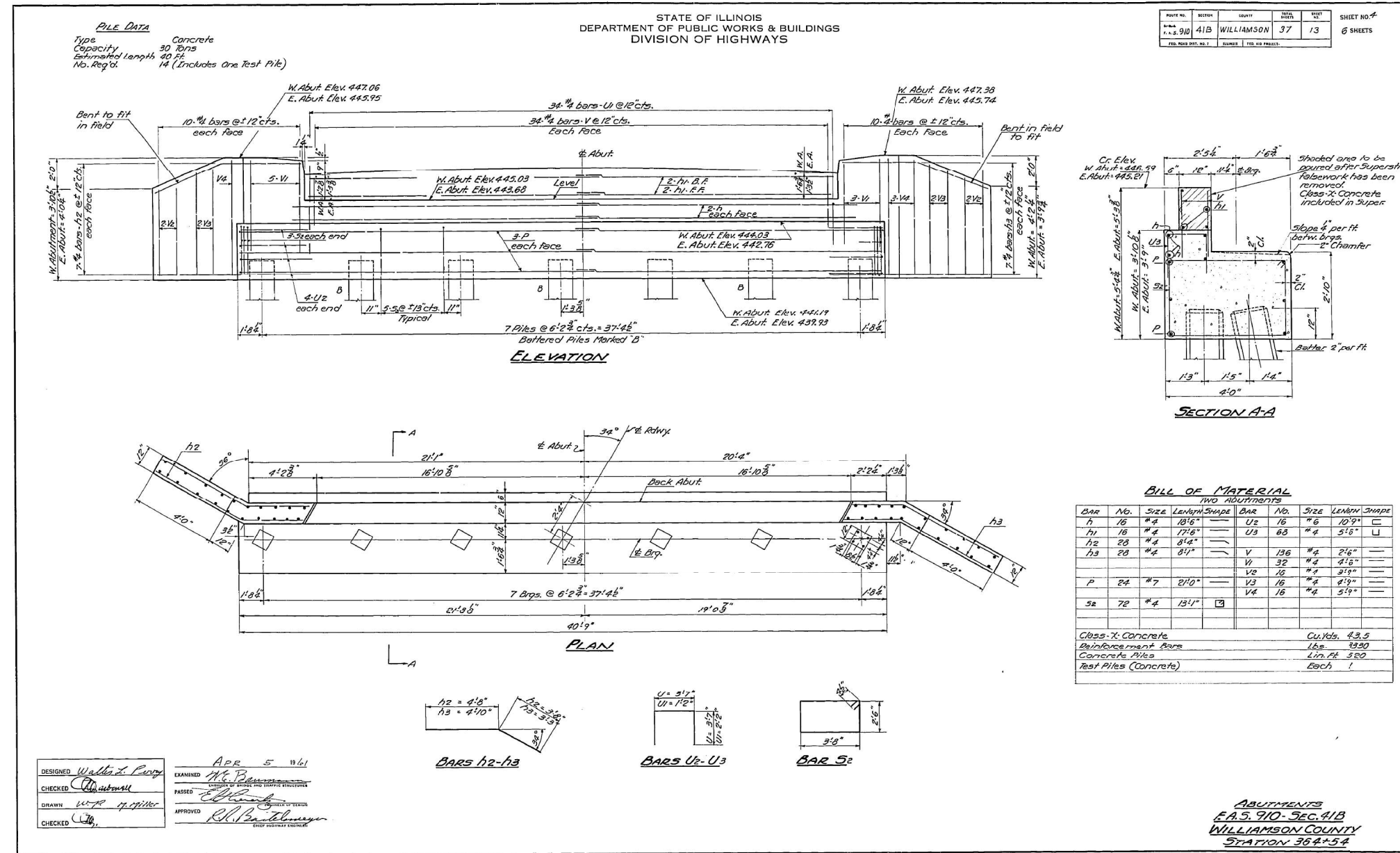

FOR INFORMATION ONLY

EFK Moen
 Civil Engineering Design

USER NAME = acb	DESIGNED - ACB	REVISED -
PLOT SCALE =	CHECKED - CDL	REVISED -
PLOT DATE = 1/26/2024	DRAWN - ACB	REVISED -
	CHECKED - CDL	REVISED -

STATE OF ILLINOIS
 DEPARTMENT OF TRANSPORTATION

EXISTING PLANS
 STRUCTURE NO. 100-0037
 SHEET 13 OF 16 SHEETS

F.A.P. RTE. 726	SECTION (41-B)BDR-1	COUNTY WILLIAMSON	TOTAL SHEETS 27	SHEET NO. 24
CONTRACT NO. 78A06				
ILLINOIS FED. AID PROJECT				

F.A.P. RTE.	SECTION	COUNTY	TOTAL SHEETS	SHEET NO.
726	41-B)SMART 99-22	WILLIAMSON	33	14
STA. 0+000 TO STA. 0+000				
FED. ROAD DIST. NO.		ILLINOIS FED. AID PROJECT		

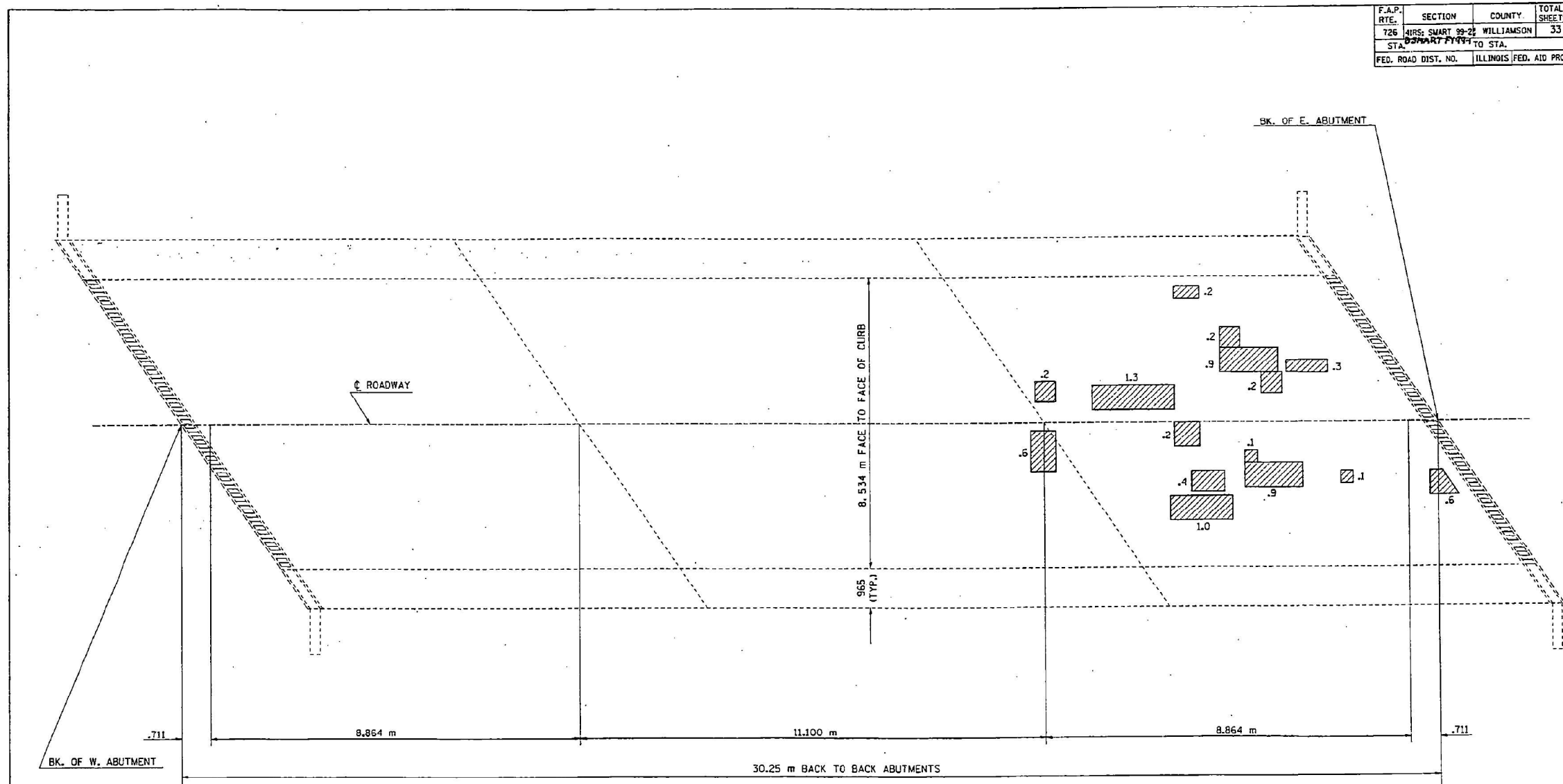

DECK PATCHING PLAN

BRIDGE DECK SURVEY
DATE: 3-17-98

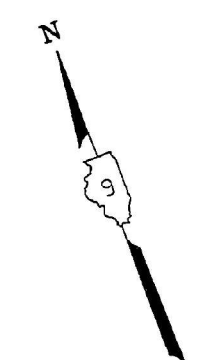

- DECK SLAB REPAIR (PARTIAL DEPTH) = 7.2 SQ. M.
- CONCRETE REMOVAL

NOTES: THE ENGINEER WILL MARK THE PLAN VIEW FOR THE DECK REPAIR TO BE INCORPORATED IN THE AS BUILT PLANS.
ALL AREAS FOR DECK SLAB REPAIR ARE IN SQUARE METERS (SQ. M.).

BILL OF MATERIAL (SN 100-0037)

SILICONE JOINT SEALER	M	25.5
FURNISHING AND ERECT. STR. STL.	KG	1,350
CONCRETE BRIDGE DECK SCARIFICATION (19 mm)	SO M	330
BRIDGE DECK MICROSILICA CONCRETE OVERLAY	SO M	248
BRIDGE DECK GROOVING	SO M	230
REINF. BARS, EPOXY COATED	KG	100
DECK SLAB REPAIR (PARTIAL DEPTH)	SO M	7.2
CONCRETE REMOVAL	CU M	2.6
CONCRETE SUPERSTRUCTURE	CU M	2.9
POLYMER MODIFIED PC MORTAR	SO M	11
BAR SPLICERS	EACH	6
ELASTOMERIC BEARING ASSEMBLY, TYPE 1	EACH	14
JACK AND REMOVE EXISTING BEARINGS	EACH	14

SN 100-0037 DECK PATCHING PLAN, TOTAL BILL OF MATERIAL

FOR INFORMATION ONLY

STATE OF ILLINOIS
DEPARTMENT OF TRANSPORTATION

EXISTING PLANS
STRUCTURE NO. 100-0037

SHEET 14 OF 16 SHEETS

F.A.P. RTE.	SECTION	COUNTY	TOTAL SHEETS	SHEET NO.
726	(41-B)BDR-1	WILLIAMSON	27	25
CONTRACT NO. 78A06				
ILLINOIS FED. AID PROJECT				

MODEL: Default
FILE NAME: Z:\23059.05 CMT IL 148 over Middle Wolf Creek\DGN\Bridges\1000037-78A06-014-Existing Plans.dgn
Wed Oct 21 13:31:02 1998
c:\p\object\ac01531\m01597a1.dgn LV=1:63

EFK Moen
Civil Engineering Design

USER NAME = acb	DESIGNED - ACB	REVISED -
PLOT SCALE =	CHECKED - CDL	REVISED -
PLOT DATE = 1/26/2024	DRAWN - ACB	REVISED -
	CHECKED - CDL	REVISED -

F.A.P. RTE.	SECTION	COUNTY	TOTAL SHEETS	SHEET NO.
726	41RS: SMART 99-2	WILLIAMSON	33	15
STA. SMART PLY-1 TO STA. SMART PLY-1				
FED. ROAD DIST. NO. ILLINOIS FED. AID PROJECT				

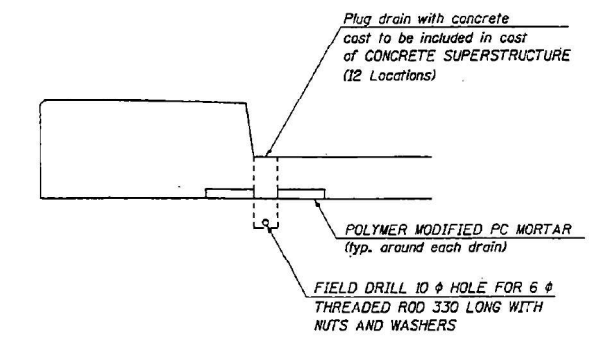
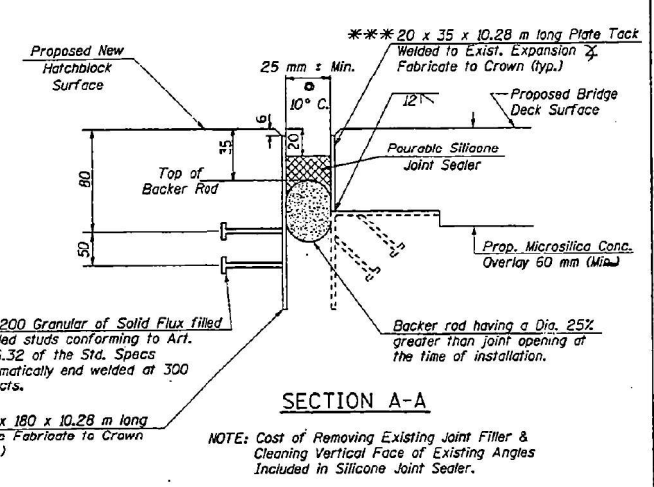
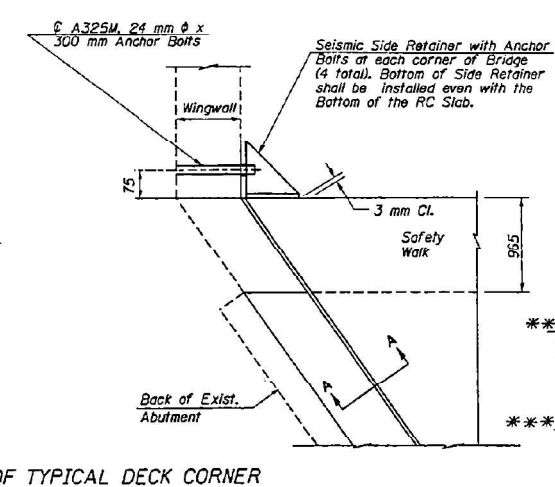
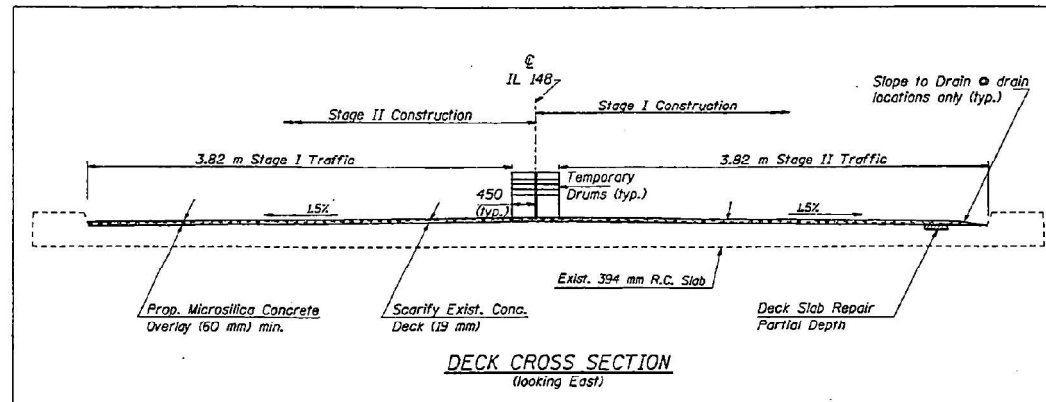

NOTE:
Alternate drains should be eliminated to provide a 3.65 m spacing. In addition, existing drains within 3.05 m of a substructure unit should be eliminated.

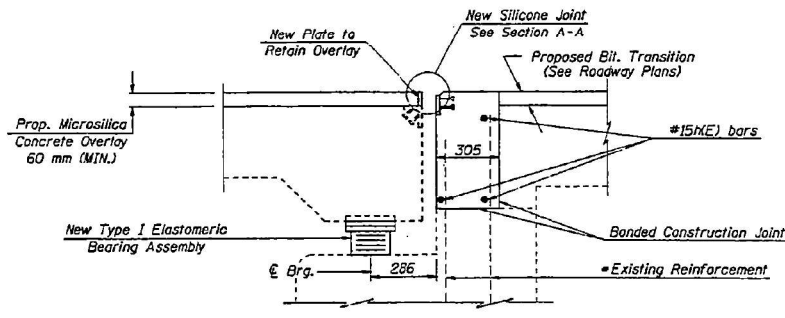
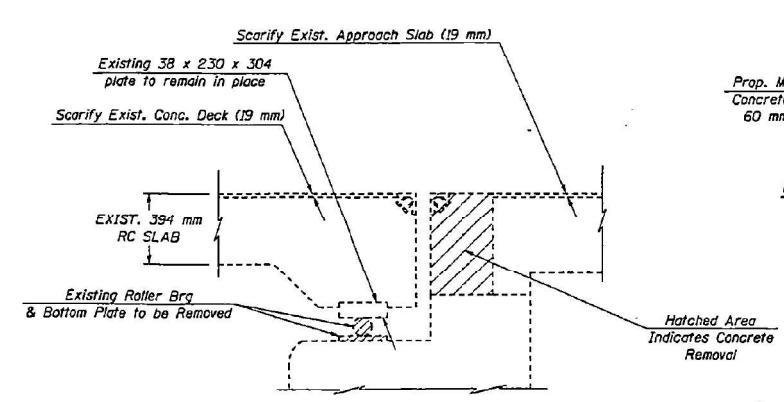
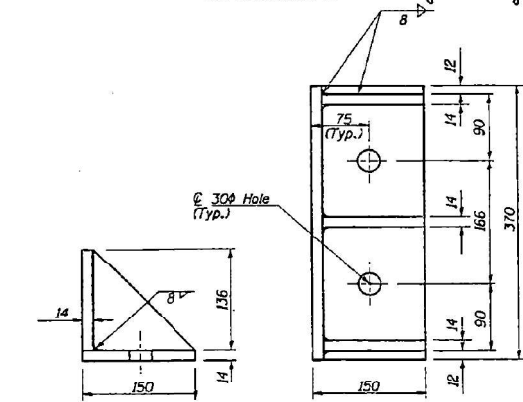
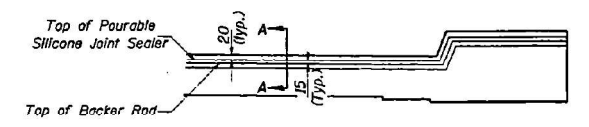

DESIGN STRESSES
(NEW CONSTRUCTION)
fy = 250 MPa (Structural steel)
fc = 24 Mpa (concrete)
fy = 400 MPa (reinforcement)

NOTE:
New Side Retainers, Anchor bolts and Plates are included in "FURNISHING AND ERECTING STRUCTURAL STEEL."
* Existing reinforcement extending into removal area shall be cleaned, straightened and incorporated into the new construction. Cost included in "CONCRETE REMOVAL."
*** 72 - 19 ϕ X 200 Granular or Solid Flux Filled Headed Studs required

SN 100-0037 - DETAILS - STAGING, DECK OVERLAY, ABUTMENT SECTION, SILICONE JOINT

FOR INFORMATION ONLY

MODEL: Default
FILE NAME: Z:\230509_05_CMT_IL_148_over_Middle_Wolf_Creek\DGN\Bridges\1000037-78A06-015-Existing_Plans.dgn
Wed Oct 21 13:16:05 1999
C:\PROGRA~1\Autocad\acad.rvt

EFK•Moen
Civil Engineering Design

USER NAME = acb	DESIGNED - ACB	REVISED -
PLOT SCALE =	CHECKED - CDL	REVISED -
PLOT DATE = 1/26/2024	DRAWN - ACB	REVISED -
	CHECKED - CDL	REVISED -

STATE OF ILLINOIS
DEPARTMENT OF TRANSPORTATION

EXISTING PLANS
STRUCTURE NO. 100-0037

SHEET 15 OF 16 SHEETS

F.A.P. RTE.	SECTION	COUNTY	TOTAL SHEETS	SHEET NO.
726	(41-B)BDR-1	WILLIAMSON	27	26
CONTRACT NO. 78A06				
ILLINOIS FED. AID PROJECT				

F.A.P. RTE.	SECTION	COUNTY	TOTAL SHEETS	SHEET NO.
T26	SHAWNEE ST. TO STA. 1+00	WILLIAMSON	33	16
FED. ROAD DIST. NO.		ILLINOIS FED. AID PROJECT		

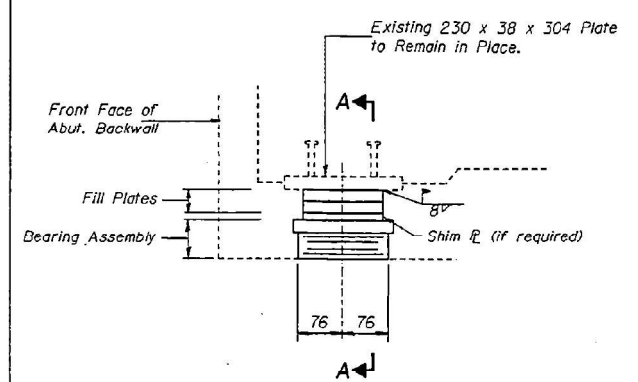

ELEVATION AT ABUTMENTS

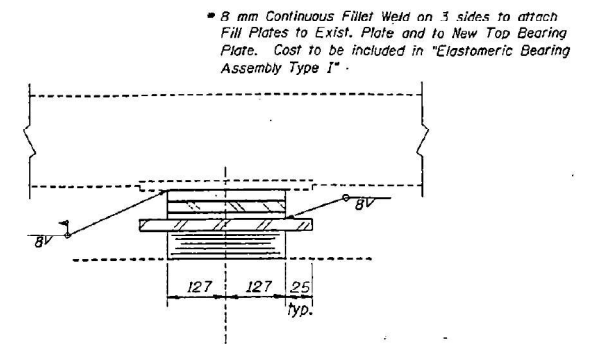

SECTION A-A

TYPE I ELASTOMERIC EXP. BRG.

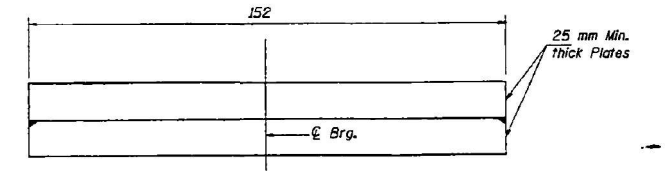

ELEVATION AT FILL PLATES

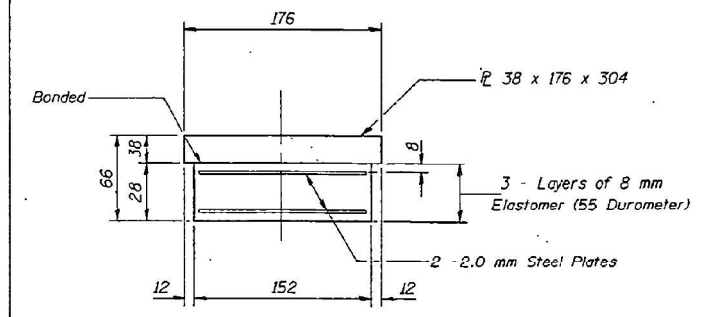

BEARING ASSEMBLY

Note: Shim plates shall not be placed under Bearing Assembly.

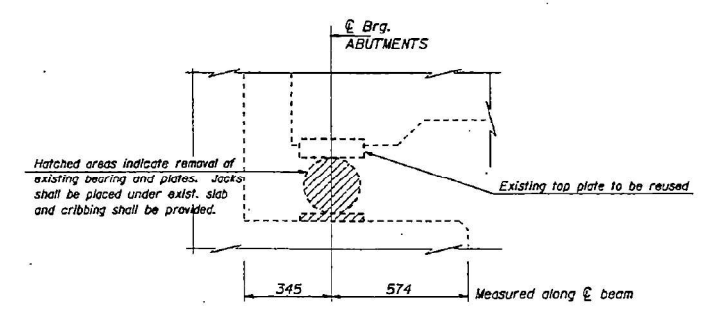

JACK AND REMOVE EXISTING BEARING PROCEDURE

The Contractor shall submit plans for jacking and cribbing to the Engineer for approval, prior to commencing any work at the bearings. The Contractor shall jack and crib under the RC slab adjacent to each individual bearing while the live load is on the adjacent lane.

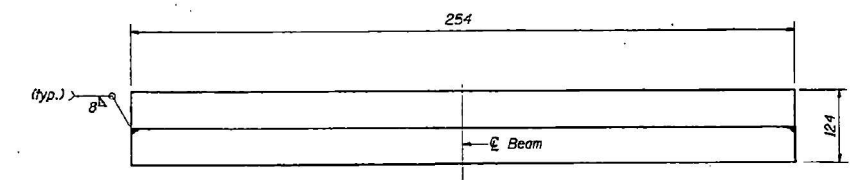

END VIEW OF FILL PLATES

* BEAM REACTION TABLE

SERVICE LOADS	ABUTMENTS
R _{DL} (KN)	62.7
R _{LL} (KN)	77.8
Imp. (KN)	23.4
R(TOTAL)(KN)	163.9

* Min. Jack Capacity at each beam shall be 175 KN.

Notes:

- New Fill Plates and Shim Plates are included in "Furnishing and Erecting Structural Steel".
- Prior to ordering any material, the contractor shall verify in the field all bearing height and fill plate thickness dimensions.
- Burn existing anchor bolts flush with existing concrete surface. Grind existing anchor bolt smooth and seal with epoxy. Cost to be included in "Jack and Remove Existing Bearing".
- Two 3 mm adjusting shims of the dimensions of the Fill plate, shall be provided for each new bearing in addition to all other plates.

BILL OF MATERIAL BOTH ABUTMENTS

Item	Unit	Total
Elastomeric Bearing Assembly Type I	Each	14
Jack and Remove Existing Bearings	Each	14

SN 100-0037 BEARING DETAILS

FOR INFORMATION ONLY

STATE OF ILLINOIS
DEPARTMENT OF TRANSPORTATION

EXISTING PLANS
STRUCTURE NO. 100-0037

SHEET 16 OF 16 SHEETS

F.A.P. RTE.	SECTION	COUNTY	TOTAL SHEETS	SHEET NO.
726	(41-B)BDR-1	WILLIAMSON	27	27
ILLINOIS		FED. AID PROJECT		

CONTRACT NO. 78A06

MODEL: Default
FILE NAME: Z:\23059.05 CMT IL 148 over Middle Wolf Creek\DGN\Bridges\1000037-78A06-016-Existing Plans.dgn
1/26/2024 9:18:23 AM

EFK Moen
Civil Engineering Design

USER NAME = acb	DESIGNED - ACB	REVISED -
PLOT SCALE =	CHECKED - CDL	REVISED -
PLOT DATE = 1/26/2024	DRAWN - ACB	REVISED -
	CHECKED - CDL	REVISED -