

STATE OF ILLINOIS
DEPARTMENT OF TRANSPORTATION

F.A.P. RTE.	SECTION	COUNTY	TOTAL SHEETS	SHEET NO.
331		Jackson	11	1
		ILLINOIS	CONTRACT NO. 78A60	

*D9 Traffic Signal 2024-2

FOR INDEX OF SHEETS, SEE SHEET NO. 3
FOR SCHEDULE OF QUANTITIES, SEE SHEET NO. 4

TRAFFIC DATA (2023)

ADT: 21,600 %TRUCKS: 5%

**TOWNSHIP
CARBONDALE**

**PROPOSED
HIGHWAY PLANS**

FAP ROUTE 331 (IL 13)
SECTION D9 TRAFFIC SIGNAL 2024-2
PROJECT
TRAFFIC SIGNAL DETECTION
JACKSON COUNTY

C-99-085-24

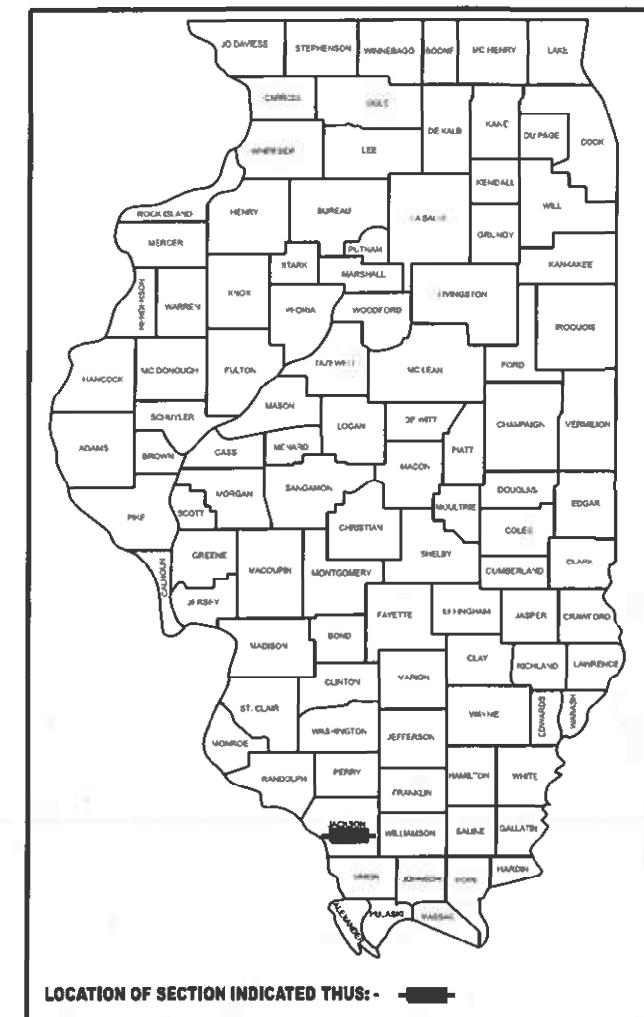

PROJECT LOCATION 1: INTERSECTION OF IL 13
AND NEW ERA / OLD 13

PROJECT LOCATION 2: INTERSECTION OF
IL 13 AND SYCAMORE ST / EMERALD LN

DESIGN DESIGNATION: N/A

POSTED SPEED
IL 13 45/ 35 MPH
NEW ERA 45 MPH
SYCAMORE RD/ EMERALD LN 40 MPH

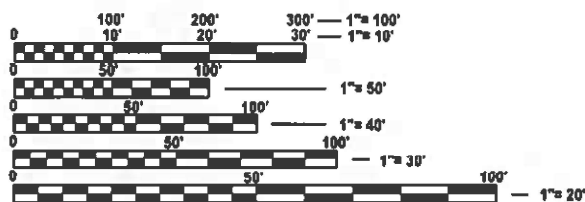

FULL SIZE PLANS HAVE BEEN PREPARED USING STANDARD
ENGINEERING SCALES. REDUCED SIZED PLANS WILL NOT
CONFORM TO STANDARD SCALES. IN MAKING MEASUREMENTS
ON REDUCED PLANS, THE ABOVE SCALES MAY BE USED.

J.U.L.I.E.
JOINT UTILITY LOCATION INFORMATION FOR EXCAVATION
1-800-892-0123
OR 811

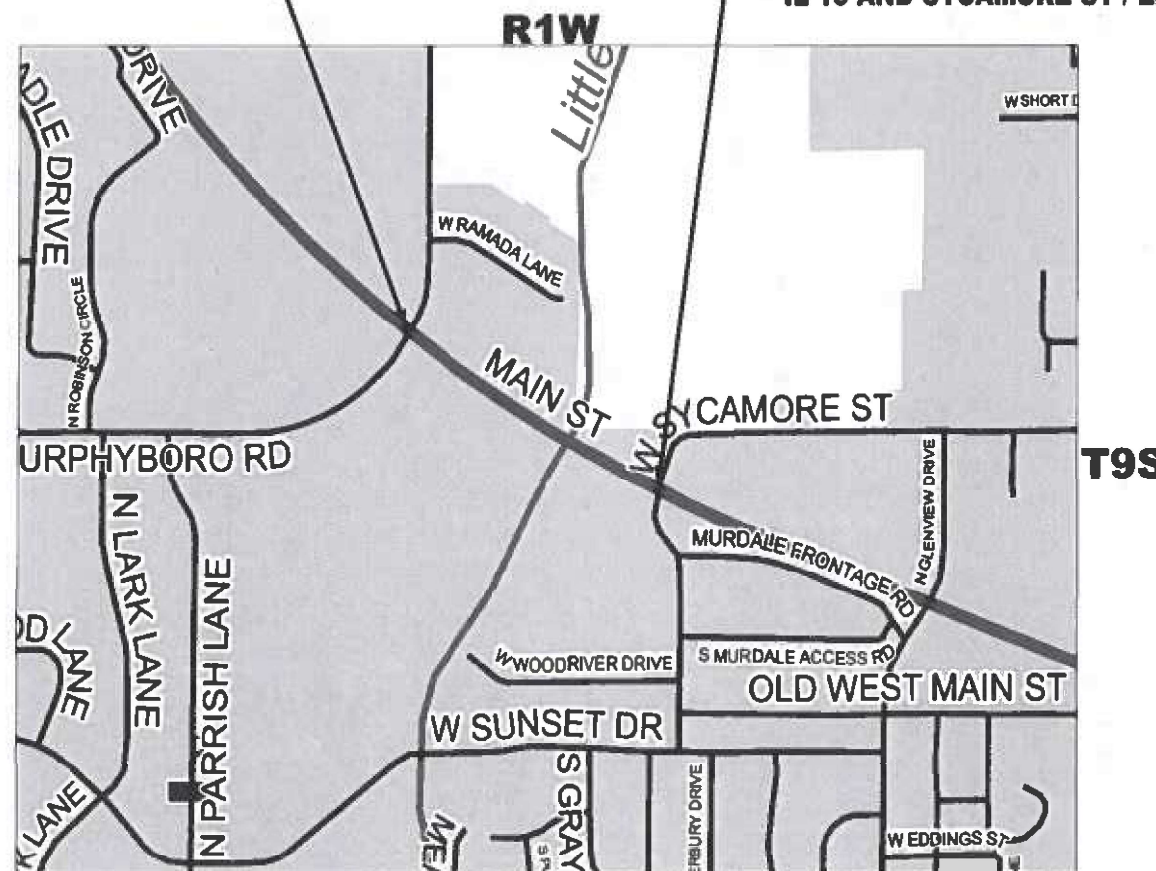

GROSS LENGTH = 1645 FT. = 0.31 MILE
NET LENGTH = 280 FT. = 0.05 MILE

PROJECT ENGINEER: SUSAN POE
PROJECT MANAGER: JAKE STARK

CONTRACT NO. 78A60

STATE OF ILLINOIS
DEPARTMENT OF TRANSPORTATION

SUBMITTED Jan 31 2024
Kirk H. Brown *not*
REGIONAL ENGINEER

March 22, 2024
[Signature]
ENGINEER OF DESIGN AND ENVIRONMENT

March 22, 2024
[Signature]
DIRECTOR OF HIGHWAYS PROJECT IMPLEMENTATION

**PRINTED BY THE AUTHORITY
OF THE STATE OF ILLINOIS**

INDEX OF SHEETS

SHEET NO	DESCRIPTION
1	COVER SHEET
2	SIGNATURE SHEET
3	INDEX OF SHEETS, HIGHWAY STANDARDS, GENERAL NOTES
4-5	SUMMARY OF QUANTITIES
6	INTERSECTION SCHEDULE
7	INTERSECTION OF IL 13 AND NEW ERA / OLD 13 TRAFFIC SIGNAL PLAN SHEET
8	INTERSECTION OF IL 13 AND NEW ERA / OLD 13 WIRING DIAGRAM
9	INTERSECTION OF IL 13 AND SYCAMORE ST / EMERALD LN TRAFFIC SIGNAL PLAN SHEET
10	INTERSECTION OF IL 13 AND SYCAMORE ST / EMERALD LN WIRING DIAGRAM
11	DETAIL SHEETS: HANDHOLE AND MAST ARM GROUNDING, CAB. FOR SERV. INSTALL. GROUND MOUNT AND CONC. FOUNDATIONS, GROUND MOUNT

HIGHWAY STANDARDS

- 000001-08 STANDARD SYMBOLS, ABBREVIATIONS AND PATTERNS
- 001006 DECIMAL OF AN INCH AND OF A FOOT
- 701001-02 OFF-ROAD OPERATIONS, 2L, 2W, MORE THAN 15 FT AWAY
- 701006-05 OFF-ROAD OPERATIONS, 2L, 2W, 15 FT TO 24 IN FROM PAVEMENT EDGE
- 701101-05 OFF-ROAD OPERATIONS, MULTILANE, 15 FT TO 24 IN FROM PAVEMENT EDGE
- 701106-02 OFF-ROAD OPERATIONS, MULTILANE, MORE THAN 15 FT AWAY
- 701601-09 URBAN LANE CLOSURE, MULTILANE, 1W OR 2W WITH NONTRAVERSABLE MEDIAN
- 701701-10 URBAN LANE CLOSURE, MULTILANE INTERSECTION
- 701801-06 SIDEWALK, CORNER OR CROSSWALK CLOSURE
- 701901-09 TRAFFIC CONTROL DEVICES
- 805001-01 ELECTRICAL SERVICE INSTALLATION DETAILS
- 857001-01 STANDARD PHASE DESIGNATION DIAGRAMS AND PHASE SEQUENCES
- 873001-02 TRAFFIC SIGNAL GROUNDING AND BONDING

GENERAL NOTES

THE CONTRACTOR SHALL NOTIFY THE ENGINEER OF TRAFFIC OPERATIONS 72 HOURS PRIOR TO THE SHUT-DOWN OR CUTTING OF EXISTING DETECTOR LOOPS.
 COMMITMENTS: NONE

REV. - MS

MODEL: Index [Sheet]
 FILE NAME: c:\p\work\pww\jacob.stark@illinois.gov\0962785\0978A60-SHB-Index_GenNotes.dgn

USER NAME = Jacob.Stark	DESIGNED -	REVISED -	STATE OF ILLINOIS DEPARTMENT OF TRANSPORTATION	INDEX OF SHEETS, HIGHWAY STANDARDS, GENERAL NOTES	F.A.P. RTE.	SECTION	COUNTY	TOTAL SHEETS	SHEET NO.	
PLOT SCALE = 0.16666633 / in.	DRAWN -	REVISED -			331	*	Jackson	11	3	
PLOT DATE = 2/7/2024	CHECKED -	REVISED -			CONTRACT NO. 78A60					
	DATE -	REVISED -			SCALE:	SHEET	OF 11 SHEETS	STA.	TO STA.	ILLINOIS FED. AID PROJECT

*D9 Traffic Signal 2024-2

SUMMARY OF QUANTITIES

COUNTY:	JACKSON CO
ROUTE:	FAP 331 (IL 13)
FUNDING:	100% STATE
LOCATION:	RURAL
TOTAL QUANTITY	ROADWAY 0021

CODE NUMBER	ITEM DESCRIPTION	UNIT	TOTAL QUANTITY	ROADWAY 0021
67100100	MOBILIZATION	L SUM	1	1
70102630	TRAFFIC CONTROL AND PROTECTION, STANDARD 701601	L SUM	1	1
70102635	TRAFFIC CONTROL AND PROTECTION, STANDARD 701701	L SUM	1	1
70102640	TRAFFIC CONTROL AND PROTECTION, STANDARD 701801	L SUM	1	1
70107025	CHANGEABLE MESSAGE SIGN	CAL DA	84	84
70200100	NIGHTTIME WORK ZONE LIGHTING	L SUM	1	1
80500010	SERVICE INSTALLATION - GROUND MOUNTED	EACH	2	2
80500100	SERVICE INSTALLATION, TYPE A	EACH	2	2
81028350	UNDERGROUND CONDUIT, PVC, 2" DIA.	FOOT	110	110
81702450	ELECTRIC CABLE IN CONDUIT, 600V (XLP-TYPE USE) 3-1/C NO. 10	FOOT	285	285
85700300	FULL-ACTUATED CONTROLLER AND TYPE V CABINET	EACH	2	2
87301815	ELECTRIC CABLE IN CONDUIT, SERVICE, NO. 6 3 C	FOOT	415	415
87301900	ELECTRIC CABLE IN CONDUIT, EQUIPMENT GROUNDING CONDUCTOR, NO. 6 1C	FOOT	1,045	1,045

MODEL: SOQ (Sheet)
FILE NAME: c:\p\work\project\jacob.stark@illinois.gov\0962782\0978A60-SHC-SOQ.dgn

USER NAME = Jacob.Stark PLOT SCALE = 0.16666633 1/In. PLOT DATE = 2/8/2024	DESIGNED - DRAWN - CHECKED - DATE -	REVISED - REVISED - REVISED - REVISED -	STATE OF ILLINOIS DEPARTMENT OF TRANSPORTATION	SUMMARY OF QUANTITIES	F.A.P. RTE. 331	SECTION *	COUNTY Jackson	TOTAL SHEETS 11	SHEET NO. 4
SCALE: SHEET OF 11 SHEETS STA. TO STA.				ILLINOIS FED. AID PROJECT CONTRACT NO. 78A60					

*D9 Traffic Signal 2024-2

SUMMARY OF QUANTITIES - CONT

COUNTY:	JACKSON CO
ROUTE:	FAP 331 (IL 13)
FUNDING:	100% STATE
LOCATION:	RURAL
TOTAL QUANTITY	ROADWAY 0021

CODE NUMBER	ITEM DESCRIPTION	UNIT	TOTAL QUANTITY	ROADWAY 0021
87900100	DRILL EXISTING FOUNDATION	EACH	1	1
88102717	PEDESTRIAN SIGNAL HEAD, LED, 1-FACE, BRACKET MOUNTED WITH COUNTDOWN TIMER	EACH	4	4
88102747	PEDESTRIAN SIGNAL HEAD, LED, 2-FACE, BRACKET MOUNTED WITH COUNTDOWN TIMER	EACH	3	3
89501250	RELOCATE EXISTING TRAFFIC SIGNAL EQUIPMENT	EACH	2	2
89502375	REMOVE EXISTING TRAFFIC SIGNAL EQUIPMENT	EACH	2	2
XP000179	GROUND ROD, 8', COPPER CLAD	EACH	8	8
X7340100	CONCRETE FOUNDATIONS, GROUND MOUNT	CU YD	0.5	0.5
X8760200	ACCESSIBLE PEDESTRIAN SIGNALS	EACH	10	10
X8891001	VIDEO VEHICLE DETECTION SYSTEM	EACH	2	2

MODEL: SQQ 2 [Sheet]
 FILE NAME: c:\p\work\pwr\jacob.stark@illinois.gov\0962782\0978A60-SHC-SQQ.dgn

REV. - MS

USER NAME = Jacob.Stark PLOT SCALE = 0.16666633 / in. PLOT DATE = 2/8/2024	DESIGNED - DRAWN - CHECKED - DATE -	REVISED - REVISED - REVISED - REVISED -	STATE OF ILLINOIS DEPARTMENT OF TRANSPORTATION	SUMMARY OF QUANTITIES	F.A.P. RTE. 331	SECTION *	COUNTY Jackson	TOTAL SHEETS 11	SHEET NO. 5
SCALE:				SHEET	OF 11	SHEETS	STA.	TO STA.	
ILLINOIS FED. AID PROJECT								CONTRACT NO. 78A60	

*D9 Traffic Signal 2024-2

INTERSECTION SCHEDULE

INTERSECTION LOCATION	SERV. INSTALL, TYPE A	SERV. INSTALL-GROUND MOUNTED	CONC. FOUND. GROUND MOUNT	ELEC. CABLE IN CONDUIT, 600V (XLP-TYPE USE) 3-1/C NO. 10	ELEC. CABLE IN CONDUIT, SERVICE, NO. 6 3 C	UNDERGROUND CONDUIT, PVC, 2" DIA.	DRILL EX. FOUND.	FULL-ACTUATED CONTROLLER AND TYPE V CABINET	RELOCATE EXISTING TRAFFIC SIGNAL EQUIPMENT	REMOVE EXISTING TRAFFIC SIGNAL EQUIPMENT	ELEC. CABLE IN CONDUIT EQUIP GROUNDING CONDUCTOR, NO. 6 1C	PED SIGNAL HEAD, LED, 1-FACE	PED SIGNAL HEAD, LED, 2-FACE	GROUND ROD, 8', COPPER CLAD	ACC. PED. SIGNALS	VIDEO VEHICLE DETECTION SYSTEM
	(EACH)	(EACH)	(CU YD)	(FOOT)	(FOOT)	(FOOT)	(EACH)	(EACH)	(EACH)	(EACH)	(FOOT)	(EACH)	(EACH)	(EACH)	(EACH)	(EACH)
IL 13 & NEW ERA/OLD 13				235	305						575					1
NORTH WEST														1		
NORTH EAST												1		1	1	
EAST MEDIAN													1		2	
SOUTH WEST		1	0.25					1	1	1				1		
SOUTH EAST	1											1		1	1	
IL 13 & SYCAMORE/EMERALD				50	110	110					470					1
NORTH WEST												1		1	1	
NORTH EAST													1	1	2	
SOUTH WEST	1	1	0.25				1	1	1	1		1		1	1	
SOUTH EAST													1	1	2	
TOTALS	2	2	0.50	285	415	110	1	2	2	2	1,045	4	3	8	10	2

REV. - MS

MODEL: Schedule (Sheet)
FILE NAME: c:\p\work\proj\iacob.stark@illinois.gov\0962782\0978A60-SHE-Schedules.dgn

USER NAME = Jacob.Stark	DESIGNED -	REVISED -	STATE OF ILLINOIS DEPARTMENT OF TRANSPORTATION	INTERSECTION SCHEDULE	F.A.P. RTE. 331	SECTION *	COUNTY Jackson	TOTAL SHEETS 11	SHEET NO. 6	
PLOT SCALE = 0.16666633 1/16"	DRAWN -	REVISED -			CONTRACT NO. 78A60					
PLOT DATE = 2/8/2024	CHECKED -	REVISED -			ILLINOIS FED. AID PROJECT					
	DATE -	REVISED -			SCALE: SHEET OF 11 SHEETS STA. TO STA.					

*D9 Traffic Signal 2024-2

LEGEND

- EX CONDUIT - SIZE, TYPE, AND LENGTH INDICATED
- ⊕ EXISTING MAST ARM MOUNTED SIGNAL FACE
- ⊖ EXISTING BRACKET MOUNTED SIGNAL FACE
- ⊙ EXISTING TRAFFIC SIGNAL POST
- ⊙ EXISTING MAST ARM ASSEMBLY & POLE
- ⊙ EXISTING LIGHT POLE AND LUMINAIRE
- ⊙ EXISTING MULTIMOUNT LUMINAIRE
- ⊙ EXISTING HANDHOLE
- EXISTING PEDESTRIAN PUSH-BUTTON POST
- ⊖ PROPOSED PEDESTRIAN SIGNAL HEAD, LED, 1-FACE, BRACKET MOUNTED WITH COUNTDOWN TIMER
- ⊖ PROPOSED PEDESTRIAN SIGNAL HEAD, LED, 2-FACE, BRACKET MOUNTED WITH COUNTDOWN TIMER
- PROPOSED ELECTRIC CABLE IN CONDUIT, EQUIPMENT GROUNDING CONDUCTOR, NO. 6 1C
- ⊙ APS
- ⊙ PROPOSED ACCESSIBLE PEDESTRIAN SIGNALS
- ⊙ PROPOSED VIDEO DETECTION UNIT
- ⊙ PROPOSED HYBRID VIDEO/RADAR DETECTION UNIT
- ⊙ PROPOSED FULL-ACTUATED CONTROLLER AND TYPE V CABINET
- G PROPOSED GROUND ROD, 8', COPPER CLAD (IN HANDHOLE)
- ⊙ PROPOSED SERVICE INSTALLATION - GROUND MOUNTED

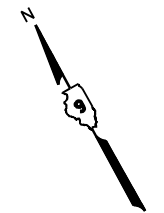

RELOCATE EXISTING TRAFFIC SIGNAL EQUIPMENT

THE FOLLOWING EXISTING TRAFFIC SIGNAL EQUIPMENT SHALL BE REMOVED BY THE CONTRACTOR AND RELOCATED TO THE PROPOSED TRAFFIC SIGNAL CONTROLLER AND CABINET. THIS WORK SHALL BE PAID FOR UNDER "RELOCATE EXISTING TRAFFIC SIGNAL EQUIPMENT".

1 EACH UNINTERRUPTABLE POWER SUPPLY AND CABINET

NOTES:

- CONTRACTOR SHALL VERIFY PROPER CAMERA PLACEMENT PRIOR TO INSTALLATION.
- GROUND MOUNT SERVICE CABINET SHALL BE PLACED IN LINE WITH EXISTING SERVICE CONDUIT IN ORDER TO INTERCEPT EXISTING CONDUIT. LOCATING EXISTING SERVICE CONDUIT SHALL BE INCLUDED IN THE COST OF "SERVICE INSTALLATION - GROUND MOUNTED"

REMOVAL OF EXISTING TRAFFIC SIGNAL EQUIPMENT

THE FOLLOWING EXISTING TRAFFIC SIGNAL EQUIPMENT SHALL BE REMOVED BY THE CONTRACTOR AND SHALL BE DISPOSED OF BY THEM OUTSIDE THE RIGHT-OF-WAY AT THEIR OWN EXPENSE. THE SALVAGE VALUE OF THE REMOVED EQUIPMENT SHALL BE REFLECTED IN THE CONTRACT BID PRICE.

4	EACH	PEDESTRIAN PUSH BUTTON
2	EACH	PEDESTRIAN SIGNAL HEAD, 1 FACE
1	EACH	PEDESTRIAN SIGNAL HEAD, 2 FACE
1	EACH	CONTROLLER AND CABINET

THE FOLLOWING CABLE SHALL BE RAN IN THE EXISTING CONDUIT:
 ELECTRIC CABLE IN CONDUIT, 600V (XLP-TYPE USE) 3-1/C NO. 10
 ELECTRIC CABLE IN CONDUIT, SERVICE, NO. 6 3C

THE FOLLOWING CABLE SHALL BE RAN IN THE EXISTING CONDUIT:
 ELECTRIC CABLE IN CONDUIT, SERVICE, NO. 6 3C

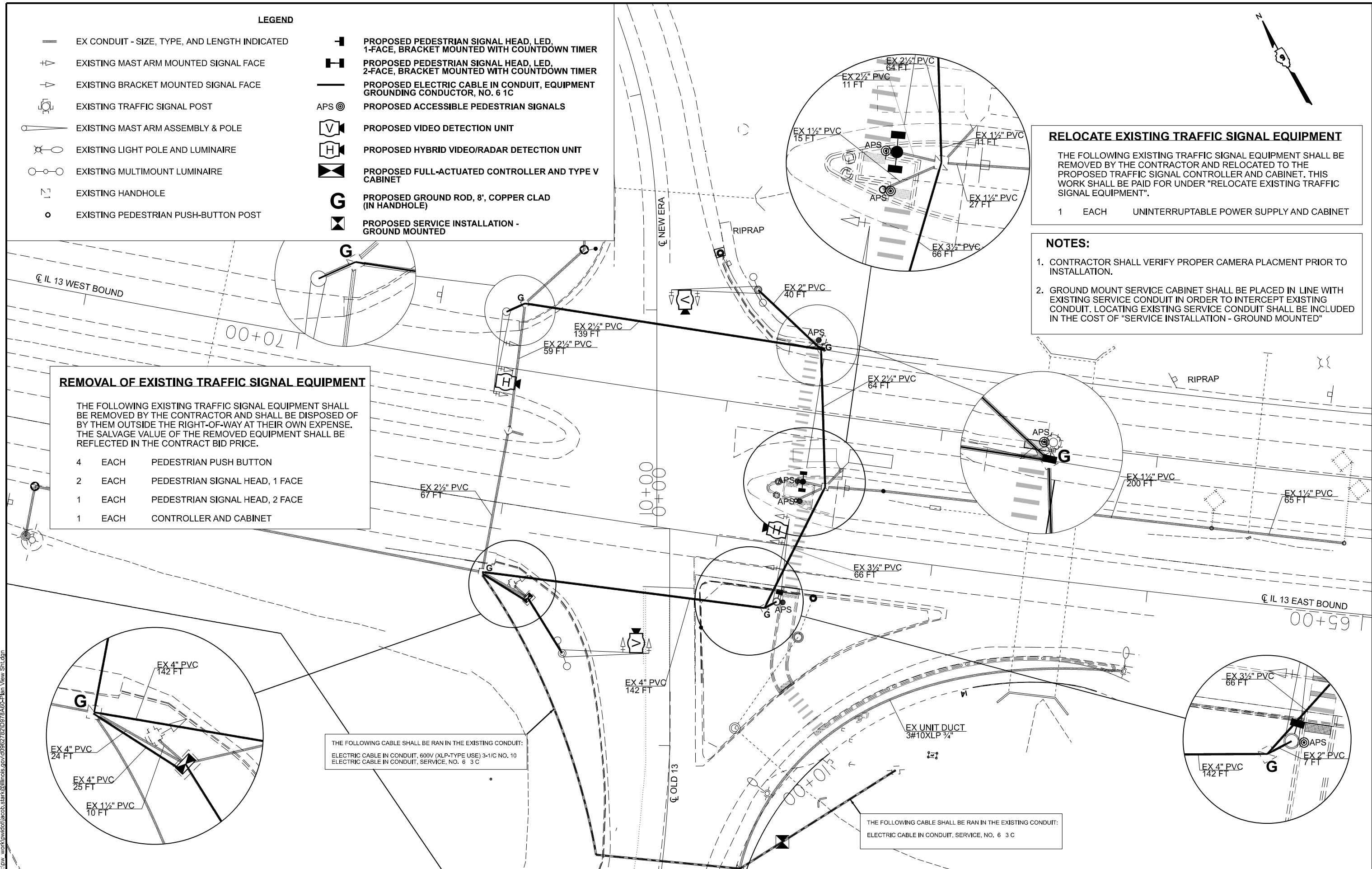

MODEL: New Era Plan View (Sheet)
 FILE NAME: c:\p\work\newera\plan\newera_plan_view_sht.dgn

USER NAME = Jacob.Stark	DESIGNED -	REVISED -
PLOT SCALE = 0.16666833' / in.	DRAWN -	REVISED -
PLOT DATE = 2/8/2024	CHECKED -	REVISED -
	DATE -	REVISED -











**STATE OF ILLINOIS
 DEPARTMENT OF TRANSPORTATION**

**INTERSECTION OF IL 13 AND NEW ERA / OLD 13
 TRAFFIC SIGNAL PLAN SHEET**

SCALE: SHEET OF 11 SHEETS STA. TO STA.

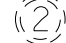
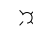
F.A.P. RTE. 331	SECTION *	COUNTY Jackson	TOTAL SHEETS 11	SHEET NO. 7
CONTRACT NO. 78A60				

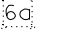
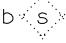
LEGEND

- APS  PROPOSED ACCESSIBLE PEDESTRIAN SIGNALS
-  PROPOSED PEDESTRIAN SIGNAL HEAD, LED,
-  PROPOSED FULL-ACTUATED CONTROLLER AND TYPE V CABINET
- PROPOSED ELECTRIC CALBE IN CONDUIT, EQUIPMENT GROUNDING CONDUCTOR, NO. 6 1C
-  PROPOSED VIDEO DETECTION UNIT
-  PROPOSED HYBRID VIDEO/RADAR DETECTION UNIT
-  ^{GM} PROPOSED SERVICE INSTALLATION - GROUND MOUNTED
-  INDICATES 2/C TWISTED, SHIELDED CABLE IN CONDUIT.
- (4) NUMBER IN PARENTHESIS INDICATES PHASE
- (5) NUMBER IN CIRCLE INDICATES NUMBER OF CONDUCTORS IN THAT CABLE
-  EXIST. LUMINAIRE
-  EXIST. SIGNAL POLE
-  INDICATES 6'X6' LOOP WITH 2" CORE DRILLED CORNERS: NUMBER INDICATES PHASE, LOWER CASE LETTER INDICATES AMPLIFIER.
-  6b  INDICATES 5'X5' LOOP WITH 2" CORE DRILLED CORNERS: NUMBER INDICATES PHASE, LOWER CASE LETTER INDICATES AMPLIFIER, "S" INDICATES SYSTEM LOOP.
- MA MA MAST ARM
- HH HH HANDHOLE

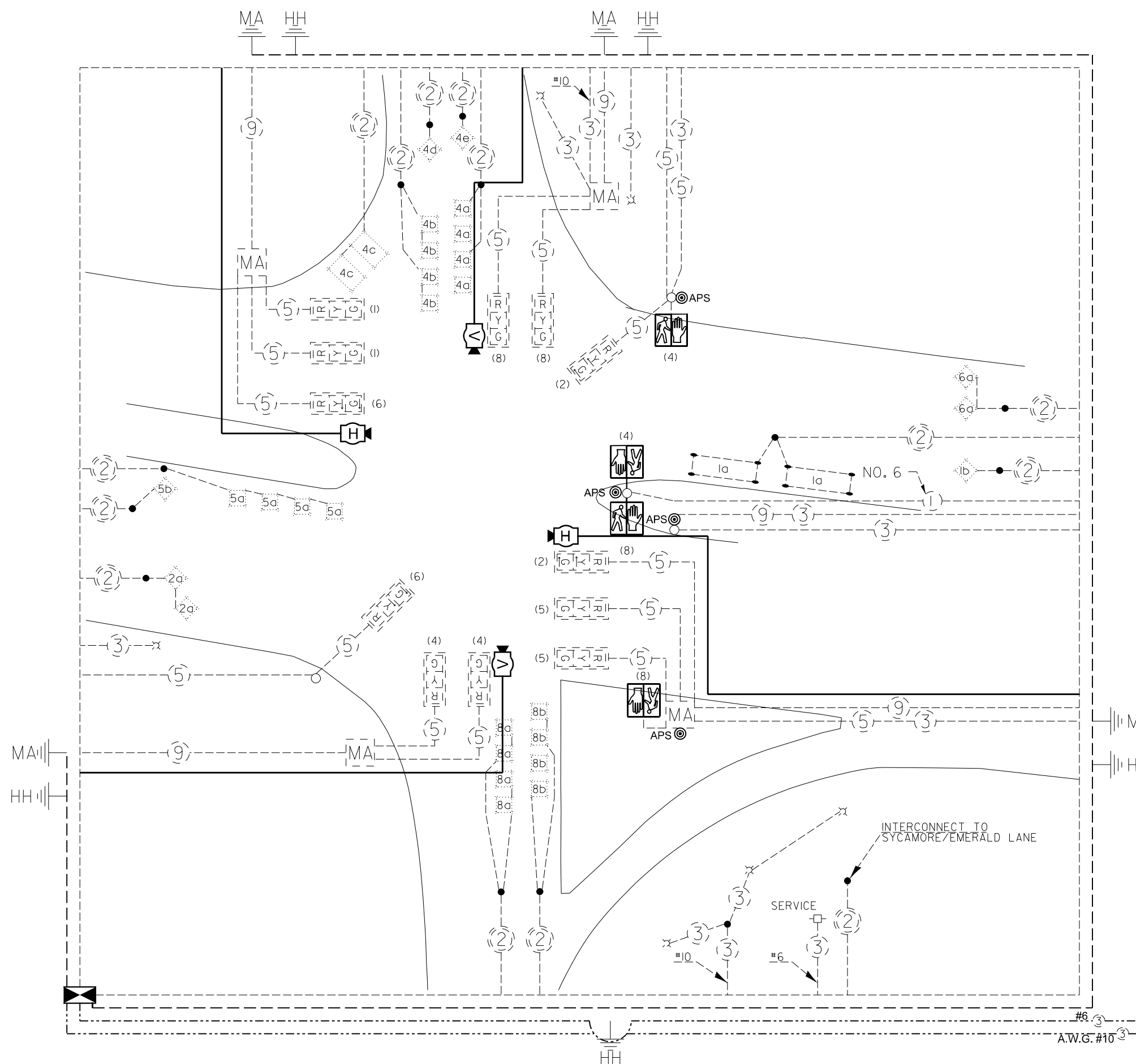

MODEL: New Era Traffic Signal Layout (Sheet)
 FILE NAME: c:\p\work\wired\jacob.stark@illinois.gov\d978a60-Plan_View_Sht.dgn

USER NAME = Jacob.Stark	DESIGNED -	REVISED -
DRAWN -	REVISOR -	
PLOT SCALE = 0.16666633' / in.	CHECKED -	REVISOR -
PLOT DATE = 2/7/2024	DATE -	REVISOR -

**STATE OF ILLINOIS
DEPARTMENT OF TRANSPORTATION**

**INTERSECTION OF IL 13 AND NEW ERA / OLD 13
WIRING DIAGRAM**

F.A.P. RTE. 331	SECTION *	COUNTY Jackson	TOTAL SHEETS 11	SHEET NO. 8
CONTRACT NO. 78A60				
ILLINOIS FED. AID PROJECT				

SCALE: SHEET OF 11 SHEETS STA. TO STA.

*D9 Traffic Signal 2024-2

LEGEND

- EX CONDUIT - SIZE, TYPE, AND LENGTH INDICATED
- ⤴ EXISTING MAST ARM MOUNTED SIGNAL FACE
- ⤴ EXISTING BRACKET MOUNTED SIGNAL FACE
- ⊕ EXISTING TRAFFIC SIGNAL POST
- ⤴ EXISTING MAST ARM ASSEMBLY & POLE
- ⊕ EXISTING LIGHT POLE AND LUMINAIRE
- ⊕ EXISTING MULTIMOUNT LUMINAIRE
- ⤴ EXISTING HANDHOLE
- EXISTING PEDESTRIAN PUSH-BUTTON POST
- ⤴ PROPOSED PEDESTRIAN SIGNAL HEAD, LED, 1-FACE, BRACKET MOUNTED WITH COUNTDOWN TIMER
- ⤴ PROPOSED PEDESTRIAN SIGNAL HEAD, LED, 2-FACE, BRACKET MOUNTED WITH COUNTDOWN TIMER
- PROPOSED ELECTRIC CABLE IN CONDUIT, EQUIPMENT GROUNDING CONDUCTOR, NO. 6 1C
- ⊕ APS ⊕ PROPOSED ACCESSIBLE PEDESTRIAN SIGNALS
- ⊕ V ⊕ PROPOSED VIDEO DETECTION UNIT
- ⊕ H ⊕ PROPOSED HYBRID VIDEO/RADAR DETECTION UNIT
- ⊕ ⊕ PROPOSED FULL-ACTUATED CONTROLLER AND TYPE V CABINET
- ⊕ G PROPOSED GROUND ROD, 8', COPPER CLAD (IN HANDHOLE)
- ⊕ ⊕ PROPOSED SERVICE INSTALLATION - GROUND MOUNTED

NOTES:
 1. CONTRACTOR SHALL VERIFY PROPER CAMERA PLACEMENT PRIOR TO INSTALLATION.

REMOVAL OF EXISTING TRAFFIC SIGNAL EQUIPMENT

THE FOLLOWING EXISTING TRAFFIC SIGNAL EQUIPMENT SHALL BE REMOVED BY THE CONTRACTOR AND SHALL BE DISPOSED OF BY THEM OUTSIDE THE RIGHT-OF-WAY AT THEIR OWN EXPENSE. THE SALVAGE VALUE OF THE REMOVED EQUIPMENT SHALL BE REFLECTED IN THE CONTRACT BID PRICE.

- 6 EACH PEDESTRIAN PUSH BUTTON
- 2 EACH PEDESTRIAN SIGNAL HEAD, 1 FACE
- 2 EACH PEDESTRIAN SIGNAL HEAD, 2 FACE
- 1 EACH *CONTROLLER AND CABINET

*THE EXISTING BATTERY BACKUPS SHALL BE REMOVED AND INSTALLED ON THE NEW CABINET AND SHALL BE INCLUDED IN THE COST OF FULL-ACTUATED CONTROLLER AND TYPE V CABINET.

RELOCATE EXISTING TRAFFIC SIGNAL EQUIPMENT

THE FOLLOWING EXISTING TRAFFIC SIGNAL EQUIPMENT SHALL BE REMOVED BY THE CONTRACTOR AND RELOCATED TO THE PROPOSED TRAFFIC SIGNAL CONTROLLER AND CABINET. THIS WORK SHALL BE PAID FOR UNDER "RELOCATE EXISTING TRAFFIC SIGNAL EQUIPMENT".

- 1 EACH UNINTERRUPTABLE POWER SUPPLY AND CABINET

THE FOLLOWING CABLE SHALL BE RAN IN THE PROPOSED UNDERGROUND CONDUIT, PVC, 2" DIA:
 ELECTRIC CABLE IN CONDUIT, 600V (XLP-TYPE USE) 3-1/C NO. 10
 ELECTRIC CABLE IN CONDUIT, SERVICE, NO. 6 3 C

THE FOLLOWING CABLE SHALL BE RAN IN THE PROPOSED UNDERGROUND CONDUIT, PVC, 2" DIA:
 ELECTRIC CABLE IN CONDUIT, SERVICE, NO. 6 3 C

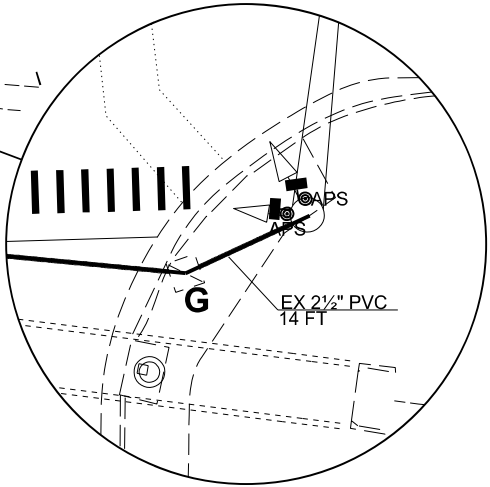
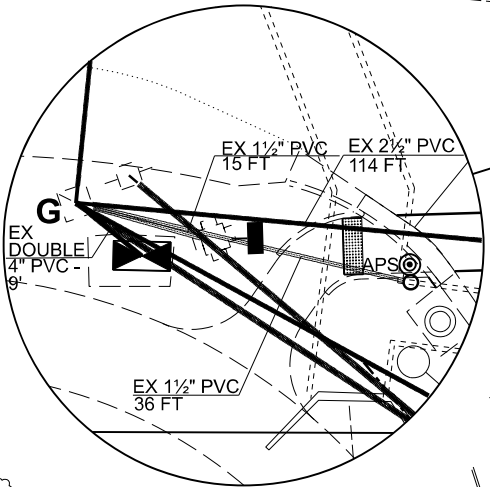

MODEL: Sycamore Plan View (Sheet)
 FILE NAME: c:\p\work\78060\plan_view\sh1.dgn

USER NAME = Jacob.Stark	DESIGNED -	REVISED -
PLOT SCALE = 0.16666633' / in.	DRAWN -	REVISED -
PLOT DATE = 2/8/2024	CHECKED -	REVISED -
	DATE -	REVISED -

**STATE OF ILLINOIS
 DEPARTMENT OF TRANSPORTATION**

**INTERSECTION OF IL 13 AND SYCAMORE ST / EMERALD LN
 TRAFFIC SIGNAL PLAN SHEET**

SCALE: SHEET OF 11 SHEETS STA. TO STA.

F.A.P. RTE. 331	SECTION *	COUNTY Jackson	TOTAL SHEETS 11	SHEET NO. 9
CONTRACT NO. 78A60				
ILLINOIS FED. AID PROJECT				

*D9 Traffic Signal 2024-2

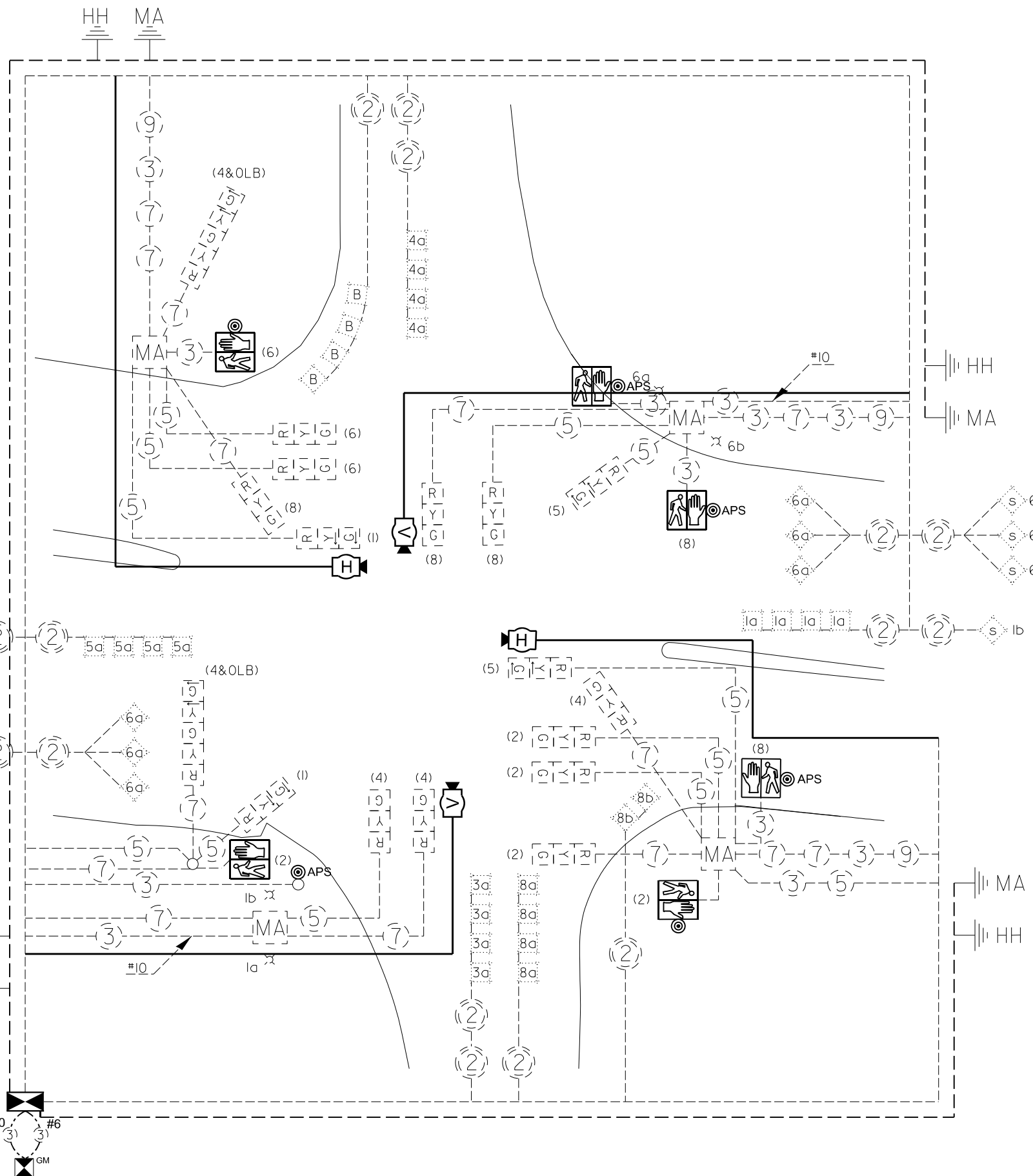

LEGEND

- APS PROPOSED ACCESSIBLE PEDESTRIAN SIGNALS
- PROPOSED PEDESTRIAN SIGNAL HEAD, LED,
- PROPOSED FULL-ACTUATED CONTROLLER AND TYPE V CABINET
- PROPOSED ELECTRIC CALBE IN CONDUIT, EQUIPMENT GROUNDING CONDUCTOR, NO. 6 1C
- PROPOSED VIDEO DETECTION UNIT
- PROPOSED HYBRID VIDEO/RADAR DETECTION UNIT
- PROPOSED SERVICE INSTALLATION - GROUND MOUNTED
- INDICATES 2/C TWISTED, SHIELDED CABLE IN CONDUIT.
- (4) NUMBER IN PARENTHESIS INDICATES PHASE
- (5) NUMBER IN CIRCLE INDICATES NUMBER OF CONDUCTORS IN THAT CABLE
- EXIST. LUMINAIRE
- EXIST. SIGNAL POLE
- INDICATES 6'X6' LOOP WITH 2" CORE DRILLED CORNERS: NUMBER INDICATES PHASE, LOWER CASE LETTER INDICATES AMPLIFIER.
- INDICATES 5'X5' LOOP WITH 2" CORE DRILLED CORNERS: NUMBER INDICATES PHASE, LOWER CASE LETTER INDICATES AMPLIFIER, "S" INDICATES SYSTEM LOOP.
- MA MAST ARM
- HH HANDHOLE

MODEL: Sycamore Traffic Signal Layout (Sheet)
 FILE NAME: c:\pwworking\jacob.stark@illinois.gov\d0962782\0978A60-Plan_View_Sht.dgn

USER NAME = Jacob.Stark	DESIGNED -	REVISED -
DRAWN -	REVISOR -	REVISION -
PLOT SCALE = 0.16666833' / in.	CHECKED -	REVISOR -
PLOT DATE = 2/7/2024	DATE -	REVISION -

**STATE OF ILLINOIS
DEPARTMENT OF TRANSPORTATION**

INTERSECTION OF IL 13 AND SYCAMORE ST / EMERALD LN			
WIRING DIAGRAM			
SCALE:	SHEET	OF 11 SHEETS	STA. TO STA.

F.A.P. RTE.	SECTION	COUNTY	TOTAL SHEETS	SHEET NO.
331	*	Jackson	11	10
CONTRACT NO. 78A60				
ILLINOIS FED. AID PROJECT				

*D9 Traffic Signal 2024-2

HANDHOLE AND MAST ARM GROUNDING

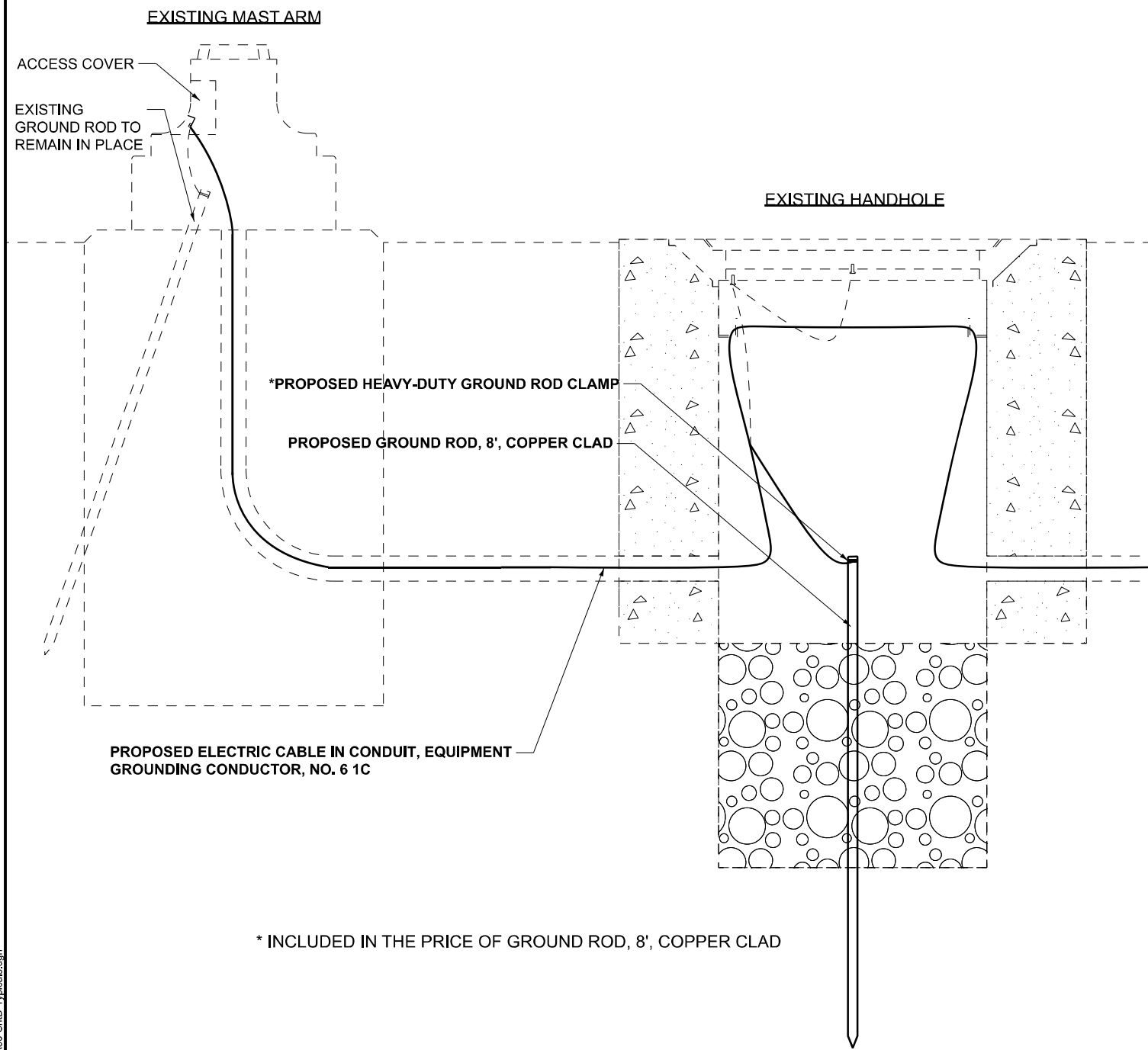

* INCLUDED IN THE PRICE OF GROUND ROD, 8', COPPER CLAD

CABINET FOR SERVICE INSTALLATION GROUND MOUNT AND CONCRETE FOUNDATIONS, GROUND MOUNT

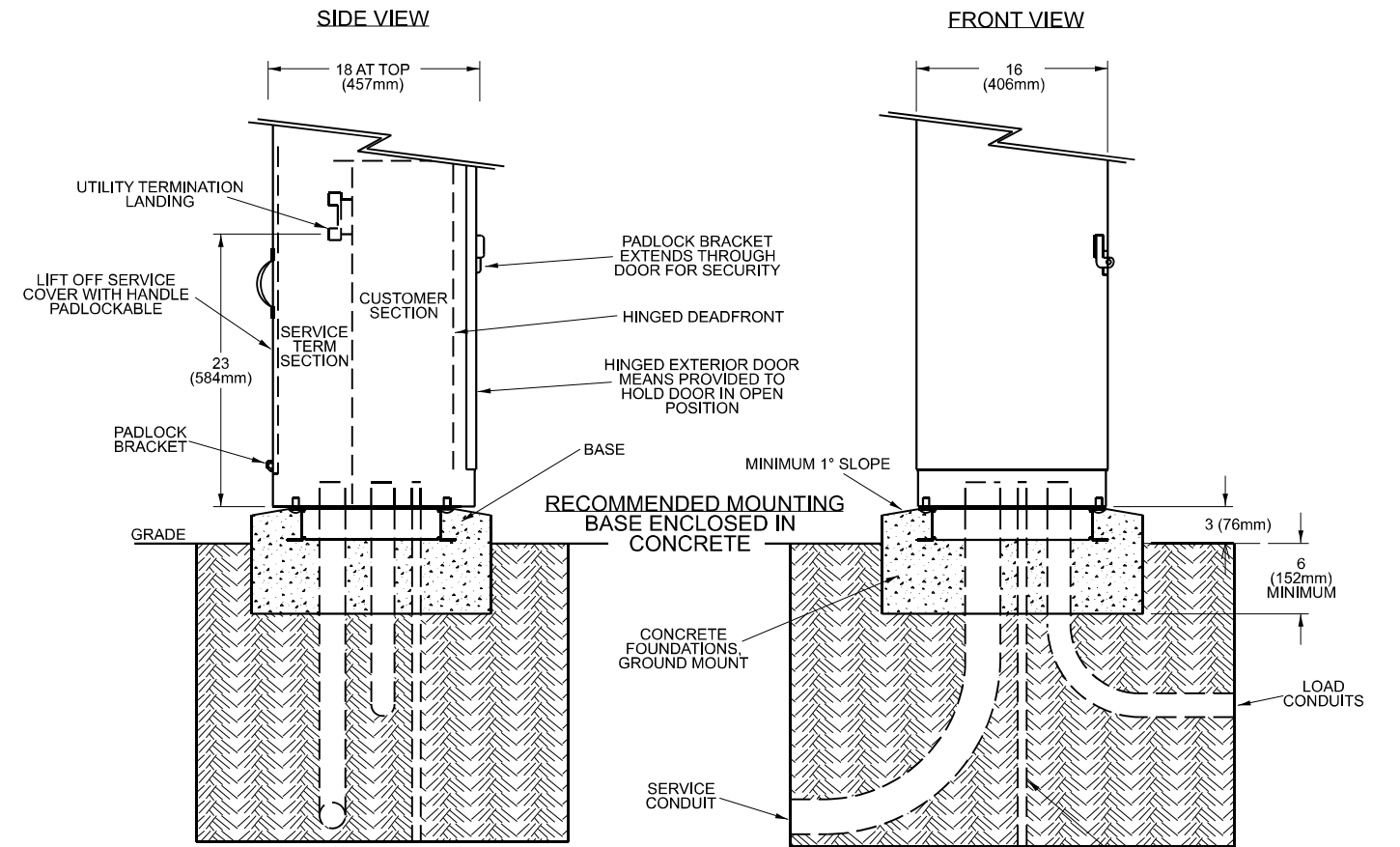

MOUNTING BASE DETAIL (TOP VIEW)

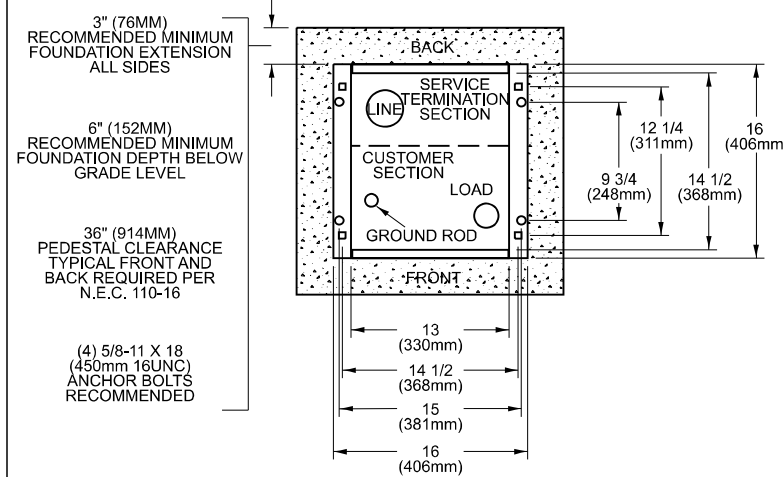

- PEDESTAL MOUNTING HOLES
- ANCHOR BOLT MOUNTING HOLES

OPTIONAL MOUNTING NO BASE, MOUNT DIRECTLY ON FOUNDATION

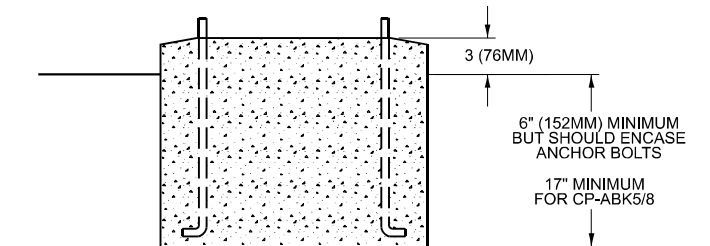

REVISIONS	
DRAWN	03-02-22
REVISION	
REVISION	
REVISION	

STD. 9-51

MODEL: Typical Hand hole grounding (Sheet)
FILE NAME: c:\p\work\wrt\jacob.stark@illinois.gov\0962782\0978A60-SHD-Typical.dgn

USER NAME = Jacob.Stark	DESIGNED -	REVISED -
PLOT SCALE = 0.16666833 / in.	DRAWN -	REVISED -
PLOT DATE = 2/6/2024	CHECKED -	REVISED -
	DATE -	REVISED -

STATE OF ILLINOIS
DEPARTMENT OF TRANSPORTATION

DETAIL SHEETS: HANDHOLE AND MAST ARM GROUNDING, CAB. FOR SERV.
INSTALL. GROUND MOUNT AND CONC. FOUNDATIONS, GROUND MOUNT

SCALE: SHEET OF 11 SHEETS STA. TO STA.

F.A.P. RTE.	SECTION	COUNTY	TOTAL SHEETS	SHEET NO.
331	*	Jackson	11	11
CONTRACT NO. 78A60				

ILLINOIS FED. AID PROJECT
*D9 Traffic Signal 2024-2