

F.A. RTE.	SECTION	COUNTY	TOTAL SHEETS	SHEET NO.
	PARK ROADS	LAKE	26	15

STA. TO STA.
 FED. ROAD DIST. NO. ILLINOIS FED. AID PROJECT
 IDNR PROJECT NO. 2-06-003

DATE	BY	BY
DATE	BY	BY
DATE	BY	BY

DATE	BY	BY
DATE	BY	BY
DATE	BY	BY

PLOT DATE = 10/15/14
 FILE NAME = 173.DWG
 PLOT SCALE = 1"=40'
 USER NAME = JUBER

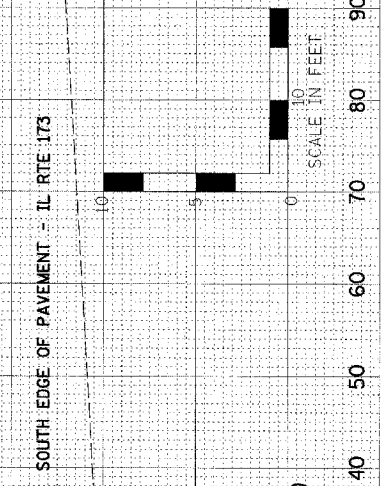
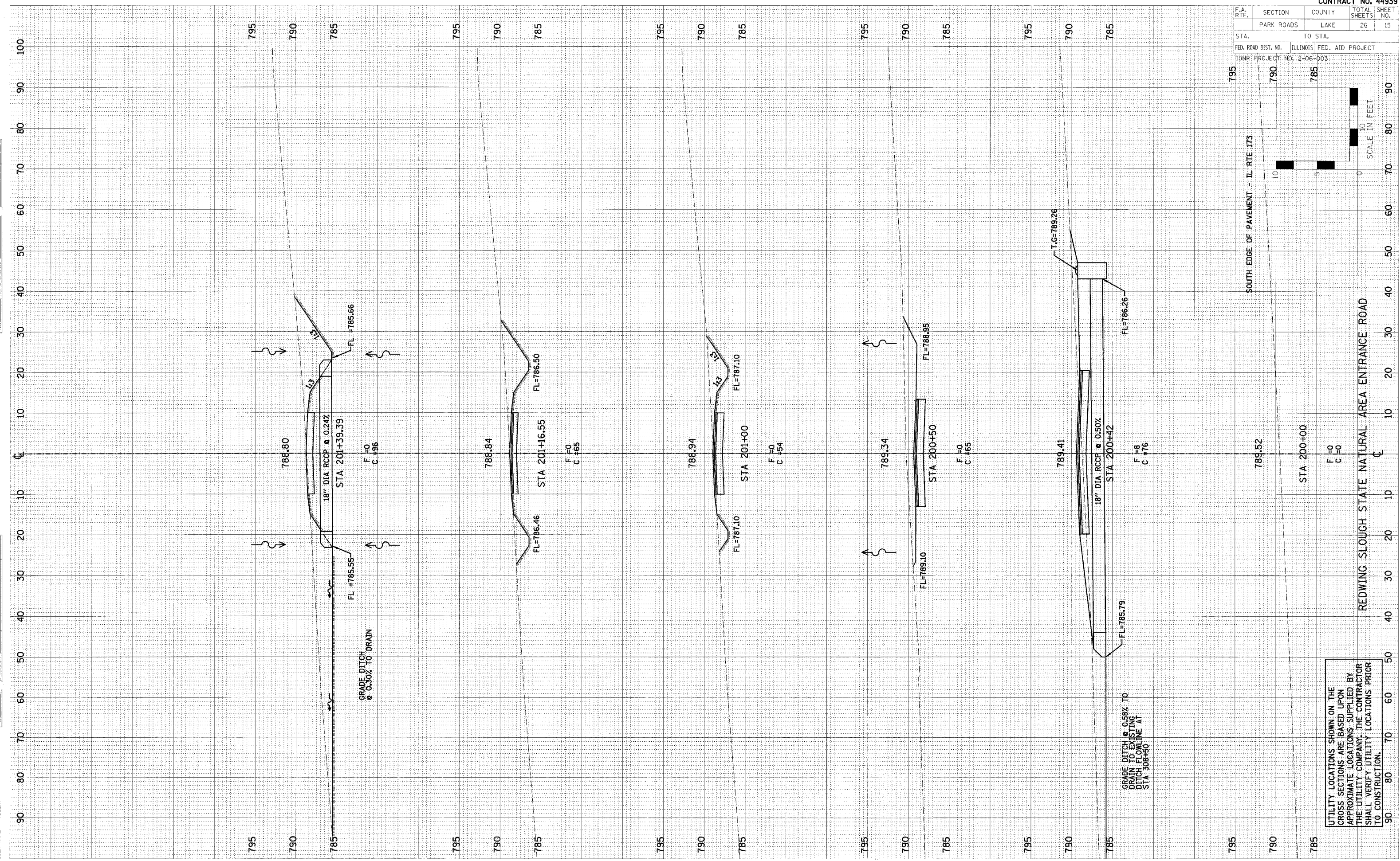

UTILITY LOCATIONS SHOWN ON THE CROSS SECTIONS ARE BASED UPON APPROXIMATE LOCATIONS SUPPLIED BY THE UTILITY COMPANY. THE CONTRACTOR SHALL VERIFY UTILITY LOCATIONS PRIOR TO CONSTRUCTION.

REDWING SLOUGH STATE NATURAL AREA ENTRANCE ROAD