

F.A.U. RTE.	SECTION	COUNTY	TOTAL SHEETS	SHEET NO.
2742	2005-061 RS	COOK	28	7
STA.		TO STA.		
FED. ROAD DIST. NO.		ILLINOIS FED. AID PROJECT		

D-91-066-06

5TH AVENUE

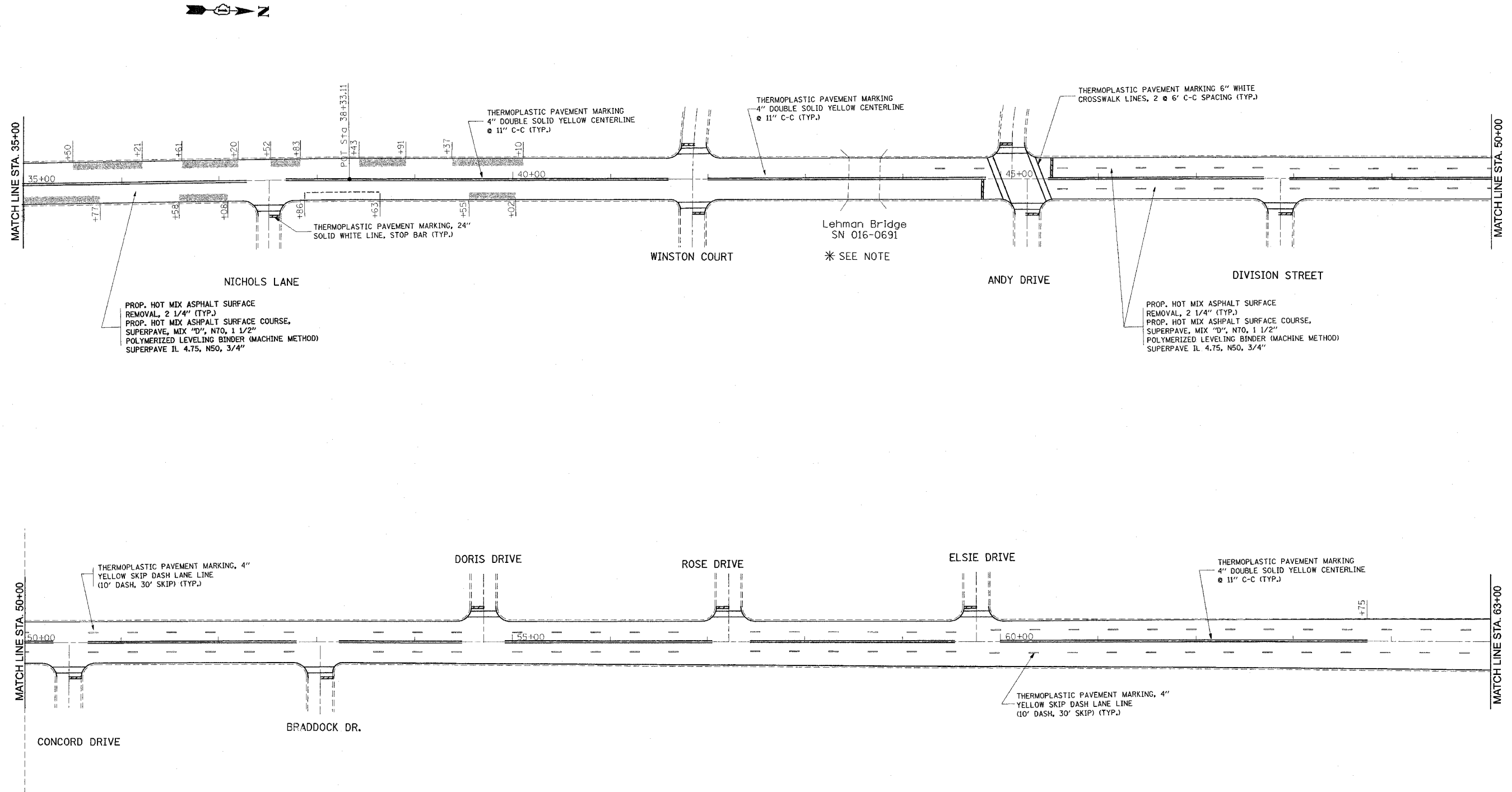

PROP. HOT MIX ASPHALT SURFACE
REMOVAL, 2 1/4" (TYP.)
PROP. HOT MIX ASPHALT SURFACE COURSE,
SUPERPAVE, MIX "D", N70, 1 1/2"
POLYMERIZED LEVELING BINDER (MACHINE METHOD)
SUPERPAVE IL 4.75, N50, 3/4"

PROP. HOT MIX ASPHALT SURFACE
REMOVAL, 2 1/4" (TYP.)
PROP. HOT MIX ASPHALT SURFACE COURSE,
SUPERPAVE, MIX "D", N70, 1 1/2"
POLYMERIZED LEVELING BINDER (MACHINE METHOD)
SUPERPAVE IL 4.75, N50, 3/4"

*NOTE
CONTRACTOR SHALL PROVIDE 2 1/4"
SAW CUT AT THE TRANSVERSE BRIDGE JOINTS

LIMIT OF RESURFACING SHALL BE TO
THE RADIUS OF RETURN ON
ALL SIDE STREETS OR AS
DIRECTED BY THE ENGINEER.

REVISIONS	
NAME	DATE

ILLINOIS DEPARTMENT OF TRANSPORTATION

5TH AVENUE
PAVEMENT MARKING/ROADWAY PLANS

SCALE: VERT. _____
HORIZ. _____
DATE _____ DRAWN BY _____
CHECKED BY _____

PLOT DATE = 12/21/2006
FILE NAME = c:\projects\dlb6686\design\as.dgn
PLOT SCALE = 50:333 / IN.
USER NAME = bmkal