

F.A.P. RTE.	SECTION	COUNTY	TOTAL SHEETS	SHEET NO.
525 (11 & 12)	RS-10	McHENRY	22	7
STA. 04 + 41		TO STA. 30 + 00		
FED. ROAD DIST. NO. 1 ILLINOIS FED. AID PROJECT				

CONTRACT NO.: 60863

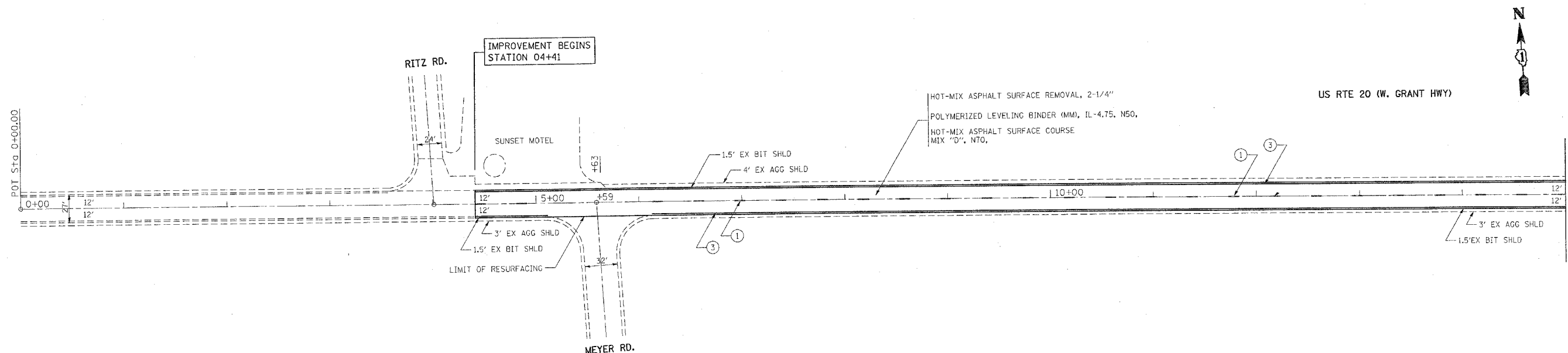

PAVEMENT MARKING LEGEND

- | | |
|---|---|
| ① THERMOPLASTIC PAVEMENT MARKING
SKIP-DASH LINE, 4" YELLOW | ⑦ THERMOPLASTIC PAVEMENT MARKING
12" SOLID YELLOW (RT. 45° DIAGONALS @ 20' C-C) |
| ② THERMOPLASTIC PAVEMENT MARKING
MEDIAN EDGE LINE, 4" SOLID YELLOW | ⑧ THERMOPLASTIC PAVEMENT MARKING
24" SOLID WHITE STOP BAR |
| ③ THERMOPLASTIC PAVEMENT MARKING
EDGE LINE, 4" SOLID WHITE | ⑨ THERMOPLASTIC PAVEMENT MARKING
LEFT AND RIGHT TURN ONLY
LETTERS AND SYMBOLS, 8" WHITE |
| ④ THERMOPLASTIC PAVEMENT MARKING
DOTTED LANE LINE, 6" WHITE | ⑩ THERMOPLASTIC PAVEMENT MARKING
CROSS WALK (SCHOOL), 6' (12" @ 90°)
SOLID WHITE |
| ⑤ THERMOPLASTIC PAVEMENT MARKING
LANE LINE, 6" WHITE | ⑪ THERMOPLASTIC PAVEMENT MARKING
MEDIAN EDGE LINE, 4" SOLID YELLOW (DOUBLE) |
| ⑥ THERMOPLASTIC PAVEMENT MARKING
CROSS WALK, 6" SOLID WHITE, 2 @ 6' C-C
AND 4' IN ADVANCE OF STOP BAR | |

PAVEMENT MARKING NOTES

- FOR PAVEMENT MARKING DETAILS, SEE SPECIAL DETAIL SHEET FOR "DISTRICT ONE TYPICAL PAVEMENT MARKINGS".
- FOR DETAILS AND SYMBOLS OF RAISED REFLECTIVE PAVEMENT MARKERS, SEE SPECIAL DETAIL FOR "TYPICAL APPLICATION OF DUAL DIRECTIONAL SNOW PLOWABLE RAISED PAVEMENT MARKERS".

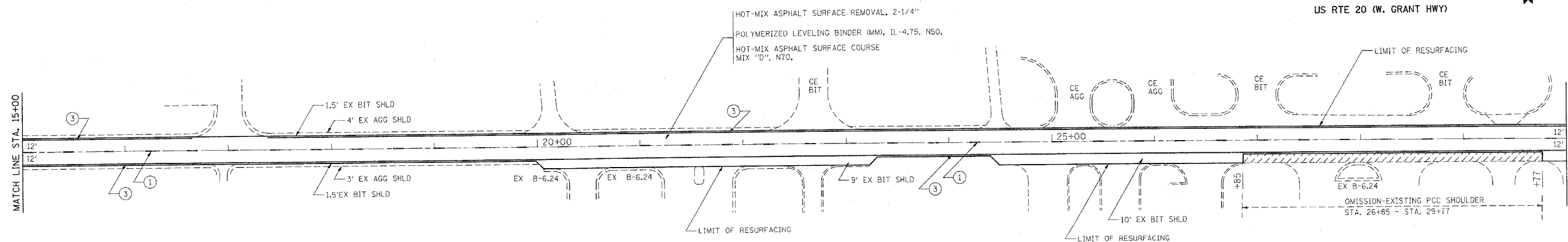

REVISIONS	
NAME	DATE

ILLINOIS DEPARTMENT OF TRANSPORTATION
**FAP 525: US 20 (GRANT HIGHWAY)
MEYER ROAD TO WEST UNION ROAD**
**EXISTING AND PROPOSED
ROADWAY AND PAVEMENT MARKING PLAN**

SCALE: VERT.
HORIZ.
DATE

DRAWN BY
CHECKED BY