

F.A.P. RTE.	SECTION	COUNTY	TOTAL SHEETS	SHEET NO.
525 (11 & 12)	RS-10	McHENRY	22	12
STA. 150 + 00		TO STA. 172 + 30		
FED. ROAD DIST. NO. 1 ILLINOIS FED. AID PROJECT				
CONTRACT NO.: 60B63				

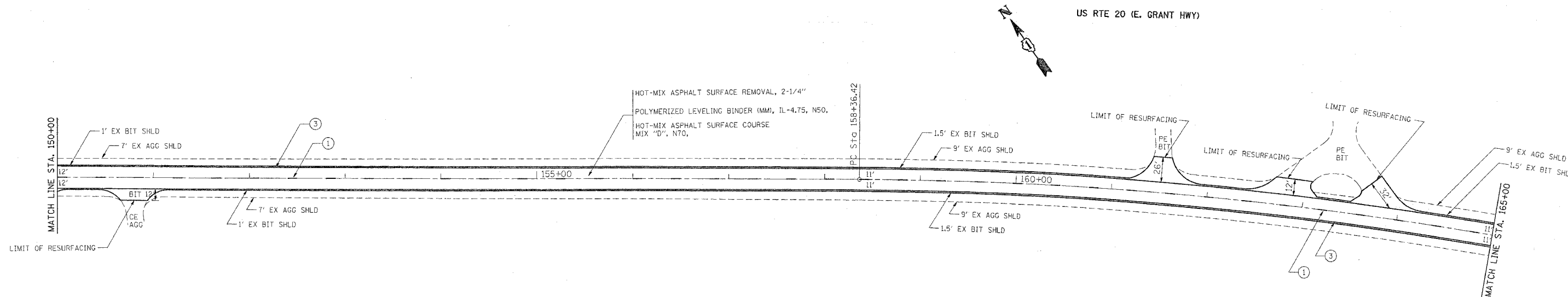

EXIST. CURVE E.US20-4
 PI STA. = 167+02.99
 $\Delta = 23^\circ 54' 36''$ (RT)
 $D = 1^\circ 24' 00''$
 $R = 4,092.66'$
 $T = 866.57'$
 $L = 1,707.91'$
 $E = 90.74'$
 $\theta = \dots$
 T.R. = \dots
 S.E. RUN = \dots
 P.C. STA. = 158+36.42
 P.T. STA. = 175+44.33

PAVEMENT MARKING LEGEND

- | | |
|---|---|
| ① THERMOPLASTIC PAVEMENT MARKING SKIP-DASH LINE, 4" YELLOW | ⑦ THERMOPLASTIC PAVEMENT MARKING 12" SOLID YELLOW (RT, 45° DIAGONALS @ 20' C-C) |
| ② THERMOPLASTIC PAVEMENT MARKING MEDIAN EDGE LINE, 4" SOLID YELLOW | ⑧ THERMOPLASTIC PAVEMENT MARKING 24" SOLID WHITE STOP BAR |
| ③ THERMOPLASTIC PAVEMENT MARKING EDGE LINE, 4" SOLID WHITE | ⑨ THERMOPLASTIC PAVEMENT MARKING LEFT AND RIGHT TURN ONLY LETTERS AND SYMBOLS, 8" WHITE |
| ④ THERMOPLASTIC PAVEMENT MARKING DOTTED LANE LINE, 6" WHITE | ⑩ THERMOPLASTIC PAVEMENT MARKING CROSS WALK (SCHOOL), 6" (12" @ 90°) SOLID WHITE |
| ⑤ THERMOPLASTIC PAVEMENT MARKING LANE LINE, 6" WHITE | ⑪ THERMOPLASTIC PAVEMENT MARKING MEDIAN EDGE LINE, 4" SOLID YELLOW (DOUBLE) |
| ⑥ THERMOPLASTIC PAVEMENT MARKING CROSS WALK, 6" SOLID WHITE, 2 @ 6' C-C AND 4' IN ADVANCE OF STOP BAR | |

PAVEMENT MARKING NOTES

- FOR PAVEMENT MARKING DETAILS, SEE SPECIAL DETAIL SHEET FOR "DISTRICT ONE TYPICAL PAVEMENT MARKINGS".
- FOR DETAILS AND SYMBOLS OF RAISED REFLECTIVE PAVEMENT MARKERS, SEE SPECIAL DETAIL FOR "TYPICAL APPLICATION OF DUAL DIRECTIONAL SNOW PLOWABLE RAISED PAVEMENT MARKERS".

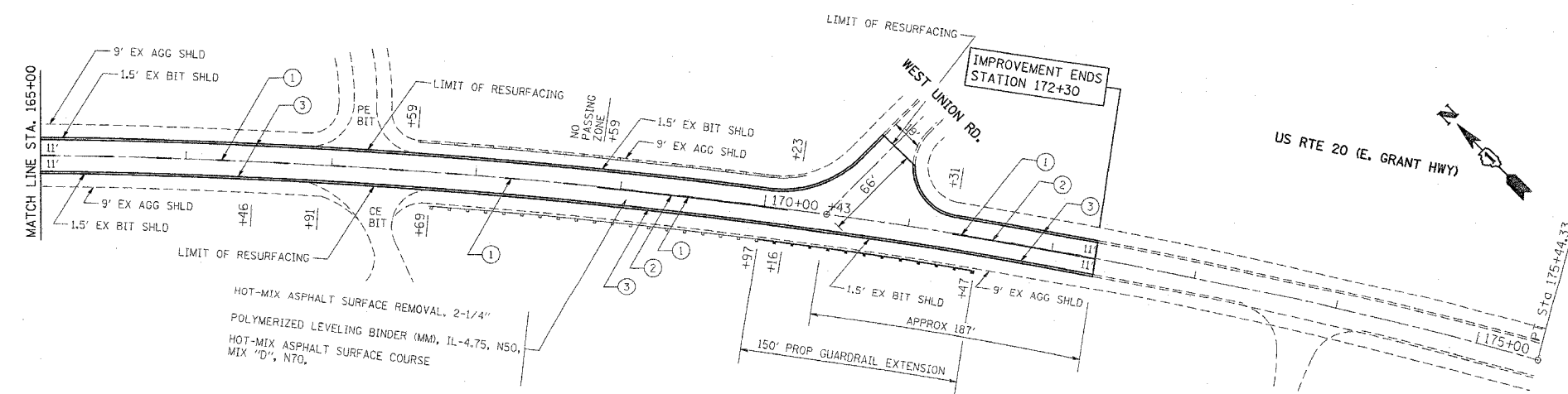

PLOT DATE = 2/1/2007
 FILE NAME = c:\projects\11385866\design\p02.dgn
 PLOT SCALE = 1/8" = 1'-0"
 USER NAME = gms@shupe

REVISIONS	
NAME	DATE

ILLINOIS DEPARTMENT OF TRANSPORTATION
**FAP 525: US 20 (GRANT HIGHWAY)
 MEYER ROAD TO WEST UNION ROAD**
**EXISTING AND PROPOSED
 ROADWAY AND PAVEMENT MARKING PLAN**
 SCALE: VERT. _____ DRAWN BY _____
 HORIZ. _____ CHECKED BY _____
 DATE _____