

F.A.P. RTE.	SECTION	COUNTY	TOTAL SHEETS	SHEET NO.
525	(11 & 12) RS-10	McHENRY	22	1

CONTRACT NO.: 60B63

23

STATE OF ILLINOIS  
DEPARTMENT OF TRANSPORTATION  
DIVISION OF HIGHWAYS

# PROPOSED HIGHWAY PLANS

F.A.P. ROUTE 525: US 20 (GRANT HIGHWAY)  
MEYER ROAD TO WEST UNION ROAD  
SECTION: (11 & 12) RS-10  
RESURFACING (MAINTENANCE)  
McHENRY COUNTY  
C-91-385-06

FOR INDEX OF SHEETS, SEE SHEET NO. 2

IMPROVEMENT IS LOCATED IN THE CITY OF MARENGO IN McHENRY COUNTY

D-91-385-06



LOCATION OF SECTION INDICATED THUS: —

**TRAFFIC DATA**

2005 ADT = 10400 - 11800  
SPEED LIMIT = 30 MPH AND VARIES TO 55 MPH

IMPROVEMENT BEGINS  
STATION 04+41

OMISSION  
STA. 56+85 - STA. 67+60

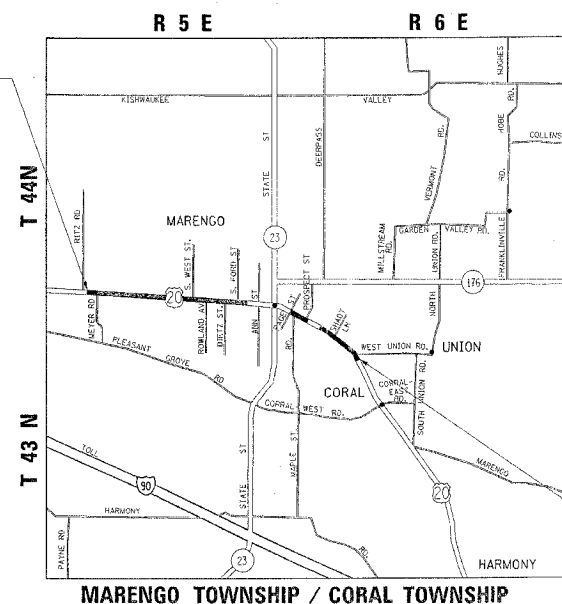

OMISSION  
STA. 98+17 - STA. 107+85

IMPROVEMENT ENDS  
STATION 172+30

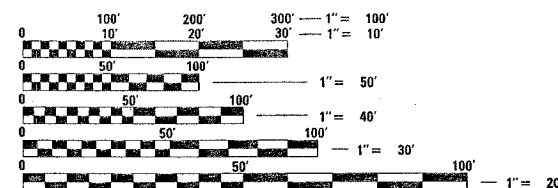

FULL SIZE PLANS HAVE BEEN PREPARED USING STANDARD ENGINEERING SCALES. REDUCED SIZED PLANS WILL NOT CONFORM TO STANDARD SCALES. IN MAKING MEASUREMENTS ON REDUCED PLANS, THE ABOVE SCALES MAY BE USED.

J.U.L.I.E.  
JOINT UTILITY LOCATION INFORMATION FOR EXCAVATION  
1-800-892-0123

GROSS LENGTH OF IMPROVEMENT = 16789 LINEAL FEET = 3.18 MILES  
NET LENGTH OF IMPROVEMENT = 14746 LINEAL FEET = 2.79 MILES

CONTRACT NO. 60B63

STATE OF ILLINOIS  
DEPARTMENT OF TRANSPORTATION  
DIVISION OF HIGHWAYS

SUBMITTED January 17 20 07  
Brian O'Keefe / on  
DEPUTY DIRECTOR OF HIGHWAYS, REGION ENGINEER

March 23, 20 07  
Eric E. Haral / on  
INTERIM ENGINEER OF DESIGN AND ENVIRONMENT

March 23, 20 07  
Milton R. Sweet / on  
DIRECTOR OF HIGHWAYS, CHIEF ENGINEER

**PRINTED BY THE AUTHORITY  
OF THE STATE OF ILLINOIS**

DISTRICT ONE - DESIGN AND PLAN PREPARATION ENGINEER - KEN ENG/J.P. CHANG (847) 705-4432



SUMMARY OF QUANTITIES			100% STATE URBAN TOTAL QUANTITIES	CONSTRUCTION TYPE CODE			
CODE NO	ITEM	UNIT		1000-2A			
20201006	GRADING AND SHAPING SHOULDERS	UNIT	210	210			
40600200	BITUMINOUS MATERIALS (PRIME COAT)	TON	22	22			
40600300	AGGREGATE (PRIME COAT)	TON	110	110			
40600400	MIXTURE FOR CRACKS, JOINTS, AND FLANGEWAYS	TON	17	17			
40600895	CONSTRUCTING TEST STRIP	EACH	2	2			
40600982	HOT-MIX ASPHALT SURFACE REMOVAL - BUTT JOINT	SQ YD	295	295			
40601005	HOT-MIX ASPHALT REPLACEMENT OVER PATCHES	TON	92	92			
40603340	HOT-MIX ASPHALT SURFACE COURSE, MIX "D", N70	TON	4629	4629			
42001300	PROTECTIVE COAT	SQ YD	790	790			
44000158	HOT-MIX ASPHALT SURFACE REMOVAL, 2 1/4"	SQ YD	53500	53500			
44000198	HOT-MIX ASPHALT SURFACE REMOVAL (VARIABLE DEPTH)	SQ YD	912	912			
44001700	COMBINATION CONCRETE CURB AND GUTTER REMOVAL AND REPLACEMENT	FOOT	3250	3250			
44002212	HOT-MIX ASPHALT REMOVAL OVER PATCHES, 3"	SQ YD	544	544			
44201749	CLASS D PATCHES, TYPE I, 9 INCH	SQ YD	52	52			
44201753	CLASS D PATCHES, TYPE II, 9 INCH	SQ YD	368	368			
44201757	CLASS D PATCHES, TYPE III, 9 INCH	SQ YD	45	45			
48102100	AGGREGATE WEDGE SHOULDER, TYPE B	TON	850	850			
48203021	HOT-MIX ASPHALT SHOULDERS, 6"	SQ YD	145	145			
55039700	STORM SEWERS TO BE CLEANED	FOOT	3000	3000			
60265700	VALVE VAULTS TO BE ADJUSTED	EACH	6	6			
60300105	FRAMES AND GRATES TO BE ADJUSTED	EACH	14	14			
60300310	FRAMES AND LIDS TO BE ADJUSTED (SPECIAL)	EACH	12	12			
60404940	FRAMES AND GRATES, TYPE 23	EACH	23	23			
60604300	COMBINATION CONCRETE CURB AND GUTTER, TYPE B-6.12 (VARIABLE WIDTH GUTTER FLAG)	FOOT	250	250			
63200310	GUARDRAIL REMOVAL	FOOT	37.5	37.5			
63200710	STEEL PLATE BEAM GUARD RAIL REMOVAL, TYPE A	FOOT	150	150			
67000400	ENGINEER'S FIELD OFFICE, TYPE A	CAL MO	6	6			

\* SPECIALITY ITEMS

SUMMARY OF QUANTITIES			100% STATE URBAN TOTAL QUANTITIES	CONSTRUCTION TYPE CODE			
CODE NO	ITEM	UNIT		1000-2A			
67100100	MOBILIZATION	L SUM	1	1			
70100450	TRAFFIC CONTROL AND PROTECTION, STANDARD 701201	L SUM	1	1			
70100460	TRAFFIC CONTROL AND PROTECTION, STANDARD 701306	L SUM	1	1			
70102635	TRAFFIC CONTROL AND PROTECTION, STANDARD 701701	L SUM	1	1			
70103815	TRAFFIC CONTROL SURVEILLANCE	CAL DA	16	16			
70300100	SHORT-TERM PAVEMENT MARKING	FOOT	14010	14010			
70300210	TEMPORARY PAVEMENT MARKING - LETTERS AND SYMBOLS	SQ FT	254.8	254.8			
70300220	TEMPORARY PAVEMENT MARKING - LINE 4"	FOOT	32976	32976			
70300240	TEMPORARY PAVEMENT MARKING - LINE 6"	FOOT	1248	1248			
70300260	TEMPORARY PAVEMENT MARKING - LINE 12"	FOOT	753	753			
70300280	TEMPORARY PAVEMENT MARKING - LINE 24"	FOOT	32	32			
70301000	WORK ZONE PAVEMENT MARKING REMOVAL	SQ FT	17358	17358			
* 78000100	THERMOPLASTIC PAVEMENT MARKING - LETTERS AND SYMBOLS	SQ FT	254.8	254.8			
* 78000200	THERMOPLASTIC PAVEMENT MARKING - LINE 4"	FOOT	32976	32976			
* 78000400	THERMOPLASTIC PAVEMENT MARKING - LINE 6"	FOOT	1248	1248			
* 78000600	THERMOPLASTIC PAVEMENT MARKING - LINE 12"	FOOT	753	753			
* 78000650	THERMOPLASTIC PAVEMENT MARKING - LINE 24"	FOOT	32	32			
* 78100100	RAISED REFLECTIVE PAVEMENT MARKER	EACH	410	410			
* 78200410	GUARDRAIL MARKERS, TYPE A	EACH	7	7			
* 78201000	TERMINAL MARKER - DIRECT APPLIED	EACH	1	1			
78300200	RAISED REFLECTIVE PAVEMENT MARKER REMOVAL	EACH	371	371			
X0322256	TEMPORARY INFORMATION SIGNING	SQ FT	465	465			
X0656100	DRIVEWAY PAVEMENT REMOVAL AND REPLACEMENT	SQ YD	1500	1500			

REVISIONS	
NAME	DATE

ILLINOIS DEPARTMENT OF TRANSPORTATION  
**FAP 525: US 20 (GRANT HIGHWAY)  
 MEYER ROAD TO WEST UNION ROAD**  
**SUMMARY OF QUANTITIES**

2/2/2007

SUMMARY OF QUANTITIES			1001 STATE URBAN TOTAL QUANTITIES	CONSTRUCTION TYPE CODE				
CODE NO	ITEM	UNIT		1000-2A				
X4067107	POLYMERIZED LEVELING BINDER (MACHINE METHOD), IL-4.75, NSO	TON	2169	2169				
XX001306	SIDEWALK REMOVAL AND REPLACEMENT	SO FT	75	75				
* XX005207	TRAFFIC BARRIER TERMINAL, TYPE 1, SPECIAL (TANGENT)	EACH	1	1				
Z0018400	DRAINAGE STRUCTURES TO BE ADJUSTED	EACH	6	6				
Z0018500	DRAINAGE STRUCTURES TO BE CLEANED	EACH	30	30				

SUMMARY OF QUANTITIES				TOTAL QUANTITIES	CONSTRUCTION TYPE CODE				
CODE NO	ITEM	UNIT	1000-2A						

\* SPECIALITY ITEMS

REVISIONS	
NAME	DATE

ILLINOIS DEPARTMENT OF TRANSPORTATION  
**FAP 525: US 20 (GRANT HIGHWAY)  
 MEYER ROAD TO WEST UNION ROAD**  
**SUMMARY OF QUANTITIES**

PLOT DATE: 2/2/2007

2/2/2007 11:14:14 AM C:\PLOT\60B63\SUMMARY.PLOT

F.A.P. RTE.	SECTION	COUNTY	TOTAL SHEETS	SHEET NO.
525	(11 & 12) RS-10	McHENRY	22	5
STA.		TO STA.		
FED. ROAD DIST. NO. 1		ILLINOIS	FED. AID PROJECT	
CONTRACT NO.: 60B63				

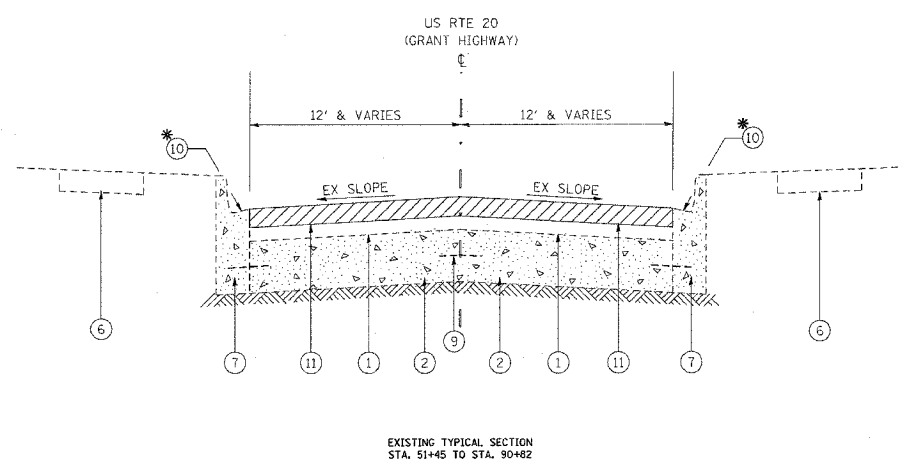
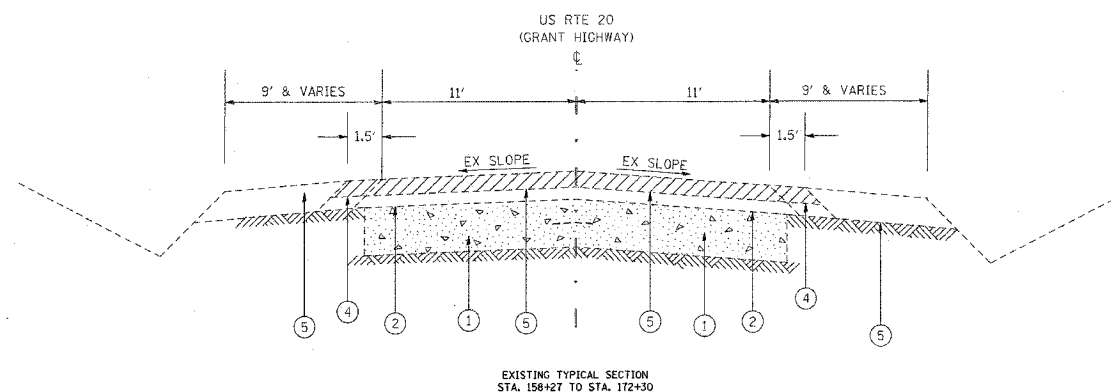
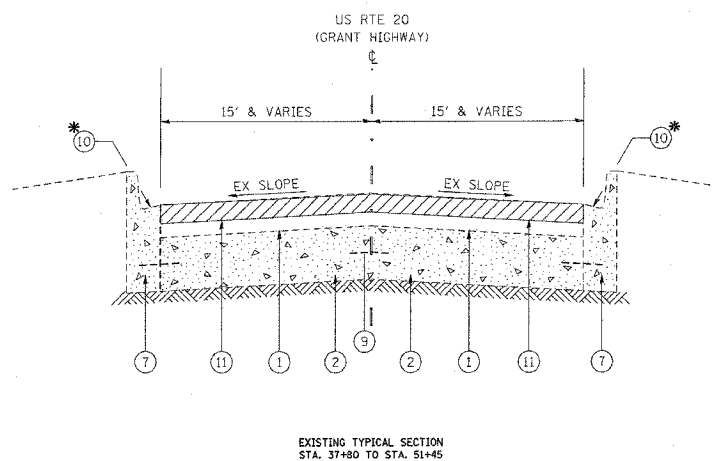
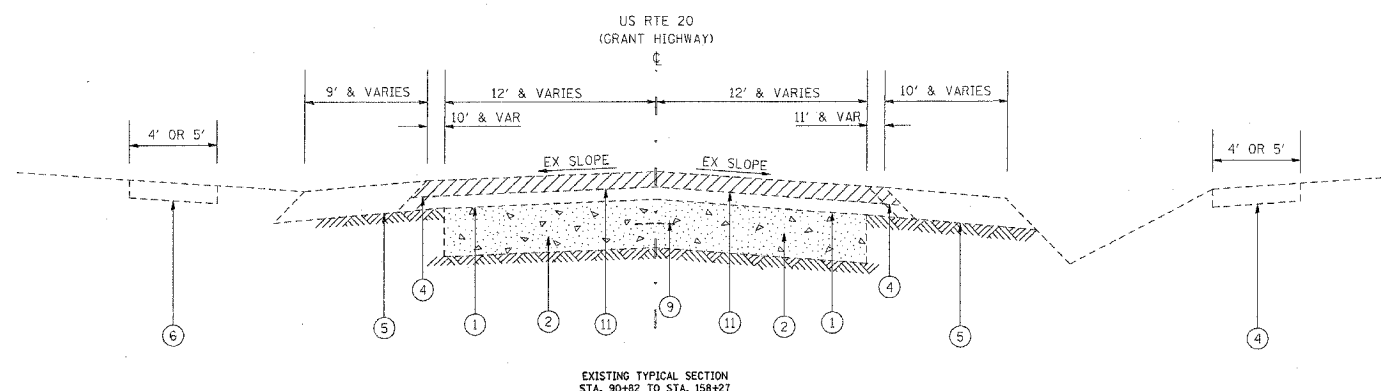
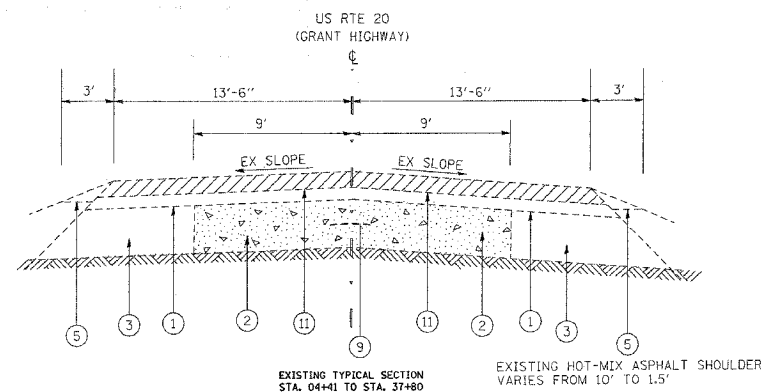

**LEGEND**

- ① EXISTING HOT-MIX ASPHALT SURFACING, 3" (±)
- ② EXISTING PCC PAVEMENT, 9" (±)
- ③ EXISTING HOT-MIX ASPHALT BASE COURSE WIDENING, 10"
- ④ EXISTING HOT-MIX ASPHALT SHOULDER, ± 6"
- ⑤ EXISTING AGGREGATE SHOULDER, TYPE B
- ⑥ EXISTING PCC SIDEWALK, 4" OR 5"
- ⑦ EXISTING COMB. CONC. CURB & GUTTER, TYPE B-6.12
- ⑧ EXISTING COMB. CONC. CURB & GUTTER, TYPE B-6.24
- ⑨ EXISTING LONGITUDINAL CONST. JOINT WITH #8 DOWEL BARS
- ⑩ PROPOSED HMA SURFACE REMOVAL (VAR. DEPTH)
- ⑪ PROPOSED HOT-MIX ASPHALT SURFACE REMOVAL, 2-1/4"
- ⑫ PROPOSED HOT-MIX ASPHALT SURFACE COURSE, MIX "D" N70, 1-1/2"
- ⑬ PROPOSED POLYMERIZED LEVELING BINDER (MM), IL-4.75, N50, 3/4"
- ⑭ PROPOSED GRADING AND SHAPING OF SHOULDERS
- ⑮ PROPOSED AGGREGATE WEDGE SHOULDER TYPE B
- \* ⑯ PROPOSED COMB CONC CURB & GUTTER (R & R)
- \* LOCATIONS TO BE DETERMINED BY THE ENGINEER

REVISIONS	
NAME	DATE

ILLINOIS DEPARTMENT OF TRANSPORTATION  
**FAP 525: US 20 (GRANT HIGHWAY)**  
**MEYER ROAD TO WEST UNION ROAD**  
**EXISTING TYPICAL SECTIONS**

SCALE: VERT. \_\_\_\_\_  
 HORIZ. \_\_\_\_\_  
 DATE \_\_\_\_\_ DRAWN BY \_\_\_\_\_  
 CHECKED BY \_\_\_\_\_

F.A.P. RTE.	SECTION	COUNTY	TOTAL SHEETS	SHEET NO.
525	(11 & 12) RS-10	McHENRY	22	6
STA. TO STA.		FED. ROAD DIST. NO. ILLINOIS FED. AID PROJECT		
CONTRACT NO.: 60B63				

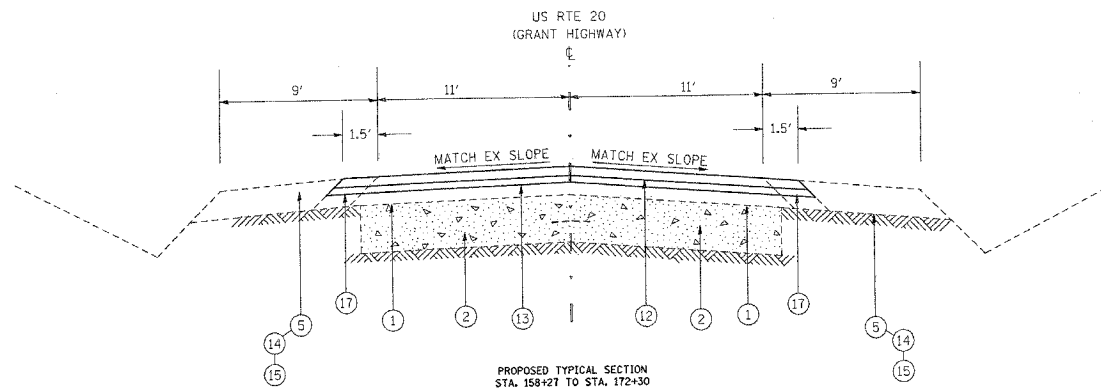
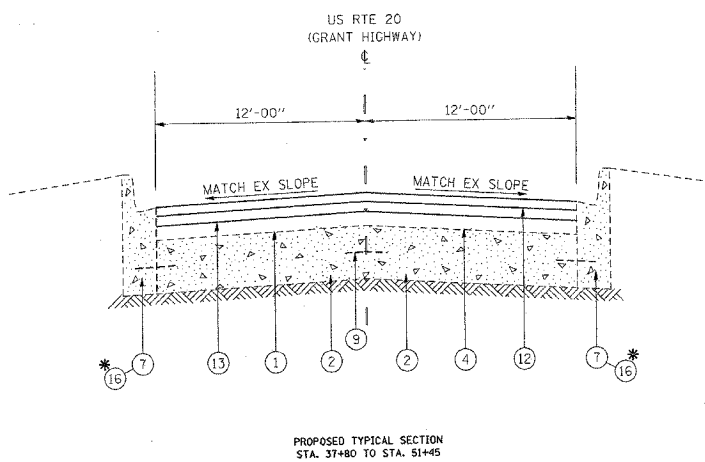
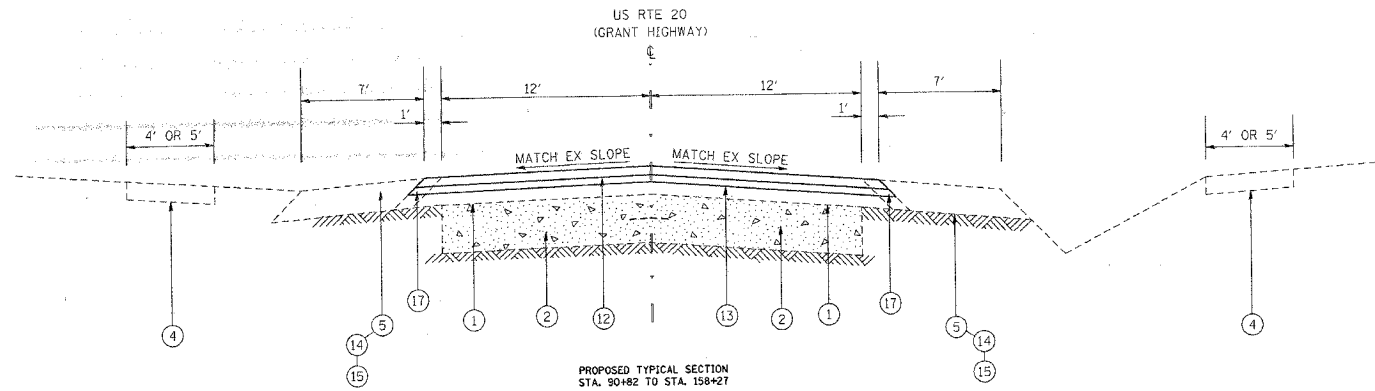
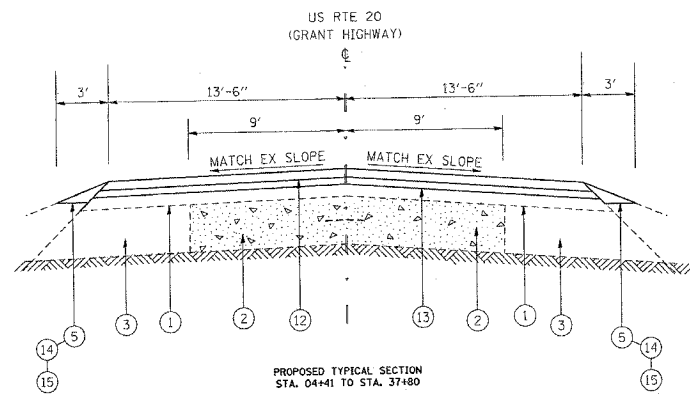

**LEGEND**

- ① EXISTING HOT-MIX ASPHALT SURFACING, 3" (±)
- ② EXISTING PCC PAVEMENT, 9" (±)
- ③ EXISTING HOT-MIX ASPHALT BASE COURSE WIDENING, 10"
- ④ EXISTING HOT-MIX ASPHALT SHOULDER, ± 6"
- ⑤ EXISTING AGGREGATE SHOULDER, TYPE B
- ⑥ EXISTING PCC SIDEWALK, 4' OR 5"
- ⑦ EXISTING COMB. CONC. CURB & GUTTER, TYPE B-6.12
- ⑧ EXISTING COMB. CONC. CURB & GUTTER, TYPE B-6.24
- ⑨ EXISTING LONGITUDINAL CONST. JOINT WITH #8 DOWEL BARS
- ⑩ PROPOSED HMA SURFACE REMOVAL (VAR. DEPTH)
- ⑪ PROPOSED HOT-MIX ASPHALT SURFACE REMOVAL, 2-1/4"
- ⑫ PROPOSED HOT-MIX ASPHALT SURFACE COURSE, MIX "D", N70, 1-1/2"
- ⑬ PROPOSED POLYMERIZED LEVELING BINDER (MM), IL-4.75, N50, 3/4"
- ⑭ PROPOSED GRADING AND SHAPING OF SHOULDERS
- ⑮ PROPOSED AGGREGATE WEDGE SHOULDER TYPE B
- \* ⑯ PROPOSED COMB CONC CURB & GUTTER (R & R)
- ⑰ PROPOSED HOT-MIX ASPHALT SHOULDER
- \* LOCATIONS TO BE DETERMINED BY THE ENGINEER

**HOT-MIX ASPHALT MIXTURE REQUIREMENTS**  
THE FOLLOWING MIXTURE REQUIREMENTS ARE APPLICABLE FOR THIS PROJECT.

MIXTURE TYPE	AC/PG	AIR VOIDS (%)
POLYMERIZED LEVELING BINDER (MM), IL-4.75, N50	SBS/SBR PG 76-28	4% @ 50 GYR
HOT-MIX ASPHALT SURFACE COURSE, MIX "D", N70	PG 64-22	4% @ 70 GYR
CLASS D PATCHES BINDER IL-19.0 MM	PG 64-22	4% @ 70 GYR
HOT-MIX ASPHALT REPLACEMENT OVER PATCHES, BINDER IL-19.0 MM	PG 64-22	4% @ 70 GYR

**ENTRANCES (PE & CE)**

HOT-MIX ASPHALT BASE COURSE	PG 58-22	4% @ 50 GYR
HOT-MIX ASPHALT SURFACE COURSE, MIX "C", N50	PG 64-22	4% @ 50 GYR

**HOT-MIX ASPHALT SHOULDER**

POLYMERIZED LEVELING BINDER (MM), IL-4.75, N50	SBS/SBR PG 76-28	4% @ 50 GYR
HOT-MIX ASPHALT SURFACE COURSE, MIX "D", N70	PG 64-22	4% @ 70 GYR

**NOTE:**

THE UNIT WEIGHT USED TO CALCULATE ALL BITUMINOUS SURFACE MIXTURE QUANTITIES IS 112 POUNDS PER SQUARE YARD PER INCH.

- WHEN RAP EXCEEDS 20%, THE NEW ASPHALT BINDER IN THE MIX SHALL BE 58-22.

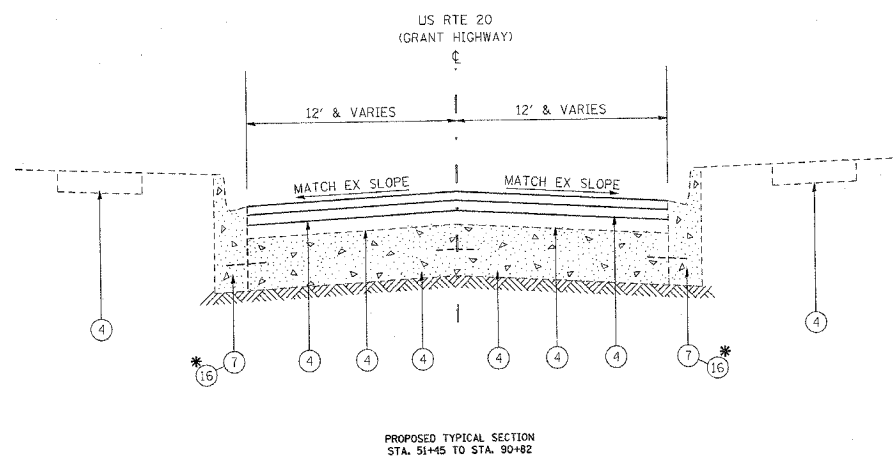

REVISIONS	
NAME	DATE

ILLINOIS DEPARTMENT OF TRANSPORTATION  
**FAP 525: US 20 (GRANT HIGHWAY)  
MEYER ROAD TO WEST UNION ROAD**  
**PROPOSED TYPICAL SECTIONS**

SCALE: VERT. \_\_\_\_\_  
HORIZ. \_\_\_\_\_  
DATE \_\_\_\_\_ DRAWN BY \_\_\_\_\_  
CHECKED BY \_\_\_\_\_

F.A.P. RTE.	SECTION	COUNTY	TOTAL SHEETS	SHEET NO.
525 (11 & 12)	RS-10	McHENRY	22	7
STA. 04 + 41		TO STA. 30 + 00		
FED. ROAD DIST. NO. 1 ILLINOIS FED. AID PROJECT				

CONTRACT NO.: 60863

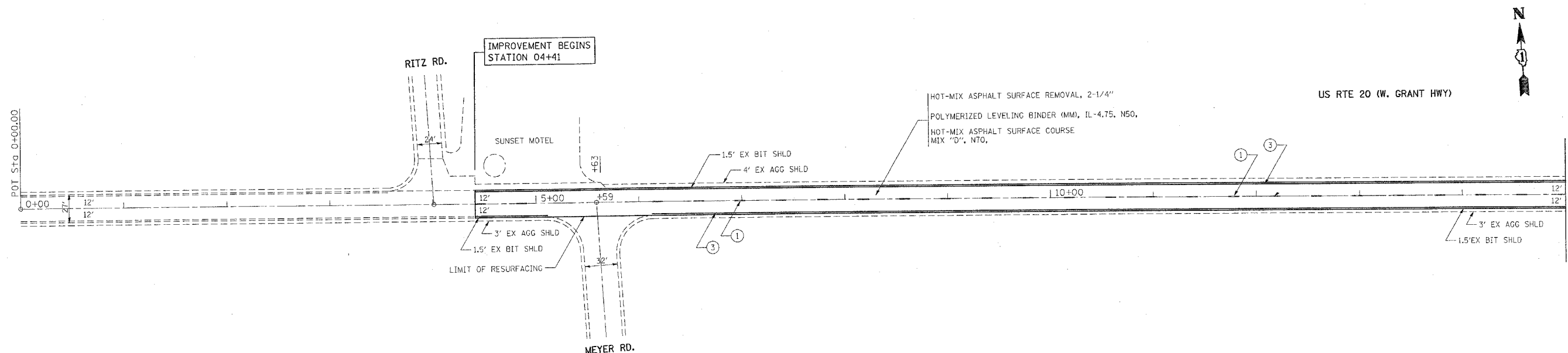

**PAVEMENT MARKING LEGEND**

- |   |   |
|---|---|
| ① THERMOPLASTIC PAVEMENT MARKING<br>SKIP-DASH LINE, 4" YELLOW   | ⑦ THERMOPLASTIC PAVEMENT MARKING<br>12" SOLID YELLOW (RT. 45° DIAGONALS @ 20' C-C)            |
| ② THERMOPLASTIC PAVEMENT MARKING<br>MEDIAN EDGE LINE, 4" SOLID YELLOW                                       | ⑧ THERMOPLASTIC PAVEMENT MARKING<br>24" SOLID WHITE STOP BAR                                  |
| ③ THERMOPLASTIC PAVEMENT MARKING<br>EDGE LINE, 4" SOLID WHITE   | ⑨ THERMOPLASTIC PAVEMENT MARKING<br>LEFT AND RIGHT TURN ONLY<br>LETTERS AND SYMBOLS, 8" WHITE |
| ④ THERMOPLASTIC PAVEMENT MARKING<br>DOTTED LANE LINE, 6" WHITE  | ⑩ THERMOPLASTIC PAVEMENT MARKING<br>CROSS WALK (SCHOOL), 6' (12" @ 90°)<br>SOLID WHITE        |
| ⑤ THERMOPLASTIC PAVEMENT MARKING<br>LANE LINE, 6" WHITE   | ⑪ THERMOPLASTIC PAVEMENT MARKING<br>MEDIAN EDGE LINE, 4" SOLID YELLOW (DOUBLE)                |
| ⑥ THERMOPLASTIC PAVEMENT MARKING<br>CROSS WALK, 6" SOLID WHITE, 2 @ 6' C-C<br>AND 4' IN ADVANCE OF STOP BAR |   |

**PAVEMENT MARKING NOTES**

- FOR PAVEMENT MARKING DETAILS, SEE SPECIAL DETAIL SHEET FOR "DISTRICT ONE TYPICAL PAVEMENT MARKINGS".
- FOR DETAILS AND SYMBOLS OF RAISED REFLECTIVE PAVEMENT MARKERS, SEE SPECIAL DETAIL FOR "TYPICAL APPLICATION OF DUAL DIRECTIONAL SNOW PLOWABLE RAISED PAVEMENT MARKERS".

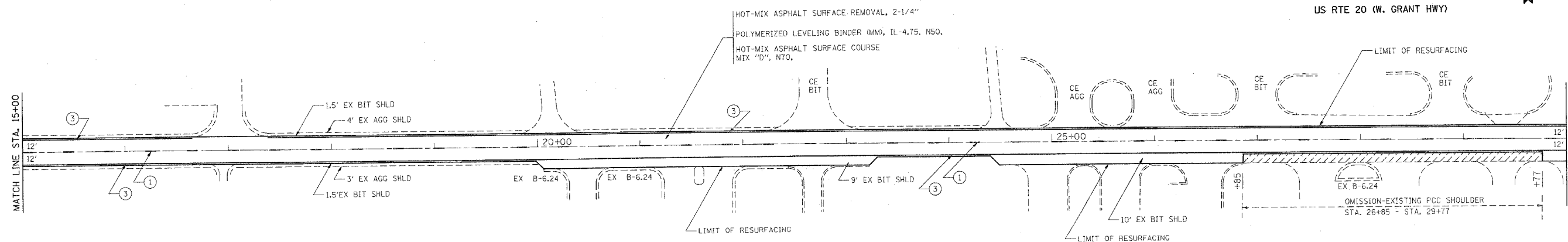

REVISIONS	
NAME	DATE

ILLINOIS DEPARTMENT OF TRANSPORTATION  
**FAP 525: US 20 (GRANT HIGHWAY)  
MEYER ROAD TO WEST UNION ROAD**  
**EXISTING AND PROPOSED  
ROADWAY AND PAVEMENT MARKING PLAN**

SCALE: VERT.  
HORIZ.  
DATE

DRAWN BY  
CHECKED BY

PLOT DATE = 2/1/2007  
FILE NAME = c:\projects\ad138596\designs.dgn  
PLOT SCALE = 50.0000 / IN.  
USER NAME = gurshepa

F.A.P. RTE.	SECTION	COUNTY	TOTAL SHEETS	SHEET NO.
525 (11 & 12) RS-10		MCHEMRY	22	8
STA. 30 +00		TO STA. 60 + 00		
FED. ROAD DIST. NO. 1		ILLINOIS	FED. AID PROJECT	
CONTRACT NO.: 60B63				

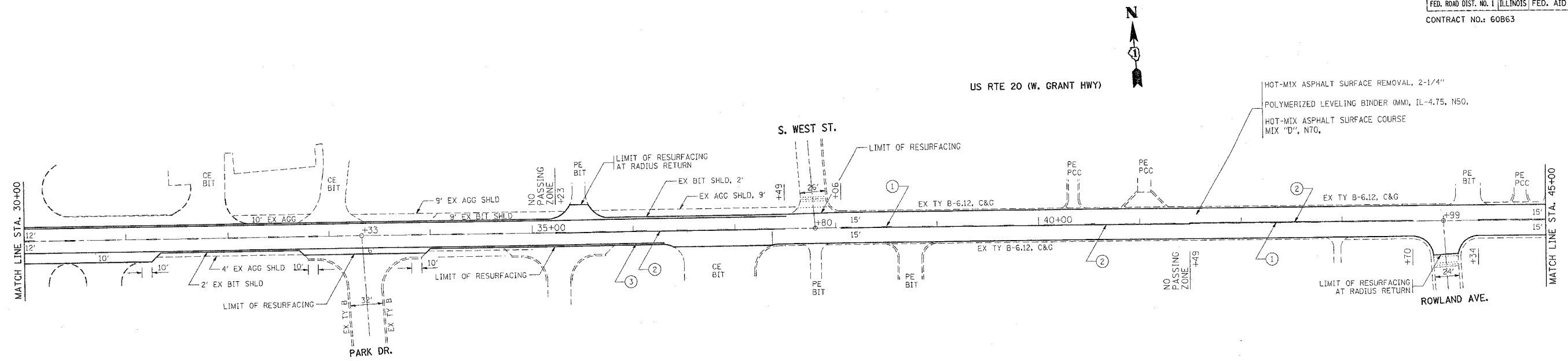

**PAVEMENT MARKING LEGEND**

- |   |   |
|---|---|
| ① THERMOPLASTIC PAVEMENT MARKING SKIP-DASH LINE, 4" YELLOW  | ⑦ THERMOPLASTIC PAVEMENT MARKING 12" SOLID YELLOW (RT. 45° DIAGONALS @ 20' C-C)         |
| ② THERMOPLASTIC PAVEMENT MARKING MEDIAN EDGE LINE, 4" SOLID YELLOW                                    | ⑧ THERMOPLASTIC PAVEMENT MARKING 24" SOLID WHITE STOP BAR                               |
| ③ THERMOPLASTIC PAVEMENT MARKING EDGE LINE, 4" SOLID WHITE  | ⑨ THERMOPLASTIC PAVEMENT MARKING LEFT AND RIGHT TURN ONLY LETTERS AND SYMBOLS, 8" WHITE |
| ④ THERMOPLASTIC PAVEMENT MARKING DOTTED LANE LINE, 6" WHITE   | ⑩ THERMOPLASTIC PAVEMENT MARKING CROSS WALK (SCHOOL 1), 6" (12" @ 90°) SOLID WHITE      |
| ⑤ THERMOPLASTIC PAVEMENT MARKING LANE LINE, 6" WHITE  | ⑪ THERMOPLASTIC PAVEMENT MARKING MEDIAN EDGE LINE, 4" SOLID YELLOW (DOUBLE)             |
| ⑥ THERMOPLASTIC PAVEMENT MARKING CROSS WALK, 6" SOLID WHITE, 2 @ 6' C-C AND 4' IN ADVANCE OF STOP BAR |   |

**PAVEMENT MARKING NOTES**

- FOR PAVEMENT MARKING DETAILS, SEE SPECIAL DETAIL SHEET FOR "DISTRICT ONE TYPICAL PAVEMENT MARKINGS".
- FOR DETAILS AND SYMBOLS OF RAISED REFLECTIVE PAVEMENT MARKERS, SEE SPECIAL DETAIL FOR "TYPICAL APPLICATION OF DUAL DIRECTIONAL SNOW PLOWABLE RAISED PAVEMENT MARKERS".

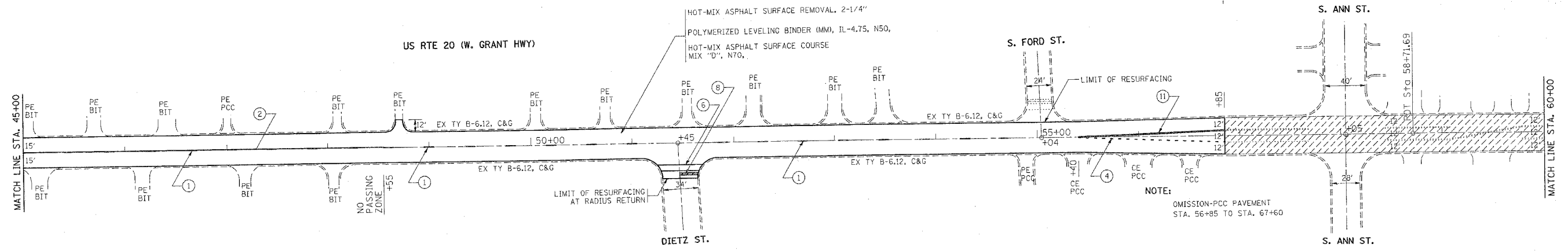

REVISIONS	
NAME	DATE

ILLINOIS DEPARTMENT OF TRANSPORTATION  
**FAP 525: US 20 (GRANT HIGHWAY)  
MEYER ROAD TO WEST UNION ROAD**  
**EXISTING AND PROPOSED  
ROADWAY AND PAVEMENT MARKING PLAN**  
SCALE: VERT. \_\_\_\_\_  
HORIZ. \_\_\_\_\_  
DATE \_\_\_\_\_ DRAWN BY \_\_\_\_\_  
CHECKED BY \_\_\_\_\_

PLOT DATE = 07/20/07  
FILE NAME = c:\pcc\msta\dl369808\design\pcc.dgn  
PLOT SCALE = 1/8" = 1'-0"  
USER NAME = qwehshyp



F.A.P. RTE.	SECTION	COUNTY	TOTAL SHEETS	SHEET NO.
525 (11 & 12) RS-10		McHENRY	22	9
STA. 60 + 00		TO STA. 90 + 00		
FED. ROAD DIST. NO. 1 ILLINOIS FED. AID PROJECT				
CONTRACT NO.: 60B63				

EXIST. CURVE E.US20-1  
 PI STA. = 69+57.34  
 $\Delta = 5^\circ 36' 16''$  (RT)  
 $D = 0^\circ 38' 30''$   
 $R = 8,929.21'$   
 $T = 437.06'$   
 $L = 873.42'$   
 $E = 10.69'$   
 $\theta =$   
 $T.R. =$   
 $S.E. RUN =$   
 $P.C. STA. = 65+20.28$   
 $P.T. STA. = 73+93.70$

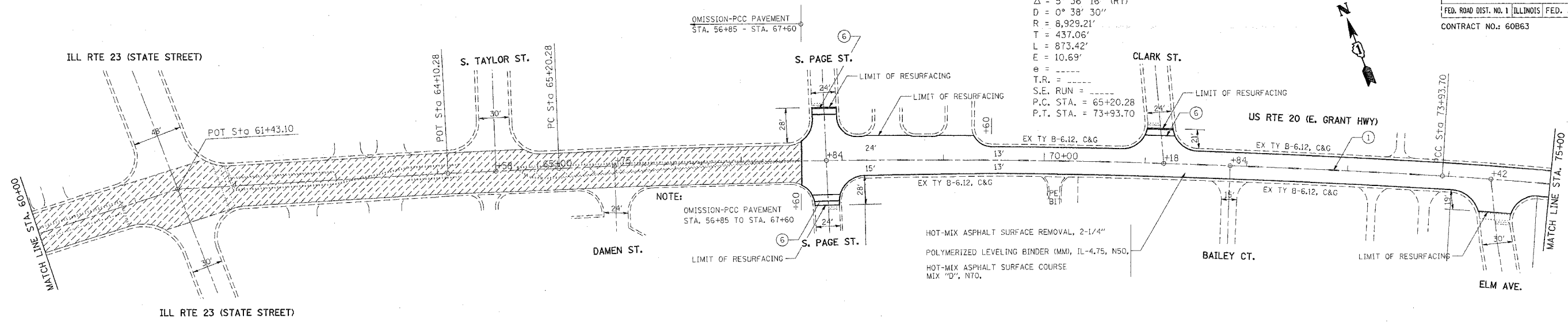

EXIST. CURVE E.US20-2  
 PI STA. = 75+82.33  
 $\Delta = 6^\circ 10' 12''$  (RT)  
 $D = 1^\circ 38' 13''$   
 $R = 3,500.00'$   
 $T = 188.63'$   
 $L = 376.90'$   
 $E = 5.08'$   
 $\theta =$   
 $T.R. =$   
 $S.E. RUN =$   
 $P.C. STA. = 73+93.70$   
 $P.T. STA. = 77+70.60$

**PAVEMENT MARKING LEGEND**

- ① THERMOPLASTIC PAVEMENT MARKING SKIP-DASH LINE, 4" YELLOW
- ② THERMOPLASTIC PAVEMENT MARKING MEDIAN EDGE LINE, 4" SOLID YELLOW
- ③ THERMOPLASTIC PAVEMENT MARKING EDGE LINE, 4" SOLID WHITE
- ④ THERMOPLASTIC PAVEMENT MARKING DOTTED LANE LINE, 6" WHITE
- ⑤ THERMOPLASTIC PAVEMENT MARKING LANE LINE, 6" WHITE
- ⑥ THERMOPLASTIC PAVEMENT MARKING CROSS WALK, 6" SOLID WHITE, 2 @ 6' C-C AND 4' IN ADVANCE OF STOP BAR
- ⑦ THERMOPLASTIC PAVEMENT MARKING 12" SOLID YELLOW (RT, 45° DIAGONALS @ 20' C-C
- ⑧ THERMOPLASTIC PAVEMENT MARKING 24" SOLID WHITE STOP BAR
- ⑨ THERMOPLASTIC PAVEMENT MARKING LEFT AND RIGHT TURN ONLY LETTERS AND SYMBOLS, 8" WHITE
- ⑩ THERMOPLASTIC PAVEMENT MARKING CROSS WALK (SCHOOL), 6" (12" @ 90°) SOLID WHITE
- ⑪ THERMOPLASTIC PAVEMENT MARKING MEDIAN EDGE LINE, 4" SOLID YELLOW (DOUBLE)

**PAVEMENT MARKING NOTES**

1. FOR PAVEMENT MARKING DETAILS, SEE SPECIAL DETAIL SHEET FOR "DISTRICT ONE TYPICAL PAVEMENT MARKINGS".
2. FOR DETAILS AND SYMBOLS OF RAISED REFLECTIVE PAVEMENT MARKERS, SEE SPECIAL DETAIL FOR "TYPICAL APPLICATION OF DUAL DIRECTIONAL SNOW PLOWABLE RAISED PAVEMENT MARKERS".

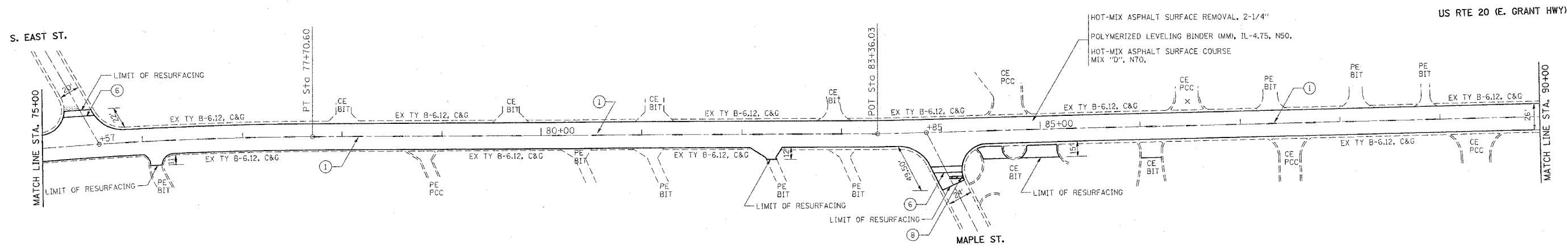

PLOT DATE = 2/1/2007  
 FILE NAME = c:\projects\138505\design\p05.dgn  
 PLOT SCALE = 1/8" = 1'-0"  
 USER NAME = gursingh

REVISIONS	
NAME	DATE

ILLINOIS DEPARTMENT OF TRANSPORTATION  
**FAP 525: US 20 (GRANT HIGHWAY)  
 MEYER ROAD TO WEST UNION ROAD**  
**EXISTING AND PROPOSED  
 ROADWAY AND PAVEMENT MARKING PLAN**  
 SCALE: VERT. \_\_\_\_\_ DRAWN BY \_\_\_\_\_  
 DATE \_\_\_\_\_ CHECKED BY \_\_\_\_\_

F.A.P. RTE.	SECTION	COUNTY	TOTAL SHEETS	SHEET NO.
525	(11 & 12) RS-10	McHENRY	22	10
STA. 90 + 00		TO STA. 120 + 00		
FED. ROAD DIST. NO. 1		ILLINOIS		FED. AID PROJECT

CONTRACT NO.: 60863

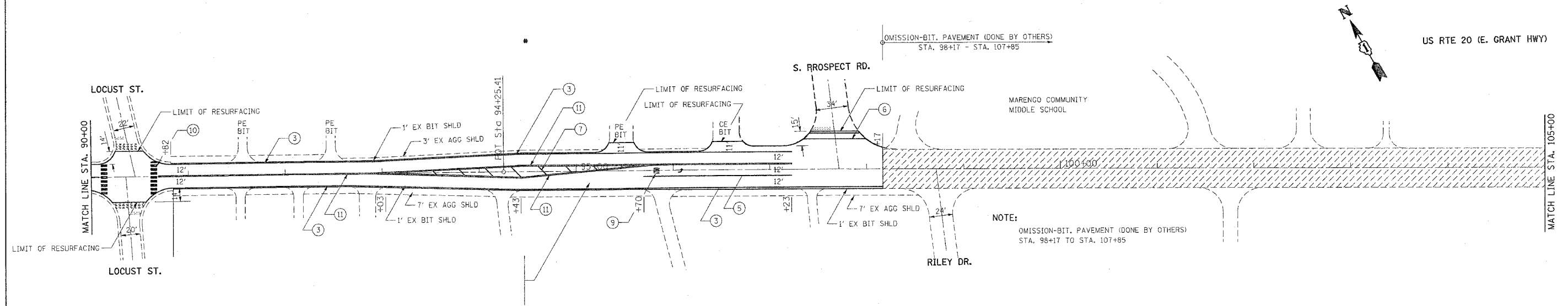

**PAVEMENT MARKING LEGEND**

- |   |   |
|---|---|
| ① THERMOPLASTIC PAVEMENT MARKING SKIP-DASH LINE, 4" YELLOW  | ⑦ THERMOPLASTIC PAVEMENT MARKING 12" SOLID YELLOW (RT. 45° DIAGONALS @ 20' C-C)         |
| ② THERMOPLASTIC PAVEMENT MARKING MEDIAN EDGE LINE, 4" SOLID YELLOW                                    | ⑧ THERMOPLASTIC PAVEMENT MARKING 24" SOLID WHITE STOP BAR                               |
| ③ THERMOPLASTIC PAVEMENT MARKING EDGE LINE, 4" SOLID WHITE  | ⑨ THERMOPLASTIC PAVEMENT MARKING LEFT AND RIGHT TURN ONLY LETTERS AND SYMBOLS, 8" WHITE |
| ④ THERMOPLASTIC PAVEMENT MARKING DOTTED LANE LINE, 6" WHITE   | ⑩ THERMOPLASTIC PAVEMENT MARKING CROSS WALK (SCHOOL), 6" (12" @ 90°) SOLID WHITE        |
| ⑤ THERMOPLASTIC PAVEMENT MARKING LANE LINE, 6" WHITE  | ⑪ THERMOPLASTIC PAVEMENT MARKING MEDIAN EDGE LINE, 4" SOLID YELLOW (DOUBLE)             |
| ⑥ THERMOPLASTIC PAVEMENT MARKING CROSS WALK, 6" SOLID WHITE, 2 @ 6' C-C AND 4' IN ADVANCE OF STOP BAR |   |

**PAVEMENT MARKING NOTES**

- FOR PAVEMENT MARKING DETAILS, SEE SPECIAL DETAIL SHEET FOR "DISTRICT ONE TYPICAL PAVEMENT MARKINGS".
- FOR DETAILS AND SYMBOLS OF RAISED REFLECTIVE PAVEMENT MARKERS, SEE SPECIAL DETAIL FOR "TYPICAL APPLICATION OF DUAL DIRECTIONAL SNOW PLOWABLE RAISED PAVEMENT MARKERS".

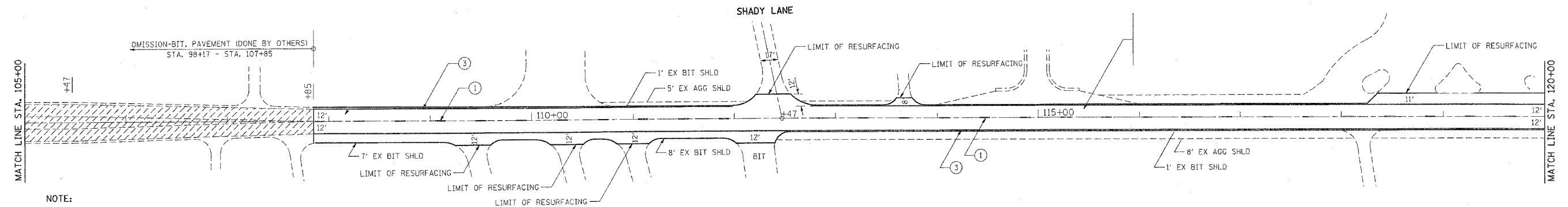

NOTE:  
OMISSION-BIT. PAVEMENT (DONE BY OTHERS)  
STA. 98+17 TO STA. 107+85

REVISIONS	
NAME	DATE

ILLINOIS DEPARTMENT OF TRANSPORTATION  
**FAP 525: US 20 (GRANT HIGHWAY)  
MEYER ROAD TO WEST UNION ROAD**  
**EXISTING AND PROPOSED  
ROADWAY AND PAVEMENT MARKING PLAN**

SCALE: VERT. \_\_\_\_\_  
HORIZ. \_\_\_\_\_  
DATE \_\_\_\_\_

DRAWN BY \_\_\_\_\_  
CHECKED BY \_\_\_\_\_

PLOT DATE = 2/1/2007  
FILE NAME = c:\p\projects\138596\design\pave.dgn  
PLOT SCALE = 50.0000 / IN.  
USER NAME = qreahy

F.A.P. RTE.	SECTION	COUNTY	TOTAL SHEETS	SHEET NO.
525 (11 & 12) RS-10		McHENRY	22	11
STA. 120 + 00		TO STA. 150 + 00		
FED. ROAD DIST. NO. 1		ILLINOIS	FED. AID PROJECT	
CONTRACT NO.: 60863				

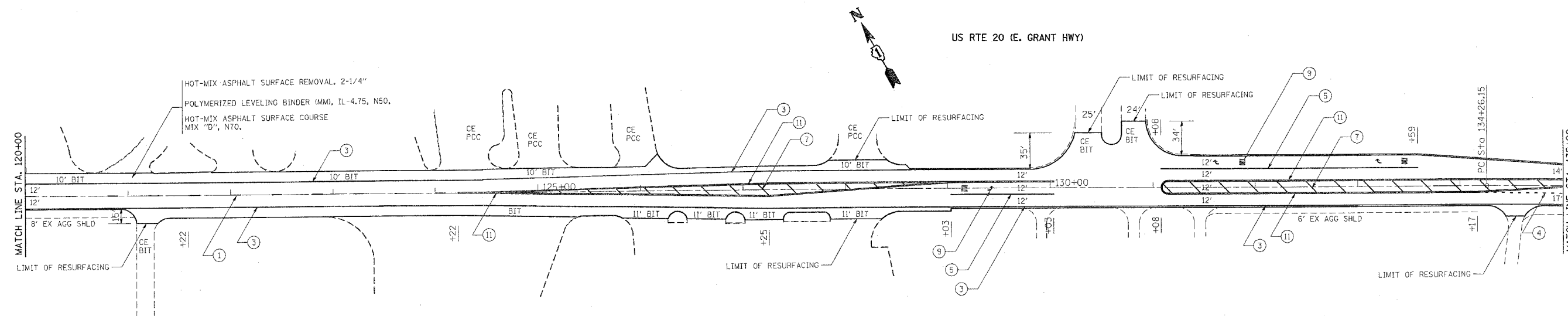

EXIST. CURVE E\_US20-3  
 PI STA. = 138+35.66  
 $\Delta = 6^\circ 15' 02''$  (RT)  
 $D = 0^\circ 45' 50''$   
 $R = 7,500.00'$   
 $T = 409.50'$   
 $L = 818.20'$   
 $E = 11.17'$   
 $e =$   
 $T.R. =$   
 S.E. RUN = 134+26.15  
 P.C. STA. = 134+26.15  
 P.T. STA. = 142+44.35

**PAVEMENT MARKING LEGEND**

- ① THERMOPLASTIC PAVEMENT MARKING SKIP-DASH LINE, 4" YELLOW
- ② THERMOPLASTIC PAVEMENT MARKING MEDIAN EDGE LINE, 4" SOLID YELLOW
- ③ THERMOPLASTIC PAVEMENT MARKING EDGE LINE, 4" SOLID WHITE
- ④ THERMOPLASTIC PAVEMENT MARKING DOTTED LANE LINE, 6" WHITE
- ⑤ THERMOPLASTIC PAVEMENT MARKING LANE LINE, 6" WHITE
- ⑥ THERMOPLASTIC PAVEMENT MARKING CROSS WALK, 6" SOLID WHITE, 2 @ 6' C-C AND 4' IN ADVANCE OF STOP BAR
- ⑦ THERMOPLASTIC PAVEMENT MARKING 12" SOLID YELLOW (RT, 45° DIAGONALS @ 75' C-C)
- ⑧ THERMOPLASTIC PAVEMENT MARKING 24" SOLID WHITE STOP BAR
- ⑨ THERMOPLASTIC PAVEMENT MARKING LEFT AND RIGHT TURN ONLY LETTERS AND SYMBOLS, 8" WHITE
- ⑩ THERMOPLASTIC PAVEMENT MARKING CROSS WALK (SCHOOL), 6" (12" @ 90°) SOLID WHITE
- ⑪ THERMOPLASTIC PAVEMENT MARKING MEDIAN EDGE LINE, 4" SOLID YELLOW (DOUBLE)

**PAVEMENT MARKING NOTES**

1. FOR PAVEMENT MARKING DETAILS, SEE SPECIAL DETAIL SHEET FOR "DISTRICT ONE TYPICAL PAVEMENT MARKINGS".
2. FOR DETAILS AND SYMBOLS OF RAISED REFLECTIVE PAVEMENT MARKERS, SEE SPECIAL DETAIL FOR "TYPICAL APPLICATION OF DUAL DIRECTIONAL SNOW PLOWABLE RAISED PAVEMENT MARKERS".

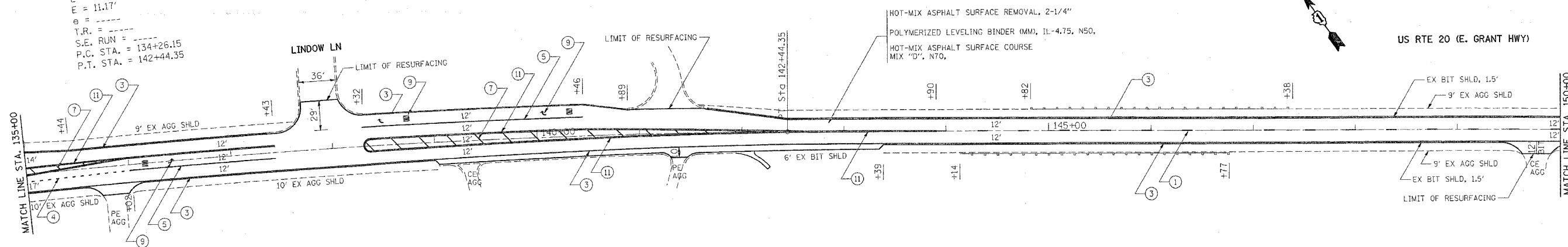

REVISIONS	
NAME	DATE

ILLINOIS DEPARTMENT OF TRANSPORTATION  
**FAP 525: US 20 (GRANT HIGHWAY)  
 MEYER ROAD TO WEST UNION ROAD**  
**EXISTING AND PROPOSED  
 ROADWAY AND PAVEMENT MARKING PLAN**  
 SCALE: VERT. \_\_\_\_\_  
 HORIZ. \_\_\_\_\_  
 DATE \_\_\_\_\_ DRAWN BY \_\_\_\_\_  
 CHECKED BY \_\_\_\_\_

PLOT DATE = 2/1/2007  
 FILE NAME = c:\pav\pav\525\525d135\designa.dgn  
 USER NAME = gprathup

F.A.P. RTE.	SECTION	COUNTY	TOTAL SHEETS	SHEET NO.
525 (11 & 12)	RS-10	McHENRY	22	12
STA. 150 + 00		TO STA. 172 + 30		
FED. ROAD DIST. NO. 1 ILLINOIS FED. AID PROJECT				
CONTRACT NO.: 60B63				

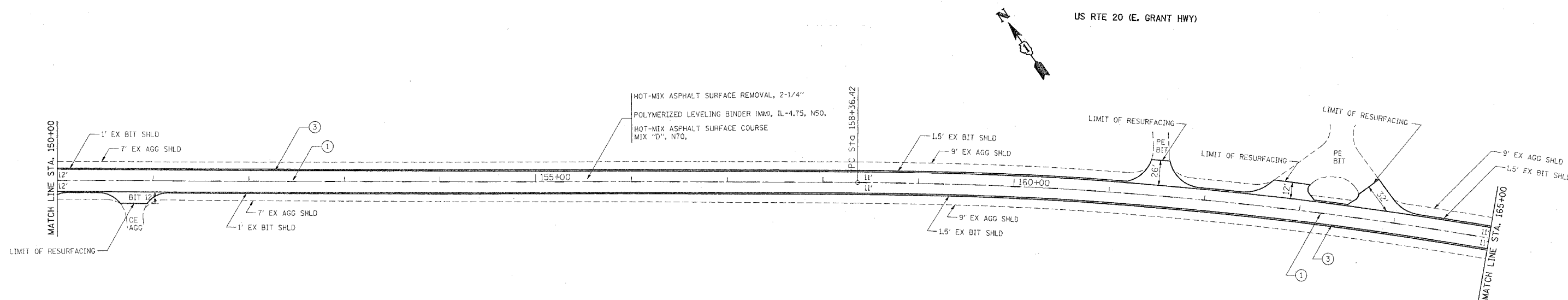

EXIST. CURVE E.US20-4  
 PI STA. = 167+02.99  
 $\Delta = 23^\circ 54' 36''$  (RT)  
 $D = 1^\circ 24' 00''$   
 $R = 4,092.66'$   
 $T = 866.57'$   
 $L = 1,707.91'$   
 $E = 90.74'$   
 $\theta =$   
 $T.R. =$   
 $S.E. RUN =$   
 $P.C. STA. = 158+36.42$   
 $P.T. STA. = 175+44.33$

**PAVEMENT MARKING LEGEND**

- |   |   |
|---|---|
| ① THERMOPLASTIC PAVEMENT MARKING SKIP-DASH LINE, 4" YELLOW  | ⑦ THERMOPLASTIC PAVEMENT MARKING 12" SOLID YELLOW (RT, 45° DIAGONALS @ 20' C-C)         |
| ② THERMOPLASTIC PAVEMENT MARKING MEDIAN EDGE LINE, 4" SOLID YELLOW                                    | ⑧ THERMOPLASTIC PAVEMENT MARKING 24" SOLID WHITE STOP BAR                               |
| ③ THERMOPLASTIC PAVEMENT MARKING EDGE LINE, 4" SOLID WHITE  | ⑨ THERMOPLASTIC PAVEMENT MARKING LEFT AND RIGHT TURN ONLY LETTERS AND SYMBOLS, 8" WHITE |
| ④ THERMOPLASTIC PAVEMENT MARKING DOTTED LANE LINE, 6" WHITE   | ⑩ THERMOPLASTIC PAVEMENT MARKING CROSS WALK (SCHOOL), 6" (12" @ 90°) SOLID WHITE        |
| ⑤ THERMOPLASTIC PAVEMENT MARKING LANE LINE, 6" WHITE  | ⑪ THERMOPLASTIC PAVEMENT MARKING MEDIAN EDGE LINE, 4" SOLID YELLOW (DOUBLE)             |
| ⑥ THERMOPLASTIC PAVEMENT MARKING CROSS WALK, 6" SOLID WHITE, 2 @ 6' C-C AND 4' IN ADVANCE OF STOP BAR |   |

**PAVEMENT MARKING NOTES**

- FOR PAVEMENT MARKING DETAILS, SEE SPECIAL DETAIL SHEET FOR "DISTRICT ONE TYPICAL PAVEMENT MARKINGS".
- FOR DETAILS AND SYMBOLS OF RAISED REFLECTIVE PAVEMENT MARKERS, SEE SPECIAL DETAIL FOR "TYPICAL APPLICATION OF DUAL DIRECTIONAL SNOW PLOWABLE RAISED PAVEMENT MARKERS".

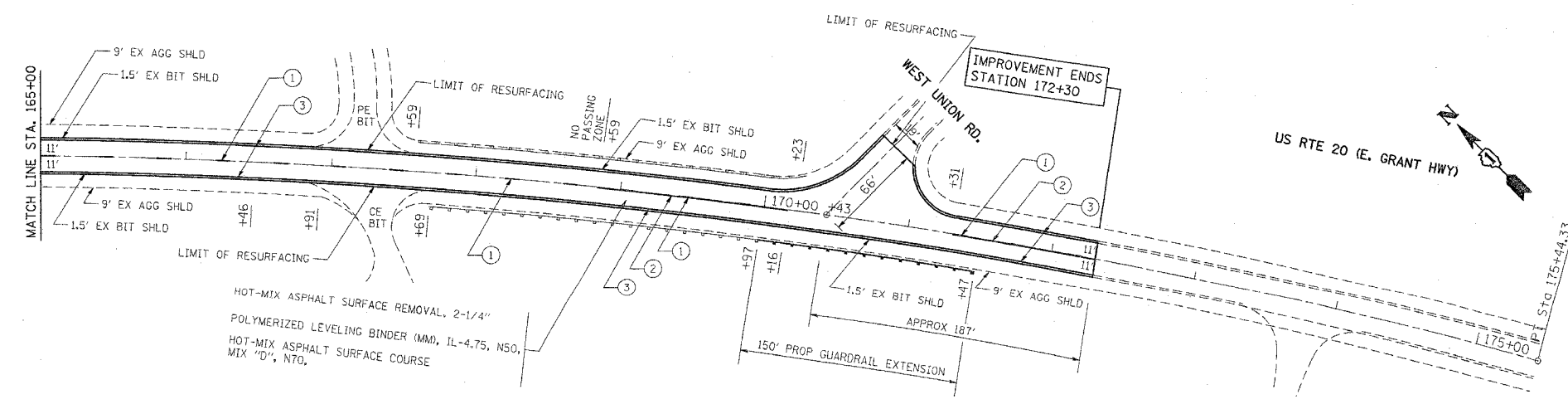

PLOT DATE = 2/1/2007  
 FILE NAME = c:\projects\11385866\design\p02.dgn  
 PLOT SCALE = 50.0000' / 1" IN.  
 USER NAME = gms@shp

REVISIONS	
NAME	DATE

ILLINOIS DEPARTMENT OF TRANSPORTATION  
**FAP 525: US 20 (GRANT HIGHWAY)  
 MEYER ROAD TO WEST UNION ROAD**  
**EXISTING AND PROPOSED  
 ROADWAY AND PAVEMENT MARKING PLAN**  
 SCALE: VERT. \_\_\_\_\_ DRAWN BY \_\_\_\_\_  
 HORIZ. \_\_\_\_\_ CHECKED BY \_\_\_\_\_  
 DATE \_\_\_\_\_

F.A.P. RTE.	SECTION	COUNTY	TOTAL SHEETS	SHEET NO.
525	(11 & 12) RS	McHENRY	22	13
STA.		TO STA.		
FED. ROAD DIST. NO. 1		ILLINOIS FED. AID PROJECT		

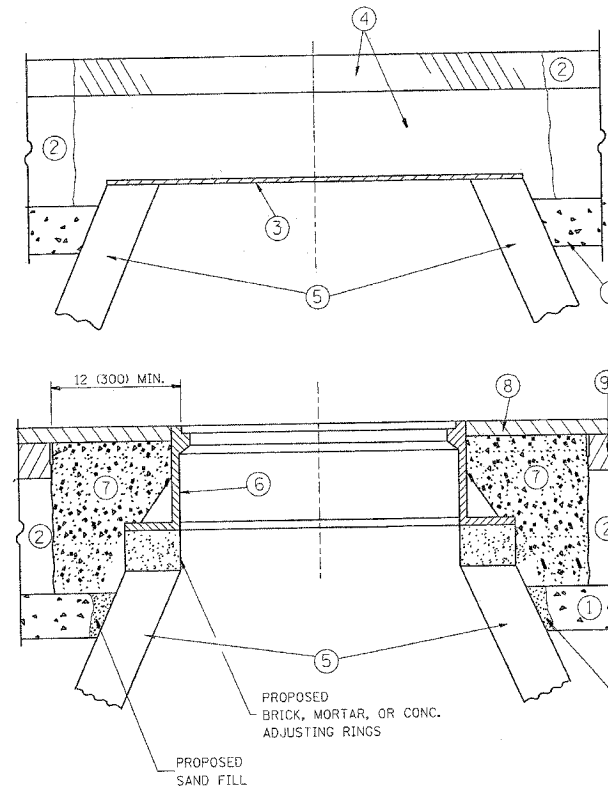

**CONSTRUCTION PROCEDURES**

**STAGE 1 (BEFORE PAVEMENT MILLING)**

- A) REMOVE A MINIMUM OF 12 (300) OF THE PAVEMENT FROM AROUND THE STRUCTURE.
- B) REMOVE THE EXISTING FRAME AND LID FROM THE STRUCTURE.
- C) COVER THE STRUCTURE OPENING WITH A 36 (900) DIAMETER METAL PLATE.
- D) BACKFILL WITH CRUSHED STONE AND A MINIMUM 1 1/2 (40) THICK HMA SURFACE MIX APPROVED BY THE ENGINEER.

**STAGE 2 (AFTER PAVEMENT MILLING)**

- A) REMOVE THE HMA SURFACE MIX AND CRUSHED STONE.
- B) INSTALL THE FRAME AND LID; ADJUST THE FRAME TO ITS FINAL SURFACE ELEVATION.
- C) THE SURROUNDING SPACE SHALL BE FILLED WITH CLASS S1 CONCRETE, OR HMA SURFACE COURSE OR HMA BINDER COURSE TO THE ELEVATION OF THE SURFACE OF THE EXISTING BASE COURSE OR THE BINDER COURSE.

THE PROCEDURE EXPLAINED ABOVE SHALL CONFORM TO THE APPLICABLE PORTIONS OF SECTIONS 353, 406, 602, AND 603 OF THE STANDARD SPECIFICATIONS.

**LEGEND**

- ① SUB-BASE GRANULAR MATERIAL
- ② EXISTING PAVEMENT
- ③ 36 (900) DIAMETER METAL PLATE
- ④ PROPOSED CRUSHED STONE AND HMA SURFACE MIX
- ⑤ EXISTING STRUCTURE
- ⑥ FRAME AND LID (SEE NOTES)
- ⑦ CLASS S1 CONCRETE, HMA SURFACE COURSE OR HMA BINDER COURSE
- ⑧ PROPOSED HMA SURFACE COURSE
- ⑨ PROPOSED HMA BINDER COURSE

**NOTES:**

EXISTING BROKEN FRAMES AND LIDS SHALL BE REMOVED AND DISPOSED OF BY THE CONTRACTOR AND SHALL BE REPLACED AS DIRECTED BY THE ENGINEER. REPLACEMENT FRAMES AND LIDS WILL BE PAID FOR IN ACCORDANCE WITH ARTICLE 109.04 OF THE STANDARD SPECIFICATIONS UNLESS A SEPARATE PAY ITEM HAS BEEN PROVIDED.

IF THE EXISTING LIDS ARE OPEN, THE FRAME WILL BE ADJUSTED TO THE ELEVATION OF THE MILLED PAVEMENT SURFACE PRIOR TO THE MILLING OPERATION. THE FRAME WILL NOT BE REMOVED AND COVERED BY THE METAL PLATE.

CITY OF CHICAGO CASTINGS ARE THE PROPERTY OF THE CITY AND THE CONTRACTOR SHALL NOTIFY THE CITY FOR REMOVAL AND DISPOSITION OF THE CASTINGS.

THE METAL PLATE USED TO COVER THE STRUCTURE SHALL REMAIN THE PROPERTY OF THE CONTRACTOR.

WHEN STRUCTURES ARE TO BE ADJUSTED OR RECONSTRUCTED, THE LOWERING AND RAISING OF THE FRAMES AND LIDS WILL NOT BE PAID FOR SEPARATELY BUT WILL BE INCLUDED IN THE COST OF THE CORRESPONDING PAY ITEM.

**LOCATION OF STRUCTURES:**

THE CONTRACTOR WILL BE REQUIRED TO KEEP A RECORD OF THE LOCATIONS OF THE BURIED STRUCTURES ACCORDING TO THE STATION AND DISTANCE LEFT OR RIGHT OF THE CENTERLINE OF PAVEMENT. UPON COMPLETION OF THE WORK, THE CONTRACTOR WILL DELIVER THE RECORD TO THE ENGINEER.

**BASIS OF PAYMENT:** THIS WORK WILL BE PAID FOR AT THE CONTRACT UNIT PRICE PER EACH FOR "FRAMES AND LIDS TO BE ADJUSTED, SPECIAL" NEW FRAMES AND LIDS, WHEN SPECIFIED, WILL BE PAID FOR SEPARATELY.

**DETAILS FOR FRAMES AND LIDS ADJUSTMENT WITH MILLING**

ALL DIMENSIONS ARE IN INCHES (MILLIMETERS) UNLESS OTHERWISE SHOWN

REVISIONS	
NAME	DATE
R. SHAH	10/25/94
R. SHAH	01/30/95
R. SHAH	03/10/95
A. ABBAS	03/21/97
R. WIEDEMAN	05/14/04
R. BORO	01/01/07

ILLINOIS DEPARTMENT OF TRANSPORTATION  
**DETAILS FOR FRAMES AND LIDS ADJUSTMENT WITH MILLING**

SCALE: VERT. NONE  
HORIZ. 1" = 10'  
PLOT DATE: 2/1/2007

DRAWN BY  
CHECKED BY

BD600-03 (BD-8)  
REVISION DATE: 01/01/07

F.A.P. RTE.	SECTION	COUNTY	TOTAL SHEETS	SHEET NO.
525	(11 & 12) RS	McHenry	22	14
STA.		TO STA.		
FED. ROAD DIST. NO. 1		ILLINOIS	FED. AID PROJECT	

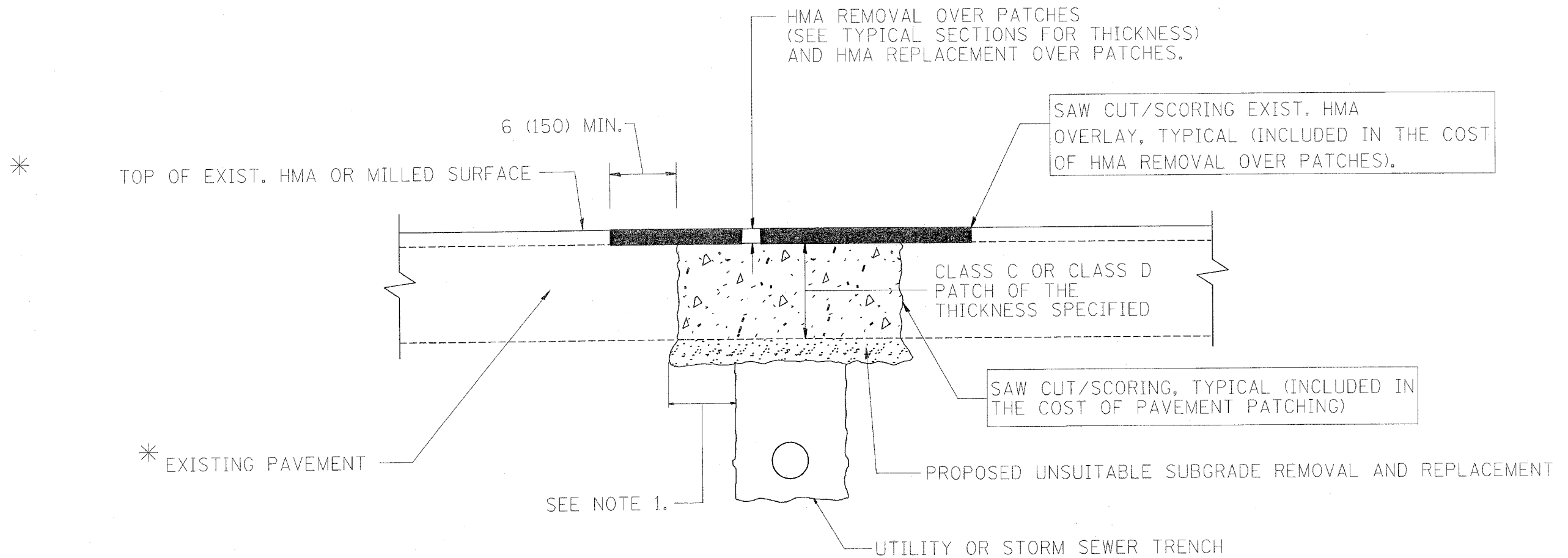

\* SEE TYPICAL SECTIONS FOR THICKNESS AND MATERIALS.

**NOTES:**

1. THE WIDTH OF THE FULL DEPTH PATCH OVER A TRENCH SHALL BE 12 (300) WIDER ON EACH SIDE OF THE TRENCH.
2. FOR METHOD OF MEASUREMENT AND BASIS OF PAYMENT, SEE RECURRING SPECIAL PROVISION "PATCHING WITH HOT-MIX ASPHALT OVERLAY REMOVAL".

**SEQUENCE OF CONSTRUCTION**

1. REMOVE THE EXISTING HMA MATERIAL OVER THE AREA TO BE PATCHED.
2. REMOVE AND REPLACE FULL DEPTH PATCHES
3. REPLACE HMA MATERIAL OVER THE AREA TO BE PATCHED.

ALL DIMENSIONS ARE IN INCHES (MILLIMETERS) UNLESS OTHERWISE SHOWN.

REVISIONS	
NAME	DATE
R. SHAH	10/25/94
R. SHAH	01/14/95
R. SHAH	03/23/95
R. SHAH	04/24/95
A. HOUSEH	03/15/96
A. ABBAS	03/21/97
A. ABBAS	01/20/98
ART ABBAS	04/27/98
R. BORO	01/01/07

ILLINOIS DEPARTMENT OF TRANSPORTATION

**PAVEMENT PATCHING FOR HMA SURFACED PAVEMENT**

SCALE: VERT. NONE  
HORIZ. NONE  
PLOT DATE: 2/1/2007

DRAWN BY  
CHECKED BY

BD400-04 (BD-22)

REVISION DATE: 01/01/07

CONTRACT NO. 60B63				
F.A.P. RTE.	SECTION	COUNTY	TOTAL SHEETS	SHEET NO.
525	(11 & 12) RS	MCHENRY	22	15
STA.		TO STA.		
FED. ROAD DIST. NO. 1		ILLINOIS FED. AID PROJECT		

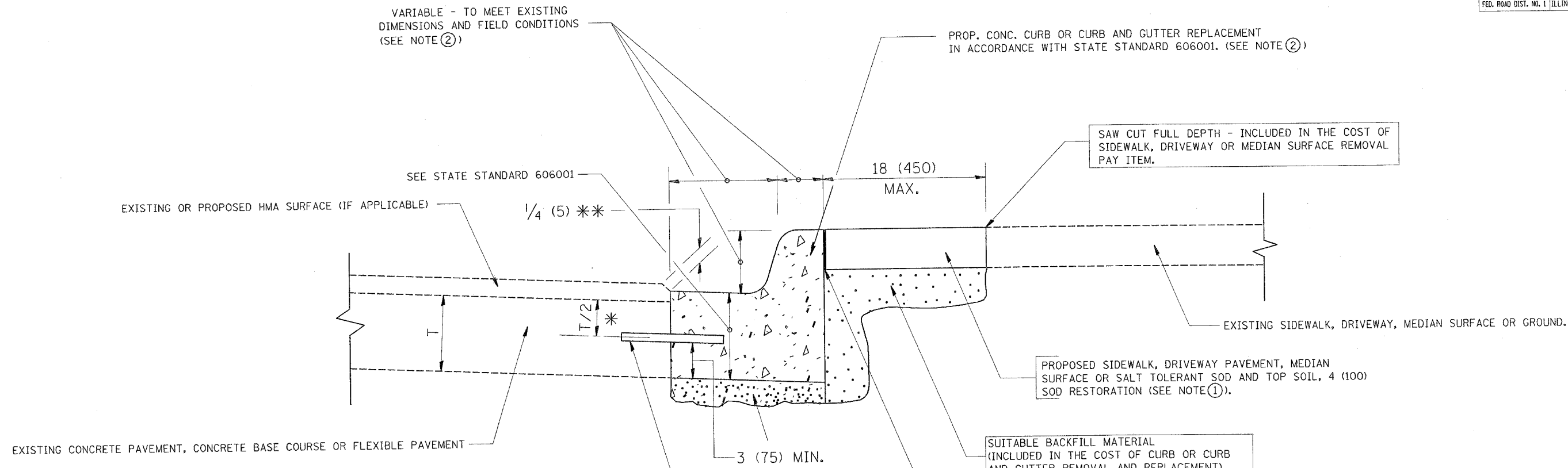

- VARIABLE - TO MEET EXISTING DIMENSIONS AND FIELD CONDITIONS (SEE NOTE ②)
- SEE STATE STANDARD 606001
- EXISTING OR PROPOSED HMA SURFACE (IF APPLICABLE)
- 1/4 (5) \*\*
- T/2 \*
- EXISTING CONCRETE PAVEMENT, CONCRETE BASE COURSE OR FLEXIBLE PAVEMENT
- 3 (75) MIN.
- PROPOSED SIDEWALK, DRIVEWAY PAVEMENT, MEDIAN SURFACE OR SALT TOLERANT SOD AND TOP SOIL, 4 (100) SOD RESTORATION (SEE NOTE ①).
- SUITABLE BACKFILL MATERIAL (INCLUDED IN THE COST OF CURB OR CURB AND GUTTER REMOVAL AND REPLACEMENT)
- PROPOSED 3/4" (20) PREFORMED EXPANSION JOINT AT CONCRETE SIDEWALKS, DRIVEWAYS, AND MEDIANS. (INCLUDED IN THE COST OF CURB OR CURB AND GUTTER REMOVAL AND REPLACEMENT.)
- UNSUITABLE SUB-BASE MATERIAL TO BE REMOVED, IF DIRECTED BY THE ENGINEER, SHALL BE REPLACED WITH EITHER SUB-BASE GRANULAR MATERIAL, TYPE B OR ADDITIONAL THICKNESS OF CONCRETE.
- REMOVAL AND REPLACEMENT 4 (100) OR LESS IS INCLUDED IN THE COST OF CURB OR CURB AND GUTTER REMOVAL AND REPLACEMENT.
- REMOVAL AND REPLACEMENT IN EXCESS OF 4 (100) WILL BE PAID FOR IN ACCORDANCE WITH ARTICLE 109.04 OF THE STANDARD SPECIFICATIONS.
- PROPOSED #6 (20) EPOXY COATED TIE BARS 24 (600) LONG AT 24 (600) CENTERS WILL NOT BE PAID FOR SEPARATELY. DELETE EPOXY COATED TIE BARS IF EXISTING TIE BARS ARE USABLE AS DETERMINED BY THE ENGINEER. (SEE NOTE ③).
- BASIS OF PAYMENT:  
THIS WORK WILL BE PAID FOR AT THE CONTRACT UNIT PRICE PER FOOT (METER) FOR "CURB REMOVAL AND REPLACEMENT" OR "COMBINATION CONCRETE CURB AND GUTTER REMOVAL AND REPLACEMENT".
- NOTE: ① SIDEWALK, DRIVEWAY PAVEMENT OR MEDIAN SURFACE SHALL BE SIMILAR TO THE MATERIAL BEING REMOVED AND WILL BE PAID FOR SEPARATELY.  
SALT TOLERANT SOD AND TOP SOIL, 4 (100) RESTORATION WILL NOT BE PAID FOR SEPARATELY, BUT SHALL BE INCLUDED IN THE COST OF CURB OR CURB AND GUTTER REMOVAL AND REPLACEMENT.
- ② CURB OR CURB AND GUTTER REPLACEMENT SHALL MATCH THE SHAPE OF THE EXISTING CURB OR CURB AND GUTTER UNLESS OTHERWISE SPECIFIED.
- ③ FOR CURB OR CURB AND GUTTER REMOVAL AND REPLACEMENT ADJACENT TO FLEXIBLE PAVEMENT DELETE EPOXY COATED TIE BARS.
- ④ LONGITUDINAL BARS, IF ENCOUNTERED IN THE EXISTING CURB OR CURB AND GUTTER, ARE NOT TO BE REPLACED. CUTTING AND REMOVING LONGITUDINAL BARS SHALL BE INCLUDED IN THE COST OF CURB OR CURB AND GUTTER REMOVAL AND REPLACEMENT.
- ⑤ THE COST OF HMA SURFACE REMOVAL IN THE EXISTING GUTTER FLAG SHALL BE INCLUDED IN THE COST OF THE CURB AND GUTTER REMOVAL AND REPLACEMENT.
- ⑥ THE REMOVAL AND REPLACEMENT OF THE EXISTING CURB OR CURB AND GUTTER SHALL BE DONE IN ACCORDANCE WITH THE APPLICABLE PORTIONS OF SECTION 440 AND 606 OF THE STANDARD SPECIFICATIONS.
- ⑦ THE LOCATIONS OF REMOVAL AND REPLACEMENT OF EXISTING CURB OR CURB AND GUTTER SHALL BE DETERMINED BY THE RESIDENT ENGINEER AT THE TIME OF CONSTRUCTION.

## CURB OR CURB AND GUTTER REMOVAL AND REPLACEMENT

REVISIONS	
NAME	DATE
A. HOUSEH	03/11/94
R. SHAH	02/24/95
R. SHAH	03/02/95
R. SHAH	08/19/96
R. SHAH	09/12/96
R. SHAH	09/19/96
R. SHAH	10/03/96
A. ABBAS	03/21/97
M. GOMEZ	01/22/01
R. BORO	01/01/07

ALL DIMENSIONS ARE IN INCHES (MILLIMETERS) UNLESS OTHERWISE SHOWN.

ILLINOIS DEPARTMENT OF TRANSPORTATION

CURB OR CURB AND GUTTER REMOVAL AND REPLACEMENT

SCALE: VERT. NONE  
HORIZ. 2/1/2007

PLOT DATE: 2/1/2007

DRAWN BY  
CHECKED BY  
BD600-06 (BD-24)

REVISION DATE: 01/01/07

PLOT DATE = 2/1/2007  
FILE NAME = C:\Documents and Settings\qurshaha\Desktop\bd24.dgn  
PLOT SCALE = 50/800 / IN.  
USER NAME = qurshaha

F.A.P. RTE.	SECTION	COUNTY	TOTAL SHEETS	SHEET NO.
525	(11 & 12) RS	McHENRY	22	16
STA.		TO STA.		
FED. ROAD DIST. NO. 1		ILLINOIS FED. AID PROJECT		

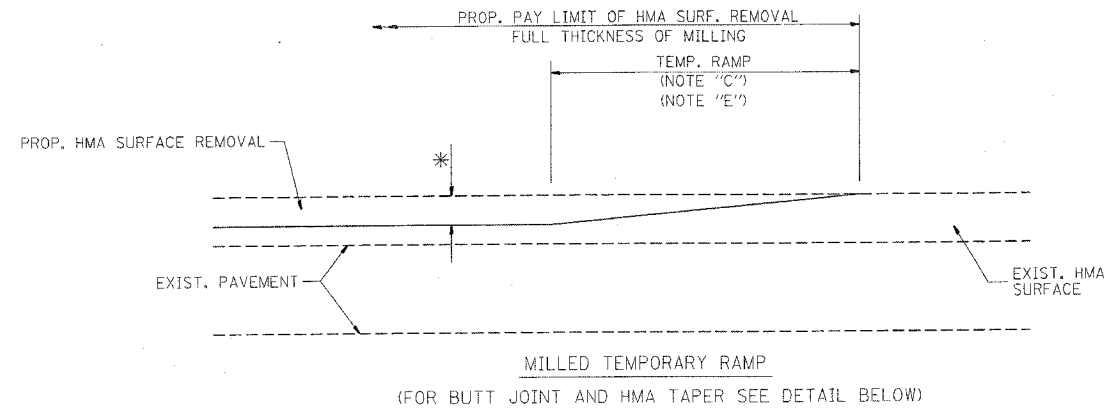

**OPTION 1**

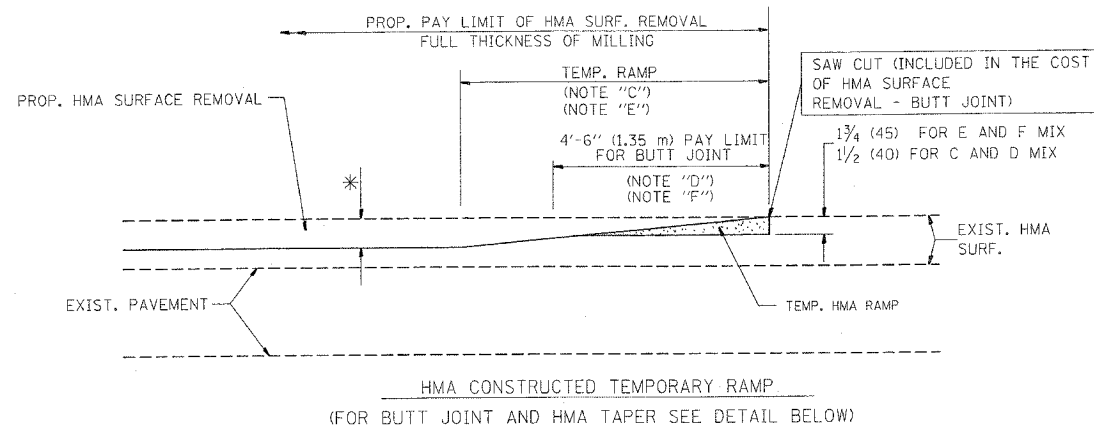

**OPTION 2**

**TYPICAL TEMPORARY RAMP**

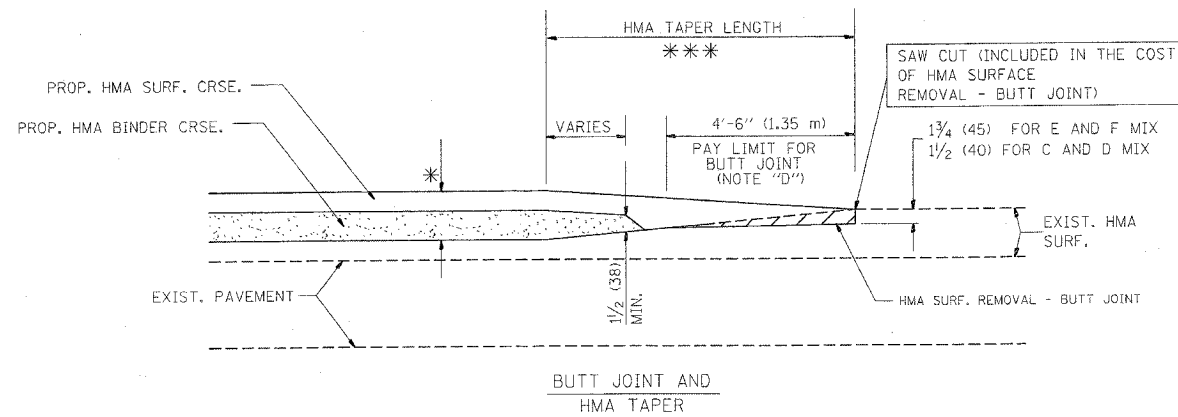

**TYPICAL BUTT JOINT AND HMA TAPER FOR MILLING AND RESURFACING**

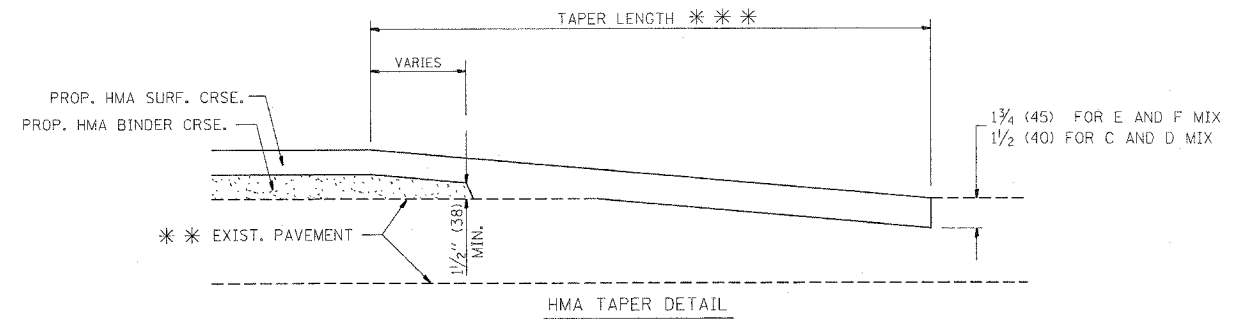
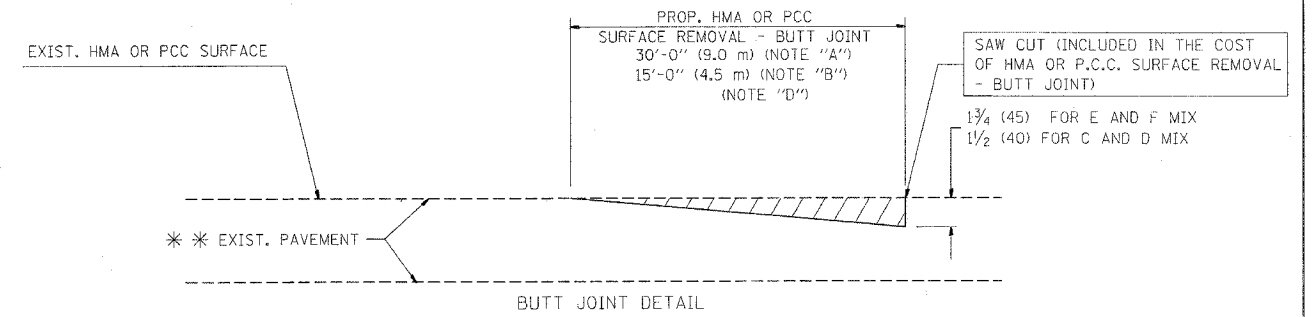

**TYPICAL BUTT JOINT AND HMA TAPER FOR RESURFACING ONLY**

\*\*\* PC CONCRETE, HMA OR HMA RESURFACED PAVEMENT.

**NOTES**

- A: MAINLINE ROADWAYS AND MAJOR SIDE ROADS.
  - B: MINOR SIDE ROADS.
  - C: THE TEMP. RAMP SHALL BE CONSTRUCTED IMMEDIATELY UPON REMOVAL OF THE EXISTING HMA SURFACE.
  - D: THE BUTT JOINT SHALL BE CONSTRUCTED IMMEDIATELY PRIOR TO PLACING THE PROPOSED HMA COURSES.
  - E: TAPER THE TEMP. RAMP AT A RATE OF 3'-0" (900 mm) PER 1 INCH (25 mm) OF MILLING THICKNESS.
  - F: INSTALLATION AND REMOVAL OF THE 4'-6" (1.35 m) TEMP. RAMP IS INCLUDED IN COST OF HMA SURFACE REMOVAL - BUTT JOINT
  - G: SEE ARTICLE 406.08 AND 406.14 OF THE STANDARD SPECIFICATIONS FOR "HMA AND/OR PCC SURFACE REMOVAL, BUTT JOINT".
- \*\*\* SEE TYPICAL SECTIONS FOR MILLING THICKNESS.

\*\*\* 20'-0" (6.1 m) PER 1 (25) RESURFACING (NOTE "A")  
 10'-0" (3.0 m) PER 1 (25) RESURFACING (NOTE "B")

ALL DIMENSIONS ARE IN INCHES (MILLIMETERS) UNLESS OTHERWISE SHOWN.

**BASIS OF PAYMENT:**

THE BUTT JOINT WILL BE PAID FOR AT THE CONTRACT UNIT PRICE PER SQUARE YARD (SQUARE METER) FOR "HOT-MIX ASPHALT SURFACE REMOVAL - BUTT JOINT" OR FOR "PORTLAND CEMENT CONCRETE SURFACE REMOVAL - BUTT JOINT".

REVISIONS	
NAME	DATE
M. DE YONG	6-13-90
M. DE YONG	7-3-90
M. DE YONG	3-27-92
R. SHAH	09/09/94
R. SHAH	10/25/94
A. ABBAS	03/21/97
M. GOMEZ	04/06/01
R. BORO	01/01/07

ILLINOIS DEPARTMENT OF TRANSPORTATION

**BUTT JOINT AND HMA TAPER DETAILS**

VERT. SCALE: NONE  
 HORIZ. SCALE: 1" = 10'  
 PLOT DATE: 2/1/2007

DRAWN BY  
 CHECKED BY

BD400-05 (VI-BD32)  
 REVISION DATE: 01/01/07



F.A.P. RTE.	SECTION	COUNTY	TOTAL SHEETS	SHEET NO.
525	(11 & 12) RS	McHENRY	22	17
STA.		TO STA.		
FED. ROAD DIST. NO.		ILLINOIS	FED. AID PROJECT	

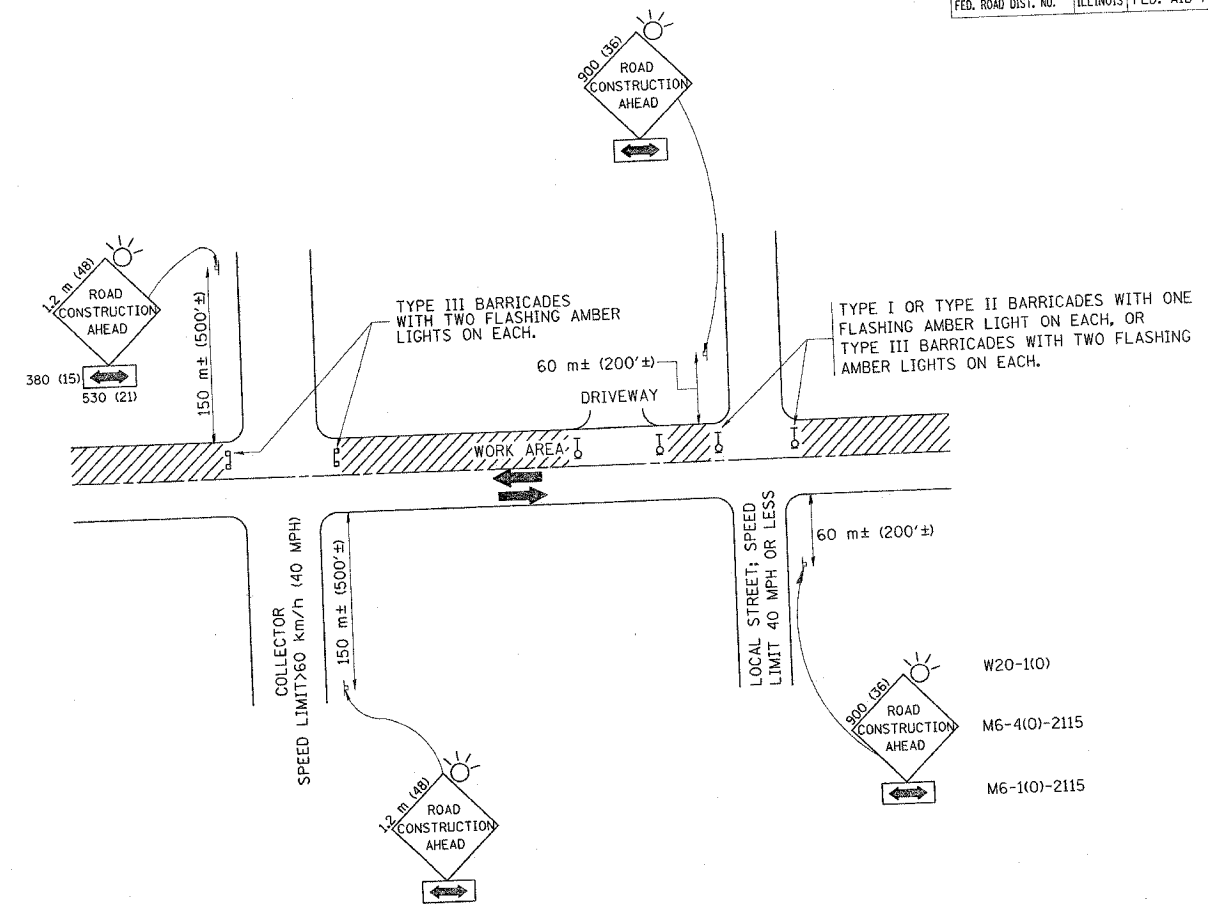

TRAFFIC CONTROL AND PROTECTION FOR SIDE ROADS, INTERSECTIONS, AND DRIVEWAYS

NOTES:

- A. FOR NO LANE RESTRICTION ON THE SIDE ROAD OR DRIVEWAYS
- SIDE ROAD WITH A SPEED LIMIT OF 60 km/h (40 MPH) OR LESS AS SHOWN ON THE DRAWING AND AS DIRECTED BY THE ENGINEER:
    - ONE ROAD CONSTRUCTION AHEAD SIGN 900x900 (36x36) WITH A FLASHER AND FLAG MOUNTED ON IT APPROXIMATELY 60 m (200') IN ADVANCE OF THE MAIN ROUTE.
    - THE CLOSED PORTION OF THE MAIN ROUTE SHALL BE PROTECTED BY BLOCKING WITH TYPE I, TYPE II OR TYPE III BARRICADES, 1/3 OF THE CROSS SECTION OF THE CLOSED PORTION.
  - SIDE ROAD WITH A SPEED LIMIT GREATER THAN 60 km/h (40 MPH) AS SHOWN ON THE DRAWING AND AS DIRECTED BY THE ENGINEER:
    - ONE ROAD CONSTRUCTION AHEAD SIGN 1.2 m x 1.2 m (48x48) WITH A FLASHER MOUNTED ON IT APPROXIMATELY 150 m (500') IN ADVANCE OF THE MAIN ROUTE.
    - THE CLOSED PORTION OF THE MAIN ROUTE SHALL BE PROTECTED BY BLOCKING WITH TYPE III BARRICADES, 1/2 OF THE CROSS SECTION OF THE CLOSED PORTION.
3. WHEN THE SIDE ROAD LIES BETWEEN THE BEGINNING OF THE MAINLINE SIGNING AND THE WORK ZONE, A SINGLE HEADED ARROW (M6-1) SHALL BE USED IN LIEU OF THE DOUBLE HEADED ARROW (M6-4).
- B. FOR A LANE CLOSURE ON A SIDE ROAD OR DRIVEWAY:  
 USE APPLICABLE PORTIONS OF THE TYPICAL APPLICATION OF TRAFFIC CONTROL DEVICES (STD. 701501, STD. 701606 OR THE APPROPRIATE STANDARD). THE SPACING OF SIGNS AND BARRICADES SHALL BE ADJUSTED FOR FIELD CONDITIONS AS DIRECTED BY THE ENGINEER. THE DIRECTIONAL ARROW SHALL BE COVERED OR REMOVED WHEN NO LONGER CONSISTENT WITH THE SIDE ROAD LANE CLOSURE.
- C. ADVANCE WARNING SIGNS ARE TO BE OMITTED ON DRIVEWAY UNLESS OTHERWISE NOTED.
- D. THE TRAFFIC CONTROL AND PROTECTION FOR SIDE ROADS, INTERSECTIONS, AND DRIVEWAYS SHALL BE INCIDENTAL TO THE COST OF SPECIFIED TRAFFIC CONTROL STANDARDS OR ITEMS.

REVISIONS	
NAME	DATE
LHA	6/89
T. RAMMACHER	09/08/94
J. OBERLE	10/18/95
A. HOUSEH	03/06/96
A. HOUSEH	10/15/96
T. RAMMACHER	01/06/00

ILLINOIS DEPARTMENT OF TRANSPORTATION  
 TRAFFIC CONTROL AND PROTECTION  
 FOR  
 SIDE ROADS, INTERSECTIONS, AND  
 DRIVEWAYS

SCALE:  
 DATE: 2/1/2007  
 DRAWN BY  
 CHECKED BY  
 TC-10  
 REVISION DATE: 01/06/00

F.A.P. RTE.	SECTION	COUNTY	TOTAL SHEETS	SHEET NO.
525	(11 & 12) RS	McHENRY	22	18
STA.		TO STA.		
FED. ROAD DIST. NO.		ILLINOIS FED. AID PROJECT		

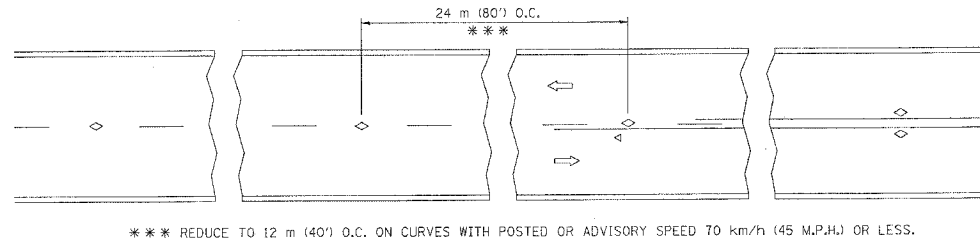

TWO-LANE/TWO-WAY

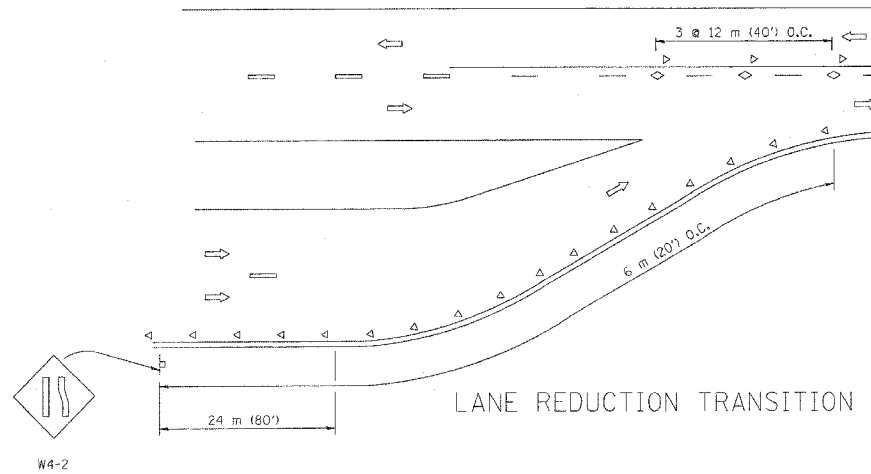

LANE REDUCTION TRANSITION

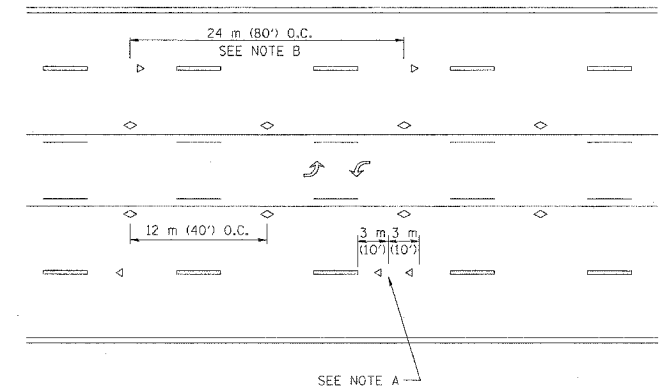

TWO-WAY LEFT TURN

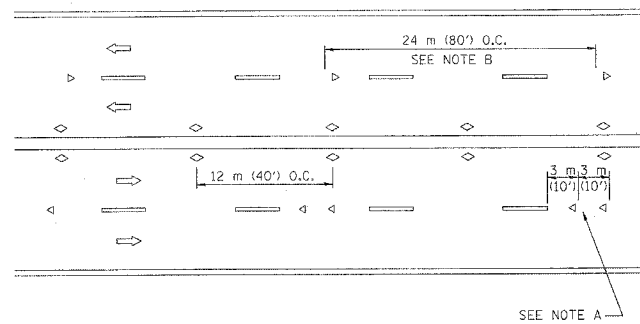

MULTI-LANE/UNDIVIDED

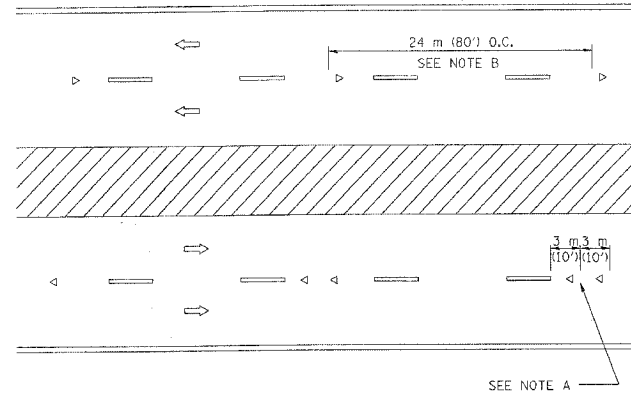

MULTI-LANE/DIVIDED

GENERAL NOTES

1. MARKERS USED WITH DASHED LINES SHALL BE CENTERED IN THE GAP BETWEEN SEGMENTS.
2. MARKERS USED ADJACENT TO SOLID LINES SHALL BE OFFSET 50 TO 75 (2 TO 3) TOWARD TRAFFIC AS SHOWN.
3. MARKERS THROUGH TANGENTS LESS THAN 150 m (500') IN LENGTH BETWEEN CURVES SHALL BE INSTALLED AT THE LESSER OF THE TWO CURVE SPACINGS.

SYMBOLS

- YELLOW STRIPE
- WHITE STRIPE
- ◁ ONE-WAY AMBER MARKER
- ◁ ONE-WAY CRYSTAL MARKER (W/O)
- ◇ TWO-WAY AMBER MARKER

LANE MARKER NOTES

- A. USE DOUBLE LANE LINE MARKERS SPACED AS SHOWN.
- B. REDUCE TO 12 m (40') O.C. ON CURVES WHERE ADVISORY SPEEDS ARE 20 km/h (10 M.P.H.) LOWER THAN POSTED SPEEDS.

DESIGN NOTES

1. DOUBLE LANE LINE MARKERS SHALL BE USED UNLESS SPECIFIED OTHERWISE.
2. EXCEPT AS SHOWN ON THE LANE REDUCTION TRANSITION AND FREEWAY EXIT RAMP DETAIL, MARKERS ARE NOT TO BE SPECIFIED ON RIGHT EDGE LINES.
3. THE EXACT MARKER LIMITS, SPACING, AND COLOR SHOULD BE INCLUDED IN THE PLANS.
4. MARKERS SHOULD NOT BE USED ALONGSIDE CURBS EXCEPT FOR EXTREMELY SHORT SECTIONS OF CURBS WHERE NOT MORE THAN TWO MARKERS WOULD BE INVOLVED.

All dimensions are in millimeters (inches) unless otherwise shown.

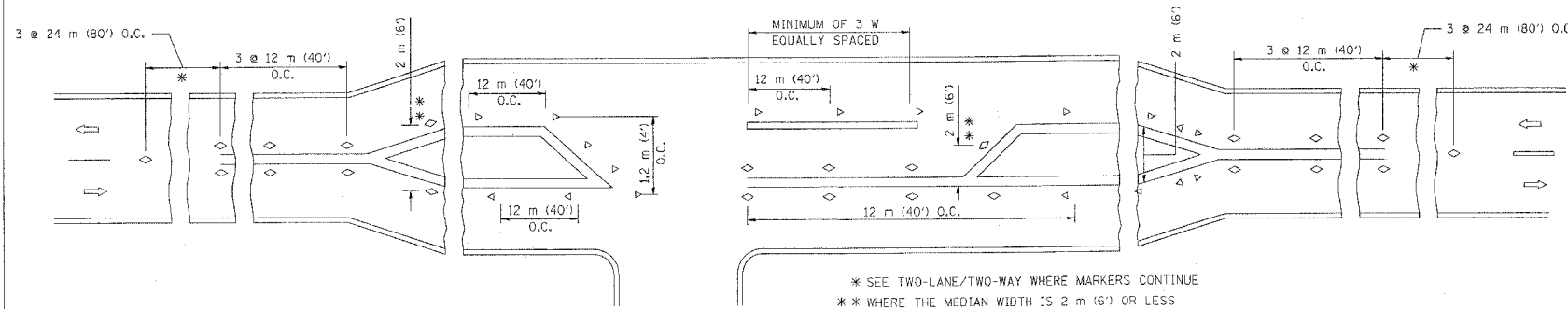

LEFT TURN

\* SEE TWO-LANE/TWO-WAY WHERE MARKERS CONTINUE  
 \*\* WHERE THE MEDIAN WIDTH IS 2 m (6') OR LESS USE TWO-WAY MARKERS.

REVISIONS	
NAME	DATE
T. RAMMACHER	09-19-94
T. RAMMACHER	03-12-99
T. RAMMACHER	01-06-00

ILLINOIS DEPARTMENT OF TRANSPORTATION  
 TYPICAL APPLICATIONS  
 RAISED REFLECTIVE PAVEMENT  
 MARKERS (SNOW-PLOW RESISTANT)

SCALE: NONE  
 DATE: 2/1/2007

DRAWN BY CADD  
 CHECKED BY  
 TC-11

REVISION DATE: 01/06/00

F.A.P. RTE.	SECTION	COUNTY	TOTAL SHEETS	SHEET NO.
525	(11 & 12) RS	McHENRY	22	19
STA.		TO STA.		
FED. ROAD DIST. NO.		ILLINOIS FED. AID PROJECT		

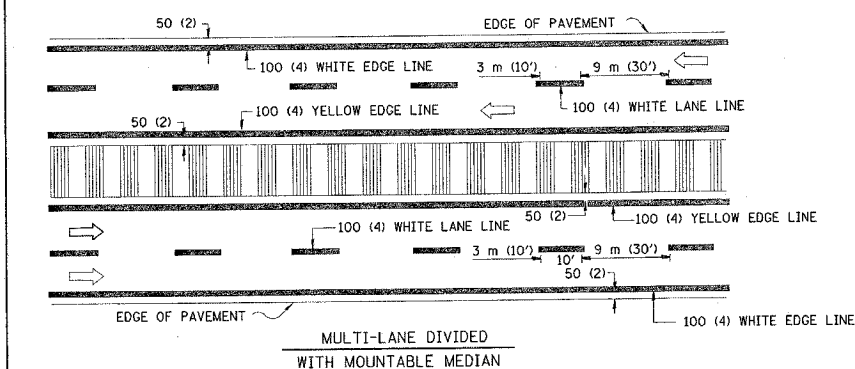
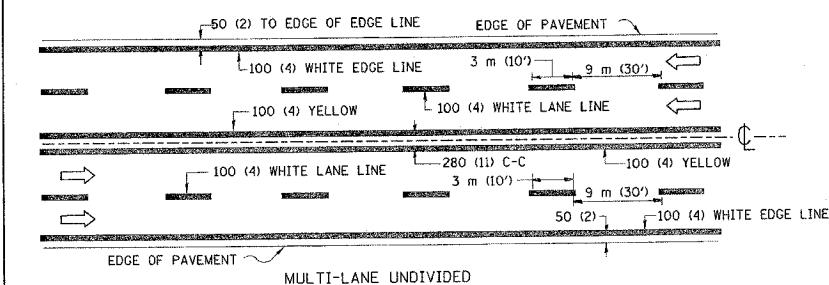
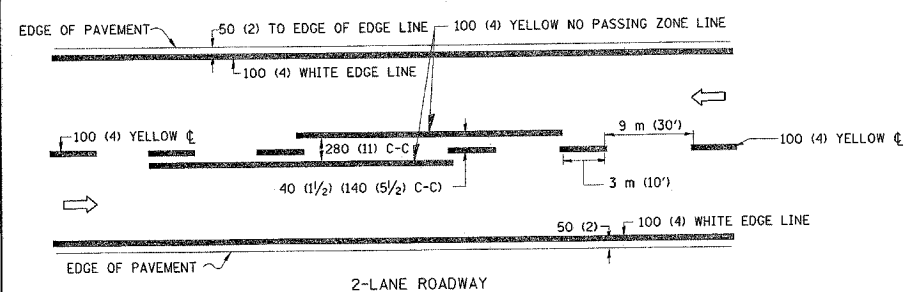

TYPICAL LANE AND EDGE LINE MARKING

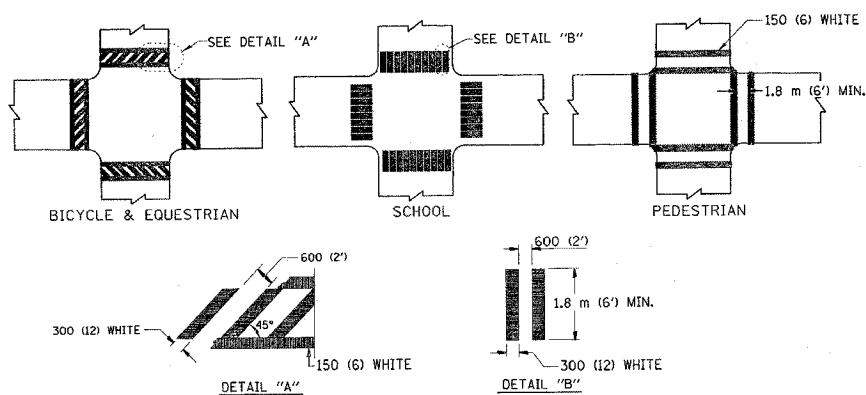

TYPICAL CROSSWALK MARKING

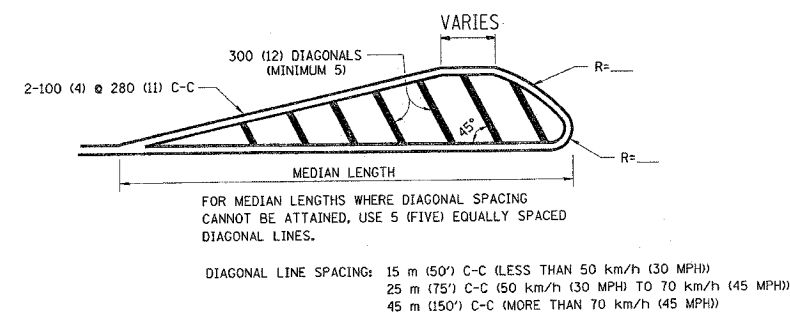
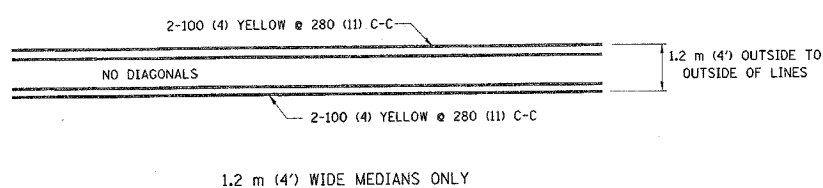

MEDIANS OVER 1.2 m (4') WIDE

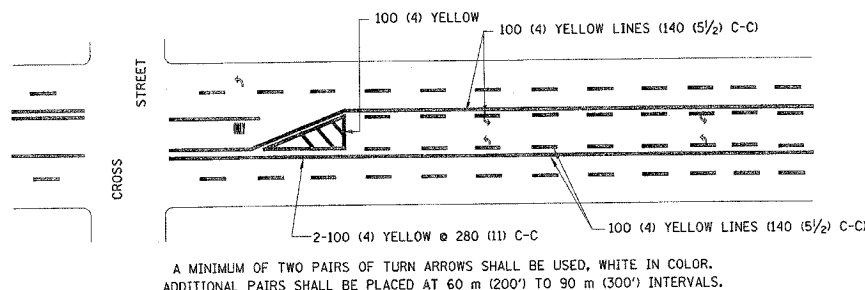

TYPICAL PAINTED MEDIAN MARKING

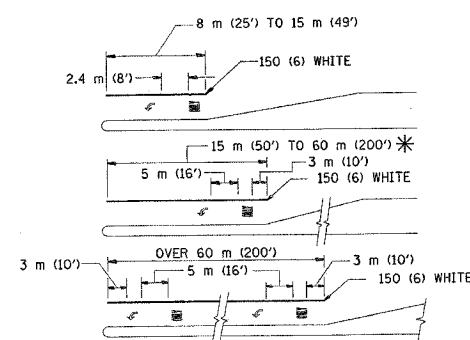

FULL SIZE LETTERS 2.4 m (8') AND ARROWS SHALL BE USED. AREA = 1.5 m<sup>2</sup> (15.6 SQ. FT.) ONLY AREA = 1.9 m<sup>2</sup> (20.8 SQ. FT.)

\* TURN LANES IN EXCESS OF 120 m (400') IN LENGTH MAY HAVE AN ADDITIONAL SET OF ARROW - "ONLY" INSTALLED MIDWAY BETWEEN THE OTHER TWO SETS OF ARROW - "ONLY".

TYPICAL LEFT (OR RIGHT) TURN LANE

TYPICAL PAINTED MEDIAN MARKING

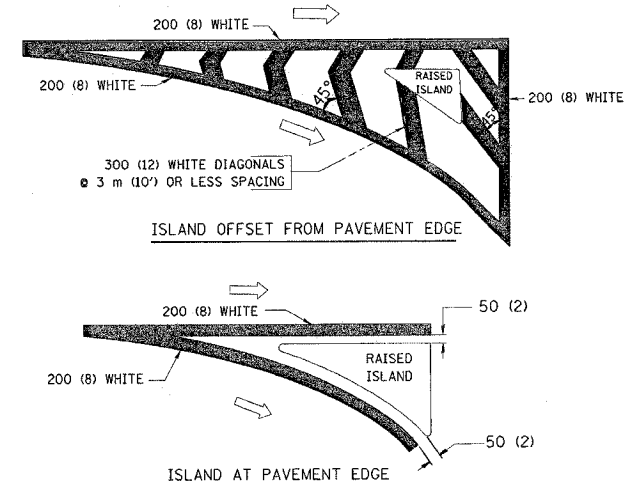

TYPICAL ISLAND MARKING

TYPE OF MARKING	WIDTH OF LINE	PATTERN	COLOR	SPACING / REMARKS
CENTERLINE ON 2 LANE PAVEMENT	100 (4)	SKIP-DASH	YELLOW	3 m (10') LINE WITH 9 m (30') SPACE
CENTERLINE ON MULTI-LANE UNDIVIDED PAVEMENT	2 @ 100 (4)	SOLID	YELLOW	280 (11) C-C
NO PASSING ZONE LINES: FOR ONE DIRECTION FOR BOTH DIRECTIONS	100 (4) 2 @ 100 (4)	SOLID SOLID	YELLOW YELLOW	140 (5 1/2) C-C FROM SKIP-DASH CENTERLINE 280 (11) C-C OMIT SKIP-DASH CENTERLINE BETWEEN
LANE LINES	100 (4) 125 (5) ON FREEWAYS	SKIP-DASH SKIP-DASH	WHITE WHITE	3 m (10') LINE WITH 9 m (30') SPACE
DOTTED LINES (EXTENSIONS OF CENTER, LANE OR TURN LANE MARKINGS)	SAME AS LINE BEING EXTENDED	SKIP-DASH	SAME AS LINE BEING EXTENDED	600 (2') LINE WITH 1.8 m (6') SPACE
EDGE LINES	100 (4)	SOLID	YELLOW-LEFT WHITE-RIGHT	OUTLINE MOUNTABLE MEDIANS IN YELLOW; EDGE LINES ARE NOT USED NEXT TO BARRIER CURB
TURN LANE MARKINGS	150 (6) LINE, FULL SIZE LETTERS & SYMBOLS (2.4 m (8'))	SOLID	WHITE	SEE TYPICAL TURN LANE MARKING DETAIL
TWO WAY LEFT TURN MARKING	2 @ 100 (4) EACH DIRECTION 2.4 m (8') LEFT ARROW	SKIP-DASH AND SOLID IN PAIRS	YELLOW WHITE	3 m (10') LINE WITH 9 m (30') SPACE FOR SKIP-DASH 140 (5 1/2) C-C BETWEEN SOLID LINE AND SKIP-DASH LINE SEE TYPICAL TWO-WAY LEFT TURN MARKING DETAIL
CROSSWALK LINES (PEDESTRIAN) A. DIAGONALS (BIKE & EQUESTRIAN) B. LONGITUDINAL BARS (SCHOOL)	2 @ 150 (6) 300 (12) @ 45° 300 (12) @ 90°	SOLID SOLID SOLID	WHITE WHITE WHITE	NOT LESS THAN 1.8 m (6') APART 600 (2') APART 600 (2') APART SEE TYPICAL CROSSWALK MARKING DETAILS.
STOP LINES	600 (24)	SOLID	WHITE	PLACE 1.2 m (4') IN ADVANCE OF AND PARALLEL TO CROSSWALK, IF PRESENT. OTHERWISE, PLACE AT DESIRED STOPPING POINT. PARALLEL TO CROSSROAD CENTERLINE, WHERE POSSIBLE
PAINTED MEDIANS	2 @ 100 (4) WITH 300 (12) DIAGONALS @ 45° NO DIAGONALS USED FOR 1.2 m (4') WIDE MEDIANS	SOLID	YELLOW; TWO WAY TRAFFIC WHITE; ONE WAY TRAFFIC	280 (11) C-C FOR THE DOUBLE LINE SEE TYPICAL PAINTED MEDIAN MARKING.
GORE MARKING AND CHANNELIZING LINES	200 (8) WITH 300 (12) DIAGONALS @ 45°	SOLID	WHITE	DIAGONALS: 4.5 m (15') C-C (LESS THAN 50 km/h (30 MPH)) 6 m (20') C-C (50 km/h (30 MPH) TO 70 km/h (45 MPH)) 9 m (30') C-C (OVER 70 km/h (45 MPH))
RAILROAD CROSSING	600 (24) TRANSVERSE LINES; "RR" IS 1.8 m (6') LETTERS; 400 (16) LINE FOR "X"	SOLID	WHITE	SEE STATE STANDARD 780001 AREA OF: "R"=0.33m <sup>2</sup> (3.6 SQ. FT.) EACH "X"=5.0 m <sup>2</sup> (54.0 SQ. FT.)
SHOULDER DIAGONALS	300 (12) @ 45°	SOLID	WHITE - RIGHT YELLOW - LEFT	15 m (50') C-C (LESS THAN 50 km/h (30 MPH)) 25 m (75') C-C (50 km/h (30 MPH) TO 70 km/h (45 MPH)) 45 m (150') C-C (OVER 70 km/h (45 MPH))

FOR FURTHER DETAILS ON PAVEMENT MARKING REFER TO STANDARD SPECIFICATIONS FOR ROAD AND BRIDGE CONSTRUCTION AND STATE STANDARD 780001.

All dimensions are in millimeters (inches) unless otherwise shown.

REVISIONS	
NAME	DATE
EVERS	03-19-90
T. RAMMACHER	10-27-94
ALEX HOUSEH	10-09-96
ALEX HOUSEH	10-17-96
T. RAMMACHER	01-06-00

ILLINOIS DEPARTMENT OF TRANSPORTATION  
DISTRICT ONE  
TYPICAL PAVEMENT MARKINGS

SCALE: NONE  
DATE: 2/1/2007

DRAWN BY CADD  
CHECKED BY  
TC-13  
REVISION DATE: 01/06/00



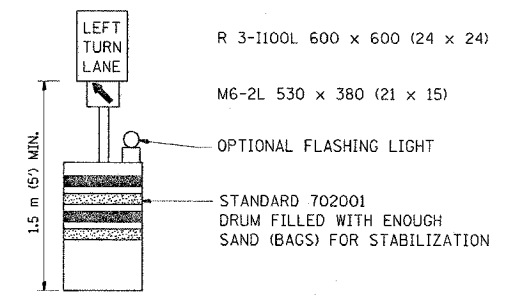
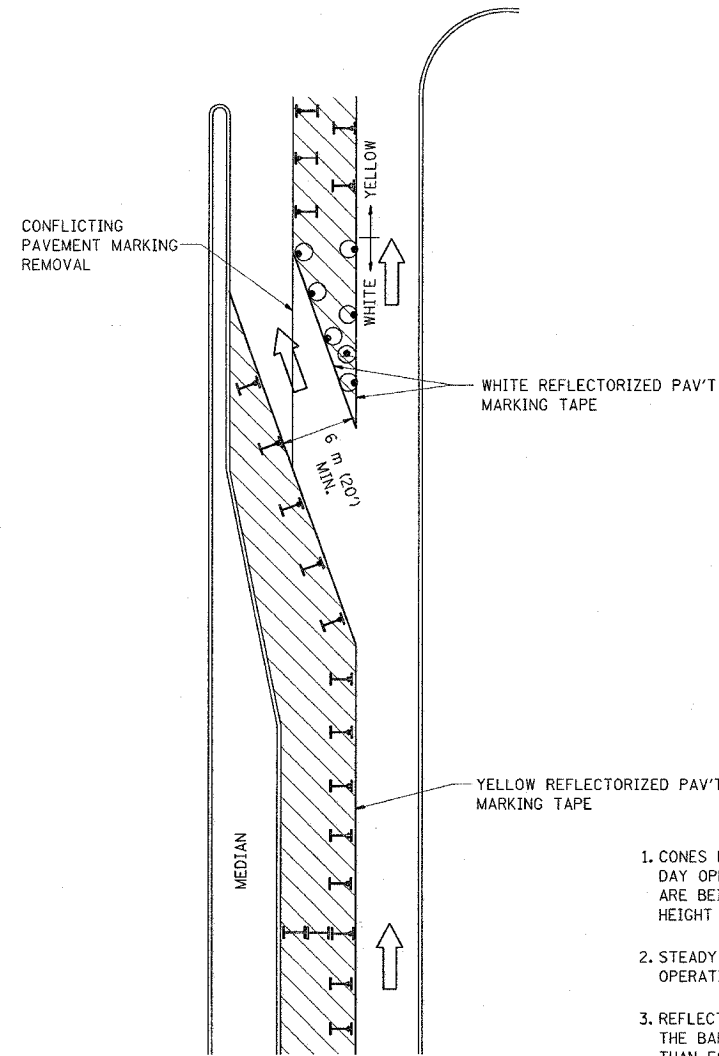

F.A.P. RTE.	SECTION	COUNTY	TOTAL SHEETS	SHEET NO.
525	(11 & 12) RS	MCHENRY	22	20
STA.		TO STA.		
FED. ROAD DIST. NO.	ILLINOIS	FED. AID PROJECT		

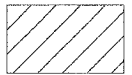
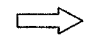

**GENERAL NOTES**

1. CONES MAY BE SUBSTITUTED FOR BARRICADES OR DRUMS AT HALF THE SPACING DURING DAY OPERATIONS. CONES SHALL BE A MINIMUM OF 710 (28) IN HEIGHT. WHEN CONES ARE BEING USED, THE "LEFT TURN LANE" SIGN MAY BE SKID MOUNTED AT A MINIMUM HEIGHT OF 1.5 m (5').
2. STEADY BURNING LIGHTS WILL NOT BE REQUIRED ON BARRICADES OR DRUMS FOR DAY OPERATIONS. ALL LIGHTS SHALL BE MONODIRECTIONAL.
3. REFLECTORIZED TEMPORARY PAVEMENT MARKING TAPE SHALL BE PLACED THROUGHOUT THE BARRICADED AREA OF EACH TURN BAY WHERE THE CLOSURE TIME IS GREATER THAN FOURTEEN DAYS.
4. THIS APPLICATION ALSO APPLIES WHEN WORK IS BEING PERFORMED IN THE RIGHT LANE(S) AND THE RIGHT TURN BAY IS TO REMAIN OPEN. UNDER THIS CONDITION, "RIGHT TURN LANE" R3-100 600 x 600 (24 x 24) AND M6-2R 530 x 380 (21 x 15) SHALL BE USED.
5. THESE CONTROLS SHALL SUPPLEMENT MAINLINE TRAFFIC CONTROL FOR LANE CLOSURES.
6. LONGITUDINAL DIMENSIONS MAY BE ADJUSTED TO FIT FIELD CONDITIONS.
7. FORM BT 725 IS REQUIRED.
8. TRAFFIC CONTROL AND PROTECTION AT TURN BAYS (TO REMAIN OPEN TO TRAFFIC) SHALL BE INCLUDED IN THE COST SPECIFIED TRAFFIC CONTROL STANDARDS OR ITEMS.

**LEGEND**

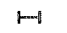
-  WORK AREA
-  LANE OPEN TO TRAFFIC
-  TYPE I OR II BARRICADE WITH STEADY BURN LIGHT
-  DRUM WITH STEADY BURN LIGHT
-  DRUM WITH SIGN (WITH OPTIONAL FLASHING LIGHT) SEE DETAIL
-  TYPE I OR II CHECK BARRICADE WITH FLASHING LIGHT

All dimensions are in millimeters (Inches) unless otherwise shown.

REVISIONS	
NAME	DATE
T. RAMMACHER	09/08/94
A. HOUSEH	11/07/95
A. HOUSEH	10/12/96
T. RAMMACHER	01/06/00

**ILLINOIS DEPARTMENT OF TRANSPORTATION  
TRAFFIC CONTROL AND PROTECTION  
AT TURN BAYS  
(TO REMAIN OPEN TO TRAFFIC)**

SCALE: NONE  
DATE: 2/1/2007  
DRAWN BY  
CHECKED BY LHA

PLOT DATE = 2/1/2007  
 PLOT SCALE = 50.0000  
 USER NAME = garshtup

F.A.P. RTE.	SECTION	COUNTY	TOTAL SHEETS	SHEET NO.
525	(11 & 12) RS	McHENRY	22	21
STA.		TO STA.		
FED. ROAD DIST. NO.		ILLINOIS FED. AID PROJECT		

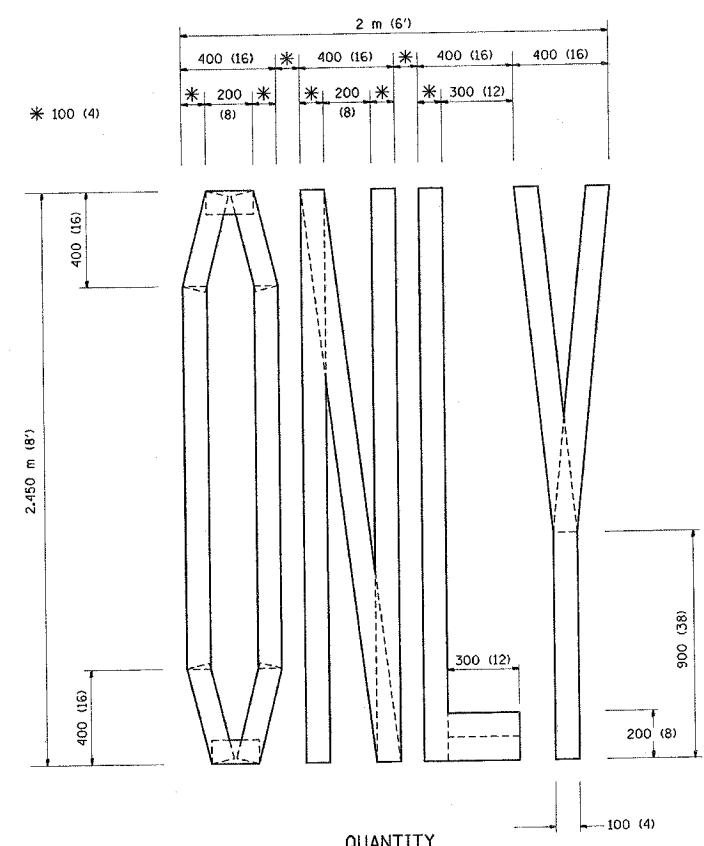

QUANTITY  
 100 (4) LINE = 19.7 m (64.1 ft.)  
 1.97 sq. m (21.1 sq. ft.)

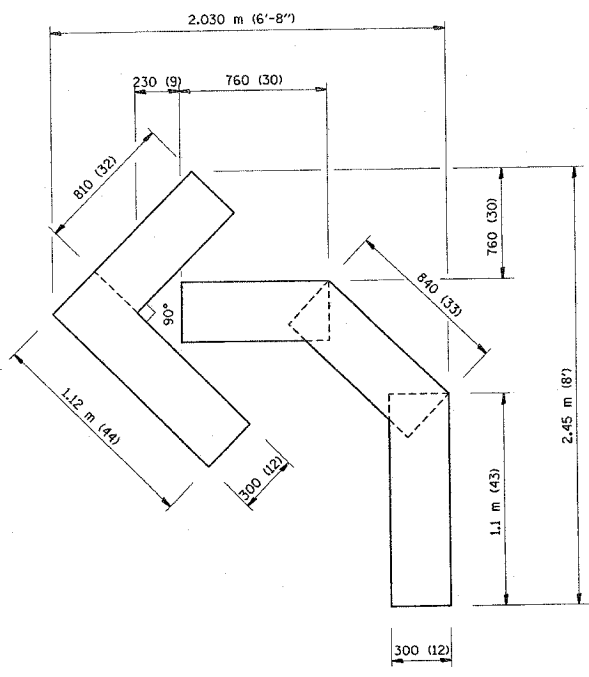

QUANTITY  
 100 (4) LINE = 13.9 m (45.5 ft.)  
 1.39 sq. m (15.2 sq. ft.)

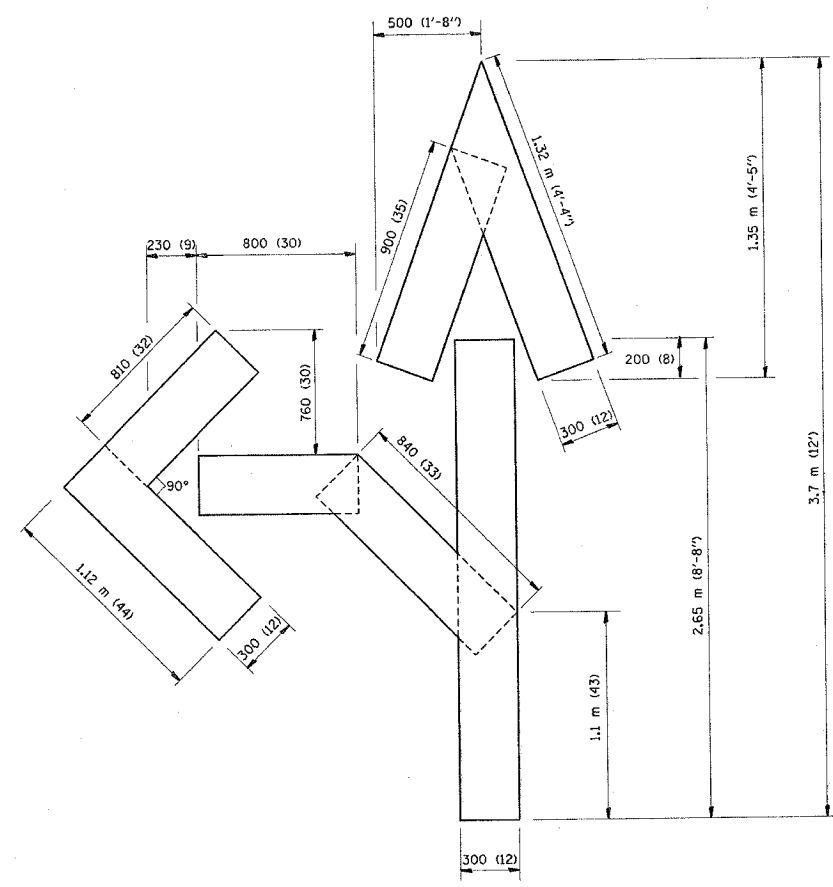

QUANTITY  
 100 (4) LINE = 25.3 m (82.5 ft.)  
 2.53 sq. m (27.5 sq. ft.)

All dimensions are in millimeters (inches) unless otherwise shown.

REVISIONS	
NAME	DATE
T. RAMMACHER	09/18/94
J. OBERLE	06/01/96
T. RAMMACHER	06/05/96
T. RAMMACHER	11/04/97
T. RAMMACHER	03/02/98
E. GOMEZ	08/28/00

ILLINOIS DEPARTMENT OF TRANSPORTATION

PAVEMENT MARKING  
 LETTERS AND SYMBOLS  
 FOR TRAFFIC STAGING

SCALE: NONE  
 DATE: 2/1/2007

DRAWN BY CADD  
 CHECKED BY  
 TC-16

CONTRACT NO. 60B63				
F.A.P. RTE.	SECTION	COUNTY	TOTAL SHEETS	SHEET NO.
525	(11 & 12) RS	McHENRY	22	22
STA.		TO STA.		
FED. ROAD DIST. NO.	ILLINOIS	FED. AID PROJECT		

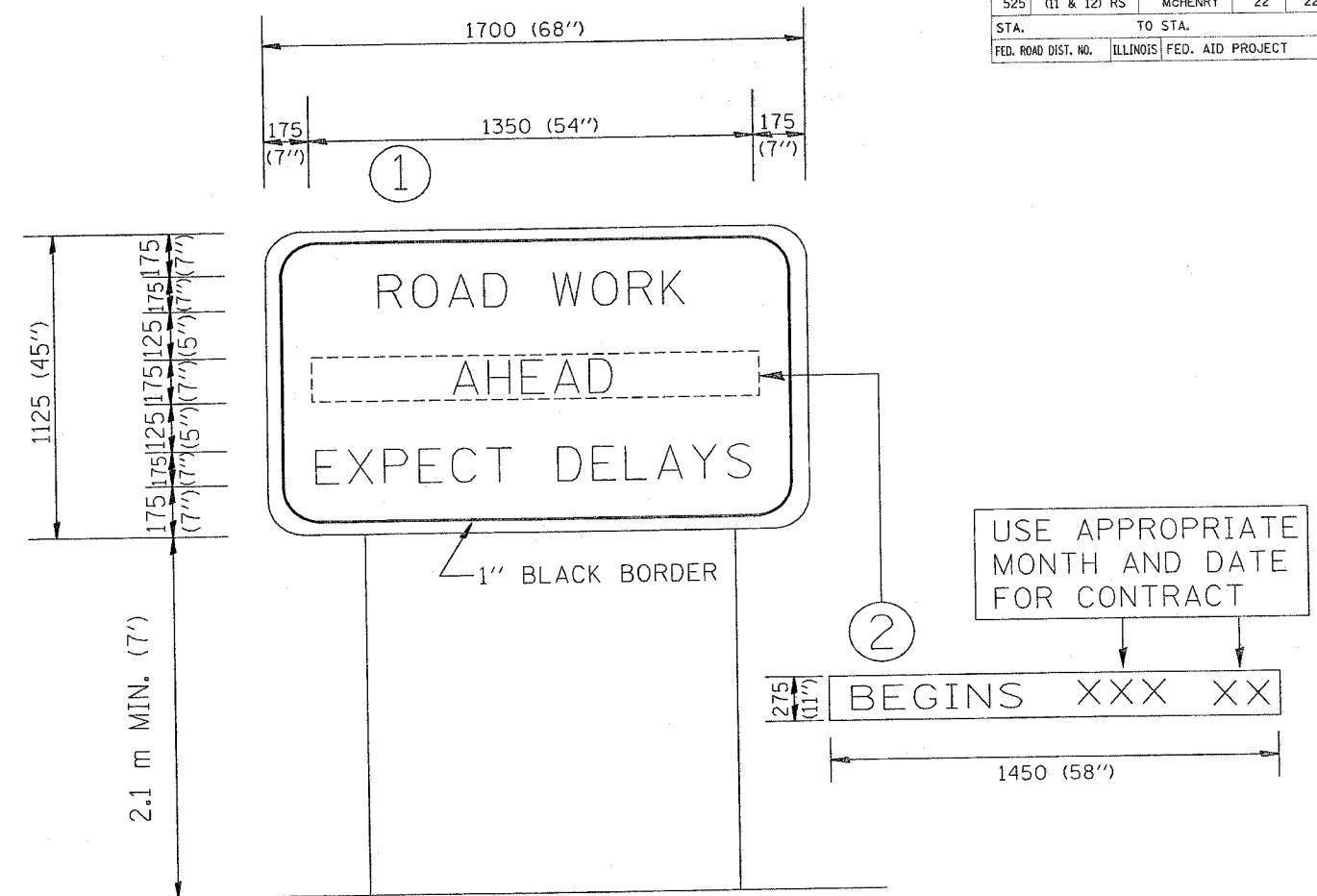

NOTES:

1. USE BLACK LETTERING ON ORANGE BACKGROUND.
2. ERECT SIGNS IN ADVANCE OF THE LOCATION FOR THE "ROAD CONSTRUCTION AHEAD" SIGN AT LOCATIONS AS DIRECTED BY THE ENGINEER.
3. ERECT SIGN ① WITH INSTALLED PANEL ② ONE WEEK PRIOR TO THE START OF CONSTRUCTION.
4. REMOVE PANEL ② SOON AFTER THE START OF CONSTRUCTION.
5. SEE SPECIAL PROVISION FOR "TEMPORARY INFORMATION SIGNING" FOR ADDITIONAL INFORMATION.
6. ONE SIGN ASSEMBLY EQUALS 2.3 SQ. M. (25.70 SQ. FT.)

ALL DIMENSIONS ARE IN MILLIMETERS (INCHES) UNLESS OTHERWISE SHOWN.

REVISIONS	
NAME	DATE
R. MIRS	9-15-97
R. MIRS	12-11-97
T. RAMMACHER	2-2-99

ILLINOIS DEPARTMENT OF TRANSPORTATION  
TEMPORARY INFORMATION SIGNING

SCALE:  
DATE: 2/1/2007

DRAWN BY DESIGN  
CHECKED BY

TC22  
REVISION DATE: 02/02/99

F.A.P. RTE.	SECTION	COUNTY	TOTAL SHEETS	SHEET NO.
S25	(11 & 12) RS	McHENRY	22	22A
STA.		TO STA.		
FED. ROAD DIST. NO. 1 ILLINOIS FED. AID PROJECT				

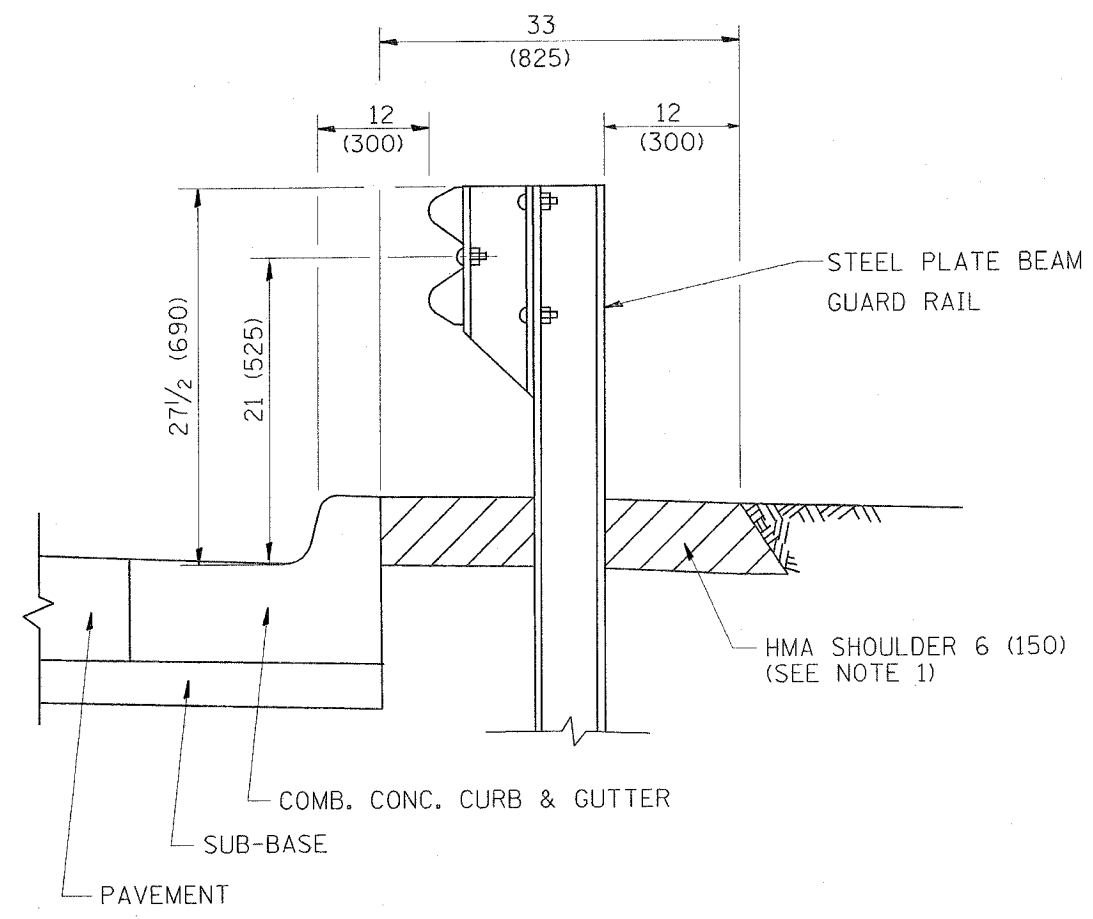

- NOTES: 1. THE HMA SHOULDER SHALL EXTEND UNDER THE TRAFFIC BARRIER TERMINAL
2. GUARD RAIL MAY BE PLACED AT THE BACK OF CURB WHEN DIRECTED BY THE ENGINEER.

BASIS OF PAYMENT: HMA SHOULDER 6 (150) WILL BE PAID FOR AT THE CONTRACT UNIT PRICE PER SQUARE YARD (SQUARE METER) FOR "HOT-MIX ASPHALT SHOULDER 6" (150 mm)".

STEEL PLATE BEAM GUARD RAIL AND TRAFFIC BARRIER TERMINAL, OF THE TYPE SPECIFIED WILL BE PAID FOR SEPARATELY.

**DETAILS FOR STEEL PLATE BEAM GUARD RAIL ADJACENT TO CURB AND GUTTER**  
 [FOR ROADWAY SPEED 35 MPH (60 kmh) TO 45 MPH (70 kmh)]

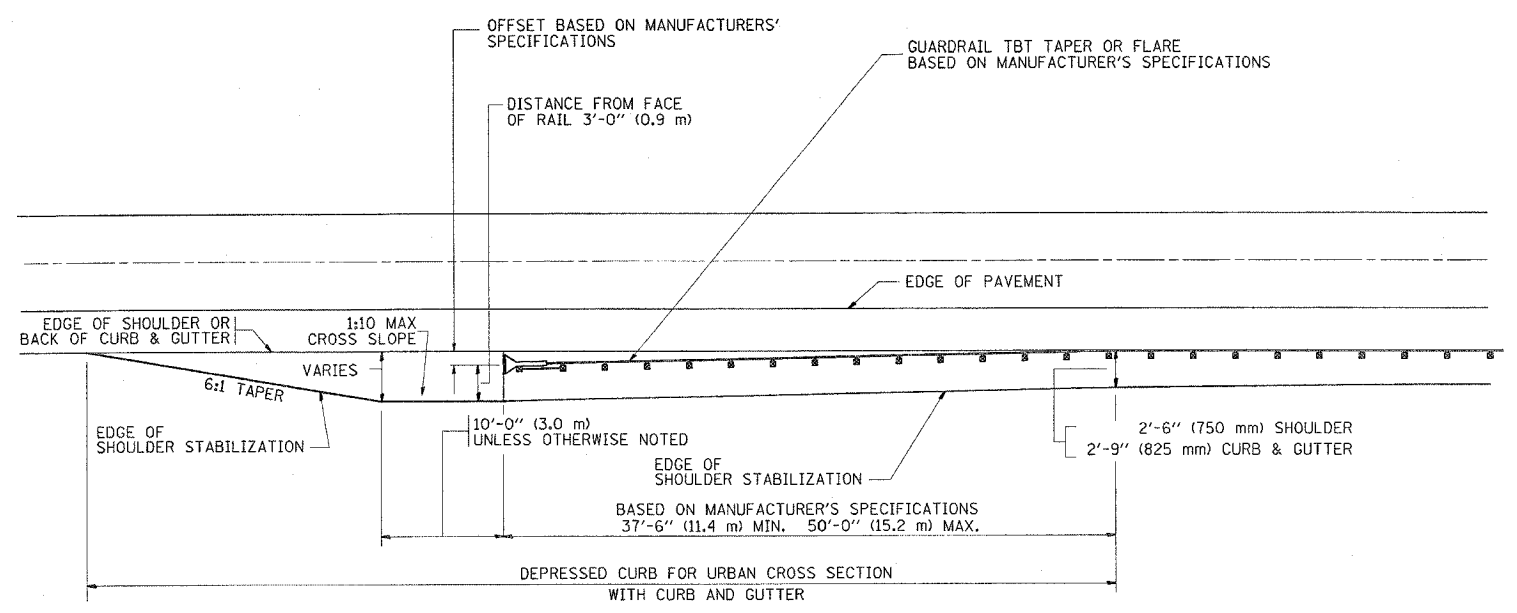

**STABILIZATION AT TBT TY. 1 SPL.**

TBT = TRAFFIC BARRIER TERMINAL  
 ALL DIMENSIONS ARE IN INCHES (MILLIMETERS) UNLESS OTHERWISE SHOWN.

REVISIONS	
NAME	DATE
M. DE YONG	09-22-90
M. DE YONG	07-14-92
R. SHAH	09/09/94
R. SHAH	10/25/94
R. SHAH	02/23/95
A. ABBAS	03/21/97
E. GOMEZ	08/28/00
R. BORO	01/01/07

ILLINOIS DEPARTMENT OF TRANSPORTATION  
**DETAILS FOR STEEL PLATE BEAM GUARD RAIL ADJACENT TO CURB AND GUTTER STABILIZATION AT TBT TY 1 SPL.**  
 SCALE: VERT. NONE  
 HORIZ. NONE  
 PLOT DATE: 2/1/2007  
 DRAWN BY Jjs  
 CHECKED BY

PLOT DATE = 2/1/2007  
 FILE NAME = C:\Documents and Settings\qureshjo\Desktop\bd600.dgn  
 PLOT SCALE = 56.25000 / 1 IN.  
 USER NAME = qureshjo