

F.A.P. RTE.	SECTION	COUNTY	TOTAL SHEETS	SHEET NO.
303	1308B-4	BOONE	147	34
STA. 422+00		TO STA. 452+00		
FED. ROAD DIST. NO.		ILLINOIS	FED. AID PROJECT	

UTILITY, DRAINAGE, & EROSION CONTROL DETAILS

STAGE III - RUNAROUND REMOVAL

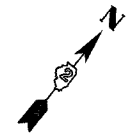

04-16-300-008
The Old Second National Bank
of Aurora, as Trustee

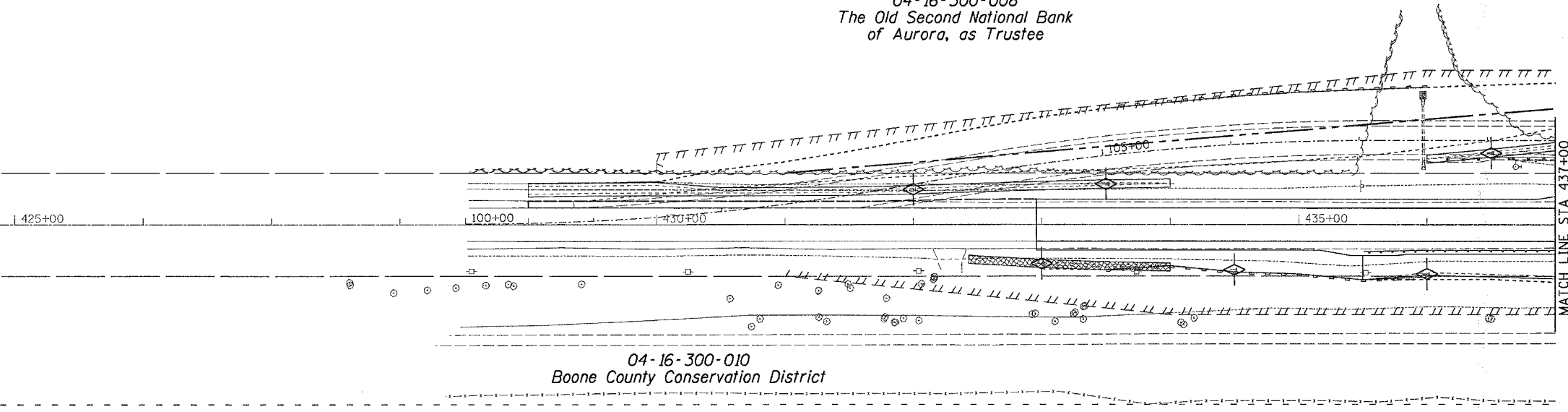

04-16-300-010
Boone County Conservation District

04-16-300-007
Robert H. Balzer & Joyce M Balzer

LEGEND

- = INLET PIPE PROTECTION
- = EROSION CONTROL BLANKET
(PLACE ON ALL DITCH BOTTOMS & 1:2 FORESLOPES & BACKSLOPES)
- = PERIMETER EROSION BARRIER
- = TEMPORARY DITCH CHECK

04-16-300-008
The Old Second National Bank
of Aurora, as Trustee

PROPOSED C OF BEAVER CREEK
CHANNEL REALIGNMENT

40-16-300-009
Donald G. Meier
as Trustee

40-16-300-003
Donald G. Meier as Trustee

STONE RIP RAP CL A4
3.5' X 8' W/ FILTER FABRIC
LT STA 439+12.27

BRIDGE APPROACH SHOULDER DRAINS
LT STA 439+12.27 (STAGE II)
32' 12" PIPE DRAIN W/ END SECTION
(PER STANDARD 609006) - STAGE III

STONE RIP RAP CL A4
3.5' X 8' W/ FILTER FABRIC
LT STA 440+70.78

BRIDGE APPROACH SHOULDER DRAINS
LT STA 440+70.78 (STAGE II)
33.5' 12" PIPE DRAIN W/ END SECTION
(PER STANDARD 609006) - STAGE III

NOTES:

TURF REINFORCEMENT MAT TO BE USED
ON PROPOSED CHANNEL FORESLOPE
STA 999+50 TO STA 999+75
STA 1000+75 TO STA 1002+25

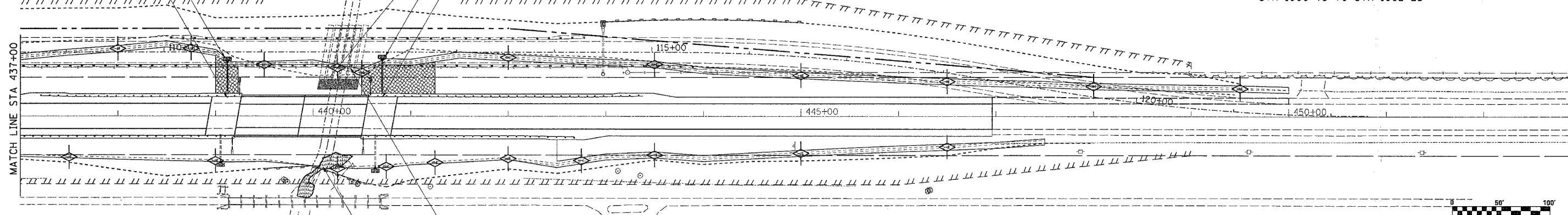

04-16-300-010
Boone County Conservation District

04-16-300-004
Donald G. Meier as Trustee

REVISIONS	
NAME	DATE

ILLINOIS DEPARTMENT OF TRANSPORTATION

SCALE: VERT. _____
HORIZ. _____
DATE _____

DRAWN BY _____
CHECKED BY _____

PLOT DATE = Fri Feb 23 09:58:44 2007
FILE NAME = c:\projects\view\04163002\04163002.dgn
USER NAME = g1621rps