

F.A.I. RTE.	SECTION	COUNTY	TOTAL SHEETS	SHEET NO.
57	(38-3,38-5)L	IRROQUOIS	16	6
STA.		TO STA.		
FED. ROAD DIST. NO.	ILLINOIS	FED. AID PROJECT		

PROPOSED ALIGNMENT DATA				
ALIGNMENT		STATION	NORTHING	EASTING
GILMAN, IL				
RAMP A	BEGIN	10+00.00	1489790.8906	1074817.2944
	PC	17+96.79	1488994.9371	1074853.6985
	PT	23+75.78	1488492.0023	1075104.8396
	PC	26+39.14	1488324.7480	1075308.2715
	PT	30+06.15	1488006.8842	1075470.2209
	END	31+65.51	1487847.8088	1075479.7397
RAMP B	BEGIN	20+00.00	1487849.1845	1075502.7304
	PC	22+33.56	1487625.3303	1075436.1003
	PT	24+61.39	1487432.5854	1075319.3257
	PC	27+24.48	1487249.3130	1075130.5749
	PT	32+56.80	1486774.0467	1074921.5254
	END	38+54.47	1486176.5850	1074905.5140
RAMP C	BEGIN	30+00.00	1489436.6893	1074693.0460
	PC	35+99.27	1488837.6538	1074676.3118
	PT	41+38.60	1488357.3723	1074462.5520
	PC	44+01.90	1488175.7445	1074271.9260
	PT	46+41.95	1487968.7300	1074155.8060
	END	48+55.95	1487761.6517	1074101.8220
RAMP D	BEGIN	40+00.00	1485892.2946	1074779.5697
	PC	47+28.21	1486619.7664	1074746.7113
	PT	53+60.59	1487121.9203	1074495.2541
	PC	55+69.96	1487289.0419	1074291.7004
	PT	59+33.71	1487603.5374	1074129.7343
	END	60+93.47	1487762.9305	1074118.9131
I-57	BEGIN	551+51.86	1497387.3359	1074567.5035
	END	669+12.78	1485629.3560	1074851.9500
ASHKUM, IL				
RAMP A	BEGIN	0+00.00	1536219.0467	1086053.5875
	PC	8+65.19	1537083.0123	1086007.6985
	PT	11+52.25	1537364.6006	1086051.6850
	END	21+02.20	1538252.6549	1086388.9733
RAMP B	BEGIN	0+00.00	1535009.2021	1084645.9434
	PC	2+85.89	1535211.7378	1084847.7338
	PT	4+92.60	1535363.8010	1084987.6602
	PC	6+74.37	1535502.3383	1085105.3364
	PT	11+04.60	1535725.3463	1085465.1195
	PC	13+70.14	1535789.2704	1085722.8499
	PT	17+50.72	1536018.9260	1086011.7163
	END	19+78.91	1536222.3203	1086115.1666
RAMP C	BEGIN	0+00.00	1537627.2664	1086014.1197
	PC	6+72.59	1537016.4705	1085732.5038
	PT	12+00.57	1536662.9697	1085357.7220
	PC	14+66.94	1536565.7547	1085109.7248
	PT	17+89.59	1536353.6729	1084876.0185
	END	20+16.94	1536151.0291	1084772.9466
RAMP D	BEGIN	0+00.00	1536154.3070	1084834.6065
	PC	6+42.70	1535516.3451	1084756.7273
	PCC	10+78.11	1535128.3626	1084575.4978
	PT	15+33.73	1534799.3099	1084260.2787
	END	20+27.61	1534446.6401	1083914.6238
IL 116	BEGIN	645+00.00	1536109.6297	1083993.4191
	END	675+00.00	1536268.7419	1086989.1967
I-57	BEGIN	100+00.00	1538920.7216	1086596.6641
	PC	122+31.02	1536851.3241	1085762.9687
	END	145+93.74	1534900.8363	1084459.3728

CALC BY: JLF - CHECK BY: JJK

Alignment.s2a

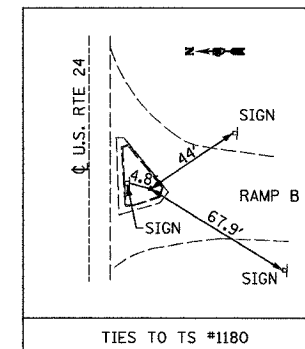
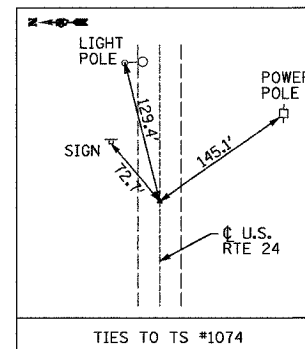

GILMAN TIES

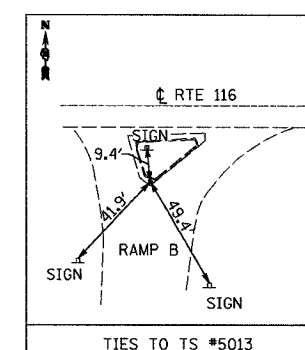
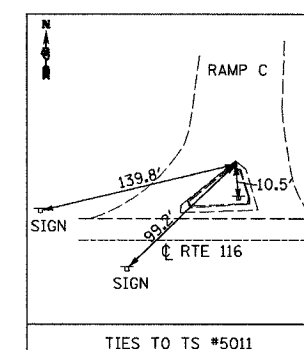
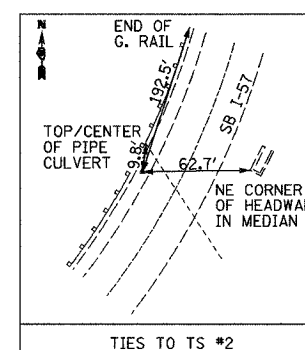
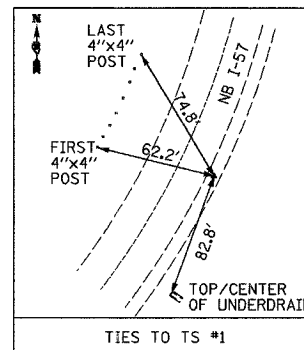

ASHKUM TIES

REVISIONS	
NAME	DATE

ILLINOIS DEPARTMENT OF TRANSPORTATION
FAI ROUTE 57

SURVEY TIES

SCALE: VERT. NO SCALE
HORIZ. 1"=40'

DRAWN BY: JJK
CHECKED BY: JLF

PLOT TIME = 4:28:47 PM
PLOT DATE = 12/21/2006
FILE NAME = X:\CHARTS\2006\060888\Plans\I-57\exchange Plans\alignment ties\gilman.dgn
USER = JLF
DATE = 12/21/2006