

F.A.I. RTE.	SECTION	COUNTY	TOTAL SHEETS	SHEET NO.
57	(46-2HB)I	KANKAKEE	10	6
FED. ROAD DIST. NO.		ILLINOIS	NON-FED. AID PROJECT	

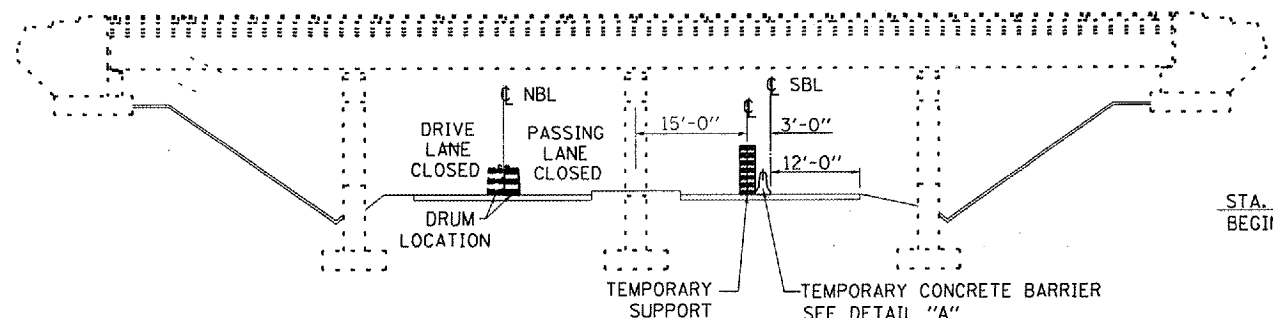

ELEVATION  
LOOKING SOUTH

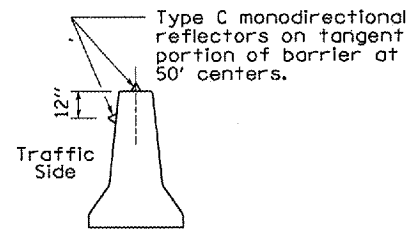

DETAIL A  
(BARRIER WALL REFLECTORS)

**IL 50 TRAFFIC CONTROL**  
TC&P STANDARD 701601

TEMPORARY PAVEMENT MARKING LINE 4"

STA. 1316+45  
BEGIN TAPER

STA. 1313+92  
BEGIN TAPER  
TEMPORARY CONCRETE BARRIER

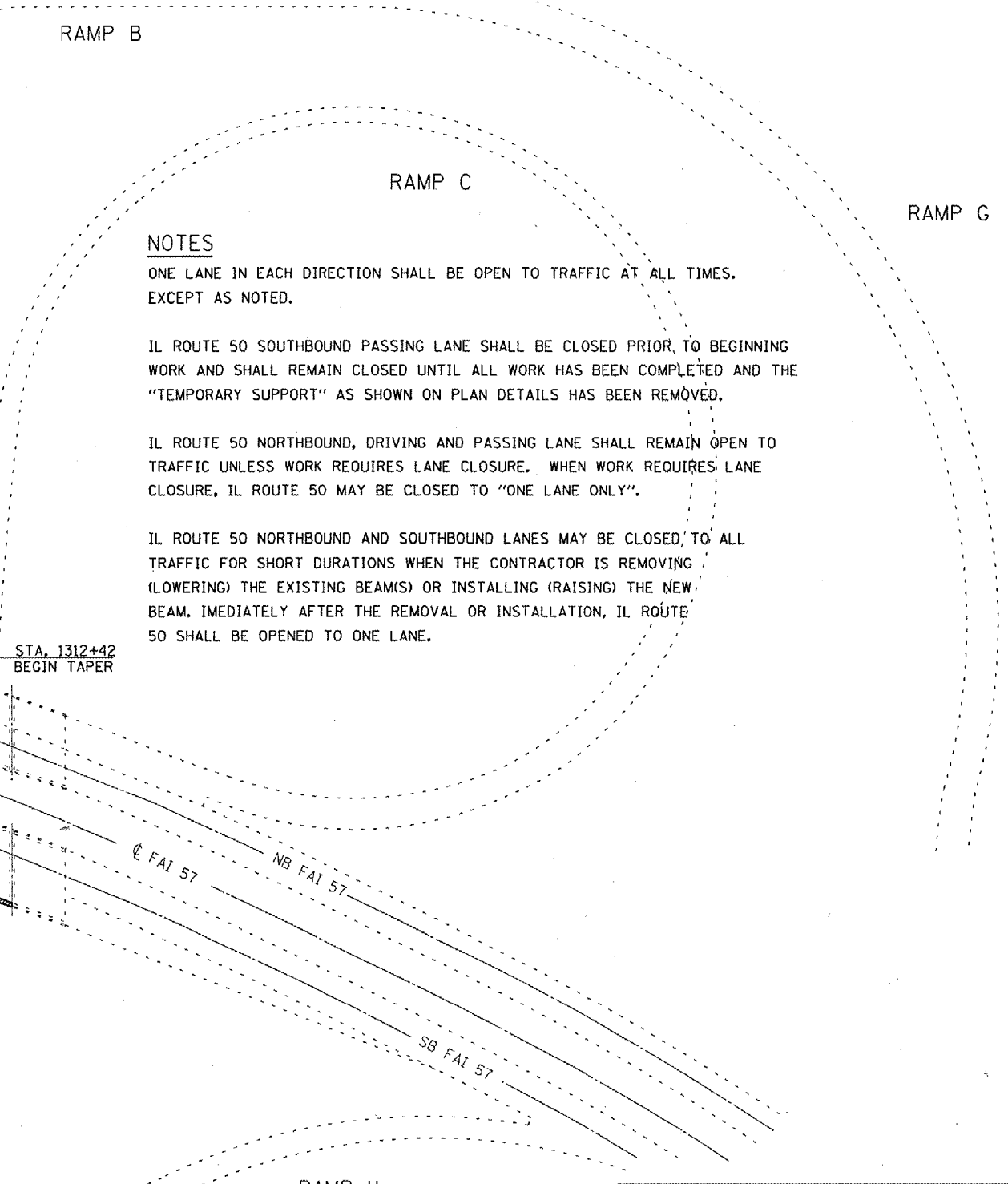

**NOTES**

ONE LANE IN EACH DIRECTION SHALL BE OPEN TO TRAFFIC AT ALL TIMES. EXCEPT AS NOTED.

IL ROUTE 50 SOUTHBOUND PASSING LANE SHALL BE CLOSED PRIOR TO BEGINNING WORK AND SHALL REMAIN CLOSED UNTIL ALL WORK HAS BEEN COMPLETED AND THE "TEMPORARY SUPPORT" AS SHOWN ON PLAN DETAILS HAS BEEN REMOVED.

IL ROUTE 50 NORTHBOUND, DRIVING AND PASSING LANE SHALL REMAIN OPEN TO TRAFFIC UNLESS WORK REQUIRES LANE CLOSURE. WHEN WORK REQUIRES LANE CLOSURE, IL ROUTE 50 MAY BE CLOSED TO "ONE LANE ONLY".

IL ROUTE 50 NORTHBOUND AND SOUTHBOUND LANES MAY BE CLOSED TO ALL TRAFFIC FOR SHORT DURATIONS WHEN THE CONTRACTOR IS REMOVING (LOWERING) THE EXISTING BEAMS) OR INSTALLING (RAISING) THE NEW BEAM. IMMEDIATELY AFTER THE REMOVAL OR INSTALLATION, IL ROUTE 50 SHALL BE OPENED TO ONE LANE.

STA. 1312+42  
BEGIN TAPER

STA. 1310+42  
END TEMPORARY CONCRETE BARRIER

**SYMBOLS**

- Work area
- BARRICADES DRUMS AND TEMPORARY PAVEMENT MARKING EDGE LINE
- TEMPORARY CONCRETE BARRIER

REVISIONS	
NAME	DATE

ILLINOIS DEPARTMENT OF TRANSPORTATION  
**TRAFFIC CONTROL FOR IL ROUTE 50**  
FAI ROUTE 57 (I-57) SECTION: (46-2HB)I  
KANKAKEE COUNTY  
S.N. 046-0014 (SB)  
STA. 311+37.70

DATE: 12/20/2006  
c:\projects\main07\cm317\details.dgn