

F.A.I. RTE.	SECTION	COUNTY	TOTAL SHEETS	SHEET NO.
57	(46-2HB)I	KANKAKEE	10	7
FED. ROAD DIST. NO.		ILLINOIS	NON-FED. AID PROJECT	

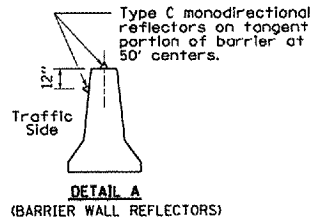
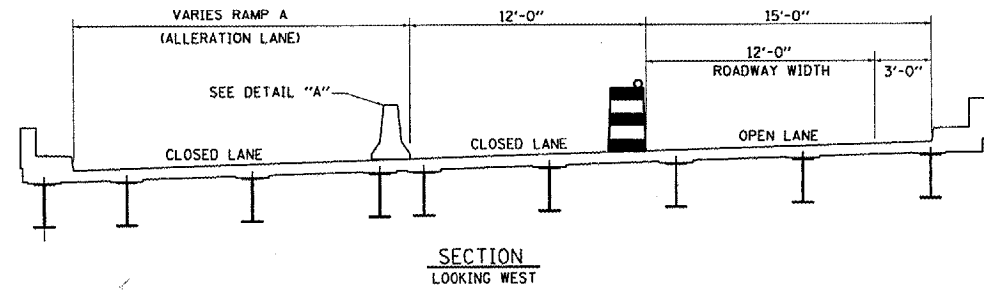

FAI 57 TRAFFIC CONTROL

TC&P STANDARD 701400
TC&P STANDARD 701401
TC&P STANDARD 701411

NOTES

TRAFFIC CONTROL FOR FAI 57 SOUTHBOUND SHALL BE ACCORDING TO TRAFFIC CONTROL AND PROTECTION STANDARD, 701400 AND 701401 EXCEPT AS MODIFIED AS SHOWN

TRAFFIC CONTROL FOR RAMP SHALL BE ACCORDING TO TRAFFIC CONTROL AND PROTECTION STANDARD 701411 EXCEPT AS MODIFIED AS SHOWN

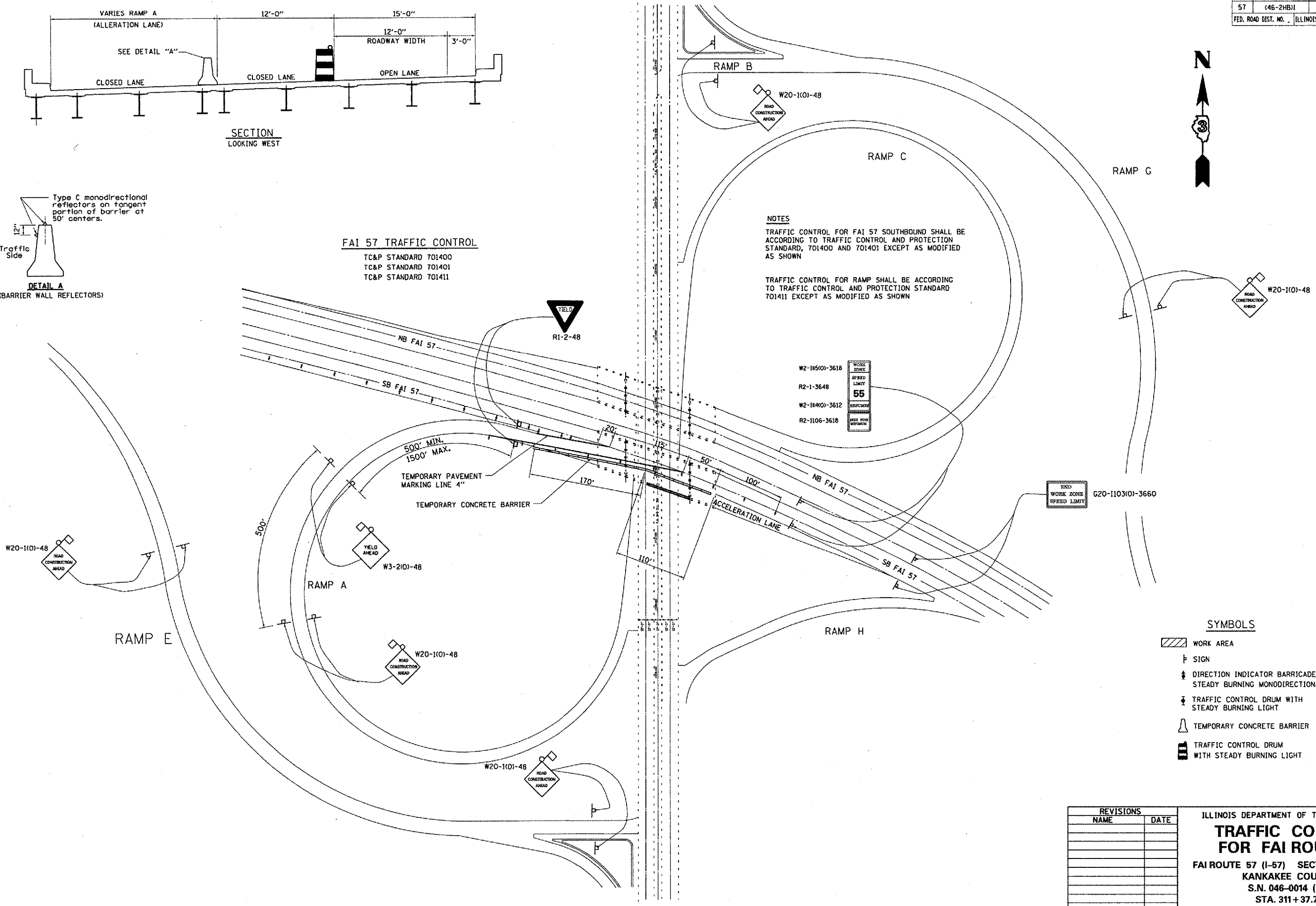

SYMBOLS

- WORK AREA
- SIGN
- DIRECTION INDICATOR BARRICADE WITH STEADY BURNING MONODIRECTIONAL LIGHT
- TRAFFIC CONTROL DRUM WITH STEADY BURNING LIGHT
- TEMPORARY CONCRETE BARRIER
- TRAFFIC CONTROL DRUM WITH STEADY BURNING LIGHT

REVISIONS	
NAME	DATE

ILLINOIS DEPARTMENT OF TRANSPORTATION
TRAFFIC CONTROL FOR FAI ROUTE 57
FAI ROUTE 57 (I-57) SECTION: (46-2HB)I
KANKAKEE COUNTY
S.N. 046-0014 (SB)
STA. 311+37.70

DATE: 12/20/2006
ci/projects/cmnh07/cm317/details.dgn