

F.A.I. RTE.	SECTION	COUNTY	TOTAL SHEETS	SHEET NO.
57874	**	**	151	33
STA. 722+00 TO STA. 737+00				
FED. ROAD DIST. NO. ILLINOIS FED. AID PROJECT				
* D5 CABLE GUARD 2007-2				
** CHAMPAIGN, DEWITT & DOUGLAS				

TAPER **	
STATION	OFFSET C
722+00	16' RT
722+50	15' RT
723+00	14' RT
723+50	13' RT
724+00	12' RT
724+50	11' RT
725+00	10' RT

EXIST. CURVE DATA  
 PI STA. = 731+02.65  
 $\Delta = 37^\circ 43' 06''$  (LT)  
 $D = 1^\circ 30' 03''$   
 $R = 3,817.85'$   
 $T = 1,304.10'$   
 $L = 2,513.32'$   
 $E = 216.58'$   
 P.C. STA. = 717+98.55  
 P.T. STA. = 743+11.87

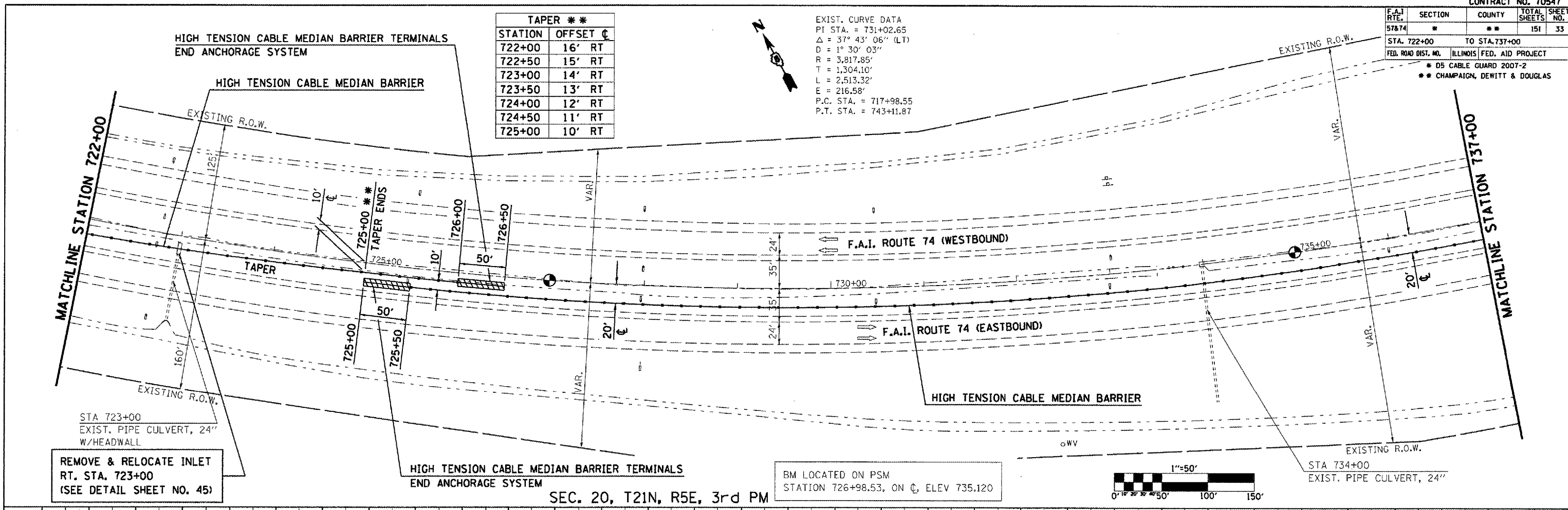

PLAN	SURVEYED	DATE
NOTED	BY	
NO. 1		

STA 723+00  
 EXIST. PIPE CULVERT, 24"  
 W/HEADWALL  
 REMOVE & RELOCATE INLET  
 RT. STA. 723+00  
 (SEE DETAIL SHEET NO. 45)

BM LOCATED ON PSM  
 STATION 726+98.53, ON C, ELEV 735.120

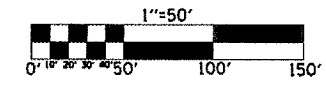

SEC. 20, T21N, R5E, 3rd PM

PROFILE	SURVEYED	DATE
NOTED	BY	
NO. 1		

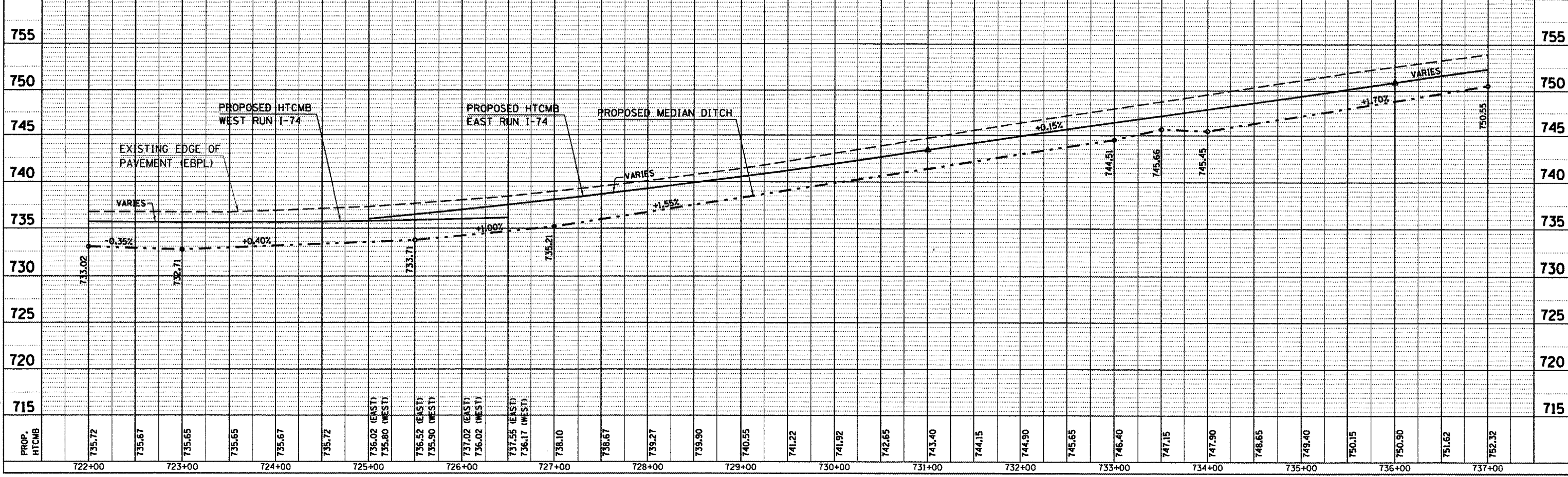

DATE: 10/20/2008  
 FILE NAME: c:\projects\70547\70547.dwg  
 PLOT SCALE: 1/8" = 1'-0"  
 USER: phillips