

F.A.I. RTE.	SECTION	COUNTY	TOTAL SHEETS	SHEET NO.
578.74	**	**	151	34
STA. 737+00 TO STA. 752+00				
FED. ROAD DIST. NO. ILLINOIS FED. AID PROJECT				
* D5 CABLE GUARD 2007-2				
** CHAMPAIGN, DEWITT & DOUGLAS				

STATION EQUATION:
 STATION 746+30.29 @ F.A.I. 74 =
 STATION 14910+91.51 N.Y.C. R.R.

STATION 746+30.29
 REINFORCED CONCRETE DECKS
 ON STEEL BEAM GIRDERS
 2 END SPANS 1 @ 66'-0" & 84'-2"
 2 CENTER SPANS 1 @ 87'-2" & 1 @ 122'-3"
 39'-0" ROADWAY, SKEWED 44°-57'-15"

STATION EQUATION:
 STATION 747+41.92 @ F.A.I. 74 =
 STATION 172+12.64 @ U.S. 150

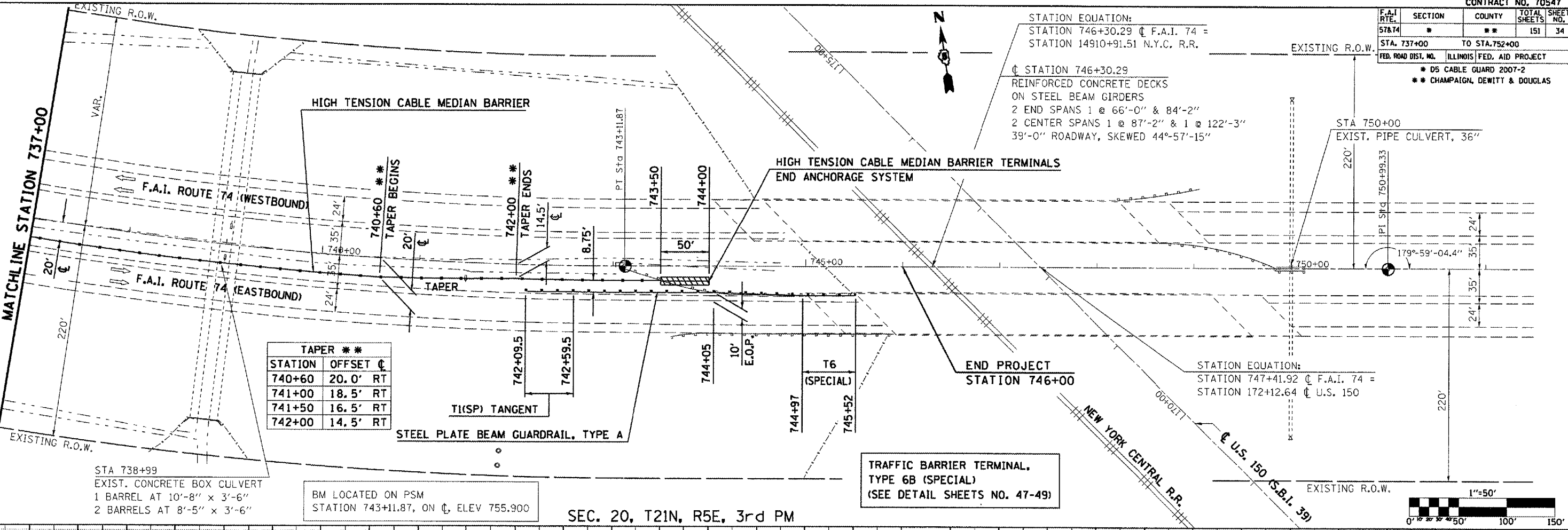

STATION	OFFSET	CL
740+60	20.0'	RT
741+00	18.5'	RT
741+50	16.5'	RT
742+00	14.5'	RT

BM LOCATED ON PSM
 STATION 743+11.87, ON CL, ELEV 755.900

SEC. 20, T21N, R5E, 3rd PM

TRAFFIC BARRIER TERMINAL,
 TYPE 6B (SPECIAL)
 (SEE DETAIL SHEETS NO. 47-49)

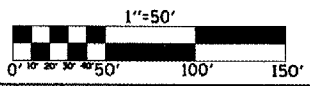

PLAN	SURVEYED	DATE
NO.	BY	
NO.	BY	

PROFILE	SURVEYED	DATE
NO.	BY	
NO.	BY	

PLOT DATE: 12/1/2008
 FILE NAME: c:\projects\70547\70547\form-cats\sheet3.dgn
 PLOT SCALE: 1/8" = 1'-0"
 USER NAME: philip.p.

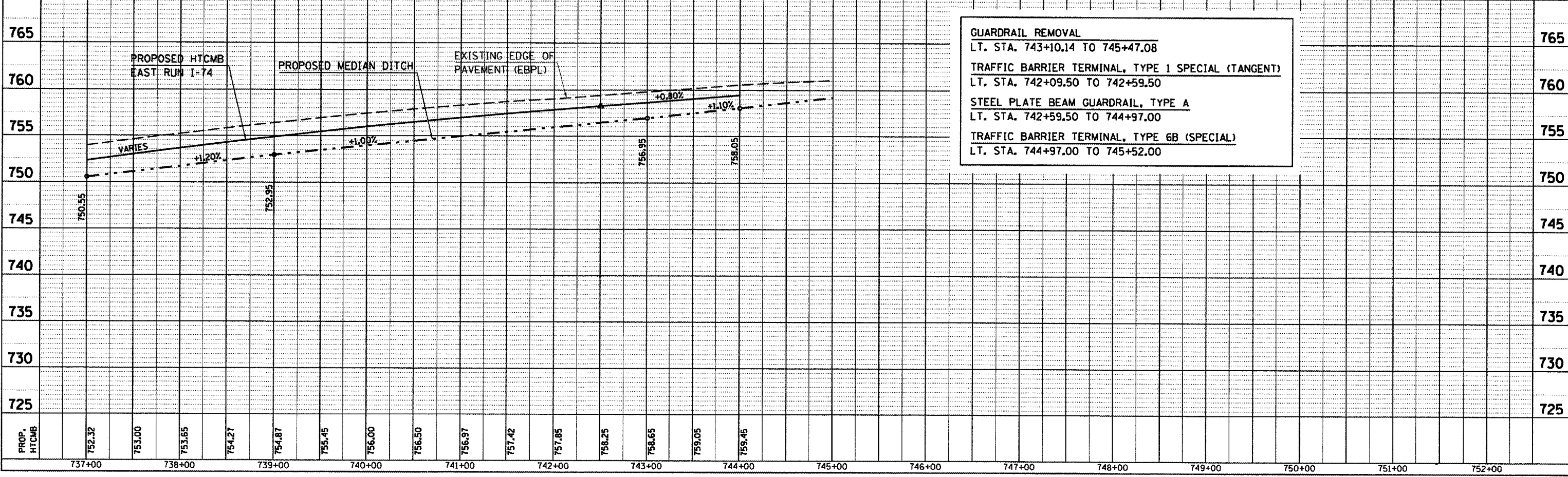

GUARDRAIL REMOVAL
 LT. STA. 743+10.14 TO 745+47.08

TRAFFIC BARRIER TERMINAL, TYPE 1 SPECIAL (TANGENT)
 LT. STA. 742+09.50 TO 742+59.50

STEEL PLATE BEAM GUARDRAIL, TYPE A
 LT. STA. 742+59.50 TO 744+97.00

TRAFFIC BARRIER TERMINAL, TYPE 6B (SPECIAL)
 LT. STA. 744+97.00 TO 745+52.00