

STATE OF ILLINOIS
DEPARTMENT OF TRANSPORTATION

F.A.P. RTE.	SECTION	COUNTY	TOTAL SHEETS	SHEET NO.
612	101B-1	SCHUYLER	15	13
FED. ROAD DIST. NO.	ILLINOIS	FED. AID PROJECT		

SHEET NO. 1
OF 1 SHEETS

CONTRACT NO. 72310

Existing Structure: The existing structure, built in 1928, is a 10' x 7' Double Box Culvert x 223' long.

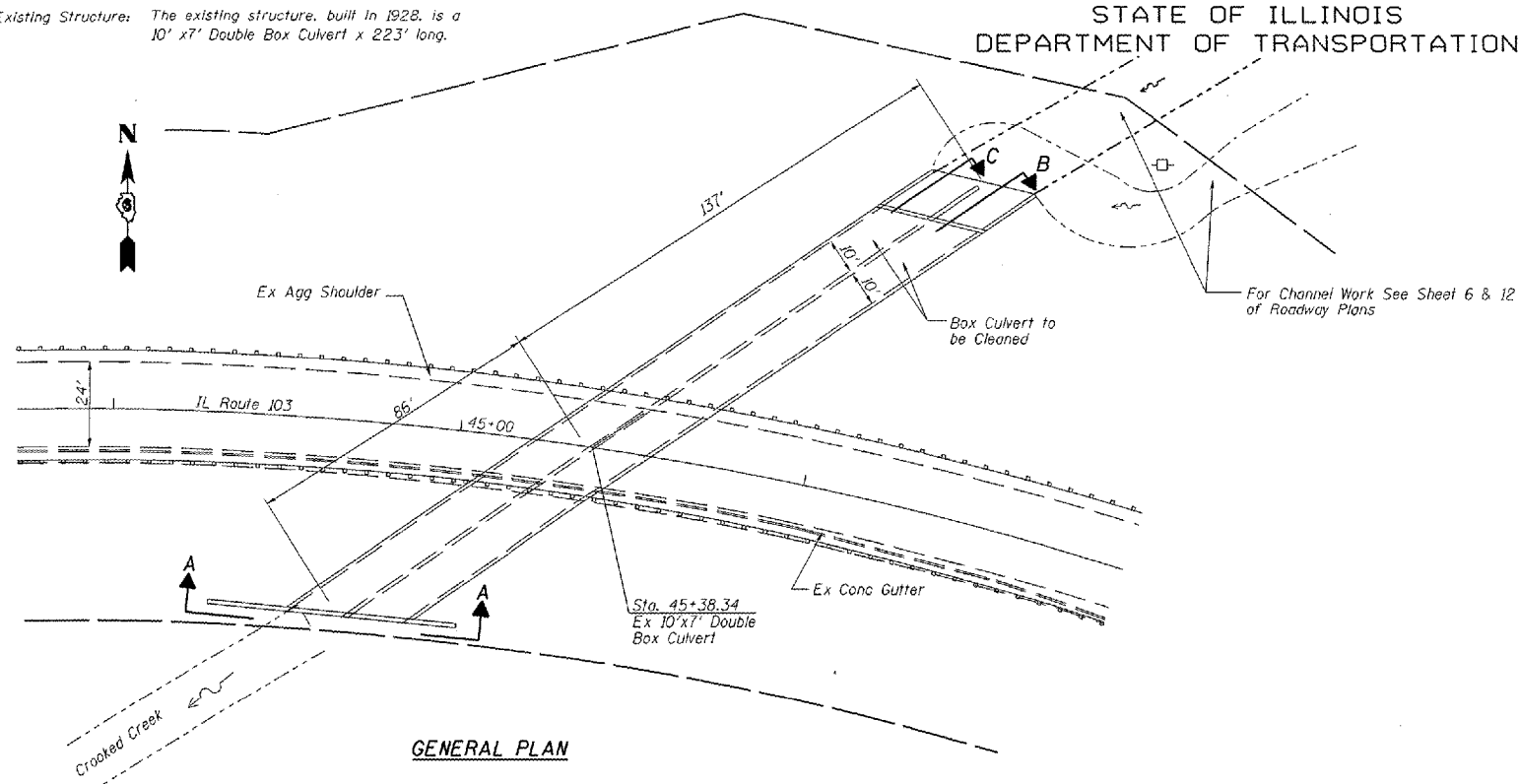

GENERAL NOTES

This work shall be constructed in accordance with the plans, the "Standard Specifications for Road and Bridge Construction" adopted Jan. 1, 2007, the "Supplemental Specifications and Recurring Special Provisions" adopted Jan. 1, 2007, and the special provisions included in the proposal.

Plan dimensions and details relative to existing plans are subject to routine variations. The Contractor shall field verify existing dimensions and details affecting new construction and make necessary approved adjustments prior to construction or ordering of materials. Such variations shall not be cause for additional compensation for a change in scope of the work, however, the Contractor will be paid for the quantity actually furnished based upon the unit price bid for the work.

Reinforcement bars shall conform to the requirements of ASTM A 706 Gr 60 (IL Modified). See Special Provisions.

Repair quantities are based on survey done in 2004.

TOTAL BILL OF MATERIAL

PAY ITEM	ITEM	UNIT	TOTAL
55000200	Epoxy Crack Injection	FOOT	30
X0325305	Structural Repair of Concrete (Depth Equal to or less than 5")	SO FT	18
20005300	Box Culvert to be Cleaned	EACH	2

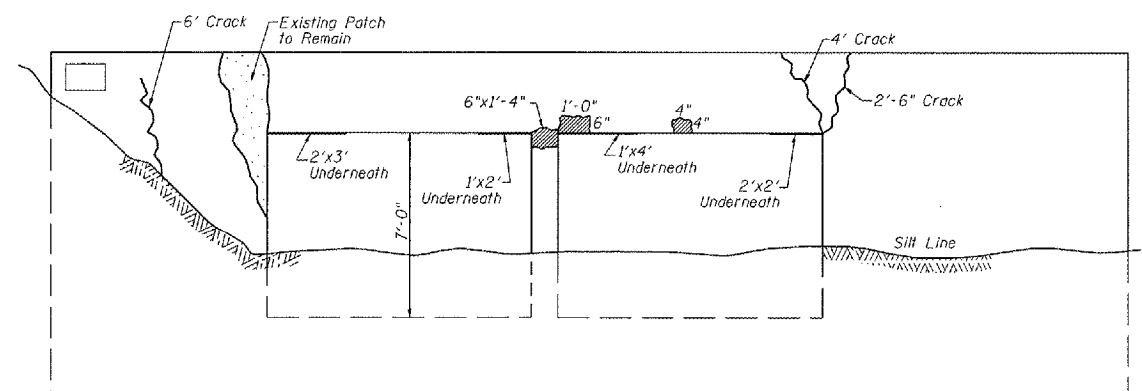

LEGEND

- Structural Repair of Concrete (Length x Width given)
- Epoxy Crack Injection (Length Given)

SECTION A-A
SOUTH HEADWALL ELEVATION
(Looking North)

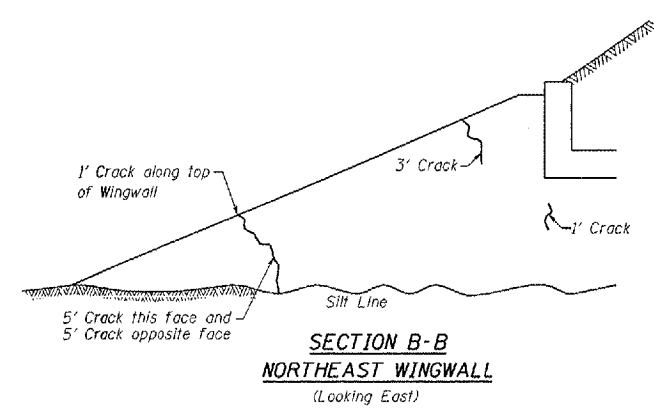

SECTION B-B
NORTHEAST WINGWALL
(Looking East)

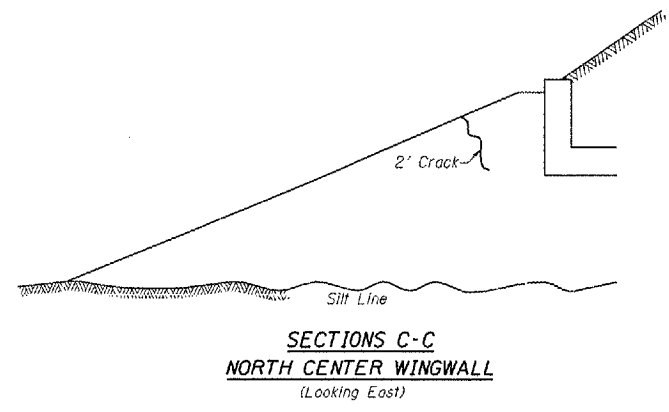

SECTIONS C-C
NORTH CENTER WINGWALL
(Looking East)

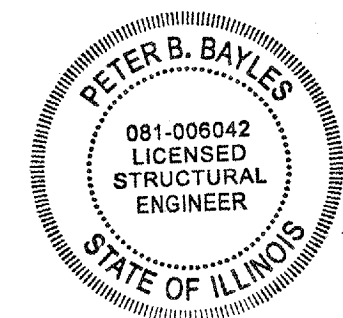

Pete B. Bayles 11/22/07

Pete B. Bayles, P.E., S.E. Date
Structural Engineer License No. 081-006042
Expiration Date: 11/30/2008
Note: This seal only extends to the inspections and subsequent plan prepared in October 2004. I Pete Bayles can not attest to any damage or changes after October 30, 2004.

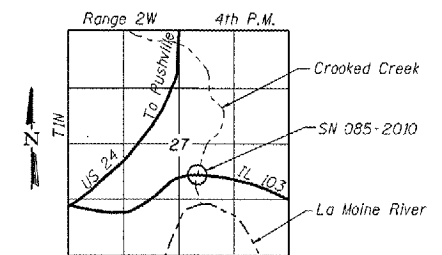

LOCATION SKETCH

CULVERT REPAIR PLANS
IL ROUTE 103 OVER
CROOKED CREEK
SECTION 101B-1
SCHUYLER COUNTY
SN 085-2010