

BENCHMARKS: CHISELED SQUARE ON TOP N.E. HEADWALL OF 4' x 3" BOX CULVERT, 500± SOUTH OF STR. #059-0030.
STATION 2134+29.69; OFFSET = 15.39' LT.; ELEV. = 627.95

SEC. 9, TWP. 10N, R 7W, 3RD PM

SBI ROUTE 4 (OLD IL. RTE. 4)
SECTION: F(B-3)
MACOUPIN COUNTY
SN 059-0030 (EXIST.)
SN 059-2503 (PROP.)
OVER HURRICANE CREEK

F.A.D. RTE.	SECTION	COUNTY	TOTAL SHEETS	SHEET NO.
SBI-4	F(B-3)	MACOUPIN	27	12
STA. 2123+10.00		TO STA. 2129+50.00		
FED. ROAD DIST. NO.		ILLINOIS	FED. AID PROJECT	
CONTRACT #72407				

R.R. SPIKE IN THIRD P.P. NORTH OF CURVE ON W. SIDE OF OLD RTE. #4.
STATION 2141+22.63; OFFSET = 31.13' RT.; ELEV. = 630.90
STATION EQUATION: STA. 2136+51.32 (BK.) = STA. 2137+36.64 (AH.)

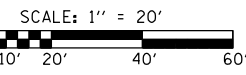
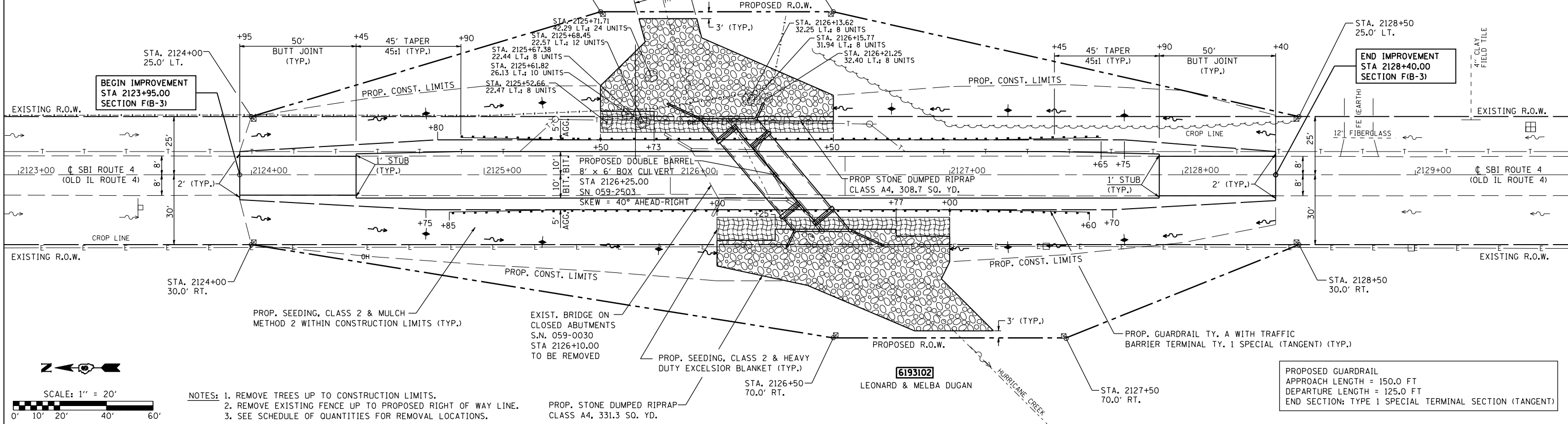

- NOTES: 1. REMOVE TREES UP TO CONSTRUCTION LIMITS.
2. REMOVE EXISTING FENCE UP TO PROPOSED RIGHT OF WAY LINE.
3. SEE SCHEDULE OF QUANTITIES FOR REMOVAL LOCATIONS.

PROPOSED GUARDRAIL
APPROACH LENGTH = 150.0 FT
DEPARTURE LENGTH = 125.0 FT
END SECTION: TYPE 1 SPECIAL TERMINAL SECTION (TANGENT)

PLAN	SURVEYED	DATE
	BY	
	NOTED	
	BY	
	DATE	

PROFILE	SURVEYED	DATE
	BY	
	NOTED	
	BY	
	DATE	

