

F.A.P. RTE.	SECTION	COUNTY	TOTAL SHEETS	SHEET NO.
67	S(RS-5, TS-7),L	SANGAMON	78	1

STATE OF ILLINOIS  
DEPARTMENT OF TRANSPORTATION  
DIVISION OF HIGHWAYS

**PROPOSED  
HIGHWAY PLANS**

FAP ROUTE 67 (IL 97/JEFFERSON ST)  
SECTION S(RS-5, TS-7),L  
PROJECT: F-HSIP-0067(075)  
SANGAMON COUNTY  
C-96- 520-07

**INDEX OF SHEETS**

- 1 COVER SHEET
- 2 GENERAL NOTES
- 3-7 SUMMARY OF QUANTITIES
- 8-18 SCHEDULE OF QUANTITIES
- 19-20 TYPICAL SECTIONS
- 21 BUTT JOINT DETAILS
- 22-25 SIDEWALK PROFILE AND ENTRANCE DETAILS
- 26-32 PLAN SHEETS
- 33-41 LIGHTING PLAN SHEETS & DETAILS
- 42-46 PAVEMENT MARKING PLANS
- 47 LEGEND FOR TRAFFIC SIGNAL DETAILS
- 48 VIDEO DETECTION SYSTEM
- 49-50 TRAFFIC SIGNALS DETAILS AT JEFFERSON ST. & VETERANS PKWY.
- 51-54 TRAFFIC SIGNALS DETAILS AT JEFFERSON ST. & CHURCHILL RD.
- 55-78 CROSS SECTION SHEETS

**STANDARDS**

000001-04	701311-02
280001-03	701501-03
424001-04	701601-04
442001-03	701701-04
442101-06	702001-06
630001-07	720016-01
630301-04	780001-01
631031-06	781001-02
635006-02	857001
701001-01	873001-01
701006-02	877011-02
701011-01	878001-05
701201-02	880001
701301-02	880006
701306-01	635011-01

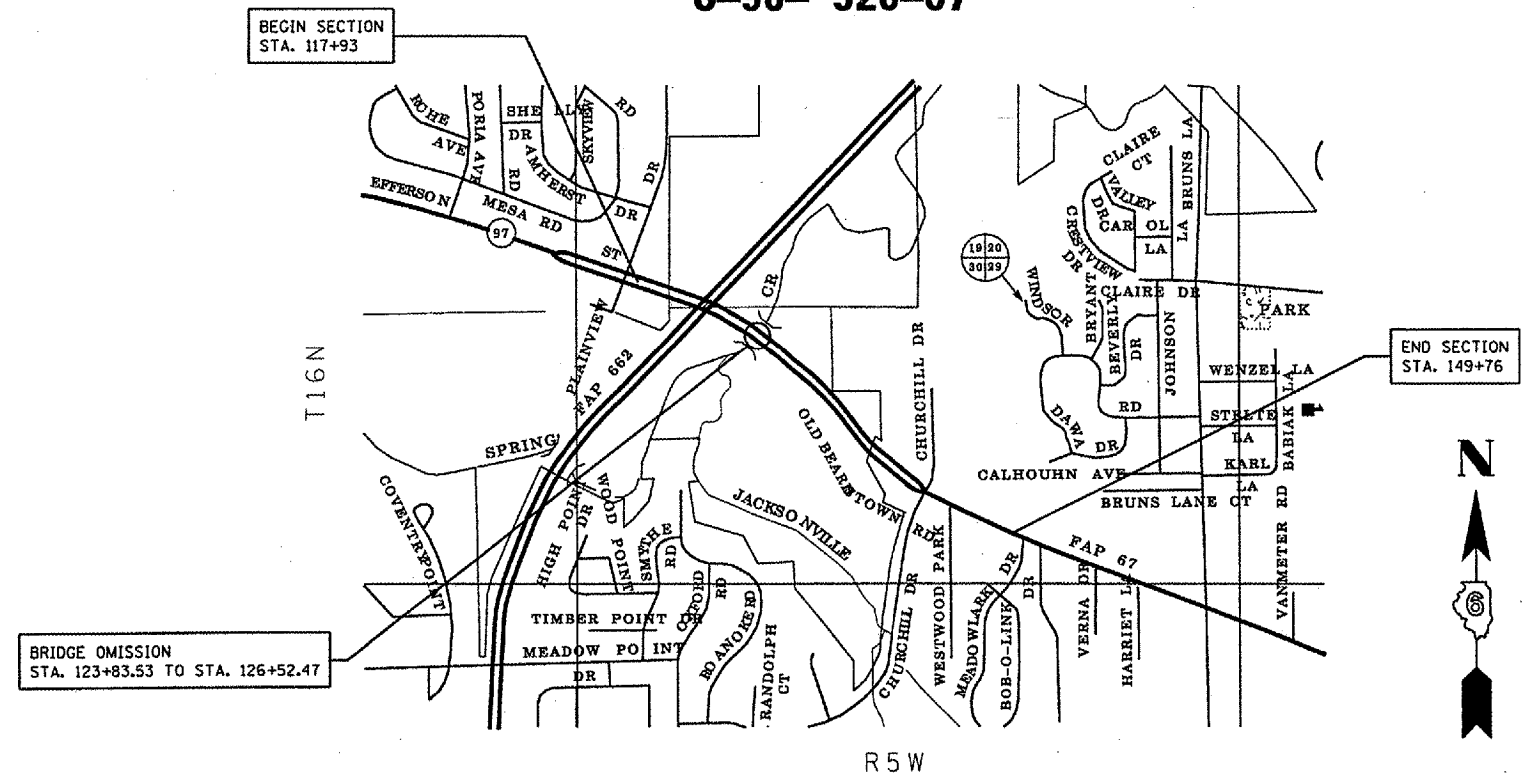

**LOCATION MAP  
SPRINGFIELD IL**

TOTAL LENGTH OF SECTION = 3183.00 FT. = 0.603 MILES  
NET LENGTH OF SECTION = 2812.97 FT. = 0.533 MILES

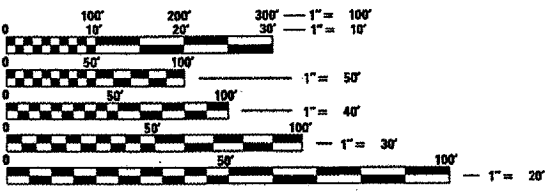

FULL SIZE PLANS HAVE BEEN PREPARED USING STANDARD ENGINEERING SCALES. REDUCED SIZED PLANS WILL NOT CONFORM TO STANDARD SCALES. IN MAKING MEASUREMENTS ON REDUCED PLANS, THE ABOVE SCALES MAY BE USED.

J.U.L.I.E.  
JOINT UTILITY LOCATION INFORMATION FOR EXCAVATION  
1-800-892-0123

STATE OF ILLINOIS  
DEPARTMENT OF TRANSPORTATION  
DIVISION OF HIGHWAYS

SUBMITTED JAN 31 20 07  
*Just Wood* DISTRICT ENGINEER

MARCH 23 20 07  
*Eric S. Harm* ENGINEER OF DESIGN AND ENVIRONMENT

MARCH 23 20 07  
*Melton R. Sees* DIRECTOR, DIVISION OF HIGHWAYS

**PRINTED BY THE AUTHORITY  
OF THE STATE OF ILLINOIS**

ADT = 17979 (YR. 2006)

**CONTRACT NO. 72851**

PROJECT ENGINEER: SAL MADONIA 217-782-4761  
SQUAD LEADER: KEN ANDERSON 217-524-7546