

F.A.P. RTE.	SECTION	COUNTY	TOTAL SHEETS	SHEET NO.
67	S(RS-5, TS-7), L	SANGAMON	78	24
STA.		TO STA.		
FED. ROAD DIST. NO.	ILLINOIS	FED. AID PROJECT		

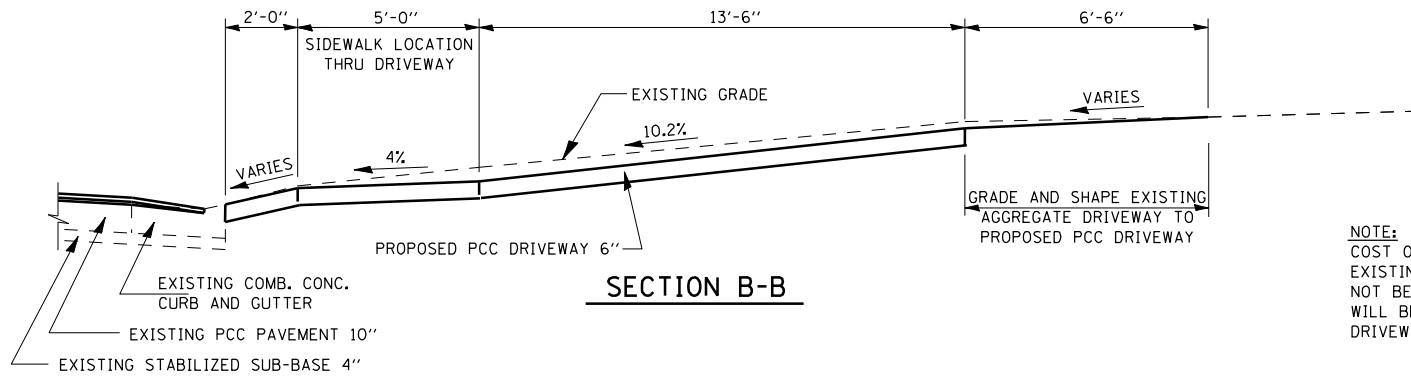

NOTE:
 COST OF GRADING AND SHAPING EXISTING AGGREGATE DRIVEWAY WILL NOT BE PAID FOR SEPARATELY BUT WILL BE INCLUDED IN THE COST FOR PCC DRIVEWAY 6"

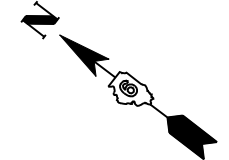
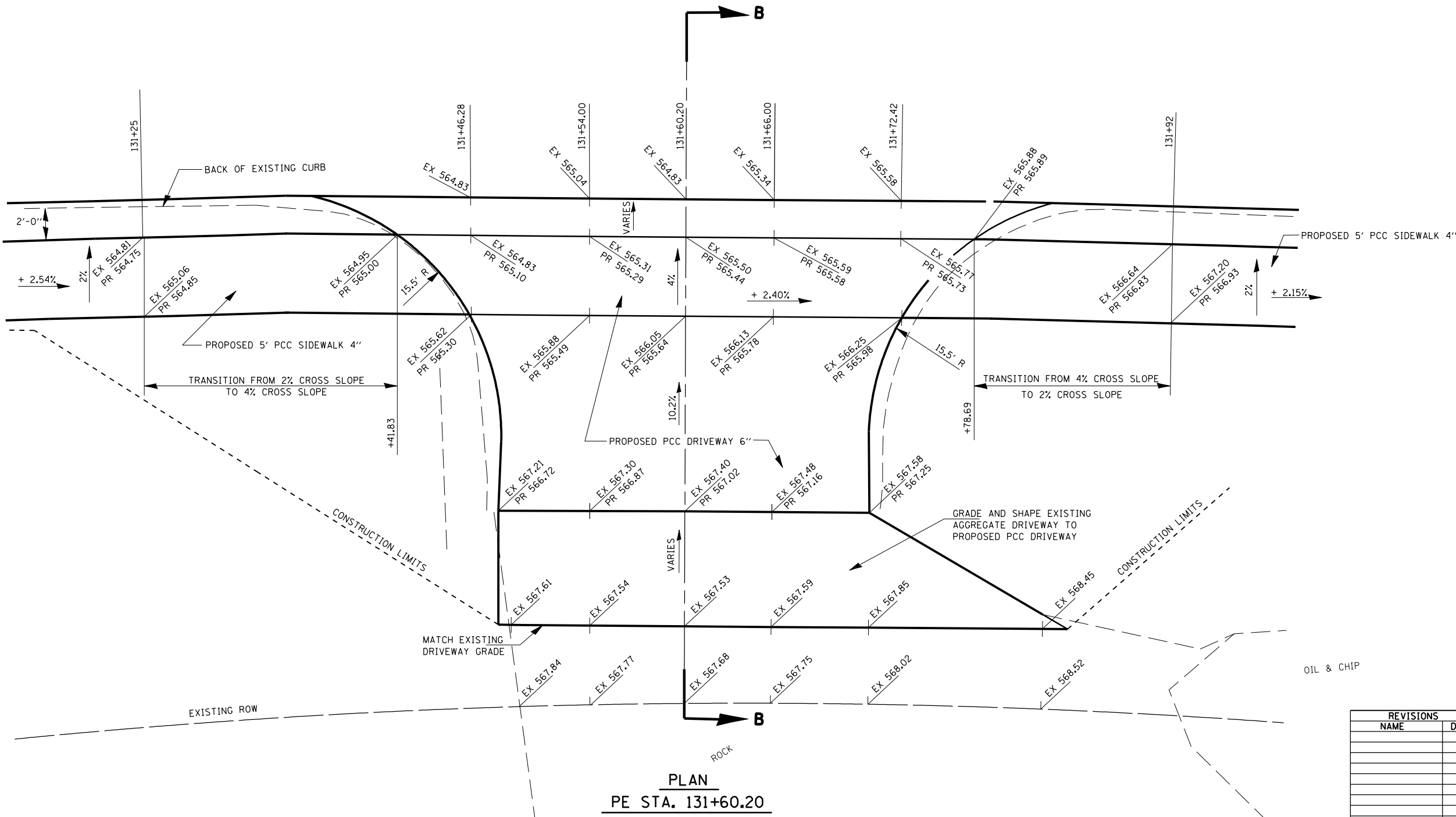

KEY:
 EX 580.00
 PR 581.00

PLOT DATE = \$DATE\$
 FILE NAME = \$FILEL\$
 PLOT SCALE = \$SCALE\$
 USER NAME = \$USER\$

REVISIONS	
NAME	DATE

ILLINOIS DEPARTMENT OF TRANSPORTATION
ENTRANCE DETAILS STA. 131+60.20
FAP 67 (IL 97/ JEFFERSON ST)
SECTION S(RS-5, TS-7), L
SANGAMON COUNTY
 SCALE: VERT. _____
 DATE: _____
 DRAWN BY _____
 CHECKED BY _____