

F.A.P. RTE.	SECTION	COUNTY	TOTAL SHEETS	SHEET NO.
67	S(RS-5, TS-7), L	SANGAMON	78	45
STA.		TO STA.		
FED. ROAD DIST. NO.	ILLINOIS	FED. AID PROJECT		

**LEGEND**

- ① PREFORMED PLASTIC PAVEMENT MARKING, TYPE B - LINE 5"
- ② PREFORMED PLASTIC PAVEMENT MARKING, TYPE B - LETTERS AND SYMBOLS (BITUMINOUS SURFACE)
- ③ POLYUREA PAVEMENT MARKING SPECIAL - 5"
- ④ POLYUREA PAVEMENT MARKING SPECIAL - 6"
- ⑤ POLYUREA PAVEMENT MARKING SPECIAL - 12"
- ⑥ POLYUREA PAVEMENT MARKING SPECIAL - 24"

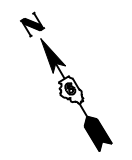

EXIST. CURVE 40  
 PI STA. = 143+25.68  
 $\Delta = 29^\circ 28' 19''$  (LT)  
 $D = 2^\circ 27' 46''$   
 $R = 2,326.55'$   
 $T = 611.92'$   
 $L = 1,196.74'$   
 $E = 79.13'$   
 $e = \text{-----}$   
 $T.R. = \text{-----}$   
 $S.E. RUN = \text{-----}$   
 P.C. STA. = 137+13.76  
 P.T. STA. = 149+10.50

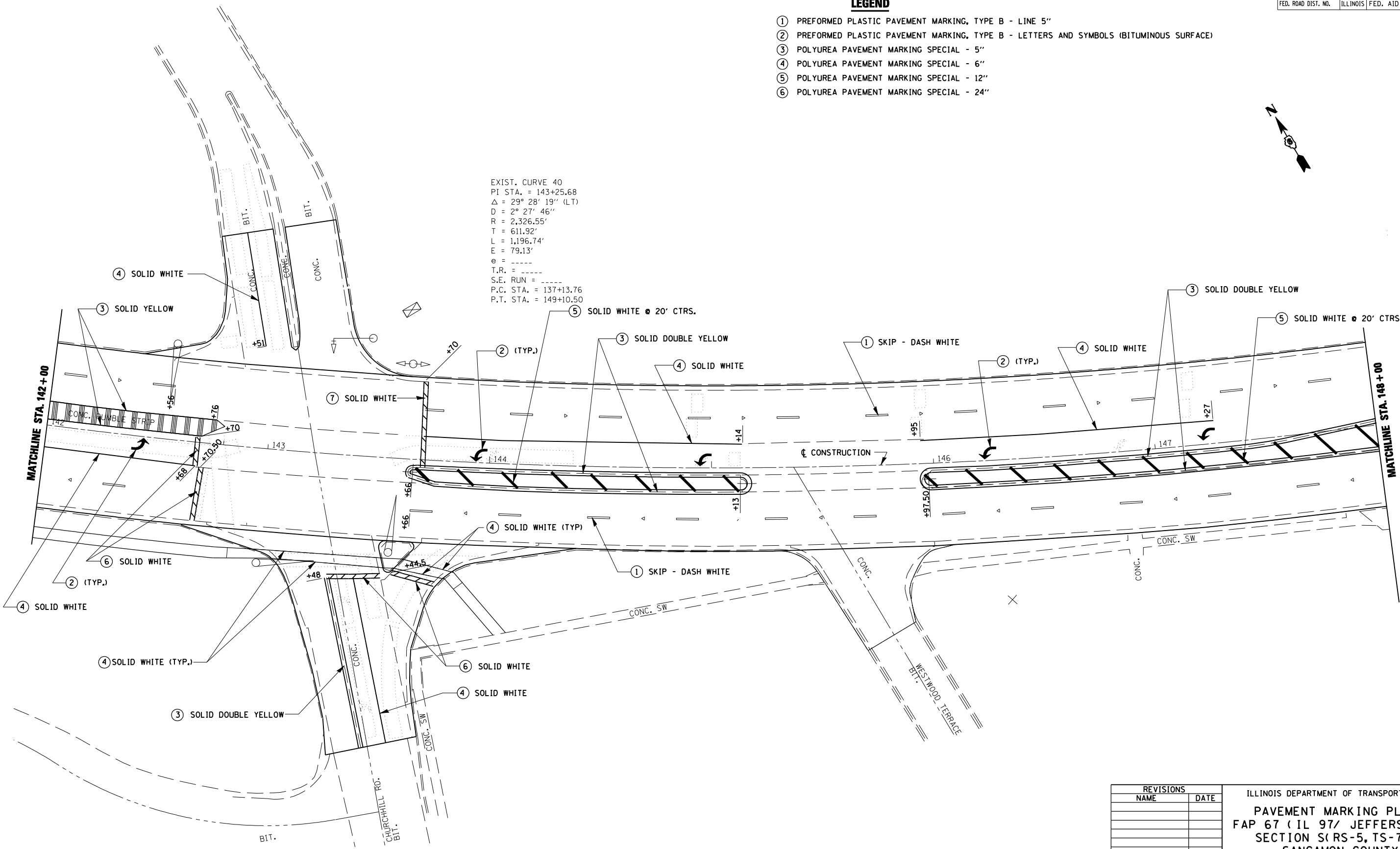

PLOT DATE =  
 DATE =  
 PLOT SCALE =  
 USER NAME =

REVISIONS	
NAME	DATE

ILLINOIS DEPARTMENT OF TRANSPORTATION  
**PAVEMENT MARKING PLANS**  
 FAP 67 (IL 97/ JEFFERSON ST)  
 SECTION S(RS-5, TS-7), L  
 SANGAMON COUNTY

SCALE: VERT. \_\_\_\_\_  
 HORIZ. \_\_\_\_\_

DATE \_\_\_\_\_ DRAWN BY \_\_\_\_\_  
 CHECKED BY \_\_\_\_\_