

LOCATION #1
BEGIN STA. 160+61

LOCATION #1
END STA. 168+11

LOCATION #2
BEGIN STA. 270+18.75

BRIDGE OMMISION
STA. 277+68.75 TO
279+62.83

LOCATION #2
END STA. 281+12.83

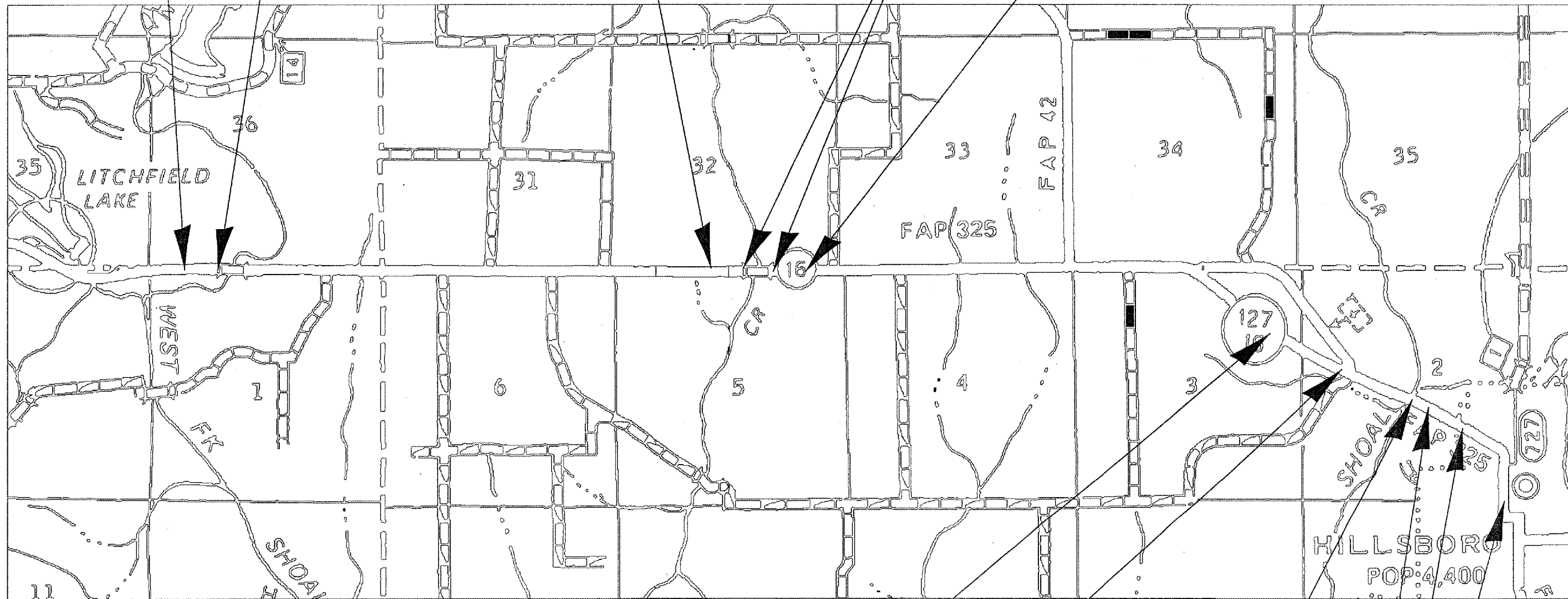

LOCATION #3
BEGIN STA. 403+06

LOCATION #3
END STA. 421+56

LOCATION #4
BEGIN STA. 15+89.5

STA. EQ. - 20+00bk
= 447+14.15ah

STA. EQ. - 456+28
= 10+00

LOCATION #4
END STA. 28+74

LOCATION MAP
FAP 325 (IL 16)
SECTION (2)I-5
MONTGOMERY COUNTY