

FAP RTE.	SECTION	COUNTY	TOTAL SHEETS	SHEET NO.
**	*	SANGAMON	14	13
STA.		TO STA.		
FED. ROAD DIST. NO.	ILLINOIS	FED. AID PROJECT		

\* D6 DIRKSEN/CLEARLAKE RES 2007  
 \*\* FAP 67 - CLEAR LAKE  
 FAP 75, 668 - DIRKSEN

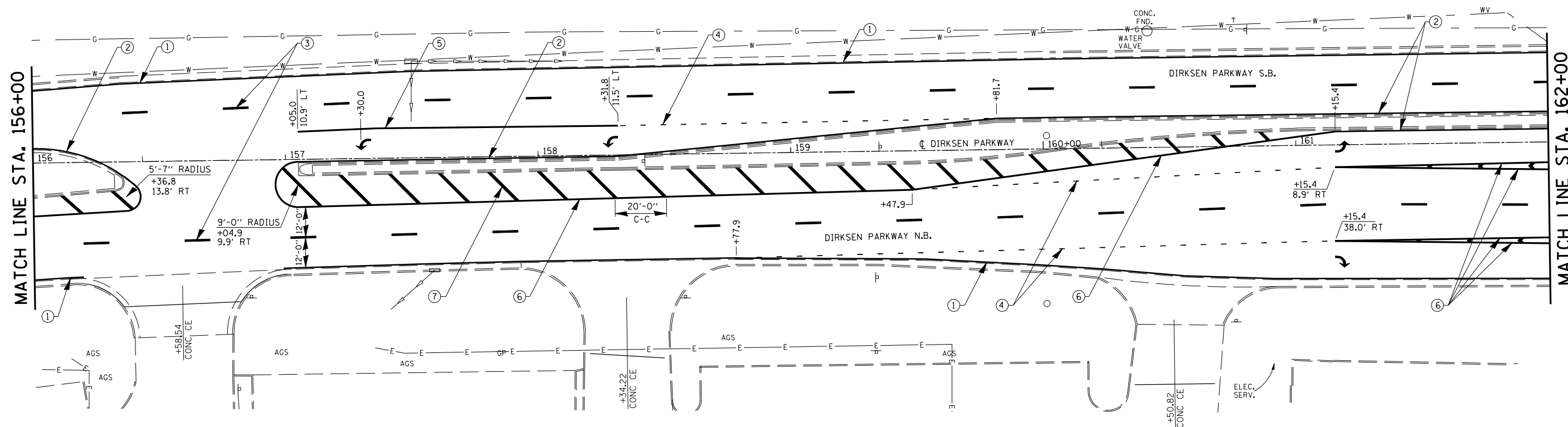

**LEGEND**

- ① 5" SOLID THERMOPLASTIC LINE, WHITE
- ② 5" SOLID THERMOPLASTIC LINE, YELLOW
- ③ 5" SKIP-DASH (30' SKIP, 10' LINE) THERMOPLASTIC LINE, WHITE
- ④ 6" SKIP-DASH (6' SKIP, 2' LINE) THERMOPLASTIC LINE, WHITE
- ⑤ 6" SOLID THERMOPLASTIC LINE, WHITE
- ⑥ 8" SOLID THERMOPLASTIC LINE, WHITE
- ⑦ 12" SOLID THERMOPLASTIC DIAGONAL LINE, WHITE
- ⑧ 24" PREFORMED PLASTIC, TYPE B STOP BARS
- ↪ PREFORMED PLASTIC, TYPE B, L&S (15.6 sq ft)

**NOTE:**

ALL STATION AND OFFSET CALLOUTS ON THIS SHEET ARE REFERENCED OFF OF THE CENTERLINE FOR DIRKSEN PARKWAY.

ILLINOIS DEPARTMENT OF TRANSPORTATION  
**PLAN & PAVEMENT MARKING DETAILS**  
**DIRKSEN PARKWAY**  
**SECTION: D6 DIRKSEN/CLEARLAKE**  
**RES 2007**  
**SANGAMON COUNTY**