

1 GIRDER 2 ELEVATION INDICATING TYPICAL FATIGUE RETROFIT LOCATIONS FOR SIX-SPAN CONTINUOUS UNIT
S51 GIRDER 1 - OPPOSITE HAND
 Note A: Fatigue retrofit locations also apply to two, three, and four-span continuous units.

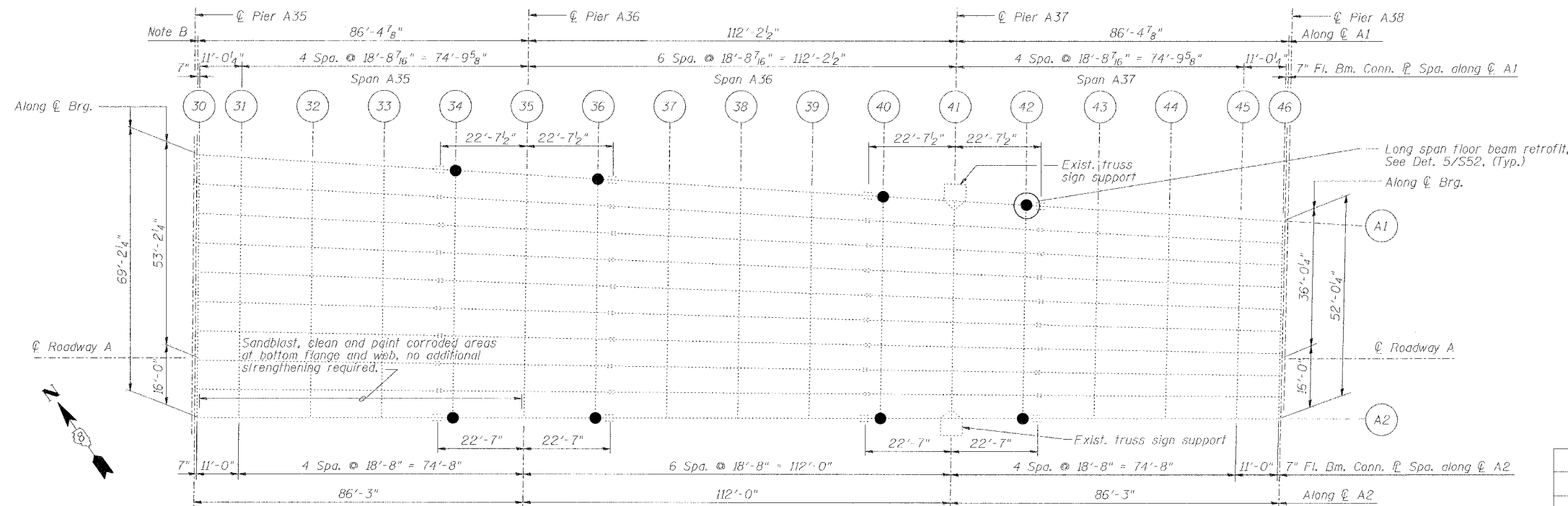

Note B: Dimensions shown are along length of girder

2 FRAMING PLAN SPANS A35 - A37
S51 SHOWING LONG SPAN FLOOR BEAM RETROFIT LOCATIONS

BILL OF MATERIAL		
ITEM	UNIT	QUANTITY
Stiffener intersection modification	Ea.	896
Long span floor beam retrofit	Ea.	8
Crack Extension Modification	Ea.	20

REVISIONS	
NAME	DATE

FATIGUE RETROFIT
 STATE OF ILLINOIS
 DEPARTMENT OF TRANSPORTATION
 REHABILITATION AND RETROFIT REPAIRS
 FAI ROUTE 70
 POPLAR STREET BRIDGE APPROACHES
 ST. CLAIR COUNTY
 STRUCTURE NO. 082-0141 (ROADWAY A)
 SCALE: N.T.S.
 DATE: 02/01/2007

DATE: 12/26/2007
 FILENAME: p:\2001\1201-1300\200112140\Drafting\RoadwayRehab_AT\ReampA\Fatigue\A-FAT101.dgn

DESIGNED	DDC
CHECKED	JCM
DRAWN	CLK
CHECKED	DDC