

F.A.P. RTE.	SECTION	COUNTY	TOTAL SHEETS	SHEET NO.
310		MADISON	418	95
STA.		TO STA.		
FED. ROAD DIST. NO.		ILLINOIS FED. AID PROJECT		
SECTION 60-14-2 & 60-14-2B				
CONTRACT NO. 76986				

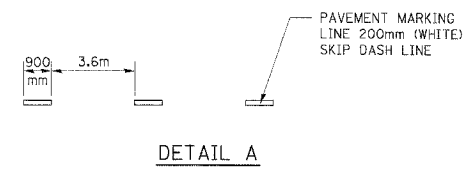
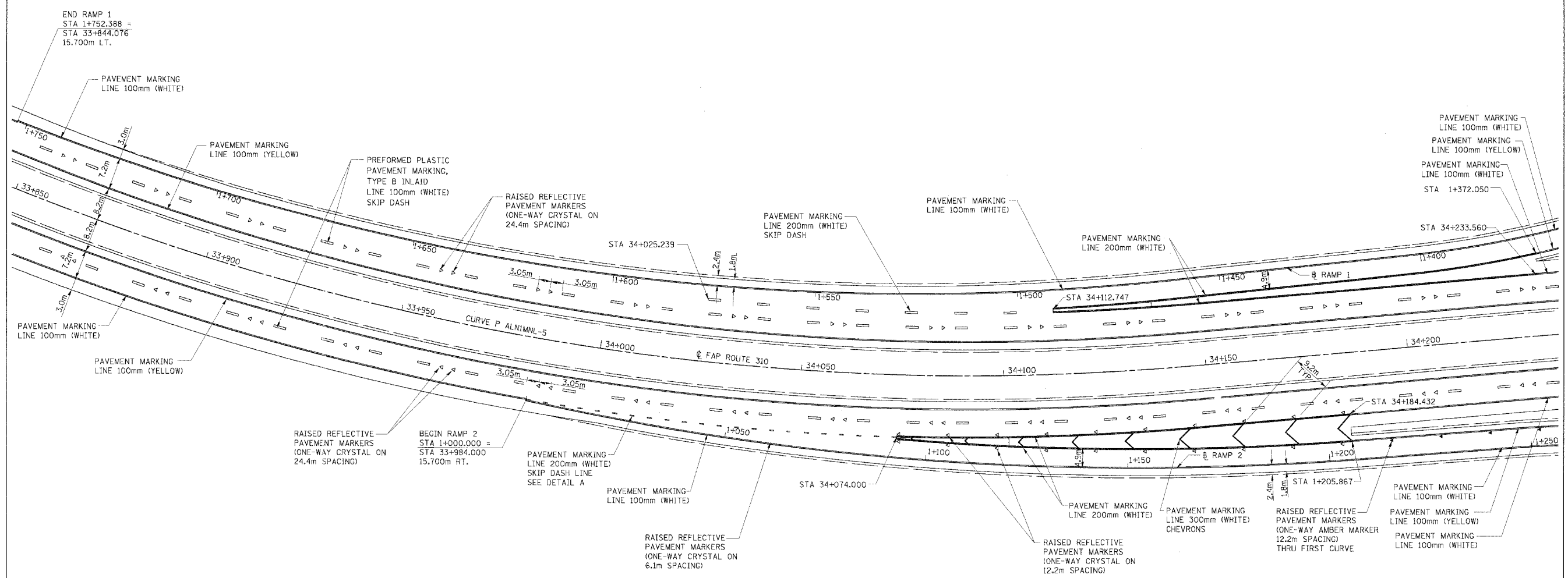

LEGEND

- ▶ ONE-WAY AMBER MARKER
- ▷ ONE-WAY CRYSTAL MARKER

NOTE
 UNLESS OTHERWISE NOTED
 ALL PAVEMENT MARKING IS
 THERMOPLASTIC



REVISIONS	
NAME	DATE

ILLINOIS DEPARTMENT OF TRANSPORTATION
**INTERCHANGE RAMP 1 & 2
 PAVEMENT MARKING DETAILS**

FAP ROUTE 310
 SECTION 60-14-2, 60-14-2B
 MADISON COUNTY

DATE _____ DRAWN BY BANDY
 CHECKED BY STELIART

PAVEMENT MARKING DETAIL, INTERCHANGE RAMP 1 & 2 (SEMINARY RD), FAP ROUTE 310