

F.A.P. RTE.	SECTION	COUNTY	TOTAL SHEETS	SHEET NO.
310	*	MADISON	418	149
STA. 30+908.196 TO STA. 30+925.000				
FED. ROAD DIST. NO.	ILLINOIS	FED. AID PROJECT		
SECTION 60-14-2		SECTION 60-14-2B		

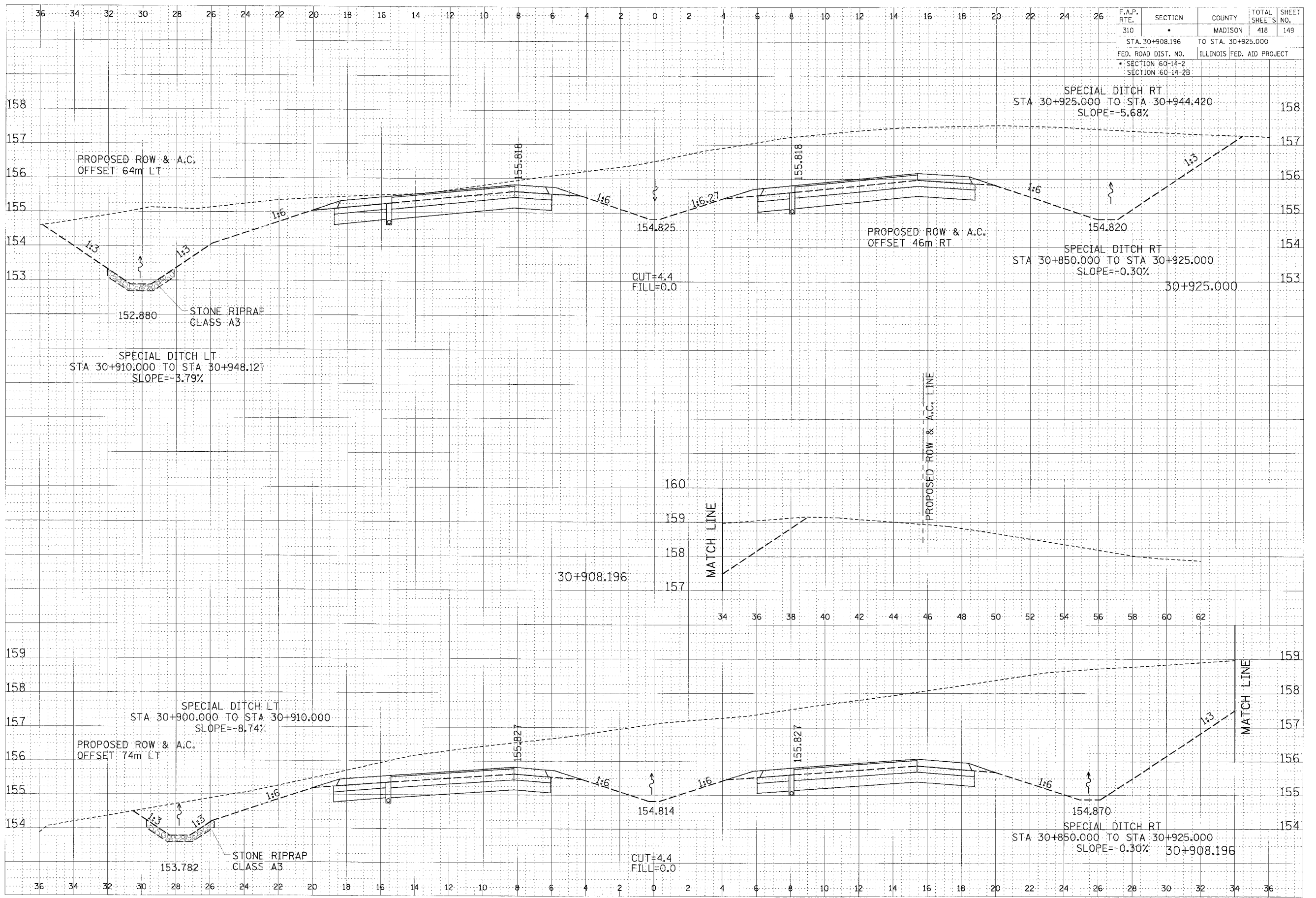

DATE	
BY	
DESIGNED	
SURVEY	
NOTE BOOK	
REPLATE	
AREAS CHECKED	
NO.	

DATE	
BY	
DESIGNED	
SURVEY	
NOTE BOOK	
REPLATE	
AREAS CHECKED	
NO.	

CROSS SECTION, FAP ROUTE 310, STA 30+908.196 TO STA 30+925.000