

F.A.P. RTE.	SECTION	COUNTY	TOTAL SHEETS	SHEET NO.
310	•	MADISON	418	189
STA. 31+800.000		TO STA.		
FED. ROAD DIST. NO.	ILLINOIS	FED. AID PROJECT		
• SECTION 60-14-2 • SECTION 60-14-2B				

DATE	
BY	
FINAL SURVEY	
NOTE BOOK	
AREAS	
AREA	
AREA	
AREA	

DATE	
BY	
ORIGINAL SURVEY	
NOTE BOOK	
AREAS	
AREA	
AREA	
AREA	

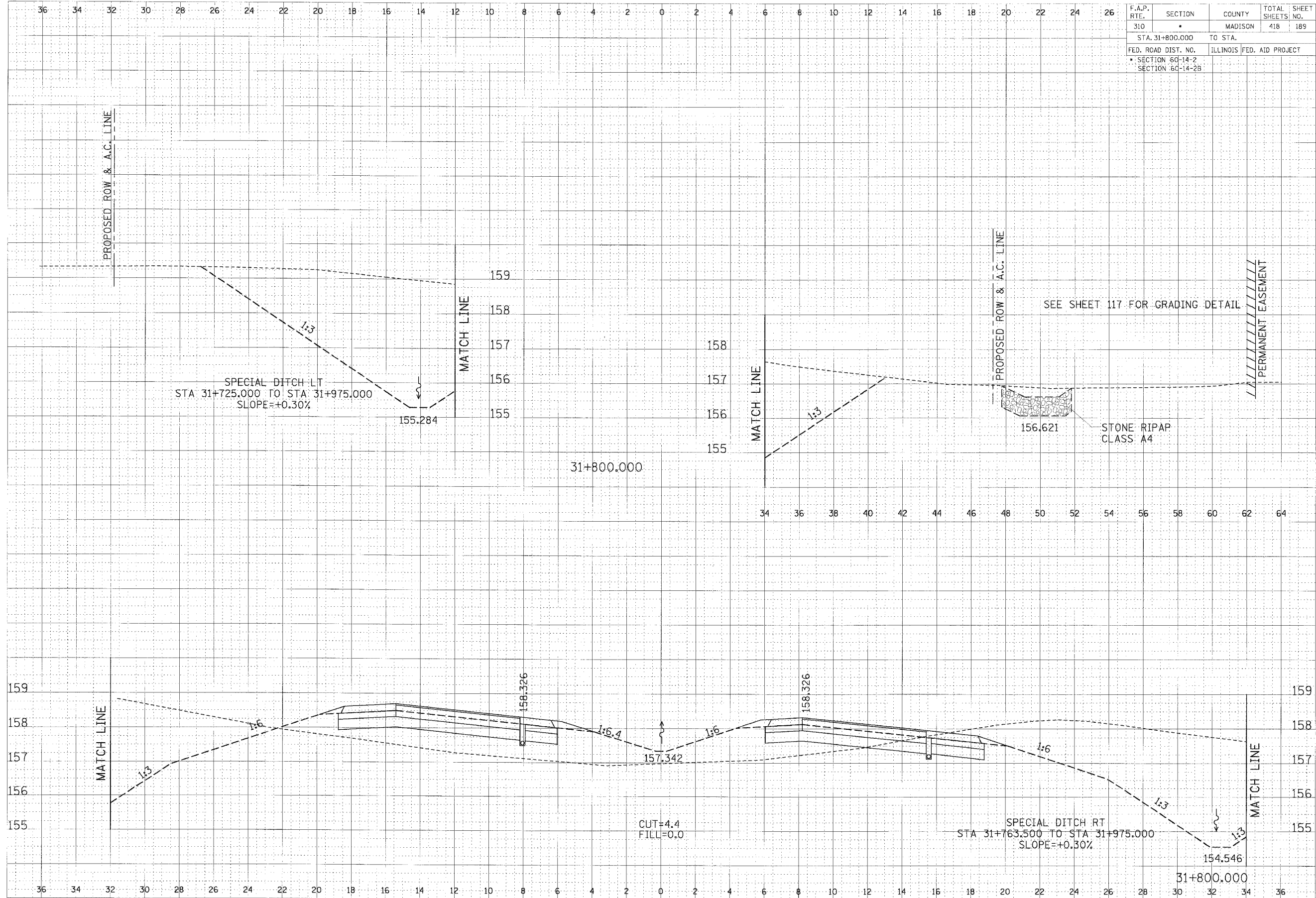

SEE SHEET 117 FOR GRADING DETAIL

PROPOSED ROW & A.C. LINE

PERMANENT EASEMENT

SPECIAL DITCH RT
STA 31+763.500 TO STA 31+975.000
SLOPE=+0.30%

SPECIAL DITCH LT
STA 31+725.000 TO STA 31+975.000
SLOPE=+0.30%

CUT=4.4
FILL=0.0

CROSS SECTION, FAP ROUTE 310, STA 31+800.000