

F.A.P. RTE.	SECTION	COUNTY	TOTAL SHEETS	SHEET NO.
310	*	MADISON	418	221
STA. 32+600.000 TO STA. 32+625.000				
FED. ROAD DIST. NO. ILLINOIS FED. AID PROJECT				
* SECTION 60-14-2				
SECTION 60-14-2B				

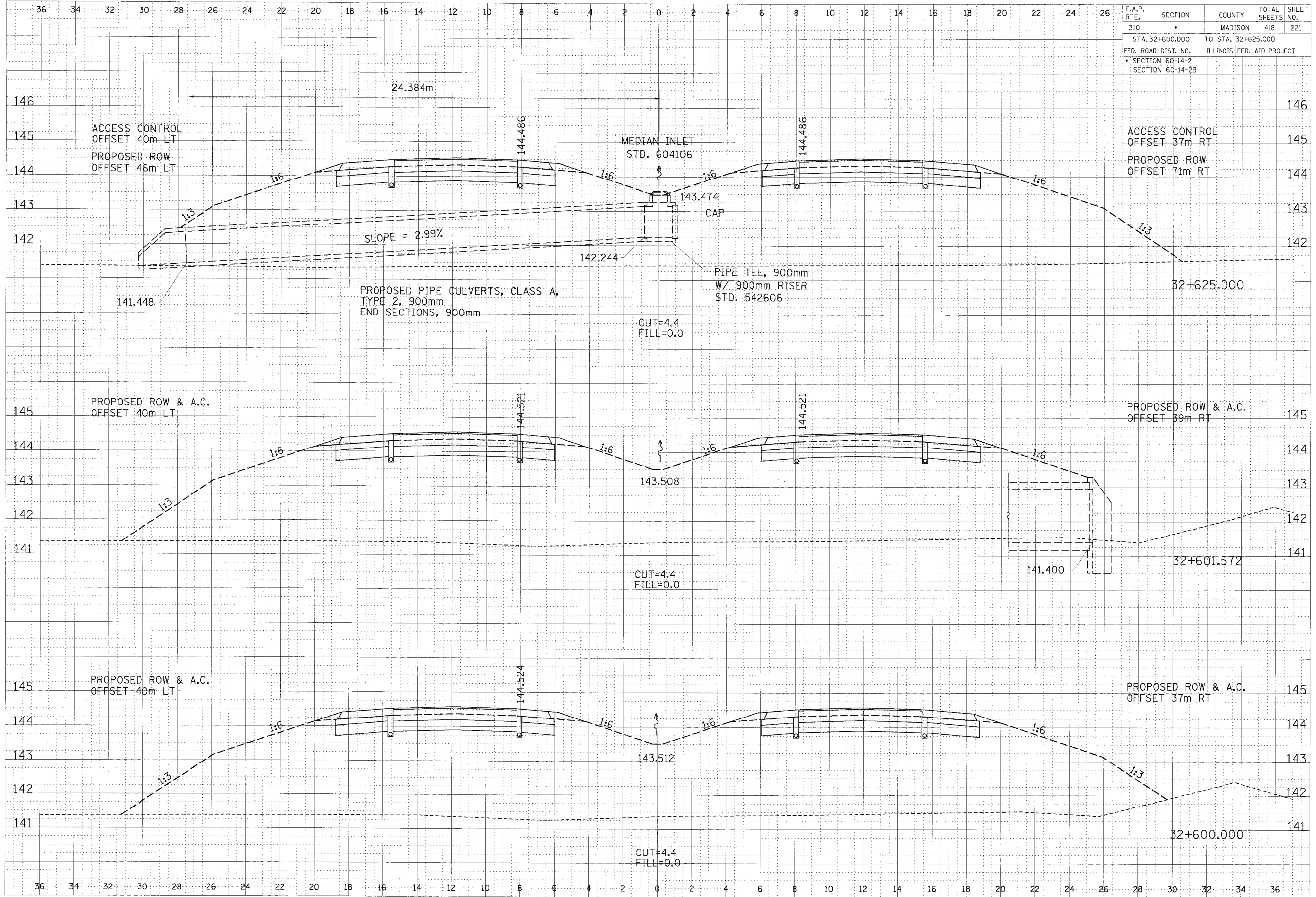

DATE	
BY	
DESIGNED	
CHECKED	
IN CHARGE	
APPROVED	
NO.	

DATE	
BY	
DESIGNED	
CHECKED	
IN CHARGE	
APPROVED	
NO.	

CROSS SECTION, FAP ROUTE 310, STA 32+600.000 TO STA 32+625.000