

F.A.P. RTE.	SECTION	COUNTY	TOTAL SHEETS	SHEET NO.
310		MADISON	418	384
STA. 9+8000.00		TO STA. 10+000.000		
FED. ROAD DIST. NO.		ILLINOIS FED. AID PROJECT		
SECTION 60-14-2 & 60-14-2B CONTRACT NO. 76986				

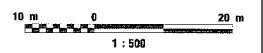
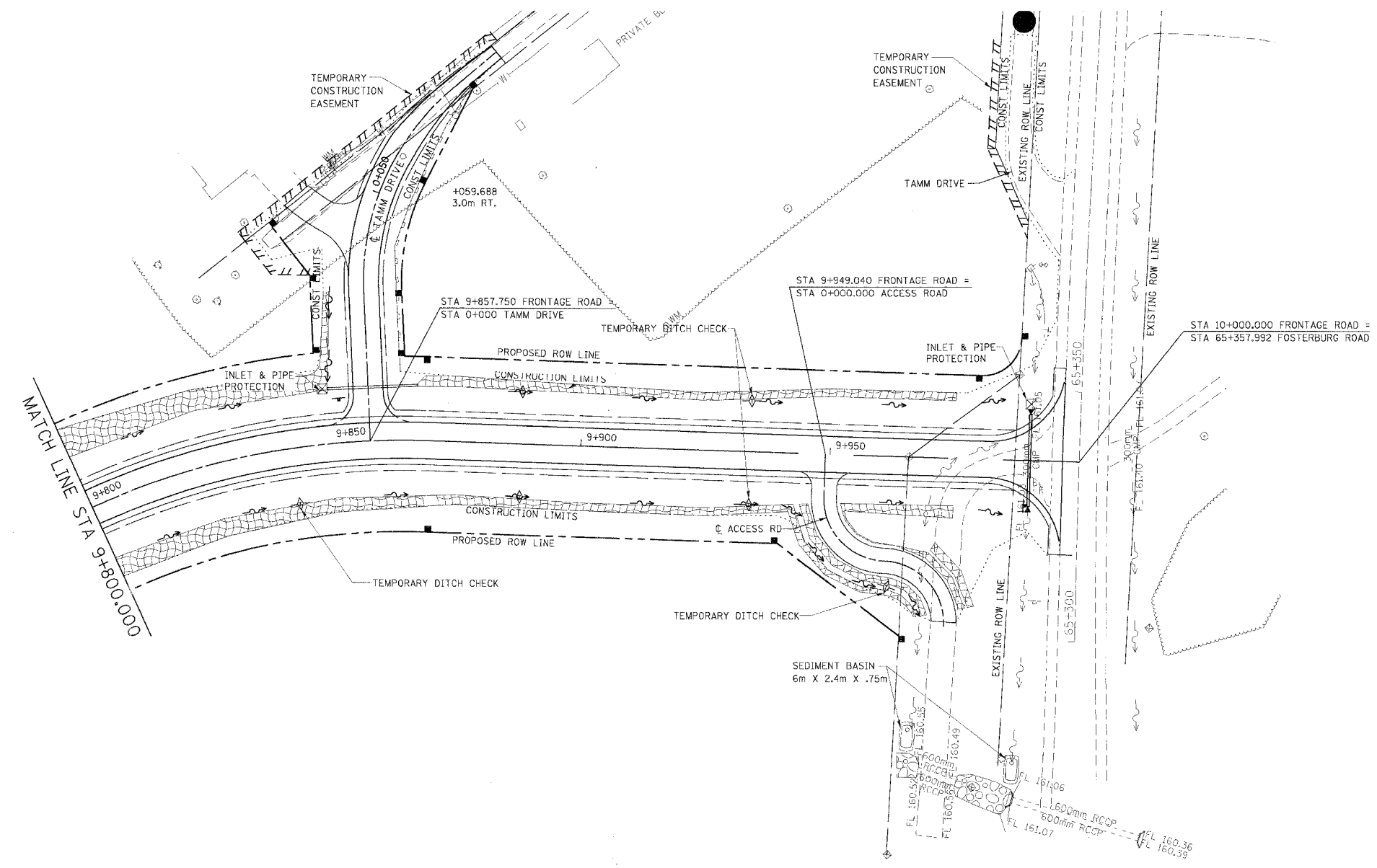
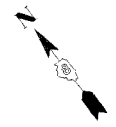

REVISIONS	
DATE	

ILLINOIS DEPARTMENT OF TRANSPORTATION
EROSION AND SEDIMENT CONTROL PLAN
 FAP ROUTE 310
 FAP ROUTE 310 SECTION 60-14-2, 60-14-2B
 MADISON COUNTY
 DRAWN BY BANDY
 CHECKED BY STEUART
 DATE

EROSION AND SEDIMENT CONTROL PLAN, FRONTAGE RD., FAP ROUTE 310, STA. 9+800.000 TO STA. 10+000.000

11/28/2007 7:45:14 AM \\f:\rd\del11-est\mg\ep\010.dwg