

FAA/RTL	SECTION	COUNTY	TOTAL SHEETS	SHEET NO
1215	99-00169-05-WR	LAKE	153	51
TRAFFIC CONTROL - STAGE 2 & 2A				
CONTRACT NO. 83847		ALIGNMENT SUNSET AVENUE		

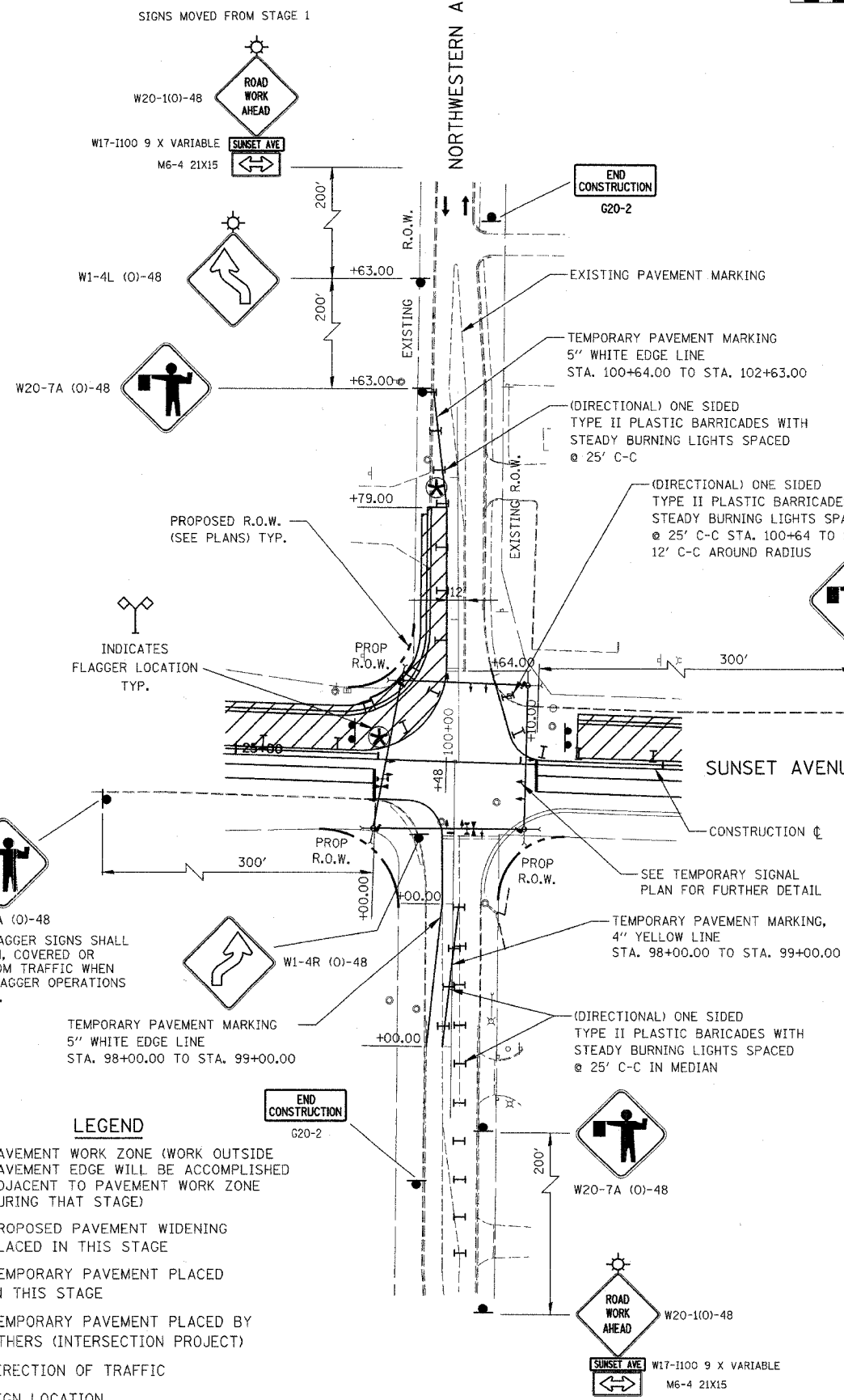

REDUCE BINDER DEPTH AT INTERSECTION EDGES IN ORDER TO PROVIDE A MAXIMUM ELEVATION DIFFERENCE OF 1/2" BETWEEN BINDER COURSE AND ADJACENT EXISTING PAVEMENT REMAINING AFTER STAGE 2 AND 2A. ANY REMAINING BINDER THICKNESS WILL BE PLACED IN STAGE 3 AND 3A.

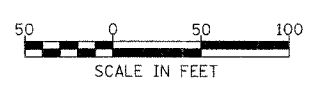
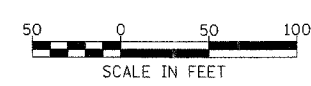
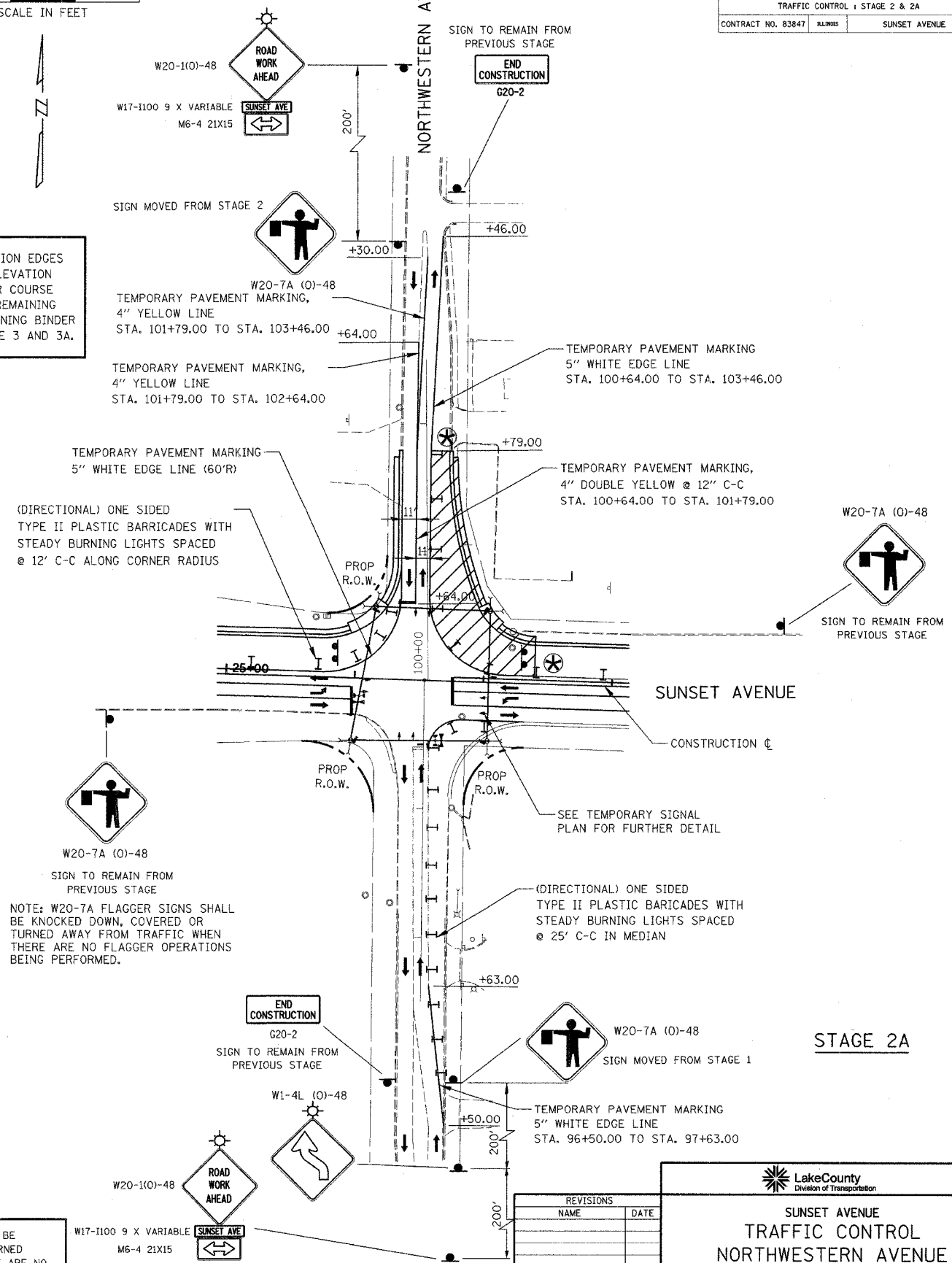

STAGE 2

STAGE 2A

NOTE: W20-7A FLAGGER SIGNS SHALL BE KNOCKED DOWN, COVERED OR TURNED AWAY FROM TRAFFIC WHEN THERE ARE NO FLAGGER OPERATIONS BEING PERFORMED.

NOTE: W20-7A FLAGGER SIGNS SHALL BE KNOCKED DOWN, COVERED OR TURNED AWAY FROM TRAFFIC WHEN THERE ARE NO FLAGGER OPERATIONS BEING PERFORMED.

NOTE: W20-7A FLAGGER SIGNS ARE TO BE KNOCKED DOWN, COVERED, OR TURNED AWAY FROM TRAFFIC WHEN THERE ARE NO FLAGGER OPERATIONS BEING PERFORMED.

- LEGEND**
- PAVEMENT WORK ZONE (WORK OUTSIDE PAVEMENT EDGE WILL BE ACCOMPLISHED ADJACENT TO PAVEMENT WORK ZONE DURING THAT STAGE)
  - PROPOSED PAVEMENT WIDENING PLACED IN THIS STAGE
  - TEMPORARY PAVEMENT PLACED IN THIS STAGE
  - TEMPORARY PAVEMENT PLACED BY OTHERS (INTERSECTION PROJECT)
  - DIRECTION OF TRAFFIC
  - SIGN LOCATION

REVISIONS	
NAME	DATE

Lake County  
Division of Transportation

SUNSET AVENUE  
TRAFFIC CONTROL  
NORTHWESTERN AVENUE  
STAGE 2 & 2A