

SECTION	COUNTY	TOTAL SHEETS	SHEET NO.
94-F3000-05-BT	COOK	102	23
STA.	TO STA.		
IDOT PROJECT NO. TE-D001(610)			
CENTENNIAL TRAIL			

CONTRACT NO. 83859

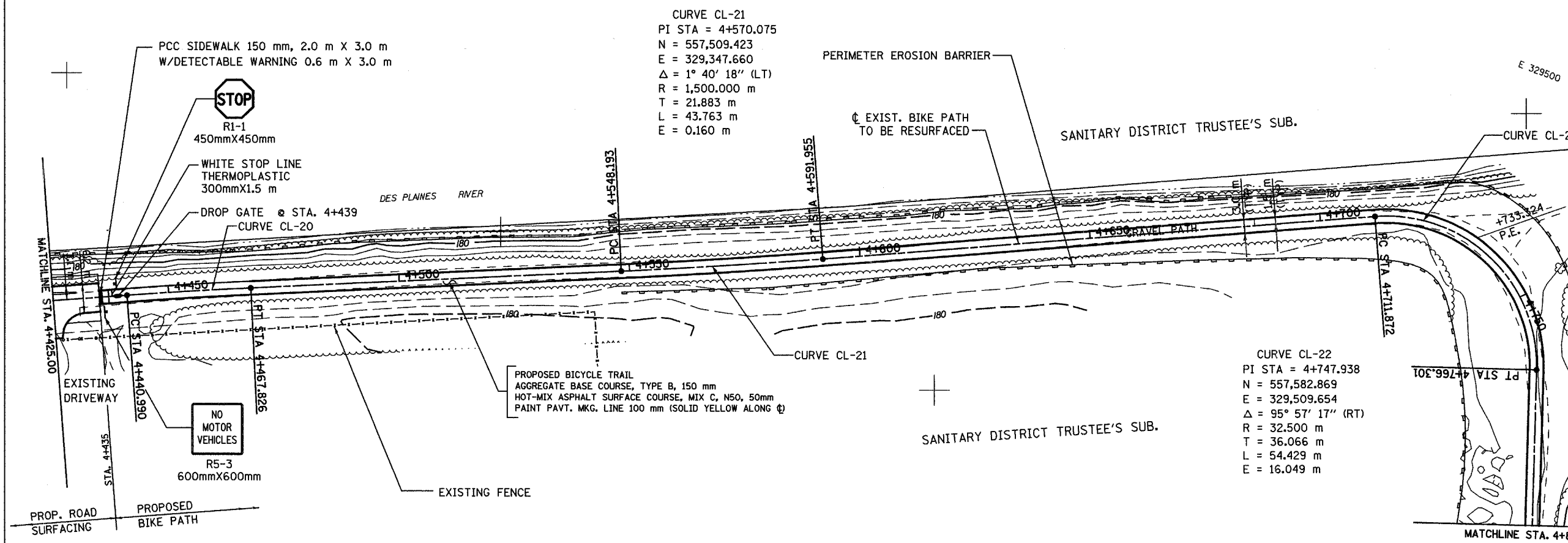

CURVE CL-20
 PI STA = 4+454.409
 N = 557,464.754
 E = 329,240.964
 $\Delta = 1^\circ 32' 15''$ (RT)
 R = 1,000.000 m
 T = 13.419 m
 L = 26.836 m
 E = 0.090 m

CURVE CL-21
 PI STA = 4+570.075
 N = 557,509.423
 E = 329,347.660
 $\Delta = 1^\circ 40' 18''$ (LT)
 R = 1,500.000 m
 T = 21.883 m
 L = 43.763 m
 E = 0.160 m

CURVE CL-22
 PI STA = 4+747.938
 N = 557,582.869
 E = 329,509.654
 $\Delta = 95^\circ 57' 17''$ (RT)
 R = 32.500 m
 T = 36.066 m
 L = 54.429 m
 E = 16.049 m

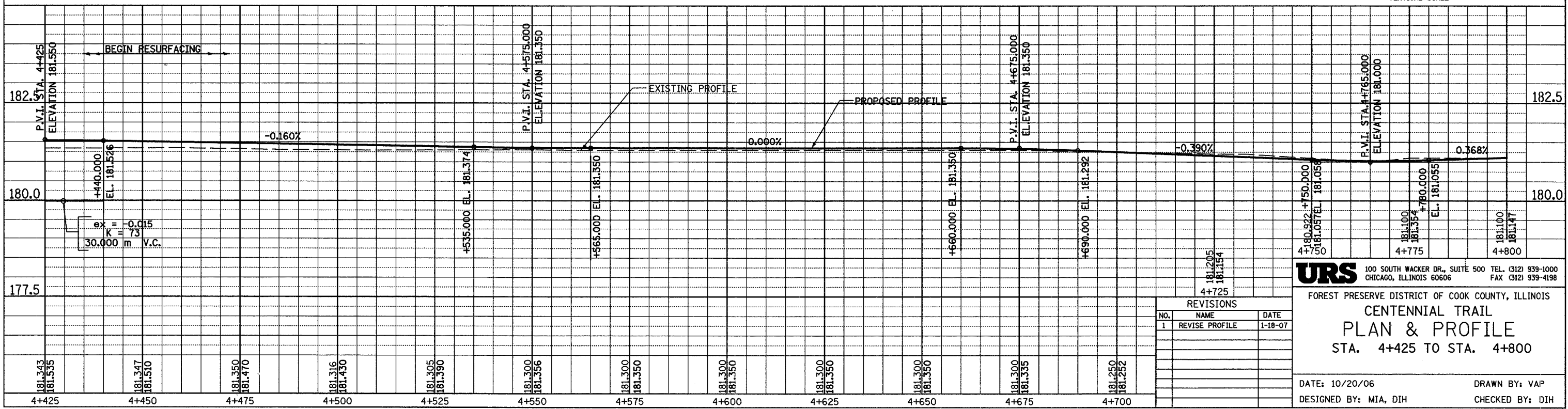
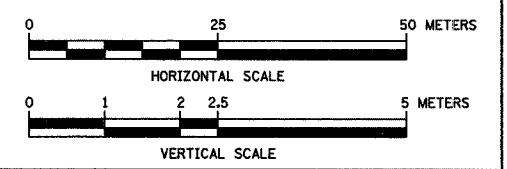

REVISIONS		
NO.	NAME	DATE
1	REVISE PROFILE	1-18-07

URS 100 SOUTH WACKER DR., SUITE 500 TEL. (312) 939-1000
 CHICAGO, ILLINOIS 60606 FAX (312) 939-4198

FOREST PRESERVE DISTRICT OF COOK COUNTY, ILLINOIS
CENTENNIAL TRAIL
PLAN & PROFILE
 STA. 4+425 TO STA. 4+800

DATE: 10/20/06 DRAWN BY: VAP
 DESIGNED BY: MIA, DIH CHECKED BY: DIH