

F.A. RTE.	SECTION	COUNTY	TOTAL SHEETS	SHEET NO.
1394	97-00226-00-PP	COOK	80	42
STA. 6+00		TO STA. 12+00		
FED. ROAD DIST. NO.	ILLINOIS	FED. AID PROJECT		
CONTRACT NO.: 83898				

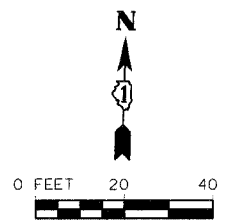
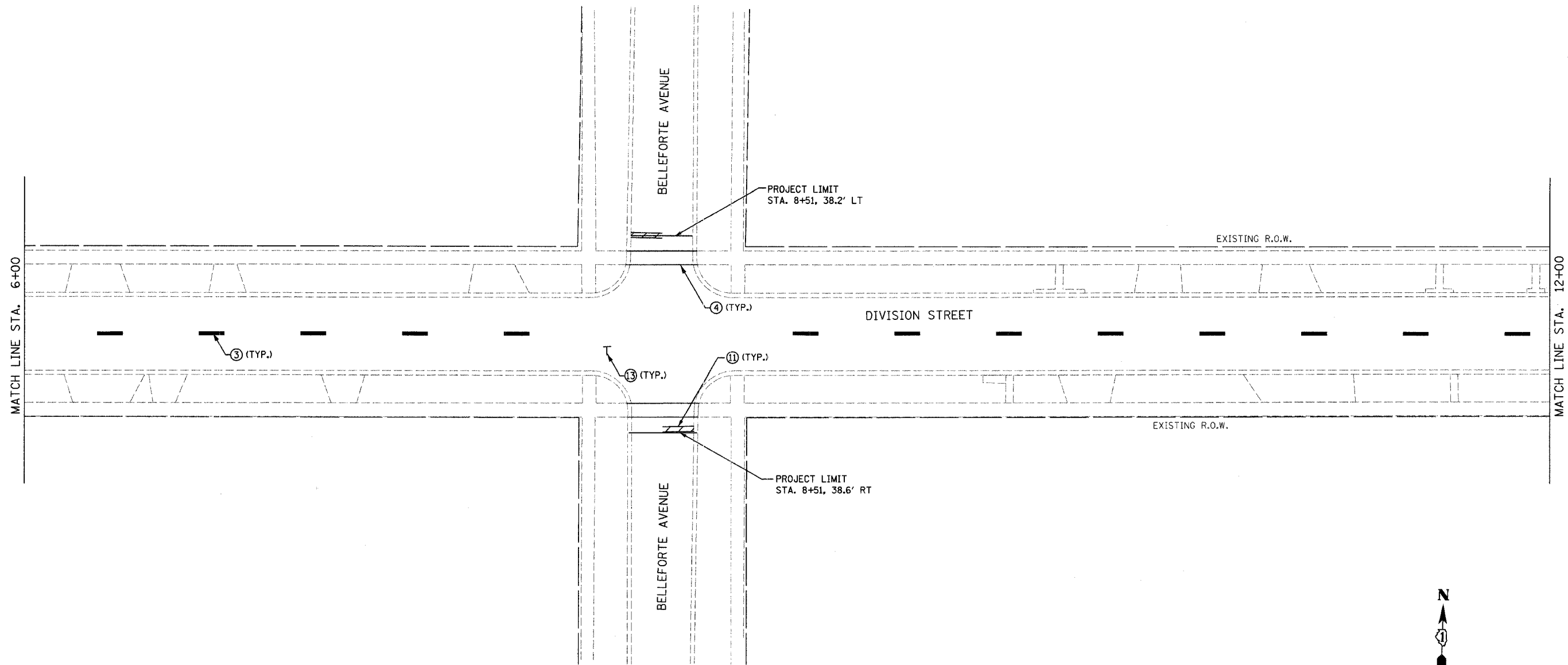

FILENAME: s:\09\751-800\751-506\misc\sheet files\pavement marking plans\division\pavement marking - 02.dgn  
 DATE: 4/2/07  
 TIME: 4:58:48 PM

	REVISIONS		ILLINOIS DEPARTMENT OF TRANSPORTATION	
	NAME	DATE	FAU 1394	
			DIVISION STREET	
			PROPOSED PAVEMENT MARKINGS	
			SCALE: VERT. 1"=40'	DRAWN BY SAK
		HORIZ. 1"=40'	CHECKED BY JDM	
		DATE 1/9/2007		