

F.A.U. RTE.	SECTION	COUNTY	TOTAL SHEETS	SHEET NO.
2638	00-00139-00-RS	DUPAGE	68	15
STA. 88+00		TO STA. 100+00		
FED. ROAD DIST. NO.		ILLINOIS FED. AID PROJECT		
PROJECT NO.: M-8003 (663)				

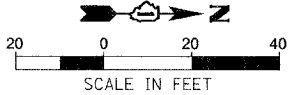

MATCHLINE STA. 88+00
SEE SHEET 6 OF 9

MATCHLINE STA. 94+00
SEE BELOW

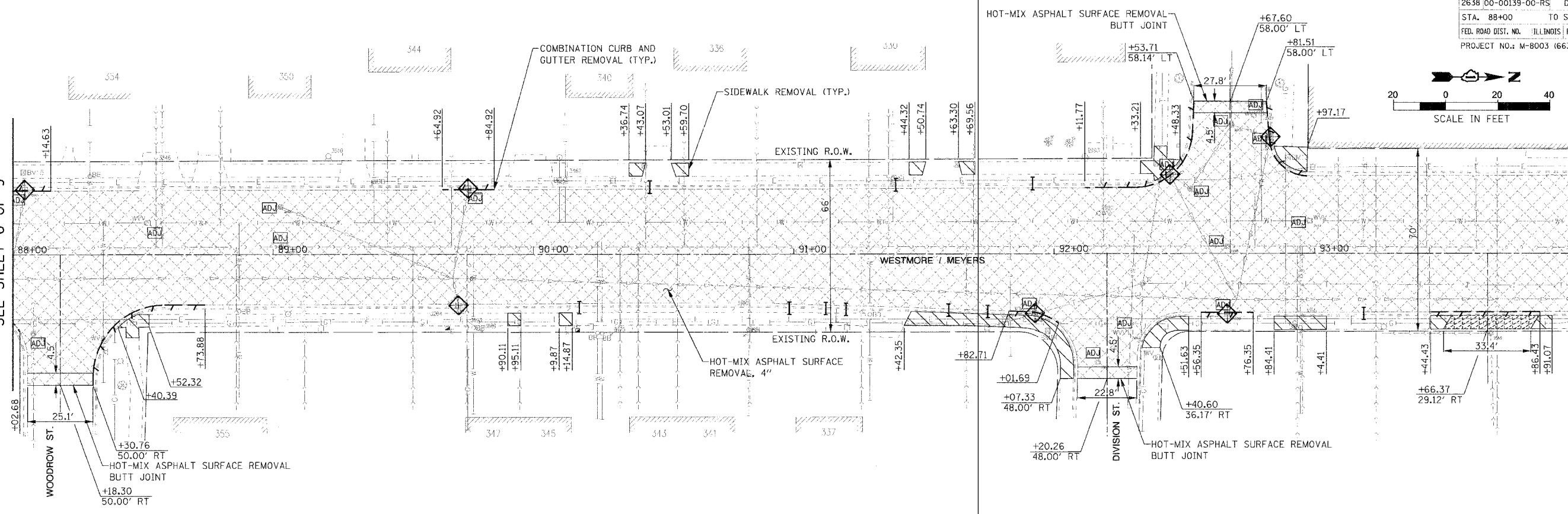

MATCHLINE STA. 94+00
SEE ABOVE

MATCHLINE STA. 100+00
SEE SHEET 8 OF 9

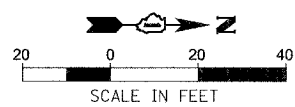
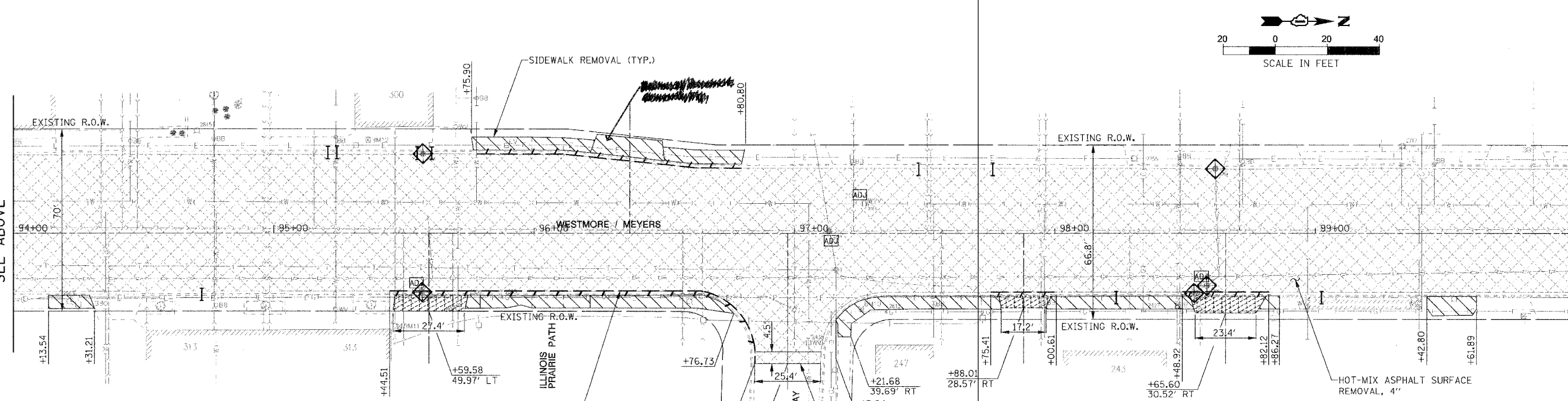

PLT DATE = 1/27/2007
FILE NAME = I:\Lombard\41485 Westmore Meyers Resurfacing\CAD\p-pat7.dgn

REVISIONS		ILLINOIS DEPARTMENT OF TRANSPORTATION
NAME	DATE	
		VILLAGE OF LOMBARD WESTMORE / MEYERS RESURFACING PROJECT REMOVAL PLAN SHEET 7 OF 9

SCALE: 1:20
DATE: 01/31/07

DRAWN BY: JRH
CHECKED BY: JMT