

F.A.U. RTE.:	SECTION:	COUNTY:	TOTAL SHEETS:	SHEET NO.:
2638	00-00139-00-RS	DUPAGE	68	20
STA. 33+00	TO STA. 45+00			
FED. ROAD DIST. NO.:		ILLINOIS FED. AID PROJECT		
PROJECT NO.: M-8003 (663)				

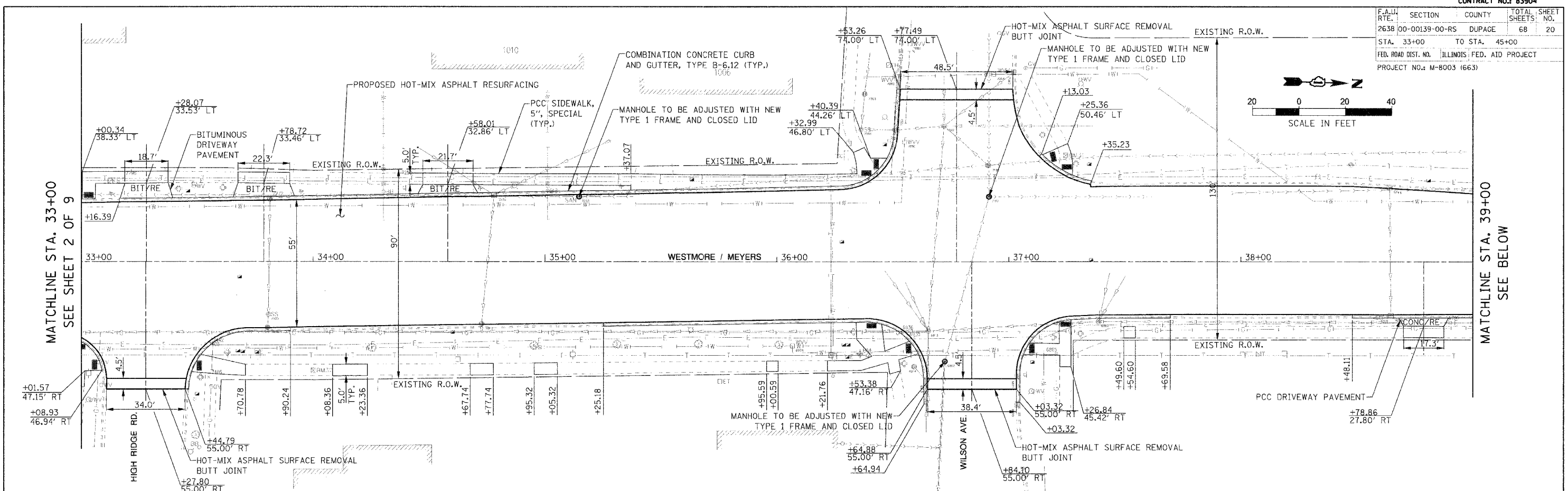

MATCHLINE STA. 33+00
SEE SHEET 2 OF 9

MATCHLINE STA. 39+00
SEE BELOW

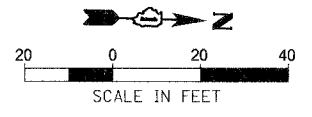
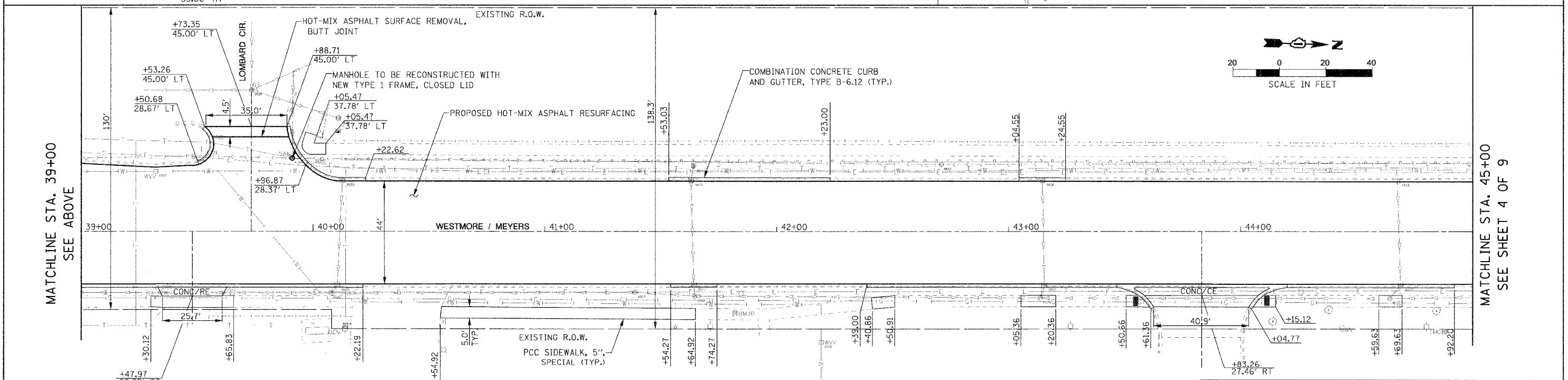

MATCHLINE STA. 39+00
SEE ABOVE

MATCHLINE STA. 45+00
SEE SHEET 4 OF 9

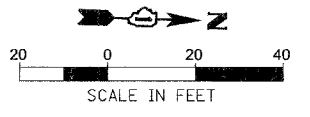

PLT DATE = 1/27/2007
FILE NAME = I:\Lombard\141489 Westmore Meyers Resurfacing\CAD\upah03.dgn

REVISIONS	
NAME	DATE

ILLINOIS DEPARTMENT OF TRANSPORTATION

VILLAGE OF LOMBARD
WESTMORE / MEYERS RESURFACING PROJECT

PROPOSED PLAN
SHEET 3 OF 9

SCALE: 1:20
DATE: 01/31/07

DRAWN BY: JMT
CHECKED BY: JMT