

F.A.D. COUNTY SECTION	TO
ROUTE 87335	SH
5348 STATE SECTION	DEKALB 4
06-00160-02-WR	
CROSS SECTIONS STA. 131+00 TO STA.	
F.H.W.A. REG.5 ILLINOIS PROJECT HPP-	

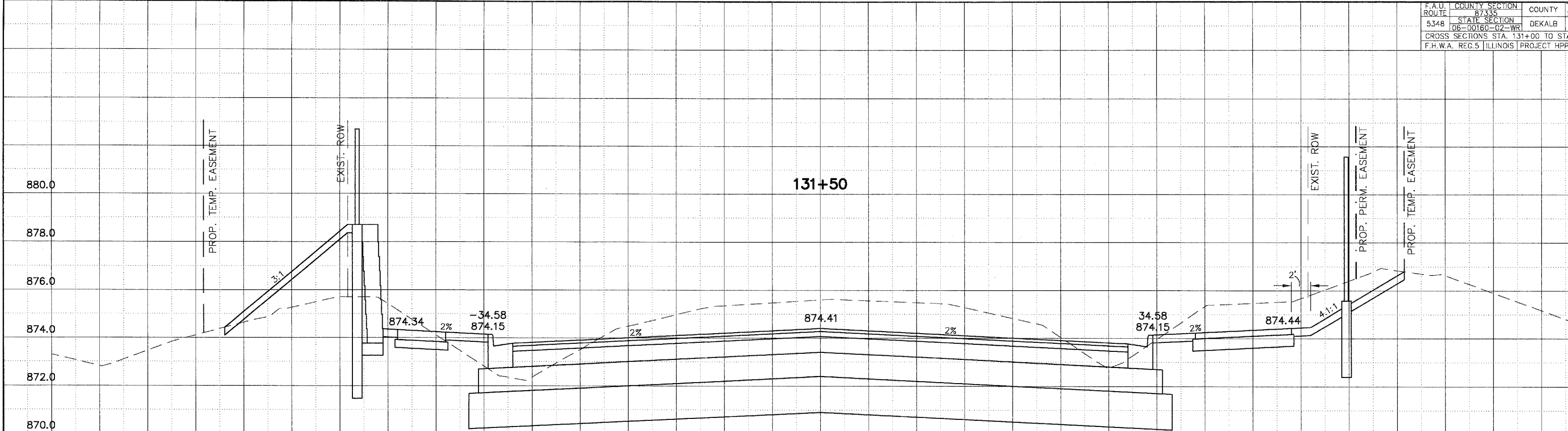

Cut = 220.1 (SF)  
 Fill = 21.2 (SF)  
 Unsuitable = 109.7 (SF)

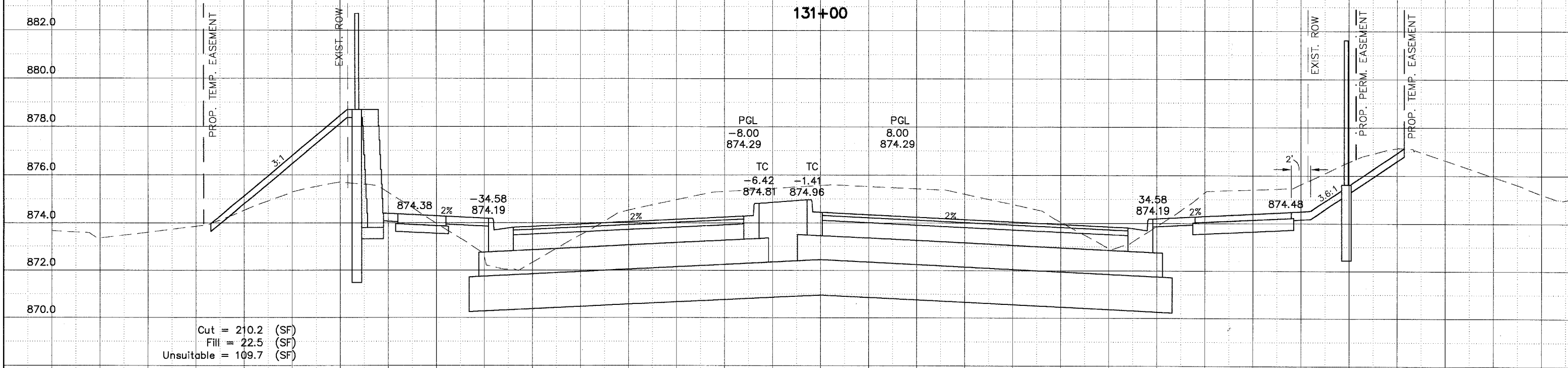

Cut = 210.2 (SF)  
 Fill = 22.5 (SF)  
 Unsuitable = 109.7 (SF)

ANNIE GLIDDEN ROAD

SCALE:  
 1" = 5' HORIZ.  
 1" = 2' VERT.