

INDEX OF SHEETS

Sheet No.	Description
1	COVER SHEET
2	TYPICAL CROSS SECTION AND DETAILS
3	DETAILS & SCHEDULES

STANDARDS

701301-02	TRAFFIC CONTROL
701306-01	TRAFFIC CONTROL
702001-06	TRAFFIC CONTROL

SUMMARY OF QUANTITIES

CODE NO.	DESCRIPTION	QUANTITY	UNIT
* 40600100	BITUMINOUS MATERIALS (PRIME COAT)	4395	GALLON
40600300	AGGREGATE (PRIME COAT)	89	TON
40600625	LEVELING BINDER (MACHINE METHOD), N50	1226	TON
40600982	HOT-MIX ASPHALT SURFACE REMOVAL - BUTT JOINT	189	SQ YD
40600990	TEMPORARY RAMP	16	SQ YD
* 40603310	HOT-MIX ASPHALT SURFACE CSE. MIX "C", N50	1541	TON
40800050	INCIDENTAL HOT-MIX ASPHALT SURFACING	46	TON
* 48101200	AGGREGATE SHOULDERS, TYPE B	921	TON
67100100	MOBILIZATION	1	L SUM
* 70100460	TRAFFIC CONTROL AND PROTECTION, STD 701306	1	L SUM
* 70300100	SHORT-TERM PAVEMENT MARKING	1172	FOOT

Construction Code 1000

\* Special Provisions

CONTRACT NO. 87340

J.U.L.I.E. 1-800-892-0123

STATE OF ILLINOIS  
DEPARTMENT OF TRANSPORTATION  
COUNTY OF KANKAKEE  
DEPARTMENT OF HIGHWAYS  
PLANS FOR PROPOSED  
FEDERAL AID SECONDARY PROJECT  
SECTION 05-00073-04-RS  
F.A.S. 318 (C.H.25) PROJECT RS-318 (105)  
JOB NO. C-93-029-07

F.A.S. ROUTE NO.	SEC.	COUNTY	NO. SHEETS	SHEET NO.
318	*	Kankakee	3	1
ILLINOIS PROJECT RS-318 (105)			CONTRACT NO. 87340	

\* 05-00073-04-RS

KANKAKEE COUNTY

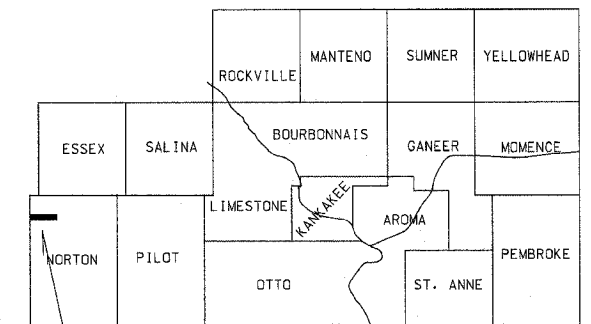

PROJECT LOCATION

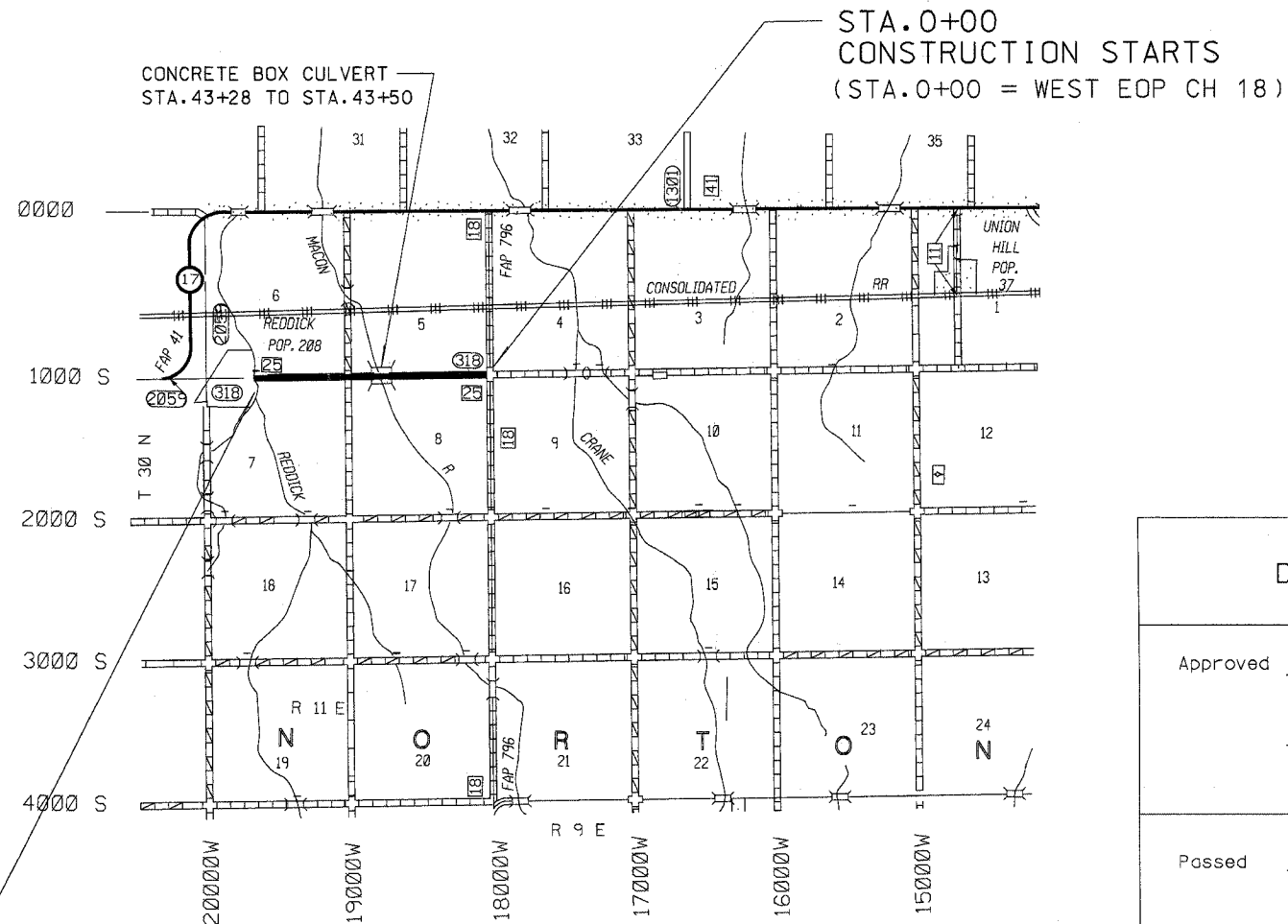

STA. 89+22  
CONSTRUCTION ENDS  
(EAST EDGE BR. DECK)

LOCATION MAP

GROSS LENGTH = 8,922 LIN FT = 1.69 MILES

THE ACCEPTANCE OF THIS PROJECT IS BASED ON THE MINIMUM DESIGN CRITERIA FOR LOCAL AGENCY PAVEMENT PRESERVATION POLICY (LAPP) PROJECTS

CLASS III ROAD  
2007 CURRENT A.D.T. = 525  
2017 DESIGN A.D.T. = 580  
DESIGN SPEED = 55 M.P.H.  
ROADWAY CLASSIFICATION = COLLECTOR

STATE OF ILLINOIS  
DEPARTMENT OF TRANSPORTATION  
DIVISION OF HIGHWAYS

Approved 2-6 2007

JAMES W. PIEKARCZYK, P.E.  
KANKAKEE COUNTY ENGINEER

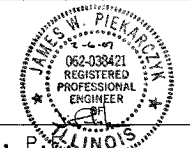

Passed 02-13 2007

KENNETH R. LANG  
BUREAU CHIEF, LOCAL ROADS & STREETS

Releasing for Bid Based on Limited Review 02-13 2007

DIANE O'KEEFE  
REGION 2 ENGINEER